

ILLUSTRATED

ASSEMBLY INSTRUCTIONS
REPAIR MANUAL

FOR MODELS:

AU8-11DB, AU8-16DB, AU8-21DB

CARDINAL

PORTABLE

8 inch

Auger

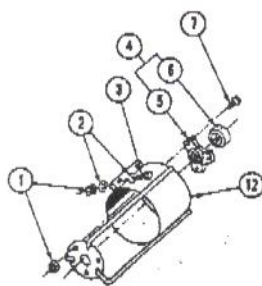
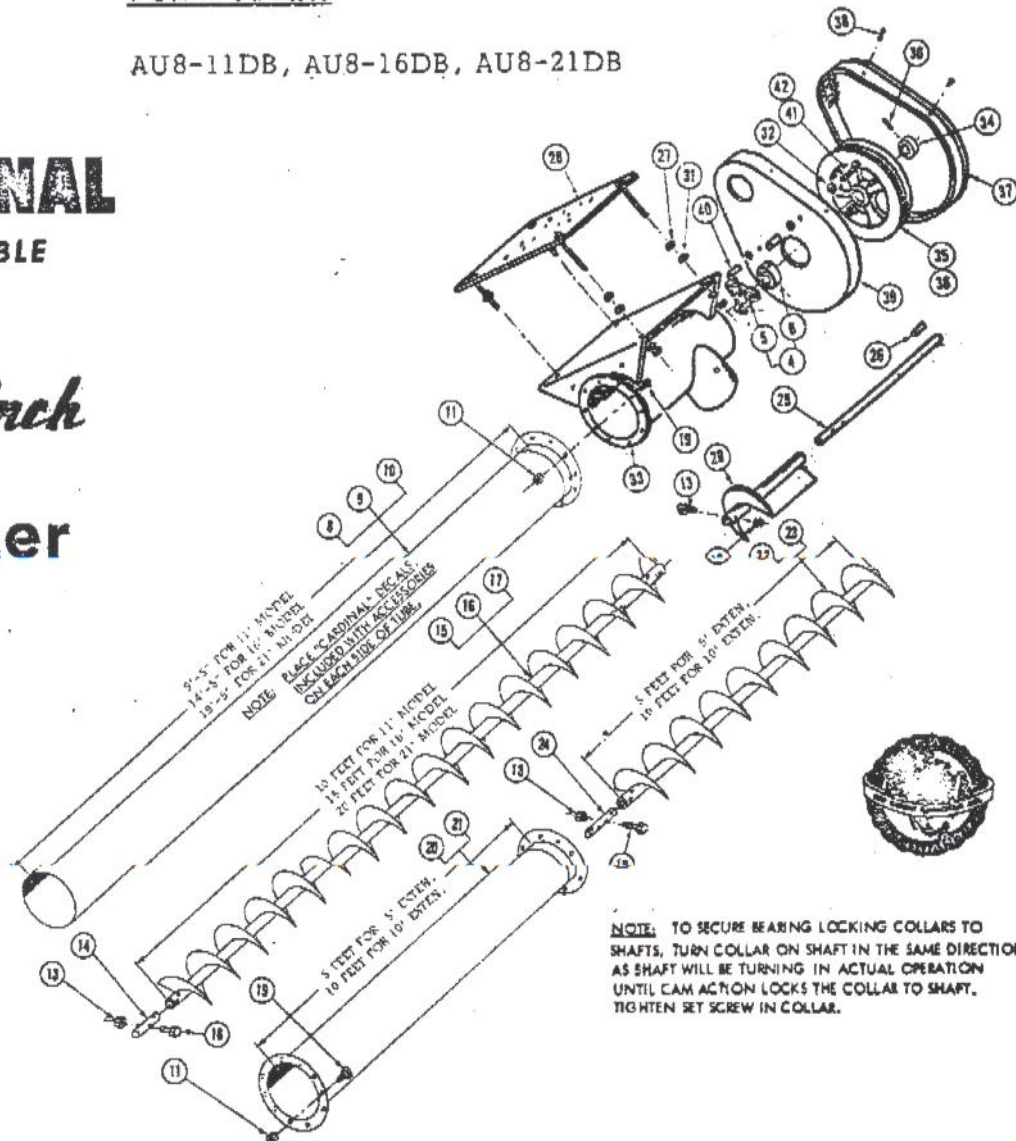

NOTE: TO SECURE BEARING LOCKING COLLARS TO SHAFTS, TURN COLLAR ON SHAFT IN THE SAME DIRECTION AS SHAFT WILL BE TURNING IN ACTUAL OPERATION UNTIL CAM ACTION LOCKS THE COLLAR TO SHAFT. TIGHTEN SET SCREW IN COLLAR.

KEY NO.	PART NO.	DESCRIPTION
1	A20621	Locknut 3/8-16UNC
2	A20622	Flat Washer 3/8 Nom.
3	A20623	Cap Screw 3/8-16UNC x 1
4	A20648	Ball Bearing
5	A20776	Fig. Bearing Elock
6	20777	Bearing Collar
7	A21036	Carriage Bolt 3/8-16UNC x 1
8	A21036	Tube (9'-5" lg.)
9	A21037	Tube (14'-5" lg.)
10	A21035	Tube (19'-5" lg.)
11	A21065	Locknut 5/16-18UNC
13	A21065	Locknut 3/8-24UNF
14	A21065	Intake Shaft
15	A20613	Auger Screw (10'-0")
16	A21042	Auger Screw (15'-0")
17	A21043	Auger Screw (20'-0")
18	A21043	Cap Screw 3/8-24UNF x 2

19	A20621	Cap screw 5/16-18UNC x 3/4
20	A20621	Tube (5'-0" lg.)
21	A20618	Tube (10'-0" lg.)
22	A20625	Auger Screw (5'-0")
23	A20616	Auger Screw (10'-0")
24	A20626	Coupler Shaft
25	24469	Drive Shaft
26	19179	Square Key
27	A24413	Wash Nut 1/2-13UNC
28	A24413	Motor Plate
29	A24466	Discharge Screw
30	10022	Spring Pin
31	A24464	Flat Washer 1/2 Nom.
32	14769	Fender Washer
33	A24464	Discharge Band
34	20652	Thrust Collar
35	A21058	V-Belt Pulley (16)
36	A21059	V-Belt Pulley (20)
37	24432	Guard Face
38	23C43	Self Tapping Screw
40	23C43	Spacer
41	A21059	Cap screw 1/4-20UNC x 1-3/4
42	A21043	Locknut 1/4-20UNC