

# CARDINAL

CARDINAL GRAIN SYSTEMS

P.O. BOX 992

COLUMBIA CITY IN 46725

PH: 219-244-4654

FAX: 219-244-7355

## 8" SELF POWERED HOPPER 4' ELECTRIC DRIVE

KEY	DESCRIPTION	PART #	UNIT	KEY	DESCRIPTION	PART #	UNIT
1.	8" GALV TUBE	A28089	1	17.	DIS SPOUT	A27546	1
2.	DIS SCREW	A28095	1	18.	WHEEL	16022	2
3.	HOPPER W/A	A28086	1	19.	WHEEL SUPPORT	28656	4
4.	INTAKE GUARD	A28601	1	20.	AXLE	27457	1
5.	WHEEL CLEVIS	30395	2	21.	U JOINT SHAFT	25322	1
6.	HOPPER SCREW	A28010	1	22.	U JOINT W/A	A27420	1
7.	SLIDE GATE	28551	1	23.	ACCESS DOOR	23407	1
8.	STRAP	28553	1	24.	U JOINT SHAFT	25326	1
10.	HOOKUP BAND	A28393	2	25.	BEARING 1 1/4	A20648	2
12.	1/2 BAND	28364	4	26.	HOPPER WHEEL	24896	2
				27.	WHEEL SHAFT	30396	2
51.	BACKPLATE	26999	1	28.	HOPPER SHAFT	27421	1
52.	DIS HEAD	A27108	1				
53.	MOTOR MT	A24413	1	59.	THRUST COLLAR	20652	1
55.	PULLEY	A21059	1	60.	BELT GUARD	A27496	1
58.	DRIVE SHAFT	21057	1	61.	SPACER	23021	2
				64.	BRG ASSY 1 1/4	A23415	1
<u>HARDWARE &amp; DECALS</u>							
31.	SELF TAP SCREW	1319	4	42.	LOCKNUT 3/8-16	1274	33
32.	HHCS 3/8-16X1	1175	17	43.	FLAT WASHER 3/4	1297	4
33.	CAR BOLT 3/8-16X1	1217	6	44.	FLAT WASHER 3/8	1294	6
34.	HHCS 5/16-18X1	1159	10	45.	COTTER PIN 1/8X1 1/2	1150	4
35.	SP PIN 3/16X1 1/4	15389	2	46.	WINGNUT 1/4-20	21872	2
36.	HHCS 3/8-16X 1 1/2	1177	8	47.	"DANGER" DECAL	23491	1
37.	HHCS 3/8-24X2	1201	8	48.	"CARDINAL" DECAL	26010	2
38.	HHCS 3/8-16X2 1/2	1851	2	49.	"CAUTION" DECAL	27018	1
				50.	LOCKNUT 1/4-20	1271	2
				54.	SP PIN 1/4X1 5/8	10023	1
40.	LOCKNUT 3/8-24	1280	8	56.	WHIZ NUT 1/2-13	1332	8
41.	LOCKNUT 5/16-18	1273	10	57.	HHCS 14-20X2	1356	2
				62.	SQ KEY	19179	1
				63.	LOCKNUT 1/2-13	1276	1

**FOR 8' ELECTRIC DRIVE HOPPER ADD OR SUBSTITUTE THE FOLLOWING:**

### ADDITIONS:

KEY #	DESCRIPTION	PART #	UNIT
4.	INTAKE GUARD	A28601	1
32.	HHCS 3/8-16X1	1175	8
42.	LOCKNUT 3/8-16	1274	8

### SUBSTITUTIONS

KEY #	DESCRIPTION	PART #	FOR #
3.	HOPPER W/A	A28088	A28086
6.	HOPPER SCREW	A28049	A28010

FOOTNOTE: #22 USTAIN (INSTALL JAINI HALF WITH GREASE ZERK ON INCLINE SCREW)

MAKING THIS MEASUREMENT W/IER  
COULD GIVE W/IER KIT TO COLLAPSE!

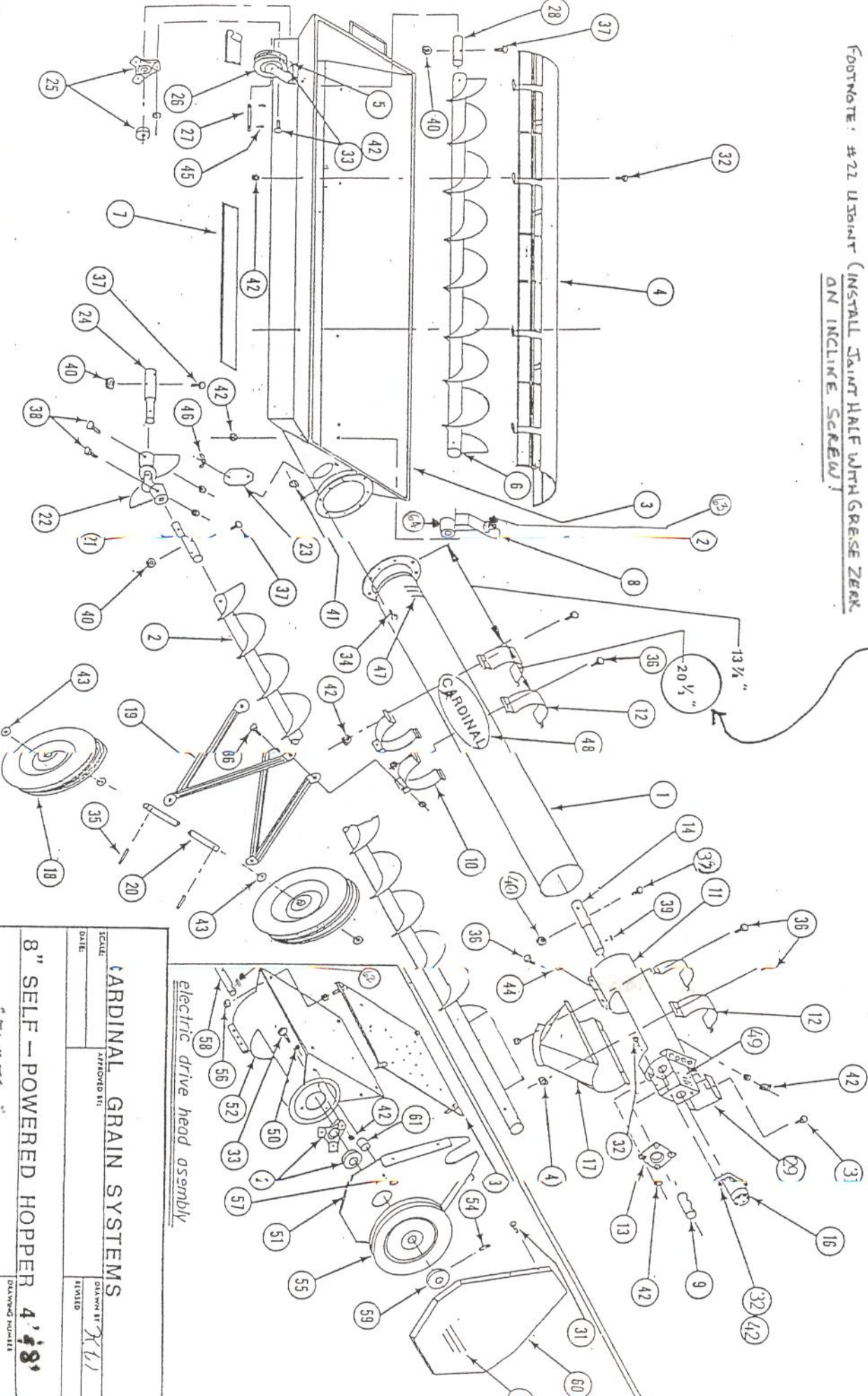

electric drive head assembly

CARDINAL GRAIN SYSTEMS

8" SELF-POWERED HOPPER 4'x8'  
"ELECTRIC"

SCALE:	APPROVED BY:	DRAWN BY:
DATE:	REVISED:	DRAWING NUMBER: