

FRONT VIEW: # 12-1350001'S (INSTALL JOINT HALF WITH GREASE ZERK ON INCLINE SCREW)

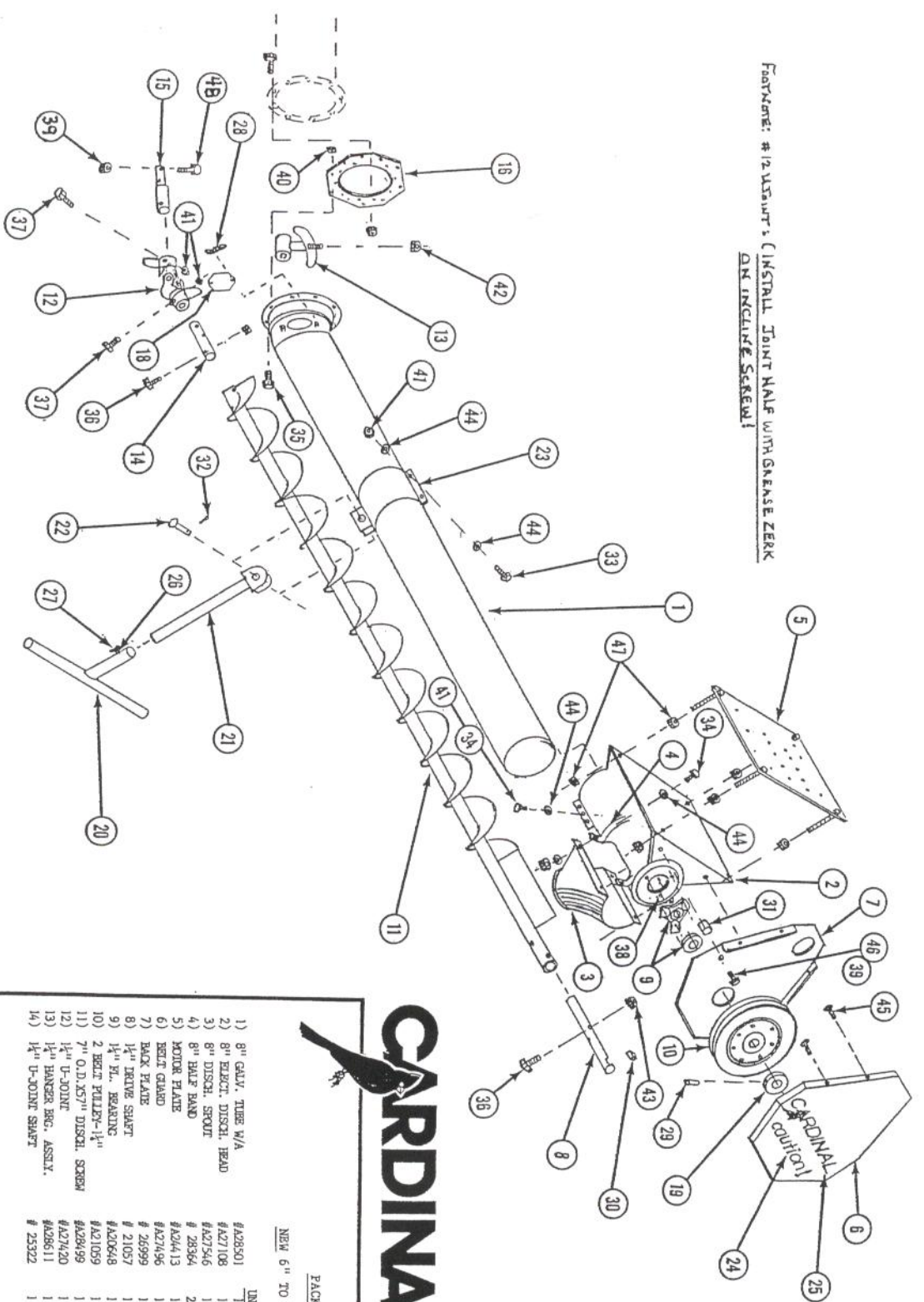

CARDINAL



PACKING LIST NEW 6" TO 8" INCLINE AUGER

1) 8" GAUV. TUBE W/A	#A28501	1	UNIT	1
2) 8" BLK/CL. DISCH. HEAD	#A27108	1	UNIT	1
3) 8" DISCH. SCOUT	#A27546	1	UNIT	1
4) 8" HALF BAND	#28364	2	UNIT	1
5) MOTOR PLATE	#A24413	1	UNIT	1
6) BELT GUARD	#A27496	1	UNIT	1
7) BACK PLATE	#26999	1	UNIT	1
8) 1 1/2" DRIVE SHAFT	#21057	1	UNIT	1
9) 1 1/2" H. BEARING	#A20648	1	UNIT	1
10) 2 BELT PULLEY-1 1/2"	#A21089	1	UNIT	1
11) 7" O.D. X 57" DISCH. SCREW	#A29499	1	UNIT	1
12) 1 1/2" U-JOINT	#A27420	1	UNIT	1
13) 1 1/2" HANGER BRG. ASSEMB.	#A28611	1	UNIT	1
14) 1 1/2" U-JOINT SHAFT	#25322	1	UNIT	1
15) 3/8" - 1 1/2" COUPLER SHAFT	#25321	1	UNIT	1
16) 6" TO 8" ADAPTER PLATE	#28304	1	UNIT	1
17) ACCESS DOOR	#23407	1	UNIT	1
18) THROBUST COLLAR	#20052	1	UNIT	1
19) BASE-STAND	#A26733	1	UNIT	1
20) CLEVIS	#A26736	1	UNIT	1
21) CLEVIS PIN	#26732	1	UNIT	1
22) 8" CLAMP BAND W/A	#A26371	1	UNIT	1
23) BECAL. (OPTION)	#27018	1	UNIT	1
24) BECAL. (CARDINAL)	#26319	1	UNIT	1
25) BECAL. (CARDINAL)	#26319	1	UNIT	1

HARDWARE ALL COMPONENTS

26) WING NUT (#A26355)	#15476	1	UNIT	3
27) WING NUT (#A26355)	#19350	1	UNIT	2
28) WING NUT 1/2-20	#21872	2	UNIT	10
29) SPRING PIN 1/4-1 5/8"	#10023	1	UNIT	10
30) SR. KEY 1/4-1 1/2"	#19179	1	UNIT	1
31) SPACER PIN 1/8x1 1/4" (#A26355)	#23021	2	UNIT	6
32) HES 3/8-16x1 1/4"	#11775	2	UNIT	18
33) HES 3/8-16x1 1/4"	#11775	2	UNIT	18
34) HES 5/16-18x3/4" (#28504)	#1195	10	UNIT	4
35) COUPLER BOLT 3/8-20x2 GR. 5	#1201	4	UNIT	8
36) COUPLER BOLT 3/8-16x2 1/4"	#1551	2	UNIT	2
37) COUPLER BOLT 3/8-16x2 1/4"	#1551	2	UNIT	2
38) CARRIAGE BOLT 3/8"x1 1/2"	#1217	3	UNIT	3
39) HEX LOCKNUT 1/2-20	#1271	2	UNIT	2
40) HEX LOCKNUT 5/16-18	#1273	10	UNIT	10
41) HEX LOCKNUT 3/8-16	#1274	10	UNIT	10
42) HEX LOCKNUT 1/2-13	#1276	1	UNIT	1
43) HEX LOCKNUT 3/8-24	#1280	6	UNIT	6
44) FLAT WASHER 3/8"	#1294	18	UNIT	18
45) SET SCREW 1/4"	#1319	4	UNIT	4
46) HES 1/2-20x1 1/4"	#1329	2	UNIT	2
47) HEX LOCKNUT 1/2-13 FL. WHTZ	#1332	8	UNIT	8
48) COUPLER BOLT 1/2-20x1.345"	#23069	2	UNIT	2