

PACIFIC NORTHWEST POLITICAL SCIENCE ASSOCIATION
ANNUAL MEETING 2022

November 10-12

Marcus Whitman Hotel, Walla Walla

Draft Conference Schedule

THURSDAY

5:00-6:00pm: Registration

LOBBY

6:30-8:30pm: 75th Anniversary Dinner – ticket required

EMPIRE

FRIDAY

7:30am onwards

Registration

LOBBY

8:15-9:45am

State, local, and provincial; Public policy – public energy preferences;
Race, ethnicity, and politics

STATE, LOCAL & PROVINCIAL POLITICS

SACAJAWEA

Chair: **Priscilla Southwell**, University of Oregon

Discussant: **Priscilla Southwell**, University of Oregon

Katie Gower, Eastern Washington University

“Compassionate Revanchism, Homelessness, and the Divided Local State: The Case of Spokane, WA”

Bill Haltom, University of Puget Sound

“Teaching Elazar’s Formulations of Political Cultures through Qualitative Crosstabulation”

Sarah James, Gonzaga University

“The policy feedback effects of data collection capacity during the COVID-19 pandemic”

Ben Larsen (presenter), **Cheong Kim**, **McAllister Hall**, and **Vanessa Fry**, Boise State University

“Idaho Permanent Supportive Housing Comparative Analysis”

Timothy Kaufman-Osborn, Whitman College

“Dr. Faust in Montana: At what price are guns banned from campus?”

PUBLIC POLICY: PUBLIC ENERGY PREFERENCES

CLARK

Chair: **Troy Abel**, Western Washington University
Discussant: **George Busenberg**, Soka University of America

Mahmood Muttaqee, Oregon State University, **Greg Stelmach**, Oregon State University; **Chad Zano**, Stanford University; **June Flora**, Stanford University; **Hilary Boudet**, Oregon State University

“Time of use pricing and willingness to shift energy activities, strategies, and timing”

Muhammad Usman Amin Siddiqi; **Erika Allen Wolters**, Oregon State University
“Group Identities, Value Orientations, and Public Preferences for Energy and Water Resource Management Policy Approaches in the American West”

Najam uz Zehra Gardezi; **Brent S. Steel**; **Angela Lavado**, Oregon State University
“Public Preferences Concerning Food-Water-Energy Policy Tradeoffs”

RACE, ETHNICITY & POLITICS

LEWIS

Chair and Discussant: **Christopher Stout**, Oregon State University

Dennis Young, University of Washington

“ICE and the Digital Dragnet”

Chadwick Pearsall, College of Eastern Idaho

“Memory and Salience of Japanese and Japanese American Internment in the 21st Century”

Christopher Stout, Oregon State University; **Katherine Tate**, Brown University; **Jennifer Garcia**, Oberlin College; **Karina Mondragon**, UCSD

“Social Networking Around Race by U.S. House Members? Cheap Talk or Legislative Intent?”

Gene Straughan, Lewis-Clark State College

“The Right to Trial by Jury, Split-Jury Verdicts, and Systemic Racism”

10:00-11:00am

Peace & conflict studies, Politics and pop culture, Pedagogy and assessment

PEACE & CONFLICT STUDIES

SACAJAWEA

Chair: **Joe Huseby**, Spokane Community College

Discussants: **Paul Lenze**, Northern Arizona University; **Joe Huseby**, Spokane Community College

Paul Lenze, Northern Arizona University; **Christy Blackburn**, Texas A&M University

“The Weaponization of Health: Understanding Changing Global Norms”

Rafiuddin Najam, Oregon State University

“The Taliban's Return to Power: An Empirical Analysis of the Afghan Peace Negotiations”

POLITICS AND POP CULTURE

CLARK

Chair & Discussant: **Rob Harbaugh**, College of Western Idaho

Edwin Taylor, Missouri Western State University

“I need a Hero?: The Rise of the Anti-Hero Archetype in Republican Party Politics”

Richard Clucas, Portland State University

“Mapping Oregon’s Byzantine Approach to Cultural Policymaking”

11:15am-12:30pm

**American politics, International relations,
Public policy – subnational policy topics**

AMERICAN POLITICS

SACAJAWEA

Chair: **Todd Schaefer**, Central Washington University

Discussant: **Earlene Camarillo**, Western Oregon University

John Pierce, University of Kansas; **William Schreckhise**, University of Arkansas; **Brent Steel**, Oregon State University; **Stephanie Witt**, Boise State University; **Francis Benjamin**; **Nicholas Lovrich**; **Steven Stehr**, Washington State University

“The Nexus Between State Citizen Civility & State Legislative Civility: Diverse Patterns of Association in the 50 US State Legislatures”

Kaitlin Holden, Utah State University

“Bipartisan Bills from Caucus Collaboration: Solutions to Polarized or Non-Polarized Issues?”

INTERNATIONAL RELATIONS

CLARK

Chair: **Ross Burkhart**, Boise State University

Discussants: **Ross Burkhart**, Boise State University; **Leif Hoffmann**, Lewis-Clark State College

Ross Burkhart, Boise State University

“The Perils of Election Forecasting: The Case of Israel”

Eduardo Gallo-Cajiao, University of Washington; **Brad Andreas**, U.S. Fish & Wildlife Service; **Isadora Angarita-Martinez**, Manomet; **Taej Mundkur**, Wetlands Institute; **Spike Millington**, International Crane Federation; **Nick Davidson**, Charles Sturt University; **Nives Dolšak**, University of Washington

“The Emergence of the Regime Complex for Conserving Migratory Shorebirds in the Western Hemisphere”

Holly Yoo, Washington State University

“The Impact of the U.S. Military Presence in South Korea towards North Korean Containment”

PUBLIC POLICY: SUBNATIONAL POLICY TOPICS

LEWIS

Chair & Discussant: **Troy Abel**, Western Washington University

Sebastian Ruiz; Donald Cooper; Nicholas Wong; Anna Ivanova; Cortney Franklin; and **Season Hoard**, Washington State University

“A systematic review of the root causes of homelessness: What do we really know?”

Season Hoard, Washington State University; **Daniel Mueller**, (USCGA); **Nana Bamea Kyei-Boadu**, Washington State University

“Updating truck driving licensing requirements to address supply chain issues: An analysis of Washington State”

Jax Richards, Oregon State University

“Restructuring the Earned Income Tax Credit: An Economic Microsimulation of Oregon’s EITC against a Working Families Tax Credit Model”

12:45-2:00pm

Lunch – ticket required

RENAISSANCE

Speaker: Former Ambassador Ryan Crocker
“The U.S. and the Middle East: Lessons from a long war”

2:15-3:30pm

Roundtable

POLITICAL ISSUES IN THE PACIFIC NORTHWEST

SACAJAWEA

- **Mark Henkels**, Western Oregon University
- **Leif Hoffmann**, Lewis-Clark State College
- **T.M. Sell**, Highline College

3:45-5:15pm

Poster session, Theory, Public policy – energy policy and politics,
Comparative politics

POSTER SESSION (will be displayed through reception)

LOBBY

Discussant: **Leif Hoffmann**, Lewis-Clark State College

Allyse Waggener, Lewis-Clark State College

“The Implications of Differential Reproductive Healthcare Access on Polarization in the United States”

Sydney Smith; Edward Greer; William Favell, Washington State University

“Masculinity on the campaign trail: the role of masculine identities in male vs male elections”

Rebecca LaRue, Washington State University

“From the Parks to the Polls: National Parks, Place Attachment, and Environmental Voting Behavior”

Anna Ivanova, Washington State University

“Governmental Agencies and Epistemic Communities: The Influence of Resource Origin on Public Support for Climate Change Policy”

Nicholas Wong, Washington State University

“Understanding supply elasticity and housing crises: Review of economic theory”

THEORY

SACAJAWEA

Chair & Discussant: **Curtis Johnson**, Lewis & Clark College

Peter Steinberger, Reed College

“Habermas, Brandom and the Politics of Pragmatism”

Robert Herold

“Examining The Foundational Paradigm of Causality”

Mark Fagiano, Washington State University

“Empathy, Polarization, & Democracy”

Jack Jackson, Whitman College

“Constitutional Time in the Political Thought of Martin Luther King, Jr.”

Christopher England, College of Western Idaho

“Between Post-Politics and History: Democracy at the Crossroads in the 21st Century”

PUBLIC POLICY: ENERGY POLICY & POLITICS

CLARK

Chair & Discussant: **Troy Abel**, Western Washington University

Anil Hira, Simon Fraser University

“BC’s LNG Play: Reasonable Transition Fuel or Environmental Disaster?”

Greg Stelmach, Oregon State University; **Hilary Boudet**, Oregon State University; **Diane Brandt**, Renewable Northwest; **Shawn Hazboun**, Oregon State University

“Public Perceptions of Wave Energy Development on the West Coast of North America.: Risks, Benefits, and Coastal Attachment”

George Busenberg, Soka University of America

“The Politics of Arctic Oil”

COMPARATIVE POLITICS

LEWIS

Chair & Discussant: **Season Hoard**, Washington State University

Adam Golob, Whatcom Community College

“Coerced Criminality in the Northern Triangle”

Vernon Demani Johnson, Western Washington University

“Indian South Africans as a middleman minority: historical and contemporary perspectives”

Todd Nelson, Cleveland State University; **Patrick Mahoney**, Washington State University

“War, Memory and Nostalgia: Militarization as a Consequence of Post-Soviet Uncertainty in Russia”

5:30pm
MEMBERSHIP MEETING, ELECTIONS & RECEPTION
ALL ENCOURAGED AND WELCOME TO JOIN!

SACAJAWEA & LOBBY

SATURDAY

8:30-9:45am
Roundtable

MIDTERM ELECTION ROUNDTABLE

SACAJAWEA

Moderator: **Rob Harbaugh**, College of Western Idaho

- **Todd Donovan**, Western Washington University
- **Kevin Pirch**, Eastern Washington University
- **Todd Schaefer**, Central Washington University
- **Priscilla Southwell**, University of Oregon

10:00-11:15am

Media and public opinion, Environmental politics, Gender and politics

MEDIA & PUBLIC OPINION

SACAJAWEA

Chair: **Furkan Cakmak**, Washington State University

Discussants: **Travis Ridout**, **Timothy Chatburn**,

Timothy Chatburn, Washington State University and Spokane Falls Community College

“Why Get Political? The Effect of Priming Rural and Urban Identities on Political Evaluations”

Travis Ridout, Washington State University; **Michael Franz**, Bowdoin College; **Erika Franklin**

Fowler, Wesleyan University; **Taewoo Kang**, Siena College

“Citizens’ Perceptions of Television and Online Political Advertising”

Todd Schaefer, Central Washington University

“Are Things Different Today? Comparing Coverage of Female Veep Ticket "Firsts" - Ferraro '84 & Harris '20”

ENVIRONMENTAL POLITICS

CLARK

Chair: **Erika Wolters**, Oregon State University
Discussant: **Debra Salazar**, Western Washington University

Molly Daly; Elley Donnelly; Eduardo Gallo-Cajiao; Nives Dolšak, University of Washington;
Trina Bayard, Audubon Washington
“Implementation of International and National Agreements for Migratory Species: A case Study of Shorebird Conservation in the Pacific Northwest”

Forrest Brungardt; Alicia Lopez; Lina Kritchko; Nives Dolšak, University of Washington
“Do WA Legislators’ Climate Votes Reflect Natural Hazard Risks?”

GENDER AND POLITICS

LEWIS

Chair & Discussant: **Amy Mazur**, Washington State University

Sandra Reineke, University of Idaho
“Assisted Reproductive Technologies and Religious Values: The Case of Pre-Implantation Genetic Diagnosis Regulation in Germany”

Connie Anthony, Seattle University
“The Global Politics of Sexuality: The States that ‘Resist’ New International Norms”

Sydney Smith, Washington State University
“Constructing and Performing Masculinity: The Case of Vladimir Putin’s Pursuit of a Hypermasculine Image”

11:30am-12:45pm

Voting and elections, Public policy – equity and justice, Political psychology

VOTING & ELECTIONS

SACAJAWEA

Chair: **Priscilla Southwell**, University of Oregon
Discussant: **Kevin Pirch**, Eastern Washington University

Todd Donovan, Western Washington University
“Campaigns under Ranked Choice Voting”

Michael Ritter, Washington State University
“Assessing the Impact of the United States Postal System and Election Administration on Absentee and Mail Voting in U.S. Elections”

Priscilla Southwell, University of Oregon
“What’s Wrong with This Picture? Restrictions to Ballot Access, 2020-22”

PUBLIC POLICY: EQUITY AND JUSTICE

CLARK

Chair: **Troy Abel**, Western Washington University

Discussant: **Shane Day**, Portland State University

Troy Abel; Debra Salazar, Madison Bash, Nathan Lloyd, Western Washington University;
Shuang Zhao, University of Alabama Huntsville; **Derek Glasgow**, Augustana College; **David Mendoza; Jamie Stroble**, The Nature Conservancy (TNC)

“Equity for U.S. State Air Quality and Climate Commitments”

Samantha Noll, Washington State University

“Food Sovereignty as Restorative Justice in the City”

Jonah White, Michigan State University

“Political-Economy Implications of Air Pollution Emissions in Seattle: An Environmental Justice Account”

Parakh Hoon, South Puget Sound Community College

“Assessing student transfer trends in Washington state: Successes, gaps, and emerging strategies”

POLITICAL PSYCHOLOGY

LEWIS

Chair & Discussant: **Kylee Britzman**, Lewis-Clark State College

Furkan Cakmak, Washington State University

“Politics Gets Emotional: Examining the Nature and Consequences of Affective Polarization Among Elites”

Jeff Deminchuk, Washington State University

“Relative State and Risky Decision-Making”

12:45pm

CONFERENCE ENDS

MAP OF CONFERENCE ROOMS + LOCATIONS AT MARCUS WHITMAN HOTEL

FINAL PROGRAM

PARKING LOT

PARKING LOT

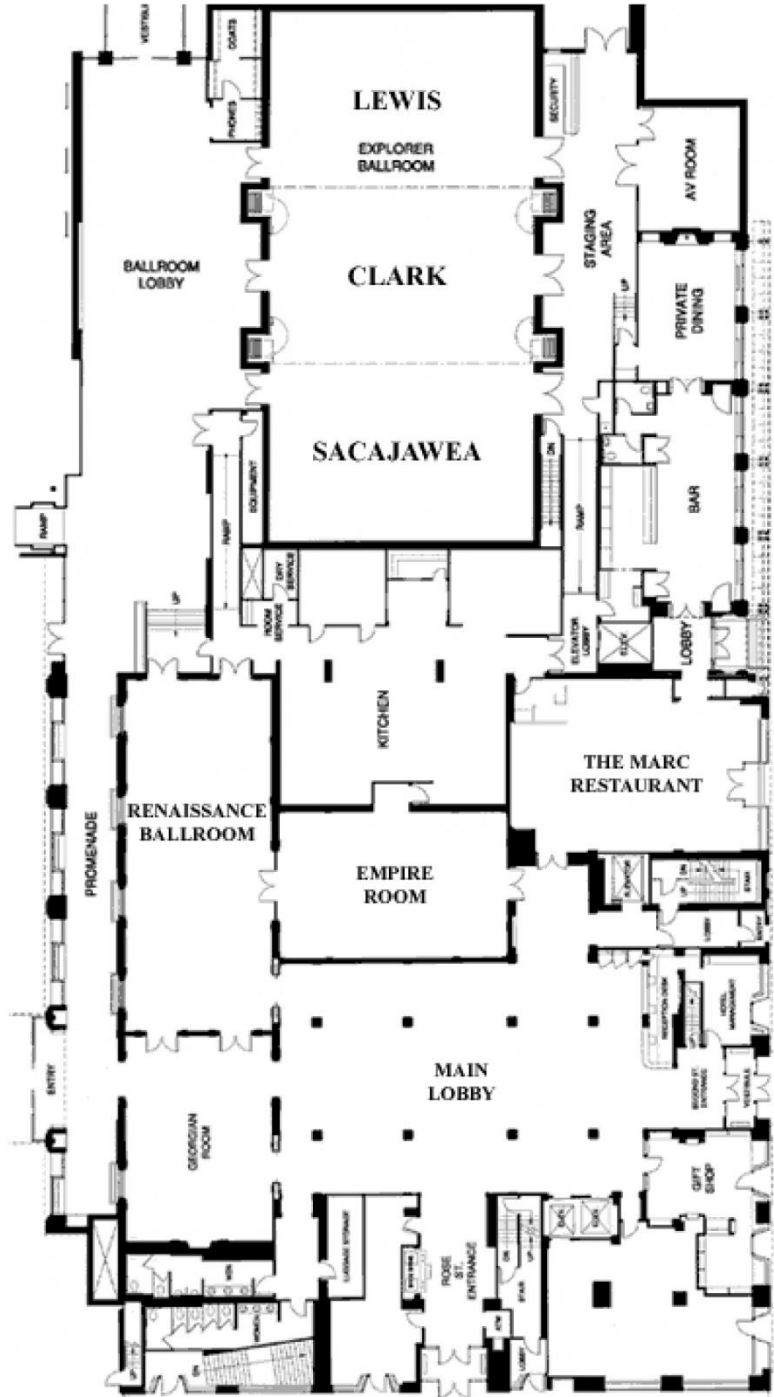

N. SECOND AVE

W. ROSE STREET