

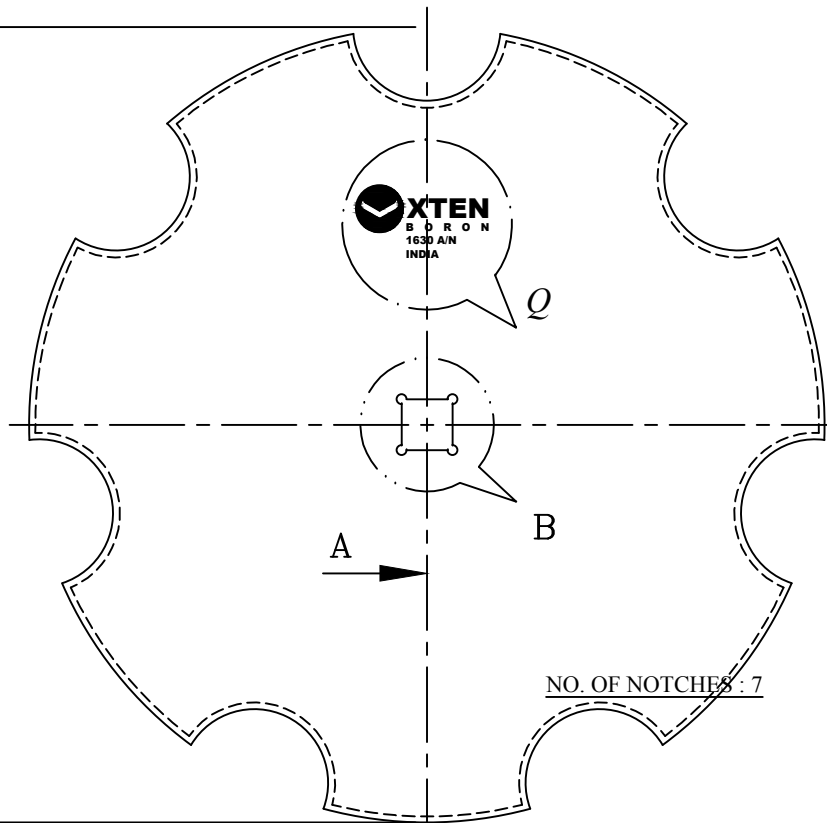

DETAIL - Q  
SCALE - 1:2

±5.0  
406 (16")



NO. OF NOTCHES : 7

NOTE -  
PASS AXLE SIZE - 25.4 mm.  
PASS GAUGE SIZE - 25.7 mm.

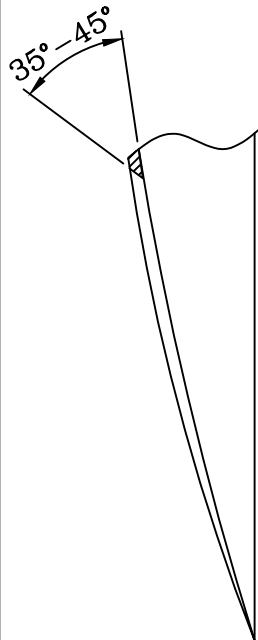
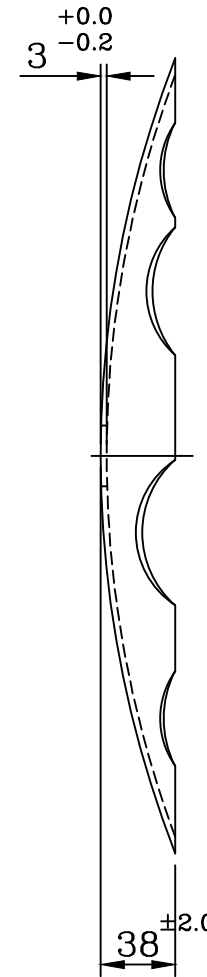

SECTION A-A  
SCALE-1:2

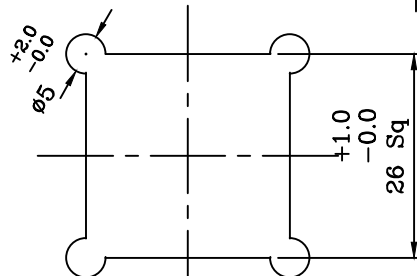

DETAIL - 'B'  
SCALE-1:1

NOTE :-  
ALL DISCS ARE SHOT BLASTED & POWDER COATED  
ALL DIMENSION OTHER - WISE SPECIFIED IN M.M.

<b>STATUTORY WARNING</b> THIS DESIGN IS THE PROPERTY OF M/S NIPHA EXPORTS (P) LTD. 28/1 SHAKESPEAR SARANI, KOL- 17 AND IS ONLY ALLOWED TO BE USED BY EXPRESS PERMISSION AND LICENCE FROM M/S NIPHA EXPORTS (P) LTD.		PROJ./PROD./STD./ENQ./CDS./ SODS. NO.-		<b>NIPHA</b> KOLKATA-INDIA	
DON'T SCALE IF ANY DOUBT , PLEASE ASK		SCALE- 1:4		CLIENT- .	
RAW MATL. SPCN.- 28 Mn B5/30 Mn B5 HARDNESS .- 46-52 HRC FINISH .- BLACK FINISH MATL. WT.-		QTY.- .		TITLE- HARROW DISC NOTCHED	
Remark- .		CODE- .		ASSE'D ON- .	
PROTECTION-		LISTED ON-		DESIGN CAL. SHT. NO.-	
DRAWN BY		D. HAZRA		21.09.17	
CHKD. BY		.		PART NO./ DRAWING NO.	
APPROVED BY		.		REV.	
				US/B/1630A/N	

REV.	DATE	REV. BY	CHKD. BY	DESCRIPTION OF REVISION	REMARKS