

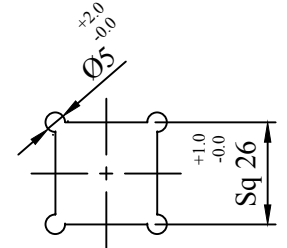

DETAIL - Q  
SCALE - 1:2

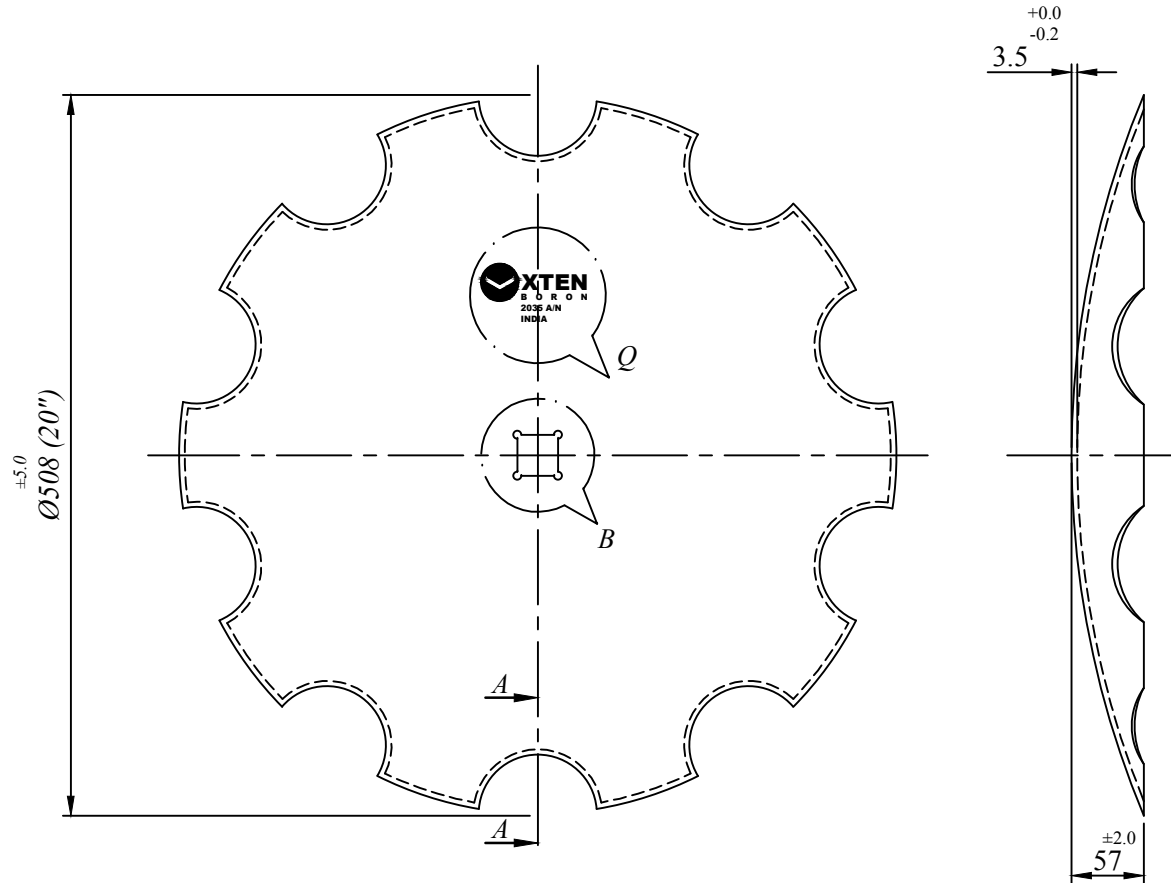

DETAIL - B  
SCALE - 1:2

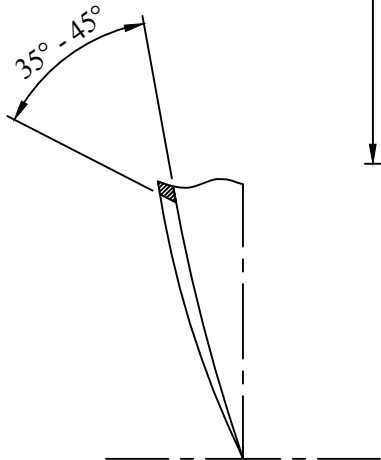

SECTION - "AA"  
SCALE - 1:2

NO. OF NOTCHING :- 10

NOTE :-

ALL DISCS ARE SHOT BLASTED & POWDER COATED  
ALL DIMENSION OTHER - WISE SPECIFIED IN M.M.

NOTE -

PASS AXLE SIZE - 25.4 mm.  
PASS GAUGE SIZE - 25.7 mm.

<b>STATUTORY WARNING</b> THIS DESIGN IS THE PROPERTY OF M/S NIPHA EXPORTS (P) LTD, 28/1 SHAKESPEAR SARANI, KOL- 17 AND IS ONLY ALLOWED TO BE USED BY EXPRESS PERMISSION AND LICENCE FROM M/S NIPHA EXPORTS (P) LTD.		PROJ./PROD./STD./ENQ./CDS./ SODS. NO.-	KOLKATA-INDIA		
DON'T SCALE IF ANY DOUBT , PLEASE ASK		SCALE-	CLIENT- .		
STATUTORY NOTES RAW MATL. SPCN.- 28 Mn B5/30 Mn B5 HARDNESS. - 46-52 HRC FINISH. - BLACK FINISH MATL. WT.- .		QTY.-	TITLE- HARROW DISC NOTCHED		
Remark-		CODE-	ASS'L'D ON-		DESIGN CAL. SHT. NO.-
PROTECTION-		LISTED ON-		CONCEPT DWG. NO.-	
DRAWN BY	D. HAZRA	21.09.17	PART NO./ DRAWING NO.		REV.
CHKD. BY	-		US/B/2035 A/N		-
APPROVED BY	-		-		

REV.	DATE	REV. BY	CHKD. BY	DESCRIPTION OF REVISION	REMARKS