

## June 2026 Block of the Month

### Fly Away - Design by Maurine Henry

I wanted to do a butterfly block for June as flowers are blooming and butterflies are fluttering all around. I wanted butterflies that looked like they were flying away rather than sitting squarely in a block, and while there are free designs of squarely sitting butterflies, I couldn't find any that were "on point". So I created my own. I made 2 different paper pieced butterflies that finish to 6 1/2" square and made 2 of each. I listed cutting supplies for 1 butterfly in case you want to make your butterflies different colors. You will need to double the pieces if you want to do them the same color. I also used generous size pieces. I positioned mine so that they were flying away from center, you can position yours in any direction you want.

#### Materials for 1 butterfly:

##### Butterfly 1:

A: top wing fabric

- 2 – 3" squares

B: bottom wing fabric

- 2 – 3 X 2 1/2" rectangles

D: Background fabric

- 2 – 1 3/4" X 3" rectangles
- 6 – 1 1/2" X 2" rectangles
- 6 – 1 1/2" squares
- 2 – 4 1/2" squares (sub-cut on the diagonal)

E: butterfly body fabric

- 1 – 1 1/2" X 3 1/2" rectangle

##### Butterfly 2:

A: inside wing fabric

- 2 – 1 1/2" X 3" rectangles
- 2 – 1 1/2" X 2 1/2" rectangles

B: middle wing fabric

- 4 – 1 1/2" X 1" rectangles
- 4 – 1 1/2" X 3 " rectangles

C: outside wing fabric

- 2 – 1 1/2" X 1" rectangles
- 2 – 1 1/2" X 3 1/2" rectangles
- 2 – 1 1/2" X 3" rectangles

D: background fabric

- 14 – 1 1/2" X 1 1/2" squares
- 2 – 1 3/4" X 3" rectangles
- 2 – 4 1/2" squares (sub-cut on the diagonal)

E: butterfly body fabric

- 1 – 1 1/2" X 3 1/2" rectangle

#### Directions:

Make 2 copies of each pattern. Set stitch length to 1.5 as you will be stitching short seams.

Please note that on the pattern pieces the number indicates the step and the letter indicates the fabric you will be using. For this project I used my add a quarter ruler, if you do not have one, a stiff piece of cardstock works well for folding and a 12" ruler with a clear 1/4" marking line works well for trimming seams.

#### Basic paper piecing steps:

Place fabric 1 with wrong side of fabric toward the back of the printed paper pattern, pin or glue in place.

Place paper up on flat surface, fold on first fold line using add a quarter ruler or card stock. (picture 2 below)

Place quarter inch measure along fold line and cut fabric 1/4" beyond the fold. (Picture 3 below)

Place next fabric, right sides together, along the just cut fabric edge, hold or pin in place. Flip to the paper side and stitch on the stitch line. Press

Repeat the fold/trim/sew/press process until all steps are complete.

Trim by measuring 1/4" from the outside solid line. (the dashed line is 1/4" but it is better to measure from the solid line.

### Butterfly 1:

Starting with top wing pieces. You will need

- 2- 3" A squares
- 2 - 1 3/4" X 3" D rectangles
- 2 - 1 1/2" X 2" D rectangles

Pin or glue 3" squares to wrong side of paper with wrong side of fabric facing the paper.

Fold paper along 1a/2d line

Cut 1/4" seam allowance.

Repeat for 1a/3d line.

Piece should look like picture 4.

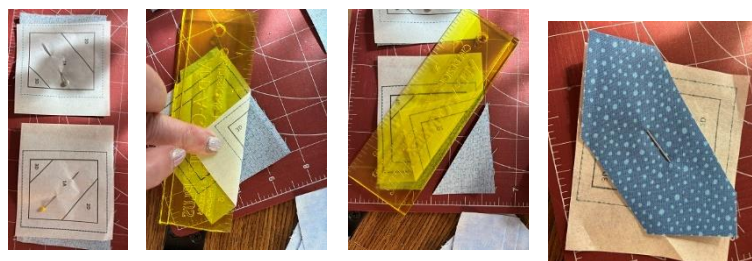

1

2

3

4

Place the 1 3/4" X 3" rectangle right sides together along the 1a/2d line, flip to paper side and stitch on the 1a/2d line.

Repeat for the 1a/3d line using the 1 1/2" X 2" rectangle.

Press

Turn back to paper side and trim 1/4" from the inside line.

Finished top wings should look like picture.



Repeat the process for the bottom wings using

- 2- 3 X 2 1/2" B rectangles
- 4 - 1 1/2" X 2" D rectangles

After the bottom wings are pressed and trimmed, sew the top and bottom wings together and press the seam open



Put the body together using

1- 1 1/2" X 3" E rectangle

6- 1 1/2" D squares

Follow the paper piecing steps to complete the body.



Line up the two wing sections on either side of the body.

Stitch together.

Press seams open



Finishing steps for butterfly 1 using

- 2 - 4 1/2" D squares cut on the diagonal.

Fold the triangles in half, finger press to show middle.  
 Center a triangle on the top and bottom of the butterfly block. Sew in place using  $\frac{1}{4}$ " seam.  
 Mark the center of each side of the butterfly block. Align the center of the triangle with the center of the block and stitch using  $\frac{1}{4}$ " seam  
 Press seams towards triangles.  
 Trim block to  $6\frac{1}{2}$ " square. Use center of butterfly body as your diagonal line for trimming.

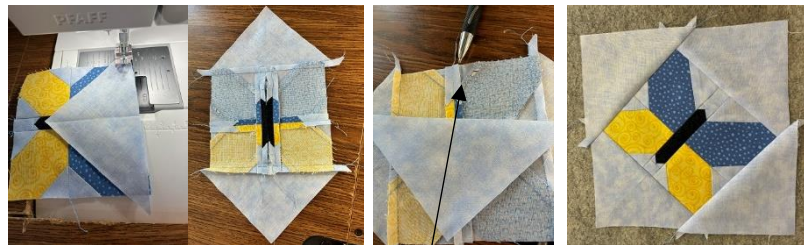

Center of side is just above the seam of the top wing.

**Butterfly #2:**

Starting with top wing pieces you will need

- 2 –  $1\frac{1}{2}$ " X 3" A rectangles
- 2 –  $1\frac{1}{2}$ " X 1" B rectangles
- 2 –  $1\frac{1}{2}$ " X 3" B rectangles
- 2 –  $1\frac{1}{2}$ " X 1" C rectangles
- 2 –  $1\frac{1}{2}$ " X 3" C rectangles
- 2 –  $1\frac{1}{2}$ " D squares
- 2 –  $1\frac{3}{4}$ " X 3" D rectangles

Follow basic paper piecing directions to complete the top wings.  
 Press and trim.

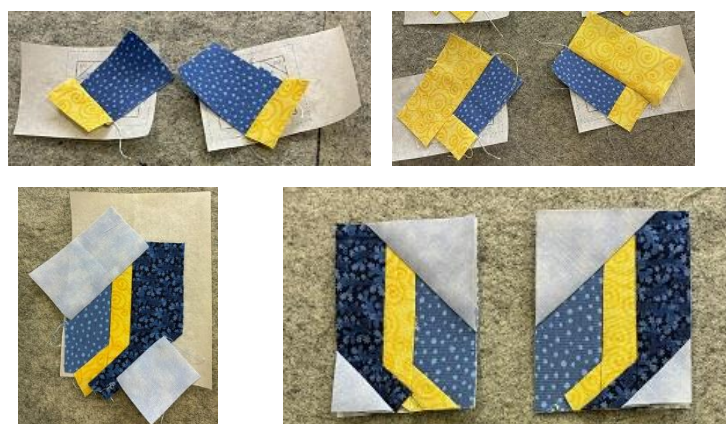

Bottom wings for butterfly 2, you will need

- 2 –  $1\frac{1}{2}$ " X  $2\frac{1}{2}$ " A rectangles
- 2 –  $1\frac{1}{2}$ " X 1" B rectangles
- 2 –  $1\frac{1}{2}$ " X 3" B rectangles
- 2 –  $1\frac{1}{2}$ " X 3" C rectangles
- 6 –  $1\frac{1}{2}$ " D squares

Follow basic paper piecing directions to complete the bottom wings.  
 Press and trim.



Line up the wings and stitch bottom wing to top wing  
 Press seam open.



Make the butterfly body the same as for Butterfly 1.  
 Sew the wings to the body.  
 Add the side triangles in the same order as for butterfly 1, top and bottom, then sides.



Arrange your 4 butterflies however you like.  
Stitch top row together.  
Stitch bottom row together.  
Stitch top to bottom matching center seam.

You can add antennae to each butterfly by drawing them on with heat erasable marker then stitching over your lines. I did mine using a seed stitch on my machine. They can also be hand embroidered.

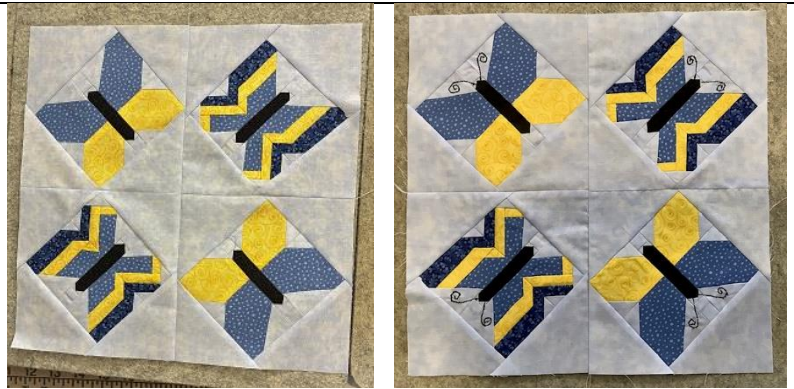

For this month's runner I made 6 of each butterfly and did them all in different colors, it was a great way to use up some scraps. I added a 3 1/2" border, quilted it and added a binding using the same color as the border.



Numeral indicates step, Letter indicates fabric.

Background fabric is D for both butterflies

Butterfly body is E for both butterflies

A & B may change if using different colors for each butterfly.

Use a short stitch length such as 1.5

### Butterfly #1

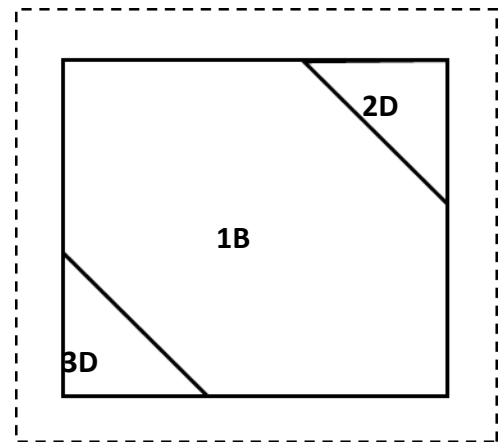
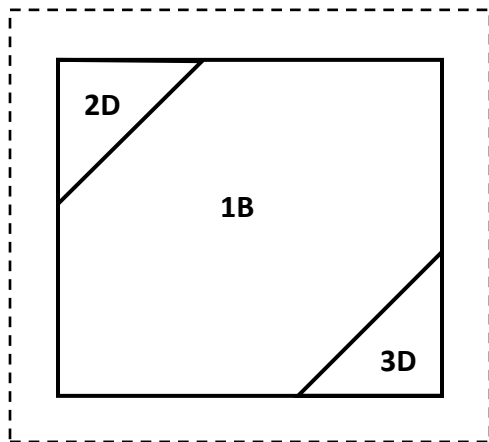
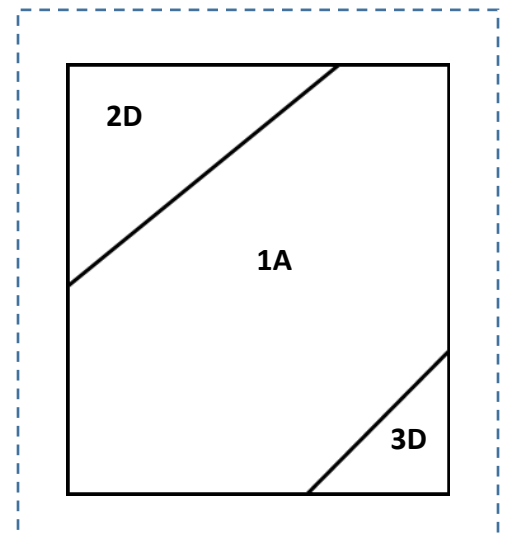
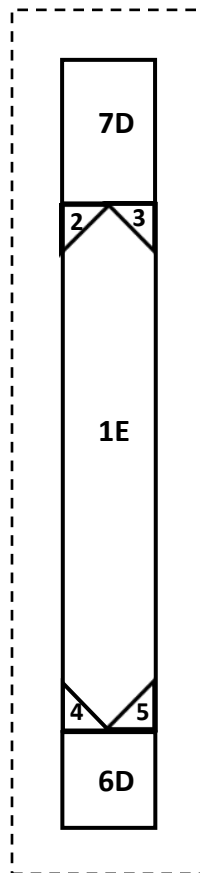
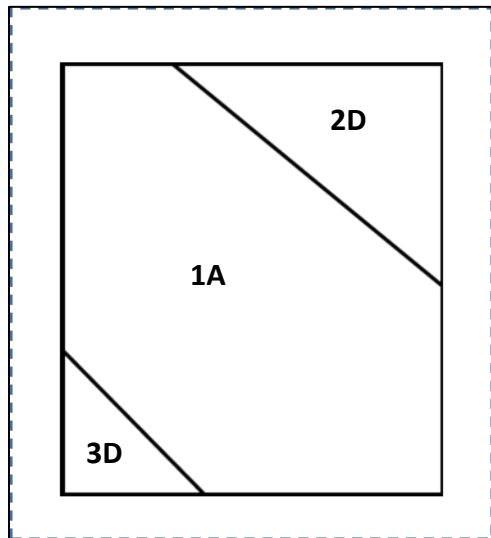

2, 3, 4, 5  
are color D

Butterfly #2

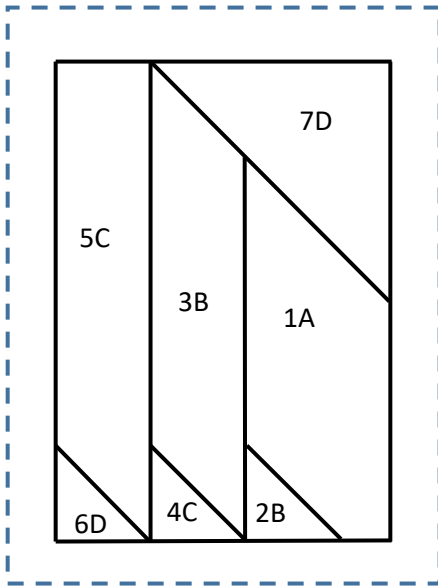

2, 3, 4, 5  
are color D

