

Soils Map

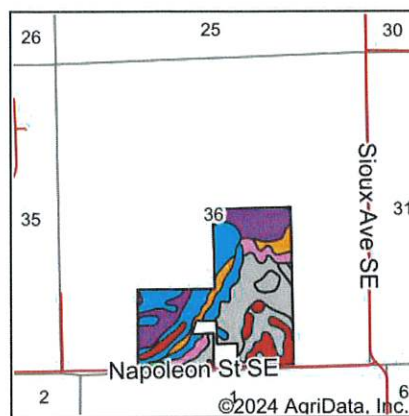

State: **Iowa**
 County: **Johnson**
 Location: **36-79N-6W**
 Township: **East Lucas**
 Acres: **118.4**
 Date: **11/13/2024**

Maps Provided By:
surety
 CUSTOMIZED ONLINE MAPPING
 © AgriData, Inc. 2023 www.AgriDataInc.com

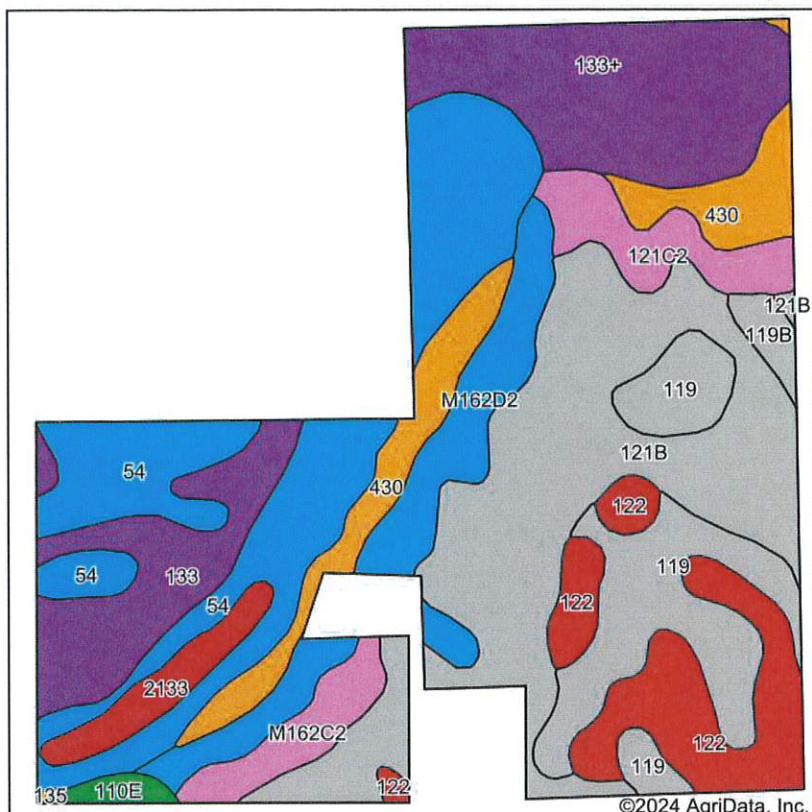

Soils data provided by USDA and NRCS.

©2024 AgriData, Inc.

Area Symbol: IA103, Soil Area Version: 27

Code	Soil Description	Acres	Percent of field	CSR2 Legend	Non-Irr Class *c	CSR2**	CSR
121B	Tama silt loam, 2 to 5 percent slopes	25.65	21.7%		Ile	95	
54	Zook silty clay loam, 0 to 2 percent slopes, occasionally flooded	20.74	17.5%		IIw	60	70
133+	Colo silt loam, 0 to 2 percent slopes, occasionally flooded, overwash	13.61	11.5%		IIw	78	80
119	Muscatine silt loam, 0 to 2 percent slopes	11.98	10.1%		Iw	100	100
122	Sperry silt loam, depressional, 0 to 1 percent slopes	9.75	8.2%		IIIw	36	63
M162D2	Downs silt loam, till plain, 9 to 14 percent slopes, eroded	8.45	7.1%		IVe	57	
133	Colo silty clay loam, 0 to 2 percent slopes, occasionally flooded	8.22	6.9%		IIw	78	85
430	Ackmore silt loam, 0 to 2 percent slopes, occasionally flooded	8.16	6.9%		IIw	70	83
121C2	Tama silt loam, 5 to 9 percent slopes, eroded	4.19	3.5%		IIIe	87	
M162C2	Downs silt loam, till plain, 5 to 9 percent slopes, eroded	3.03	2.6%		IIIe	82	
2133	Colo silty clay loam, 0 to 2 percent slopes, ponded, occasionally flooded	2.69	2.3%		Vw	35	
119B	Muscatine silty clay loam, 2 to 5 percent slopes	1.08	0.9%		Ile	95	95
110E	Lamont fine sandy loam, 9 to 18 percent slopes	0.78	0.7%		Vle	16	12
135	Coland clay loam, 0 to 2 percent slopes, occasionally flooded	0.07	0.1%		IIw	65	80
Weighted Average					2.28	74.4	*.

**IA has updated the CSR values for each county to CSR2.

*- CSR weighted average cannot be calculated on the current soils data, use prior data version for csr values.

*c: Using Capabilities Class Dominant Condition Aggregation Method

Soils data provided by USDA and NRCS.