

Basins (Basin Assembly) 26" Diameter

Features

- Patented 26" polyethylene basins for use as filter containers, pump stations and other onsite applications
- Up to 12" of additional riser may be added to each basin to bring to grade
- Tamper resistant fasteners and special fastening tool included with each lid
- Basin assembly includes lid, and 2-4" SCH 40 or 2-4" SDR35 grommets

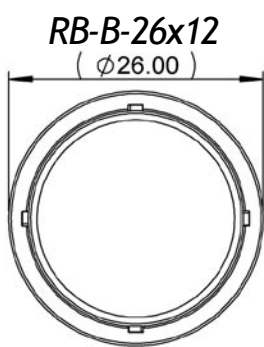
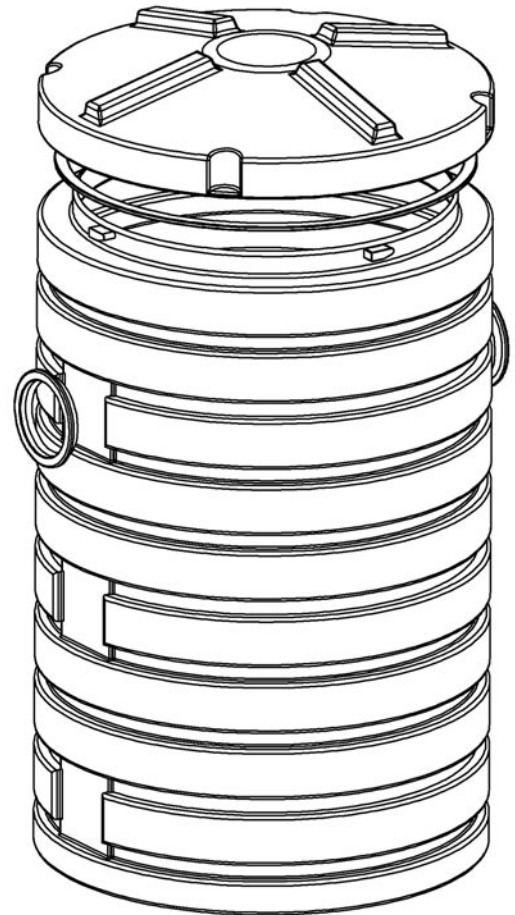

RB-BAS-26x18 (Basin Assembly)

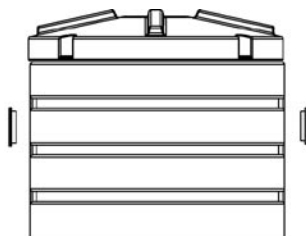

RB-BAS-26x38 (Basin Assembly)

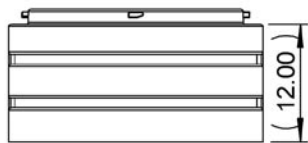
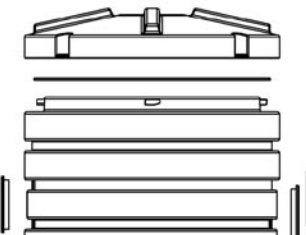

RB-B-26x18 (Basin)

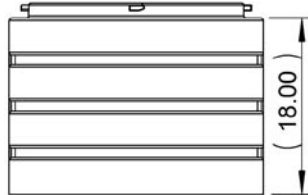

RB-B-26x38 (Basin)

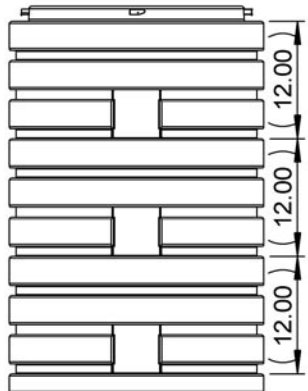

Inlet Side

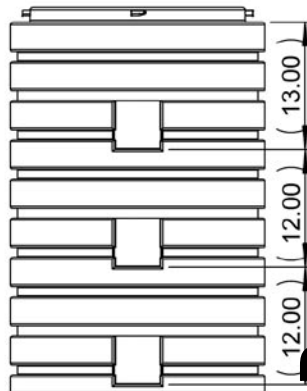

Outlet Side

Materials:

Basin and lid

- High density non-corrosive polyethylene plastic
- Stainless steel screws
- Neoprene gasket

Warranty for Defects in Material and Workmanship

- Basins and Lids - 2 Years

IMPORTANT:

- When adding risers and basins together for deeper installations Quanics does not recommend exceeding a maximum depth of 50".
- Neoprene gaskets must be installed as per instructions
- To prevent unauthorized entry install all tamper resistant fasteners as per instructions

AutoCad dwg files at www.quanics.net

1-877-QUANICS - www.quanics.net