

176

DIGITAL DEPTH CALIPER

- ◆ Measure the depth of grooves, small holes and tire thread
- ◆ Resolution: 0.01mm/0.0005"
- ◆ Automatic power on/off
- ◆ Buttons: on/off, zero, mm/inch
- ◆ Data output
- ◆ Made of stainless steel

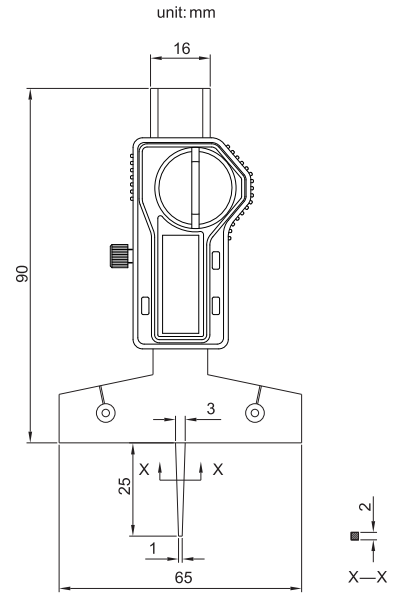

Code	Range	Accuracy
176-001-11	0-25mm/0-1"	±0.03mm

176

VERNIER DEPTH CALIPER

- ◆ Measure the depth of grooves, small holes and tire thread
- ◆ Graduation: 0.1mm
- ◆ Made of stainless steel

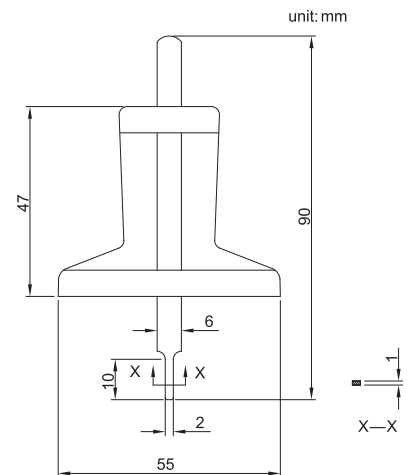

Code	Range	Accuracy
176-030-12	0-30mm	±0.10mm

DEPTH MICROMETER

SERIES 391

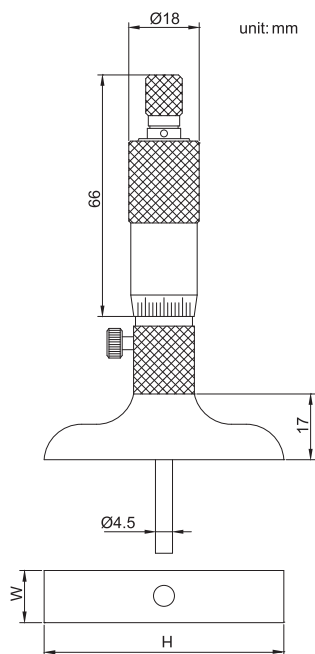

391-001-01

- ◆ Micrometer head accuracy: $\pm 3\mu\text{m}$
Rod accuracy: $\pm(2+L/75)\mu\text{m}$,
L is the measuring range in mm
- ◆ Supplied with rods
- ◆ Ratchet stop

Code	Range	Base (HxW)
391-001-01	0-25mm	101.5x17mm
391-002-01	0-50mm	101.5x17mm
391-003-01	0-75mm	101.5x17mm
391-004-01	0-100mm	101.5x17mm
391-006-01	0-150mm	101.5x17mm
391-008-01	0-200mm	101.5x17mm
391-012-01	0-300mm	101.5x17mm
391-001-02	0-25mm	63x17mm
391-002-02	0-50mm	63x17mm
391-003-02	0-75mm	63x17mm
391-004-02	0-100mm	63x17mm
391-006-02	0-150mm	63x17mm
391-008-02	0-200mm	63x17mm
391-012-02	0-300mm	63x17mm



DEPTH MICROMETER

SERIES 392

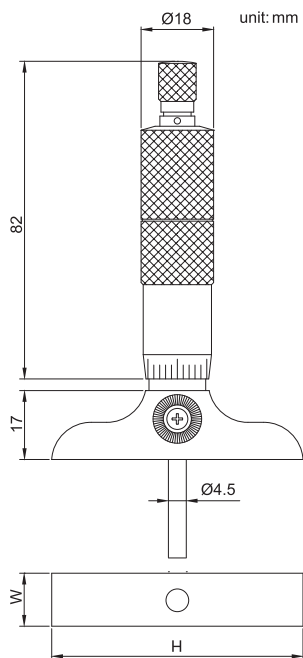

392-001-01

- ◆ Micrometer head accuracy: $\pm 3\mu\text{m}$
- ◆ Rod accuracy: $\pm(2+L/75)\mu\text{m}$,
L is the measuring range in mm
- ◆ Supplied with rods
- ◆ Ratchet stop

Code	Range	Base (HxW)
392-001-01	0-25mm	101.5x17mm
392-002-01	0-50mm	101.5x17mm
392-003-01	0-75mm	101.5x17mm
392-004-01	0-100mm	101.5x17mm
392-006-01	0-150mm	101.5x17mm
392-008-01	0-200mm	101.5x17mm
392-012-01	0-300mm	101.5x17mm
392-001-02	0-25mm	63x17mm
392-002-02	0-50mm	63x17mm
392-003-02	0-75mm	63x17mm
392-004-02	0-100mm	63x17mm
392-006-02	0-150mm	63x17mm
392-008-02	0-200mm	63x17mm
392-012-02	0-300mm	63x17mm

SERIES 293

DIGITAL DEPTH INDICATOR



- ◆ Resolution: 0.01mm/0.0005"
- ◆ Button: tolerance set, data preset, inch/mm conversion, measuring direction set, max./min./range measurement, absolute/incremental measurement
- ◆ Data output
- ◆ Automatic power off
- ◆ Stainless steel base
- ◆ Supplied with pointed tip and ball tip

extension rods for 293-300-11 and 293-300-12

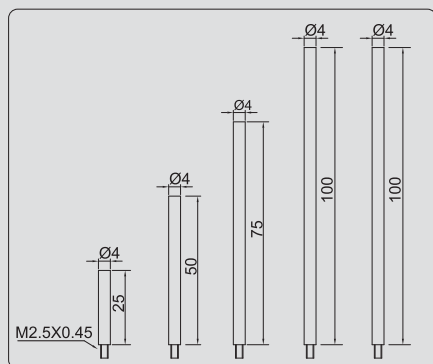

styli

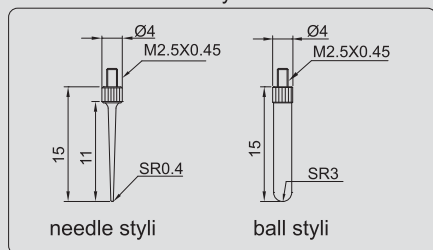

293-300-12



293-010-12

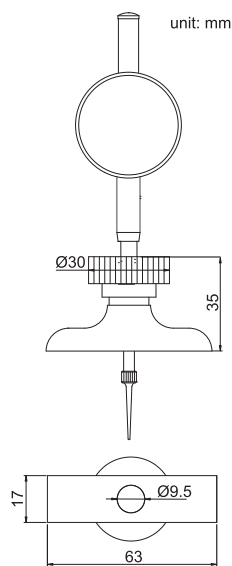

293-300-11

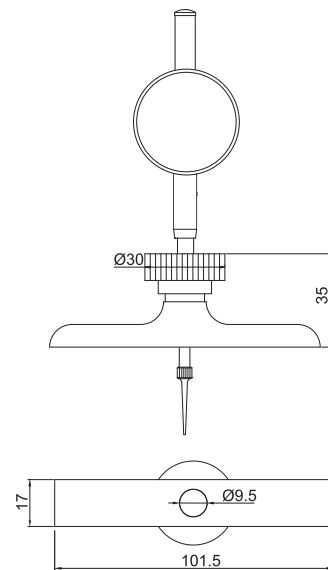

293-300-12

Code	Range	Accuracy	Digital indicator stroke	Base
293-300-11	0-300mm/0-12"	±0.03mm	25.4mm/1"	63x17mm
293-300-12	0-300mm/0-12"	±0.03mm	25.4mm/1"	101.5x17mm
293-010-11	0-10mm/0-0.4"	±0.03mm	12.7mm/0.5"	63x17mm
293-010-12	0-10mm/0-0.4"	±0.03mm	12.7mm/0.5"	101.5x17mm

DIAL DEPTH INDICATOR

SERIES 291



291-010-12

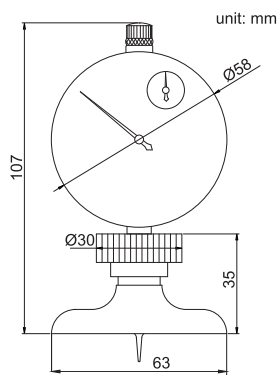

291-010-11

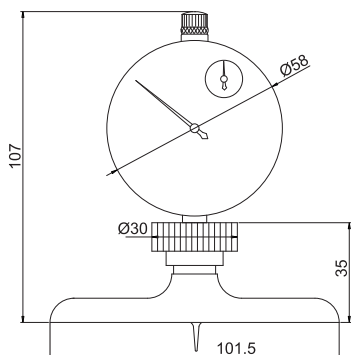

291-010-12

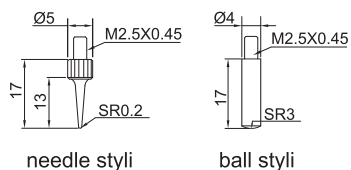

needle styli

ball styli

- ◆ Graduation: 0.01mm
- ◆ Indicator travel: 10mm
- ◆ Accuracy: ± 0.03 mm
- ◆ Stainless steel base
- ◆ With needle and ball styli

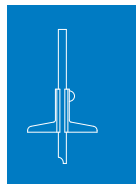

Code	Range	Base
291-010-11	0-10mm	63x17mm
291-010-12	0-10mm	101.5x17mm

DIAL DEPTH INDICATOR

SERIES 292



292-300-12

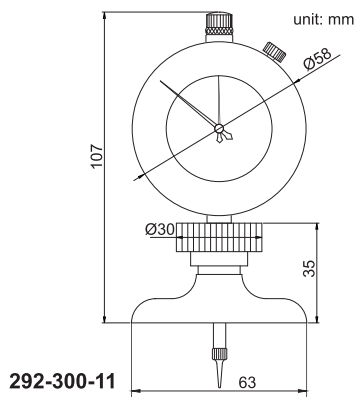

292-300-11

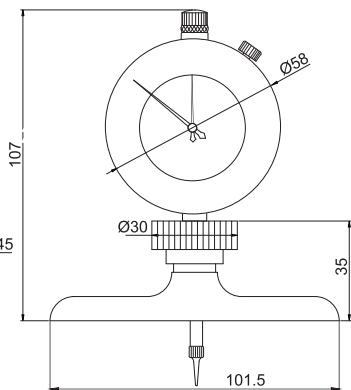

292-300-12

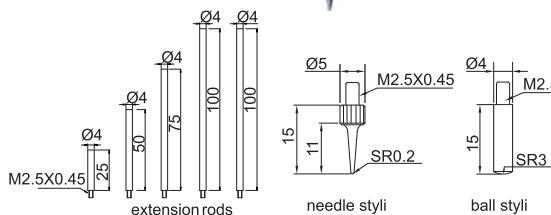

extension rods

needle styli

ball styli

- ◆ Graduation: 0.01mm
- ◆ Indicator travel: 30mm
- ◆ Accuracy: ± 0.03 mm
- ◆ Stainless steel base
- ◆ With needle and ball styli
- ◆ Extension rod: 25mm (1pc), 50mm (1pc), 75mm (1pc), 100mm (2pcs)

Code	Range	Base
292-300-11	0-300mm	63x17mm
292-300-12	0-300mm	101.5x17mm

HG50E

PRECISION HEIGHT GAGE

- ◆ High accuracy
- ◆ Working table is made of ceramic
- ◆ Response speed: max. 5000mm/sec
- ◆ Easy convert between metric and inch
- ◆ 8 bits highlight green LED
- ◆ Power off automatically
- ◆ Optional accessories series 270
(see page 95-97)

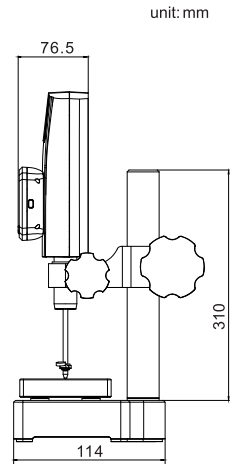
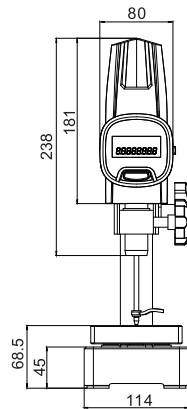

unit: mm

SPECIFICATION

Measuring range	0-50mm
Resolution	0.5μm / 1μm
Accuracy	1.5μm (working table is 20 ± 1°C)
Repeatability	0.5μm
Tip force	1-1.5N
Dimension of working table	130x130mm
Flatness of working table	1.5μm
Power supply	5V/1A AD/DC adaptor
Working temperature	0°C - 40°C
Weight	6.6kg

INCLUDED ACCESSORIES

Main unit	1pc
Working table	1pc
Needle contact point	1pc
Ball contact point	1pc
AD/DC adaptor	1pc
Spindle lift knob	2pcs

Needle contact point

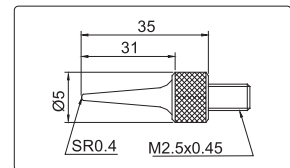

Ball contact point

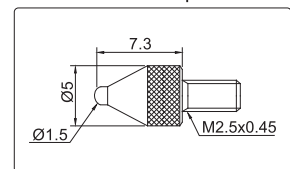

DIGITAL HEIGHT GAGE

SERIES 181

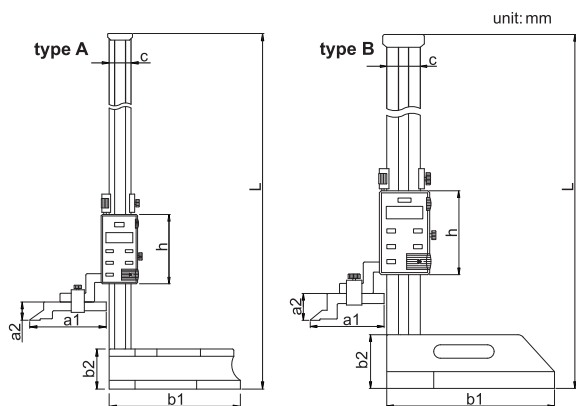

181-024-11

- ◆ Resolution: 0.01mm/0.0005"
- ◆ Buttons: on/off, inch/mm, ABS/INC, data hold, tolerance measurement, data preset, set data
- ◆ Carbide tipped scriber
- ◆ Made of stainless steel (except the base)
- ◆ Data output
- ◆ With clamps (Ø8mm holder)

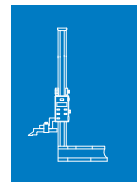

clamp



Code	Range	Type	Accuracy	a1	a2	b1	b2	c	h	L
181-012-11	0-300mm/0-12"	A	±0.04mm	76	25	135	45	23	80	470
181-024-11	0-600mm/0-24"	A	±0.05mm	103	25	180	55	30	95	820
181-040-11	0-1000mm/0-40"	B	±0.07mm	110	39	250	80	50	125	1275

DIGITAL HEIGHT GAGE WITH DRIVING WHEEL

SERIES 184

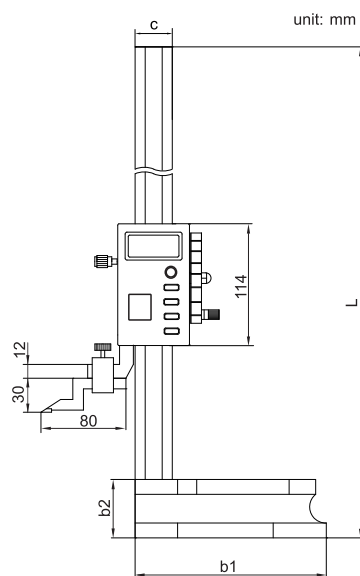

Dial test indicator holder (optional)

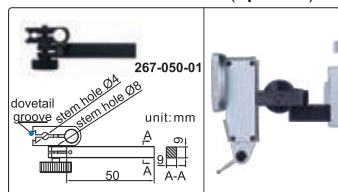

184-012-11

- ◆ Resolution: 0.01mm/0.0005"
- ◆ Buttons: on/off, zero, mm/inch, ABS/INC, hold
- ◆ Automatic power off, move the digital unit to turn on power
- ◆ Carbide tipped scriber
- ◆ Made of stainless steel
- ◆ Data output
- ◆ Optional accessories:
dial test indicator holder (267-050-01)

Code	Range	Accuracy	b1	b2	c	L
184-012-11	0-300mm/0-12"	±0.03mm	180	55	32	515
184-024-11	0-600mm/0-24"	±0.05mm	180	55	32	815

SERIES 182

DIGITAL HEIGHT GAGE

- ◆ Resolution: 0.01mm/0.001"
- ◆ Buttons: on/off, inch/mm, ABS/INC, data preset, set data
- ◆ Carbide tipped scriber
- ◆ Made of stainless steel beam
- ◆ With driving wheel
- ◆ Optional accessory: 267 series clamps

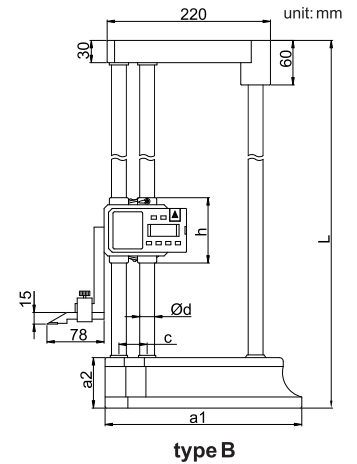
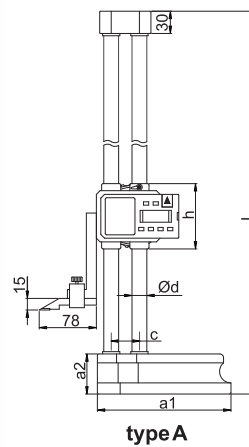

182-012-11

driving wheel

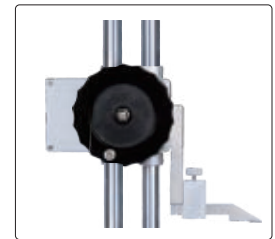

Code	Range	Type	Accuracy	a1	a2	c	Ød	h	L
182-012-11	0-300mm/0-12"	A	±0.04mm	135	43	33	15	84	475
182-024-11	0-600mm/0-24"	A	±0.05mm	180	54	38	20	88	810
182-040-11	0-1000mm/0-40"	B	±0.05mm	265	68	38	20	88	1230

SERIES 185

DIAL HEIGHT GAGE

- ◆ Indicator graduation: 0.01mm
- ◆ Carbide tipped scriber
- ◆ Made of stainless steel (except the base)
- ◆ With driving wheel
- ◆ Optional accessory: 267 series clamps

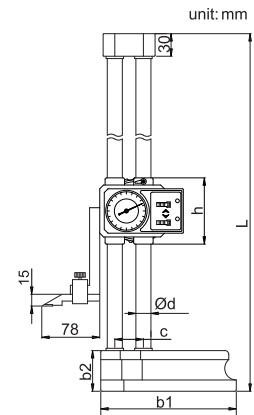

driving wheel



185-012-11

Code	Range	Accuracy	b1	b2	c	Ød	h	L
185-012-11	0-300mm	±0.04mm	135	43	33	15	84	475
185-024-11	0-600mm	±0.05mm	180	54	38	20	88	810

VERNIER HEIGHT GAGE

SERIES 186



186-012-11

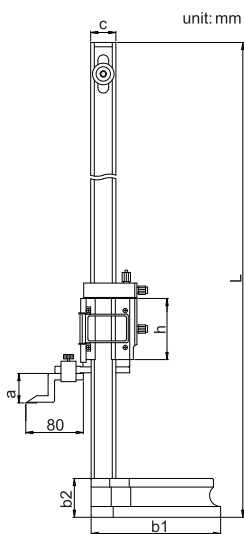

- ◆ Graduation: 0.02mm/0.001"
- ◆ Move main scale to set zero
- ◆ Carbide tipped scriber
- ◆ Made of stainless steel (except the base)
- ◆ Satin chrome plated scale
- ◆ With magnifier
- ◆ Optional accessory: 267 series clamps

Code	Range	Accuracy	a	b1	b2	c	h	L
186-012-11	0-300mm/0-12"	±0.04mm	30	135	43	28	75	545
186-024-11	0-600mm/0-24"	±0.05mm	41	180	54	35	85	870

SCRIBER FOR HEIGHT GAUGES

SERIES 180



180-000-SC1

- ◆ Carbide tipped

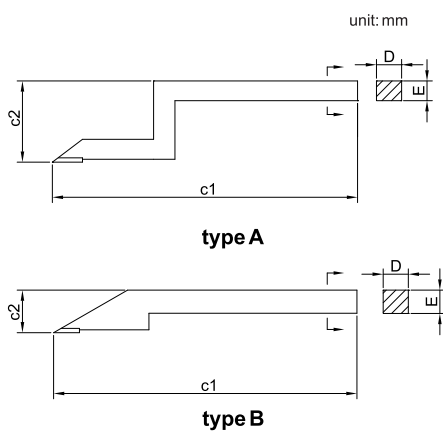

Code	For height gauges	Type	c1	c2	D	E
180-000-SC1	181-012-11	A	76	25	6	8
180-000-SC2	181-024-11	A	103	25	10	12
180-000-SC3	181-040-11	A	110	39	10	15
180-000-SC4	185-012-11, 185-024-11, 182-012-11, 182-024-11	B	78	15	9	9
180-000-SC6	186-012-11	A	80	30	9	9
180-000-SC7	186-024-11	A	80	41	9	9

SERIES 183

MINI DIGITAL HEIGHT GAGE

- ◆ Resolution: 0.01mm/0.0005"
- ◆ Buttons: on/off, inch/mm, zero
- ◆ Carbide tipped scriber
- ◆ Made of stainless steel (except the base)
- ◆ Data output
- ◆ Automatic power off

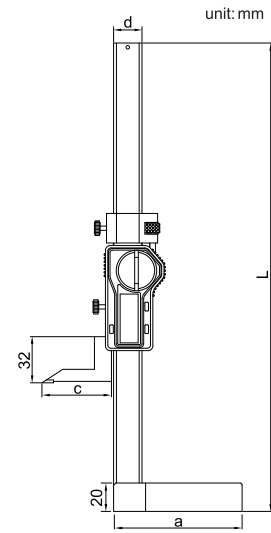

183-006-11

Code	Range	Accuracy	a	c	d	L
183-006-11	0-150mm/0-6"	±0.03mm	75	43	16	265
183-008-11	0-200mm/0-8"	±0.03mm	90	49	16	325
183-010-11	0-250mm/0-10"	±0.03mm	90	49	16	380

SERIES 187

MINI VERNIER HEIGHT GAGE

- ◆ Graduation 0.02mm/0.001"
- ◆ Carbide tipped scriber
- ◆ Made of stainless steel (except the base)
- ◆ Satin chrome plated scale

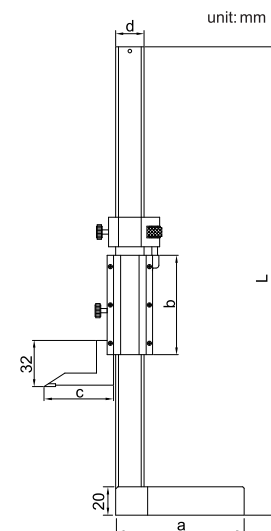
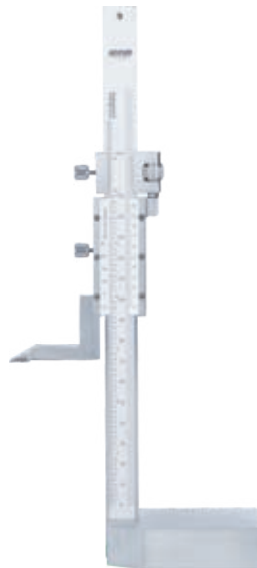

187-006-11

Code	Range	Accuracy	a	b	c	d	L
187-006-11	0-150mm/0-6"	±0.03mm	75	57	43	16	265
187-008-11	0-200mm/0-8"	±0.03mm	90	70	49	20	325
187-010-11	0-250mm/0-10"	±0.03mm	90	70	49	20	380

DIGITAL OUTSIDE MICROMETER

SERIES 313



313-001-01

- ◆ Resolution: 0.001mm/0.00005"
- ◆ IP65 protection level
- ◆ Button: on/off, mm/inch, set, zero
- ◆ Automatic power off
- ◆ Carbide measuring faces, ratchet stop
- ◆ Setting standards are included (except 313-001-01)

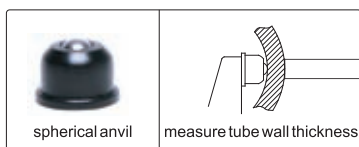
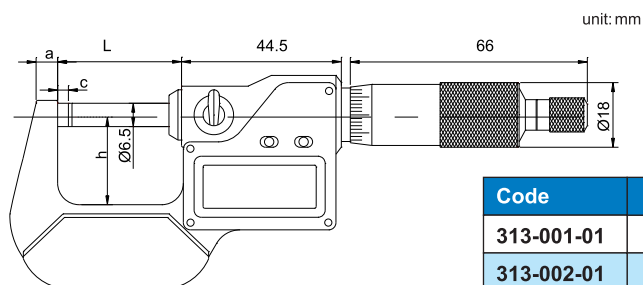

spherical anvil

measure tube wall thickness

Code	Range	Accuracy	a	c	h	L
313-001-01	0-25mm/0-1"	±2μm	6	3	25	34.5
313-002-01	25-50mm/1-2"	±2μm	8	3	32	59.5
313-003-01	50-75mm/2-3"	±3μm	8	3	44.5	84.5
313-004-01	75-100mm/3-4"	±3μm	8	3	57	109.5
313-005-01	100-125mm/4-5"	±3μm	10	3	70	135
313-006-01	125-150mm/5-6"	±3μm	10	3	82	160.5
313-007-01	150-175mm/6-7"	±4μm	12	5.5	94.5	186
313-008-01	175-200mm/7-8"	±4μm	12	5.5	107	211.5

DIGITAL OUTSIDE MICROMETER WITH DATA OUTPUT

SERIES 313



313-001-01S

- ◆ Resolution: 0.001mm/0.00005"
- ◆ IP65 protection level
- ◆ Button: on/off, mm/inch, set, zero
- ◆ Automatic power off
- ◆ Carbide measuring faces, ratchet stop
- ◆ Setting standards are included (except 313-001-01S)

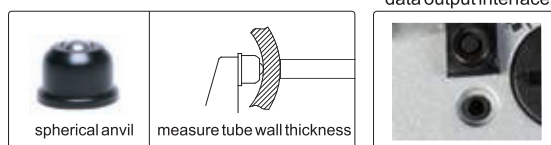
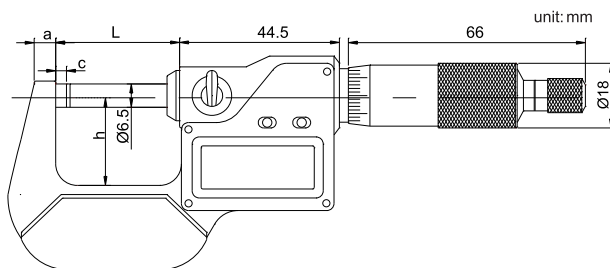

spherical anvil

measure tube wall thickness

data output interface

Code	Range	Accuracy	a	c	h	L
313-001-01S	0-25mm/0-1"	±2μm	6	3	25	34.5
313-002-01S	25-50mm/1-2"	±2μm	8	3	32	59.5
313-003-01S	50-75mm/2-3"	±3μm	8	3	44.5	84.5
313-004-01S	75-100mm/3-4"	±3μm	8	3	57	109.5
313-005-01S	100-125mm/4-5"	±3μm	10	3	70	135
313-006-01S	125-150mm/5-6"	±3μm	10	3	82	160.5
313-007-01S	150-175mm/6-7"	±4μm	12	5.5	94.5	186
313-008-01S	175-200mm/7-8"	±4μm	12	5.5	107	211.5
313-009-01S	200-225mm/8-9"	±4μm	23	5.5	129.5	236
313-010-01S	225-250mm/9-10"	±4μm	23	5.5	142.5	261.5
313-011-01S	250-275mm/10-11"	±5μm	23	5.5	155	287
313-012-01S	275-300mm/11-12"	±5μm	23	5.5	167.5	312.5

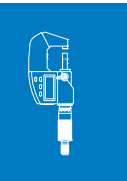

SERIES 313

IP65 DIGITAL OUTSIDE MICROMETER

- ◆ Resolution: 0.001mm/0.00005"
- ◆ IP65 protection level
- ◆ Button: on/off, mm/inch, zero
- ◆ Automatic power off
- ◆ Data output
- ◆ Carbide measuring faces
- ◆ Ratchet stop
- ◆ Setting standards are included (except 313-001-02)



313-001-02

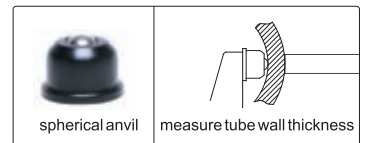
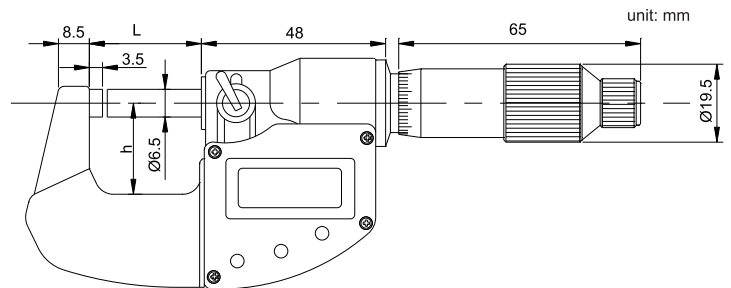

Code	Range	Accuracy	h	L
313-001-02	0-25mm/0-1"	3μm	25	31.5
313-002-02	25-50mm/1-2"	3μm	32	57
313-003-02	50-75mm/2-3"	4μm	44.5	82.5
313-004-02	75-100mm/3-4"	4μm	57	107
313-005-02	100-125mm/4-5"	5μm	70	133
313-006-02	125-150mm/5-6"	5μm	82	158

SERIES 314

DIGITAL SNAP MICROMETER

- ◆ Quick measurement with lever
- ◆ Resolution: 0.001mm/0.00005"
- ◆ IP65 protection level
- ◆ Button: on/off, mm/inch, origin, ABS/zero
- ◆ Automatic power off
- ◆ Data output
- ◆ Carbide measuring faces
- ◆ Setting standards are included (except 314-001-02)



314-001-02

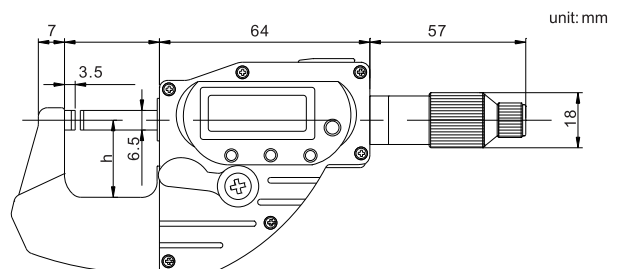

Code	Range	Accuracy	h	L
314-001-02	0-25mm/0-1"	3μm	25	31
314-002-02	25-50mm/1-2"	3μm	32	57
314-003-02	50-75mm/2-3"	4μm	44.5	82
314-004-02	75-100mm/3-4"	4μm	57	107

DIGITAL OUTSIDE MICROMETER

SERIES 312



312-001-03

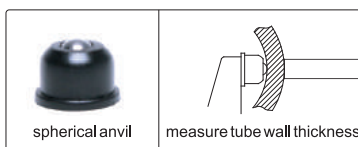
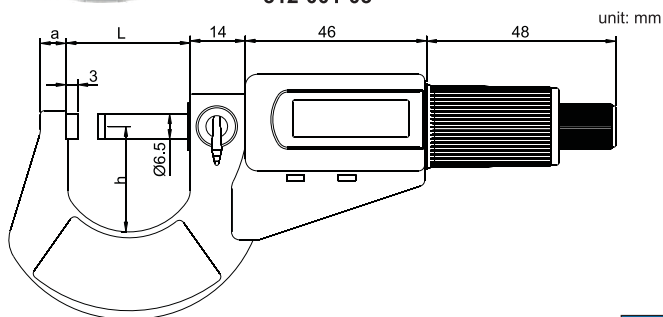

- ◆ Resolution: 0.001mm/0.00005"
- ◆ Button: ON/OFF/SET, ABS/INC/UNIT
- ◆ Carbide measuring faces
- ◆ Ratchet stop
- ◆ Setting standards are included (except 312-001-03)

Code	Range	Accuracy	a	h	L
312-001-03	0-25mm/0-1"	±2μm	6	27.5	32
312-002-03	25-50mm/1-2"	±2μm	8	37	57
312-003-03	50-75mm/2-3"	±3μm	8	50	82
312-004-03	75-100mm/3-4"	±3μm	10	61	107

OUTSIDE MICROMETER

SERIES 321

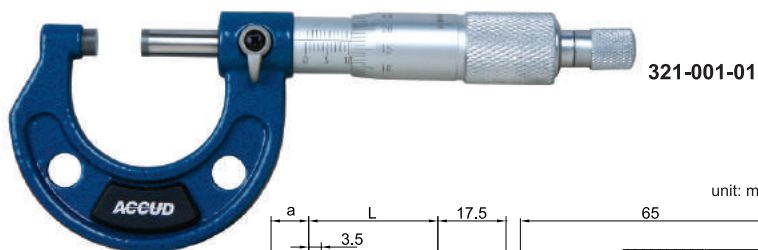

321-001-01

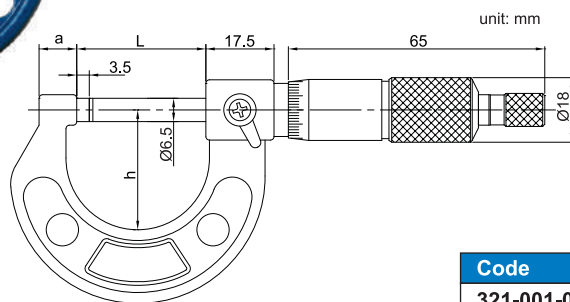

- ◆ Graduation: 0.01mm
- ◆ Carbide measuring faces
- ◆ Ratchet stop
- ◆ Setting standards are included (except 321-001-01)

INDIVIDUAL MICROMETER

OUTSIDE MICROMETER SET

Code	Range	Total QTY.	Included micrometers
321-003-03	0-75mm	3pcs	0-25, 25-50, 50-75mm
321-004-04	0-100mm	4pcs	0-25, 25-50, 50-75, 75-100mm
321-006-06	0-150mm	6pcs	0-25, 25-50, 50-75, 75-100, 100-125, 125-150mm
321-012-06	150-300mm	6pcs	150-175, 175-200, 200-225, 225-250, 250-275, 275-300mm
321-012-12	0-300mm	12pcs	0-25, 25-50, 50-75, 75-100, 100-125, 125-150, 150-175, 175-200, 200-225, 225-250, 250-275, 275-300mm

Code	Range	Accuracy	a	h	L
321-001-01	0-25mm	4μm	9	29	32
321-002-01	25-50mm	4μm	9	39	58
321-003-01	50-75mm	5μm	10	53	83
321-004-01	75-100mm	5μm	10	65	109
321-005-01	100-125mm	6μm	11.5	76	133
321-006-01	125-150mm	6μm	11.5	88	159
321-007-01	150-175mm	7μm	11.5	101	185
321-008-01	175-200mm	7μm	11.5	114	210
321-009-01	200-225mm	8μm	11.5	126	235
321-010-01	225-250mm	8μm	12	139	260
321-011-01	250-275mm	9μm	12.5	151	286
321-012-01	275-300mm	9μm	12.5	164	311

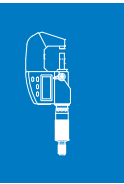

SERIES 325

- ◆ Graduation: 0.01mm
- ◆ Ratchet stop
- ◆ Carbide measuring faces
- ◆ Supplied with setting standards

OUTSIDE MICROMETER WITH INTERCHANGEABLE ANVILS

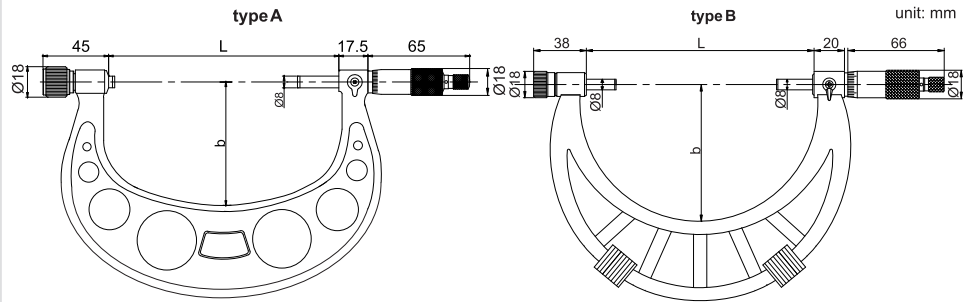

Code	Range	Type	Accuracy	L	b
325-002-01	0-50mm	A	4μm	58	35
325-004-01	0-100mm	A	5μm	108	57
325-006-01	0-150mm	A	6μm	158	82
325-008-01	100-200mm	A	7μm	208	114
325-012-01	150-300mm	A	9μm	308	165
325-016-02	300-400mm	B	11μm	409	224
325-020-02	400-500mm	B	13μm	509	275
325-024-02	500-600mm	B	14μm	609	321
325-028-02	600-700mm	B	16μm	709	371
325-032-02	700-800mm	B	18μm	809	426
325-036-02	800-900mm	B	20μm	909	476
325-040-02	900-1000mm	B	22μm	1009	576



325-006-01

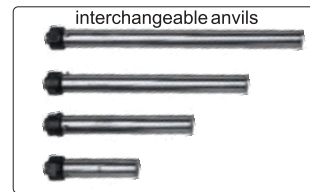

SERIES 329

- ◆ Adjust collars for different measuring ranges
- ◆ Graduation 0.01mm
- ◆ Ratchet stop
- ◆ Carbide measuring faces
- ◆ Supplied with setting standards

OUTSIDE MICROMETER WITH EXTENSION ANVIL

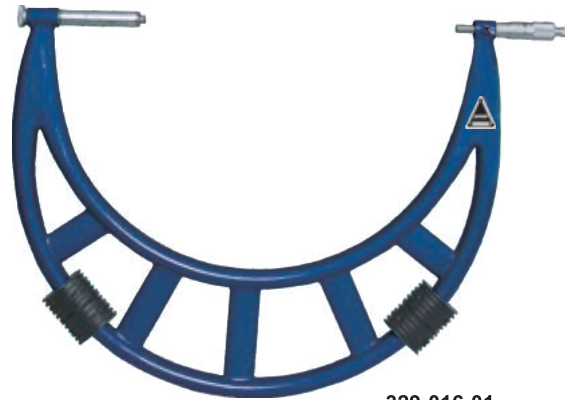

329-016-01

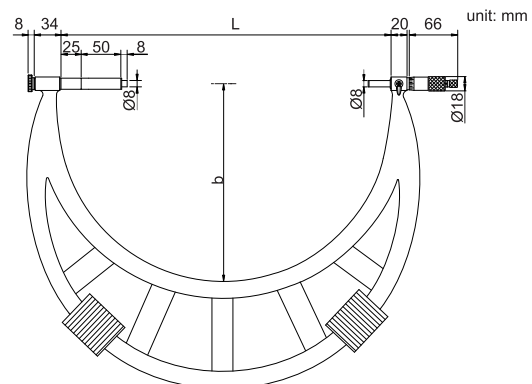

Code	Range	Accuracy	L	b
329-016-01	300-400mm	11μm	410	250
329-020-01	400-500mm	13μm	510	295
329-024-01	500-600mm	14μm	610	345
329-028-01	600-700mm	16μm	710	395
329-032-01	700-800mm	18μm	810	445
329-036-01	800-900mm	20μm	910	495
329-040-01	900-1000mm	22μm	1010	545

DIGITAL BLADE MICROMETER

SERIES 316



316-001-03

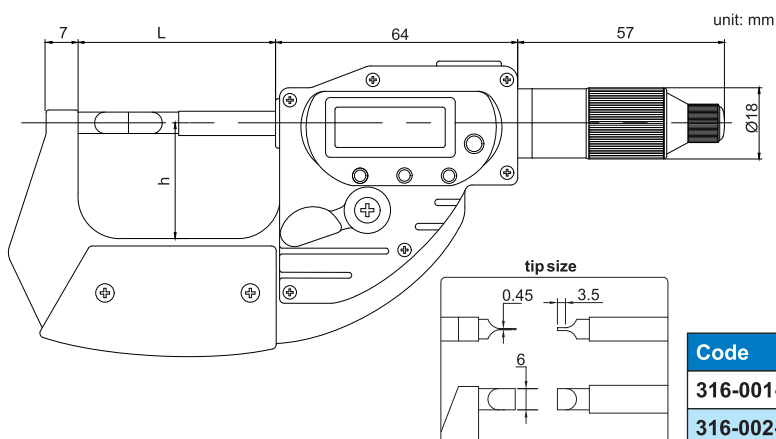

- ◆ Measure the groove diameter of shafts and keyways
- ◆ Quick measurement with lever
- ◆ Resolution: 0.001mm/0.00005"
- ◆ IP65 protection level
- ◆ Button: on/off, mm/inch, origin, ABS/zero
- ◆ Automatic power off
- ◆ Data output
- ◆ Carbide measuring faces
- ◆ Setting standards are included (except 316-001-03)

Code	Range	Accuracy	h	L
316-001-03	0-25mm/0-1"	3μm	31	55
316-002-03	25-50mm/1-2"	3μm	44	80

BLADE MICROMETER

SERIES 326



326-001-03

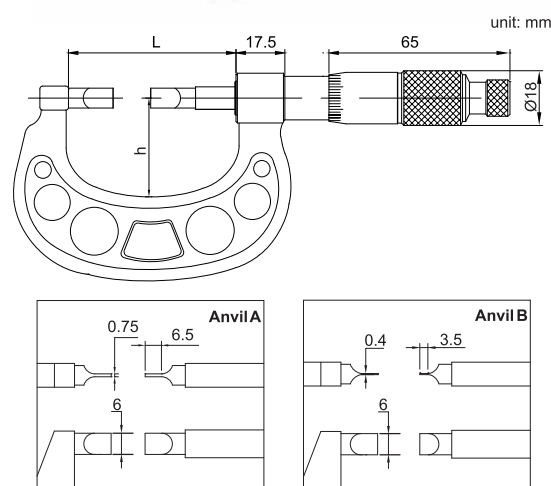

- ◆ Measure the small groove diameter
- ◆ Graduation: 0.01mm
- ◆ Non-rotating spindle
- ◆ Ratchet stop
- ◆ Setting standards are included (except 0-25mm)

Code	Range	Anvil	Accuracy	h	L
326-001-03	0-25mm	A	4μm	35	57
326-002-03	25-50mm	A	4μm	46	82
326-003-03	50-75mm	A	5μm	58	107
326-004-03	75-100mm	A	5μm	70	133
326-005-03	100-125mm	A	6μm	83	158
326-006-03	125-150mm	A	6μm	96	183
326-007-03	150-175mm	A	7μm	109	209
326-001-04	0-25mm	B	4μm	35	57
326-002-04	25-50mm	B	4μm	46	82

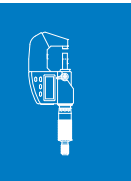

SERIES 317

DIGITAL POINT MICROMETER

- ◆ Measure the web thickness of drills, small grooves and keyways
- ◆ Resolution: 0.001mm/0.00005"
- ◆ Button: on/off/set, mm/inch/ABS
- ◆ Automatic power off
- ◆ Setting standards are included (except 317-001-03)



317-001-03

unit: mm

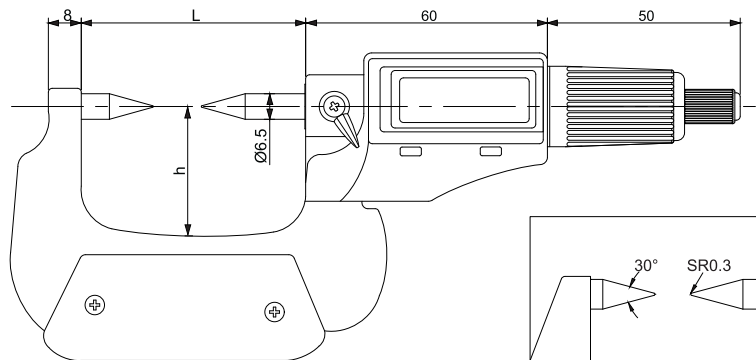

Code	Range	Accuracy	h	L
317-001-03	0-25mm/0-1"	3μm	31	55
317-002-03	25-50mm/1-2"	3μm	44	80
317-003-03	50-75mm/2-3"	4μm	58	115
317-004-03	75-100mm/3-4"	4μm	72	130

SERIES 327

POINT MICROMETER

- ◆ Measure the thickness of drills, small grooves and keyways
- ◆ Graduation: 0.01mm
- ◆ Ratchet stop
- ◆ Carbide measuring faces
- ◆ Setting standards are included (except 0-25mm)



327-001-03

unit: mm

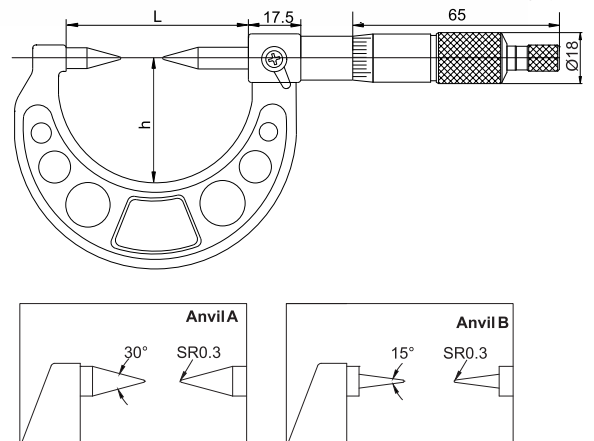

Code	Range	Anvil	Accuracy	h	L
327-001-03	0-25mm	A	4μm	39	58
327-002-03	25-50mm	A	4μm	53	83
327-003-03	50-75mm	A	5μm	65	109
327-004-03	75-100mm	A	5μm	76	133
327-001-04	0-25mm	B	4μm	39	58
327-002-04	25-50mm	B	4μm	53	83
327-003-04	50-75mm	B	5μm	65	109
327-004-04	75-100mm	B	5μm	76	133

DIGITAL SPLINE MICROMETER

SERIES 318



318-002-03

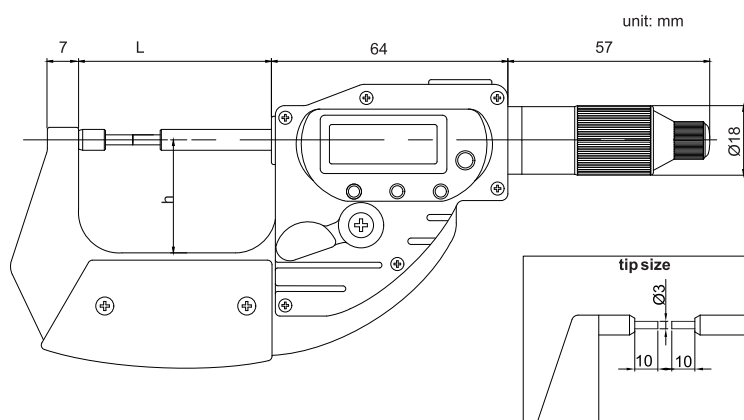

- ◆ Measure splined shafts, slots and keyways
- ◆ Quick measurement with lever
- ◆ Resolution: 0.001mm/0.00005"
- ◆ IP65 protection level
- ◆ Button: on/off, mm/inch, origin, ABS/zero
- ◆ Automatic power off
- ◆ Data output
- ◆ Carbide measuring faces
- ◆ Setting standards are included (except 318-001-03)

Code	Range	Accuracy	h	L
318-001-03	0-25mm/0-1"	3µm	31	55
318-002-03	25-50mm/1-2"	3µm	44	80

SPLINE MICROMETER

SERIES 328



328-001-03

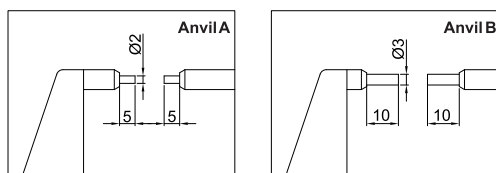
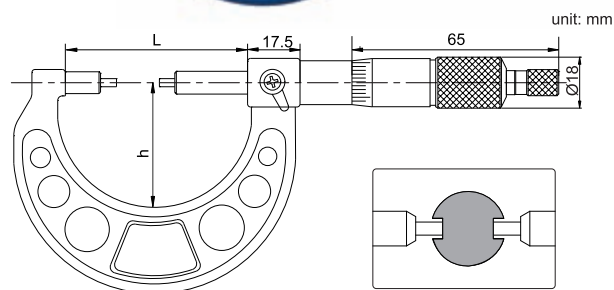

- ◆ Measure grooves and sharpened parts
- ◆ Graduation: 0.01mm
- ◆ Carbide measuring faces
- ◆ Ratchet stop
- ◆ Setting standards are included (except 0-25mm)

Code	Range	Accuracy	Anvil	h	L
328-001-04	0-25mm	4µm	A	39	58
328-001-03	0-25mm	4µm	B	39	58
328-002-03	25-50mm	4µm	B	53	83
328-003-03	50-75mm	5µm	B	65	109
328-004-03	75-100mm	5µm	B	76	133

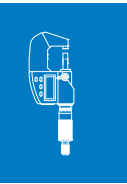

319

DIGITAL CRIMP HEIGHT MICROMETER

- ◆ Measure the height of crimp contact
- ◆ Button: on/off/set, mm/inch/ABS
- ◆ Automatic power off
- ◆ Carbide measuring faces

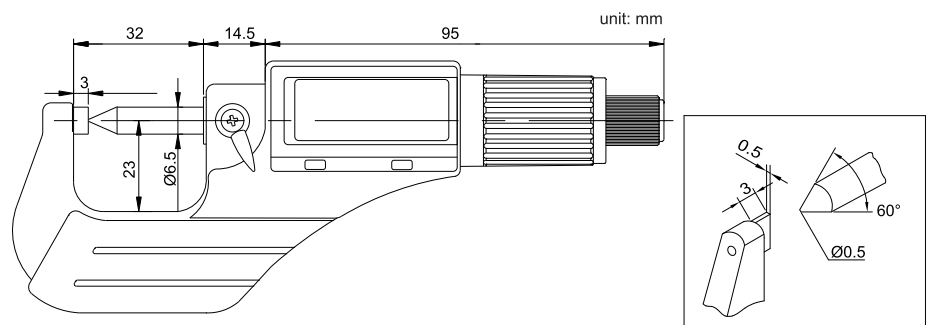

Code	Range	Accuracy
319-001-03	0-20mm/0-0.8"	3µm

SERIES 331

DIGITAL SPHERICAL ANVIL TUBE MICROMETER

- ◆ Resolution: 0.001mm/0.00005"
- ◆ Button: on/off/set, mm/inch/ABS
- ◆ Carbide measuring faces
- ◆ Ratchet stop
- ◆ Setting standards are included (except 331-001-03)



331-001-03

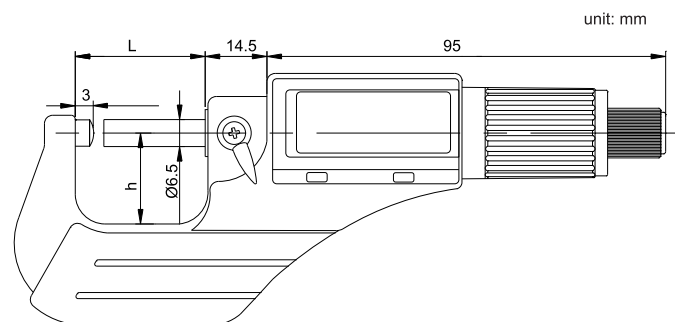

Code	Range	Accuracy	h	L
331-001-03	0-25mm/0-1"	3µm	25	31
331-002-03	25-50mm/1-2"	3µm	32	57
331-003-03	50-75mm/2-3"	4µm	44.5	82
331-004-03	75-100mm/3-4"	4µm	57	107

SPHERICAL ANVIL TUBE MICROMETER

SERIES 340



340-001-01

- ◆ Measure wall thickness of tubes
- ◆ Graduation: 0.01mm
- ◆ Carbide measuring faces
- ◆ Ratchet stop
- ◆ Setting standards are included (except 0-25mm)

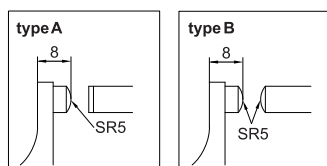
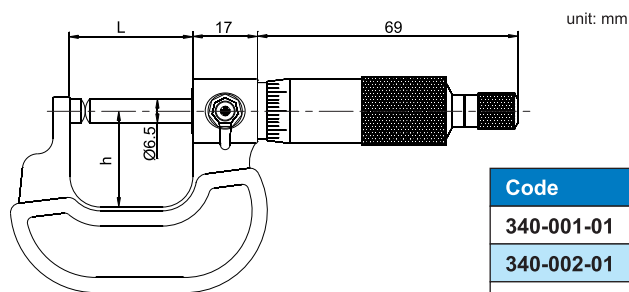

Code	Range	Type	Accuracy	L	h
340-001-01	0-25mm	A	4µm	57	24
340-002-01	25-50mm	A	4µm	82	32
340-003-01	50-75mm	A	5µm	107	44.5
340-004-01	75-100mm	A	5µm	133	57
340-001-02	0-25mm	B	4µm	57	24
340-002-02	25-50mm	B	4µm	82	32
340-003-02	50-75mm	B	5µm	107	44.5
340-004-02	75-100mm	B	5µm	133	57

TUBE MICROMETER

SERIES 341



341-001-04

- ◆ Measure the wall thickness of tube, bearing and rings
- ◆ Graduation: 0.01mm
- ◆ Carbide measuring faces
- ◆ Ratchet stop
- ◆ Setting standards are included (except 0-25mm)

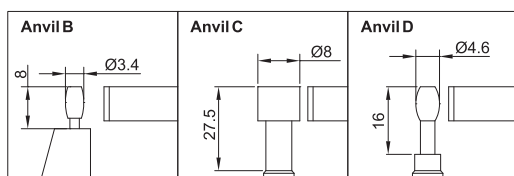
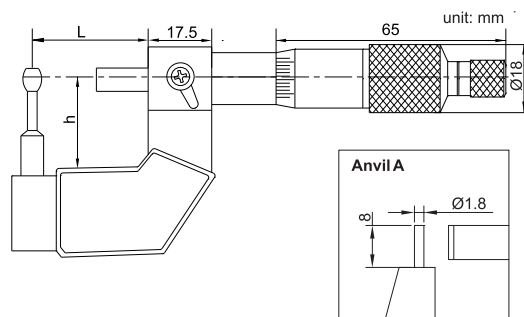

Code	Range	Anvil	Accuracy	h	L
341-001-01	0-25mm	A	6µm	24	31
341-002-01	25-50mm	A	6µm	32	57
341-001-02	0-25mm	B	6µm	24	31
341-002-02	25-50mm	B	6µm	32	57
341-001-03	0-25mm	C	6µm	24	31
341-001-04	0-25mm	D	6µm	24	31



SERIES 343

SCREW THREAD MICROMETER

- ◆ Measure pitch diameter of screw threads
- ◆ Graduation 0.01mm
- ◆ Non-rotating spindle
- ◆ Ratchet stop
- ◆ Supplied with 60° setting standards (except 0-25mm)
- ◆ Optional accessory: 55° setting standards, measuring tips



343-001-02

measuring tips are not included

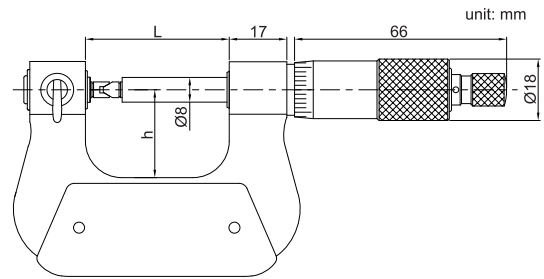

Code	Range	Micrometer head accuracy	Measuring tips accuracy	L	h
343-001-02	0-25mm	4µm	8µm	42	26
343-002-02	25-50mm	4µm	8µm	67	38
343-003-02	50-75mm	5µm	10µm	92	50
343-004-02	75-100mm	5µm	10µm	118	62
343-005-02	100-125mm	6µm	15µm	143	70
343-006-02	125-150mm	6µm	15µm	168	82
343-007-02	150-175mm	7µm	15µm	192	94.5
343-008-02	175-200mm	7µm	15µm	217	107

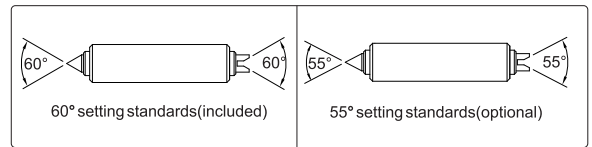

SERIES 343

MEASURING TIPS FOR SCREW THREAD MICROMETER



343-000-01

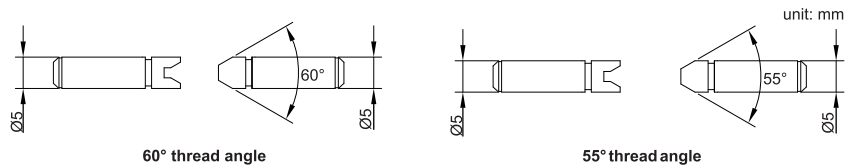

Metric and unified thread (60° thread angle)

Code	Pitch
343-000-01	0.4-0.5mm/64-48TPI
343-000-02	0.6-0.9mm/44-28TPI
343-000-03	1-1.75mm/24-14TPI
343-000-04	2-3mm/13-9TPI
343-000-05	3.5-5mm/8-5TPI
343-000-06	5.5-7mm/4.5-3.5TPI
343-000-TS	6 pairs/set, including all above tips

Whitworth thread (55° thread angle)

Code	Pitch	Code	Pitch
343-000-11	60-48TPI	343-000-18	10-7TPI
343-000-12	48-40TPI	343-000-19	7-4.5TPI
343-000-13	40-32TPI	343-000-20	4.5-3.5TPI
343-000-14	32-24TPI	343-000-2TS	10 pairs/set, including all above tips
343-000-15	24-18TPI		
343-000-16	18-14TPI		
343-000-17	14-10TPI		

DISK MICROMETER

SERIES 342



342-002-02

- ◆ Measure root tangent length of gear
- ◆ Graduation 0.01mm
- ◆ Ratchet stop
- ◆ Supplied with setting standards (except 0-25mm)

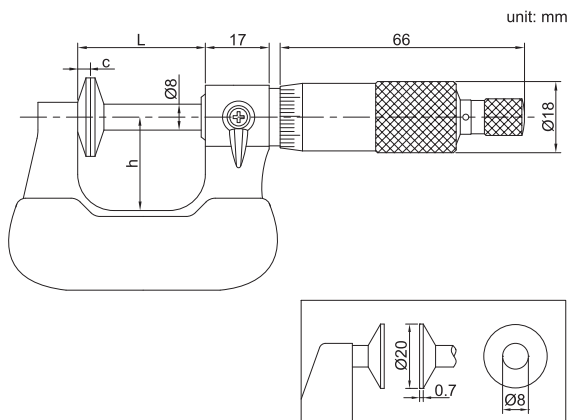

Code	Range	Accuracy	L	h	c
342-001-02	0-25mm	4µm	34	24	3.3
342-002-02	25-50mm	4µm	59	32	3.3
342-003-02	50-75mm	5µm	85	45	3.3
342-004-02	75-100mm	5µm	110	57	3.3

INDICATING MICROMETER

SERIES 349



349-001-01

- ◆ Micrometer head graduation: 0.01mm
- ◆ Dial indicator: graduation 0.001mm, accuracy 0.001mm
- ◆ Carbide measuring faces
- ◆ Supplied with setting standards (except 0-25mm)

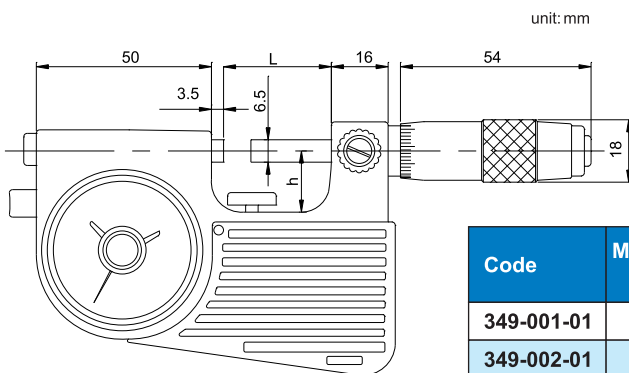

Code	Micrometer head range	Accuracy	Indicator range	L	h
349-001-01	0-25mm	±3µm	60µm	28.5	19
349-002-01	25-50mm	±3µm	60µm	53.5	30
349-003-01	50-75mm	±4µm	60µm	78.5	45
349-004-01	75-100mm	±4µm	60µm	103.5	57



SERIES 324

OUTSIDE MICROMETER

- ◆ Graduation: 0.0001in
- ◆ Carbide measuring faces
- ◆ Ratchet stop
- ◆ Setting standards are included (except 324-001-01)



324-001-01

Code	Range	Accuracy	a	h	L
324-001-01	0-1"	±0.00016"	9	29	32
324-002-01	1-2"	±0.00016"	14	39	58
324-003-01	2-3"	±0.0002"	15	53	83
324-004-01	3-4"	±0.0002"	15	65	109
324-005-01	4-5"	±0.00024"	16.5	76	133
324-006-01	5-6"	±0.00024"	16.5	88	159
324-007-01	6-7"	±0.00028"	19.4	29	32
324-008-01	7-8"	±0.00028"	19.4	39	58
324-009-01	8-9"	±0.00031"	19.4	53	83
324-010-01	9-10"	±0.00031"	19.4	65	109
324-011-01	10-11"	±0.00035"	19.4	76	133
324-012-01	11-12"	±0.00035"	19.4	88	159

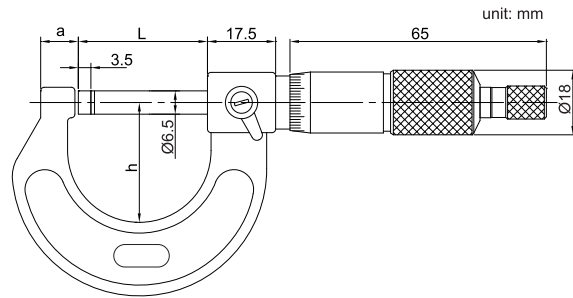

SERIES 324

OUTSIDE MICROMETER SET



324-006-06

MICROMETER SET

Code	Range	Total quantity	Included micrometers
324-003-03	0-3"	3pcs	0-1", 1-2", 2-3"
324-004-04	0-4"	4pcs	0-1", 1-2", 2-3", 3-4"
324-006-06	0-6"	6pcs	0-1", 1-2", 2-3", 3-4", 4-5", 5-6"
324-012-06	6-12"	6pcs	6-7", 7-8", 8-9", 9-10", 10-11", 11-12"
324-012-12	0-12"	12pcs	0-1", 1-2", 2-3", 3-4", 4-5", 5-6", 6-7", 7-8", 8-9", 9-10", 10-11", 11-12"

MICROMETER STAND

381

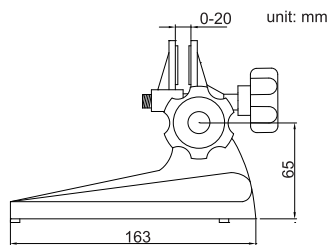

- ◆ For micrometers which measuring range is less than 100mm

Code

381-000-00

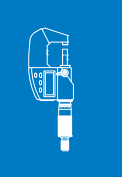

MICROMETER STAND

383

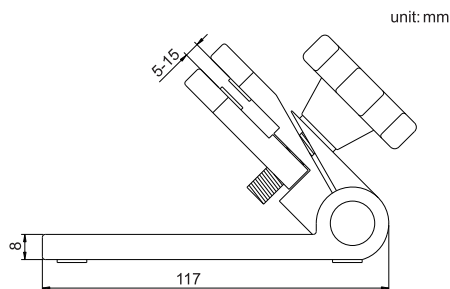

- ◆ For micrometers which measuring range is less than 100mm

Code

383-000-00

SERIES 551

OPTICAL PARALLEL

- ◆ Check the flatness and parallelism of measuring faces of micrometer



Code	Parallels included
551-001-02	12, 12.12, 12.25, 12.37mm
551-002-02	25, 25.12, 25.25, 25.37mm

SERIES 321

MICROMETER SETTING STANDARD

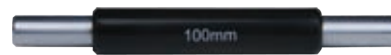

321-004-ST



Code	Length	Accuracy	D
321-001-ST	25mm	±1.5μm	Ø7mm
321-002-ST	50mm	±2μm	Ø7mm
321-003-ST	75mm	±2.5μm	Ø7mm
321-004-ST	100mm	±3μm	Ø8mm
321-005-ST	125mm	±3.5μm	Ø8mm
321-006-ST	150mm	±4μm	Ø8mm
321-007-ST	175mm	±4.5μm	Ø8mm
321-008-ST	200mm	±5μm	Ø8mm
321-009-ST	225mm	±5.5μm	Ø8mm
321-010-ST	250mm	±6μm	Ø8mm
321-011-ST	275mm	±6.5μm	Ø8mm

MICROMETER HEAD

SERIES 371



371-001-02

- ◆ Graduation: 0.01mm
- ◆ Accuracy: 0.003mm
- ◆ Carbide measuring faces
- ◆ Ratchet stop

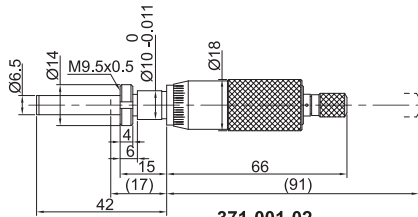

371-001-02

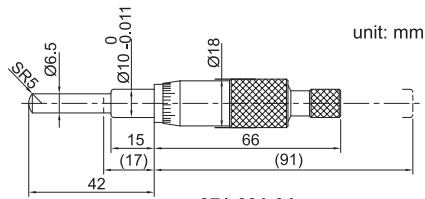

371-001-04

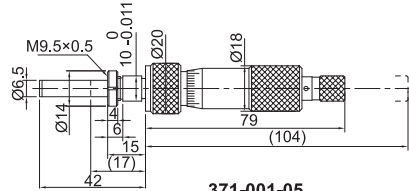

371-001-05

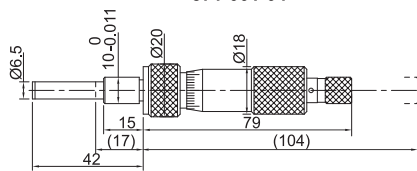

371-001-06

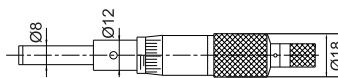

371-001-11

Code	Range	Stem	Spindle tip	Remark
371-001-02	0-25mm	with clamp nut	flat (carbide)	
371-001-03	0-25mm	with clamp nut	spherical (SR5)	
371-001-04	0-25mm	plain	spherical (SR5)	
371-001-05	0-25mm	with clamp nut	flat (carbide)	with spindle lock
371-001-06	0-25mm	plain	flat (carbide)	with spindle lock
371-001-11	0-25mm	plain	flat (carbide)	

DIGITAL MICROMETER HEAD

SERIES 376



376-001-02

- ◆ Resolution 0.001mm/0.00005"
- ◆ IP54 dust/waterproof
- ◆ Button function: on/off, set, mm/inch, ABS/INC, data output
- ◆ Data output
- ◆ Automatic power off
- ◆ Ratchet stop

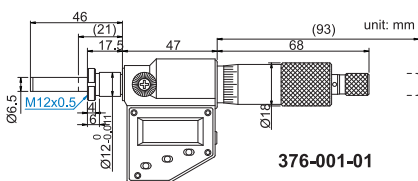

376-001-01

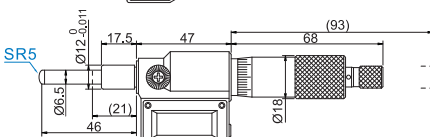

376-001-04

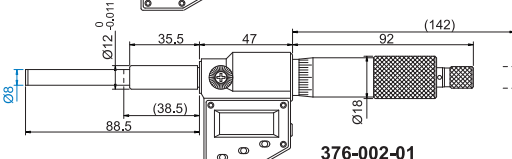

376-002-01

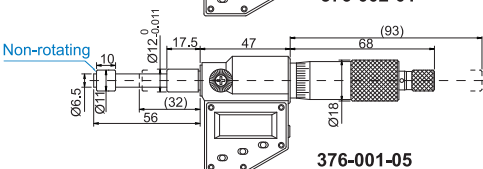

376-001-05

Rotating spindle

Code	Range	Stem	Spindle tip	Accuracy
376-001-01	0-25mm/0-1"	with clamp nut	flat (carbide)	±2μm
376-001-02	0-25mm/0-1"	plain	flat (carbide)	±2μm
376-001-03	0-25mm/0-1"	with clamp nut	spherical (SR5)	±2μm
376-001-04	0-25mm/0-1"	plain	spherical (SR5)	±2μm
376-002-01	0-50mm/0-2"	plain	flat (carbide)	±4μm

Non-rotating spindle

Code	Range	Stem	Spindle tip	Accuracy
376-001-05	0-25mm/0-1"	plain	flat (carbide)	±2μm



SERIES 361

DIGITAL THREE POINTS INSIDE MICROMETER

- ◆ Resolution: 0.001mm/0.00005"
- ◆ IP54 protection level
- ◆ Automatic power off
- ◆ Data output
- ◆ Ratchet stop
- ◆ Carbide measuring faces (over 12mm series)
- ◆ Setting rings and extension rod are included



361-003-01

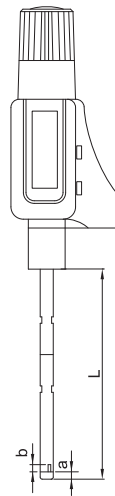

Range 6-20mm

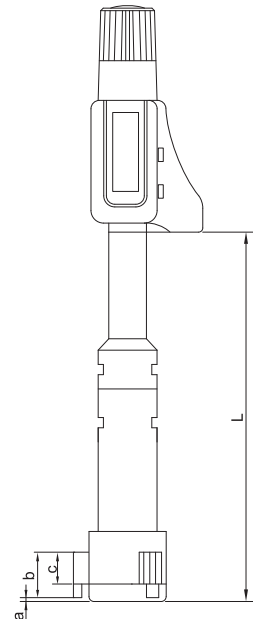

Range 20-100mm

Code	Range	Accuracy	Setting ring	Extension rod	a	b	c	L
361-001-01	6-8mm/0.24-0.31"	4μm	Ø6mm	100mm	1.5	2.5	/	54.5
361-002-01	8-10mm/0.31-0.4"	4μm	Ø8mm	100mm	1.5	2.5	/	63
361-003-01	10-12mm/0.4-0.47"	4μm	Ø10mm	100mm	1.5	2.5	/	63
361-004-01	12-16mm/0.47-0.63"	4μm	Ø16mm	150mm	0.5	6	4.5	80
361-005-01	16-20mm/0.63-0.8"	4μm	Ø16mm	150mm	0.5	6	4.5	80
361-006-01	20-25mm/0.8-1"	4μm	Ø25mm	150mm	0.5	8	6	105
361-007-01	25-30mm/1-1.2"	4μm	Ø25mm	150mm	0.5	8	6	105
361-008-01	30-40mm/1.2-1.6"	4μm	Ø40mm	150mm	0.5	14	12	110
361-009-01	40-50mm/1.6-2"	5μm	Ø40mm	150mm	0.5	14	12	110
361-010-01	50-63mm/2-2.5"	5μm	Ø62mm	150mm	0.5	17.5	14.5	114
361-011-01	62-75mm/2.5-3"	5μm	Ø62mm	150mm	0.5	17.5	14.5	114
361-012-01	75-88mm/3-3.5"	5μm	Ø87mm	150mm	0.5	17.5	14.5	114
361-013-01	87-100mm/3.5-4"	5μm	Ø87mm	150mm	0.5	17.5	14.5	114

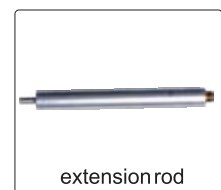

THREE POINTS INSIDE MICROMETER

SERIES 362



362-004-01

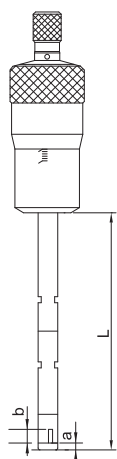

Range 6-12mm

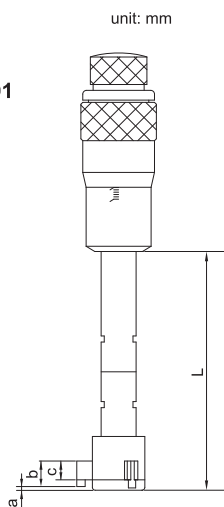

Range 12-100mm

- ◆ 6-12mm graduation: 0.001mm
Steel measuring faces
- ◆ 12-100mm graduation: 0.005mm
Carbide measuring faces
- ◆ Ratchet stop
- ◆ Setting rings and extension rod are included

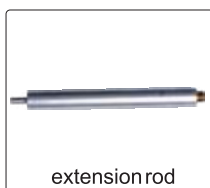

Code	Range	Accuracy	Setting ring	Extension rod	a	b	c	L
362-001-01	6-8mm	4μm	Ø6mm	100mm	1.5	2.5	/	54.5
362-002-01	8-10mm	4μm	Ø8mm	100mm	1.5	2.5	/	54.5
362-003-01	10-12mm	4μm	Ø10mm	100mm	1.5	2.5	/	54.5
362-004-01	12-16mm	4μm	Ø16mm	150mm	0.5	6	4.5	80
362-005-01	16-20mm	4μm	Ø16mm	150mm	0.5	6	4.5	80
362-006-01	20-25mm	4μm	Ø25mm	150mm	0.5	8	6	90
362-007-01	25-30mm	4μm	Ø25mm	150mm	0.5	8	6	90
362-008-01	30-40mm	4μm	Ø40mm	150mm	0.5	14	12	97
362-009-01	40-50mm	5μm	Ø40mm	150mm	0.5	14	12	97
362-010-01	50-63mm	5μm	Ø62mm	150mm	0.5	17.5	14.5	114
362-011-01	62-75mm	5μm	Ø62mm	150mm	0.5	17.5	14.5	114
362-012-01	75-88mm	5μm	Ø87mm	150mm	0.5	17.5	14.5	114
362-013-01	87-100mm	5μm	Ø87mm	150mm	0.5	17.5	14.5	114

SERIES 361/362

THREE POINTS INSIDE MICROMETER SET

DIGITAL TYPE

Code	Range	Micrometers included	Setting ring	Extension rod
361-103-03	6-12mm	6-8, 8-10, 10-12mm	Ø6, Ø8, Ø10mm	100mm
361-305-03	12-20mm	12-16, 16-20mm	Ø16mm	150mm
361-509-05	20-50mm	20-25, 25-30, 30-40, 40-50mm	Ø25mm, Ø40mm	150mm
361-913-05	50-100mm	50-63, 62-75, 75-88, 87-100mm	Ø62mm, Ø87mm	150mm

MECHANICAL TYPE

Code	Range	Micrometers included	Setting ring	Extension rod
362-103-03	6-12mm	6-8, 8-10, 10-12mm	Ø6, Ø8, Ø10mm	100mm
362-305-03	12-20mm	12-16, 16-20mm	Ø16mm	150mm
362-509-05	20-50mm	20-25, 25-30, 30-40, 40-50mm	Ø25mm, Ø40mm	150mm
362-913-05	50-100mm	50-63, 62-75, 75-88, 87-100mm	Ø62mm, Ø87mm	150mm



362-913-05

SERIES 351

INSIDE MICROMETER

- ◆ Graduation: 0.01mm
- ◆ Carbide measuring faces
- ◆ Ratchet stop



351-001-01

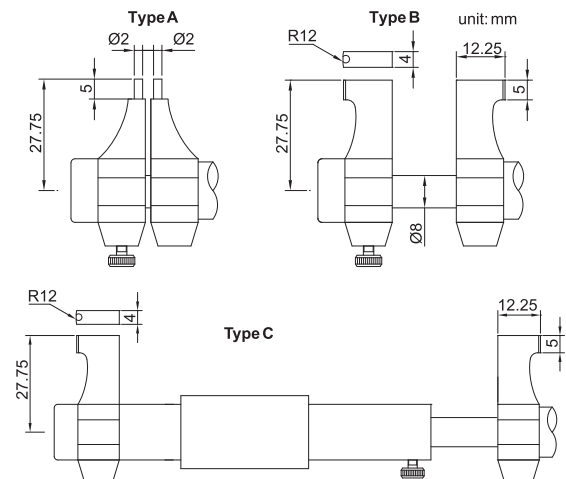

Code	Range	Type	Setting ring	Accuracy
351-001-01	5-30mm	A	included	7µm
351-002-01	25-50mm	B	included	8µm
351-003-01	50-75mm	B	optional	9µm
351-004-01	75-100mm	C	optional	10µm
351-005-01	100-125mm	C	optional	10µm
351-006-01	125-150mm	C	optional	11µm
351-007-01	150-175mm	C	optional	11µm
351-008-01	175-200mm	C	optional	12µm

TUBULAR INSIDE MICROMETER

SERIES 352



352-006-01

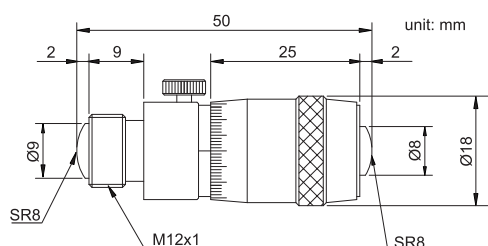

- ◆ Graduation: 0.01mm
- ◆ Travel of micrometer head: 13mm
- ◆ Accuracy: $(3+n+L/50)\mu\text{m}$, n is number of rods, L is max. measuring length in mm
- ◆ Supplied with setting standards
- ◆ Carbide measuring faces

Code	Range	Extension rods (mm)
352-002-01	50-63mm	—
352-006-01	50-150mm	13, 25, 50
352-012-01	50-300mm	13, 25, 50(2pcs), 100
352-020-01	50-500mm	13, 25, 50(2pcs), 100, 200
352-024-01	50-600mm	13, 25, 50, 100, 150, 200
352-040-01	50-1000mm	13, 25, 50(2pcs), 100, 200(2pcs), 300
352-060-01	50-1500mm	13, 25, 50(2pcs), 100, 200(3pcs), 300(2pcs)

TUBULAR INSIDE MICROMETER

SERIES 354



354-005-01

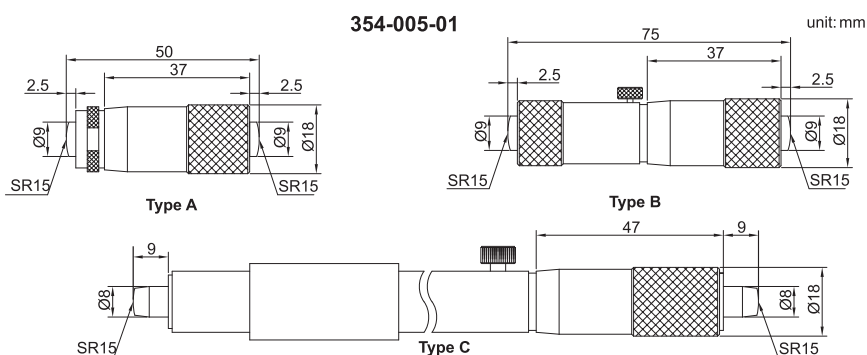

- ◆ Graduation 0.01mm
- ◆ Carbide measuring faces

Code	Range	Type	Accuracy
354-003-01	50-75mm	A	5 μm
354-004-01	75-100mm	B	5 μm
354-005-01	100-125mm	C	6 μm
354-006-01	125-150mm	C	6 μm
354-007-01	150-175mm	C	7 μm
354-008-01	175-200mm	C	7 μm
354-009-01	200-225mm	C	8 μm
354-010-01	225-250mm	C	8 μm
354-011-01	250-275mm	C	9 μm

Code	Range	Type	Accuracy
354-012-01	275-300mm	C	9 μm
354-013-01	300-325mm	C	9 μm
354-014-01	325-350mm	C	9 μm
354-015-01	350-375mm	C	10 μm
354-016-01	375-400mm	C	10 μm
354-017-01	400-425mm	C	10 μm
354-018-01	425-450mm	C	10 μm
354-019-01	450-475mm	C	11 μm
354-020-01	475-500mm	C	11 μm



SERIES 353

TUBULAR INSIDE MICROMETER

- ◆ Graduation 0.01mm
- ◆ Accuracy: $(3+n+L/50)\mu\text{m}$
n is number of rods, L is maximum measuring length in mm
- ◆ Travel of micrometer head: 25mm
- ◆ Supplied with setting standards
- ◆ Carbide measuring faces



353-020-01

Code	Range	Extension rods (mm)
353-005-01	100-125mm	—
353-020-01	100-500mm	25, 50, 100, 200
353-036-01	100-900mm	25, 50, 100, 200, 400
353-052-01	100-1300mm	25, 50, 100, 200, 400(2pcs)
353-068-01	100-1700mm	25, 50, 100, 200, 400(3pcs)
353-084-01	100-2100mm	25, 50, 100, 200, 400(4pcs)

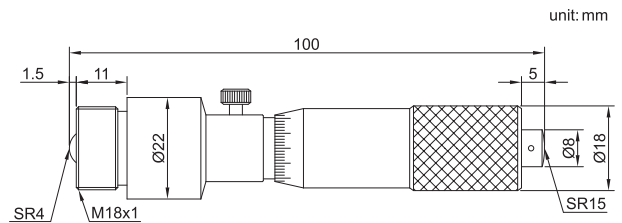

355

TUBULAR INSIDE MICROMETER

- ◆ Graduation 0.01mm
- ◆ Accuracy: $(6+L/50)\mu\text{m}$
L=maximum measuring length(mm)
- ◆ Optional accessory: setting ring(code 531)



355-008-01

Code	Range	Extension rods	Travel of micrometer head
355-001-01	25-32mm	—	7mm
355-002-01	25-50mm	2pcs	7mm
355-003-01	50-63mm	—	13mm
355-008-01	50-200mm	6pcs	13mm
355-012-01	50-300mm	10pcs	13mm
355-009-01	200-225mm	—	25mm
355-020-01	200-500mm	3pcs	25mm
355-040-01	200-1000mm	8pcs	25mm

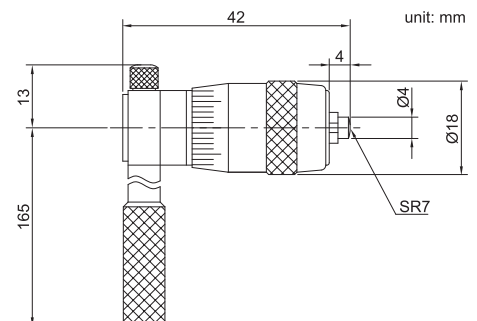

PRECISION DIAL BORE GAUGE

SERIES 251

- ◆ Wooden handle isolate heat conduction
- ◆ Optional accessory: series 531 setting rings and long handle series 250.

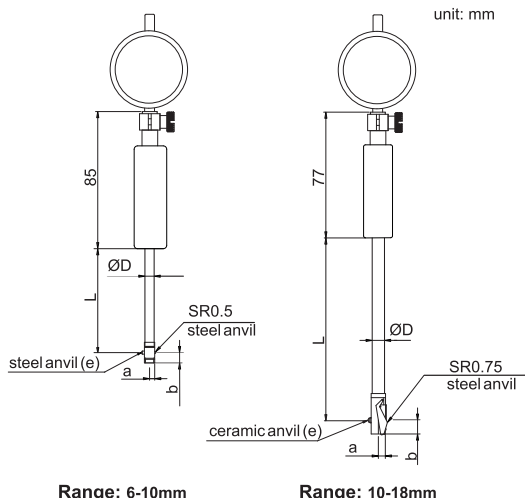

251-160-01

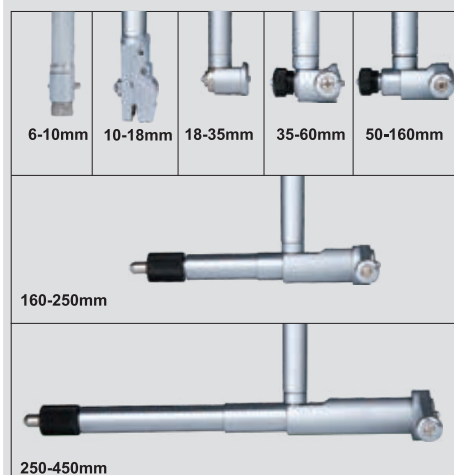
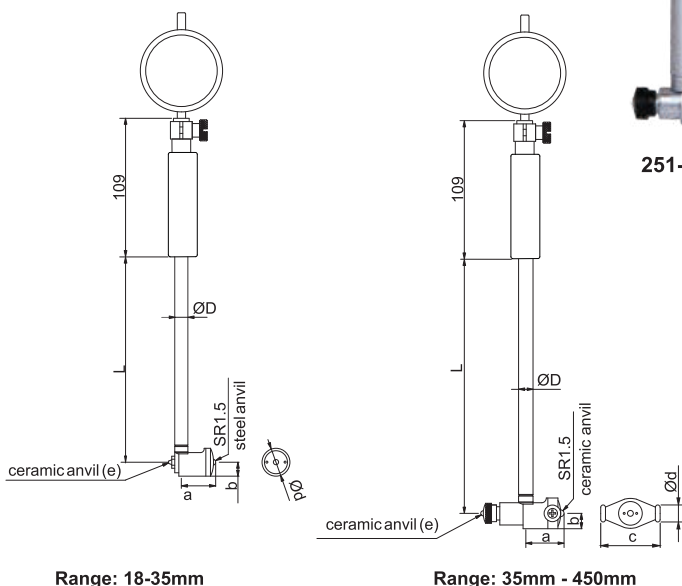

Code	Range	Dial indicator	Accuracy	Repeatability	a	b	c	Ød	ØD	e	L
251-010-01	6-10mm	Range: 1mm graduation: 0.001mm	±0.005mm	2µm	3.6	5.7	/	/	4.5	SR1	48
251-018-01	10-18mm		±0.005mm	2µm	5.6	7.8	/	/	6	SR1	105
251-035-01	18-35mm		±0.006mm	2µm	12.2	6.4	/	12.7	9	SR1	141
251-060-01	35-60mm		±0.007mm	2µm	26	9	27	13	12.8	SR2	141
251-160-01	50-160mm		±0.007mm	2µm	26	9	35	13	12.8	SR2	141
251-250-01	160-250mm		±0.007mm	2µm	56.5	13	74.5	15	14.5	SR3.5	400
251-450-01	250-450mm		±0.007mm	2µm	86.5	15	101.5	15	14.5	SR3.5	400



SERIES 251

DIAL BORE GAUGE

- ◆ Wooden handle isolate heat conduction
- ◆ Optional accessory: series 531 setting rings

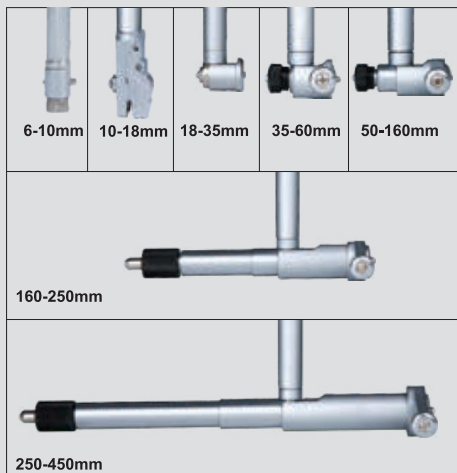

251-160-11

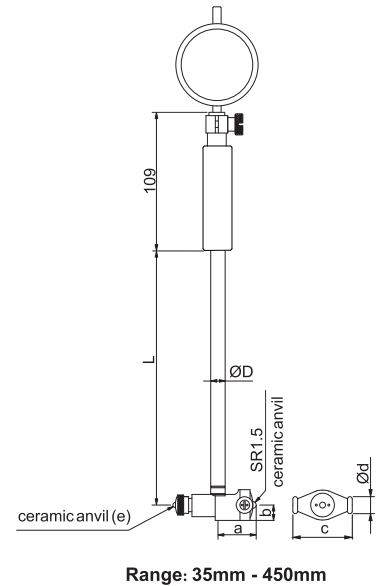
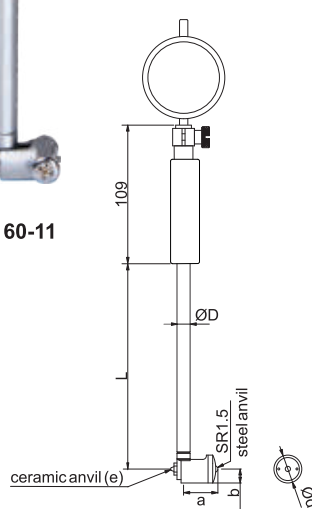
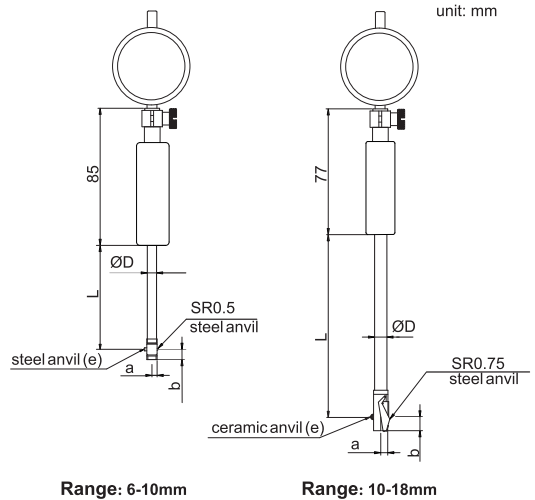

Code	Range	Dial indicator	Accuracy	Repeatability	a	b	c	Ød	ØD	e	L
251-010-11	6-10mm	Range: 3mm graduation: 0.01mm	±0.012mm	3µm	3.6	5.7	/	/	4.5	SR1	48
251-018-11	10-18mm		±0.012mm	3µm	5.6	7.8	/	/	6	SR1	105
251-035-11	18-35mm	Range: 10mm graduation: 0.01mm	±0.015mm	3µm	12.2	6.4	/	12.7	9	SR1	141
251-060-11	35-60mm		±0.018mm	3µm	26	9	27	13	12.8	SR2	141
251-100-11	50-100mm		±0.018mm	3µm	26	9	35	13	12.8	SR2	141
251-160-11	50-160mm		±0.018mm	3µm	26	9	35	13	12.8	SR2	141
251-160-12	100-160mm		±0.018mm	3µm	26	9	35	13	12.8	SR2	141
251-250-11	160-250mm		±0.018mm	3µm	56.5	13	74.5	15	14.5	SR3.5	400
251-450-11	250-450mm		±0.018mm	3µm	86.5	15	101.5	15	14.5	SR3.5	400

DIAL BORE GAUGE SET

SERIES 251

- ◆ Wooden handle isolate heat conduction
- ◆ Optional accessory: series 531 setting rings

251-046-11



251-346-13



Code	Range	Indicator	Accuracy	Repeatability	Bore gages included
251-046-11	35-160mm	range 10mm, graduation 0.01mm	35-50mm $\pm 0.018\text{mm}$ 50-160mm $\pm 0.018\text{mm}$	0.003mm	35-50mm anvil (dial indicator and handle are not included) 50-160mm bore gage
251-346-13	18-160mm	range 10mm, graduation 0.01mm	18-35mm $\pm 0.015\text{mm}$ 35-60mm $\pm 0.018\text{mm}$ 50-160mm $\pm 0.018\text{mm}$	0.003mm	18-35mm bore gage 35-60mm (dial indicator is not included) 50-160mm (dial indicator is not included)



SERIES 241

DIGITAL PRECISION BORE GAUGE

- ◆ Wooden handle isolate heat conduction
- ◆ With min. value tracking function, get the diameter automatically
- ◆ Optional accessory: series 531 setting rings

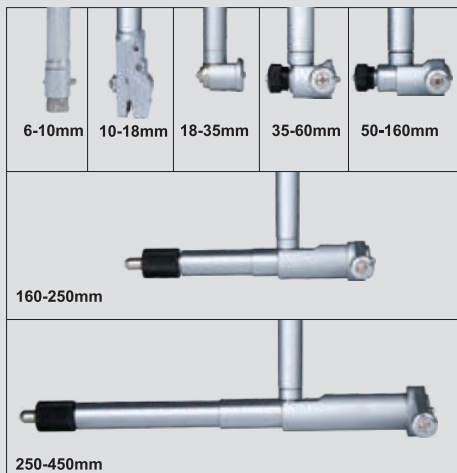

241-035-01

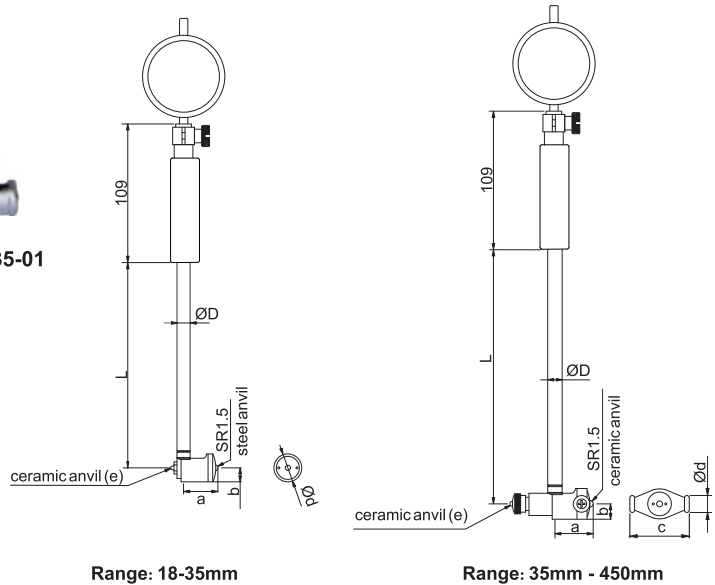
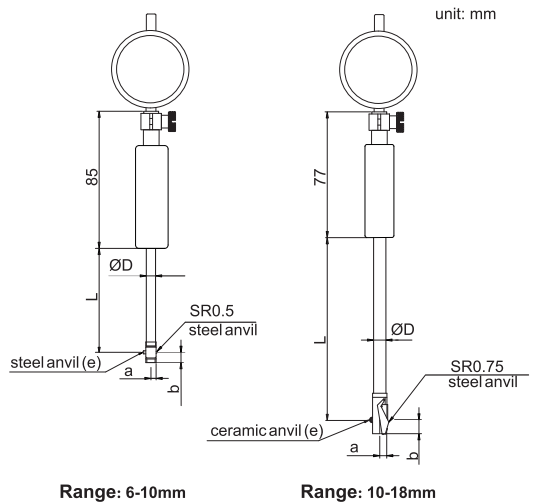

Code	Range	Digital indicator	Accuracy	Repeatability	a	b	c	Ød	ØD	e	L
241-010-01	6-10mm	Range: 12.7mm resolution: 0.001mm	±0.012mm	2µm	3.6	5.7	/	/	4.5	SR1	48
241-018-01	10-18mm		±0.012mm	2µm	5.6	7.8	/	/	6	SR1	105
241-035-01	18-35mm		±0.015mm	2µm	12.2	6.4	/	12.7	9	SR1	141
241-060-01	35-60mm		±0.018mm	2µm	26	9	27	13	12.8	SR2	141
241-160-01	50-160mm		±0.018mm	2µm	26	9	35	13	12.8	SR2	141
241-160-02	100-160mm		±0.018mm	2µm	26	9	35	13	12.8	SR2	141
241-250-01	160-250mm		±0.018mm	2µm	56.5	13	74.5	15	14.5	SR3.5	400
241-450-01	250-450mm		±0.018mm	2µm	86.5	15	101.5	15	14.5	SR3.5	400

DIGITAL BORE GAUGE

SERIES 241

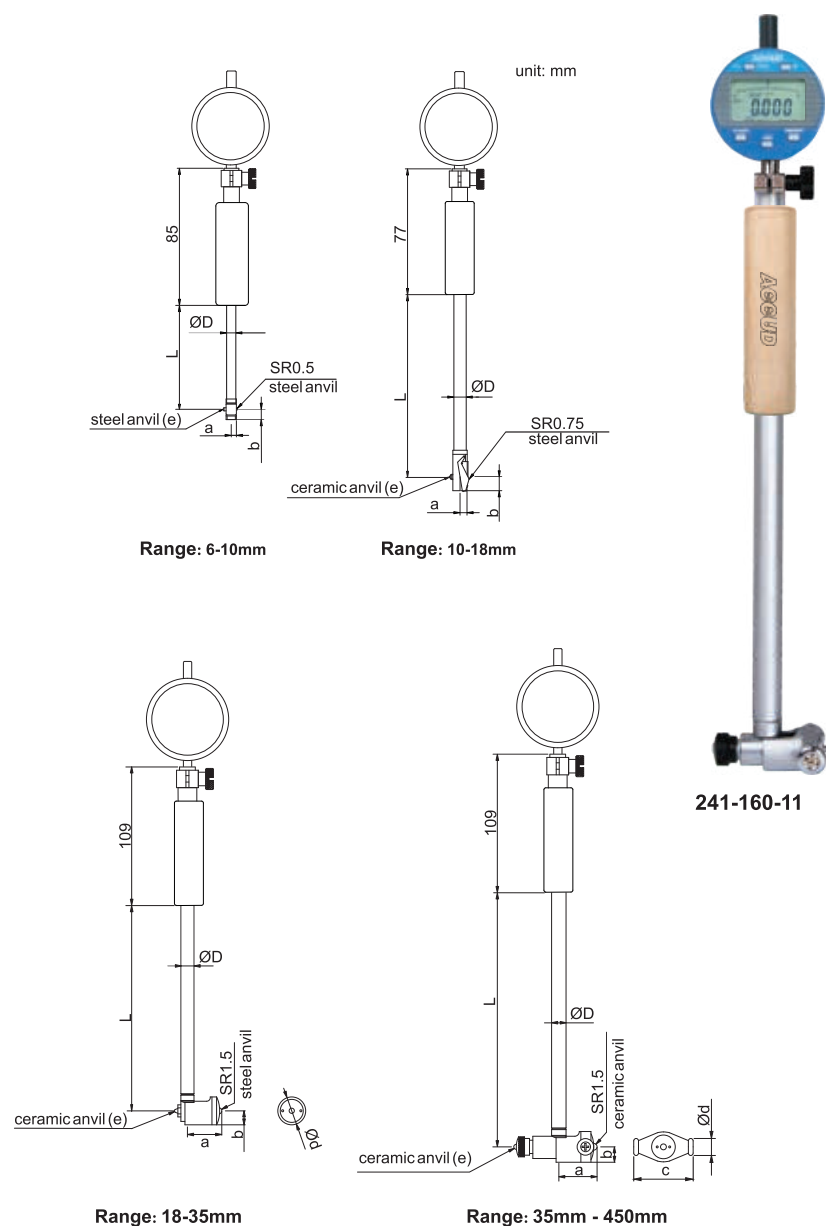

- ◆ Wooden handle isolate heat conduction
- ◆ With min. value tracking function, get the diameter automatically
- ◆ Optional accessory: series 531 setting rings

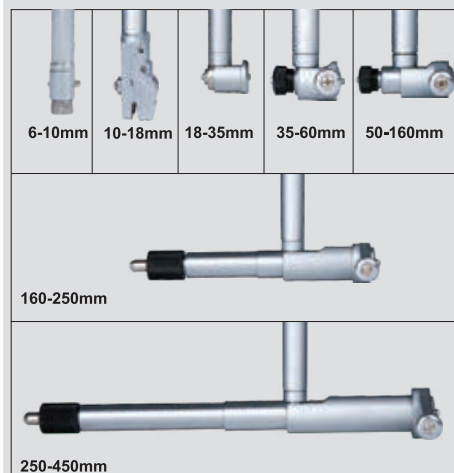

Code	Range	Digital indicator	Accuracy	Repeatability	a	b	c	Ød	ØD	e	L
241-010-11	6-10mm	Range: 12.7mm resolution: 0.002mm	±0.012mm	3µm	3.6	5.7	/	/	4.5	SR1	48
241-018-11	10-18mm		±0.012mm	3µm	5.6	7.8	/	/	6	SR1	105
241-035-11	18-35mm		±0.015mm	3µm	12.2	6.4	/	12.7	9	SR1	141
241-060-11	35-60mm		±0.018mm	3µm	12.2	9	27	13	12.8	SR2	141
241-100-11	50-100mm		±0.018mm	3µm	26	9	35	13	12.8	SR2	141
241-160-11	50-160mm		±0.018mm	3µm	26	9	35	13	12.8	SR2	141
241-160-12	100-160mm		±0.018mm	3µm	26	9	35	13	12.8	SR2	141
241-250-11	160-250mm		±0.018mm	3µm	56.5	13	74.5	15	14.5	SR3.5	400
241-450-11	250-450mm		±0.018mm	3µm	86.5	15	101.5	15	14.5	SR3.5	400



244/254

BORE GAUGE

- ◆ Accuracy: 0.018mm
- ◆ Repeatability: 0.003mm



Dial type

Code	Range	Indicator
254-060-11	35-60mm	dial indicator: (Code: 222-010-12) range 10mm, graduation 0.01mm
254-160-11	50-160mm	
254-250-11	160-250mm	
254-450-11	250-450mm	

Digital type

Code	Range	Indicator
244-060-11	35-60mm	digital indicator (see picture) range: 12.7mm/0.5", graduation: 0.002mm/0.0001"
244-160-11	50-160mm	
244-250-11	160-250mm	
244-450-11	250-450mm	

digital indicator for series 244



254-060-11

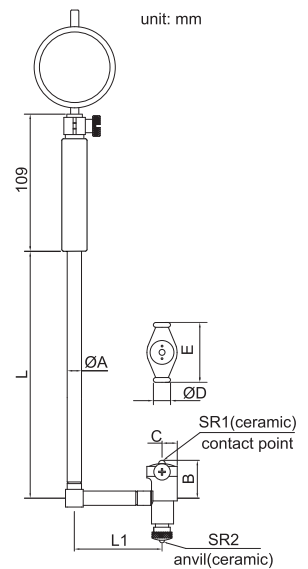

Range	ØA	B	C	ØD	E	L	L1
35-60mm	12.8	22	9	13	27	141	75
50-160mm	12.8	28.5	9.2	13	35	141	76.2
160-250mm	14.5	62.0	12.7	15	74.5	391	100
250-450mm	14.5	91.5	15.0	15	101.5	391	100

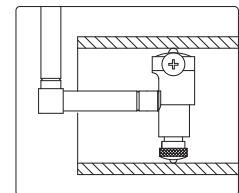

243/253

BORE GAUGE

digital indicator for 243-800-11

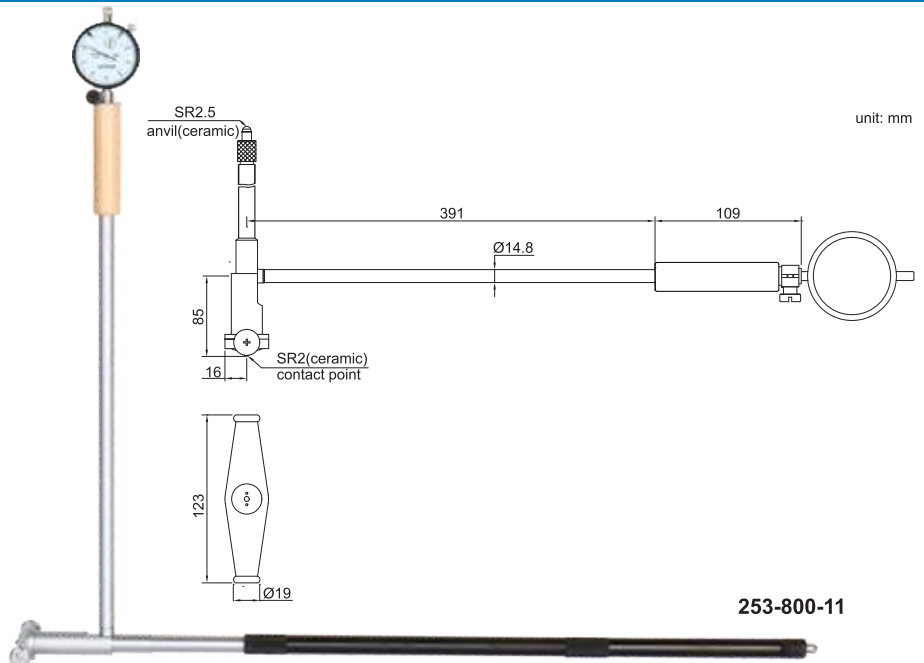

Code	Range	Accuracy	Repeatability	Indicator
253-800-11	400-800mm	±0.025mm	0.003mm	dial indicator (Code: 222-010-12) range 10mm, graduation 0.01mm
243-800-11	400-800mm	±0.025mm	0.003mm	digital indicator (see picture) range 12.7mm, resolution 0.002mm/0.0001"

INCH DIAL BORE GAUGE

SERIES 252

- ◆ Wooden handle isolate heat conduction
- ◆ Optional accessory: Long handle series 250

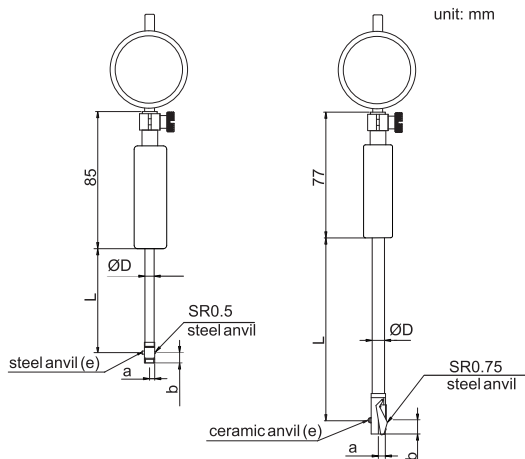

Range: 0.24-0.4"

Range: 0.4-0.7"



252-015-11

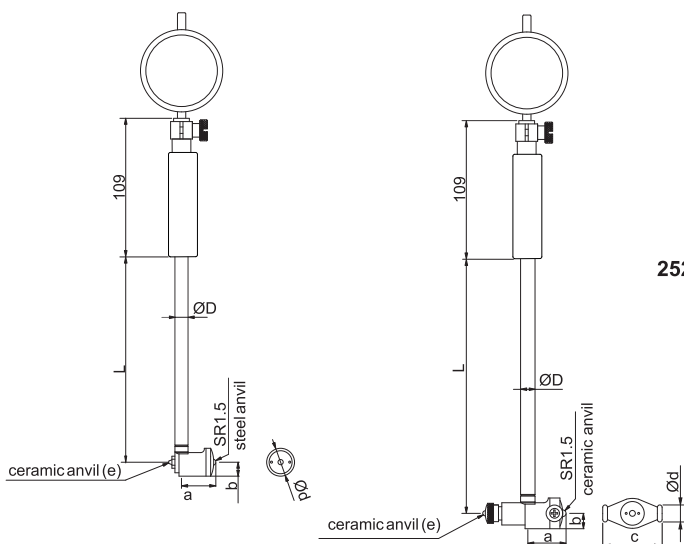

Range: 0.7-1.5"

Range: 1.4- 16"

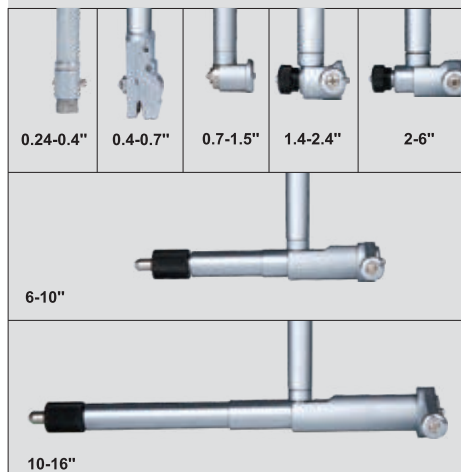

Code	Range	Digital indicator	Accuracy	Repeatability	a	b	c	Ød	ØD	e	L
252-004-11	0.24-0.4"	dial indicator, range 0.25", graduation 0.0005"	±0.00075"	0.00015"	3.6	5.7	/	/	4.5	SR1	48
252-007-11	0.4-0.7"		±0.00075"	0.00015"	5.6	7.8	/	/	6	SR1	105
252-015-11	0.7-1.5"		±0.00075"	0.00015"	12.2	6.4	/	12.7	9	SR1	141
252-024-11	1.4-2.4"		±0.0009"	0.00015"	26	9	27	13	12.8	SR2	141
252-060-11	2-6"		±0.0009"	0.00015"	26	9	35	13	12.8	SR2	141
252-100-11	6-10"		±0.0009"	0.00015"	56.5	13	74.5	15	14.5	SR3.5	400
252-160-01	10-16"		±0.0009"	0.00015"	86.5	15	101.5	15	14.5	SR3.5	400



SERIES 250

ANVIL FOR BORE GAUGES

◆ Measuring face is made of ceramic



250-160-11



Code	For Bore Gauges	QTY. per Set	Measuring Tip Material	Measuring Range of Anvil (mm)
250-010-11	6-10mm	9pcs	steel	6, 6.5, 7, 7.5, 8, 8.5, 9, 9.5, 10
250-018-11	10-18.5mm	9pcs	ceramic	10, 11, 12, 13, 14, 15, 16, 17, 18
250-035-11	18-35mm	9pcs	ceramic	18, 20, 22, 24, 26, 28, 30, 32, 34
250-060-11	35-60mm	6pcs	ceramic	35, 40, 45, 50, 55, 60
250-100-11	50-100mm	11pcs	ceramic	50, 55, 60, 65, 70, 75, 80, 85, 90, 95, 100
250-160-11	50-160mm	12pcs	ceramic	50, 55, 60, 65, 70, 75, 80, 85, 90, 95, 100, 105
250-160-12	100-160mm	12pcs	ceramic	50, 55, 60, 65, 70, 75, 80, 85, 90, 95, 100, 105
250-250-11	160-250mm	5pcs	ceramic	160, 170, 180, 190, 200
250-450-11	250-450mm	5pcs	ceramic	250, 260, 270, 280, 290

SERIES 250

LONG HANDLE

◆ To assist deep-hole measurement

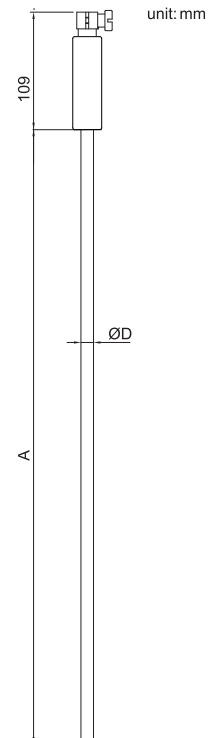

Code	For Bore Gauges	A	ØD
250-000-01	35-60mm, 50-100mm, 50-160mm, 100-160mm	473	13
250-000-02		980	13
250-000-03	160-250mm, 250-450mm	480	14.5
250-000-04		980	14.5

BORE GAUGE SETTER

SERIES 256

- ◆ Can be used in vertical and horizontal
- ◆ To be used with gage blocks

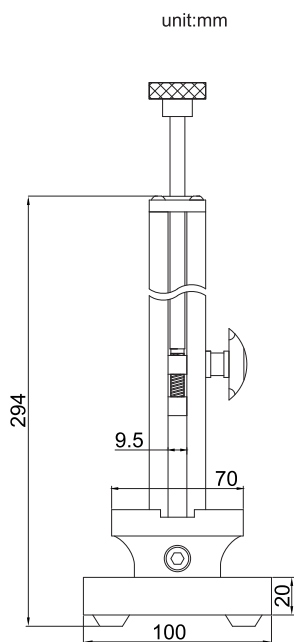

Application



Gage block set for 256-160-11



Gage block set (grade 2, ISO3650) for 256-160-11

Blocks per set	Size(mm)	Step(mm)	Quantity(pcs)
33	1.005		1
	1.01-1.09	0.01	9
	1.1-1.9	0.1	9
	1-9	1	9
	10-30	10	3
	50		1
	100		1

Code	Range	Repeatability	Gage block set
256-160-11	0-160mm	1.2μm	with
256-160-10	0-160mm	1.2μm	without



296

DIGITAL RADIUS GAUGE

- ◆ Measure radius of internal and external arcs
- ◆ Accuracy: $\pm 0.01R$, R is the radius to be measured in mm
- ◆ Data output (cable code: 200-01 or 200-02)
- ◆ Supplied with 5 jaws for different sizes of arc

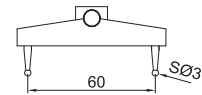
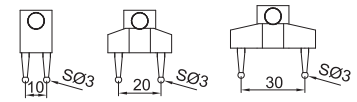
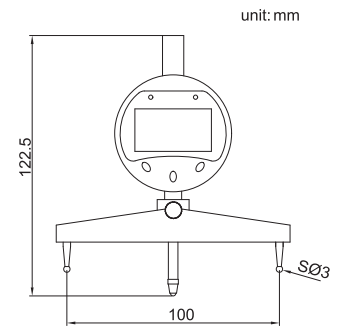

Code	Range of radius	Resolution
296-700-11	5-700mm/0.2-27.5"	0.01mm/0.001"

SERIES 956

CIRCUMFERENCE TAPE

- ◆ Measure diameter and circumference of pipes, trees, etc.
- ◆ Graduation: 0.1mm
- ◆ Accuracy:
Circumference: ± 1.5 mm
Diameter: ± 0.5 mm
- ◆ Laser engraved scale
- ◆ Made of stainless steel



956-012-11

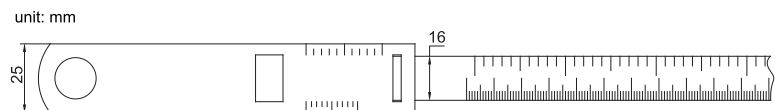

Code	Range	
	Diameter	Circumference
956-012-11	20-300mm	60-950mm
956-028-11	300-700mm	940-2200mm
956-044-11	700-1100mm	2190-3460mm

LINEAR GAUGE

SERIES 201

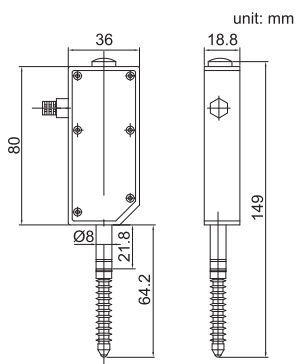

- ◆ Suitable for measuring the height, thickness, squareness, coaxiality and so on.
- ◆ IP65 protection level
- ◆ High frequency: 100 times/s, can measure high speed workpiece
- ◆ Output signal: 90° phase difference wave
- ◆ Standard cable length: 2m
- ◆ Long working life due to the special bearing

Single gauge application

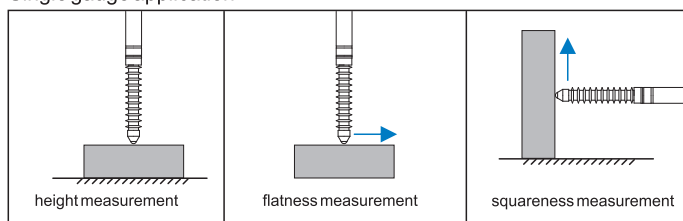

Multi-gauges application

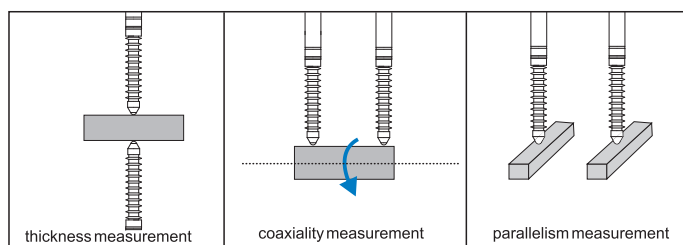

Code	Resolution	Interface	Range	Measuring force	Stem	Accuracy	Hysteresis
201-010-11	0.01mm	Pin4	0-12.7mm	1.5N	Ø8mm	20µm	10µm
201-010-12	0.01mm	RS232	0-12.7mm	1.5N	Ø8mm	20µm	10µm
201-010-01	0.001mm	Pin4	0-12.7mm	1.5N	Ø8mm	5µm	2µm
201-010-02	0.001mm	RS232	0-12.7mm	1.5N	Ø8mm	5µm	2µm



206

DISPLAY UNIT FOR LINEAR GAUGE

- ◆ High and low limits with judgement
- ◆ With external control
- ◆ With output I/O
- ◆ Power: DC9-24V

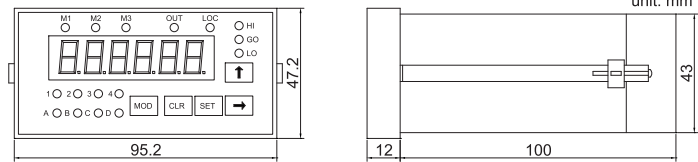

Code	Gage Input	Interface
206-010-01	1	Pin4

SERIES 208

COUNTER FOR LINEAR GAUGE

- ◆ With data recording software, can transfer the data into Excel

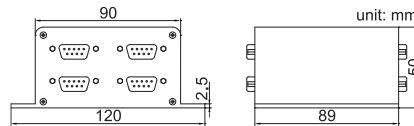

208-004-01

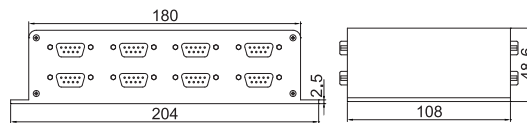

208-008-01

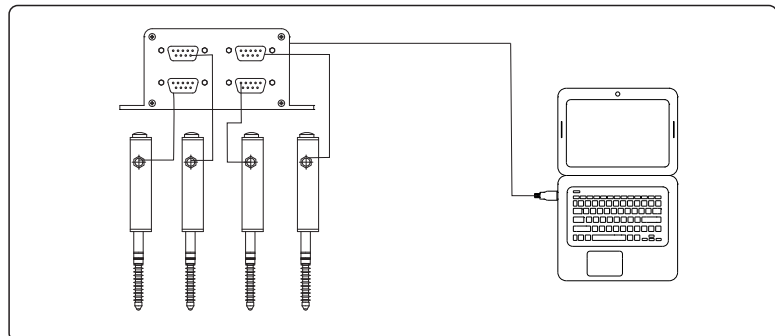

Code	Gages Input	Interface
208-004-01	4	RS232/485
208-008-01	8	RS232/485

DIGITAL INDICATOR

SERIES 210

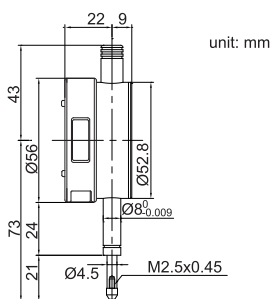

Range: 0-12.7mm

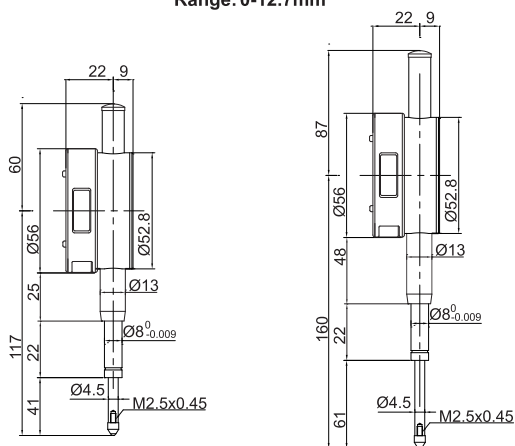

Range: 0-25.4mm

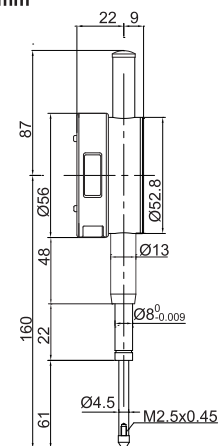

Range: 0-50.8mm



210-010-03

- ◆ Button: tolerance set, data preset, inch/mm conversion, measuring direction set, max./min./range measurement, absolute/incremental measurement
- ◆ Data output
- ◆ Automatic power off
- ◆ Supplied with flat and lug back

Code	Range	Resolution	Accuracy	Hysteresis
210-010-03	12.7mm/0.5"	0.001mm/0.00005"	5µm	2µm
210-025-03	25.4mm/1"	0.001mm/0.00005"	5µm	3µm
210-050-03	50.8mm/2"	0.001mm/0.00005"	6µm	3µm
210-010-13	12.7mm/0.5"	0.01mm/0.0005"	20µm	10µm
210-025-13	25.4mm/1"	0.01mm/0.0005"	20µm	10µm
210-050-13	50.8mm/2"	0.01mm/0.0005"	30µm	10µm



DIGITAL INDICATOR

SERIES 211

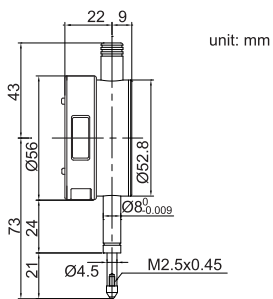

Range: 0-12.7mm

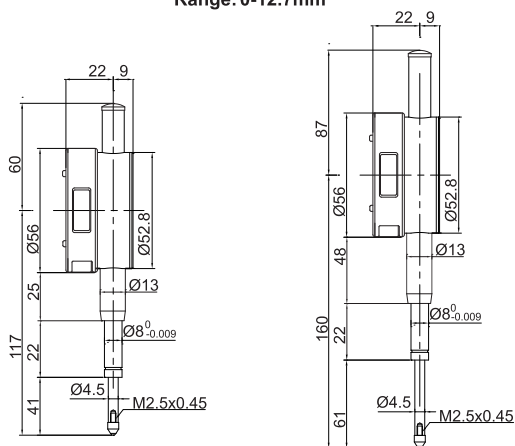

Range: 0-25.4mm

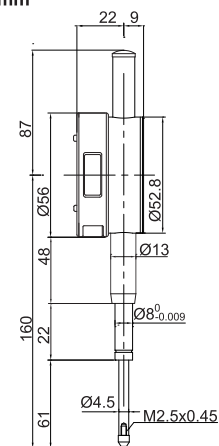

Range: 0-50.8mm



211-010-13

- ◆ With analog reading
- ◆ Button: tolerance set, data preset, inch/mm conversion, measuring direction set, max./min./range measurement, absolute/incremental measurement
- ◆ Data output
- ◆ Automatic power off
- ◆ Supplied with flat and lug back

Code	Range	Resolution	Accuracy	Hysteresis
211-010-03	12.7mm/0.5"	0.001mm/0.00005"	5µm	2µm
211-025-03	25.4mm/1"	0.001mm/0.00005"	5µm	3µm
211-050-03	50.8mm/2"	0.001mm/0.00005"	6µm	3µm
211-010-13	12.7mm/0.5"	0.01mm/0.0005"	20µm	10µm
211-025-13	25.4mm/1"	0.01mm/0.0005"	20µm	10µm
211-050-13	50.8mm/2"	0.01mm/0.0005"	30µm	10µm

SERIES 212

DIGITAL INDICATOR

- ◆ Button: on/off, zero, inch/mm conversion, measuring direction set, data preset absolute/incremental measurement
- ◆ Data output
- ◆ Automatic power off
- ◆ Supplied with flat and lug back



212-010-13

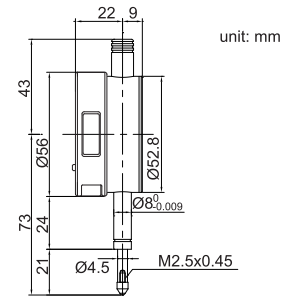

Range: 0-12.7mm

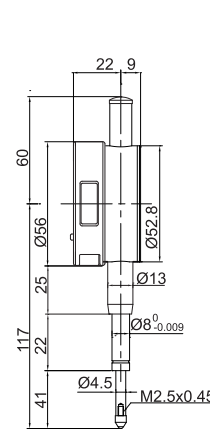

Range: 0-25.4mm

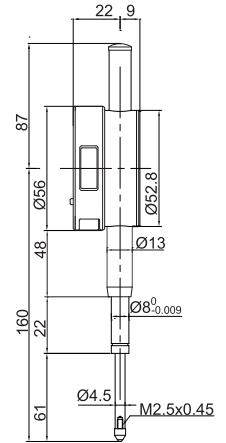

Range: 0-50.8mm

Code	Range	Resolution	Accuracy	Hysteresis
212-010-03	12.7mm/0.5"	0.001mm/0.00005"	5μm	2μm
212-025-03	25.4mm/1"	0.001mm/0.00005"	5μm	3μm
212-050-03	50.8mm/2"	0.001mm/0.00005"	6μm	3μm
212-010-13	12.7mm/0.5"	0.01mm/0.0005"	20μm	10μm
212-025-13	25.4mm/1"	0.01mm/0.0005"	20μm	10μm
212-050-13	50.8mm/2"	0.01mm/0.0005"	30μm	10μm

SERIES 213

WATERPROOF DIGITAL INDICATOR

- ◆ Dust/waterproof
- ◆ Button: on/off, zero, inch/mm conversion, measuring direction set, data preset absolute/incremental measurement
- ◆ Automatic power off
- ◆ Data output
- ◆ Supplied with lug and flat back



213-010-01

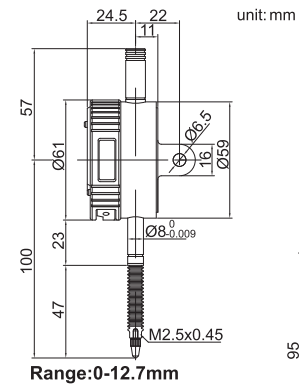

Range: 0-12.7mm

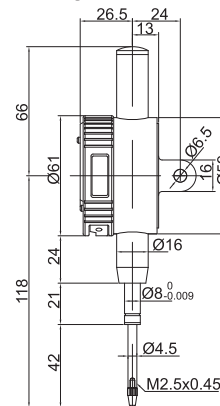

Range: 0-25.4mm

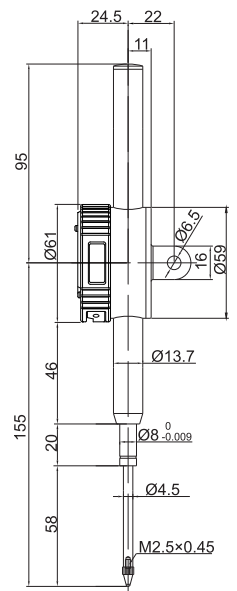

Range: 0-50.8mm

Code	Range	Resolution	Proof Level	Accuracy	Hysteresis
213-010-01	12.7mm/0.5"	0.001mm/0.00005"	IP65	5μm	2μm
213-025-01	25.4mm/1"	0.001mm/0.00005"	IP54	5μm	3μm
213-050-01	50.8mm/2"	0.001mm/0.00005"	IP54	6μm	3μm
213-010-11	12.7mm/0.5"	0.01mm/0.0005"	IP65	20μm	10μm
213-025-11	25.4mm/1"	0.01mm/0.0005"	IP54	20μm	10μm
213-050-11	50.8mm/2"	0.01mm/0.0005"	IP54	30μm	10μm

DIGITAL INDICATOR

SERIES 214

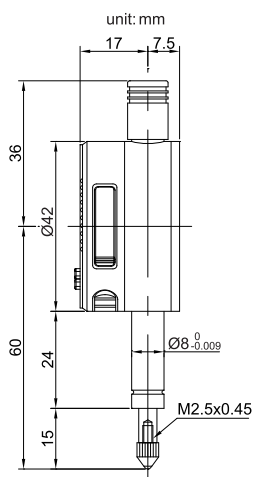

214-005-12

- ◆ Button: on/off, zero, inch/mm conversion, measuring direction set, data preset absolute/incremental measurement
- ◆ Automatic power off
- ◆ Data output
- ◆ Supplied with flat back

Code	Range	Resolution	Accuracy	Hysteresis
214-005-02	5mm/0.2"	0.001mm/0.00005"	5µm	3µm
214-005-12	5mm/0.2"	0.01mm/0.0005"	20µm	10µm



DIGITAL INDICATOR

SERIES 214

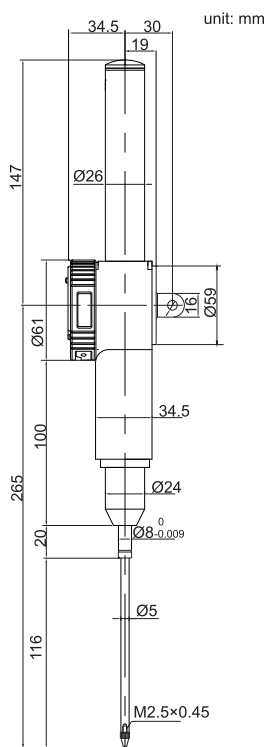

214-100-11

- ◆ Button: on/off, zero, inch/mm conversion, measuring direction set, data preset absolute/incremental measurement
- ◆ Automatic power off
- ◆ Data output
- ◆ Supplied with lug and flat back

Code	Range	Resolution	Accuracy	Hysteresis
214-100-01	100mm/4"	0.001mm/0.00005"	9µm	3µm
214-100-11	100mm/4"	0.01mm/0.0005"	30µm	10µm

SERIES 223

DIAL INDICATOR

- ◆ Graduation: 0.01mm
- ◆ With limit hands
- ◆ Range per revolution: 1mm
- ◆ With lock screw

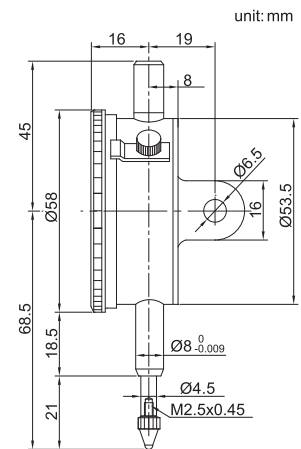

223-010-11

Code	Range	Back	Accuracy	Scale	Hysteresis
223-010-11	10mm	lug	20µm	0-100	3µm
223-010-12	10mm	flat	20µm	0-100	3µm

SERIES 222

DIAL INDICATOR

- ◆ Graduation: 0.01mm
- ◆ With limit hands
- ◆ Jeweled bearing
- ◆ Range per revolution: 1mm
- ◆ With lock screw

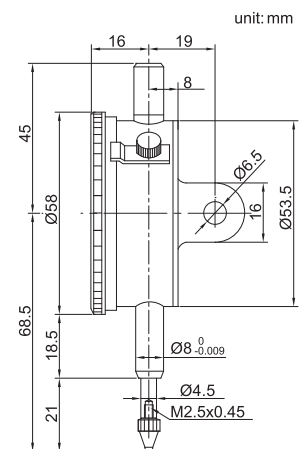

222-010-11

Code	Range	Back	Accuracy	Scale	Hysteresis
222-003-11	3mm	lug	14µm	0-100	3µm
222-005-11	5mm	lug	16µm	0-100	3µm
222-010-11	10mm	lug	20µm	0-100	3µm
222-003-12	3mm	flat	14µm	0-100	3µm
222-005-12	5mm	flat	16µm	0-100	3µm
222-010-12	10mm	flat	20µm	0-100	3µm

DIAL INDICATOR

SERIES 222

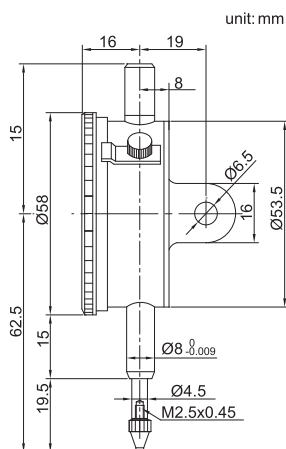

222-001-01

- ◆ Graduation: 0.001mm
- ◆ With limit hands
- ◆ Jeweled bearing
- ◆ Rang per revolution: 0.2mm
- ◆ With lock screw



Code	Range	Back	Scale	Accuracy	Hysteresis
222-001-01	1mm	lug	0-100-0	5µm	2µm
222-001-02	1mm	flat	0-100-0	5µm	2µm

DIAL INDICATOR

SERIES 221

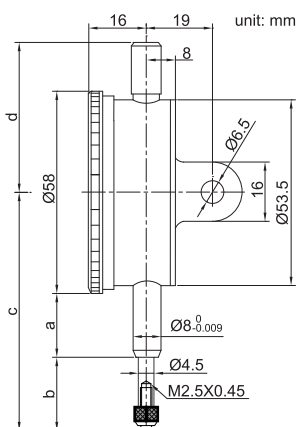

221-001-01

- ◆ Graduation: 0.001mm
- ◆ With limit hands
- ◆ Jeweled bearing
- ◆ Rang per revolution: 0.2mm
- ◆ Supplied with lug and flat back

Code	Range	Scale	Accuracy	Hysteresis	a	b	c	d
221-001-01	1mm	0-200	5µm	2µm	15	19.5	62.5	45
221-003-01	3mm	0-200	10µm	4µm	10	21.5	59.5	41.5
221-005-01	5mm	0-200	10µm	4µm	10	21.5	59.5	41.5

SERIES 226

SHOCKPROOF DIAL INDICATOR

- ◆ Shockproof
- ◆ Graduation: 0.01mm
- ◆ With limit hands
- ◆ Jeweled bearing
- ◆ Rang per revolution: 1mm
- ◆ Supplied with lug and flat back



226-010-11

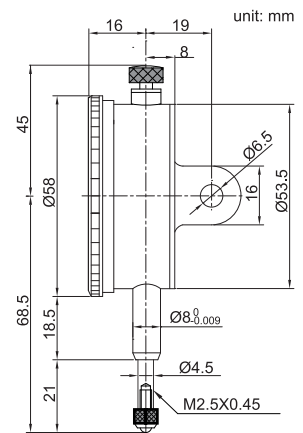

Code	Range	Accuracy	Hysteresis	Scale
226-005-11	5mm	16µm	3µm	0-100
226-010-11	10mm	20µm	3µm	0-100

SERIES 228

DIAL INDICATOR

- ◆ Bezel: Ø40mm
- ◆ Graduation: 0.01mm
- ◆ With limit hands
- ◆ Jeweled bearing
- ◆ Rang per revolution: 1mm
- ◆ Supplied with lug and flat back



228-005-11

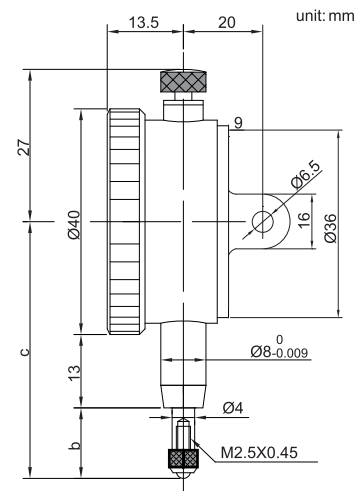

Code	Range	Accuracy	Hysteresis	Scale	b	c
228-003-11	3mm	14µm	3µm	0-100	11mm	44mm
228-005-11	5mm	16µm	3µm	0-100	12.5mm	45.5mm

DIAL INDICATOR

SERIES 229

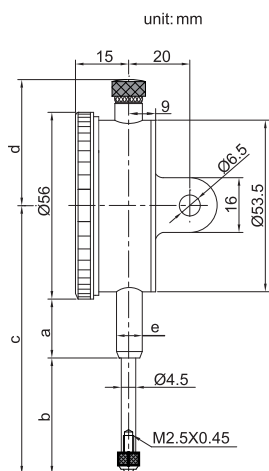

229-030-11

- ◆ Graduation: 0.01mm
- ◆ With limit hands
- ◆ Rang per revolution: 1mm
- ◆ Supplied with lug and flat back

Code	Range	Accuracy	Hysteresis	Scale	a	b	c	d	e
229-020-11	20mm	25µm	5µm	0-100	20mm	35mm	83mm	37.5mm	Ø8mm
229-025-11	25mm	35µm	7µm	0-100	20mm	40mm	88mm	37.5mm	Ø8mm
229-030-11	30mm	35µm	7µm	0-100	20mm	40mm	88mm	37.5mm	Ø8mm
229-050-21	50mm	40µm	8µm	0-100	40mm	58mm	127mm	108mm	Ø8mm
229-100-21	100mm	50µm	9µm	0-100	60mm	108mm	207mm	168mm	Ø10mm

WATERPROOF DIAL INDICATOR

231

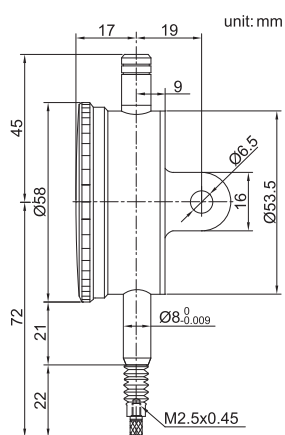

- ◆ IP54 dust/waterproof
- ◆ Graduation:0.01mm
- ◆ Jeweled bearing

Code	Range	Accuracy(f _{ges})	Hysteresis(f _u)	Range/rev	Dial reading
231-010-11	10mm	17µm	3µm	1mm	0-100



SERIES 232

ONE REVOLUTION DIAL INDICATOR

- ◆ Shock proof



232-001-11

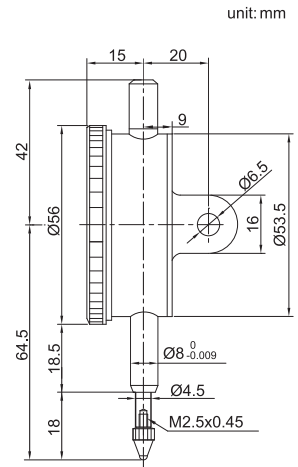

Code	Range	Graduation	Accuracy	Hysteresis	Dial reading
232-0005-11	0.5mm	0.01mm	9μm	3μm	25-0-25
232-001-11	1mm	0.01mm	9μm	3μm	50-0-50

SERIES 225

INCH DIAL INDICATOR

- ◆ Supplied with limit hands and bezel clamp
- ◆ Lug back



225-025-11

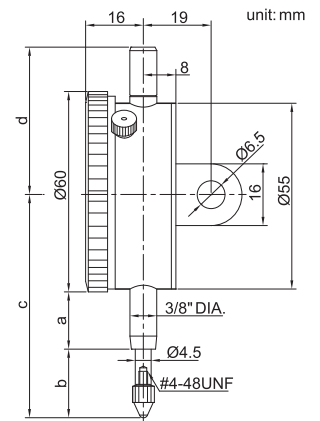

Code	Range	Graduation	Dial reading	Range/rev	Accuracy(f _{ges})	a	b	c	d
225-006-11	0.25"	0.001"	0-100	0.1"	0.004"	20	25	75	46
225-012-11	0.5"	0.001"	0-100	0.1"	0.004"	20	25	75	46
225-025-11	1"	0.001"	0-100	0.1"	0.004"	20	35	85	46
225-050-11	2"	0.001"	0-100	0.1"	0.008"	50	59	139	111

DIAL TEST INDICATOR

259



- ◆ Jeweled bearing
- ◆ Double scale spacing
- ◆ Anti-magnetic aluminium alloy body
- ◆ With two clamps: Ø4mm and Ø8mm

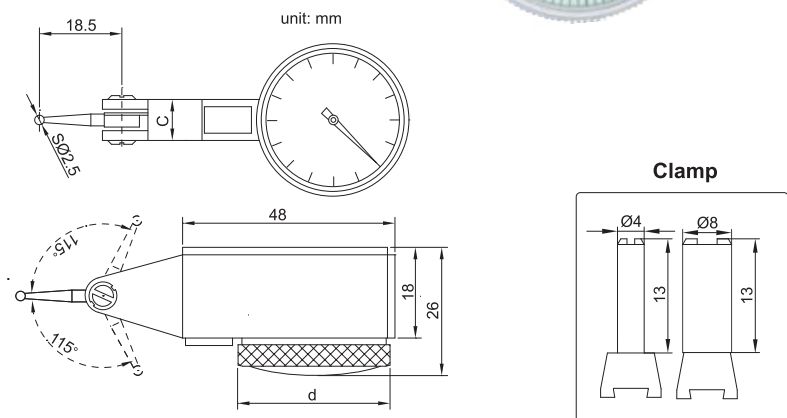

Code	Range	Bezel(d)	Graduation	Styli	Accuracy	Hysteresis	Scale	C
259-008-11	0.8mm	Ø31mm	0.01mm	steel	13µm	3µm	0-40-0	8.3mm

DIAL TEST INDICATOR

SERIES 261

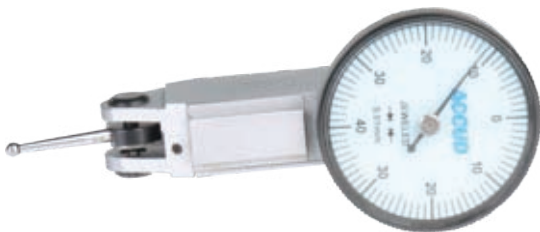

261-008-12

unit: mm

- ◆ Jeweled bearing
- ◆ Double scale spacing
- ◆ Anti-magnetic copper body
- ◆ With two clamps: Ø4mm and Ø8mm

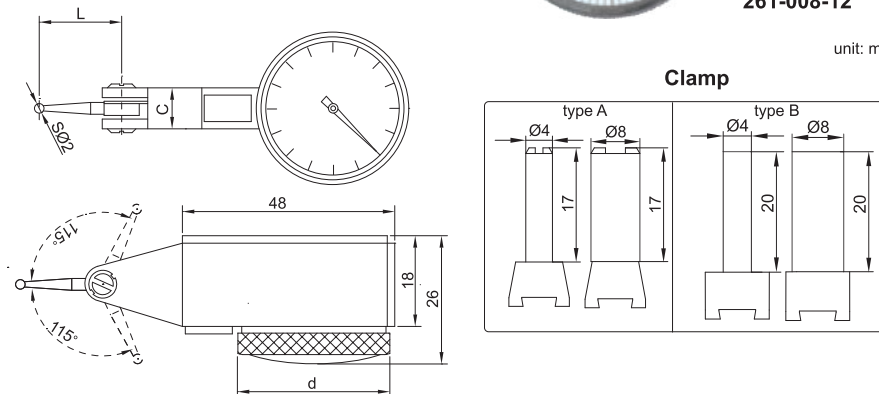

Code	Range	Bezel(d)	Graduation	Styli	Clamp	Accuracy	Hysteresis	Scale	C	L
261-008-11	0.8mm	Ø30mm	0.01mm	carbide	type A	13µm	3µm	0-40-0	8.9	16.5
261-008-12	0.8mm	Ø37.5mm	0.01mm	carbide	type A	13µm	3µm	0-40-0	8.9	16.5
261-002-01	0.2mm	Ø30mm	0.002mm	ruby	type B	6µm	2µm	0-100-0	8	17
261-002-02	0.2mm	Ø37.5mm	0.002mm	ruby	type B	6µm	2µm	0-100-0	8	17



263

LONG STYLI DIAL TEST INDICATOR

- ◆ Jeweled bearing
- ◆ Double scale spacing
- ◆ Anti-magnetic copper body
- ◆ With two clamps: Ø4mm and Ø8mm

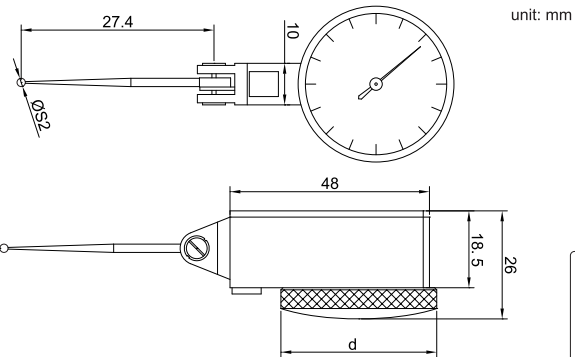

unit: mm

Code	Range	Bezel(d)	Graduation	Styli	Accuracy	Hysteresis	Scale
263-008-11	0.8mm	Ø37.5mm	0.01mm	carbide	13µm	3µm	0-40-0

264

BACK PLUNGER TYPE DIAL TEST INDICATOR

- ◆ Jeweled bearing
- ◆ Carbide contact point
- ◆ Two measuring directions
- ◆ Anti magnetic body
- ◆ Supplied with two clamps: diameter Ø4mm and Ø8mm
- ◆ Optional accessory: styli

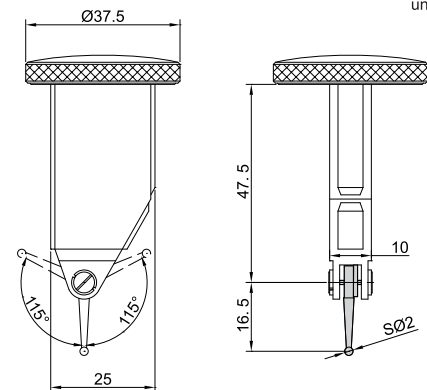

unit: mm

Code	Range	Graduation	Accuracy(f _{ges})	Hysteresis(f _u)	Dial Reading
264-008-11	0.8mm	0.01mm	13µm	3µm	0-40-0

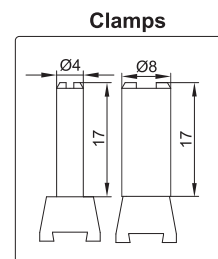

DIAL TEST INDICATOR

265

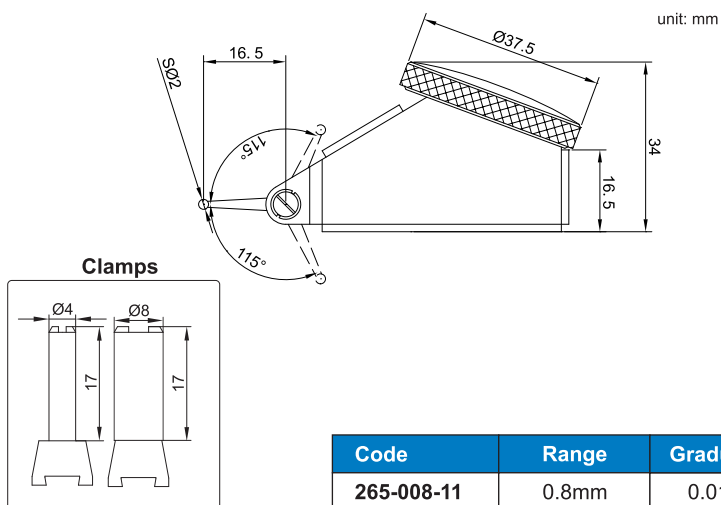

- ◆ Jeweled bearing
- ◆ Carbide contact point
- ◆ Two measuring directions
- ◆ Anti magnetic body
- ◆ Supplied with two clamps: diameter Ø4mm and Ø8mm
- ◆ Optional accessory: styli

Code	Range	Graduation	Accuracy	Hysteresis	Dial Reading
265-008-11	0.8mm	0.01mm	13µm	3µm	0-40-0

LARGE RANGE DIAL TEST INDICATOR

266

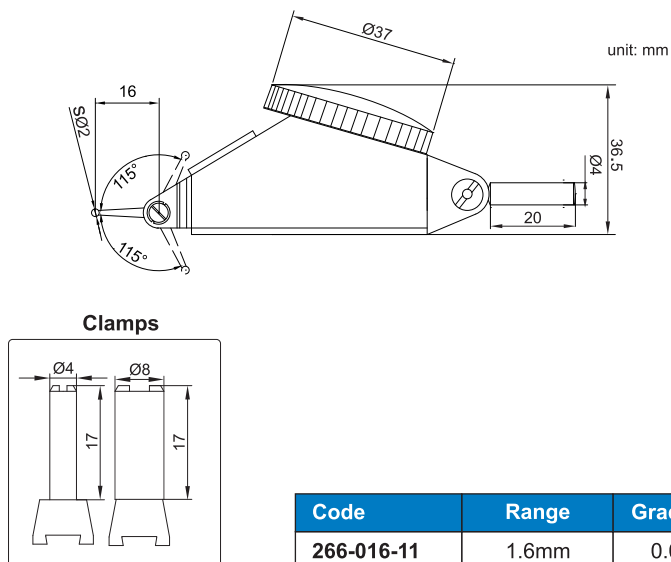

- ◆ Jeweled bearing
- ◆ Carbide contact point
- ◆ Two measuring directions
- ◆ Anti magnetic body
- ◆ Supplied with two clamps: diameter Ø4mm and Ø8mm
- ◆ Optional accessory: styli

Code	Range	Graduation	Accuracy	Hysteresis	Dial reading
266-016-11	1.6mm	0.01mm	38µm	11µm	0-40-0



SERIES 260

STYLI FOR DIALTEST INDICATOR



260-002-02

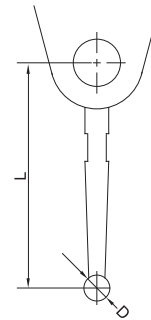

Code	For products	Tip material	D(mm)	L(mm)
260-001-01	261-008-11,	steel	SØ1	16.5
260-002-02	261-002-12, 266-016-11,	carbide	SØ2	16.5
260-003-02	264-008-11,	carbide	SØ3	16.5
260-010-01	265-008-11,	ruby	SØ2	16.5
260-009-01	261-002-01, 261-002-02	ruby	SØ2	17
260-010-02	263-008-01	carbide	SØ2	27.4

SERIES 267

HOLDER FOR INDICATOR

- ◆ Use as holder for dial/digital indicators, dial test indicators and height gages



267-115-02

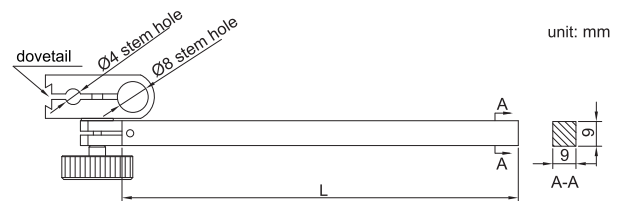

267-050-01 and 267-100-01

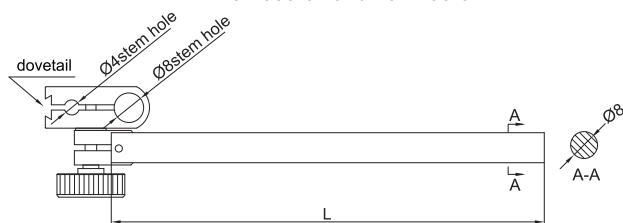

267-115-02

Code	Section size	Size(L)
267-050-01	9x9mm	50mm
267-100-01	9x9mm	100mm
267-115-02	Ø8mm	115mm

UNIVERSAL HOLDER FOR DIAL TEST INDICATOR

268

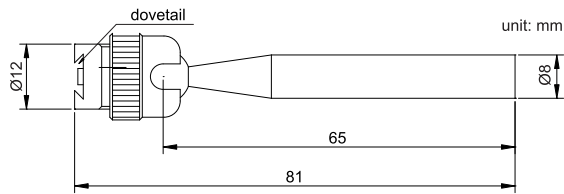

- ◆ Universal head

Code	Section size	Size(L)
268-055-01	Ø8mm	55mm



DIAL TEST INDICATOR CENTERING HOLDER

269

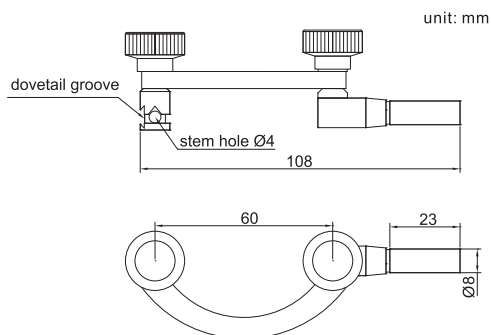

- ◆ Center cylinders or holes on a machine tool

Code
269-060-01

SERIES 270

CONTACT POINTS

type A

Code	Material	L(mm)
270-001-01	carbide	7.3
270-001-02	ceramic	7.3
270-001-03	carbide	8.3
270-001-04	carbide	12.1
270-001-05	carbide	14
270-001-06	carbide	15
270-001-07	ceramic	15
270-001-08	carbide	17
270-001-09	carbide	19.3
270-001-10	carbide	20
270-001-11	ceramic	20
270-001-12	carbide	22
270-001-13	carbide	25
270-001-14	ceramic	25
270-001-15	carbide	30
270-001-16	ceramic	30

Ball Point



270-001-01

type A

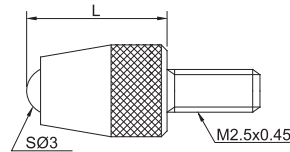

unit: mm

type B

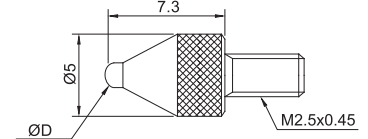

unit: mm

type B

Code	Material	ØD(mm)
270-001-21	steel	1
270-001-22	carbide	1.5
270-001-23	carbide	1.8
270-001-24	carbide	2.5
270-001-25	carbide	4

Shell Type Point



270-002-01

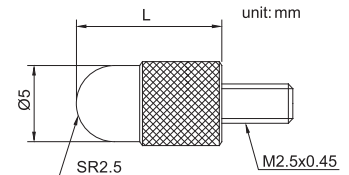

unit: mm

Code	Material	L(mm)
270-002-01	steel	5
270-002-02	steel	10
270-002-03	steel	15
270-002-04	steel	20
270-002-05	steel	25
270-002-06	steel	30

Spherical Point

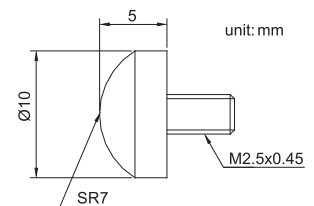

unit: mm

Code	Material
270-003-01	steel

Conical Point



270-004-01

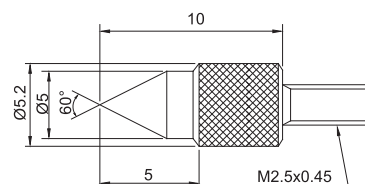

270-004-01

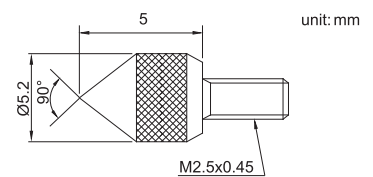

unit: mm

270-004-02

Code	Material
270-004-01	steel
270-004-02	steel



CONTACT POINTS

SERIES 270

Flat Point



270-005-11

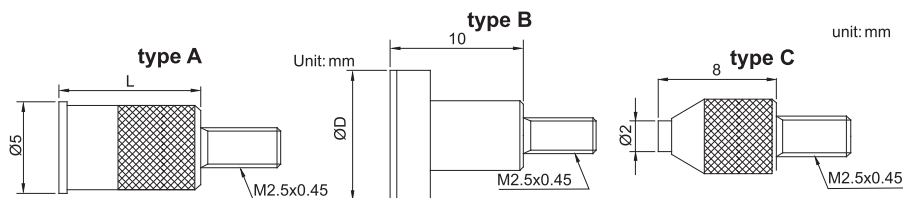

type A

Code	Material	L
270-005-01	steel	8
270-005-02	steel	10

type B

Code	Material	ØD
270-005-11	steel	10
270-005-12	steel	15
270-005-13	steel	20
270-005-14	steel	25
270-005-15	steel	30

type C

Code	Material
270-005-21	carbide

Needle Point



270-006-21

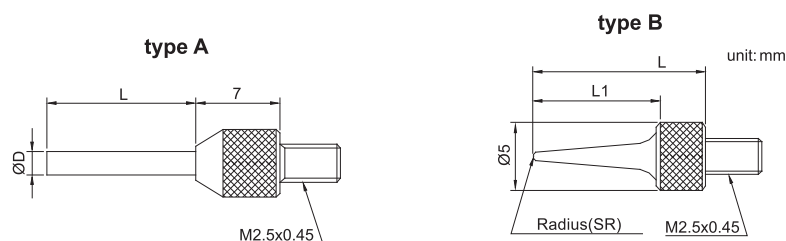

type B

Code	Material	L1	L	SR
270-006-21	steel	11	15	0.4
270-006-22	steel	13	17	0.2
270-006-23	steel	21	25	0.4
270-006-24	steel	31	35	0.4

Knife Edge Point

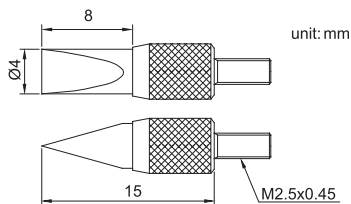

Code	Material
270-007-01	steel

Blade Point



270-008-01

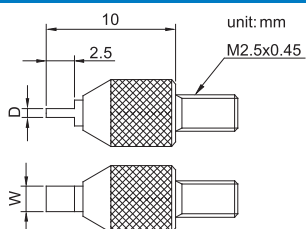

Code	Material	D	W
270-008-01	steel	0.4	2
270-008-02	steel	0.6	2
270-008-03	steel	1	4



SERIES 270

EXTENSION ROD FOR CONTACT POINTS



270-000-13

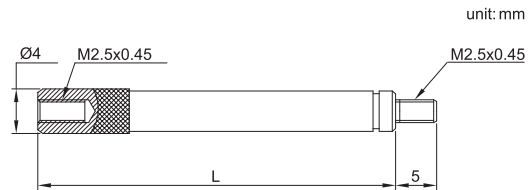

Code	Material	L
270-000-01	steel	10
270-000-02	steel	15
270-000-03	steel	20
270-000-04	steel	25
270-000-05	steel	30
270-000-06	steel	35
270-000-07	steel	40
270-000-08	steel	45
270-000-09	steel	50

Code	Material	L
270-000-10	steel	55
270-000-11	steel	60
270-000-12	steel	65
270-000-13	steel	70
270-000-14	steel	75
270-000-15	steel	80
270-000-16	steel	90
270-000-17	steel	100

SERIES 272

LUG AND FLAT BACK



272-000-01

unit: mm

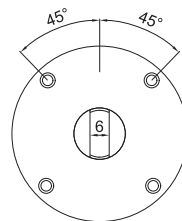

272-000-01

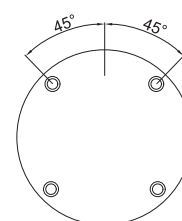
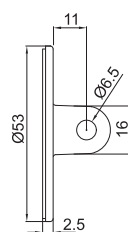

272-000-02

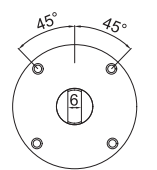
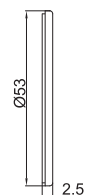

272-000-03

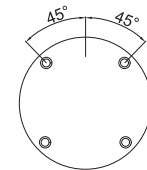
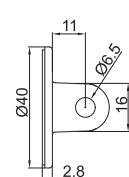

272-000-04

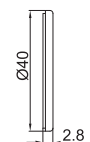

Code	Type	Material
272-000-01	lug	metal
272-000-02	flat	plastic
272-000-03	lug	metal
272-000-04	flat	plastic