

Pre-Leasing Available Now!
OPSINVESTMENTS.COM

Shoppes On Woodmark



Leasing information

9600 E. Woodmark Dr.
Shoppes on Woodmark
Salon Suites by A

Wayne Rambally
281-901-1552

OpsInvestments.com
SalonSuitesbyA.com



Executive Summary

Ops Investments is pleased to announce the opportunity to lease retail space at 9600 E. Woodmark Dr. located in the booming city of Conroe, just a few miles north of Houston. Currently in development, the property is comprised of a single 10,143 SF retail center divided into seven units. Shoppes on Woodmark provides entrepreneurs the ability to start living their dreams and setting their own schedules.

Six suites will be built out with electrical, HVAC, plumbing and sheetrock and are ready for the new tenant customization. These units are well suited for use as either office or retail. Contact OPS Investments at OPSINVESTMENTS.com for leasing options!

The middle suite is leased to Salon Suites by A, which will have thirteen (13) private salon suites available for rent by Estheticians, Cosmetologists, Barbers and Hair Stylists. Contact Salon Suites by A at SalonSuitesbyA.com for salon suite rental options!

Shoppes on Woodmark Suite Layout

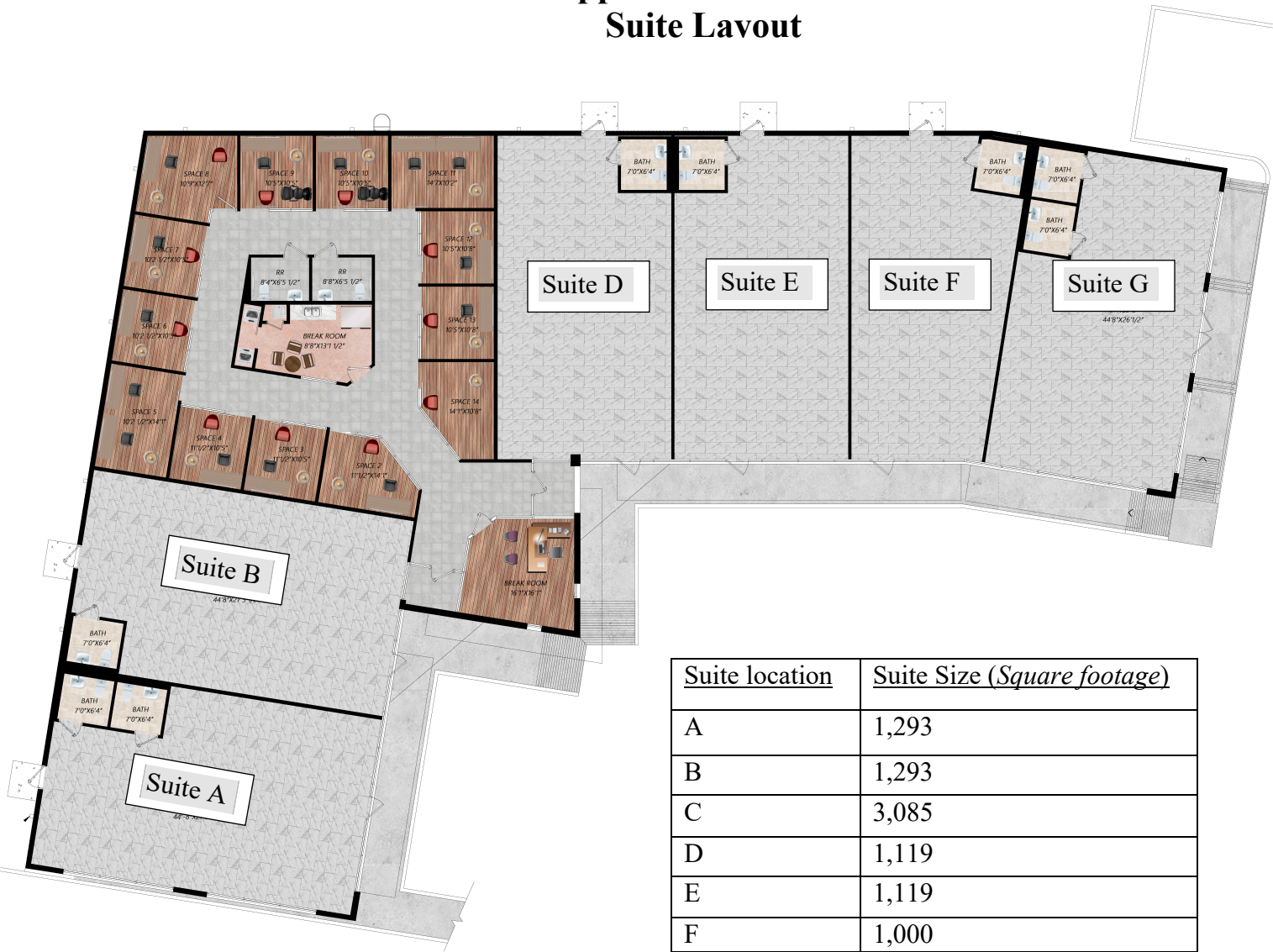

<u>Suite location</u>	<u>Suite Size (Square footage)</u>
A	1,293
B	1,293
C	3,085
D	1,119
E	1,119
F	1,000
G	1,234

Salon Suites by A

If you're looking for more control in your life, flexibility and new adventures, Salon Suites by A is the perfect place for you to get your hair or nail salon business started! Contact us for more information on leasing one of our suites today! Visit our website for more information!

SalonSuitesbyA.com



<i>Salon Suites by A available suite sizes:</i>	
<u>Number of Suites</u>	<u>Suite Size (Square footage)</u>
8	100
2	115
1	140
2	144

DEMOGRAPHICS OVERVIEW

DEMOGRAPHICS	2 MILES	5 MILES	10 MILES
2010 Population	6,948	55,048	182,384
2021 Population	15,818	91,563	267,503
2026 Population Projection	18,432	104,685	302,910
Annual Growth 2010-2021	11.60%	6.00%	4.20%
Annual Growth 2021-2026	3.30%	2.90%	2.60%
Median Age	38.6	35.7	37.9

Demographics below are within a 10 mile radius of property

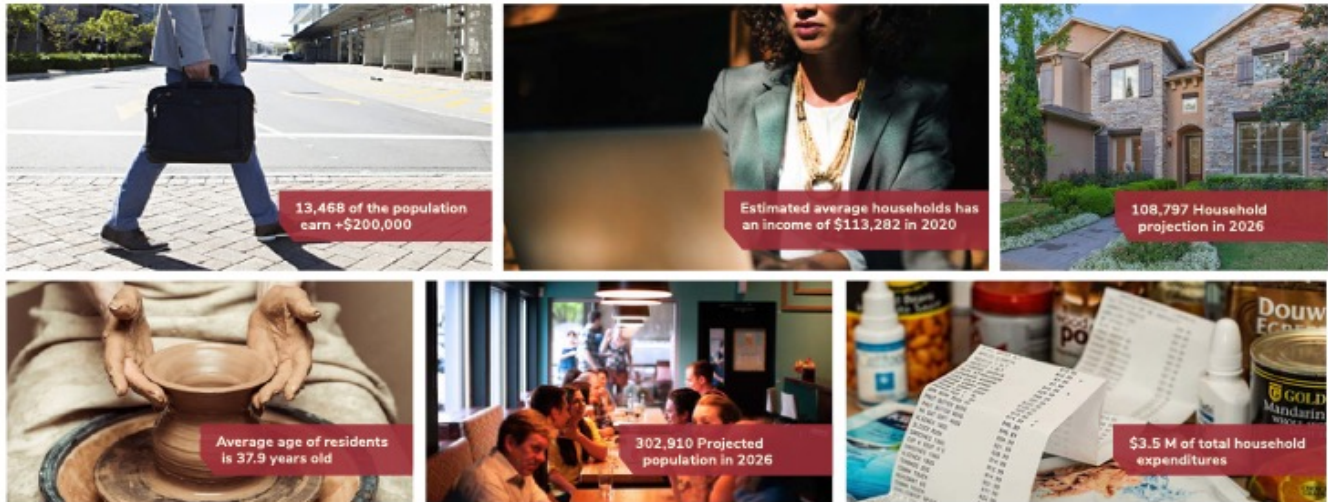

Resource: SitesUSA.com