

BLDG. #	ADDRESSES	# OF UNITS
BUILDING A	199 OCEAN AVENUE	156
BUILDING B	92 DANFORTH AVENUE	130
BUILDING C	82 DANFORTH AVENUE	40
BUILDING D	72 DANFORTH AVENUE	42
TOTAL # OF UNITS		368
TOTAL # OF DWELLING UNITS		357
TOTAL # OF NON-DWELLING UNITS		11

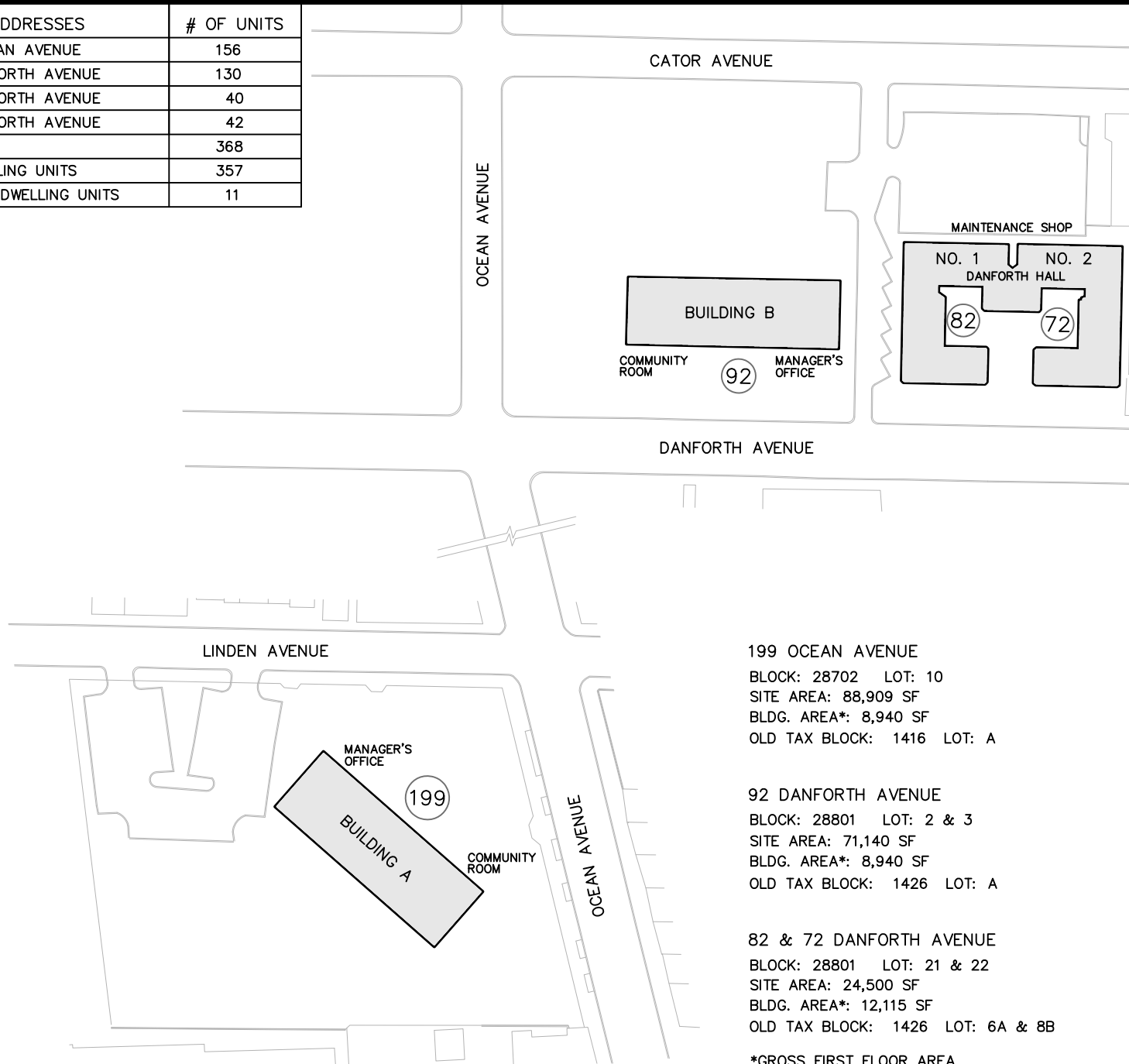

199 OCEAN AVENUE  
 BLOCK: 28702 LOT: 10  
 SITE AREA: 88,909 SF  
 BLDG. AREA\*: 8,940 SF  
 OLD TAX BLOCK: 1416 LOT: A

92 DANFORTH AVENUE  
 BLOCK: 28801 LOT: 2 & 3  
 SITE AREA: 71,140 SF  
 BLDG. AREA\*: 8,940 SF  
 OLD TAX BLOCK: 1426 LOT: A

82 & 72 DANFORTH AVENUE  
 BLOCK: 28801 LOT: 21 & 22  
 SITE AREA: 24,500 SF  
 BLDG. AREA\*: 12,115 SF  
 OLD TAX BLOCK: 1426 LOT: 6A & 8B

\*GROSS FIRST FLOOR AREA



PROJECT N.J. 9-9  
 BERRY GARDENS  
 JERSEY CITY, NJ 07305

BUILDING A: 199 OCEAN AVENUE  
 BUILDING B: 92 DANFORTH AVENUE  
 BUILDING C: 82 DANFORTH AVENUE  
 BUILDING D: 72 DANFORTH AVENUE

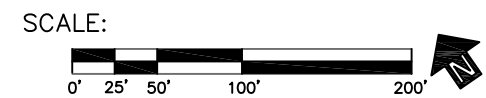

REVISED: 01/2014

X:\JCHA Site Maps\Updated 2014 with New Tax Block-Lot #s\NJ9-9, Berry Gardens.dwg\esg