

L A F A Y E T T E V I L L A G E

WOODWARD STREET

JAMES "POP" CURRY DRIVE

WALTER MAYS DRIVE

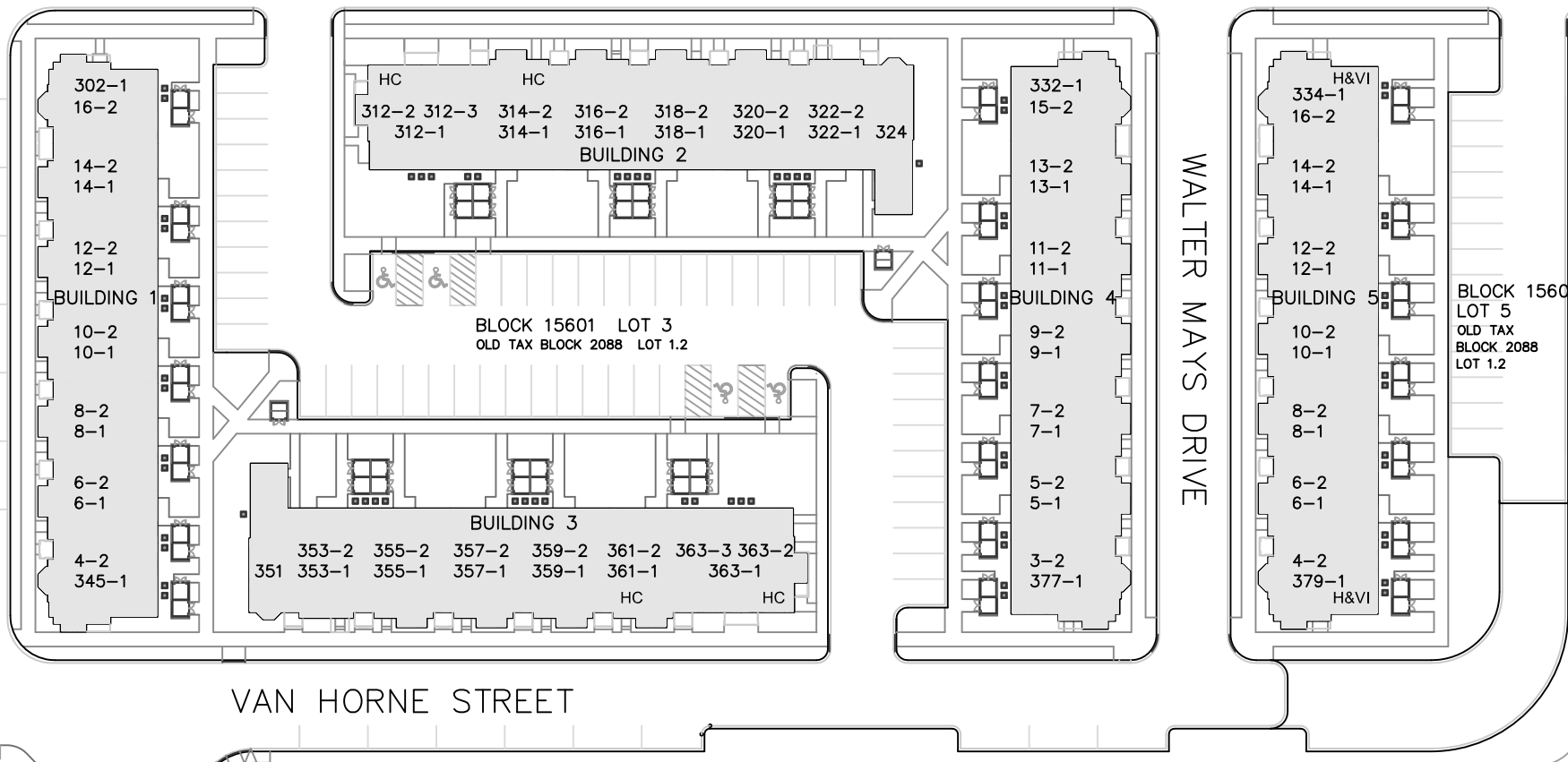

VAN HORNE STREET

CARBON

BUILDING 1	302-1 WOODWARD STREET 16-2, 14-2, 14-1, 12-2, 12-1, 10-2, 10-1, 8-2, 8-1, 6-2, 6-1, 4-2 JAMES "POP" CURRY DRIVE 345-1 VAN HORNE STREET	BUILDING 2	312-1, 312-2, 312-3, 314-2, 314-1, 316-2, 316-1, 318-2, 318-1, 320-2, 320-1, 322-2, 322-1, 324 WOODWARD STREET	BUILDING 3	351, 353-2, 353-1, 355-2, 355-1, 357-2, 357-1, 359-2, 359-1 361-2, 361-1, 363-3, 363-2, 363-1 VAN HORNE STREET
14 UNITS		14 UNITS		14 UNITS	
7,669 SF*		7,579 SF*		7,579 SF*	
BUILDING 4	322-1 WOODWARD STREET 15-2, 13-2, 13-1, 11-2, 11-1, 9-2, 9-1, 7-2, 7-1, 5-2, 5-1, 3-2 WALTER MAYS DRIVE 377-1 VAN HORNE STREET	BUILDING 5	334-1 WOODWARD STREET 16-2, 14-2, 14-1, 12-2, 12-1, 10-2, 10-1, 8-2, 8-1, 6-2, 6-1, 4-2 WALTER MAYS DRIVE 379-1 VAN HORNE STREET	SITE AREA: 2.31 AC TOTAL BLDG. AREA*: 38,165 SF TOTAL # OF UNITS: 70 TOTAL # OF ACC UNITS: 45	
14 UNITS		14 UNITS			
7,669 SF*		7,669 SF*			

*GROSS FIRST FLOOR AREA
OLD TAX BLOCK: 2088 LOT: 1.2



PROJECT N.J. 9-15
WOODWARD TERRACE
JERSEY CITY, NJ 07304

SITE PLAN
BLOCK: 15601 LOT: 3, 5
REVISED: 01/2014

