

EasyNetworker

- For the "Smart Home Installer" !
Small yet powerfull Network Analyzer !

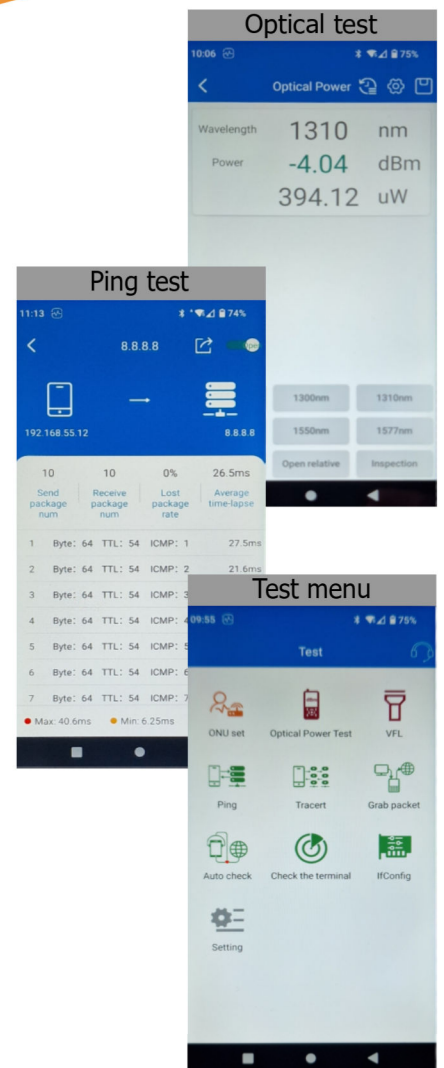

For easy testing of Data Networks:

- Ethernet test (one 2Gbps port and one 1Gbps port)
- WiFi Test
- Bluetooth Test
- IPTV Test
- Mobile 4G and 5G Test
- Optical Power Meter (dB) input
- VFL (Visual Fault Locator)
- HDMI Display Test
- Built in GPS
- Android 12 OS platform, 64 GB. 12mp+6mp cameras

EasyNetworker

- For the "Smart Home Installer" !
Small yet powerful Network Analyzer !

The **EasyNetworker** is an easy to use and very affordable instrument for testing and verifying that surrounding Data Networks are working correct.

The **EasyNetworker** is the tool to use for testing Ethernet speed (up to 2.5 Gbps), WiFi speed and function, Bluetooth connections/signal strength, IPTV-test and the operation of Mobile Networks (4G and 5G).

Furthermore the instrument has a VFL (Visual Fault Locator) and OPM (Optical Power Meter) for checking fiber connections and measuring signal level (dB).

The instrument also got an HDMI-input for testing HDMI-displays and/or to be used as a HDMI-display.

The **EasyNetworker** is the perfect tool for the "Smart Home Installer" who wants to verify that cabling/transmissions are working correct and that the networks are covering the whole planned area. It is very suitable for factories, offices, schools, hospitals etc.

The instrument is built upon an Android 12 OS platform with a 6" TFT-display. It has a 8 Core, 2.4 GHZ CPU with 64 Gb internal memory. It got a USB-C OTG port for connecting with external gadgets such as keyboard, mouse, memorystick, etc. EasyNetworker can also be used as a Mobile phone for 4G/5G and have two slots besides the battery-pack for Nano SIM-cards. It has a built in rechargeable battery with a Stand by time of >650 hours. It can be recharged by any Mobile charger of +5V, 1amp (USB C).

The **EasyNetworker** comes in a soft nylon carrying-case for transport protection. Total weight of the instrument with battery pack and carrying-case is just around half a kg.

Technical specification

Operating system	Android 12
Mobile Bands	5G EU: n1/ 3/ 5/ 7/ 8/ 20/ 28/ 38/ 40/ 41/ 77/ 78 4G LTE EU: B1/ 3/ 5/ 7/ 8/ 20/ 28/ 32/ 38/ 39/ 40/ 41/ 42
SIM	2x Nano SIM slots
CPU	8 core, 2.4GHz
Internal memory	6GB RAM, 64GB ROM
External interace	2x1Gbps port (or 1Gbps port + 2.5G port) 1 port for Optical Power Meter 1 port for VFL (Visual Fault Locator) 1 USB-C port (OTG) 1 HDMI input
Bluetooth	Supports 5.2
Wifi	Support WIFI 802.11a/b/g/n/ac/ax 2.4G and 5G dual-band Support 2*2MIMO, up to 4*4 MIMO (optional). Support 160M bandwidth
Barcode scanning	Support 1D/2D barcode scanning function
Display	6 inch, 2160*1080 TFT
Camera	Front: 8 million pixels Rear: 16 million pixels
LiPo-battery	3.7V, 5400 mAh
Stand by	About 10mA in Stand by (can be in Stand by mode for more than 650 hours)
GPS	Yes
Size, wight	170x76x21mm, 450g