

## 2" 4'x6' BACK FOLDING METAL HOCKEY GOAL



No.	Sketch	Description	Part #	Qty
1		Front End Swedged Top Rail	5038551 331	1
2		Front End Plain Top Rail	5038551 332	1
3		Left Upper Front corner	5038552 303	1
4		Right Upper Front corner	5038552 307	1
5		Red Folding Leg	5038552 304	2
6		Left Base Bend	5038551 351	1
7		Right Base Bend	5038551 352	1
8		Rear base with two swedges	5038551 341	1
9		Rear base with one swedge	5038551 342	1
10		Upper Back Support With Holes	5038551 311	1
11		Lower Back Support With Pin	5038551 309	1
12		Top Shelf Left Corner	5038551 321	1
13		Top Shelf Right Corner	5038551 322	1
14		White Lacing Rope	9141	2
15		Hockey Net 4'x6'	69114	1
16		4x6 Hockey 4 Pocket Target Nets	69101	1
17		8mm Folding section bolt	5310	2
18		8mm Self locking nut	008	3
19		Pull Pin 60mm 2-3/8"	6592	2
20		Allen wrench	018	1
21		Wrench	017	1

### Installation Instructions

Please read instructions  
**COMPLETELY**  
before assembly.



**DO NOT RETURN  
PRODUCT TO THE  
STORE**

Missing Parts,  
Need Replacements, or  
Help with Assembly

Please Contact  
Customer Service:

**Service@ezgoal.net**

**203 591 9032**

**WATERBURY, CT 06710, U.S.A.**



**Note:** Precision Connections will fit snugly. Use a rubber mallet or block of wood if needed.

### Follow the directions

Connect the folding section and base parts together. Part 304 to parts 351 and 352.

The folding section bolts should be on the inside and in front.

The nuts should be on the outside.

Do not over tighten the nuts.

The pull pins should be in the back of the folding section.

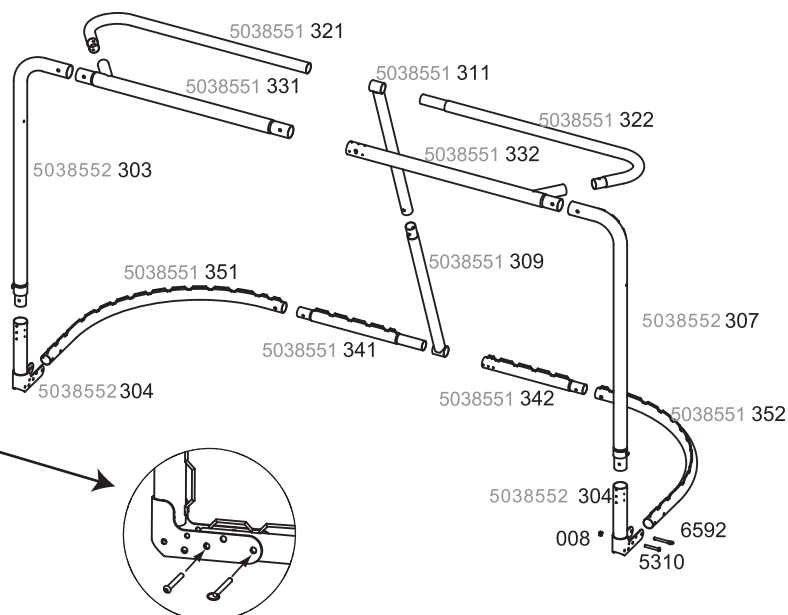

1. Begin assembly at the base of the goal and work upwards. Follow the diagram. Note: Pull pins from both folding legs and unfold. Reinsert pins to lock position prior to assembly.

2. Drape Hockey net over goal frame. Align the red tab in the center of the top and the green tab with the bottom back. Secure the six corners to align the net.

3. Starting at the red tab on top. Tie off one end of the rope to the welded wire. Lace only one loop through each square box of the goal net. Tie off with a good knots.

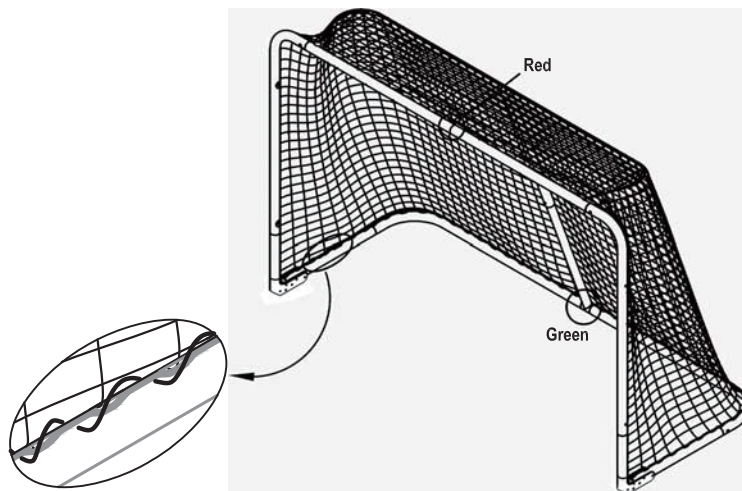

## Folding & Storage

### Folding & Storing goal with net attached:

1. Release the button the back bar support and pull apart.
2. Pull the pins on both folding legs
3. Press the 4 buttons on the top rail and the top shelf will fold down.
4. Lift base up and into the front of the goal. Reinsert pins on the top hole to secure base so the folded section will stay in the up position.

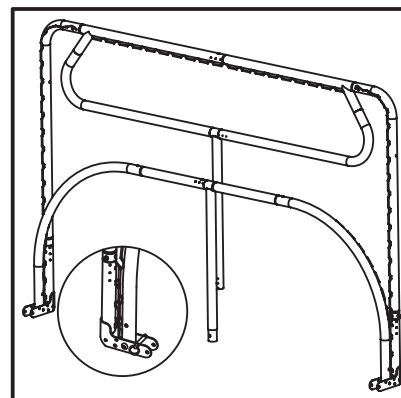
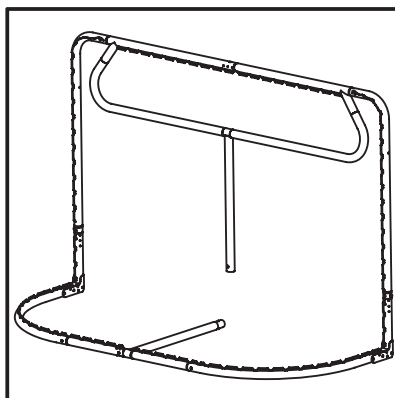

## 4'x6' 4 Pocket Target Nets Installation

**Step 1** Lay out the EZ Goal target pockets in front Fig. 1 of the goal. Align the colored tabs in each pocket with the appropriate corner

**BROWN** upper right  
**BLUE** upper left  
**ORANGE** lower right  
**RED** lower left

Figure 1

Center color tab in corners

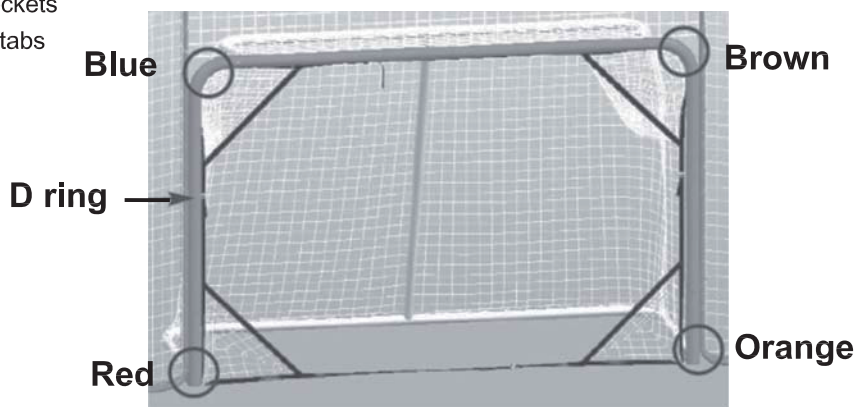

**Step 2** Hook the 2 hooks on the back of the wire frame separated by about 4" or one wire loop. (see Figure 2) Keep the color tab in the middle of the corner while adjusting, leaving slack in the line for final adjustment with the D rings.

Figure 2

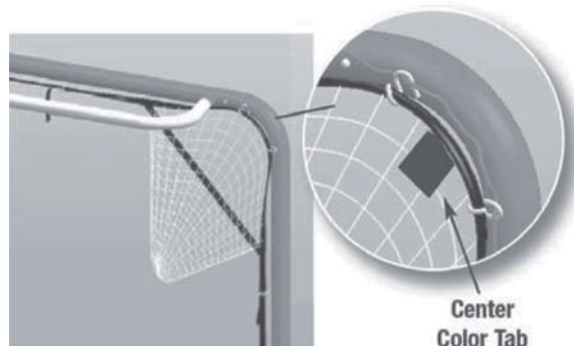
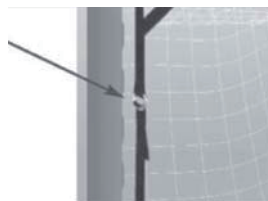

**Step 3** Attach each bottom pocket by inserting hook through the lower bracket hole from the inside. (NOTE: you may also secure the hook in the bottom of the tube). Keep the color tabs in the four corners for the purpose of alignment. Fig. 3.

Figure 3

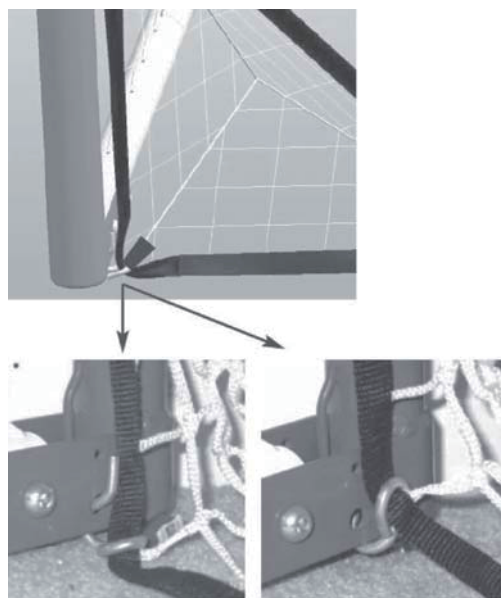

**Step 4** Remove the slack from the straps by tightening the D-rings to a snug fit. (NOTE: adjust the straps so that the pocket and color tabs are centered in the corners).

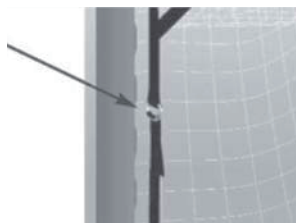

# Backstop Rebounder Kit (Fits all goals)

Make a good player a better one!

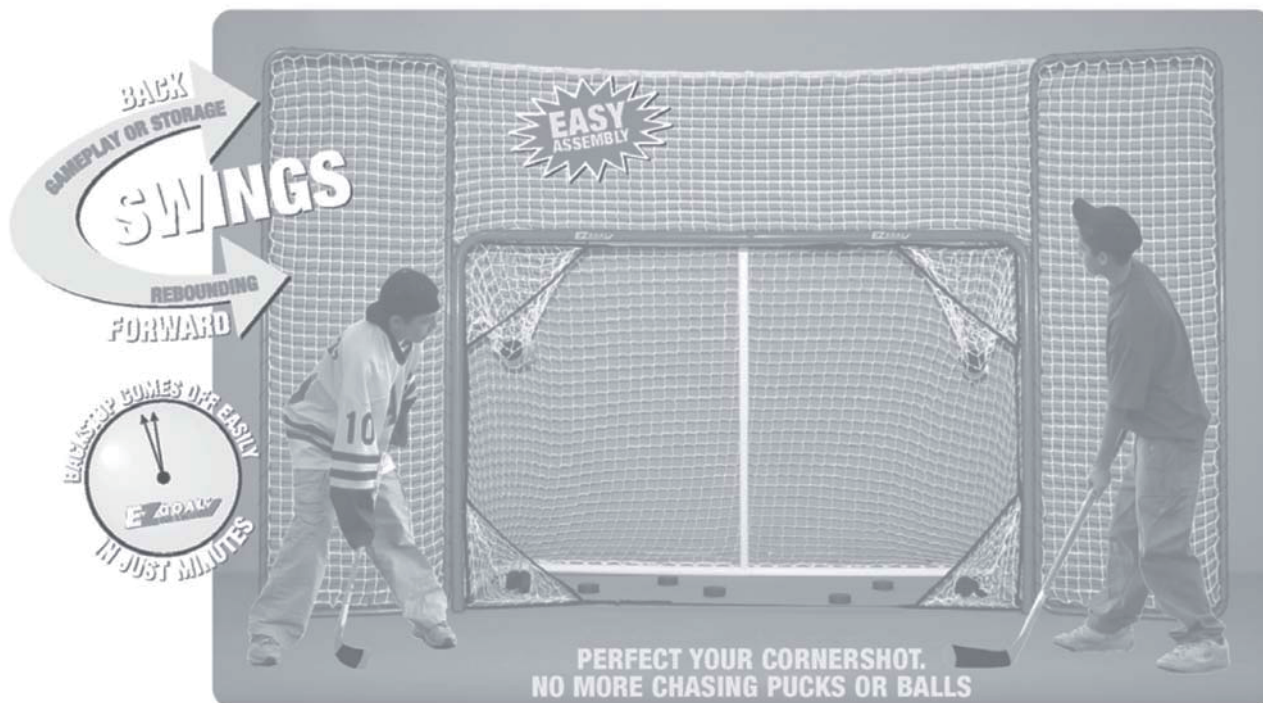

To Order the Backstop Rebounder Visit **ezgoal.net**  
**CUSTOMER ASSISTANCE**

For help, replacement parts, questions or concerns about your EZ Goal Products, EMAIL or Call

EZ Goal Sports  
 Customer Service:  
 WATERBURY, CT 06710, U.S.A.

**Service@Ezgoal.net** or 203 591 9032

## SAFETY PRECAUTIONS



### WARNING

- Manufacturer suggests wearing safety goggles for net assembly, to protect against bungee cords hitting eye.
- As with any play equipment, children **MUST** be supervised at all times.
- Use product on a level surface.
- Never use near steps or stairs.
- For outdoor use only.
- Allow 8 feet from structures such as a fence, garage, house, overhanging branches, laundry lines, or electrical wires.
- Use common sense, and all the same precautions as you would when playing sports.
- Secure unit, so high winds do not blow it over.



### WARNING

- **NEVER** allow anyone (people or pets) to stand behind the net or in any possible path of a ball or puck should you miss the net or should the ball or puck go through the net.
- Inspect unit before and during each use. Replace any worn or damaged parts.
- Never allow children to stand on unit. This could cause damage to unit and result in an injury.
- Do not use bungees for any other purposes other than to apply net.
- As with any sporting activity, always wear the recommended safety equipment.
- Never leave children unattended.
- Use protective eyewear when securing bungees.