

2" 4'x6' BACK FOLDING METAL HOCKEY GOAL



No.	Sketch	Description	Part #	Qty
1		Front End Swedged Top Rail	5038551 331	1
2		Front End Plain Top Rail	5038551 332	1
3		Left Upper Front corner	5038552 303	1
4		Right Upper Front corner	5038552 307	1
5		Red Folding Leg	5038552 304	2
6		Left Base Bend	5038551 351	1
7		Right Base Bend	5038551 352	1
8		Rear base with two swedges	5038551 341	1
9		Rear base with one swedge	5038551 342	1
10		Upper Back Support With Holes	5038551 311	1
11		Lower Back Support With Pin	5038551 309	1
12		Top Shelf Left Corner	5038551 321	1
13		Top Shelf Right Corner	5038551 322	1
14		White Lacing Rope	9141	2
15		Hockey Net 4'x6'	69115	1
16		8mm Folding section bolt	5310	2
17		8mm Self locking nut	008	3
18		Pull Pin 60mm 2-3/8"	6592	2
19		Allen wrench	018	1
20		Wrench	017	1

Installation Instructions

Please read instructions
COMPLETELY
before assembly.



**DO NOT RETURN
PRODUCT TO THE
STORE**

Missing Parts,
Need Replacements, or
Help with Assembly

Please Contact
Customer Service:

Service@ezgoal.net

203 591 9032

WATERBURY, CT 06710, U.S.A.

Note: Precision Connections will fit snugly. Use a rubber mallet or block of wood if needed.

Follow the directions

Connect the folding section and base parts together. Part 304 to parts 351 and 352.

The folding section bolts should be on the inside and in front.

The nuts should be on the outside.

Do not over tighten the nuts.

The pull pins should be in the back of the folding section.

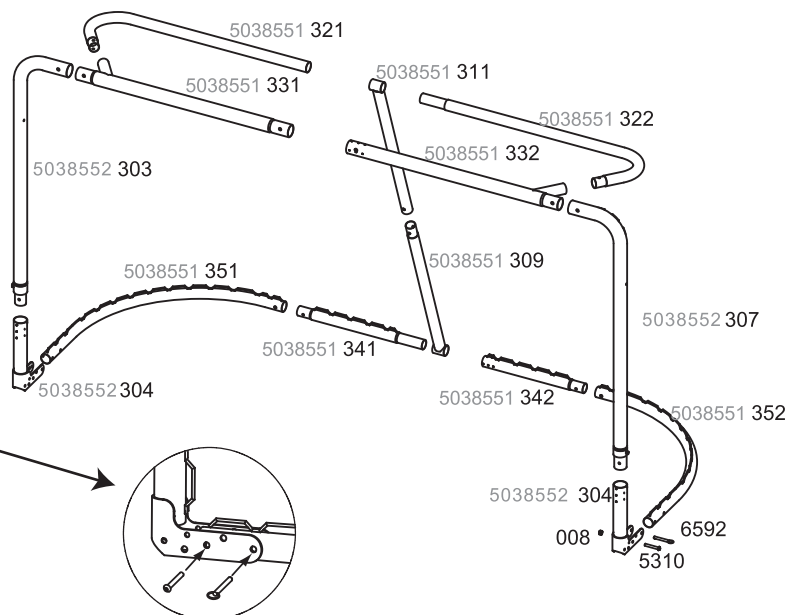

1. Begin assembly at the base of the goal and work upwards. Follow the diagram. Note: Pull pins from both folding legs and unfold. Reinsert pins to lock position prior to assembly.

2. Drape Hockey net over goal frame. Align the red tab in the center of the top and the green tab with the bottom back. Secure the six corners to align the net.

3. Starting at the red tab on top. Tie off one end of the rope to the welded wire. Lace only one loop through each square box of the goal net. Tie off with a good knots.

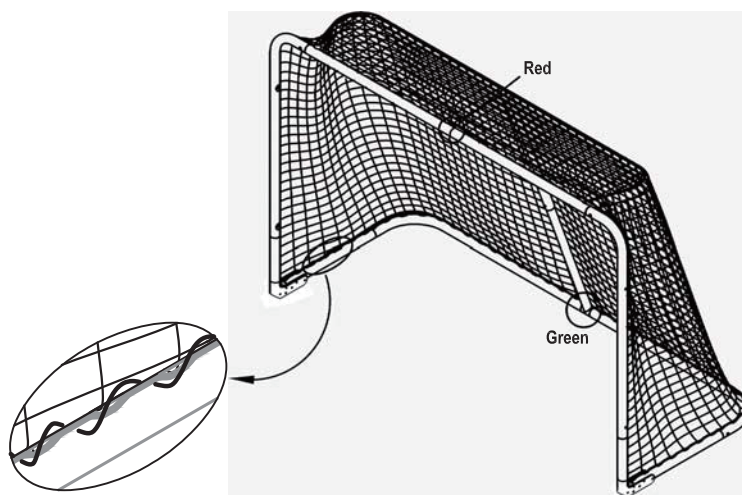

Folding & Storage

Folding & Storing goal with net attached:

1. Release the button the back bar support and pull apart.
2. Pull the pins on both folding legs
3. Press the 4 buttons on the top rail and the top shelf will fold down.
4. Lift base up and into the front of the goal. Reinsert pins on the top hole to secure base so the folded section will stay in the up position.

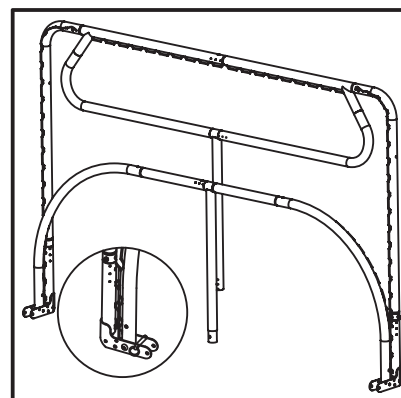
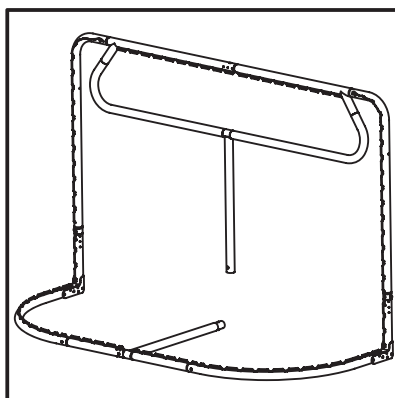

Backstop Rebounder Kit (Fits all goals)

#65121

Make a good player a better one!

#65511

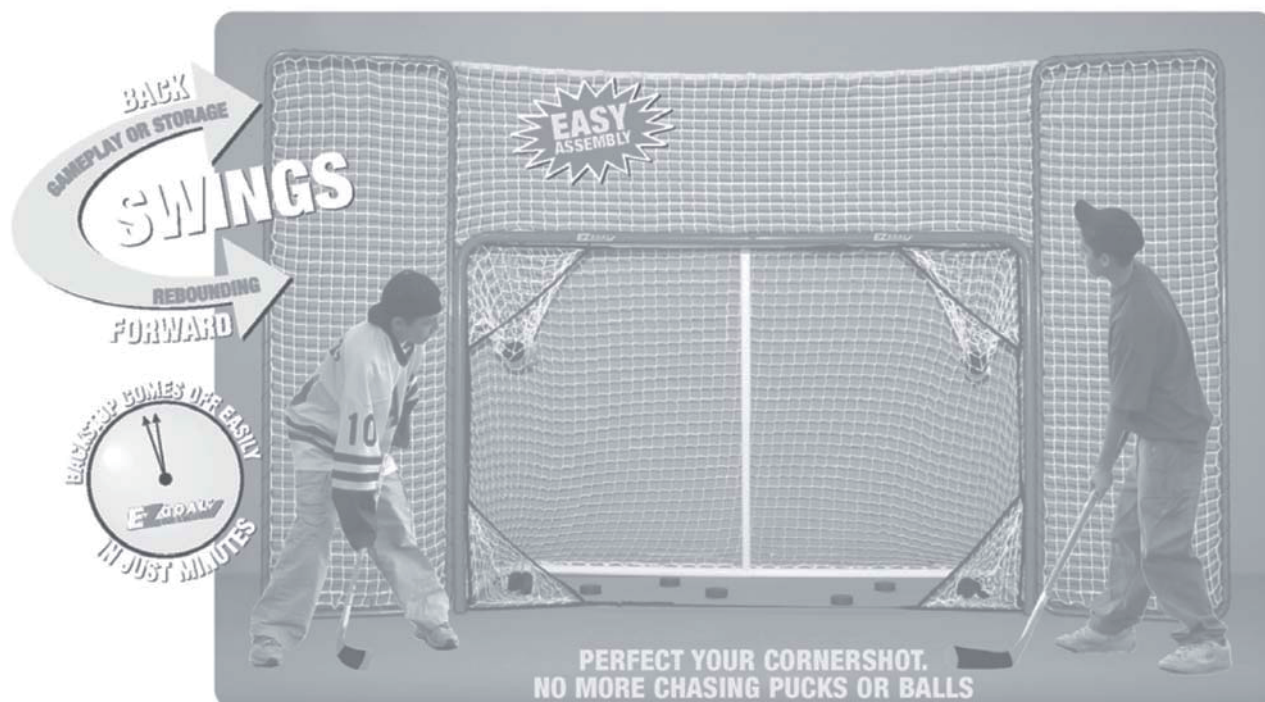

To Order the Backstop Rebounder Visit **ezgoal.net**
CUSTOMER ASSISTANCE

For help, replacement parts, questions or concerns about your EZ Goal Products, EMAIL or Call

EZ Goal Sports
Customer Service:
WATERBURY, CT 06710, U.S.A.

Service@Ezgoal.net or 203 591 9032

SAFETY PRECAUTIONS



WARNING

- Manufacturer suggests wearing safety goggles for net assembly, to protect against bungee cords hitting eye.
- As with any play equipment, children **MUST** be supervised at all times.
- Use product on a level surface.
- Never use near steps or stairs.
- For outdoor use only.
- Allow 8 feet from structures such as a fence, garage, house, overhanging branches, laundry lines, or electrical wires.
- Use common sense, and all the same precautions as you would when playing sports.
- Secure unit, so high winds do not blow it over.



WARNING

- **NEVER** allow anyone (people or pets) to stand behind the net or in any possible path of a ball or puck should you miss the net or should the ball or puck go through the net.
- Inspect unit before and during each use. Replace any worn or damaged parts.
- Never allow children to stand on unit. This could cause damage to unit and result in an injury.
- Do not use bungees for any other purposes other than to apply net.
- As with any sporting activity, always wear the recommended safety equipment.
- Never leave children unattended.
- Use protective eyewear when securing bungees.