

#87514 1.5" Lacrosse Folding Goal

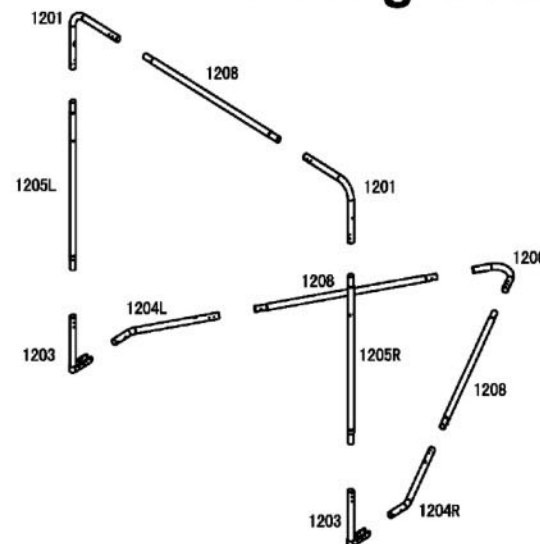

**Installation
Instructions**
Please read instructions
COMPLETELY
before assembly.



**DO NOT RETURN
PRODUCT TO THE
STORE**

**Missing Parts,
Need Placements, or
Help with Assembly**

Please Contact Customer Service:

Serivce@ezgoal.net

203.933.4442

West Haven, CT 06516



page 1

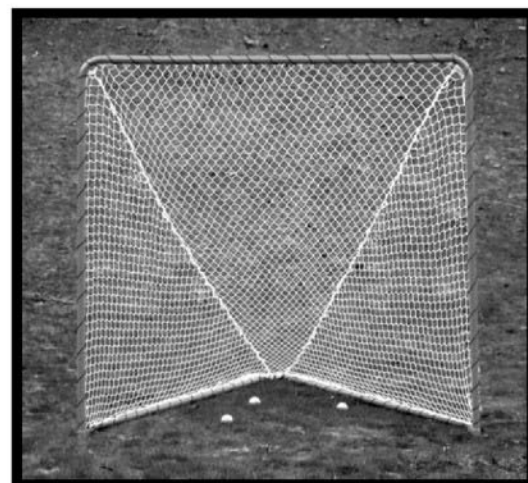

NO.	Drawing	Description	Part#	Qty.
1		Left Bottom Bent Folding Section Tube	1204L	1
2		Right Bottom Bent Folding Section Tube	1204R	1
3		Front Folding Tube	1203	2
4		Right Front Up Right	1205R	1
5		Left Front Up Right	1205L	1
6		Front Top Bent Tube	1201	2
7		Top Front & Bottom Back Straight Tube With Swedge	1208	3
8		Bottom Back Bent Tube	1206	1
9		8mm Folding Section Bolt	5310	2
10		8mm Self Locking Nut	008	3
11		Pull Pin 60mm 2 3/8"	6592	2
12		Lacrosse Net	69126	1
13		Black Rope	9171	4
14		Wrench	017	1
15		Allen Wrench	018	1

87514 Instructions 08 15 09
38mm Folding Lacrosse Goal P1



Installation Instructions
Please read instructions
COMPLETELY
Before Assembly

**#87514
15" Lacrosse
Folding Goal**

DO NOT RETURN TO THE STORE

Missing Parts Help with Assembly Need Replacement Parts

Please **EMAIL** or Call Customer Service for Assistants
Service@ezgoal.net



203.933.4442

CALL



Note: Precision Connections will fit snugly.
Use a rubber mallet or block of wood if needed.

Follow the diagrams.

Connect the folding section and base parts together.

Part 1203 to parts 1204L and 1204R.

The folding section bolts should be on the inside and in front.

The nuts should be on the outside. Do not over tighten the nuts.

The pull pins should be in the back of the folding section.

Make sure the big slot on the bottom base tube that connects to the folding section is facing up. See diagrams.

Insert the pull pins into the folding section while in the open position.

Assemble the bottom base of the goal first, then the front uprights.

Put front upright parts 1205L & 1205R in the proper locations.

Make sure the big slot is facing towards the back.

Front Net Lacing

Temporarily secure the 5 corners of the net to the frame.

Make sure the 2 center thick ropes that go from the top 2 corners of the goal to the back bottom are on the inside of the goal net before lacing.

Starting at the folding section and lace up. Securely tie off the rope.

Lace the bottom front corner box.

NOTE: Lace every 3rd net box on the straight sections

Lace every other box on the corners

Tie off with good knots. See pictures below and box front

Bottom Net Lacing.

Note: Lace every 3rd box on the straight sections.

Lace every other box on the corners

Leave about 8" of rope to tie off the pull pin.

Lace the rope around the tube and make a secure knot away from the folding section so you do not cut the rope when folding the goal

Tie off with a good knots.

See pictures and box front

Put a little Super Glue on all knots if possible, to keep the knots from coming untied.

Take the pull pin out & fold goal
Insert pin here for storage

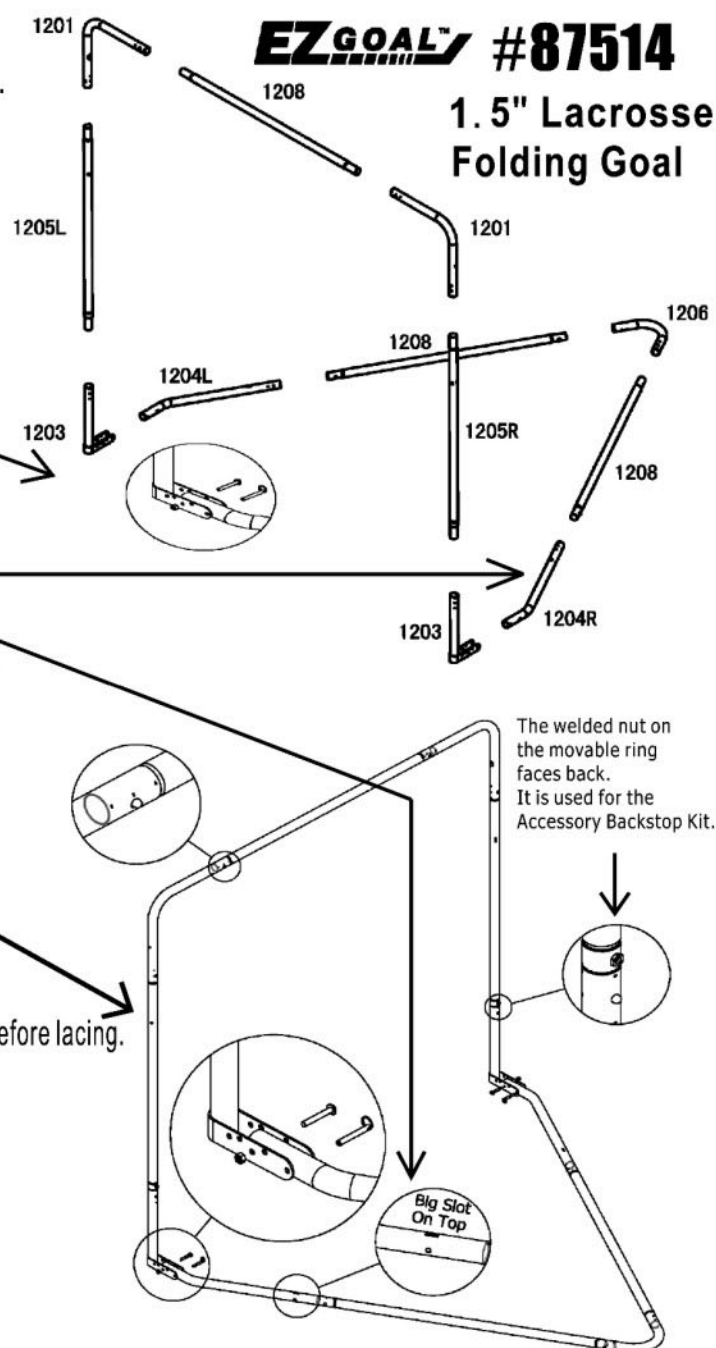

Practice Play Fold-It-Away™

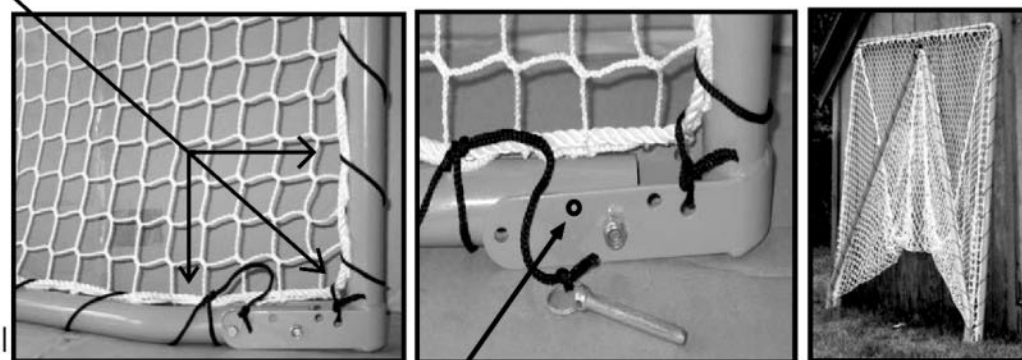

Page 2

87514 Instructions 08 15 00
38mm Folding Lacrosse Goal P2

Backstop Rebounder Kit (Fits all goals) #87514

Make a good player better one!

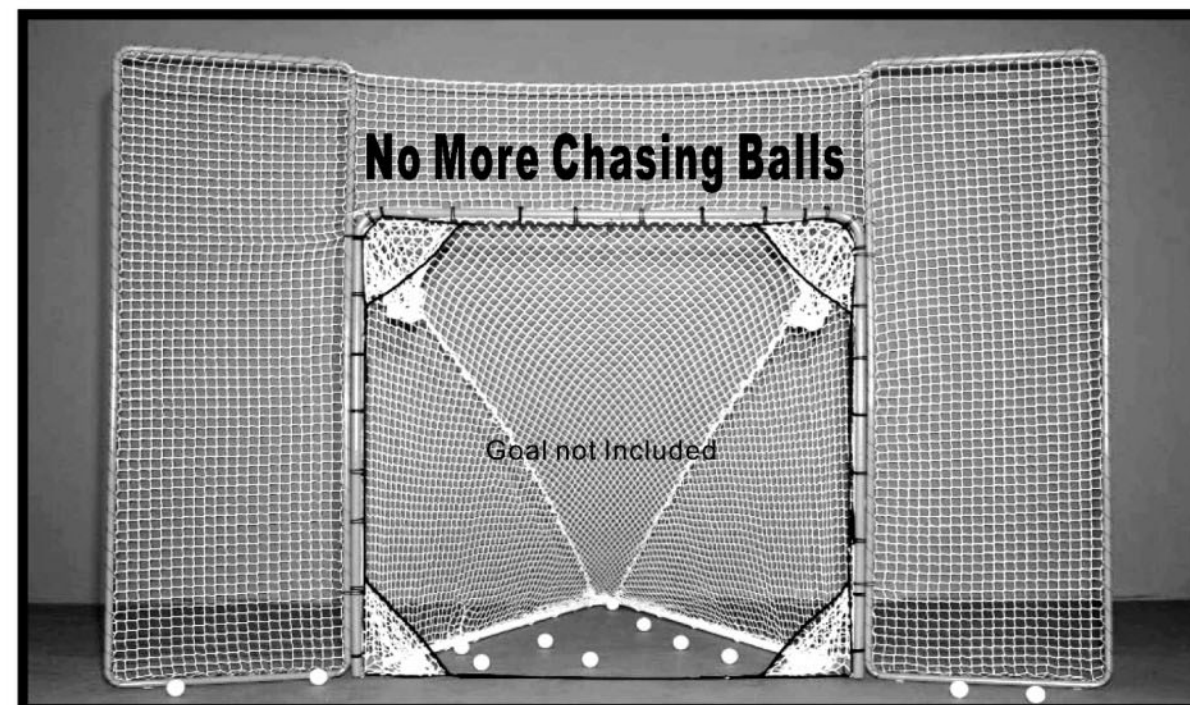

To Order the Backstop Rebounder Kit Visit **ezgoal.net**
CUSTOMER ASSISTANCE

For help, replacement parts, questions or concerns about your EZ Goal Products EMAIL or Call

EZGoal Sports
Customer Service:
West Haven, CT 06516

Service@Ezgoal.net or 203.933.4442

SAFETY PRECAUTIONS



WARNING

- Manufacturer suggests wearing safety goggles for net assembly, to protect against bungee cords hitting eye.
- As with any play equipment, children MUST be supervised at all times.
- Use product on a level surface.
- Never use near steps or stairs.
- For outdoor use only.
- Allow 8 feet from structures such as a fence, garage, house, overhanging branches, laundry lines, or electrical wires.
- Use common sense, and all the same precautions as you would when playing sports.
- Secure unit, so high winds do not blow it over.

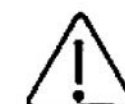

WARNING

- **NEVER** allow anyone (people or pets) to stand behind the net or in any possible path of a ball or puck should you miss the net or should the ball or puck go through the net.
- Inspect unit before and during each use. Replace any worn or damaged parts.
- Never allow children to stand on unit. This could cause damage to unit and result in an injury.
- Do not use bungees for any other purposes other than to apply net.
- As with any sporting activity, always wear the recommended safety equipment.
- Never leave children unattended.
- Use protective eyewear when securing bungees.

page 3