

51635
SOUTH
OCEAN

An aerial photograph of a beach and ocean. The left side shows a wide, sandy beach with some faint tracks. The right side shows the ocean with a wave breaking, creating white foam. The water transitions from a light blue near the shore to a deeper blue further out.

A modern expression inspired
by classic Palm Beach.

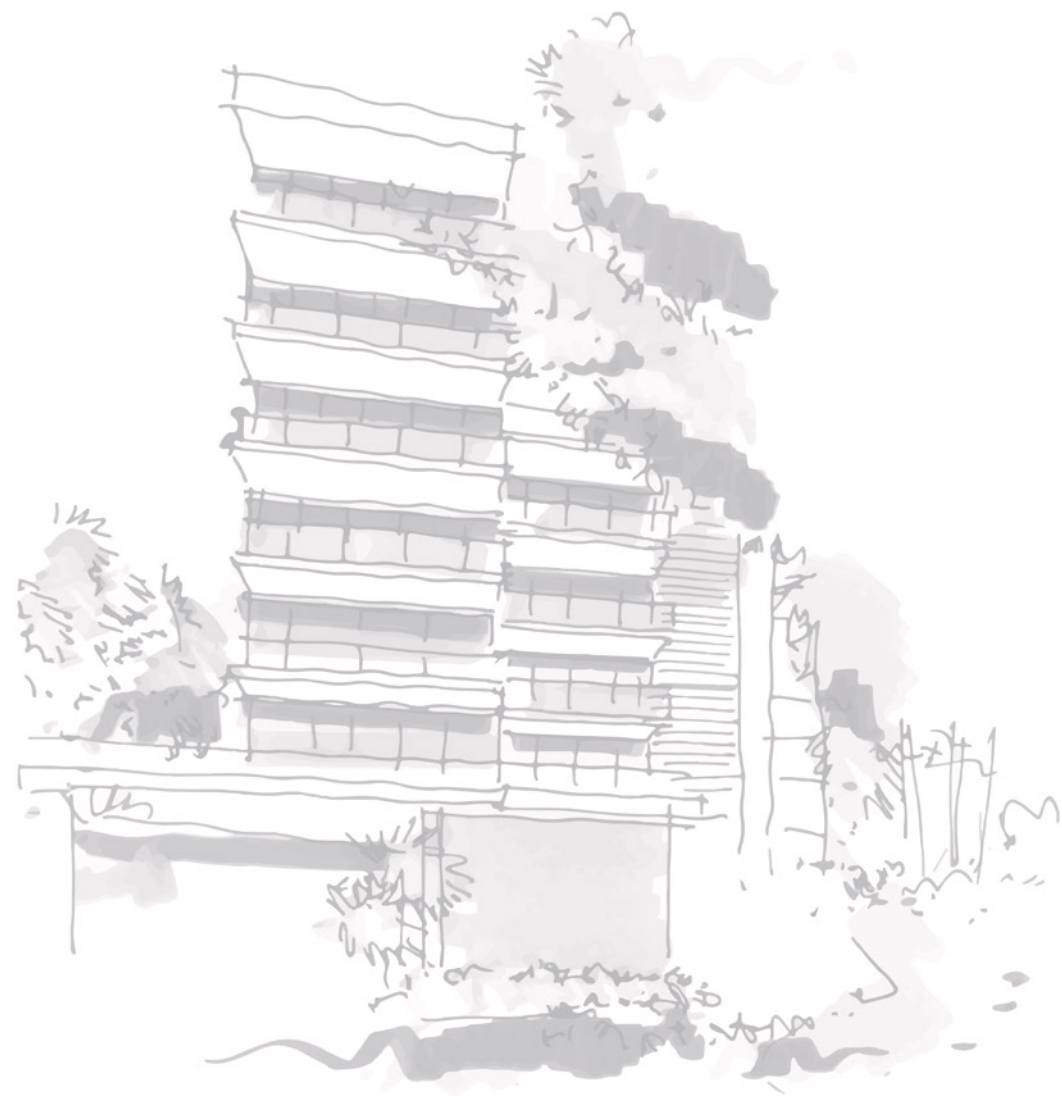

WELCOME HOME



Courtesy of the State Archives of Florida



HISTORIC. MODERN. PERFECT.





BUILDING

- Atlantic Ocean and Intracoastal Waterway views
- Two and three-plus bedroom residences ranging from 2,700 to over 3,000 square feet
- Direct elevator access to each residence
- Floor-to-ceiling glass windows and sliding doors
- Master-planned tropical landscape
- Private, gated entry and beach access



RESIDENCES

- Private balconies
- Chef's kitchens
- Imported white oak wide-plank floors
- Utility rooms with full-size high-efficiency washer / dryer

PENTHOUSE RESIDENCES

- Private balconies
- Private outdoor rooftop terraces for entertaining
- Chef's kitchens
- Imported white oak wide-plank floors
- Utility rooms with full-size high-efficiency washer / dryer













AMENITIES

- Fitness studio with natural lighting
- Beachfront pool
- Preferred partner of the Forbes Five-Star Rated Eau Palm Beach Resort & Spa
- Private parking
- Private storage
- DDG concierge services

CREDITS

Developer
DDG

Design Director
DDG

Design Architect
KOBI KARP ARCHITECTURE

Architect
GARCIA STROMBERG

Interior Design
CHAMPALIMAUD

Construction Manager
DDG

Sales & Marketing
DOUGLAS ELLIMAN DEVELOPMENT MARKETING





YOUR PIECE OF THE GOLD COAST

3550 South Ocean is a striking addition to Palm Beach's sun-kissed coastline. Contemporary and modern, it stretches east to west, maximizing ocean views, the breeze, and the sunlight.

- | | |
|------------------------------|---|
| 1 WORTH AVENUE | 9 NORTON MUSEUM |
| 2 CITY PLACE | 10 THE SOCIETY OF THE FOUR ARTS |
| 3 DOWNTOWN DELRAY BEACH | 11 EAU PALM BEACH RESORT & SPA |
| 4 RUSTICO ITALIANO | 12 THE BREAKERS |
| 5 AL FRESCO | 13 HENRY MORRISON FLAGLER MUSEUM |
| 6 JOHN G'S | 14 PALM BEACH INTERNATIONAL AIRPORT |
| 7 GOLF ON THE OCEAN | 15 PALM BEACH POLO GOLF AND COUNTRY CLUB |
| 8 PHIPPS OCEAN PARK & TENNIS | 16 PALM BEACH INTERNATIONAL EQUESTRIAN CENTER |
| GOLF COURSES | PARKS |



ORAL REPRESENTATIONS CANNOT BE RELIED UPON AS CORRECTLY STATING THE REPRESENTATIONS OF THE DEVELOPER. FOR CORRECT REPRESENTATIONS, MAKE REFERENCE TO THIS BROCHURE AND TO THE DOCUMENTS REQUIRED BY SECTION 718.503, FLORIDA STATUTES, TO BE FURNISHED BY A DEVELOPER TO A BUYER OR LESSEE. OBTAIN THE PROPERTY REPORT REQUIRED BY FEDERAL LAW AND READ IT BEFORE SIGNING ANYTHING. NO FEDERAL AGENCY HAS JUDGED THE MERITS OR VALUE, IF ANY, OF THIS PROPERTY. We are pledged to the letter and spirit of U.S. policy for the achievement of equal housing throughout the Nation. We encourage and support an affirmative advertising and marketing program in which there are no barriers to obtaining housing because of race, color, sex, religion, handicap, familial status or national origin. These materials are not intended to be an offer to sell, or solicitation to buy a unit in the condominium. Such an offering shall only be made pursuant to the prospectus (offering circular) for the condominium and no statements should be relied upon unless made in the prospectus or in the applicable purchase agreement. In no event shall any solicitation, offer or sale of a unit in the condominium be made in, or to residents of, any state or country in which such activity would be unlawful. No real estate broker or salesperson is authorized to make any representations or other statements regarding this project, and no agreements with, deposits paid to or other arrangements made with any real estate broker are or shall be binding on the developer. All artist's or architectural renderings, sketches, graphic materials, prices, plans, specifications, terms, conditions, statements, features, dimensions, amenities, existing or future views and photos depicted or otherwise described herein are proposed and conceptual only, and are based upon preliminary development plans, which are subject to withdrawal, revisions and other changes, without notice, as provided in the purchase agreement and the offering circular. They should not be relied upon as representations, express or implied, of the final detail of the proposed improvements. All improvements, designs and construction are subject to first obtaining the appropriate federal, state and local permits and approvals for same. All features listed for the residences are representative only, and the developer reserves the right, without notice to or approval by the Buyer, to make changes or substitutions of equal or better quality for any features, materials and equipment which are included with the unit. Interior photos may depict options and upgrades that are not representative of standard features and may not be available for all model types, and all depictions of furniture, appliances, counters, soffits, floor coverings and other matters of detail, including, without limitation, items of finish and decoration, are not necessarily included in each unit. Furnishings and finishes are only included if and to the extent provided in your purchase agreement. No guarantees or representations whatsoever are made that existing or future views of the project and surrounding areas depicted by artist's conceptual renderings or otherwise described herein, will be provided or, if provided, will be as depicted or described herein. Any view from any unit or from other portions of the property may in the future be limited or eliminated by future development or forces of nature. The photographs contained in this brochure may be stock photography or have been taken off-site and are used to depict the spirit of the lifestyle to be achieved rather than any that may exist or that may be proposed, and are merely intended as illustrations of the activities and concepts depicted therein.



3550 South Ocean Blvd.
Palm Beach, FL 33480





Jacqueline Zimmerman

Specializing in the Finest Palm Beach Properties | Committed To Finding You Exactly What You Want

Palm Beach Island, In Town, Estate Section, North End, South Condos, Palm Beach, FL 33480, US

+1 561-906-7153

jacqueline.zimmerman@elliman.com

<https://folio.elliman.com/jacqueline-zimmerman>

Jacqueline and Adam Zimmerman specialize in the finest luxury properties on the Island of Palm Beach. For over 12 years, the high-powered brother and sister duo have lived on the Island and mastered the art of bringing Palm Beach buyers and sellers together to generate years of successful real estate transactions. They are intimately familiar with the Palm Beach lifestyle as well as passionate about Palm Beach real estate. In 2010, they founded the Distinctive Palm Beach Properties team and developed a state-of-the-art real estate website, DistinctivePalmBeachProperties.com, to assist clients in quickly and more efficiently locating the perfect property. The website, updated continuously throughout the day, facilitates client search, showcases unusual investment opportunities, and provides a window into the Palm Beach lifestyle. The website remains one of Palm Beach's best, most frequently visited real estate websites. Prior to working in real estate, Jacqueline worked as an investment banker and as a corporate risk analyst at Merrill Lynch in New York, after graduating from Columbia Business School with an MBA in Finance. The high level analytical and organizational skills she gained working on Wall Street, serves her well in identifying real estate value investment opportunities for her clients, as well as marketing and pricing luxury properties. In 2006, Adam transitioned from a career as a stockbroker with a Wall Street Investment firm to becoming a Realtor with Martha A. Gottfried, Inc. (now Douglas Elliman). His many accomplishments in sales include the PIMCO Chairman's Award, as well as a record-setting sale in the South Condos for the highest price per square-foot* in the area. The recent sale doubled the highest price paid for a condominium in the building just a year and a half before, setting a new pricing level. The Zimmerman's business background combined with their in-depth knowledge of the local market enables them to provide accurate, up-to-date market information, expert advice, and unparalleled investment opportunities for their clients. The team monitors the MLS throughout the day, to bring clients the very latest in information, pricing and investment analysis. The Distinctive Palm Beach Property team's contacts extend from the U.S. and Canada to Europe, including the UK, Italy, Germany, Switzerland and France. Whether clients are looking for a romantic seaside home or a modern condo with sweeping Ocean views, Jacqueline and Adam are committed to finding clients exactly what they want. In their time-off, both Jacqueline and Adam enjoy salt-water fly-fishing, traveling and contemporary art. Jacqueline, a commercial pilot, enjoys flying her brother Adam to the less-traveled reaches of the Bahamas to explore the fishing wilderness.

Languages I speak

English

I can advise you on:

- Condominiums
- Luxury Homes
- Rental
- Vacation Homes
- International Buyers
- New Construction
- Resort & Second Homes
- Investment Property
- Oceanfront Homes
- Townhomes

<https://www.facebook.com/DistinctivePalmBeachProperties/>

<https://www.instagram.com/distinctivepalmbeachproperties/>

Jacqueline Zimmerman
+1 561-906-7153