



# KLJ

KLJ-Home use elevator





Open the era of elevator home appliance



### CANNY ELEVATOR home series elevator

Break the traditional structure, create more spatial possibilities;  
Multiple security protection, give families more care;  
Green and energy-saving technology, open the era of elevator home appliance.

(Machine roomless shaft)



Gantry structure

220V 1.1KW  
220V household power supply, 1.1 KW low power consumption



Free layout break up the whole into parts  
Experience the worship above architecture

**More advanced (machine roomless structure)**

Excellent elevator performance, unique structure experience. Small occupation area, low civil requirements, can meet the needs of different types of villa structure.

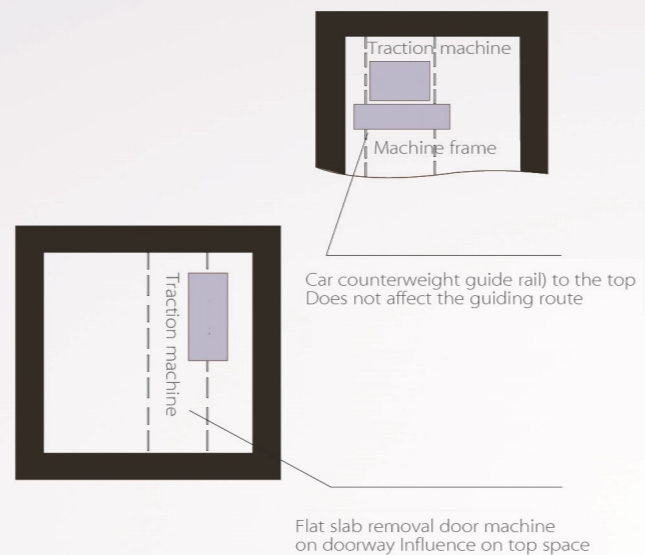

**More convenient installation structure of the main machine**

> Main machine installation, eliminate reserved holes, simple installation, free to enjoy.

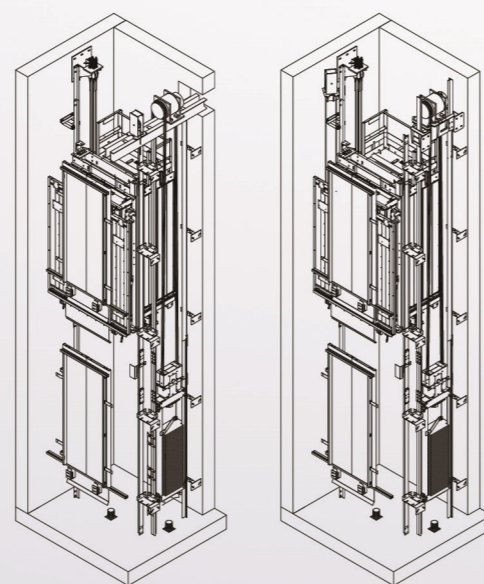

**Compact layout**

> Higher utilization; release family space, reserve for your life design taste.



Flexible space layout

Fashion appliance

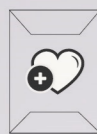

Smart living, free lifting  
Comprehensively care for you and your family



Smooth operation system

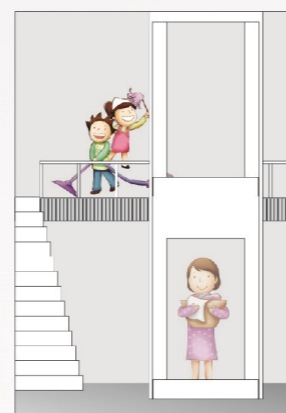
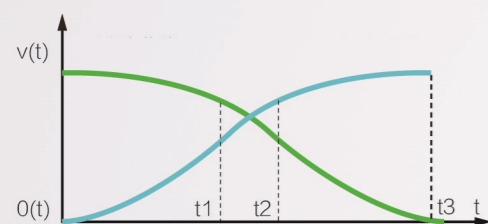

### Permanent magnet synchronous door machine system

- > Optimized S-curve and smooth opening and closing operation of elevator door can effectively reduce operating noise, and create a more comfortable home environment.
- > High-sensitive light curtain door protection can effectively prevent jam accidents of the elderly in wheelchairs and small children.
- > Smooth operation system specially designed for the elderly and children has the most comfortable speed running curve, ensure a smooth and stable starting.
- > Integrated control cabinet combined industry control technology with communication technology is adopted, closed design of entire steel plate, can achieve convenient maintenance.

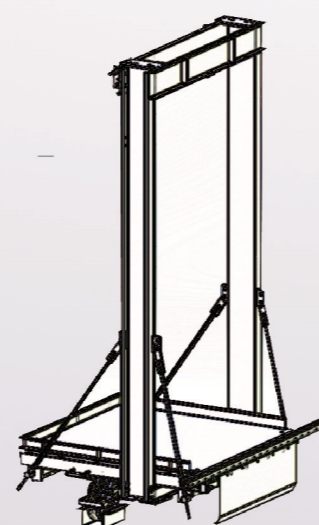

### More stable gantry rod structure

- > Gantry car frame with rod structure, double stable structures to make the car running more comfortable and steady.





All LED lighting system

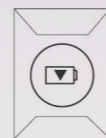

Home appliance era energy-saving storm  
Pay the greatest sincerity to future life



All LED lighting system

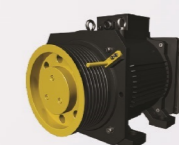

40% ↓

### Energy-saving design

- > Use permanent magnet synchronous gearless traction machine, can save energy by more than 40%, and a lot of electricity fee for you.
- > All LED lighting system, low maintenance rate, long service life, can save energy by nearly (60%) than ordinary lamps.
- > In case of no one using the car, the lighting system and the fan will automatically shut down. Reopen upon receiving call command, can effectively reduce your household consumption.



LED

### Energy-saving home appliance

- > 220V household power supply, 1.1KW low energy consumption for braking, power consumption is far less than that of other electrical appliances such as refrigerator, become your true energy-saving appliance.

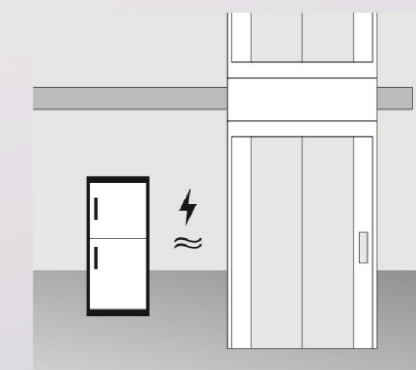



Standard design

### KL/J3-001

Ceiling: KL/DD-4004, dusting steel plate, middle supporting small hole, LED light source  
Car wall: Hairline stainless steel

Front wall: Hairline stainless steel

Control box: KL231C, Hairline stainless steel  
Car door: Hairline stainless steel

Floor: Monochrome PVC

Flooring angular line: Hairline stainless steel



Scan the QR code to know more about the lift car in the 360-degree manner



KL231C

Display screen

One-key Dialing Telephone:  
The telephone is designed for home elevator. By pressing the talk-listen button, the preinstalled phone number will be dialed. At the same time, it can answer phone calls

Circular micro-trip button

Hairline stainless steel

Integrated operation panel



KL J-Home series elevator



### LED lighting design

Has advantages such as stability, low temperature, no radiation, long service life, etc



Integrated operation panel  
Elegant and generous appearance, simple but fashionable design



Scan the QR code to know more about the lift car in the 360-degree manner

### KL/J3-002

Ceiling: KL/DD-4004, dusting steel plate, middle supporting small hole, LED light source  
 Car wall: Hairline stainless steel, wood plastic coated steel plate  
 COP: KL231C, Hairline stainless steel  
 Car door: Hairline stainless steel  
 Floor: KLJUDJ-4001, monochrome PVC  
 Flooring angular line: Hairline stainless steel  
 Handrail: KL-FS 001



Scan the QR code to know more about the lift car in the 360-degree manner

### KL/J4-001

Ceiling: KL/DD-3001 Wooden frame, mirror stainless steel, LED light source  
 Car wall: Wood veneer, wooden line modeling, beauty mirror, wallpaper  
 Front Wall: Stainless steel mirror  
 COP: KL-330, mirror stainless steel  
 Car door: Stainless steel mirror  
 Floor: Marble mosaic  
 Flooring angular line: Wooden paint



Scan the QR code to know more about the lift car in the 360-degree manner

### KL/J4-002

Ceiling: KL/DD-3002 Wooden paint, gold foil, LED light source titanium mirror stainless steel  
 Car door: Titanium mirror stainless steel  
 Floor: PVC printing  
 Flooring angular line: Wooden paint  
 Handrail: KL-FS 012



Scan the QR code to know more about the lift car in the 360-degree manner

### KL/J4-003

Ceiling: KL/DDJ-4005, Stainless steel mirror, acrylic, LED light source  
 Car wall: Hairline stainless steel, stainless steel mirror, decorative painting, marble  
 Front wall: Stainless steel mirror  
 COP: KL231C, Hairline stainless steel  
 Car door: Mirror stainless steel  
 Floor: Marble mosaic  
 Flooring angular line: Stainless steel mirror



Scan the QR code to know more about the lift car in the 360-degree manner

### KL/J4-005

Ceiling: KL/DDJ-4003, Wooden frame, LED light source, light belt  
 Back wall: Wood veneer, decorative picture, PVC wallpaper, wooden wire frame  
 Side wall: Wood veneer, stainless steel mirror  
 Front wall: Stainless steel mirror  
 COP: Titanium-made handrail type maneuvering box  
 Car door: Mirror stainless steel  
 Floor: Printing PVC  
 Flooring angular line: Wood finishes



Scan the QR code to know more about the lift car in the 360-degree manner

### KL/J4-006 For Extra Interior Finishing

Ceiling: KL/DDJ-4002, dusting steel plate (be gray), long-shaped LED light source  
 Car wall: dusting steel plate (be gray), users prepares for secondary decoration  
 COP: KL-330  
 Floor: Printing PVC  
 Flooring angular line: Hairline stainless steel

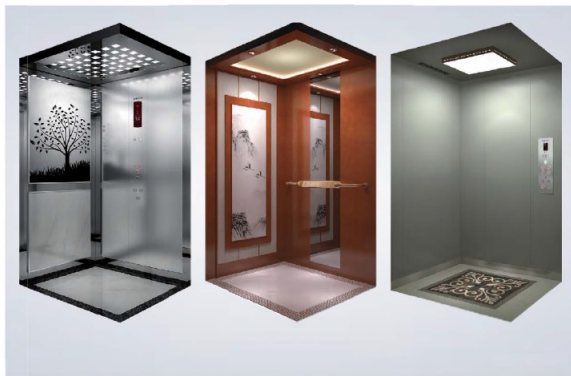



## Ceiling optional design



**KL/DDJ-4002**

Car-top plate: Dusting steel plate  
Lighting: Long-shaped LED light source



**KL/DDJ-4003**

Car-top plate: Wooden frame, dusting steel plate  
Lighting: LED light source, light belt



**KL/DDJ-4004**

Car-top plate: Baking varnished wooden board and lines  
Lighting: LED light source, light belt



**KL/DDJ-4005**

Car-top plate: Mirror stainless steel  
Lighting: Transparent acrylic lamppost, LED light source



Scan the QR code to know more about the lift car in the 360-degree manner



Scan the QR code to know more about the lift car in the 360-degree manner



Scan the QR code to know more about the lift car in the 360-degree manner

### KL/J6-055

Suspended ceiling: laquering board,  
LED lighting Cabin wall: Wood decorative  
painting, wooden molding, decorative  
painting, tawny glasses  
Armrest: solid wood  
Floor: composite panels in thin marble  
Front wall: bronze mirror finishing

### KL/J6-057

Suspended ceiling: Powder coating plate,  
mirror finishing decorative strip, LED  
lighting  
Cabin wall: Primary color mirror, wood  
finishes, decorative painting  
Armrest: flat-rolled Steel  
Floor: composite panels in thin marble  
Front wall: short-drawn hairline finishing

### KL/J6-058

Suspended ceiling: laquering board, bronze  
hairline finishing, gold foil, LED lighting  
Cabin wall: Capele veneer, bronze mirror  
finishing, bronze hairline finishing, decorative  
painting  
Armrest: bronze hairline finishing, Capele  
Floor: composite panels in thin marble  
Front wall: bronze mirror finishing

### PVC Floor (optional)



KLJJD-4001



KLJJD-4002

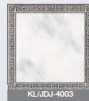

KLJJD-4003

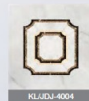

KLJJD-4004



KLJJD-4004



KLJJD-4006

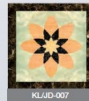

KLJJD-007

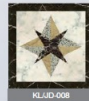

KLJJD-008





## Optional design of man-machine interface



## Integrated operation panel



## Calling Indicator Without Bottom Box



## Embedded operation panel



## Dusting color standard (optional)



## Landing door series

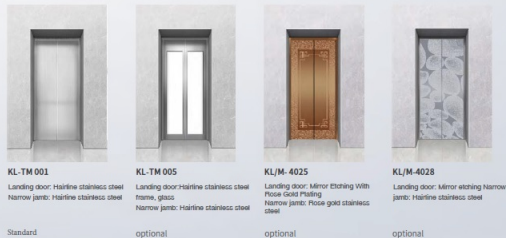

| Model    | Panel material           | Button                   | Display screen                | Ranking number     |
|----------|--------------------------|--------------------------|-------------------------------|--------------------|
| KL232C   | Hairline stainless steel | Square micro-take button | Dot matrix display screen     | 2-5 parking floors |
| KL233C   | Hairline stainless steel | Pound micro-take button  | Liquid crystal display screen | 2-5 parking floors |
| KL234C   | Hairline stainless steel | Square micro-take button | Liquid crystal display screen | 2-5 parking floors |
| KL235C   | Hairline stainless steel | Pound micro-take button  | 7" TFT-LCD                    | 2-5 parking floors |
| KL236C   | Hairline stainless steel | Square micro-take button | 7" TFT-LCD                    | 2-5 parking floors |
| KL233-1C | Hairline stainless steel | Pound micro-take button  | Liquid crystal display screen | 2-5 parking floors |
| KL234-1C | Hairline stainless steel | Square micro-take button | Liquid crystal display screen | 2-5 parking floors |
| KL233-2C | Hairline stainless steel | Pound micro-take button  | Liquid crystal display screen | 2-5 parking floors |
| KL234-2C | Hairline stainless steel | Square micro-take button | Liquid crystal display screen | 2-5 parking floors |



Handrail optional design

Handrail (optional)



KL-FS 001

Stainless steel hairline mono-tube



KL-FS 002

Titanium gold mirror stainless steel mono-tube



KL-FS 009

Short grain stainless steel, arc head



KL-FS 010

Short grain titanium gold stainless steel, arc head

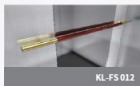

KL-FS 012

Combination of round wood and titanium gold



KL/FSJ4-007

Combination of round wood and mirror stainless steel

Stainless steel color standard (optional)



Hairline stainless steel

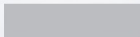

Mirror stainless steel



Etched hairline stainless steel

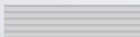

Mirror etched stainless steel



Titanium gold hairline stainless steel



Titanium gold mirror stainless steel

Plastic steel plate color sticker (optional)



A119

Gold sand pattern



B103

Red wood



B107

Dark teak



B125

Black sandar



C102

Rosewood



C127

Platinum wire

H frame home elevator construction layout

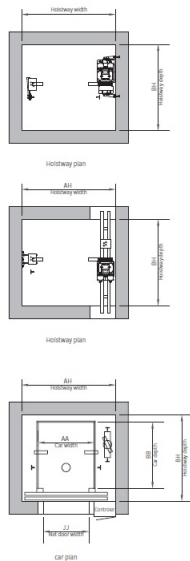
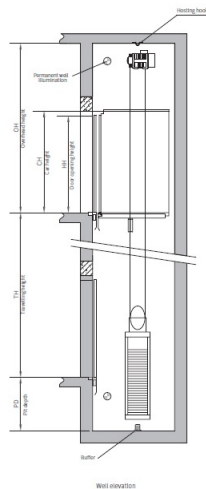

H frame home elevator specification

| (Kg)             | (m/s)       | (mm)               | (mm)               | (mm)                | Car size |      | Hoistway size |      | (mm)            | (mm)      | Steps | (m)                   |
|------------------|-------------|--------------------|--------------------|---------------------|----------|------|---------------|------|-----------------|-----------|-------|-----------------------|
| Loading capacity | Rated speed | Door opening width | Door opening width | Door opening height | W        | D    | W             | D    | Overhead height | Net depth |       | Max travelling height |
| 250              | 0.4         | 800                | 700                | 2000                | 900      | 1060 | 1650          | 1650 | 1100/2000       | 300x600   | 5     | 12                    |
|                  |             |                    | 650                |                     | 960      | 1400 | 1400          |      |                 |           |       |                       |
|                  |             |                    | 800                |                     | 1100     | 1850 | 1500          |      |                 |           |       |                       |
| 330              | 0.4         | 700                | 800                | 1050                | 1000     | 2100 | 1500          | 1500 | 3200            | 300       |       |                       |
|                  |             |                    | 800                | 1100                | 1300     | 1700 |               |      |                 |           |       |                       |
| 400              | 0.4         | 700                | 800                | 1100                | 1200     | 1600 | 1600          | 1700 |                 |           |       |                       |
|                  |             |                    | 700                | 1150                | 1200     | 1400 | 1700          |      |                 |           |       |                       |

Remarks: First line is C.W. side drop, second line is C.W. rear drop.

- **Safety loop protection**

Protection switch of various safety devices compose the safety loop. When safety loop disconnects, the elevator stops immediately.

- **Brake detection protection**

Brake arm detection switch executes real-time monitor to brake opening / closing. If the brake does not open as per the requirements, the system will not allow the elevator start.

- **Light curtain protection**

In the process of door shut, when anybody / object that enters into / exit from the elevator car hinders light curtain, the door re-opens or keeps open.

- **Protection of none door opening outside door zone**

Automatic door opening is forbidden under none door zone condition.

- **Overspeed protection**

The protection functions to prevent the speed from exceeding the controlled range and causing any safety problem(s).

- **Prompt of overload alarm**

Before the elevator shuts the door, if it detects overload signal, overload buzzer rings. It alarms and brightens overload indicating lamp. After it removes overload problem, it re-starts automatically.

- **Automatic parking in trouble**

When the elevator stops in none leveling zone due to any trouble, if it is not caused by safety device action, it executes self-rescue running towards the middle floor direction at low speed. It parks and opens the door at the nearest service floor to prevent from any trapping accident.

- **Emergency car lighting**

When power supply disconnects, emergency lamp at the car ceiling or in the operation box brightens automatically.

- **Home landing elevator locking**

When the elevator is under automatic condition, after it shuts home landing locking switch, the elevator will complete all the registered car command services, automatically return to home landing, it enters into parking condition. As soon as locking switch opens, it immediately exits from parking condition and throws into normal running.

- **Full selective collective running**

Waiting hall has one up and down calling button respectively. It automatically judges the elevator running direction according to the car command and landing calling. It responds various car commands and landing calling signals one by one from up to down sequence.

● standard function ● free optional ● charged optional

- **Cancel the error-register**

If the passenger presses the car command button at certain floor and has registered it by mistake, (by then the car indicating lamp is bright), under the condition of none elevator running, you only require to press the car command button at the same floor to cancel the register. (By then the car indicating lamp dies out.)

- **Automatic stop of the car lighting and fan**

If nobody uses the elevator within certain period of time, the car lighting and fan shut off automatically. It re-opens at receiving any landing calling command(s).

- **Full-load straight travel**

When the car load exceeds 80% of load rating, it does not respond any landing calling. It only responds the car command(s).

- **Automatic correction of floor signal**

If the floor display position has error, after the system detects terminal switch in the travel, it will automatically correct the floor display.

- **Cancel reverse command(s) in the car**

When the elevator travels to the farthest floor and changes the speed, it removes all the car command register.

- **Self-diagnostic embedded calling button**

If press calling button at certain landing for over 20 second, then it still does not disconnect, the system assumes that it is embedded button. It does not register the landing calling of the same floor afterwards. Responsive lamp which corresponds to the button keeps flickering and alarming. When the button disconnects, it exits from above condition.

- **Automatic return to home landing**

In no-operator running, if automatic return function to home landing is still effective, when no-landing calling signal time fulfills preset time, the elevator returns to home landing automatically.

- **Car arrival gong**

Arrival gong at the car top reminds the passengers in the car and those waiting in the hall that the elevator comes.

- **Automatic emergency leveling travel**

In case of power cut, automatic emergency leveling device will generate power and support the elevator to reach the nearest landing floor, open the door after leveling, let passengers get out the car safety.

- **Re-leveling function**

If the elevator parks at the current floor, when too much passengers enter into / leave the elevator, because wire rope extends or shortens, the car is separated from the leveling zone. The elevator will then travel to the leveling position at low speed under the condition of door-opening.