

January 2025

Smith Elementary offers unique design challenges with its colorful tubes and concrete walls. The school's design team has worked with CSO to modernize the design of each of the classroom pods and improve visibility and wayfinding with the ribbed metal tubes.

PROJECT HIGHLIGHT: L. FRANCES SMITH ELEMENTARY



Proposed corridor design



Rendering of tube improvements

R. L. JOHNSON EARLY EDUCATION

Phase 1 work is wrapping up and will be ready for occupation in the spring semester. Phase 2 documents are complete and are in the process of bidding. Construction on that phase is slated to start in January and be completed for the start of the 2025-2026 school year.



Renovated classroom

L. C. SCHMITT ELEMENTARY



Rendering of learning commons

Construction is ongoing at the new main office, and work has begun on the addition. Students are now using the first round of completed classrooms, and the new main reception has relocated to its final location facing 27th Street.

NEW ELEMENTARY #12

Schematic design and programming has concluded. The shell of the building remains in design, as does the site. Once these designs have progressed, design architect Höweler + Yoon will finalize a concept for construction documentation. The project is expected to break ground this summer.

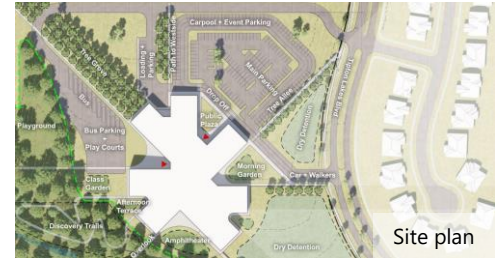

Site plan

L. FRANCES SMITH ELEMENTARY

The existing footprint at Smith will be modified to provide each classroom pod with a learning commons. Teachers and staff can bring students into the shared space for collaboration, enrichment, or remediation purposes.



Rendering of learning commons

CENTRAL MIDDLE

Central MS is set to receive a media center face lift, as well as a new wellness area. A new maker space – designed to support students and staff with their creative endeavors – will also be part of the project, as will upgrades to classroom technology.

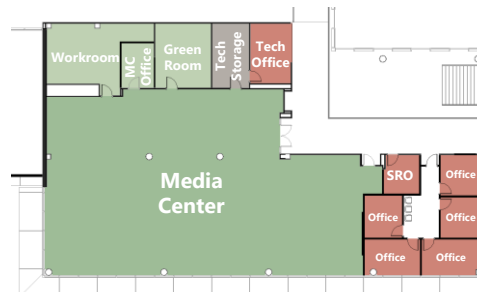

NORTHSIDE MIDDLE



Rendering of learning commons

Northside MS has moved into the construction documents phase. The project aims to improve building circulation, safety, and access for students. Each of the school's six teams will have their own corridor with a commons area, restrooms, small group rooms, and staff support spaces. Construction is expected to begin in May.

COLUMBUS EAST HIGH

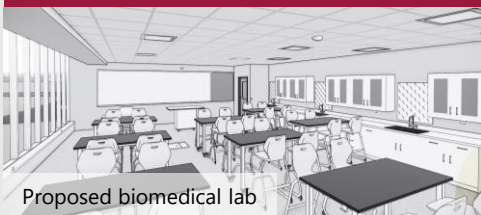

Proposed biomedical lab

C4 Health Science Occupations classrooms will be overhauled as part of an interior renovation project. One biomedical lab is to be renovated, and a second will be created. Two new C4 labs and four adjoining classrooms for those spaces are also included in the scope of work. New, mobile furniture is planned for the rooms to allow for improved flexibility.

MT. HEALTHY ELEMENTARY



Existing open-concept classrooms

CSO has met with building principal, Dana Bodart, and district administration to discuss the existing design of the building and begin preliminary planning. A design committee has been committed and will commence building tours and design meetings in January 2025.

COLUMBUS NORTH HIGH

The C4 program at Columbus North is receiving a new, expanded biomedical lab on the second floor of the building. The lab will combine their current classroom with a storage room to provide additional square footage for lab tables and equipment.

The project is being bid and constructed in tandem with the Northside Middle project and will provide some much-needed elbow room for the C4 program.