

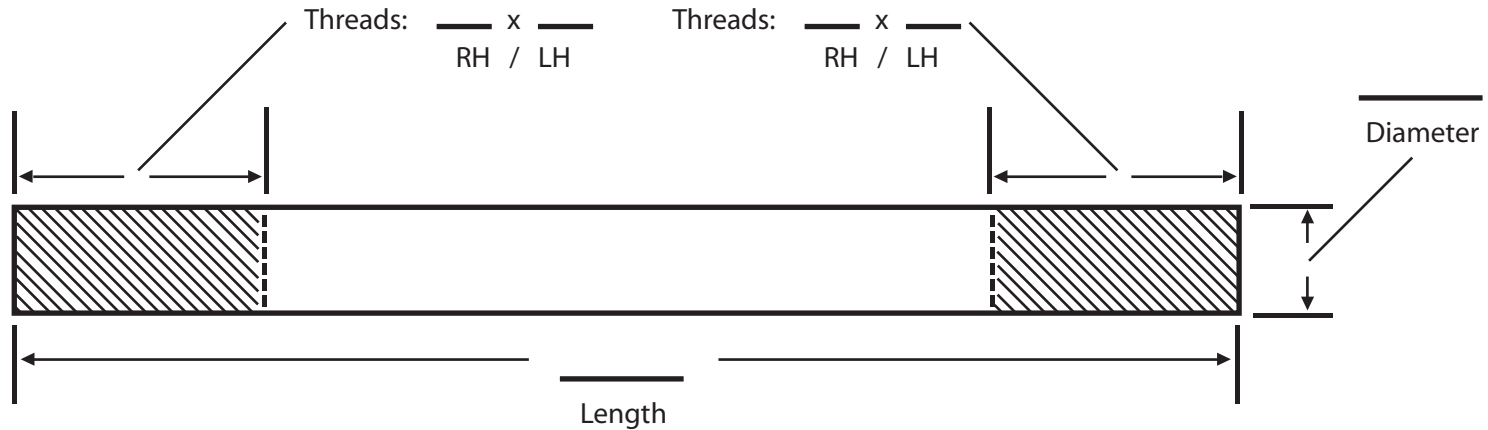

Part Description: Double End Rods
Part #: _____
Material: _____



Thread Type: _____
(UNC, UNF, ACME, Metric/Pitch, etc.)

Special Services: _____

Finish: _____

Other Requirements: _____

Company Name: _____
Customer Approval: _____ (signature)
Name: _____
Title: _____
Today's Date: _____
Date Required: _____

Palo Verde Five LLC

1050 N Fairway Dr B111
Avondale AZ 85323
PH: 623.215.2922 FAX: 623.215.2148
sales@paloverdefive.com

1. All prints must be signed and approved before production begins.
2. Specials cannot be returned unless the fault of manufacturer.