



MINI TANK 6 GAL

MINI TANK

The Mini Tank is specifically designed to dispense hot water in places where the lack of hot water lines or the distance of the water outlet makes difficult the installation of a regular water heater.

The minitank is a very practical solution for these cases
These are some of the places where this water heater can be used:

- Hairdresser's
- Office Buildings
- Gas Stations
- Campers
- Restaurants
- Medical or Health Center
- Hotels/Motels.
- Restrooms in overall housing where the hot water path is long.
- Others.

Mini Tank Series
UL Approval



SPECIFICATIONS

General Characteristics	6g
Color:	Stainless Steel
Orientation:	Vertical
Models:	EMT – 6
Capacity net:	5.4 Gal
Wattage:	1500W
Amperage:	12 A
Maximum temperature:	131°F
Recovery Time: ($\Delta T: 72^\circ F$)	28 min
Voltage:	120V
Max Work Pressure:	100psi
Test Pressure:	150psi
T & P Relief Valve:	150psi/210°F



MINI TANK 6 GAL

CONNECTIONS

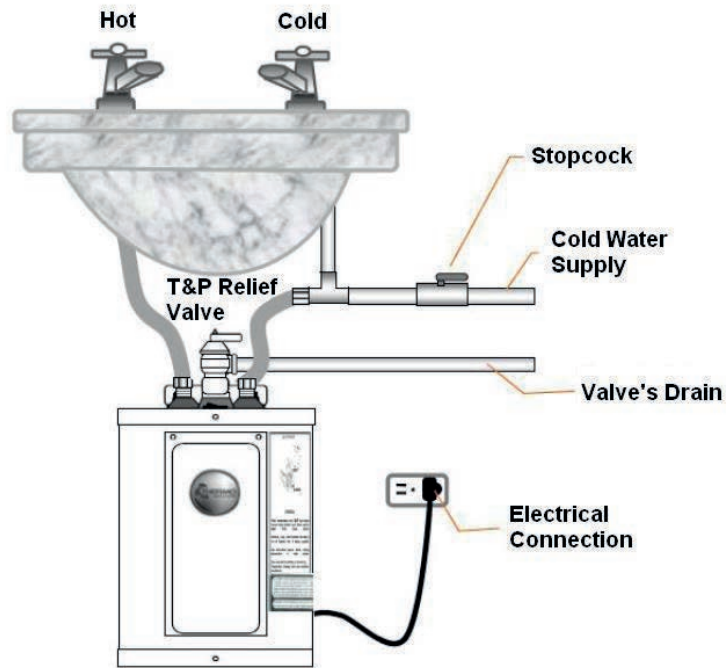

DIMENSIONS

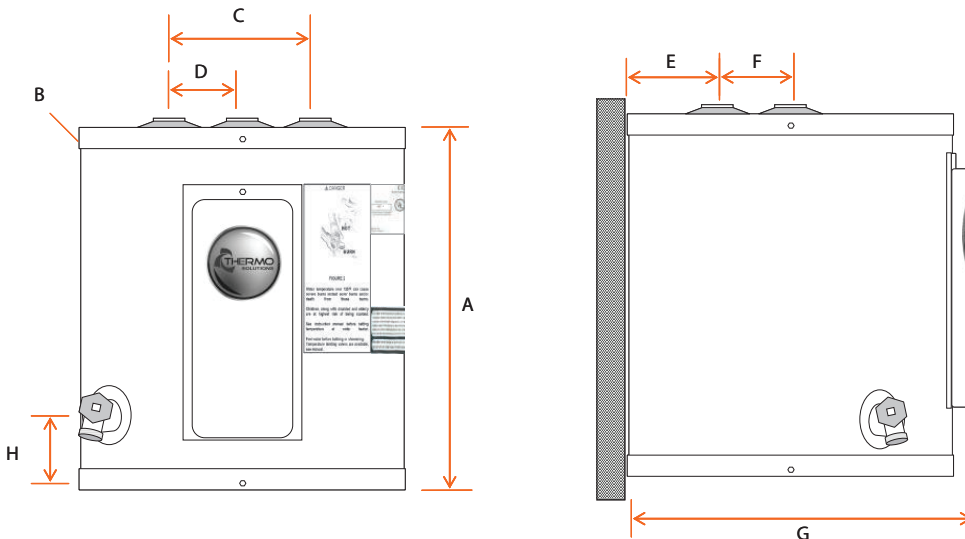

	EMT6
A	14.57"
B	13.58"
C	6.30"
D	3.15"
E	3.64"
F	3.15"
G	14.17"
H	3.35"