

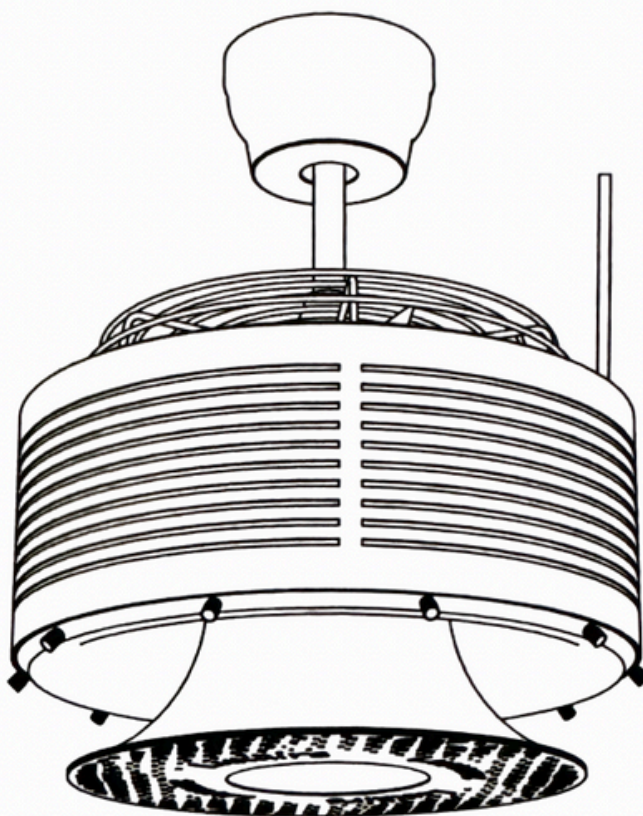

LUXAIRE MISTING CEILING FAN

*Misting Ceiling Fan With Light
User Manual & Guide*



2025 OWNER'S MANUAL

READ AND SAVE THESE INSTRUCTIONS



WARNING

WARNING: To avoid fire, shock and serious personal injury, please read the following instructions carefully.

Important Safety Instructions

1. Read all instructions and safety information before installing your new fan. Review the accompanying assembly diagrams.
2. Before installing the fan, disconnect the power by removing fuses or turning off circuit breakers.
3. Make sure all electrical connections comply with local codes, ordinances, or National Electrical Codes. Hire a qualified electrician or consult a do-it-yourself wiring handbook if you are familiar with installing electrical wiring.
4. Make sure the installation site you choose allows the fan blades to rotate without any obstructions. Allow a minimum clearance of 7 feet from the floor to the trailing edge of the blades.
5. If you are mounting the fan on a ceiling outlet box, use a metal outlet box. Secure the box directly to the building structure. The outlet box and its support must be able to support the moving weight of the fan (at least 50 lbs.) Do not use a plastic outlet box. Attach the mounting bracket by using the hardware supplied with the ceiling outlet box.
6. If you are mounting the fan to a joist, make sure it is strong enough to support the moving weight of the fan (at least 50 lbs.)
7. After installing the fan, make sure all the connections are secured. This will prevent the fan from falling.
8. Do not insert anything into the fan blades while the fan is operating.
9. Turn the fan off and wait for it to stop before reversing the fan direction.
10. To reduce the risk of electrical shock and personal injury, do not install the fan on a sloped ceiling.
11. To reduce the risk of electrical shock and personal injury, do not use this fan with any solid-state.
12. To reduce the risk of personal injury, use only the two steel screws and lock washers provided with the fan for mounting the outlet box.

Table of Contents

ASSEMBLY DRAWING & PARTS LIST WITH LIGHT.....	3
HOW TO INSTALL THE FAN WITH LIGHT.....	4-7
PROTECTIVE FUNCTIONS OF THE RECEIVER.....	8
MAINTENANCE.....	8
BALANCING FANOBBLING/TROUBLE SHOOTING.....	9

BEFORE INSTALLATION

Unpack your fan and check the contents. You should have the following.

Parts List

1	Mounting Bracket	1
2	Wall Control	1
3	Canopy	1
4	Canopy Screws	2
5	Downrod & Hanger Ball	1
6	Cross Pin	1
7	Clamp Pin	1
8	Horn Hood	1
9	Lamp Top Screw	6
10	T-Shaped Connector	1
11	Fan Light Body	1
12	Receiver	1
13	Expansion Screws	2
14	Wood Screws	4

Assembly Drawing

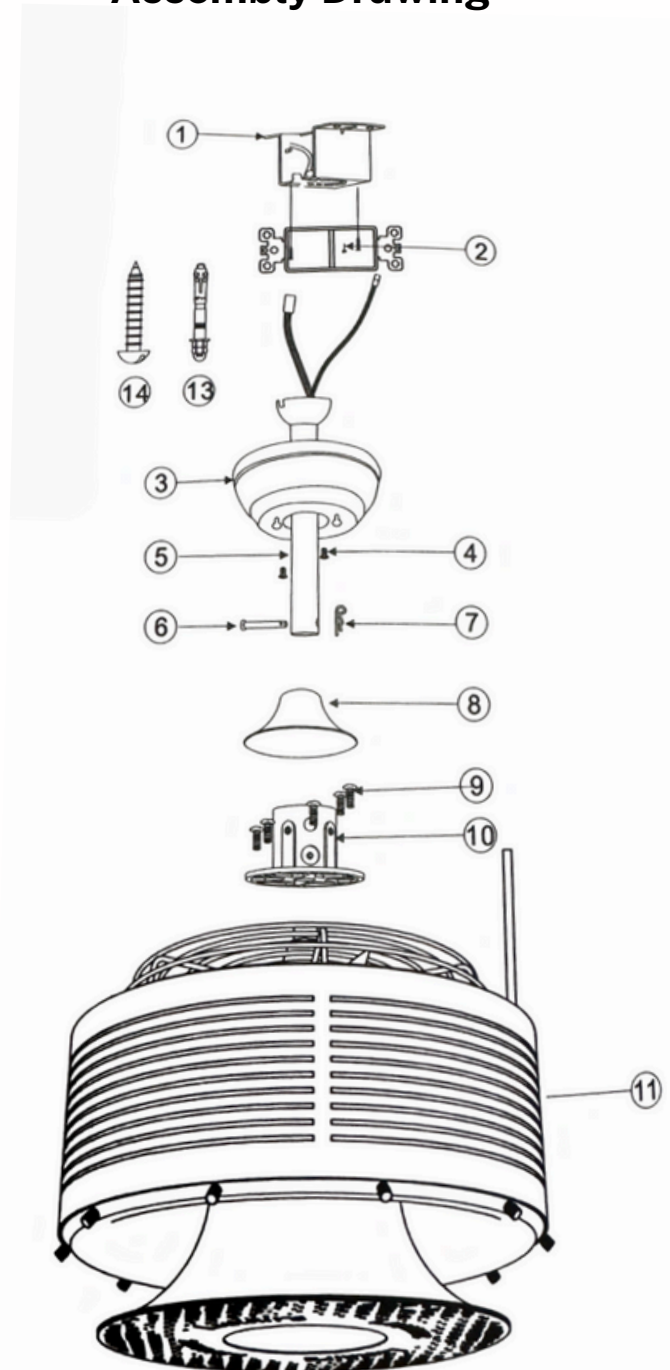

ASSEMBLY DRAWING & PARTS LIST-WITH LIGHT

1. Fix the hanger with screws at the reserved ceiling position. (Figure 1)

Concrete Ceiling

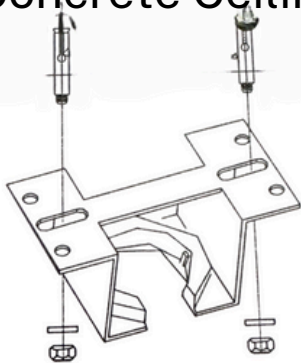

Wooden Ceiling

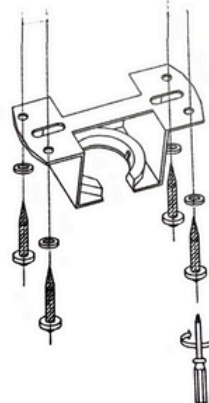

Figure 1

2. Loosen the set screws in the hanger ball assembly until the ball slides carefully down the downrod. Remove the pin from the downrod. (Figure 2)

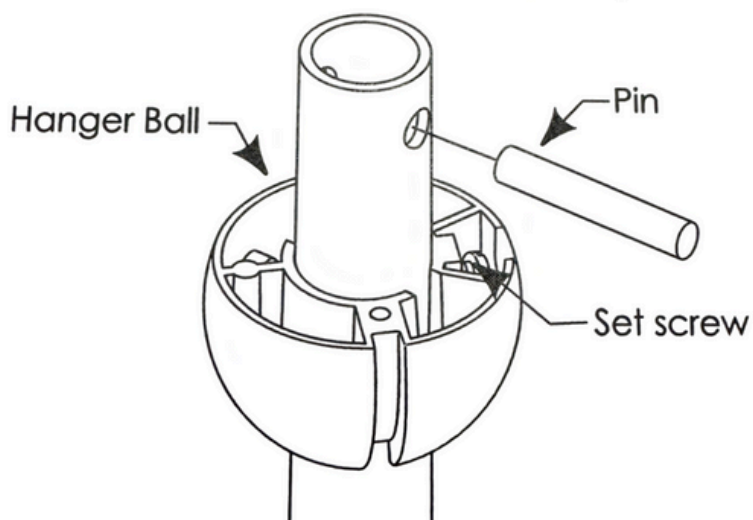

Figure 2

3. Remove and save the clevis pin and hairpin of the downrod. Put the downrod through the canopy and coupling cover. (Figure 3)



Figure 3

ASSEMBLY DRAWING & PARTS LIST-WITH LIGHT

4. Loosen two set screws on the downrod support and then place the downrod into the downrod support.(Figure 4)

Thread the electrical wires and the earth wire through the downrod.

Align the clevis pin holes in the downrod with the holes in the downrod support. Be sure to push the straight leg of the hairpin clip through the hole near the end of the clevis pin until the curved portion of the hairpin snaps around the clevis pin. Finally, re-tighten the two set screws.

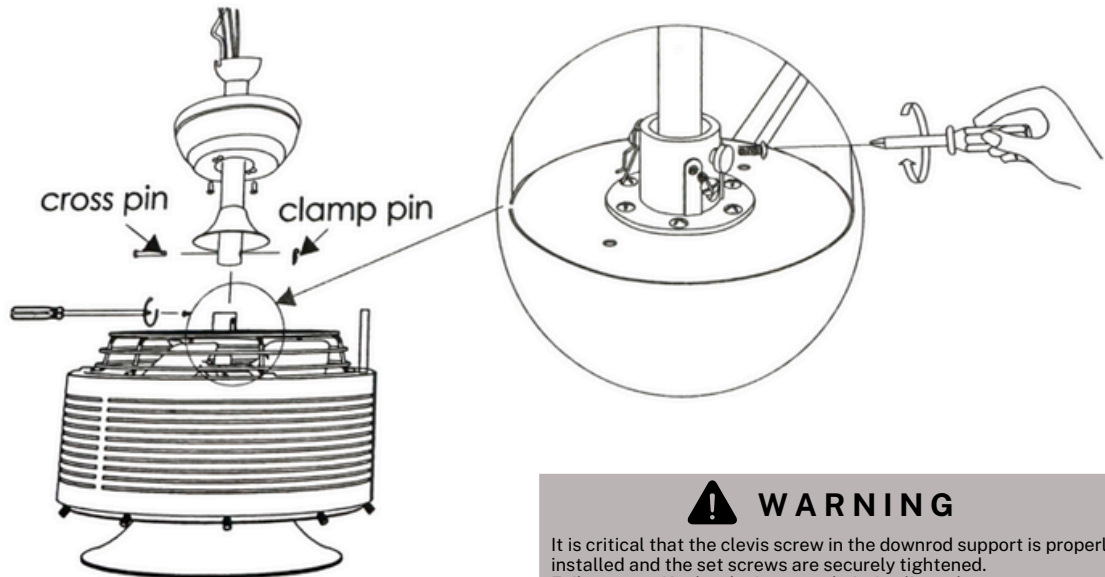

Figure 4



WARNING

It is critical that the clevis screw in the downrod support is properly installed and the set screws are securely tightened. Failure to verify the clevis screw, hairpin clip and set screws are properly installed could result in the fan falling.

5. Carefully lift the fan, and set the downrod / hanger ball assembly on the hanger bracket attached to the ceiling joist. Be sure the groove in the ball is properly aligned with the tab on the hanger bracket. (Figure 5)

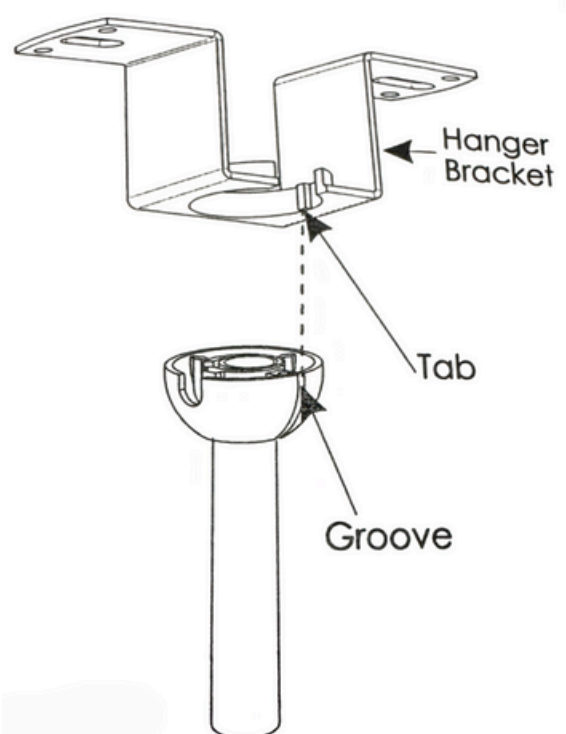

WARNING

The fan must be hung with at least 230 cm of clearance from the floor to the blades.

Figure 5

HOW TO INSTALL THE FAN-WITH LIGHT

Precautions for connecting the power cord:

WARNING

To avoid possible electrical shock, be sure electricity is turned off at the main fuse box before wiring.

Connect 110V main power (dwelling) to the terminal block located on the hanger

6. Correctly link the light wire, motor wire, and neutral wire and live wire according to the guidelines on the right. (Figure 6)

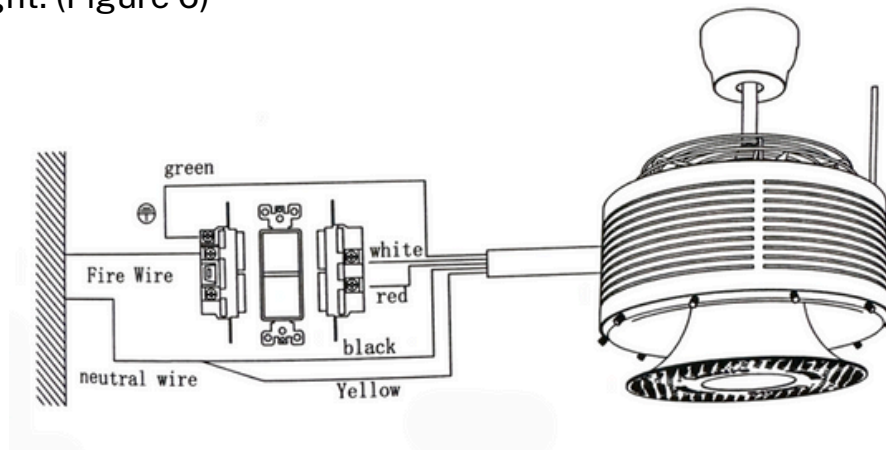
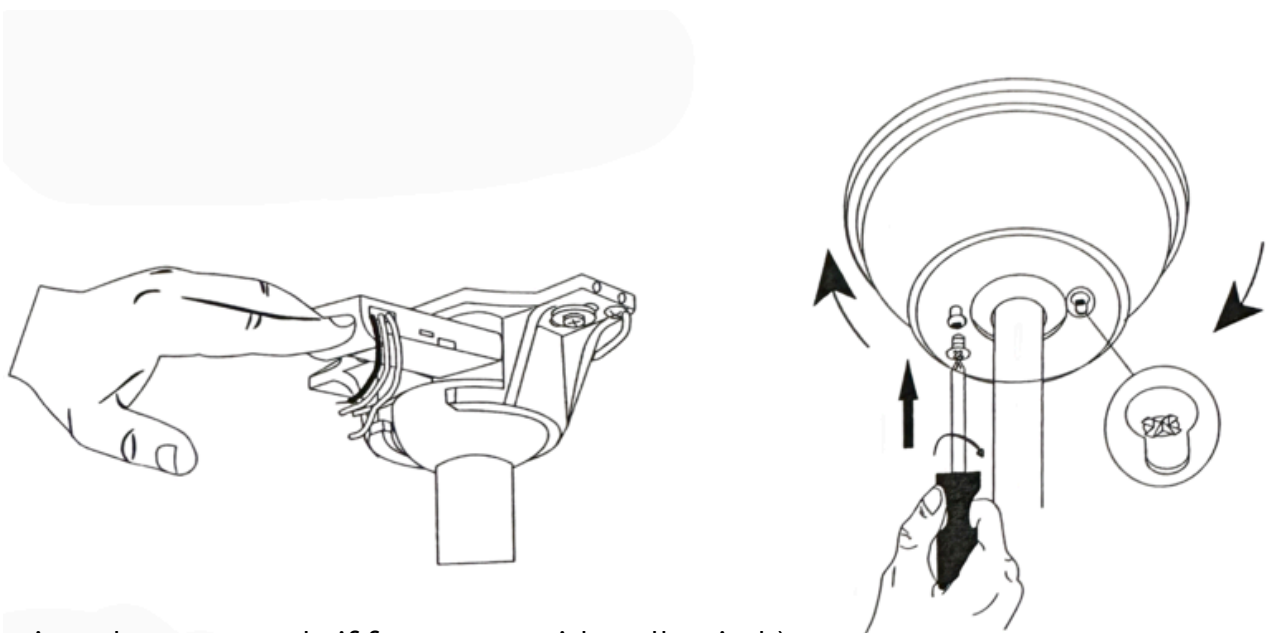

Figure 6

7. Put the receiver into the bracket and arrange the wires, mount the canopy as previously stated. (Figure 7)



(Receiver does not apply if fan comes with wall switch)

Figure 7

ASSEMBLY DRAWING & PARTS LIST-WITH LIGHT

8. Install water pipes. (Figure 8)

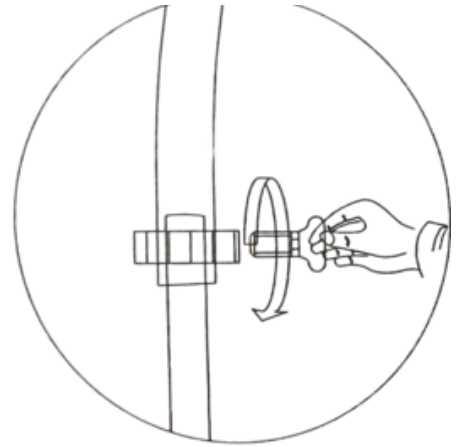
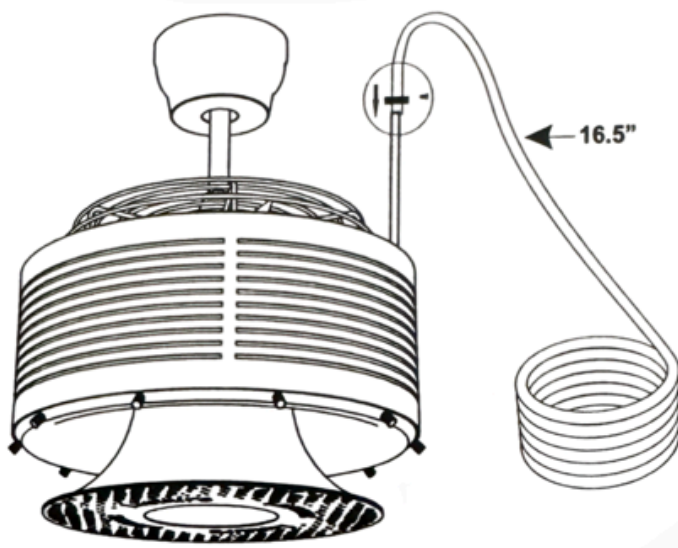

Figure 8

Attention: The length of the water pipe is 16.5". Please measure the distance between the lamp and the water pump when installing the water pump. If the water pipe is too long, cut off the excessive part during installation.

PROTECTIVE FUNCTIONS

Lock protection- The motor has a built-in safety feature against blade or motor obstruction during operation. If something obstructs the fan blades or motor, the motor will keep trying to run and then stop operation after about 30 seconds of interruption. Please remove obstacles and reset. To reset: Turn the fan off by transmitter and then turn the fan on.

Over load protection (current limit)- The device will limit the maximum current output from the receiver/drive if the fan load has increased abnormally.

Tips

1. If your fan operates automatically after installation and power on, it is because your fan has memorized the previous factory setting. Use the universal mode or the learning function and your fan will be ready for use.
2. If the fan or light isn't working, reset power (turn the power off for at least 5 seconds and then turn the power back on) and redo the learn function setting.
3. It is not possible to remotely operate more than one fan in the same room (in the same area where the signal can reach to) if they share the same power supply. Separate power supplies (such as using individual wall switches for each fan) is required if you want to separately control more than one fan in same room.
4. When the fan is turned on or operated using forward/reverse function, it shutters and goes back and forth until it turns. This is normal and will take a few seconds to run this operation.

MAINTENANCE

1. Periodic cleaning of your new ceiling fan is the only maintenance that is needed.
2. When cleaning, use only a soft brush or lint free cloth to avoid scratching the finish.
3. Abrasive cleaning agents are not required and should be avoided to prevent damage to finish.

WARNING

Do not use solvents when cleaning your ceiling fan. It could damage the motor and create the possibility of electrical shock.

RECOMMENDED:

Periodically check that the blade sets to the fan motor set screws are secure and tight.

BALANCING FAN/WOBBLING TROUBLE SHOOTING

Please note that all ceiling fans are not the same, even in the same model-some may move more or less than others.

Movement of a couple of centimeters is quite acceptable and does not suggest the fan will fall down.

Even though all blades are weighted and grouped by weight, it is impossible to eliminate wobble altogether. This should not be considered a fault, ceiling fans tend to move during operation due to the fact that they are not generally rigidly mounted.

TRY THE FOLLOWING TO REDUCE A WOBBLING FAN:

1. Check that all of the blade mounting screws are tightened and secure.
2. Wobbling problems may result from inconsistent blade level. To check the blade level, measure the distance from each blade tip to the ceiling.
Note: If measurements are inconsistent:
 - Be sure the blade mount screws are not too tight or too loose, which may cause wobbling due to an unlevel blade tip.
 - An out of shape blade can cause wobbling. Check by removing the blade and placing on a flat surface.
3. Blade tracking may be checked simply by use of household ruler. Place the ruler vertically against the ceiling and even with the outside leading edge of a blade. Note the distance of the edge of a blade compared to the others. Turn the blade slowly by hand to check the remaining blades if a blade is not in alignment, the blade is either out of shape, warped or the blade screws are not evenly tightened or either loose.

BALANCING KIT

A balancing kit has been provided to assist with reducing a wobble. Please retain the kit as it may become useful should the fan develop a wobble in the future.

Step 1. Clamp the balance clip to the middle position marked A of any fan blade. Turn on the fan and check if the vibration of the fan blades is reduced. Proceed to step 3 if the shaking is reduced. If shaking increases go to step 2.

Step 2. Take out the balance clip, clip it to the middle mark B of the clockwise adjacent blades, and so on until you find the fan blade that can reduce the shaking.

Step 3. When we found the fan blade that can reduce the shaking. Move the balance clip on the fan blade towards the center or edge and turn on the fan to see if the wobble reduced. If the balance clip cannot fully counteract the shaking of the fan blade at the center or edge position, you can add an additional balance clip near the center or edge position for adjustment.

Step 4. When the fan blade no longer shakes, use a balance patch to stick to the position where the clip on the back of the fan blade is clamped to replace the balance clip. (1 balance patch instead of 1 balance clip)

Step 5. The adjustment is complete.

Luxaire Ceiling Misting Fan Specifications

Fan Options	Current	Rpm	Volts	Motor HP	Amps	Decibels	.006 Nozzle Capacity	.008 Nozzle Capacity
14" Mini	FLA LIA	1500rpm	110V	1HP VAC	1.1 Amps	5Db	6	6
18"	FLA LIA	1500rpm	110V	1HP VAC	1.1 Amps	5Db	10	10
24"	FLA LIA	1500rpm	110V	1HP VAC	1.1 Amps	5Db	12	12

Features

- Powder Coated Housing Colors
- CCL White/Warm/Day LED Lights (Multi White)
- Down Rod with Flush Mount Canopy
- Weather/Degradation Resistant/Outdoor Rated
- 1/4" OD Integrated Misting Ring
- Nozzle Thread 10-24unc
- Decibels: 5Db
- 110V IPH VAC 1.1 Amps
- Wall Switch 110V Light/Far



SKUs:

- PMCF1800 (Antique White)
- PMCF1300 (Modern White)
- PMCF2400 (Contemporary White)
- PMCF1700 (Contemporary Brown)
- PMCF1200 (Modern Brown)
- PMCF2300 (Contemporary Brown)
- PMCF2100 (Antique Adobe)
- PMCF1500 (Modern Adobe)
- PMCF2600 (Contemporary Adobe)
- PMCF1900 (Antique Grey)
- PMCF1400 (Modern Grey)
- PMCF2500 (Contemporary Grey)
- PMCF1600 (Antique Black)
- PMCF1100 (Modern Black)
- PMCF2200 (Contemporary Black)
- PMCF1899 (Breeze Black)
- PMCF1877 (Victorian Black)
- 1844 (Shell Black)
- PMCF1888 (Vintage Black)

Precision. Quality. Innovation.

60 W Baseline Rd, Suite 106
Mesa, AZ 85210

www.precisionmist.com
480-809-7634