

MODEL - PAYTON

IT IS THE INTENT OF THESE DOCUMENTS TO PROVIDE SUFFICIENT INFORMATION TO THE EXPERIENCED BUILDER TO CONSTRUCT THE PROJECT SHOWN. IT IS THEREFORE HIS RESPONSIBILITY TO VERIFY ACCURACY AND COMPLIANCE WITH ALL REGULATORY AGENCIES PRIOR TO CONSTRUCTION. THOSE REGULATORY REQUIREMENTS MUST TAKE PRECEDENCE OVER ANY CONFLICTING INFORMATION SHOWN HEREIN. THE DESIGNER SHALL NOT BE LIABLE FOR HUMAN ERROR AFTER THE CONSTRUCTION BEGINS. THIS DESIGN IS SOLD TO THE PURCHASER FOR ONE-TIME USE ONLY TO BE BUILT AT THE SPECIFIED LOCATION. THE DESIGN REMAINS THE PROPERTY OF THE DESIGNER. THE DESIGN MAY NOT BE REPRODUCED, REUSED, LOANED OR SOLD WITHOUT WRITTEN PERMISSION FROM "CORMIER HOME DESIGNS".

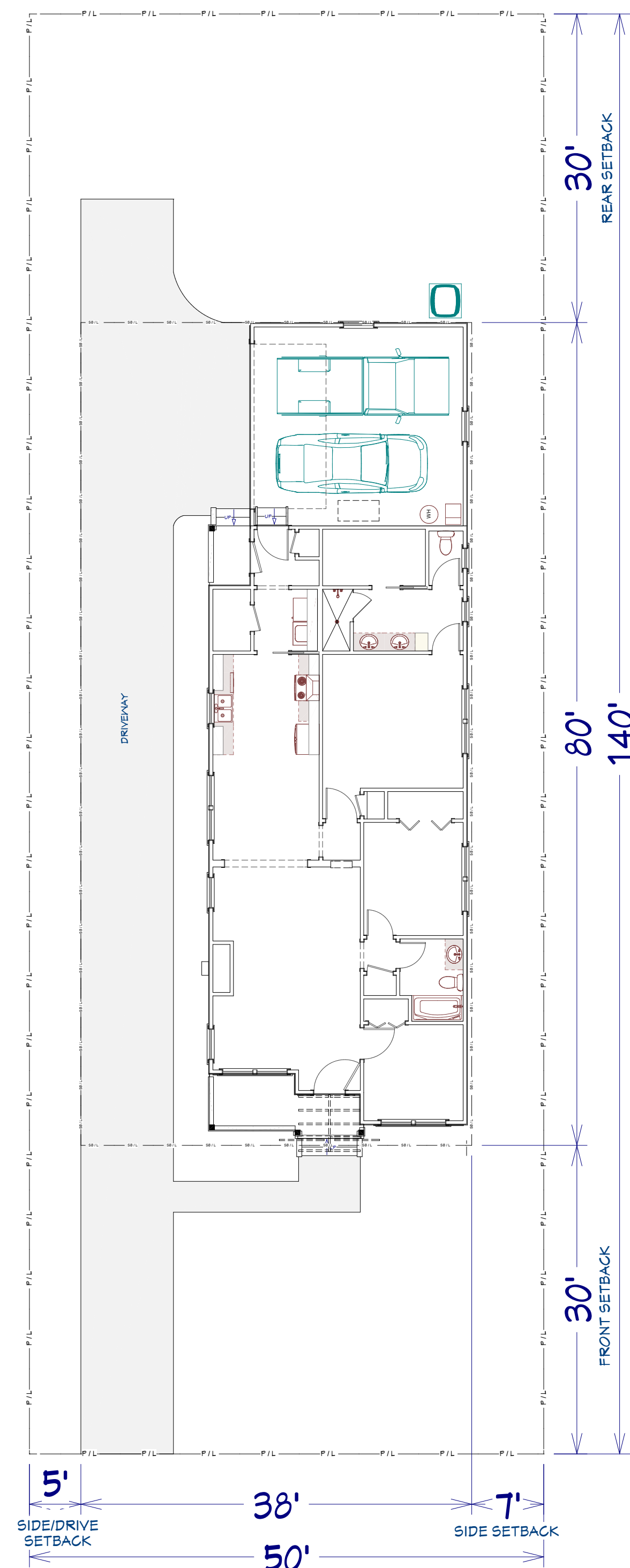

SITE PLAN
1"=10'



COVER PAGE

AREA CALCULATIONS	
MAIN FLOOR HEATED AREA	1,359 SQ. FT.
2 CAR GARAGE	413 SQ. FT.
COVERED ENTRY	74 SQ. FT.
COVERED REAR PORCH	23 SQ. FT.

PROJECT KEY	
TITLE	PAGE
Cover Page	A-1
Foundation Plan	A-2
1st Floor Plan	A-3
Elevations	A-4
Sections	A-5
Roof Plan	A-6
Schedules	A-7
Notes Page	A-8

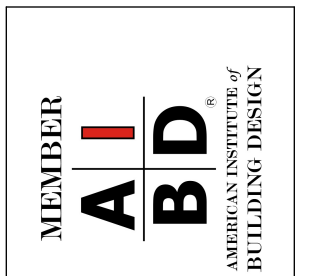

PISTOL CREEK - PAYTON MODEL
(1 STORY) "B" LOTS

J.E. CORMIER HOME DESIGNS
10420 EAGLES VIEW DRIVE, KNOXVILLE, TN 37922
P: (665) 255-1120 / E: JUSTIN@CORMIERHOMEDESIGNS.COM

DRAWN BY:
R.M.S.

DATE:

6/20/2019

SCALE:

SEE DWG.

SHEET:

A1