

Overview

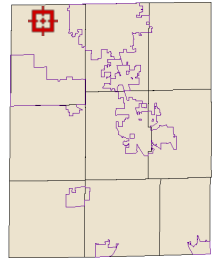

Legend

-  Cities
-  Parcels
- Roads**
 -  ACCESS RAMP
 -  HIGHWAY
 -  INTERSTATE
 -  LOCAL
 -  MAJOR ARTERIAL
 -  MAJOR COLLECTOR
 -  MINOR ARTERIAL
 -  MINOR COLLECTOR
 -  PRIVATE ROAD

| | | | | | |
|------------------------------|-------------------------------------------------------------------------------------|---------------------|-------------------|----------------------|----------------------------------|
| Parcel ID | 41-03-33-013-080.000-038 | Alternate ID | 1414 33 07 056/00 | Owner Address | INNISBROOKE HOMEOWNERS ASSOC INC |
| Sec/Twp/Rng | n/a | Class | Common areas | | PO BOX 202 |
| Property Address | INNISBROOKE TR GREENWOOD | Acreage | 2.446 | | GREENWOOD, IN 46142 |
| District | 038 | | | | |
| Brief Tax Description | INNISBROOKE SEC III COMMON AREA <i>(Note: Not to be used on legal documents)</i> | | | | |

DISCLAIMER: Johnson County maintains this World Wide Web site to enhance public access to information. This site is continually under development and therefore subject to change without notice. While we endeavor to provide timely and accurate information, we make no guarantees. Johnson County makes no warranty, express or implied, including warranties of merchantability and fitness for a particular purpose. Use of the information is the sole responsibility of the user. The material on this site comes from a variety of sources. We do not control or guarantee the accuracy, relevance, timeliness or completeness of any outside information. Further, the inclusion of pointers to particular items is not intended to reflect their importance nor is it an endorsement of any of the views expressed or products or services offered. Maps and data are provided for informational purposes only.

Date created: 5/4/2020
Last Data Uploaded: 5/4/2020 7:38:23 PM