

John Duncan

241 Lord Street, Southport PR8 1ND
Telephone (01704) 537686
3 Cambridge Arcade, Southport PR8 1AS
Telephone (01704) 536051

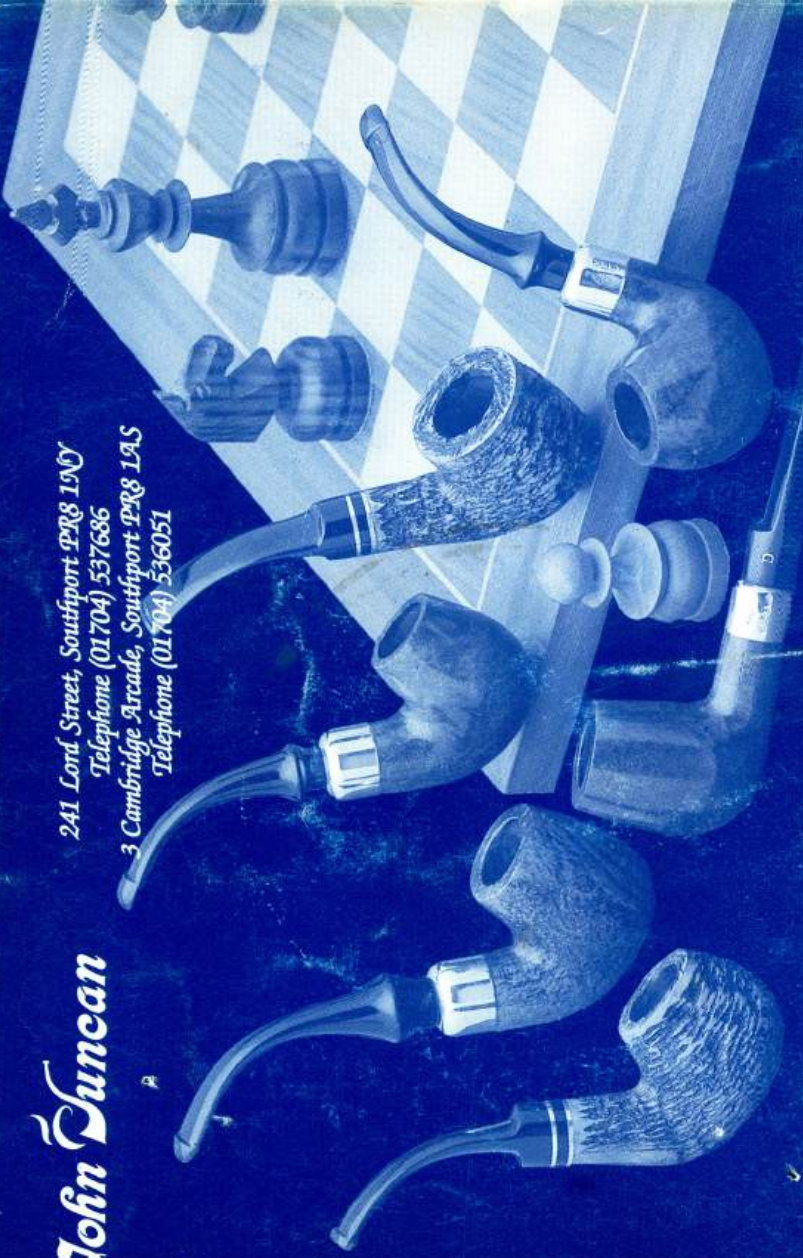

Pipes, Lighters, Cigars, Tobacco, Gloves, Pens, Walking Sticks, Games, Umbrellas, Brief Cases, Handbags, Shaving Sets, Purses, Wallets, Compacts and other high class gifts.

1999-2000

Southport & District Badminton League

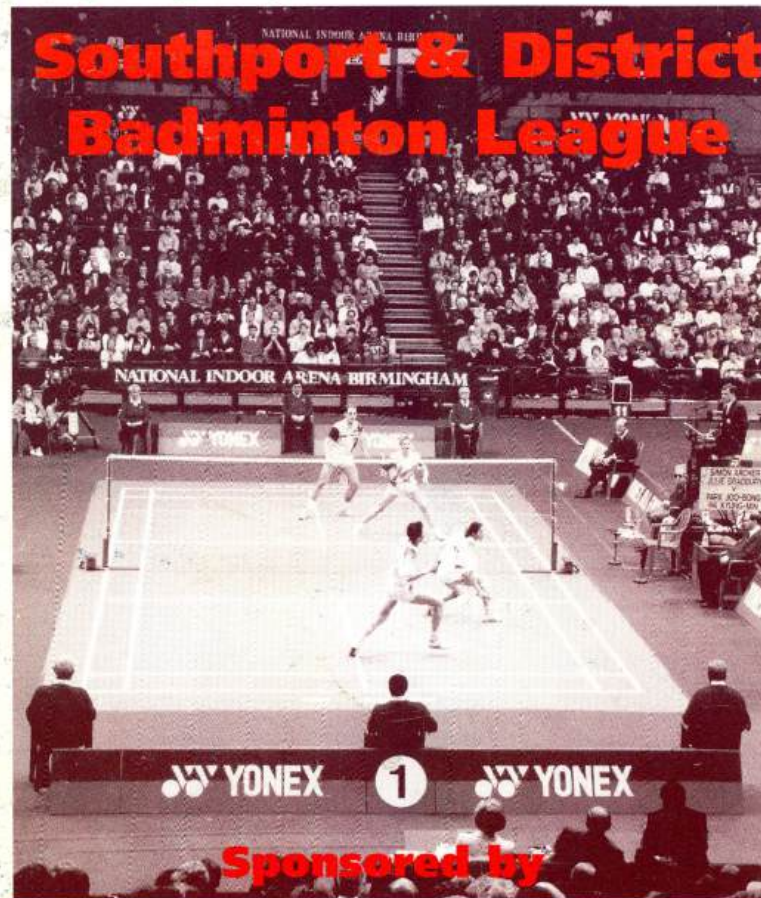

Sponsored by



GARRYOWEN
LTD

Building & Roofing Contractors
26a Everton Road, Southport Tel: (01704) 562011

GARRYOWEN

LTD

26a Everton Road, Southport PR8 4BT
Tel.: (01704) 562011 Fax.: (01704) 550003

Dear Members,

Fáilte moor (a big welcome) to the Southport and District Badminton League which Garryowen Limited are happy to be sponsoring.

I hope that the forthcoming events in the league's calendar will be successful. I wish the contestants good luck in the tournaments and the spectators a happy and enjoyable time. May the league go from success to success in the future and continue to be blessed with both the quality and quantity of competitors and spectators it deserves.

A big thank you to your committee for the invitation to your annual dinner which my manager and I thoroughly enjoyed. I enjoy our association with the league and look forward to seeing you at the prize giving ceremonies.

Fáile go brá aguib

(Have great tournaments everyone)

Yours sincerely

F. J. Bartlett
Managing Director

Garryowen Limited



GARRYOWEN

LTD

- | | |
|-------------|--------------|
| * Building | * Roofing |
| * Plumbing | * Tiling |
| * Flooring | * Plastering |
| * Brickwork | * Glazing |
| * Painting | * Joinery |
| * Drainage | * Metalwork |

* Emergency Repairs
& Drain Clearing

All work carried out to the
Highest Standards
by Qualified Tradesmen

Tel: 01704 562011



26a Everton Road, Southport

THE GARRYOWEN LTD

'A', 'B', 'C' AND 'V'

TOURNAMENTS

CONDITIONS OF ENTRY:

1. An entry form is required for each competitor.
2. Entry fee per person per event is £3.25. Cheques payable to Southport Badminton League.
3. Closing dates for entries are 'A', 'V1' and 'V2' 16-10-99, 'C' 15-1-00, 'B' 19-2-00.
4. All Tournaments will be played on a straight "Knockout" basis. The first shuttle used in each round will be provided.
5. A "Plate" Competition will be played in all "A" Tournament Events attracting an entry of **16 or more.**
6. The date and time of your first event will be sent to your club secretary and published in the Southport Visiter. No other notification will be given.
7. **Competitors must report to the desk immediately upon arrival and ensure that any additional shuttle costs have been settled prior to their departure.**
9. Tournament regulations on pages 50/51 should be noted carefully, in particular regulation 3(e) regarding 'V1' and 'V2' tournaments criteria.

Competitors may note below any further information relevant to their entry.

INDEX

Page/s

Sponsor's letter and informationInside front and back covers

ENTRY FORMS

The GARRYOWEN LTD, J. BLOCKLEY, A, B, C & V Tournaments53, 54, 55, 56, 57, 58, 59, 60
New International Setting Rule31

THE LEAGUE

Officials2
Committees3
Gala Millennium Disco/Dance.....4
Directory of Clubs and Registration Fees 1999/2000.....5, 7, 9
The "Inflight" Junior League10, 11
Divisional Champions13
League Tables 1, 2, 3A15
League Tables 3B, 4A, 4B17
League Tables 5A, 5B, 6.....19
Umpires20
Fault Serving20/21
Shuttle Testing, Rules and Court Markings.....23
Divisions and League Programme 1999/2000 (Facing Centre Pages).....30/31
Coaching, International Appearances, Lancashire Appearances25

LEAGUE RECORDS

Individual Open29
Team K.O. (Cups)43
Team Handicap (Shields and Watkinson Trophy).....41
Vera Maxwell Trophy27

RULES AND REGULATIONS

League Rules32,33,34,35
League Rule 5c: Competition - Appendix & Registration Fees35,36,37,38
Cup Regulations and Notes.....44,45
Shield Regulations46,47
Watkinson Trophy Regulations49
Individual Tournament Regulations50, 51

ADVERTS 6, 8, 12, 14, 16, 22, 24, 26, 28, 39, 40, 42, 48, 52, Back Cover

SOUTHPORT AND DISTRICT BADMINTON LEAGUE

Life Members:

H. G. Highton, M. R. E. Hyde.

140 / 545545

Vice-Presidents:

G. C. C. Lindsay, K. Houldcroft, G. H. Lloyd, J. E. Moore and G. H. Bailey.

THE LEAGUE EXECUTIVE

President & Registration Officer:

J. Henderson, Flat 4, 16 Westcliffe Road, Southport, PR8 2BN. Tel. 565957

Executive Chairman:

M. Banham, 36 Larch Street, Southport, PR8 6DL. Tel. 547917

Vice-Chairman:

G. Perry, 216 Guildford Road, Southport, PR8 4NQ. Tel. 564551

General Secretary:

R. D. Kime, 134 Larkfield Lane, Churchtown PR9 8NP. Tel. 231417

Treasurer:

G. M. Pike, 25 Blundell Road, Hightown, Liverpool, L38 9EE. Tel. 0151 929 2996

League Match Chairman:

Mrs. M. Halliwell, 100 Lexton Drive, Southport, PR9 8QW. Tel. 225500

League Match Officer:

R. H. Simm, 87 Warren Road, Southport, PR9 7QU. Tel. 227939
Mobile 0780 3918656

Cups & Shields Chairman:

D. Bradley, 173 Wennington Road, Southport PR9 7AH. Tel. 214235

Tournaments Chairman:

M. Billington, 17 Barford Close, Southport, PR8 2RS. Tel: 576599

Sponsorship Officer:

N. R. Marshall, 9 Nolan Street, Southport, PR8 6QQ. Tel. 542088

Press Officer:

J. Sinclair, 12 Longacre, Southport, PR9 9TB. Tel. 212374

Ordinary Members:

D. Clark, J. Howell, J. G. Prescott, K. Courtley, D. Wright, A. C. Ascott, Mrs. P. Boylett, P. Duncan, D. B. James, Mrs. M. Rimmer, Miss J. Cook, Mrs. J. Tobin and P. Morgans.

THE GARRYOWEN LTD 'V' TOURNAMENT

ENTRY FORM

To: M. Billington, Esq.

17 Barford Close, Southport, PR8 2RS.
Tel: 576599

Date

Signature

Full Name (Mr./Mrs./Miss).....(Capitals)

Address Tel. No.

Club and Team in Southport League

Division.....

Club and Team in other Leagues.....

Division.....

EVENT:	PARTNER'S FULL NAME: (COMPETITORS REQUIRING A PARTNER SHOULD ENTER 'PARTNER REQUIRED')	
	V1	V2
Men's/Ladies Singles	40+	50+
Men's/Ladies Doubles		
Mixed Doubles		

Entry Fee Per Person Per Event is £3.25 (see overleaf for provision of shuttles)

TOTAL ENTRY FEE ENCLOSED £.....

PLEASE REFER TO CONDITIONS OF ENTRY OVERLEAF

THE GARRYOWEN LTD

'A', 'B', 'C' AND 'V'

TOURNAMENTS

CONDITIONS OF ENTRY:

1. An entry form is required for each competitor.
2. Entry fee per person per event is £3.25. Cheques payable to Southport Badminton League.
3. Closing dates for entries are 'A', 'V1' and 'V2' 16-10-99, 'C' 15-1-00, 'B' 19-2-00.
4. All Tournaments will be played on a straight "Knockout" basis. The first shuttle used in each round will be provided.
5. A "Plate" Competition will be played in all "A" Tournament Events attracting an entry of **16 or more**.
6. The date and time of your first event will be sent to your club secretary and published in the Southport Visiter. No other notification will be given.
7. **Competitors must report to the desk immediately upon arrival and ensure that any additional shuttle costs have been settled prior to their departure.**
9. Tournament regulations on pages 50/51 should be noted carefully, in particular regulation 3(e) regarding 'V1' and 'V2' tournaments criteria.

Competitors may note below any further information relevant to their entry.

COMMITTEES:

The Chairman, Vice-Chairman and General Secretary are ex-officio members of all Committees except the Selection Sub Committee.

Tournaments Committee: M. Billington (Chairman)

D. Clark, K. Courtley, Mrs. M. Halliwell, J. Henderson, M. R. E. Hyde, D. B. James, Mrs. M. Rimmer, R. Simm, and J. Sinclair.

Cups and Shields Committee: D. Bradley (Chairman)

A. Ascott, Mrs. P. Boylett, P. Duncan, M. R. E. Hyde, P. Morgans, G. Perry, J. Prescott, R. Simm, J. Sinclair and D. Wright.

League Match Committee: Mrs. M. Halliwell (Chairman)

M. Billington, D. Bradley, K. Courtley, D. Clark, P. Duncan, M. R. E. Hyde, Mrs. M. Rimmer, R. Simm, J. Sinclair and Mrs. J. Tobin.

Administration Committees: G. Perry (Chairman)

Tel. 564551

Discipline & Courts:

D. Bradley, D. Courtley, Mrs. M. Halliwell, J. Howell, M. R. E. Hyde, N. Marshall, J. Prescott, R. Simm, J. Sinclair and Mrs. J. Tobin.

Juniors:

M. Banham, D. Clark, J. Cook (01704 - 212839), J. Henderson, J. Howell, R. Ingleby (Co-opted), P. Morgans and R. Simm.

Selection:

A. Ascott, Mrs. M. Rimmer, J. Prescott plus 3 Club Co-optees.

General Purposes Committee:

Chairman, Vice-Chairman, Secretary, Treasurer, Four Committee Chairmen.

Auditor:

P. Marshall, 28 Ryder Crescent, Birkdale, Southport.

SOUTHPORT & DISTRICT BADMINTON LEAGUE
WEBSITE AT: <http://www.miller-d.demon.co.uk>

LEAGUE A.G.M.

APRIL 26th 2000

A.G.M. AGENDAS AVAILABLE FROM CLUB
SECRETARIES IN MID-MARCH

GALA MILLENNIUM DISCO DANCE

(Including Presentation of League Trophies)

FRIDAY, 28th APRIL, 2000

8 p.m. till 1 a.m.

in the

BALMORAL SUITE
THE ROYAL CLIFTON HOTEL

Tickets £4.00

from your own Secretary or Ron Kime. Telephone: 231417

To avoid disappointment order your tickets now

Clubs are asked to provide a Raffle Prize which can
be given to any League Officer prior to the Dance

*Bring a party and enjoy this final event
of the season*

THE GARRYOWEN LTD 'A', 'B' and 'C' TOURNAMENTS

ENTRY FORM

To: M. Billington, Esq.

17 Barford Close,
Southport, PR8 2RS.
Tel: 576599

Please enter me in the following events:

DateSignature

Full Name (Mr./Mrs./Miss).....(Capitals)

AddressTel. No.

Club and Team in Southport LeagueDivision.....

Club and Team in other LeaguesDivision.....

EVENT:	A/B/C	PARTNER'S FULL NAME: (COMPETITORS REQUIRING A PARTNER SHOULD ENTER 'PARTNER REQUIRED')
Men's/Ladies Singles		
Men's/Ladies Doubles		
Mixed Doubles		

Entry Fee Per Person Per Event is £3.25 (see overleaf for provision of shuttles)

TOTAL ENTRY FEE ENCLOSED £.....

PLEASE REFER TO CONDITIONS OF ENTRY OVERLEAF

DIRECTORY OF CLUBS

AINSDALE7.00 p.m. Wednesday, Thursday & Friday

Location of Hall : Ainsdale High School, Sandringham Road, Ainsdale, Southport.
 General Secretary : Miss. F. Haigh, 8 Rutland Road, Southport. Tel. 544865
 Match Secretary : Mrs. M. Warren, Flat 2, 31 Park Road, Southport. Tel. 548448

ALL SOULS7.00 p.m. Monday

Location of Hall : All Souls Parochial Hall, Norwood Road, Southport.
 General Secretary : Mrs. H. Blomley, 27 Tedder Avenue, Southport. Tel. 228327
 Match Secretary : Mrs. J. Finley, 25 Ryder Crescent, Southport. Tel. 578073

BURSCOUGH7.00 p.m. Wednesday

Location of Hall : Burscough S. C., Mart Lane, Burscough.
 General Secretary : Pat Boylett, Threlfalls Farm, Ormskirk. Tel. 01695 572884
 Match Secretary : Mrs. M. Clarke, 7 Rotten Row, Southport. Tel. 535714

CHURCHTOWN7.00 p.m. Monday, Wednesday or Thursday

Location of Hall : United Reformed Church Hall, Botanic Road, Southport.
 General Secretary : Mrs. S. A. Hurst, 17 Irton Road, Southport. Tel. 533396
 Match Secretary : Mrs. L. Ring, 118 Churchgate, Southport. Tel. 506241

FORMBY7.00 p.m. Tuesday & Friday

Location of Halls : Formby High School, Freshfield Road, Formby.
 General Secretary : Mrs. G. Clatworthy, 16 Langdale Avenue, Formby. Tel. 870020
 Match Secretary : Mrs. C. Gresty, 17 Greenloons Walk, Formby. Tel. 879046

FORMBY METHODIST7.00 p.m. Tuesday and Friday

Location of Hall : Methodist Church Hall, Elbow Lane, Formby.
 General Secretary : Mrs. V. Bousfield, 3 Eskdale Drive, Formby. Tel. 876352
 Match Secretary : Mrs. A. Almond, 5 Romsey Avenue, Formby. Tel. 877857

HESKETH BANK7.00 p.m. Monday & Wednesday

Location of Hall : All Saints Hall, Station Road, Hesketh Bank.
 General Secretary : Mrs. K. Baybutt, 9 Willow Hey, Tarleton. Tel. 01772 813401
 Match Secretary : M. Schofield, 44 Delta Park Drive, Hesketh Bank. Tel. 01772 815288

HOOLE8.20 p.m. Friday

Location of Hall : Burscough S. C., Mart Lane, Burscough.
 General Secretary : R. Jones, 8 Standhouse Lane, Aughton, Lancashire. Tel. 01695 423916
 Match Secretary : C. Hornby, 24 Springfield Close, Burscough Tel. 892276

MAWDESLEY7.00 p.m. Thursday

Location of Hall : Burscough S.C., Mart Lane, Burscough.
 General Secretary : P. Edgeller, 9 Hartley Crescent, Southport. Tel. 568156
 Match Secretary : Mrs. J. Lewis, Hayfields, Tanfield Nook, Parbold. Tel. 01257 462465



SOUTHPORT SPORTS

*WE CARRY THE MOST COMPREHENSIVE RANGE
OF BADMINTON RACKETS IN TOWN*

LARGE RANGE OF SPORTSWEAR AND FOOTWEAR

UNRIVALLED STRINGING SERVICE

GENEROUS CLUB DISCOUNTS

48 KING STREET, SOUTHPORT
Telephone: (01704) 530886

THE JACK BLOCKLEY TOURNAMENT

Conditions of Entry

1. Entry Fee per pair is £6. Cheques payable to Southport Badminton League.
2. Competitors must be under 21 years of age at the closing date for entry.
3. The closing date for entry is 16/10/99.
4. The dates and times of your events will be sent to your Club Secretary and published in the Southport Visiter. No other notification will be given.
5. Competitors must report to the desk immediately upon arrival.

ORMSKIRK **7.00 p.m.** Wednesday
 Location of Hall : Ormskirk Grammar School, Mill Lane, Ormskirk.
 General Secretary : A. Cunningham, 68 St. Helens Road, Ormskirk. Tel. 01695 574991
 Match Secretary : Mrs. A. Alcock, Slack House Farm, St. Helens Road, Ormskirk.
 Tel. 01695 573146

PHOENIX **7.00 p.m.** Monday (NMCLC) Wednesday (URC)
 Location of Halls : United Reformed Church Hall, Grosvenor Road, Southport.
 North Meols Community Leisure Centre (Greaves Hall), Banks.
 General Secretary : K. Courtley, 50 Mallee Crescent, Southport. Tel. 231606
 Match Secretary : M. Billington, 17 Barford Close, Southport. Tel. 576599

PIONEERS **7.40 p.m.** Monday & **7.30 p.m.** Friday
 Location of Halls : Burscough S. C., Mart Lane, Burscough.
 King George V College, Scarisbrick New Road, Southport.
 General Secretary : Mrs. B. Milne, 34 Riverview, Tarleton. Tel. 01772 813991
 Match Secretary : N. Haywood, 37 Highfield Road, Southport. Tel. 232910

SACRED HEART **8.00 p.m.** Thursday
 Location of Hall : St. Thomas More, Liverpool Road, Ainsdale, Southport.
 General Secretary : Mrs. S. Potter, 15 Croft Heys, Aughton, Ormskirk. Tel. 01695 422602
 Match Secretary : J. Alston, 62 Windsor Road, Southport. Tel. 532405

ST. CUTHBERT'S **7.00 p.m.** Monday & **7.30 p.m.** Friday
 Location of Halls : St. Cuthbert's Parochial Hall, Botanic Road, Southport.
 Southport Hospital, Town Lane, Southport (Spinal Unit Gym).
 General Secretary : S. Hodge, 148 Marshside Road, Southport. Tel. 232895
 Match Secretary : Mrs. J. Bridge, 1a St. John's Road, Southport. Tel. 565596

SANDGROUNDERS/SOUTHBANK **7.00 p.m.** Monday, Tuesday,
 Wednesday & Thursday
 Location of Halls : Stanley High School, Fleetwood Road, Southport.
 North Meols Community Leisure Centre (Greaves Hall), Banks.
 Wesley Church Hall, Southbank Road, Southport.
 General Secretary : Miss J. Cook, 5 Truro Avenue, Southport. Tel. 212839
 Match Secretary : P. Marshall, 28 Ryder Crescent, Southport. Tel. 577378

SOUTHPORT **7.00 p.m.** Tuesday, Wednesday & **7.30 p.m.** Thursday
 Location of Hall : The Drill Hall, Manchester Road, Southport.
 General Secretary : Mrs. S. Sells, 52 St John's Road, Southport. Tel. 566645
 Match Secretary : A. Ascott, 3 Albion Court, 32 Park Ave., Southport. Tel. 541780

TARLETON **7.00 p.m.** Tuesday & Thursday
 Location of Halls : Methodist Hall, Church Road, Tarleton.
 Burscough S. C., Mart Lane, Burscough.
 General Secretary : Mrs. E. Hawksby, 69 Red Cat Lane, Burscough. Tel. 893264
 Match Secretary : Mrs. D. Harrison, 58 Red Cat Lane, Burscough. Tel. 892500

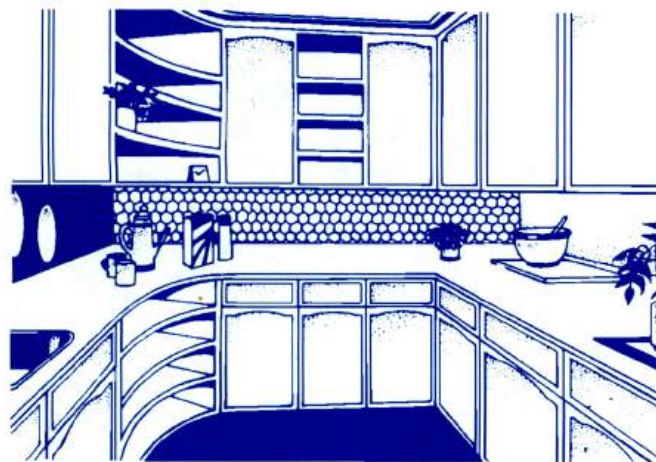

Malcolm Banham

- SHOPFITTERS •
 - KITCHEN SPECIALISTS •
 - CONSERVATORIES •
 - PLUMBING • JOINERY •
 - ELECTRICAL •
- FOR FREE ESTIMATES
PHONE (01704) 547917**

THE JACK BLOCKLEY TOURNAMENT

Entry Form
To: M. Billington, Esq.

17 Barford Close,
Southport PR8 2RS
Tel: 576599

From:(Club)

Please enter the following pair(s) in the above tournament

Pair (1)	Man	Lady
Full Name	Full Name	Full Name
.....
Tel. No.	Tel. No.	Tel. No.
Club Team.....	Club Team.....	Club Team.....
Division.....	Division.....	Division.....

Pair (2)	Man	Lady
Full Name	Full Name	Full Name
.....
Tel. No.	Tel. No.	Tel. No.
Club Team.....	Club Team.....	Club Team.....
Division.....	Division.....	Division.....

Signature(Club Secretary)

Entry Fee per pair is £6 (inclusive of all shuttles used)

Entry Fee enclosed £

Please refer to conditions of entry overleaf

Karwowski Motors

VEHICLE SERVICE AND REPAIR ENGINEERS

UNIPART



CAR CARE
CENTRE

"For your peace
of mind"

- Full service facilities available to EVERY MAKE OF CAR, courtesy car provided with every major service.
- 4x4 Landrover Discovery, Shogun, Toyotas, servicing a speciality.
- SAME DAY clutch/gearbox service.
- Brake overhauls.
- Lifetime guarantee batteries.
- Car alarms and radios supplied and fitted.
- Prop shafts repairs carried out ie Ford, Vauxhall, Volvo, Mercedes and BMW.
- Large selection of second hand parts available.
- MOT's with computerised reminders.

£10 OFF YOUR NEXT
FULL SERVICE

OR **£6 OFF** YOUR NEXT
M.O.T.

PETROL AND DIESEL
On production of this advert

ACCIDENT DAMAGE REPAIRS CARRIED OUT WITH FULL BODY JIGGING
FACILITIES AND LOW BAKE PAINTING OVEN — INSURANCE APPROVED



Tram Shed Works, 99a Boundary Street,
Birkdale, Southport.
Telephone: 01704 543630

After Service Hours Breakdown
Number 0860 272658

AA



VICTORIA HALL7.00 p.m. Monday, Tuesday, Wednesday, Thursday
Location of Hall : Victoria Hall, Timms Lane, Freshfield.
General Secretary : Mrs. R. Foreman, 21 Harebell Close, Formby. Tel. 833783
Match Secretary : Mrs. L. McMorran, 27 Timms Lane, Freshfield. Tel. 874898

WEST END PARK7.00 p.m. Monday (St. Johns) 7.30 p.m. (KGV) Monday & Wednesday
Location of Halls : King George V College, Scarisbrick New Road, Southport.
St. John's Church Hall, St. John's Road, Southport.
General Secretary : M. Howard, 4 Grange Road, Southport. Tel. 532354
Match Secretary : S. Mann, 81 Chester Road, Southport. Tel. 211676

WOODVALE7.00 p.m. (URC Hall) Wednesday, Thursday
7.30 p.m. Monday & Wednesday
Location of Halls : United Reformed Church Hall, Grosvenor Road, Southport.
Southport Hospital, Town Lane, Southport (Spinal Unit Gym).
General Secretary : Mrs. C. Grice, 20 Dunbar Crescent, Southport. Tel. 564696
Match Secretary : Mrs. B. Miller, 9 Kirklees Road, Southport. Tel. 550129

TRANSFER FEES THROUGHOUT THE SEASON £1.00

Registration Fees:

B.A. of E. Fee Senior or Junior + LCBA Fee + Insurance

£6.90 or £3.45 + £1.30 + £0.50 = £8.70 or £5.25

After 31st October + Late Registration Fee

£8.70 or £5.25 + £1.00 + = £9.70 or £6.25

THE "INFLIGHT" JUNIOR LEAGUE – REGULATIONS

1. The Junior League shall be played in three age groups as follows:-
 - (a) - under 16 years at midnight December 31st.
 - (b) - under 13 years at midnight December 31st.
 - (c) - under 11 years at midnight December 31st.
2. A Club will be allowed a maximum of 3 teams per age group in Junior League events.
3. (a) Each team shall consist of at least two boys and two girls whose ages are within the above.
(b) A senior member of each Club or Organisation entering a team or teams in the Junior League shall be the non-playing captain of each team (1 adult to each team).
(c) No player shall be eligible to play in the Junior League, who is not a bona fide member of the Club for which he/she plays.
4. The Executive Committee shall appoint one of its members to be in charge of all matches played on each particular occasion.
5. (a) Each match will consist of a boys doubles, a girls doubles and two mixed doubles or as decided by the Executive Committee.
(b) No player may play in more than one like event.
(c) No player may play for two or more teams on the same day in each age group. This may be waived at the discretion of the Executive Committee.
(d) Points for matches won and drawn shall be awarded as in the Senior League.
(e) Any Club playing an ineligible player shall, at the discretion of the Executive Committee, forfeit all games and points won by that player while he/she was ineligible.
6. All matches to be played at a central venue to be determined by the Executive Committee on a date and at a time stated by that Committee. Any variation will be at the Executive Committee's discretion.
7. The annual subscription to the Junior League shall be determined by the Executive Committee. This shall be payable before 1st December in the season.
8. Transfers may only be allowed between Clubs with the written agreement of both Clubs. No Club shall have the right to object to the transfer except where the player is not clear on the books of the objecting Club in respect of monies outstanding.
9. No match may be postponed without 24 hrs notice being given to opposing team representative and the officer in charge on the evening concerned.
10. **Eligibility**
All Clubs applying to join the Junior League shall be junior sections of Senior League Clubs or have a base within 15 miles of Southport town centre

6. The Executive:-
 - (a) shall determine the entry fees per player per event;
 - (b) shall determine the date by which entries, accompanied by entry fees, shall be in the hands of the Tournaments & Competitions Officer;
 - (c) shall arrange the seeding, handicapping and draw;
 - (d) shall direct when and where matches shall be played and the disposal of results;
 - (e) shall arrange the finals;
 - (f) shall determine the prizes awarded;
 - (g) may delegate its authority to such Committee as it sees fit;
 - (h) shall have the power to refuse the entry of anyone who in its opinion, is too good a player for the "B" or "C" Tournament;
 - (i) shall have the power to cancel any event in the "B", "C" or "V" Tournaments if, in its opinion, the entry is not sufficient to warrant the event. Five events shall be played in the "A" Tournament;
 - (j) shall deal with any matter not provided for by these regulations and shall be the sole authority for the interpretation thereof.

Gala Millennium Disco Dance

(Including Presentation of League Trophies

April 28th 2000

Clubs please do not forget
Prizes for the Tombola.

LEAGUE A.G.M.

APRIL 26th 2000

**A.G.M. AGENDAS AVAILABLE FROM CLUB
SECRETARIES IN MID-MARCH**

**SOUTHPORT & DISTRICT BADMINTON LEAGUE
WEBSITE AT: <http://www.miller-d.demon.co.uk>**

INDIVIDUAL TOURNAMENTS REGULATIONS

1. (a) At its first meeting each season, the Executive shall consider organising the following tournaments restricted to League members and veteran players who reside locally:-
 Tournament A - Open.
 Tournament B - Moderate Players Tournament. (Minimum standard).
 Tournament C - Restricted Moderate Players Tournament.
 (restricted to moderate players in the fourth and lower divisions).
 Tournament V - Veterans Tournament.
- (b) Each tournament, unless decided otherwise by the Executive, shall consist of:-
 Men's Singles, Ladies Singles.
 Men's Doubles, Ladies Doubles, Mixed Doubles
2. All tournaments shall be run, as far as is practical, in accordance with the B.A. of E's regulations for tournaments and recommendations to tournament committees.
3. (a) All bona-fide players registered with League Clubs shall be eligible to enter the tournament.
- (b) Players shall be seeded in the Open Tournament.
- (c) Tournament B - Moderate Players Tournament
 On the closing date for entries, a player who has been awarded Lancashire county colours or who, during the current season or past season, has played more than once for the Lancashire county first team, shall be debarred from competing in this tournament, except that a player who has been awarded Lancashire county colours may be eligible to compete at the discretion of the Executive provided that four clear seasons have elapsed since his or her last appearance for Lancashire county first team in the Inter County Championship. Players who have been awarded any other county's colours, or who have played for any other county first team, may be eligible to compete at the discretion of the Executive.
- (d) If a player, excluding a recognised floater, has played during the current season 4 or more times in a 3rd division or higher division team in League, Cup or Shield matches at the closing date for entries, he/she will not be eligible for the 'C' Tournament.
- (e) Veteran competitors shall conform to the following criteria:-
 Tournament 'V1': 40 years and over before the tournament closing date.
 Tournament 'V2': 50 years and over before the tournament closing date.
 Those eligible for Tournament 'V2' may also enter Tournament 'V1'.
- (f) In the A, B and C Tournaments, all players shall have played at least ten matches for their clubs during the current or previous seasons or otherwise at the discretion of the League Executive.
4. Entry shall be on forms obtainable from the Tournaments Officer.
5. Unless decided otherwise by the Executive, matches shall consist of games of 15 aces (ladies singles-11 aces), the side first winning two games being the winner.

11. (a) All junior club members wishing to play in the Junior League and Individual Tournaments must be registered and insured. Registration forms will be distributed by the Junior League Committee.
- (b) Any variation will be at the Junior League Committee's discretion.

12. Cup Competitions

- (a) Each match shall consist of one of each of the following, boys singles, girls singles, boys doubles, girls doubles and mixed doubles.
- (b) The boy and the girl who play singles events shall not be eligible to play the mixed doubles.

13. Complaints

- (a) The Junior League Committee shall deal with any written complaint arising out of League matches and deal with any matters not provided for in these regulations.
- (b) Any Club shall have the right to appeal to the League Executive Committee on any matter and any such appeal or application hereunder shall be dealt with in such a manner as the Executive Committee may determine, and its decision shall be final.

JUNIOR SECTION

As the section has grown and eligible age groups have varied, the leagues and trophies have similarly varied in who may compete.

The League

Division A (Under 12)

1987-88 Victoria II
 1988-89 Churchtown
 1989-90 Victoria
 1990-91 Hesketh Bank
 1991-93 Churchtown
 1993-95 Victoria
 1995-96 Sacred Heart
 1996-97 Southport
 1997-98 Churchtown
 1998-99 Southport

Division B (Under 14)

1972-83 Southport
 1983-84 Lathom
 1984-85 Southport
 1985-86 Formby Sports
 1986-87 Southport
 1987-88 Victoria II
 1988-90 Southbank Road
 1990-99 Churchtown

Division C (Under 16)

1980-84 Southport
 1984-85 Red Rum
 1985-86 Southport
 1986-87 Red Rum II
 1987-88 Penwortham
 1988-90 Churchtown
 1990-91 Victoria
 1991-92 Hesketh Bank
 1992-99 Churchtown

Competitions

T. R. Highton Cup

1977-79 Churchtown Cong.
 1979-82 Southport
 1982-83 Southbank Road
 1983-88 Southport
 1988-90 Victoria
 1990-92 Hesketh Bank
 1992-93 Southbank Road
 1993-98 Churchtown
 1998-99 Southport

Wesley Cup

1972-73 Churchtown Cong.
 1973-80 Southport
 1980-81 Southbank Road
 1981-87 Southport
 1987-88 Victoria
 1988-89 Southbank Road
 1989-90 Victoria
 1990-91 Churchtown
 1991-92 Southport I
 1992-99 Churchtown

West End Cup

1984-87 Southport
 1987-88 Victoria
 1988-89 Guild Hall
 1989-90 Churchtown
 1990-91 Victoria
 1991-92 Churchtown
 1992-95 Victoria I
 1995-96 Sacred Heart
 1996-97 Southport
 1997-99 Churchtown

ARCADE SPORTS & GAMES

Roller Blades, Classic Games, Crown Green Bowls

•
*Large range of Badminton rackets
and clothing by leading manufacturers
including*

*CARLTON, SLAZENGER, DONNAY,
BROWNING, TALBOT, WILSON, PRINCE,
PRO-KENNEX & YONEX (Specialist)*

•
Stringing Service

•
Extensive range of Badminton Shoes

•
Feathered shuttlecocks at discounted prices

*THE SPORTS SHOP THAT'S RUN FOR BADMINTON
PLAYERS BY BADMINTON PLAYERS*

Cambridge Arcade
LORD STREET, SOUTHPORT
Telephone 532522

REGULATIONS FOR THE WATKINSON TROPHY COMPETITION

1. The competition shall be played annually between all teams in the League on a knockout basis and the Executive shall be responsible for the organisation, including the handicapping and the draw for each round. Entry shall be free and optional.
2. (a) Matches shall be played by teams of four men and four ladies in a similar manner to League matches and within the rules applicable to League matches.
(b) Teams will be handicapped on the standard of their current league team. If a player of a higher standard is included after the handicap has been set, then that team shall forfeit the match.
(c) All teams shall receive a points handicap and scored points plus handicap points shall decide the winner. There shall be no setting.
(d) Team captains shall complete their teams on both copies of the score sheet prior to the start of the match and BOTH SHEETS, duly completed, **must** be returned **by the winners** to the Cups & Shields Officer, within 48 hours of the completion of the match, or the winners may be disqualified.
(e) In the event of a tie on points, games won shall not count and the match shall be replayed on the court of the team playing away in the original match. In the event of a further tie, the captains shall spin a coin to decide the choice of court for the next replay.
3. No player shall play for more than one team in the competition unless an authorised floater approved by the Executive.
4. (a) An eligible substitute, if present at the match at the time of an injury may be used. Such substitution shall be direct, the substitute being assumed to be of an equivalent standard to the injured player. The substitute shall play in all relevant events after and including the event in which the injury occurred. Alternatively an eligible substitute may be summoned to the match without undue delay but may only take part in the injured players subsequent events and all points scored by a substitute shall count to the teams advantage.
(b) Substitution as described in Rule 4(a) shall only be permitted provided the injury was caused entirely after play in the match had begun and was not due to tiredness or the worsening of an existing ailment.
(c) Once replaced by a substitute, an injured player shall not take part again in the match.
(d) A team may replace an injured player with an ineligible player subject to the approval of the opposing captain. Such substitution shall be direct as in regulation 4(a) above but all games involving the ineligible player shall be deemed to be lost with the ineligible player failing to score.
5. (a) Exceptionally an ineligible player may be played at 4th mixed doubles and 2nd men's/ladies doubles but the opposing team captain must be told prior to the start of the match.
(b) The scores in each game shall count as 15-0 to the opposing team.
(c) If an ineligible player is played other than as stated in 4 or 5(a) then the match shall be forfeited to the opposing team.
6. The Executive shall:-
 - (a) arrange the venue for the final.
 - (b) appoint a referee for the final who shall have full charge of the match, including the order of play.
 - (c) deal with any matter not provided for in these regulations.
 - (d) be the sole authority for the interpretation of these regulations.



Bispham Road Pharmacy

84 BISPHAM ROAD
SOUTHPORT
MERSEYSIDE • PR9 7DF

TELEPHONE: (01704) 506006

FAX: (01704) 507151

V.A.T. No. 636 4211 56

OUT OF WORK HOURS
TEL: (01704) 573938

Pharmacy Proprietor:
Mr. TONY WOOLLEY, BSc. (HONS.), M.R.PHARM.S.

DIVISIONAL CHAMPIONS

As the League has expanded and its structure been revised, the divisional shields have also been adapted accordingly.

CHAMPIONSHIP SHIELD (1st Division)

1970-76 Southport Hawks
1976-77 Wainwright
1977-78 The Park
1978-99 Southport

BLOWICK SHIELD (Division 4A)

1989-90 Our Lady's II
1990-91 Freshfield III
1991-92 Pioneers II
1992-93 Burscough II
1993-94 Feathers I
1994-95 Woodvale III
1995-96 Phoenix II
1996-97 Pioneers III
1997-98 Southport V
1998-99 Formby II

CHURCHTOWN B.C. SHIELD (Division 6)

1989-90 Woodvale IV
1990-91 Sandgrounders III
1991-92 Range III
1992-93 Phoenix III
1993-94 St. Cuthberts III
1994-95 Tarleton V
1995-96 Formby Ravens
1996-97 St. Cuthberts III
1997-98 Churchtown IV
1998-99 Formby VI

BLAKEMAN TROPHY (2nd Division)

1988-89 Park
1989-90 Freshfield II
1990-91 Mawdesley
1991-92 Hoole
1992-93 Mawdesley
1993-95 Southport III
1995-96 Woodvale
1996-97 Pioneers
1997-98 St. Peters
1998-99 Southport III

ST. CUTHBERT'S SHIELD (Division 4B)

1989-90 Southport IV
1990-91 Formby
1991-92 Duke Street II
1992-93 Hesketh Bank
1993-94 Formby I
1994-95 Formby II
1995-96 Churchtown III
1996-97 Burscough IV
1997-98 Sandgrounders II
1998-99 Formby III

KEW SHIELD (Division 7)

1984-85 S.P.H.
1985-86 Churchtown IV
1986-87 Lathom
1987-88 Formby IV
1988-89 Mawdesley IV
1989-90 Hoole III
1990-91 Park V
1991-92 Hoole IV
1992-93 Southport X
1993-94 Sacred Heart
1994-95 Woodvale VI
1995-96 -
1996-97 Formby VII
1997-98 Formby Methodist II

WILF KIME SHIELD (Division 3A)

1989-90 Phoenix
1990-91 Pioneers
1991-92 St. Peters III
1992-93 Phoenix
1993-94 Southport IV
1994-95 Mawdesley II
1995-96 Phoenix
1996-97 Tarleton
1997-98 Formby
1998-99 Woodvale III

PANTHERS SHIELD (Division 5A)

1989-90 Duke Street II
1990-91 Hoole
1991-92 Hesketh Bank
1992-93 St. Cuthbert's II
1993-94 Hoole III
1994-95 Tarleton III
1995-96 Woodvale IV
1996-97 St. Cuthberts II
1997-98 Southport VI
1998-99 Formby Methodist

RIGBY SHIELD (Division 3B)

1989-90 Churchtown II
1990-91 Duke Street
1991-92 Southport III
1992-93 Burscough
1993-94 Woodvale II
1994-95 Hoole II
1995-96 West End Park II
1996-97 Feathers
1997-98 Southport IV
1998-99 Ainsdale

RONNIE SIMM SHIELD (Division 5B)

1989-90 Pioneers III
1990-91 Ormskirk II
1991-92 Trafalgar
1992-93 Sandgrounders III
1993-94 Southport VI
1994-95 Burscough IV
1995-96 Tarleton IV
1996-97 Formby Ravens
1997-98 Pioneers IV
1998-99 Ainsdale III

MENTHA & HALSALL LTD

D.I.Y. DEPARTMENT

FREE PARKING

*FOR ALL YOUR D.I.Y. NEEDS COME
TO OUR WORKS WHERE WE HAVE
EVERYTHING YOU REQUIRE.*

**ALL SOFTWOODS, HARDWOODS,
PLYWOODS ETC.**

**1,000's Sq. Ft. LAMINATE, ALUMINIUM,
POST-FORMED WORKTOPS.
CUT TO SIZE**



CONTACT:
D. LITTLEWOOD



**79 LINAKER STREET, SOUTHPORT,
MERSEYSIDE**

Telephone: (01704) 530800

6. (a) If a player is injured during a match and unable to continue, the score in the game in which the injury occurred shall:

(i) if the game were completed, stand.

(ii) if the games were not completed, be recorded as a win for the opposing team with the injured player's team being credited with the score at the time of injury, subject to regulation 6(b) below.

(b) An eligible substitute, if present at the match at the time of an injury may be used. Such substitution shall be direct, the substitute being assumed to be of an equivalent standard to the injured player. The substitute shall play in all relevant events after and including the event in which the injury occurred. Alternatively an eligible substitute may be summoned to the match without undue delay but may only take part in the injured players subsequent events and all points scored by a substitute shall count to the teams advantage.

(c) A team may replace an injured player with an ineligible player subject to the approval of the opposing captain. Such substitution shall be direct but all games involving the ineligible player shall be deemed to be lost with the ineligible player failing to score

(d) Substitution as described in Rule 6(b) shall only be permitted provided the injury was caused entirely after play in the match had begun and was not due to tiredness or the worsening of an existing ailment.

(e) Once replaced by a substitute, an injured player shall not take part again in the match.

7. Teams will be handicapped on the standard of their current League team. If a player of a higher standard is included after the handicap has been set, then that team shall forfeit the match.

8. The League Executive shall:

(a) arrange the venue for each final.

(b) appoint a referee to each final who shall have full charge of the match including the order of play.

(c) deal with any matter not provided for in these regulations.

(d) be the sole authority for the interpretation of these regulations.

LEAGUE A.G.M.

APRIL 26th 2000

**A.G.M. AGENDAS AVAILABLE FROM CLUB
SECRETARIES IN MID-MARCH**

THE SHIELDS
COMPETITION REGULATIONS

1. The competition shall be played annually between League teams on a knockout basis and the League Executive shall be responsible for the organisation including the allocation of teams to competitions, handicapping and the draw for each round.

2. (a) Matches shall be played by teams of 4 men and 4 ladies, playing three mixed doubles, three men's doubles and three ladies doubles, each event to consist of one game of 21 aces. There shall be no setting.

(b) Team captains shall complete their teams on both copies of the score sheet prior to the start of the match and BOTH SHEETS, duly completed, **must** be returned **by the winners** to the Cups & Shields Officer, within 48 hours of the completion of the match, or the winners may be disqualified.

(c) In each team three men and three ladies will form three mixed doubles pairs which shall play in order of strength. The remaining man/lady shall play in turn with the three men/ladies who played in the mixed events to play three men's/ladies doubles which also shall be played in order of strength.

(d) Where an ineligible player is played, that player shall play third mixed and third men's/ladies doubles.

(e) Games involving an ineligible player shall be deemed to have been lost and the ineligible player not to have scored. The score will appear on the score sheet to the handicap played e.g. 21:minus 5; 21:0; 21:5.

(f) If a team plays an ineligible player other than as stated in regulations 2(d) or 6(c), then that team shall forfeit the match.

3. (a) No player selected to play in a particular match shall be eligible to play in the match unless he or she is present and ready to play by 8.15 p.m. This may be extended to 8.30 p.m. by mutual agreement.

(b) All players in the competition shall be registered members of the League.

(c) No player may play in more than one team in the competition unless an authorised floater.

(d) Any player, unless an authorised floater or excepted player, having played during the current season two or more times for a team, may not play in any lower divisional competition.

(e) Excepted player. Subject to obtaining the prior approval of the competition secretary, any player promoted to a higher club team, having played in a lower competition team, may continue as a member of the lower competition team for the current season and shall be known as an Excepted Player.

4. (a) It shall be the sole responsibility of the home team to decide on which night during the appointed week the match shall be played.

(b) The home team shall give at least 7 days notice to their opponents.

(c) All matches shall start at 7.00 p.m. unless mutually agreed otherwise.

5. (a) The order of play, unless mutually agreed otherwise, shall be 1st, 2nd & 3rd Mixed Doubles. The order of play in the Men's and Ladies Doubles shall be in accordance with the requirements of the home team captain except in the final round.

(b) A player asked to play consecutive games is entitled to a 10 minute break between games.

FINAL LEAGUE TABLES 1998/99

	P	W	W/D	L/D	L	F	A	Pts
Division One								
Southport	18	17	0	1	0	243	45	52
Victoria Hall	18	16	0	1	1	227	61	49
Southport II	18	13	1	0	4	171	117	41
Churchtown	18	9	0	2	7	170	118	29
West End Park	18	8	1	0	9	130	158	26
Woodvale	18	8	0	0	10	143	145	24
Southbank Road	18	5	3	0	10	123	165	21
Victoria Hall II	18	4	0	3	11	113	175	15
Mawdesley	18	4	0	0	14	90	198	12
Burscough	18	0	0	0	18	30	258	0

Division Two								
Southport III	18	18	0	0	0	245	43	54
Victoria Hall III	18	12	0	0	6	170	118	36
Mawdesley II	18	11	1	1	5	148	140	36
Woodvale II	18	11	0	0	7	168	120	33
Pioneers	18	11	0	0	7	153	135	33
Tarleton	18	7	2	1	8	142	146	26
West End Park II	18	7	2	0	9	129	159	25
Southport IV	18	6	0	2	10	128	160	20
Formby	18	1	0	2	15	92	196	5
Phoenix	18	0	1	0	17	65	223	2

Division Three 'A'								
Woodvale III	18	16	0	0	2	200	88	48
Churchtown II	18	15	0	0	3	203	85	45
Victoria Hall IV	18	13	0	1	4	172	116	40
Hesketh Bank	18	11	1	1	5	179	109	36
St. Cuthberts	18	10	1	0	7	168	120	32
Hoole	18	6	0	0	12	128	160	18
West End Park III	18	6	0	0	12	107	181	18
Southport V	18	5	0	1	12	119	169	16
Burscough II	18	4	0	1	13	109	179	13
Sacred Heart	18	0	2	0	16	55	233	4

Churchtown Decorators

**CRAFTSMANSHIP IN PRIVATE &
COMMERCIAL DECOR**

*WE WOULD BE PLEASED TO
SUBMIT OUR FREE
TENDER FOR ANY DECORATIONS
YOU WISH TO BE
CARRIED OUT*



**CONTACT:
D. WRIGHT**



**79a LINAKER STREET,
SOUTHPORT, MERSEYSIDE.
Telephone: (01704) 537019**

6. (a) Exceptionally, an ineligible player must be played at 4th mixed doubles and 2nd men's/ladies doubles but the opposing team captain must be told prior to the start of the match.
- (b) The scores in each game shall count as 9-0 to the opposing team.
- (c) If an ineligible player is played other than as stated in 6 (a) then the match shall be forfeited to the opposing team.
7. The Executive shall:-
 - (a) arrange the venue for each final.
 - (b) appoint a referee in each final who shall have full charge of the match, including the order of play.
 - (c) deal with any matter not provided for in these regulations.
 - (d) be the sole authority for the interpretation of these regulations.

NOTES

.....

.....

.....

.....

.....

.....

.....

.....

.....

.....

.....

.....

.....

.....

.....

.....

.....

.....

.....

.....

.....

.....

**THE CUPS,
COMPETITION REGULATIONS**

1. The competitions shall be played annually between teams in the League on a knock-out basis and the League Executive shall be responsible for the organisation, including seeding and the draw for each round.
2. (a) Teams in the First division and any club that does not have a team in the First division but wishes to enter a representative team, shall be given free entry to the Hudson Cup competition.
- (b) Teams in the second and lower divisions shall be given free entry to the Hackney, St. Pauls, West End, St. Simon & St. Jude and Frank Simpson Cup competitions and the Executive, at their first meeting each season, shall decide which teams shall enter each competition.
3. (a) Matches, which shall be decided on points only, shall consist of four mixed doubles, two mens doubles and two ladies doubles, all consisting of three games to nine points, with no setting, change of ends at 5 points in the third game. In all other respects matches will be played within the rules applicable to league matches.
- (b) Team captains shall complete their teams on both copies of the score sheet prior to the start of the match and BOTH SHEETS, duly completed **must** be returned **by the winners** to the Cups and Shields Officer within 48 hours of the completion of the match, or the winners may be disqualified.
- (c) In the event of a tie the match shall be replayed on the court of the team playing away in the original match. In the event of a further tie, the captains shall spin a coin to decide the choice of the court for the next replay.
4. (a) No player may play in more than one of the Hackney, St. Pauls, West End, St. Simon & St. Jude and Frank Simpson Cups or in more than one team in each Cup Competition unless a registered floater approved by the Executive.
- (b) No player may play for more than one club in the Cup Competitions.
- (c) Any player being nominated for a club team at the beginning of the season may not play in a lower team cup competition for that club.
- (d) Any player, unless an authorised floater or excepted player, having played during the current season two or more times for a team, may not play in any lower divisional competition.
- (e) Excepted player. Subject to obtaining the prior approval of the competition secretary, any player promoted to a higher club team, having played in a lower competition team, may continue as a member of the lower competition team for the current season and shall be known as an Excepted Player
5. (a) It shall be the sole responsibility of the home team to decide on which night during the appointed week the match shall be played.
- (b) The home team shall give at least 7 days notice to the visiting team and advise their opponents which will be the first two events played.
- (c) All matches shall start at 7.00 p.m. unless mutually agreed otherwise.

	P	W	W/D	L/D	L	F	A	Pts
Division Three 'B'								
Ainsdale <i>Back</i>	18	17	1	0	0	230	58	53
Pioneers II	18	14	1	1	2	188	100	45
Ormskirk	18	11	0	2	5	160	128	35
Southbank Road II	18	8	3	2	5	166	122	32
St. Cuthberts II	18	8	1	1	8	131	157	27
Victoria Hall V	18	7	1	2	8	131	157	25
Churchtown III	18	5	1	1	11	126	162	18
Tarleton II	18	3	3	1	11	120	168	16
Sandgrounders	18	3	0	1	14	94	194	10
Phoenix II	18	3	0	0	15	94	194	9
Division Four 'A'								
Fomby II <i>Back</i>	16	15	0	0	1	192	64	45
Woodvale IV	16	13	0	1	2	191	65	40
Ainsdale II	16	9	3	0	4	158	98	33
Victoria Hall VI	16	9	2	1	4	152	104	32
Pioneers III	16	8	0	1	7	145	111	25
Sandgrounders II	16	5	1	1	9	96	160	18
Southport VI	16	4	0	1	11	106	150	13
Southbank Road III	16	2	0	1	13	62	194	7
Tarleton IV	16	1	0	0	15	50	206	3
Division Four 'B'								
Formby III <i>Back</i>	18	16	1	0	1	221	67	50
Woodvale V	18	15	0	0	3	182	106	45
All Souls	18	11	2	2	3	196	92	39
Pioneers IV	18	10	1	0	7	150	138	32
Tarleton III	18	7	1	2	8	130	158	25
Victoria Hall VII	18	5	2	1	10	103	185	20
Sandgrounders III	18	6	0	1	11	117	171	19
Mawdesley III	18	5	1	1	11	129	159	18
Burscough III	18	5	0	2	11	135	153	17
Southport VII	18	1	0	1	16	77	211	4

MARIC TROPHIES



*Quality Trophies
and Engraving*

**Trophies made to your
own specification**

- *Discount to clubs etc.*
- *Collection &
Delivery Service*

**FREE engraving
on all purchases**



**For a free brochure
call us any time on**

(01704) 531798

TEAM KNOCKOUT COMPETITIONS

HUDSON CUP

1970-76 Southport Hawks
1976-77 Wainwright
1977-82 Southport
1982-83 Churchtown
1983-85 Southport
1985-86 Churchtown
1986-96 Southport
1996-97 Freshfield
1997-99 Southport

HACKNEY CUP

1983-84 Freshfield
1984-85 St. Peter's II
1985-87 Southbank II
1987-92 Southport II
1992-93 Mawdesley I
1993-94 Woodvale I
1994-95 Southport III
1995-96 Woodvale
1996-99 Southport III

ST. SIMON & ST. JUDE CUP

1988-89 Our Lady's
1989-90 Hoole
1990-91 Duke Street
1991-92 Southport III
1992-93 Hoole II
1993-94 Woodvale II
1994-95 Mawdesley II
1995-96 Phoenix
1996-98 Formby
1998-99 Woodvale III

ST. PAUL'S CUP

1989-90 Southport V
1990-91 Range
1991-92 Pioneers II
1992-93 Southport V
1993-94 Formby I
1994-95 Formby II
1995-96 Churchtown III
1996-97 West End Park III
1997-98 Southport V
1998-99 Ainsdale II

NAT. GIRO CUP

1989-90 Duke Street II
1990-91 Hoole II
1991-92 Hesketh Bank I
1992-93 St. Cuthbert's II
1993-94 Hoole III
1994-95 Burscough IV
1995-96 Feathers II
1996-97 Formby Ravens
1997-98 Southport VI

WEST END CUP

1989-90 Woodvale IV
1990-91 Hoole III
1991-92 Woodvale V
1992-93 Hoole IV
1993-94 Burscough IV
1994-95 Hesketh Bank II
1995-96 All Souls II
1996-97 St. Cuthberts III
1997-98 Churchtown IV
1998-99 Woodvale VII

FRANK SIMPSON CUP

1989-90 Hoole III
1990-91 The Park V
1991-92 Feathers IV
1992-93 Southport X
1993-94 Sacred Heart II
1994-95 Tarleton V
1995-96 Pioneers V
1996-97 Formby VII
1997-98 Sandgrounders V
1998-99 Ainsdale III

OTHER AWARDS

THE RAYNOR TROPHY

1989-90 Hesketh Bank II
1990-91 Tarleton
1991-92 Formby Meth
1992-93 Formby Ravens II
1993-94 Tarleton IV
1994-95 Phoenix III
1995-96 St Peters IV
1996-97 Sacred Heart II
1997-98 Freshfield
1998-99 Victoria Hall III



OSIRIS ANTIQUES
DECORATIVE ARTS
&
FASHIONS
1880 ~ 1960

PERIOD CLOTHING
LINENS.
LACE TABLE-CLOTHS
EARLY TEXTILES
JEWELLERY.
GLASSWARE.
POTTERY
SILVER.
OLD TOYS
LIGHT FITTINGS
FURNITURE.

WE WISH TO BUY
ALL OF THE
ABOVE ITEMS.

104 SHAKESPEARE STREET
SOUTHPORT 500991
HOME 560418

	P	W	W/D	L/D	L	F	A	Pts
Division Five 'A'								
Formby Meth <i>Back</i>	18	15	1	0	2	214	74	47
St. Cuthberts III	18	15	0	2	1	211	77	47
Woodvale VI	18	15	0	1	2	209	79	46
Ainsdale IV	18	11	1	0	6	181	107	35
Southport VIII	18	9	0	1	8	158	130	28
West End Park V	18	7	0	0	11	101	187	21
Fomby V	18	4	1	1	12	102	186	15
Mawdesley IV	18	4	0	0	14	73	215	12
All Souls II	18	3	1	0	14	104	184	11
Sacred Heart II	18	2	0	1	15	87	201	7

Division Five 'B'								
Ainsdale III <i>Back</i>	18	18	0	0	0	247	41	54
West End Park IV	18	14	0	1	3	208	80	43
Churchtown IV	18	12	1	0	5	163	125	38
Formby IV	18	12	0	0	6	179	109	36
Tarleton V	18	8	1	1	8	130	158	27
Phoenix III	18	7	0	0	11	132	156	21
Ormskirk II	18	6	1	0	11	118	170	20
Hesketh Bank II	18	5	1	1	11	118	170	18
Sandgrounders IV	18	2	0	1	15	75	213	7
Ainsdale V	18	2	0	0	16	70	218	6

Division Six								
Formby VI ✓	14	14	0	0	0	206	18	42
Woodvale VII	14	12	0	0	2	164	60	36
Formby Meth II	14	8	0	1	5	116	108	25
Woodvale VIII	14	6	1	0	7	109	115	20
St. Cuthberts IV	14	6	0	1	7	111	113	19
Sandgrounders V	14	3	3	0	8	78	146	15
Southport IX	14	3	0	1	10	69	155	10
West End Park VI	14	0	0	1	13	43	181	1

UMPIRES

The Badminton Umpires Association of England Accredited Umpires are:

M. Banham, D. Bradley, Miss J. Cook, P. Duncan, R. Grindlay, Miss S. Grindlay, N. Haywood, K. Hughes, G. Perry, J. Sinclair.

The Southport and District Badminton League Accredited Umpires are:

J. Henderson, N. Marshall.

Accredited Umpires may be used in all Cups, Shields and Trophy Finals, in the Jack Blockley A, B, C and V Tournaments, and in any other event as the League may decide.

Umpires may appear at any match or event in an advisory capacity or as the League may decide.

Clubs may request the attendance of Umpires but this will only occasionally be possible and must not be assumed.

League members interested in Umpiring should contact Malcolm Banham (Tel. 547917).

9. SERVICE

9.1 In a Correct service:

- 9.1.1 neither side shall cause undue delay to the delivery of the service once server and receiver have taken up their respective positions;
- 9.1.2 the server and receiver shall stand within diagonally opposite service courts without touching the boundary lines of these service courts;
- 9.1.3 some part of both feet of the server and receiver must remain in contact with the surface of the court in a stationary position from the start of the service (Law 9.4) until the service is delivered (Law 9.6);
- 9.1.4 the server's racket shall initially hit the base of the shuttle;
- 9.1.5 the whole shuttle shall be below the server's waist at the instant of being hit by the server's racket;
- 9.1.6 the shaft of the server's racket at the instant of hitting the shuttle shall be pointing in a downward direction to such an extent that the whole of the head of the racket is discernibly below the whole of the server's hand holding the racket as in Diagram D;
- 9.1.7 the movement of the server's racket must continue forwards after the start of the service (Law 9.4) until the service is delivered; and
- 9.1.8 the flight of the shuttle shall be upwards from the server's racket to pass over the net so that, if not intercepted, it lands in the receiver's service court (ie on or within the boundary lines).

9.2 If a service is not correct by virtue of any of Laws 9.1.1 to 9.1.8, it shall be a 'fault' (Law 13) by the offending side.

9.3 It is a 'fault' if the server, in attempting to serve, misses the shuttle.

9.4 Once the players have taken their positions, the first forward movement of the server's racket head is the start of the service.

9.5 The server shall not serve before the receiver is ready but the receiver shall be considered to have been ready if a return of service is attempted.

9.6 Once the service is started (Law 9.4), it is delivered when the shuttle is hit by the server's racket or, in attempting to serve, the server misses the shuttle.

9.7 In doubles, the partners may take up any positions which do not unsight the opposing server or receiver.

TEAM HANDICAP COMPETITIONS

THE FLEETWOOD HESKETH SHIELD

1988-89 West End
1989-90 Churchtown
1990-91 Woodvale
1991-92 West End
1992-94 Churchtown
1994-95 Southport IV
1995-96 Burscough
1996-97 Churchtown
1997-98 Southbank II
1998-99 Southport III

THE LEAGUE SHIELD

1989-90 Ormskirk
1990-91 Southport IV
1991-92 Woodvale II
1992-93 Formby
1993-94 Our Ladys
1994-95 Burscough II
1995-96 St Cuthberts
1996-97 Formby II
1997-98 Woodvale III
1998-99 West End Park III

FRANK SIMPSON SHIELD

1989-90 Hoole III
1990-91 Sacred Heart III
1991-92 Woodvale VII
1992-93 Range V
1993-94 Sandgrounders V
1994-95 Pioneers IV
1995-96 Formby Meths II
1996-97 West End Park V
1997-98 Formby Meths II
1998-99 Sacred Heart II

ST. JOHN'S SHIELD

1989-90 Phoenix II
1990-91 Hesketh Bank
1991-92 All Souls
1992-93 Sandgrounders II
1993-94 Feathers
1994-95 Trafalgar
1995-96 Sandgrounders II
1996-97 Burscough III
1997-98 Woodvale V
1998-99 Tarleton IV

BARCLAYS BANK SHIELD

1988-89 Churchtown IV
1989-90 Formby IV
1990-91 Woodvale IV
1991-92 Mawdesley III
1992-93 Southbank V
1993-94 Woodvale V
1994-95 Formby IV
1995-96 Churchtown IV
1996-97 Formby Ravens
1997-98 Ormskirk II

SOUTHPORT B.C. SHIELD

1989-90 Formby Meth. II
1990-91 St. Cuthbert's IV
1991-92 Trafalgar II
1992-93 Range IV
1993-94 Pioneers IV
1994-95 Formby Ravens II
1995-96 Woodvale VIII
1996-97 Trafalgar II
1997-98 West End Park V
1998-99 Woodvale VIII

THE WATKINSON TROPHY

1989-90 The Park VI
1990-91 Formby Meth.
1991-92 Woodvale
1992-93 Burscough II
1993-94 Churchtown
1994-95 Woodvale VI
1995-96 Southport V
1996-97 Hesketh Bank
1997-98 Churchtown IV
1998-99 Pioneers III

Jobi Shuttles



they
could
be the
only
friend
you
have!



Customer care rates highly on our agenda, subsequently all shuttlecocks can be returned for a full refund should any problems arise. Orders can be made in writing or telephoned.

Order now tel: 0151 286 1290

Jobi International
THEY TAKE SOME BEATING

92/94 Priory Road Anfield Liverpool L4 2SH
Tel: 0151 286 1290

DIAGRAM D

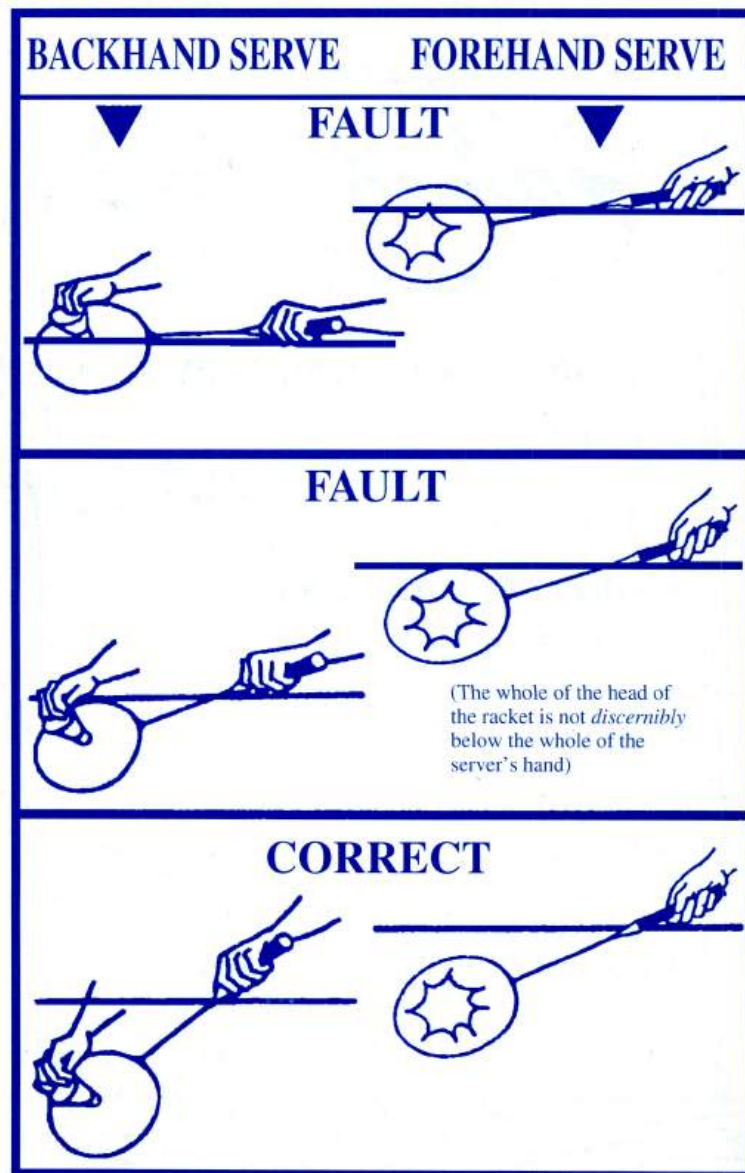

Fabus Art

Picture Frames and Gallery

- BESPOKE FRAMING SERVICE
- PRINTS
- MIRRORS
- ORIGINAL WORKS BY LOCAL ARTISTS
- GREETINGS CARDS

Two Locations:

49 Eastbank Street
Southport

Tel: 530700

51 Piercefield Road
Formby
(near The Grapes)
Tel: 834559

20% discount on production of this handbook



**“Our sports
coverage
goes further
than the Shuttle”**

**SOUTHPORT
VISITER**

Order a copy at your Newsagent

6. **Divisional Champions, Promotion and Relegation**
- 6.1 Promotion and relegation shall be decided by the Executive at its first meeting.
- 6.2 The team securing most points in each division shall be the champion team of that division and shall be entitled to the custody of the championship trophy of that division until the succeeding annual general meeting.
- 6.3 Points shall be awarded as follows:-
- 3 points for a win on games irrespective of aces
 - 2 points for a tie on games and a win on aces
 - 1 point for a tie on games and a tie on aces
 - 1 point for a tie on games and a loss on aces
- 6.4 Where two teams secure the same number of points, the number of games won shall be the deciding factor.
- 6.5 No club may have more than two teams in any division except the lowest.
- 6.6 At least one team from the second and lower divisions shall be promoted subject to rule 6.7 below.
- 6.7 In the event of the champion team of a division being ineligible for promotion under rule 6.5 or 6.8, then the highest placed eligible team(s) may play a challenge match if it wishes against the team(s) with the worst record(s) in the higher division.
- 6.8 A team may not challenge or supersede a senior team from the same club but another team may.
- 6.9 Challenge matches shall be on the senior team's court in the week determined by the Executive.
- 6.10 The Executive shall advise the eligible team of their right to challenge and determine whether the team wishes to do so.
- 6.11 Third division champions promoted. Runners-up play off and winners play third from bottom of second division. The winners of this match play in Division 2 and the losers in Division 3.

LEAGUE A.G.M. APRIL 26th 2000

**A.G.M. AGENDAS AVAILABLE FROM CLUB
SECRETARIES IN MID-MARCH**

TRANSFER FEES THROUGHOUT THE SEASON £1.00

Registration Fees:

B.A. of E. Fee Senior or Junior + LCBA Fee + Insurance

£6.90 or £3.45 + £1.30 + £0.50 = £8.70 or £5.25

After 31st October + Late Registration Fee

£8.70 or £5.25 + £1.00 = £9.70 or £6.25

SHUTTLE TESTING

One thing that most League members seem to agree on is the fact that the overall standard of feathered shuttlecocks is dropping.

Whereas there is little your League Executive can do to influence the quality and consistency of the shuttle manufacturers' product, we can at least try to ensure standardisation of speed.

It would appear that opinions of what speed a shuttle should be and more importantly how to test it vary greatly throughout all the divisions.

In order to clarify precisely what constitutes testing a shuttle we have printed below the relevant extracts from the LAWS OF BADMINTON and included a diagram of distances and tolerances to show where a tested shuttlecock should land from a full underhand stroke which makes contact with the shuttle over the back boundary line. The shuttle shall be hit at an upward angle and in a direction parallel to the sideline.

Optional Testing Marks for Doubles Court
(See Law 1.3)

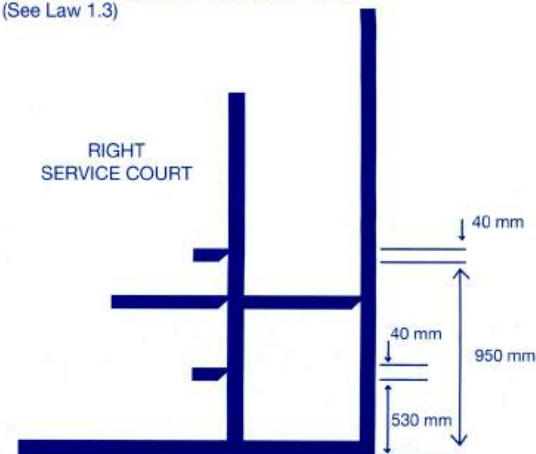

N.B. measurement of marks 40 mm by 40 mm

Leisure Services

Burscough Sports Centre

Mart Lane, Burscough, Tel. 01704 895266

Sports Halls, Fitness Suite, All Weather Courts, Squash Courts, Licensed Bar

Nye Bevan Pool

The Concourse, Skelmersdale, Tel. 01695 727111

Swimming Pools, Fitness Suite, Health Suite

North Meols Community Leisure Centre

Greaves Hall Avenue, Banks, Tel. 01704 212970

Sports Halls, Fitness Suite, All Weather Courts, Meetings Rooms, Licensed Bar

Park Pool

Park Road, Ormskirk, Tel. 01695 576325

Swimming Pools, Fitness Suite, Health Suite, Squash Courts

Skelmersdale Sports Centre

Digmoor Road, Skelmersdale, Tel. 01695 723777

Sports Halls, Fitness Suite, Squash Courts, Licensed Bar

Make the most of Your leisure time!

West Lancashire District Council, Commercial Services, Stanley Way,
Skelmersdale WN8 8EE

3.2 In the event of any occurrence arising under 2.3, the Executive may require both captains to appear before the League Match Committee for the purpose of explanation and may impose on the club found to be at fault such fine or penalty as they may in their absolute discretion deem adequate.

4. Players' Eligibility

4.1 All players participating in League competitions must be registered with the League and be members with League clubs. For registration, each club secretary shall send on the form provided together with required fees, a list of club players to the League Registration Officer before the first match of the season. Additional players may be registered on individual registration forms, together with required fees which must be sent to the League Registration Officer before participating in any match or tournament of any kind. No player may be registered after 31 January in the current season except by permission of the Executive. Each year information about new fees will be sent to each club.

4.2 No player may participate in League competitions until the player's BA of E, LCBA and Insurance fees have been received by the League Registration Officer on behalf of the League Treasurer (see rule 7C).

4.3 Any player having been registered for one club and wishing to play in league matches for another club during the same season may apply to the Executive for a transfer to the last mentioned club. A form of application to transfer must be purchased from the Registration Officer for a fee of £1.00 and must be duly completed and deposited with the Registration Officer not less than 7 days before the first match in which the player intends to play for his/her new club. The player shall not play for the new club until he/she receives notification from the Registration Officer that the transfer has been completed.

4.4 No club shall have the right to object to the registration of any player with another club except where the player is not clear on the books of the objecting club in respect of monies outstanding. Any club wishing to object under this rule must lodge such objection with the League Secretary, in writing, without undue delay, giving full particulars. The suspension by the Executive of any registration under this rule shall be operative only until the defaulting player shall have discharged his/her obligations to the objecting club.

5. Higher Team Play Eligibility and Floaters

5.1 Where a club has more than one team, whether in the same or different divisions, a player, having played in a club team on more than one occasion, or in two higher teams on one occasion each, is thereby debarred from playing in any lower ranked team.

5.2 However, the Executive may transfer down such a player from one team to another on application being made for that purpose but only one transfer shall be allowed in a season in respect of such a player. Such transfer shall be free. After such transfer has been made, a player may play for a higher ranked team on one further occasion. Upon playing on a second occasion rule 5.1 becomes operative.

5.3 A club shall have the right to nominate to the Executive not later than three weeks after the first Monday of the season the names of one lady and one gentleman from their lower team or from each of their lower teams, and upon being approved by the Executive, these players shall not during that season be subject to the provision of rule 5.1. Such players shall be known as "floaters" and may only float up.

5.4 No club shall be permitted to use floaters on a permanent basis except between their bottom two teams.

5.5 The decision of the Executive regarding any application under rule 5.2 or nomination under rule 5.3 above shall be final.

2. **Match**
- 2.1 Each match shall consist of four mixed doubles, two men's doubles and two ladies doubles; each event shall consist of two games of 15 aces. No player, including floaters (see 5), may play more than one like event nor in more than one match in any one night.
- 2.2 Captains must complete their teams on the match score sheet before the start of the match. Pairs must be played in order of strength otherwise, at the discretion of the Executive, events or the match may be forfeited.
- 2.3 The actual time of starting the match must be marked accurately on the score sheet. In the event of any delay arising in the commencement of any match, or any occurrence resulting in the match not being completed the reasons therefore shall be entered on the back of the score sheet and signed by both captains.
- 2.4 Feather shuttlecocks, of a type to be determined by the Executive, shall be used in League matches and competitions except that nylon shuttles may be used by mutual agreement, on request, by giving 14 days prior notice.
- 2.5 In all events organised by the League, coloured clothing may be worn. In order to ensure attractive presentation of badminton, all clothing should be acceptable badminton sports clothing and, wherever possible, doubles partners are asked to try and wear the same colours. Track suits shall not be worn during match play except by agreement of both captains.
- 2.6 The order of play in all events shall be in accordance with the requirements of the home captain.
- 2.7 To be eligible to play in a particular match a player must be present and ready to play by 8.15pm. This may be extended to 8.30pm by mutual agreement on or before the date the match is played. Prior to 8.15pm (extended to 8.30pm by mutual agreement) a team can substitute a player already entered on the match score sheet and who has not yet played in that match provided the substitute is of equal or lesser standard than the player originally named.
- 2.8 Where a player is not present by 8.15pm (extended to 8.30pm by mutual agreement) and a substitute has not been used, as per rule 2.7, then the opposing team captain shall regard all the games in which the absent player would have played as being forfeited. The captain must inform the opposing captain immediately that he/she regards the games of the absent player as forfeited, and the games involved must be entered on the Match Score Sheet as 15.0 and identified by W/o (Walkover).
- 2.9 Where a team plays an ineligible player, that player must play at 4th mixed and 2nd Men's/Ladies Doubles and the opposing captain notified. If a team plays an ineligible player other than as stated, then that team shall forfeit the match.
- 2.10 In the event of any player being incapacitated after play in a match has begun so that he or she cannot continue playing, a captain shall be entitled to include a substitute of an equal or lesser standard in any subsequent event in which the incapacitated player should have taken part provided that the injury or other incapacity was caused entirely after play in the match had begun and was not solely due to tiredness or the worsening of an existing ailment.
- 2.11 Any comments/complaints entered on the reverse of the Match Score Sheet must be acknowledged by way of signature by a representative from both teams, prior to the submission of the Match Score Sheet to the League Match Officer.
- 2.12 In the event of a match not being played it shall NOT be conceded without permission being sought and obtained from the League Match Officer.
3. **Post-match**
- 3.1 The home team shall be responsible for ensuring that the completed score sheet is received by the League Match Officer within 5 days of the match being played. Failure to comply with this rule will result in a penalty not exceeding £20 being imposed by the Executive.

LANCASHIRE COUNTY BADMINTON ASSOCIATION COACHING

The Coach for Southport and District is:

Miss Jane Bridge

The coaching scheme is available to all affiliated clubs and applications should be made to: Miss Jane Bridge. Tel: 01257 - 251650 **OR** (if this number is unavailable) any member of the Executive.

A qualified coach will come to your club to organise sessions to suit your own requirements. The number of sessions can be arranged with the coach.

Costs: The club requesting coaching is responsible for supplying the hall and shuttles (nylon are more economical), and paying the coach's travelling expenses. As the coach probably lives locally these will be minimal.

Should individuals wish to become qualified coaches, please contact your League Chairman who will give you further advice on courses that can be arranged to suit your convenience.

INTERNATIONAL APPEARANCES

Name	
Mrs. S. Sankey, G.B.	1
Mrs. S. Sankey, England	78
Miss J. Wright, England	1

SOUTHPORT LEAGUE PLAYERS (representing Lancashire County 1st Team)

Name	No. of Appearances	Name	No. of Appearances
Mrs. S. Sankey	74	Mrs. D. Vines	24
K. Houldcroft	57	Miss S. Littlewood	15
Mrs. J. Pearson	53	Mrs. A. Abdous	11
E. J. Usher	51	Miss H. Reed	7
Mrs. B. Kime	45	J. Harford	6
Mrs. S. Lindsay	40	R. Marshall	5
Miss J. Wright	39	N. Green	2
P. B. Kime	36	R. C. Jones	2
D. Allen	35	M. Kellet	2
Miss K. Pearson	33	Mrs. V. L. Maxwell	1
M. H. Hill	30	Miss C. Kelly	1



We serve, and our clients return.

From business cards to full colour brochures, our service and quality remains paramount, which is why our company is growing, along with the recognition from our continually satisfied customers.

Tel: 01704 535529
Fax: 01704 543216

ISDN: 01704 547850
Email: print@mitchell-wright.demon.co.uk
Website: www.mitchell-wright.co.uk

BPIF
British Printing Industry Federation



Cert. No. 1298

**Mitchell
& Wright**
PRINTERS LTD

The Print Works, Banastre Road, Southport PR8 5AL.

- H. The League accounts shall be audited within two months of the end of the financial year and shall be available for inspection upon request by any registered League member.
- I. A copy of the final accounts for the financial year just ended shall be produced at the Annual General Meeting and shall be suitably claused if not audited.

8.-APPEALS

Any club or player shall have the right to appeal to the Executive on any matter and any such appeal or other application hereunder shall be dealt with in such manner as the Executive may determine and their decision shall be final.

9.-RULES

Any matter not provided for by these rules shall be dealt with by the Executive who shall also be the sole authority for the interpretation thereof, provided that any decision given by a General Meeting shall be binding. Any addition to, or interpretation of, these rules made by the Executive shall only be operative until the next Annual General Meeting of the League when they shall be reported to such meeting for confirmation or otherwise. No amendment or alteration to these rules shall be made except at a General Meeting.

APPENDIX RULE 5c - COMPETITION

1. **Pre-match**
 - 1.1 All matches shall be played under the Laws of Badminton with each court having a minimum playing standard as decided by the Executive. Unless prior permission to re-arrange a match has been obtained from the League Match Officer, see 1.4, matches shall be played in the particular week appointed by the Executive.
 - 1.2 The home club shall have sole responsibility for deciding which night during the appointed week the match shall be played, what time play shall commence and which two events shall be played first, giving at least 14 days notice to the visiting club. It will be the duty of both clubs to ensure that its players are available for those events at the agreed time.
 - 1.3 All matches shall commence not later than 7pm. In the event of a hall not being available for play at 7pm, prior approval for the use of the hall for matches must be obtained from the Executive.
 - 1.4 Permission to re-arrange a match, which must be obtained by the Match Secretary from the League Match Officer, will only apply in the following circumstances:
 - (a) The Home Club's hall is not available in the week the League fixture is due to be played
 - (b) A Cup, Shield or Trophy match has to be played in the same week as the League Fixture by the home or away team and both matches cannot be played,
 - or
 - (c) A Club's lowest team is unable to field 8 players.
 For re-arranged fixtures under (a), (b) or (c), permission must be sought **as soon as possible**. No postponement will be permitted on the day of the match where (c) applies.
 Failure to comply with this Rule will result in the Executive imposing a penalty not to exceed £20 and/or 3 points being deducted from either or both teams.
 For all re-arranged fixtures due to (c), where the away team seeks such a postponement, a payment of £20 to defray expenses will be made by the away Club to the home Club.
 - 1.5 Matches can only be re-arranged (see 1.4) by Match Secretaries and must be completed within 56 days of the original match date. Failure to comply with this rule will result in a penalty not exceeding £20 being imposed by the Executive on either or both teams and the League Match Officer will direct when and where the match be played.

- (b) All items to be placed on the agenda of the Annual General Meeting, including nominations for office and for the Executive, shall be sent in writing to the General Secretary so as to reach him not later than 28th February in the same year.
- (c) Not less than 14 days notice of any general meeting shall be given. Written notification to each affiliated club secretary, which shall include the agenda for the meeting shall be deemed to be sufficient notice of the Annual General Meeting.
- (d) An Extraordinary General Meeting shall be convened upon a resolution of the League Executive or at the written request to the General Secretary of not less than 20 members being representative of at least 6 member clubs. Such requests shall state the purpose for which the meeting is required and no other business shall be transacted. The meeting shall be held within one month of such requisition being received by the General Secretary and the notice and agenda shall be circulated to all member club secretaries at least 14 days in advance.
- (e) Accidental omission to give the required notice to any Club Secretary shall not invalidate the proceedings at a general meeting.
- (f) All registered players of the League shall be entitled to attend and vote at any general meeting of the League.
- (g) Voting shall be by show of hands unless any 6 persons present, and entitled to vote, demand a ballot.
- (h) No member may vote by proxy.
- (i) No individual may have more than one vote, except the Chairman of a meeting who shall have a casting vote.
- (j) At all General Meetings 20 members entitled to vote shall form a quorum.
- (k) If there is no quorum for:-
 - (i) an Extraordinary General Meeting, the motion(s) on the agenda shall be deemed to have been defeated and the meeting concluded.
 - (ii) an Annual General Meeting, it shall be adjourned and another notification shall be circulated without a time restriction. At the adjourned meeting the members present shall form a quorum.

7.-FINANCE

- A. The Financial year of the League shall end on 31st March.
- B. Annual subscriptions shall be paid by 31st October in each League year. The Club subscriptions are:-
 - (i) League entrance fee (New Clubs only).
 - (ii) Club annual subscription.
 - (iii) Team registration fee.
 - (iv) Junior team registration fee.
 and all rates will be advised by the league treasurer, to every Club Treasurer by the 31st of July of the current season.
- C. No player may participate in any Cup, League, Tournament or Shield event until the player's B.A.E., L.C.B.A. and Insurance fees have been received by the League Treasurer. All rates will be advised to every Club Treasurer by the 31st July of the current season.
- D. All monies due to the League shall be deemed to be owing to the League Treasurer.
- E. Any Club whose annual subscriptions, as in 'B' above, remain unpaid after 31st October each year shall be liable to such a penalty as the Executive may decide.
- F. After 31st October individual registrations will be subject to a **LATE REGISTRATION fee of £1.00 which is in addition to the normal B.A.E., L.C.B.A. and Insurance fees.**
- G. Application to **TRANSFER fee: £1.00.**

THE VERA MAXWELL TROPHY

Nominations may be submitted any time but must be made by February 28th.

Personal nominations, in confidence, from any League member, to anyone on the Review Panel which is:

M. Banham, Mrs. F. Colville, J. Duncan, R. D. Kime and G. Perry.

In considering the award, the Review Panel prefers to recognise the services generously given by those unsung, hard working amateur enthusiasts who do not normally attract general acclaim.

The awards may be for a particular occurrence or for the culmination of many seasons' unrecognised service.

THE VERA MAXWELL TROPHY

1978 J. Blockley
 1979 D. Alderson and F. Simpson
 1980 Mrs. K. Griffiths
 1981 R. H. Simm
 1982 Miss A. Howard
 1983 *No Award Made*
 1984 G. H. Lloyd
 1985 F. Skelly
 1986 *No Award Made*
 1987 J. Henderson
 1988 *No Award Made*
 1989 D. Barton
 1990 P. Isherwood
 1991 Mrs. S. Rimmer
 1992 D. James
 1993 R. Warhurst and K. Breese
 1994 *No Award Made*
 1995 Mrs. T. Pattison and A. Woolley
 1996 Mrs H. Cannon and Mr. R. Cannon
 1997 Mrs. L. Davies
 1998 M. R. E. Hyde
 1999 Mrs. M. Warren and R. Shepherd

MERSEY OIL COMPANY LIMITED

"The Environmentally Friendly Oil Company"

CROWLAND STREET INDUSTRIAL ESTATE,
SOUTHPORT, MERSEYSIDE, PR9 7RJ.

TEL: (01704) 538787 FAX: (01704) 536783

Your Local Supplier of City Diesel and City Red Diesel

COMPETITIVE PRICES
FOR ALL GRADES OF PETROL,
HEATING OIL, DERV, PARAFFIN,
KEROSENE, TRACTOR FUELS, LUBRICANTS,
LOW SULPHUR MERCOSENE,
BULK SUPPLIES, L.P.G.,
PROPANE & BUTANE



PART OF THE SAMUEL COOKE GROUP

4C.

- (iii) All retiring officers shall be eligible for re-election.
- (i) The Executive shall have full power to transact the general business of the League.
- (ii) The Executive shall have the power to:-
 - (a) fill any casual vacancy occurring, including a vacancy under Clause (iv) of this rule but anyone so appointed shall serve only until such time as the original member would have retired by rotation.
 - (b) elect at any time any number of Vice-Presidents of the League, to hold office for such period as the Executive may determine.
 - (c) take any steps which they consider necessary for the purpose of enforcing payment of any subscription or fines payable or imposed under any rules for the time being of the League.
 - (d) admit individuals to League membership.
 - (e) elect Honourary Life Members who may attend meetings of the Executive.
 - (f) appoint and delegate powers to Committees and such Committees may co-opt members to the Committee from outside the Executive provided that the number of co-opted members is always less than the number of members of the Executive on the Committee.
- (iii) The Executive shall meet not less than three times annually. Meetings shall be called at the discretion of the Chairman or at the request in writing of at least six members of the Executive.
- (iv) if any member of the Executive be absent from three consecutive Meetings he may, at the discretion of the Executive be treated as having thereby tendered his resignation.

5.-THE LEAGUE

5A.

General

- (i) The League year for which all officers and Executive members, whether elected, co-opted or substituted, shall hold office, and during which the membership and registration of all clubs and players shall subsist shall be from the 1st day of May in one year to the 30th of April the following year.
- (ii) Application for membership to the League for any year must be delivered in writing to the General Secretary not later than the 30th day of April preceding the year concerned. First applications must be accompanied by the prescribed entrance fee and details of the Club's insurance cover which is compulsory.
- (iii) an annual subscription shall be paid by each member club.
- (iv) where a club has entered a number of teams in the League and then requests permission to withdraw any particular team after the Division has been formed by the Executive such requests may be submitted to the General Purposes Committee for arbitration. The decision of the Executive based on all relevant facts shall be final. The team registration fee and an administration fee, as determined by the Executive, shall be paid.

5B.

Structure

- (i) The League shall consist of such one or more divisions as the Executive shall determine.
- (ii) The Executive shall form each division at its first meeting, when it may reconstitute the divisions.

5C.

Competition - (see Appendix page 35)

6.-GENERAL MEETINGS

(a)

The Annual General Meeting of the League shall be held in the month of April on a day and at a place and time appointed by the Executive for the adoption of the Executive report and final accounts, any alterations to rules, the election of officers and the Executives as required under Rule 4, the election of the Hon. Auditor, and such other business as may be transacted in general meeting.

SOUTHPORT AND DISTRICT BADMINTON LEAGUE RULES

1.-NAME

The League shall be called the Southport and District Badminton League.

2.-OBJECTS

The objects of the League shall be:-

- (a) to promote badminton generally in Southport and District.
- (b) to take any action to further the interests of badminton.
- (c) to ensure that affiliated members observe:-
 - (i) the laws of Badminton
 - (ii) the regulations of the International Badminton Federation and of the Badminton Association of England
 - (iii) the regulations of the Lancashire County Badminton Association.

3.-CONSTITUTION

The League shall be affiliated to the Lancashire County B.A. Members eligible for affiliation to the League at the discretion of the Executive Committee shall be:-

- (a) clubs of which at least one of the objects is badminton and which have their headquarters and courts in Southport and district. The Executive shall determine the effective district boundary.
- (b) Schools and Youth Associations whose member clubs have an age limit of 21 years. Such member clubs need not affiliate themselves directly, but unless so affiliated shall not be entitled to the privileges of affiliation.
- (c) Schools and Youth Clubs whose members have an age limit of 21 years.
- (d) Individuals, known as private members, who shall:-
 - (i) pay an annual subscription
 - (ii) receive copies of all league circulars
 - (iii) be eligible to attend League Meetings
 - (iv) be eligible to vote and hold office
 - (v) be eligible to enter the Veterans Tournament only, subject to the rules of that tournament.
- (e) Honorary Life Members.

Individual members of individual clubs and associations are ipso facto indirect members of the League.

4.-ADMINISTRATION

- 4A.
 - (i) The management of the League shall be vested in an Executive consisting of:-
 - (a) the officers of the League
 - (b) fifteen other members to be elected at the Annual General Meeting, five of whom retire each year in rotation.
 - (ii) Six members shall form a quorum at any committee meeting.
 - (iii) All retiring members of the Executive shall be eligible for re-election.
 - (iv) The Officers of the League upon retirement from office shall be ex-officio Executive for one year unless the Executive shall otherwise decide.
 - (v) The Chairman shall have a casting vote at all meetings of the Executive.
- 4B.
 - (i) The officers of the League shall consist of:-

President	League Match Committee Chairman
Chairman	Cups & Shields Committee Chairman
Vice-Chairman	Tournaments Committee Chairman
General Secretary	League Match Officer
Treasurer	Press Officer
Registration Officer	Sponsorship Officer

INDIVIDUAL OPEN CHAMPIONSHIPS

Men's Singles

1990 N. Tolman
1991 J. Machin
1992 S. Almond
1993 J. Harford
1994 J. Machin
1995 S. Almond
1996 J. Harford
1997 J. Harford
1998 M. Kellett
1999 M. Kellett

Ladies' Singles

1990 Miss S. Littlewood
1991 Miss S. Littlewood
1992 Miss S. Littlewood
1993 Miss J. Wright
1994 Miss J. Wright
1995 Miss J. Wright
1996 Miss D. Tollitt
1997 Miss J. Wright
1998 No Event
1999 Miss J. Long

Men's Doubles

1990 S. Hurst and R. Marshall
1991 S. Hurst and R. Marshall
1992 S. Hurst and R. Marshall
1993 S. Hurst and R. Marshall
1994 J. Machin and K. Balmforth
1995 S. Almond and J. Abdous
1996 S. Hurst and R. Marshall
1997 S. Hurst and R. Marshall
1998 S. Almond and J. Abdous
1999 S. Almond and J. Abdous

Ladies' Doubles

1990 Miss A. Allen & Miss D. Blackledge
1991 Mrs. A. Abdous & Miss D. Blackledge
1992 Mrs. A. Abdous and Mrs. D. Vines
1993 Miss J. Bridge & Miss S. Littlewood
1994 Mrs. S. Sankey and Miss J. Wright
1995 Mrs. S. Sankey and Mrs. D. Rigby
1996 Mrs. S. Sankey and Mrs. D. Rigby
1997 Miss J. Wright and Miss D. Tollitt
1998 Miss J. Wright and Mrs. D. Rigby
1999 Miss C. Clucas and Miss C. Walker

Mixed Doubles

1990 R. Marshall and Miss D. Blackledge
1991 S. Hurst and Mrs. A. Abdous
1992 R. Marshall and Mrs. D. Vines
1993 R. Marshall and Mrs. D. Vines
1994 S. Hurst and Mrs. A. Abdous
1995 S. Almond and Mrs. D. Rigby
1996 J. Harford and Miss J. Wright
1997 J. Harford and Miss J. Wright
1998 S. Almond and Mrs. D. Rigby
1999 S. Almond and Mrs. D. Rigby

GARRYOWEN LTD

SOUTHPORT AND DISTRICT BADMINTON LEAGUE

COMPOSITION OF DIVISIONS FOR 1999/2000 SEASON

Division One

1. Southport
2. Victoria Hall
3. Mawdesley
4. Churchtown
5. Woodvale
6. Southport II
7. Victoria Hall II
8. Mawdesley II
9. West End Park
10. Sand/South

Division Two

1. Southport III
2. Victoria Hall III
3. Burscough
4. West End Park II
5. Woodvale III
6. Ainsdale
7. Tarleton
8. Pioneers
9. Churchtown II
10. Woodvale II

Division Three 'A'

1. Southport V
2. Victoria Hall V
3. Formby
4. Phoenix
5. Woodvale V
6. St. Cuthberts II
7. Hoole
8. Formby III
9. West End Park III
10. Hesketh Bank

Division Three 'B'

1. St. Cuthberts
2. Tarleton II
3. Pioneers II
4. Churchtown III
5. Sand/South II
6. Southport IV
7. Victoria Hall IV
8. Formby II
9. Ormskirk
10. Woodvale IV

Division Four 'A'

1. Ainsdale II
2. St. Cuthberts III
3. Sacred Heart
4. West End Park IV
5. Sand/South IV
6. Southport VI
7. Victoria Hall VI
8. Pioneers III
9. Phoenix II
10. Sand/South VI

Division Four 'B'

1. All Souls
2. Victoria Hall VII
3. Pioneers IV
4. Mawdesley III
5. Sand/South V
6. Ainsdale III
7. Tarleton III
8. Burscough II
9. Formby Meth.
10. Sand/South III

Division Five 'A'

1. Ainsdale IV
2. Tarleton IV
3. Burscough III
4. West End Park V
5. Woodvale VII
6. Southport VIII
7. Formby V
8. Sacred Heart II
9. Mawdesley IV
10. Sand/South VII

Division Five 'B'

1. Southport VII
2. Formby VI
3. Formby IV
4. Ormskirk II
5. Hesketh Bank II
6. All Souls II
7. Tarleton V
8. Phoenix III
9. Churchtown IV
10. Woodvale VI

Division Six

1. Southport IX
2. Sacred Heart III
3. Phoenix IV
4. Formby Meth II
5. Sand/South VIII
6. Ainsdale V
7. St. Cuthberts IV
8. Burscough IV
9. West End Park VI
10. Woodvale VIII

INTERNATIONAL SETTING RULE

1. No setting at 13 all or 9 all (ladies singles)
2. Setting only at 14 all or 10 all (ladies singles)
3. Scoring does not return to "Love-All"
4. Scoring proceeds 15,16,17 and 11,12,13 (ladies singles)
5. 3 Points are played in all cases
6. Option of playing "Straight Through" is still available

CUPS, SHIELDS and TOURNAMENTS

LEAGUE FIXTURES - DIVISIONS 1 TO 6

		Week Beginning					
		September					
1999	L1 L2	CUPS – Preliminary Round	13	-	-	-	-
			20	1 v 2	7 v 6	5 v 3	8 v 10
			27	3 v 1	6 v 8	2 v 7	4 v 5
		October					
L3 L4	CUPS – Round 1 A, V & JB TOURNAMENT Entries by 16.10.99	4	-	-	-	-	
		11	1 v 4	9 v 6	5 v 10	2 v 3	
		18	5 v 1	6 v 10	3 v 8	4 v 2	
		WATKINSON – Preliminary Round	25	-	-	-	
			November				
L5 L6	CUPS – Round 2 A, V & JB TOURNAMENTS		1	1 v 6	3 v 4	2 v 5	9 v 8
		8	7 v 1	6 v 5	8 v 2	10 v 4	
		15	-	-	-	-	
L7	CUPS – Semi-Finals WATKINSON – Round 1 Cup Competition Trophies - All to be returned fully engraved	22	1 v 8	4 v 6	2 v 9	3 v 10	
		29	-	-	-	-	
		December					
L8	CUPS – Finals & SHIELDS – Preliminary by 7.1.00	6	9 v 1	6 v 3	10 v 2	8 v 5	
		13	-	-	-	-	
		20	-	-	-	-	
		WATKINSON – Round 2 by 14.1.00	27	-	-	-	
			January				
2000	L9 L10 L11		3	1 v 10	2 v 6	3 v 7	4 v 8
		10	2 v 1	6 v 7	3 v 5	10 v 8	
		17	1 v 3	8 v 6	7 v 2	5 v 4	
L12	SHIELDS – Round 1 WATKINSON – Round 3	24	-	-	-	-	
		31	4 v 1	6 v 9	10 v 5	3 v 2	
		February					
L13	C TOURNAMENT B TOURNAMENT Entries by 19.2.00 SHIELDS – Round 2 & WATKINSON – Round 4	7	1 v 5	10 v 6	8 v 3	2 v 4	
		14	-	-	-	-	
		21	-	-	-	-	
L14		28	6 v 1	4 v 3	5 v 2	8 v 9	
		March					
		6	1 v 7	5 v 6	2 v 8	4 v 10	
L15 L16 L17	SHIELDS & WATKINSON – Semi-Finals B TOURNAMENT	13	8 v 1	6 v 4	9 v 2	10 v 3	
		20	-	-	-	-	
		27	1 v 9	3 v 6	2 v 10	5 v 8	
		April					
L18	SHIELDS & WATKINSON – Finals DIVISIONAL PLAY-OFFS	3	10 v 1	6 v 2	7 v 3	8 v 4	
		10	-	-	-	-	
		17	-	-	-	-	

N.B. - LEAGUE TOURNAMENTS MAY START THE WEEKEND PRIOR.
- GOOD FRIDAY - 21st APRIL 2000
- LEAGUE A.G.M. - 26th APRIL 2000

FORMBY RESTRICTED TOURNAMENT, EASTER
- EASTER MONDAY - 24th APRIL 2000
- LEAGUE DANCE - 28th APRIL 2000