

Domestic, Commercial and Industrial Premises

- All your requirements for
- All types of locks supplied and fitted
 - Emergency call out service
 - Door and window locks
 - Master Key Suites
 - Wall and underfloor safes
 - Mechanical and electronic digital entry



Head Office: 23 Southbank Road, Southport PR8 6QJ

Southport
01704 545400

Preston
01772 804044

Liverpool
0151 321 3002

Chorley
01257 599001

Master Lock & Safe



Southport & District Badminton League 2011-2012

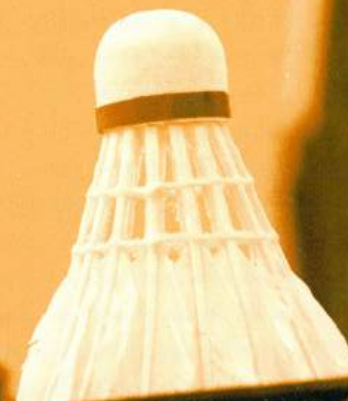

Sponsored by

MASTER LOCK & SAFE
LOCKSMITHS - ARCHITECTURAL HARDWARE
23, SOUTHBANK ROAD, SOUTHPORT PR8 6QJ
Telephone: (01704) 545400

MASTER LOCK AND SAFE

23 Southbank Road, Southport PR8 6QJ

Tel: (01704) 545400 Fax: (01704) 500239

Email: sales@masterlockandsafe.com

Website: www.masterlockandsafe.com

As a well established, family business in Southport, Master Lock and Safe are delighted to be given the opportunity to sponsor the Southport and District Badminton League for a second year.

Many of our employees are keen sportsmen and we appreciate the dedication, hard work and effort required to achieve continued success in such a competitive sport.

As Olympic year 2012 approaches, we wish competitors, spectators and all those involved with the League an exciting, enjoyable and successful season.

With our very best wishes
MARTIN & DI TAYLOR

Heating Protection Plan

with Priority Weekend cover
at no additional cost

Inc.
FREE
Boiler Service
(worth £70.50)

Appointments 7 days a week!

Do you have difficulty finding a reliable, professional heating engineer to carry out essential repairs or even routine servicing and maintenance on your gas appliances at weekends without paying a premium?

- ➡ We offer a FREE ring before service, enabling us to work around your busy lifestyle.
- ➡ You can book your appointments on-line or by phone.
- ➡ Fast, reliable & professional service by **the experts** you can **trust**.

Our **Heating Protection Plan** gives you **priority** weekend calls.

Call us on

01704 566895 or 0151 203 1345

Email: info@ronlaw.co.uk

Web: www.ronlaw.co.uk



Ron Law
Central Heating Services Ltd

Warming people for over 30 years!

THE JACK BLOCKLEY TOURNAMENT

Conditions of Entry

1. Entry Fee per pair is £10.00. Cheques payable to Southport Badminton League.
2. Competitors must be under 21 years of age at the closing date for entry.
3. The closing date for entry is 11/11/11.
4. The date and times of the event will be sent to each Club Secretary and published in the Southport Visiter and on the League's website. No other notification will be given.
5. Competitors must report to the desk immediately upon arrival.

INDEX

Sponsor's letter	I.F.C.
League Executive Officers, Members & Committees	2-3
Chairman's Message	4
Directory of Clubs	6-8
Badminton England and League Coaching	8
Junior League	10-11
Junior League and Competition Winners	11
Junior League Tables (2010/2011)	12
Annual League Presentation Dance	14
Divisional Champions	16
League Tables (2010/2011)	17-19
Child Protection Policy	19
Umpires and Service Laws (including diagram)	22-23
Shuttle Testing	25
Representative Appearances	26
Vera Maxwell Award	30
Divisions and League Programme (facing centre pages)	32-33
Individual Open Championship Winners	35
Guidance on Rally Points Scoring	37
League Rules	38-41
League Rule 5C: Competition – Appendix	41-44
Jack Blockley Tournament information	44
Team Handicap Competition Winners	46
Team Knockout Competition Winners	47
Cup Regulations	48-49
Shield Regulations	51-52
Watkinson Trophy Regulations	53
C, A, V & B Tournaments information	56-57
Individual Tournaments Regulations	58-59
Entry Form for C, A, V & B Tournaments	
Conditions of Entry	61
Entry Form for Jack Blockley Tournament	
Conditions of Entry	63

SOUTHPORT AND DISTRICT BADMINTON LEAGUE

Life members:

Mr. F. J. Bartlett, Mr. M. R. E. Hyde

Vice-Presidents:

R. S. Grindlay, Mrs. M. Halliwell, D. B. James, R. D. Kime, G. H. Lloyd,
N. Marshall, J. E. Moore, G. M. Pike and J. Prescott

THE LEAGUE EXECUTIVE

President:

J. Henderson, Flat 4, 16 Westcliffe Road, Southport, PR8 2BN
Tel. 01704 565957

Executive Chairman:

M. Banham, 36 Larch Street, Southport, PR8 6DL Tel. 01704 547917
e-mail: mbanham36@blueyonder.co.uk

Vice-Chairman:

G. Perry, 216 Guildford Road, Southport, PR8 4NQ Tel. 01704 564551
e-mail: gperry5@sky.com

General Secretary:

J. P. Duncan, 8 Saffron Mews, Thornton, Liverpool, L23 1XQ
e-mail: jpduncan@btinternet.com Tel. 0151 924 0061

Treasurer:

Mrs. P. Higgins, 53 Eshe Road North, Blundellsands, Liverpool, L23 8UE
e-mail: higgins.pamela@hotmail.co.uk Tel. 0151 924 1053

League Match Chairman:

Mr. K. Hughes, 134A Roe Lane, Southport, PR9 7PJ
e-mail: kjhughes01@hotmail.co.uk Tel. 01704 211308

League Match Officer:

R. H. Simm, 87 Warren Road, Southport, PR9 7QU Tel. 01704 227939
Mobile 0780 391 86 56

Cups & Shields Chairman:

Mrs. P. Boylett, Swallow Barn, Vicarage Lane, Ormskirk, L40 6HG
e-mail: p.boylett@sky.com Tel. 01695 572884

Tournaments Chairman:

D. Wright, Apt 1, 48a Nelson Street, Liverpool, L1 5DN Tel. 07886 509171
e-mail: daniel.wright@kpmg.co.uk

Junior League Officer:

Miss M. Taylor, 62 Brentwood Court, Rawlinson Road, Southport, PR9 9JW
e-mail: mo@brentwood62.wanadoo.co.uk Tel. 01704 545545

Press Officer:

Mr. S. Dart, 88 Bispham Road, Southport, PR9 7DF Tel. 01704 224835
e-mail: simon@simondart.co.uk Mobile 0779 034 84 66

Sponsorship Officer:

Mrs. C. Stanton, 52 Skipton Avenue, Southport PR9 8JP Tel. 01704 507485
e-mail: chrisstan52@hotmail.co.uk

THE JACK BLOCKLEY TOURNAMENT

Entry Form

To: D. Wright

Apt 1, 48a Nelson Street,
Liverpool, L1 5DN

Tel: 07886 509171

daniel.wright@kpmg.co.uk

From:.....(Club) Please enter the following pair(s)
in the above tournament. **Clubs may enter as many pairs as they wish.** If
more than one pair is entered, then the information requested below must be
provided for each pair.

Pair (1)	Man	Woman
Full Name	Full Name	Full Name
.....
Tel. No.	Tel. No.	Tel. No.
Mobile	Mobile	Mobile
Club Team & Division	Club Team & Division	Club Team & Division

Pair (2)	Man	Woman
Full Name	Full Name	Full Name
.....
Tel. No.	Tel. No.	Tel. No.
Mobile	Mobile	Mobile
Club Team & Division	Club Team & Division	Club Team & Division

Signature(Club Secretary)

Entry Fee per pair is £10.00 (inclusive of all shuttles used)

Entry Fee enclosed £

PLEASE REFER TO CONDITIONS OF ENTRY OVERLEAF

THE MASTER LOCK AND SAFE

A, B, C AND V TOURNAMENTS

CONDITIONS OF ENTRY:

1. An entry form is required for each competitor although entry by e-mail is acceptable.
2. Entry fee per person per event is £10.00 (or £15.00 per person for two or three events entered in the same tournament). Cheques payable to Southport Badminton League.
3. Closing dates for entries are 'V' and J.B. 01-10-10,
A, C and J.B. 11.11.11; V and B 09.03.12.
4. All shuttles will be provided.
5. All events will be played in Groups of at least 4 players/pairs followed by knockout rounds.
6. The date and time of your first event will be sent to your club secretary and published in the Southport Visiter and on the League's website. If a competitor provides an email address on their entry form then they will receive email notification.
7. **Competitors must report to the desk immediately upon arrival.**
8. Tournament regulations on pages 58/59 should be noted carefully.

Competitors may note below any further information relevant to their entry.

Ordinary Members:

Mrs. P. Barron, A. Bate (co-opted), D. Clark, Miss J. Cook, R. Courtley (co-opted), Miss M. Dixon, A. Dolman, D. Foden, N. Haywood, Mrs. S. McGrath, J. Marsh, Mrs. D. Rigby, Miss E. Walmsley, Mrs. S. Wilkie, S. Williams

COMMITTEES

The Chairman, Vice-Chairman and General Secretary are ex-officio members of all Committees

Tournaments Committee: D. Wright (Chairman)

Miss J. Cook, L. Dean (co-opted), Miss M. Dixon, D. Foden, J. Henderson, J. Marsh, D. Miller (co-opted), Mrs. D. Rigby, R. H. Simm, Mrs. C. Stanton and Miss E. Walmsley

Cup & Shields Committee: Mrs. P. Boylett (Chairman)

Mrs. P. Barron, S. Dart, A. Dolman, N. Haywood, K. Hughes, J. Marsh, R. H. Simm and Mrs. S. Wilkie

League Match Committee: K. Hughes (Chairman)

D. Clark, S. Dart, A. Dolman, D. Foden, Mrs. S. McGrath, R. H. Simm, Mrs. S. Wilkie and S. Williams

Administration Committees:

Discipline & Courts: G. Perry (Chairman)

Mrs. P. Boylett, K. Hughes, R. H. Simm and D. Wright

Juniors: M. Banham (Chairman)

Secretary Miss. M. Taylor (Tel. 01704 545545), D. Clark, L. Dean (co-opted), J. Henderson, K. Hughes, R. H. Simm and S. Williams

Selection: R. Courtley (Chairman) (Tel. 01704 231606)

A. Bate, Miss M. Dixon, Mrs. D. Rigby, Miss E. Walmsley and Mrs. S. Wilkie plus 3 team captains (co-opted)

Website Management and Development: S. Dart (Tel. 07790 348466)
A. Bate and P. Stanton (co-opted)

General Purposes Committee:

Chairman, Vice-Chairman, Secretary, Treasurer and Four Committee Chairmen

Auditor: Mr. L. Ball, 28 Dunkirk Road, Southport

SOUTHPORT & DISTRICT BADMINTON LEAGUE
WEBSITE AT: www.southportbadminton.co.uk

LEAGUE A.G.M.

APRIL 18th 2012

A.G.M. AGENDAS AVAILABLE FROM CLUB SECRETARIES IN MID-MARCH

CHAIRMAN'S MESSAGE

The countdown has already started with less than 12 months to go before the Olympics get underway in London. Unless you have been fortunate enough to secure tickets through the random selection process, for the majority of us we will be doing our watching from a distance, probably via television, of such a prestigious and historic event for this country.

Before we get to next July, we have another season fast approaching for the Southport and District Badminton League. To all players, whether you play league badminton or just confine yourself to Club nights, a very warm welcome to the 2011/2012 season. The League Executive has taken notice of comments/suggestions made by individuals and Clubs, and innovative changes are being introduced for two of the League's competitions this season.

To provide more play in the Shields competition for those players who currently only participate in one mixed and one level doubles, the three mixed doubles events will consist of 2 games of 30 aces. Another innovation, which is being trialled in 2011/2012, relates to the issuing of a sealed handicap for all Watkinson Trophy matches. The envelope containing the handicap is not opened until the match is finished when only then will the winner be known. These changes have been incorporated within the Competitions' Regulations which are within this handbook.

It is important that your Executive is given feedback on whether you feel, after having played with these changes, whether they enhanced your enjoyment of playing in these events. Of course, any other comments you may have about the way your league operates are welcome and should be sent to me at mbanham36@blueyonder.co.uk

The League is very grateful to Master Lock and Safe for their continued sponsorship of our League. This season also sees Tronex providing sponsorship for our tournaments and many companies and individuals taking out adverts in the handbook. Through all these sources the income generated is vital for the continued well being of the League. To all of them I send our sincere thanks for the contributions they make.

Finally, this season there are some changes to the tournaments, particularly the C and V. I would urge all of you to look at the information about all the tournaments in the handbook and hope that by doing so you might be tempted to enter. You will also see at the foot of the League Programme on page 33 that there is an Under 19 Lancashire Inter-League Competition being held at Southport College on Sunday 6 May 2012. If anyone within the League who meets the age criteria, will be available on that date (9am to 6pm) and wishes to be considered to represent our League, then please contact Ken Hughes, the League Match Chairman whose details are on page 2 of this handbook.

On behalf of your League Executive and myself, I wish you all a most enjoyable season.

Best wishes

Malcolm Banham, Chairman

ENTRY FORM

To: D. Wright

THE MASTER LOCK AND SAFE A, B, C & V TOURNAMENTS

Apt 1, 48a Nelson Street, Liverpool, L1 5DN
Tel: 07886 509171 daniel.wright@kpmg.co.uk

Date Signature
Full Name (Mr./Mrs./Miss) (Capitals)
Address Tel. No.
Email Address Mobile
Club and Team in Southport League Division

EVENT:	A/B/C/V	PARTNER'S FULL NAME COMPETITORS REQUIRING A PARTNER SHOULD ENTER 'PARTNER REQUIRED'
Mens/Womens Singles		
Mens/Womens Doubles		
Mixed Doubles		

Entry Fee per person per event is £10.00 (or £15.00 for two or three events)

TOTAL ENTRY FEE ENCLOSED £.....

PLEASE REFER TO CONDITIONS OF ENTRY OVERLEAF

ENTRY VIA E-MAIL IS ACCEPTABLE

www.tronexshuttles.co.uk



Follow us on:
twitter

Tronex
Since 1978

True Technology

BWF APPROVED GOOSE FEATHER SHUTTLECOCKS



Tronex GOLD

From
▲ £14.00 ▲



Tronex GREEN

From
▲ £13.00 ▲

UK Sales Line: 0161 408 5188

No minimum order
& FREE UK DELIVERY

Email: sales@tronexshuttles.co.uk

www.tronexshuttles.co.uk



The Jill Fielding Band

Country, Irish, 50/60's, Americana, Bluegrass, Classic Rock /Pop

Always Live with three part harmony

Now available for :

Special Events

Celebrations

Birthdays

Special Events

Concerts Indoor/Outdoor

Birthday
Weddings

Concerts

Charity Events

Corporate Events

To place a booking
or for any enquiries
call or visit

01695 424209
07712 892999

www.jillfielding.co.uk
jillpfielding@yahoo.co.uk

DIRECTORY OF CLUBS

SOUTHPORT AND DISTRICT BADMINTON LEAGUE 2011/2012 SEASON Clubs showing General & Match Secretaries and Venue(s) with Start Times

BURSCOUGH7.40pm Wednesday
Location of Hall : Burscough Sports Centre, Mart Lane, Burscough, L40 0SD
General Secretary : Mrs. P. Boylett, Swallow Barn, Vicarage Lane, Ormskirk, L40 6HG
p.boylett@sky.com Tel: 01695 572884
Match Secretary : Mr. D. Broadbent, 17 Hurst Green, Mawdesley, L40 2QS
andrew@andrewbroadbent.wanadoo.co.uk Tel: 01704 822541

CHURCHTOWN7pm Monday & Thursday
Location of Hall : United Reformed Church Hall, Botanic Road, Southport, PR9 7NG
General Secretary : Mr. A. Dolman, 18 The Paddock, Ainsdale, PR8 3PT Tel: 01704 574370
andrew_dolman@hotmail.com
Match Secretary : Mr. J. Steele, 8 Shelley Grove, Southport, PR8 6HA Tel: 01704 534880
j_o_e_s@hotmail.com

FORMBY7pm Tuesday
Location of Hall : Formby High School, Freshfield Road, Formby, L37 3HW
General Secretary : Mrs. S. McGrath, 7b Barkfield Lane, Formby, L37 3JW Tel: 01704 878417
bruceandsara@sky.com
Match Secretary : Mrs. S. McGrath, 7b Barkfield Lane, Formby, L37 3JW Tel: 01704 878417
bruceandsara@sky.com

FORMBY METHODIST7pm Tuesday & Wednesday
Location of Hall : Formby Methodist Church Hall, Elbow Lane, Formby, L37 4AF
General Secretary : Mrs. C. Sheridan, 1 Hampton Road, Formby, L37 6EJ Tel: 01704 872247
chriskevin.sheridan@blueyonder.co.uk
Match Secretary : Mrs. A. Almond, 5 Romsey Avenue, Formby, L37 8BP Tel: 01704 877857

HESKETH BANK7pm Monday, Tuesday & Wednesday
Location of Hall : All Saints Church Hall, Station Road, Hesketh Bank, PR4 6SQ
General Secretary : Ms A. Hartley-Worrall, 14 Charles Close, Hesketh Bank, PR4 6SZ Tel: 01772 811654
Match Secretary : Mrs. J. Pope, 25 Foxglove Close, Hesketh Bank, PR4 6TG Tel: 01772 816209
jBedm@yahoo.co.uk Mob: 07962 482321

HOOLE8.05pm Friday
Location of Hall : Ormskirk School, Wigan Road, Ormskirk, L39 2AT
General Secretary : Mr. R. Jones, 11 Cygnet Close, Aughton, Lancs, L39 5QH Tel: 01695 422820
jones@highmere.wanadoo.co.uk
Match Secretary : Mr. P. Jones, 5 Upton Bridle Path, Widnes, Cheshire Tel: 0151 424 3004

MAWDESLEY7.40pm Thursday
Location of Hall : Burscough Sports Centre, Mart Lane, Burscough, L40 0SD
General Secretary : Mrs. J. Richardson, 21 Drapers Avenue, Eccleston, PR7 5SY Tel: 01257 451941
joanner@bdprints.co.uk
Match Secretary : Mrs. N. Mitchell, Stalk House, High Street, Mawdesley, L40 3TD Tel: 01704 822577
nickymitchell1@hotmail.co.uk

6. The Executive:-
 - (a) shall determine the entry fees per player per event;
 - (b) shall determine the date by which entries, accompanied by entry fees, shall be in the hands of the Tournaments & Competitions Officer;
 - (c) shall arrange the seeding, handicapping and draw;
 - (d) shall direct when and where matches shall be played and the disposal of results;
 - (e) shall arrange the finals;
 - (f) shall determine the prizes awarded;
 - (g) may delegate its authority to such Committee as it sees fit;
 - (h) shall have the power to refuse the entry of an individual or pairing for any handicapped event who, in its opinion, cannot be handicapped within appropriate limits for that event.
 - (i) shall have the power to cancel any event in the "B", "C" or "V" Tournaments if, in its opinion, the entry is not sufficient to warrant the event. Five events shall be played in the "A" Tournament;
 - (j) shall deal with any matter not provided for by these regulations and shall be the sole authority for the interpretation thereof.

SOUTHPORT & DISTRICT LEAGUE WEBSITE

Visit: www.southportbadminton.co.uk

For

- *League Tables* • *News* • *Town Teams* •
- *Juniors Southport/Lancashire* •
- *Cups* • *Photographs* •
- *Nostalgia* • *Chat Room* •

An excellent site with regularly updated information about your league.

INDIVIDUAL TOURNAMENTS REGULATIONS

1. (a) At its first meeting each season, the Executive shall consider organising the following tournaments restricted to League members and veteran players who reside locally:-
 - Tournament A - Open.
 - Tournament B - Moderate Players Tournament. (Minimum standard).
 - Tournament C - Restricted Moderate Players Tournament.
(restricted to moderate players in the fourth and lower divisions).
 - Tournament V - Veterans Tournament.
 - Tournament JB - The Jack Blockley 'Under 21' Tournament.
- (b) Each tournament, unless decided otherwise by the Executive, shall consist of:-
Men's Singles, Women's Singles.
Men's Doubles, Women's Doubles, Mixed Doubles
The rally points scoring system will be played in all Tournaments.
2. All tournaments shall be run, as far as is practical, in accordance with the Badminton England regulations for tournaments and recommendations to tournament committees.
3. (a) All bona-fide players registered with League Clubs shall be eligible to enter the tournament.
- (b) Players shall be seeded in the Open Tournament.
- (c) Tournament B - Moderate Players Tournament
On the closing date for entries, a player who has been awarded Lancashire County colours or who, during the current season or past season, has played more than once for the Lancashire county first team, shall be debarred from competing in this tournament, except that a player who has been awarded Lancashire county colours may be eligible to compete at the discretion of the Executive provided that four clear seasons have elapsed since his or her last appearance for Lancashire county first team in the Inter County Championship. Players who have been awarded any other county's colours, or who have played for any other county first team, may be eligible to compete at the discretion of the Executive.
- (d) If a player, has played during the current season 4 or more times in a 3rd division or higher division team in League, Cup or Shield matches at the closing date for entries, he/she will not be eligible for the 'C' Tournament.
- (e) Veteran competitors must be aged 40 years or over at the closing date for entries.
- (f) The League Executive may refuse the entry for a player to any tournament if, in its opinion, that player has not competed in the Southport & District Badminton League on a sufficient number of occasions within the current or previous season.
4. Entry shall be on forms obtainable from the Tournaments Officer or by e-mail.
5. Unless decided otherwise by the Executive, matches shall consist of games of 21 aces, the side first winning two games being the winner.

ORMSKIRK	7pm Wednesday
Location of Hall : Ormskirk School, Wigan Road, Ormskirk, L39 2AT	
General Secretary : Mrs. J. Thompson, 97 Marians Drive, Ormskirk, L39 1LG mrstomo@talktalk.net	Tel: 01695 572214
Match Secretary : Mrs. A. Alcock, Slack House Farm, St. Helens Road, Ormskirk, L39 9EA	Tel: 01695 573146
PIONEERS	7.40pm Monday
Location of Hall : Burscough Sports Centre, Mart Lane, Burscough, L40 0SD	
General Secretary : Mrs. B. Moore, 362 Liverpool Road, Southport, PR8 3BZ barbaramoore1@tiscali.co.uk	Tel: 01704 576381
Match Secretary : Mr. N. Haywood, 37 Highfield Road, Southport, PR8 8QL neil.haywood@monitoraudio.co.uk	Tel: 01704 232910
ST. CUTHBERTS	7pm Monday (PCH) 8pm Tuesday (NMCLC) & 7.30pm Friday (Hospital)
Location of Hall : St. Cuthberts Parochial Church Hall, Off Botanic Road, Southport, PR9 7NA North Meols Community Leisure Centre (Greaves Hall), Banks, PR9 8BL Southport Hospital, Town Lane, Southport (Spinal Unit Gym) PR8 6PN	
General Secretary : Mrs. T. Pattison 6 Fosters Close, Southport, PR9 7QD traceypat@blueyonder.co.uk	Tel: 01704 229268
Match Secretary : Mrs. J. Bridge, 1a St. Johns Road, Southport, PR8 4JP igbstoneleigh@aol.com	Tel: 01704 565596
SOUTHPORT	7pm Tuesday and Wednesday
Location of Hall : Southport Technical College, Mornington Road, Southport, PR9 0TT	
General Secretary : Mrs. E. Davies, 9 Endbutt Lane, Crosby, L23 0TT elainedavies64@gmail.com	Tel: 0151 931 3809
Match Secretary : Mrs. A. Softley, 3 Parklands Way, Waterloo, L22 3YX Annette.softley@virgin.net	Tel: 0151 928 7444
SOUTHSANDS	7.30pm Tuesday (Stanley HS), 8pm Monday & Wednesday (NMCLC) 7pm Thursday (NMCLC)
Location of Hall : Stanley High School, Marshside Road, Southport, PR9 9TF North Meols Community Leisure Centre (Greaves Hall), Banks, PR9 8BL	
General Secretary : Mr. N. Griffith, 43 Hawthorne Grove, Southport, PR9 7AA neilgriff29@gmail.com	Tel: 01704 380757
Match Secretary : Mrs. H. Foden, 76 Southbank Road, Southport, PR8 6QW matchsec@southsandsbc.org.uk	Tel: 01704 512963
TARLETON	7.40pm Monday, 7pm Tuesday
Location of Hall : Burscough Sports Centre, Mart Lane, Burscough, L40 0SD	
General Secretary : Mr. A. Sumner, Barrowdale, Lathom Road, Bickerstaffe, L39 0EA ae.sumner@virgin.net	Tel: 01695 724069
Match Secretary : Mrs. A. McGing, 15 Ormonde Drive, Maghull, L31 7AN	Tel: 0151 531 7731
VICTORIA HALL	7pm Friday
Location of Hall : Greenbank High School, Hastings Road, Southport, PR8 2LT	
General Secretary : L. Singleton, Apt 123, 20 Shaw Street, Liverpool, L6 1HA leahsingleton@badmintonengland.co.uk	Tel: 07581 844570
Match Secretary : Miss C. Clucas Flat 3, Lawwood, Victoria Road, Formby, L37 7DH Caz.clucas@gmail.com	Tel: 01704 879467

WEST END PARK7.15pm Monday & Wednesday (KGV)

8pm Friday (Southport College)

Location of Hall : KGV College, Scarisbrick New Road, Southport, PR8 6LR
Southport College, Morningson Road, Southport, PR9 0TT
General Secretary : Mrs. H. Marshall, 9 Nolan Street, Southport, PR8 6QQ Tel: 01704 542088
mez_1979@yahoo.co.uk
Match Secretary : Miss J. Cook, 5 Truro Avenue, Southport, PR9 9RT Tel: 01704 212839
judith52@talktalk.net

WOODVALE7pm Monday & Wednesday (Greenbank HS)

7pm Thursday & 7.15pm Friday (URC Hall)

Location of Hall : Greenbank High School, Hastings Road, Southport, PR8 2LT
Birkdale United Reformed Church Hall, Grosvenor Road, Southport, PR8 2ET
General Secretary : Mrs. C. Grice, 20 Dunbar Crescent, Southport, PR8 3AB Tel: 01704 564696
mikegrice03@gmail.com
Match Secretary : Mr. T. Woolley, 19 Weld Road, Southport, PR8 2AZ Tel: 01704 564429
tonywoolley@hotmail.com

LEAGUE COACH

The coach for the Southport and District Badminton League is: Mr. Adam Taylor - 01704 569358.

A qualified coach will come to your club to organise sessions to suit your own requirements. The number of sessions can be arranged with the coach.

Costs: The club requesting coaching is responsible for supplying the hall and shuttles and paying the coach's travelling expenses. As the coach probably lives locally these will be minimal.

Should individuals wish to become affiliated coaches, please contact your League Chairman who will give you further advice on courses that can be arranged to suit your convenience.

BADMINTON ENGLAND – COACHING

The Regional Development Manager for the North is: **Tom Webster.**

The coaching scheme is available to all affiliated clubs and applications should be made to: **Tom Webster - 07725 413876.**

A qualified coach can come to your club to organise sessions to suit your own requirements. The number of sessions can be arranged with the coach.

Costs: The club requesting coaching is responsible for supplying the hall and shuttles and paying the coach's expenses. As the coach probably lives locally these should be minimal.

Should individuals wish to become qualified coaches, please contact your League Chairman who will give you further advice on courses that can be arranged to suit your convenience.

VETERANS TOURNAMENT (OVER 40s)

to be played during week commencing

Monday 19th March 2012

Monday & Tuesday 19th & 20th – Mixed Doubles

Wednesday 21st – Mens Doubles

Thursday 22nd Mens Doubles & Mens & Womens Singles

Friday 23rd - Mens Singles & Womens Doubles

Order of play is only a guide and will be confirmed when number of entries is known

FINALS ON SUNDAY 25th March 2012 (approx. 4:00 p.m.)

at Greenbank High School, Hastings Road, Hillside, Southport

Closing Date for Entries: Friday 9th March 2012

Entry Fee: £10 per person per event **or** £15 for two or three events

Each event* will be played in groups of at least 3
(guaranteeing 2 matches per event) followed by knockout rounds

Prizes will be awarded to winners and runners-up

***Subject to the number of entries received**

Draw and start times will be published in the Southport Visiter and on the League's website

Entry by email is acceptable (daniel.wright@kpmg.co.uk)

B - TOURNAMENT

Saturday 24th March 2012

Mens Singles, Mens Doubles & Womens Singles

Sunday 25th March 2012

Womens Doubles & Mixed Doubles

Finals on Sunday 25th March 2012 (approx. 4:00 p.m.)

at Greenbank High School, Hastings Road, Hillside, Southport

Closing Date for Entries: Friday 9th March 2012

Entry Fee: £10 per person per event **or** £15 for two or three events

Each event* will be played in groups of at least 3
(guaranteeing 2 matches per event) followed by knockout rounds

Prizes will be awarded to winners and runners-up

***Subject to number of entries received**

Depending on entry levels, some Saturday events may continue into the Sunday

Draw and start times will be published in the Southport Visiter and on the League's website

Entry by email is acceptable (daniel.wright@kpmg.co.uk)

C - TOURNAMENT

to be played during week commencing

Monday 28th November 2011

Monday & Tuesday 28th & 29th – Mixed Doubles

Wednesday 30th – Mens Doubles

Thursday 1st Dec. Mens Doubles & Mens & Womens Singles

Friday 2nd December - Mens Singles & Womens Doubles

Order of play is only a guide and will be confirmed when number of entries is known

FINALS ON SUNDAY 4th December 2011 (approx. 4:00 p.m.)

at Greenbank High School, Hastings Road, Hillside, Southport

Closing Date for Entries: Friday 11th November 2011

Entry Fee: £10 per person per event **or** £15 for two or three events

Each event* will be played in groups of at least 3

(guaranteeing 2 matches per event) followed by knockout rounds.

***Subject to the number of entries received**

Prizes will be awarded to winners and runners-up

Draw and start times will be published in the Southport Visiter and on the League's website

Entry by email is acceptable (daniel.wright@kpmg.co.uk)

A - TOURNAMENT

Saturday 3rd December 2011

Mens Singles, Mens Doubles & Womens Singles

Sunday 4th December 2011

Womens Doubles & Mixed Doubles

Finals on Sunday 4th December 2011 (approx. 4:00 p.m.)

at Greenbank High School, Hastings Road, Hillside, Southport

Closing Date for Entries: Friday 11th November 2011

Entry Fee: £10 per person per event **or** £15 for two or three events

Each event* will be played in groups of at least 3

(guaranteeing 2 matches per event) followed by knockout rounds

***Subject to the number of entries received**

Prizes will be awarded to winners and runners-up

Depending on entry levels, some Saturday events may continue onto the Sunday

Draw and start times will be published in the Southport Visiter and on the League's website

Entry by email is acceptable (daniel.wright@kpmg.co.uk)

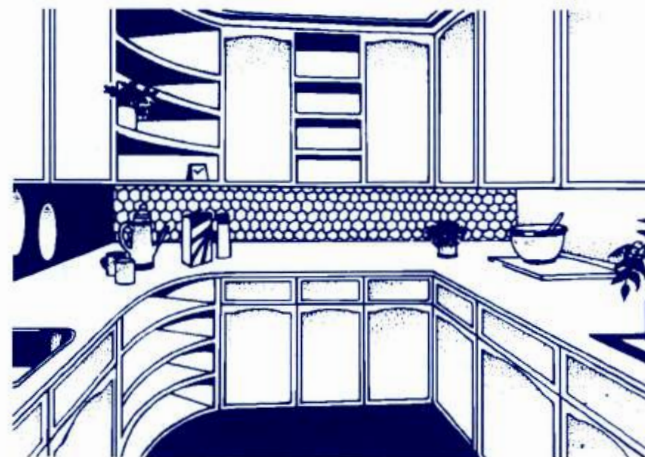

Malcolm Banham

Shopfitting Ltd

- KITCHEN SPECIALISTS •
- CONSERVATORIES •
- PLUMBING • JOINERY •
- ELECTRICAL •

Gas Safe Registration No. 533136

**FOR FREE ESTIMATES
PHONE (01704) 547917**



THE JUNIOR LEAGUE – REGULATIONS

1. The Junior League shall be played in three age groups as follows:-
 - (a) - under 16 years at midnight August 31st.
 - (b) - under 14 years at midnight August 31st.
 - (c) - under 12 years at midnight August 31st.
2. A Club will be allowed a maximum of 3 teams per age group in Junior League events.
3. (a) Each team shall consist of at least two boys and two girls whose ages comply with 1 above.
(b) **A senior member of each Club or Organisation entering a team or teams in the Junior League shall be the non-playing captain of each team (1 adult to each team).**
(c) No player shall be eligible to play in the Junior League, who is not a bona fide member of the Club for which he/she plays.
4. The Executive Committee shall appoint one of its members to be in charge of all matches played on each particular occasion.
5. (a) Each match will consist of a boys doubles, a girls doubles and two mixed doubles or as decided by the Executive Committee.
(b) No player may play in more than one like event.
(c) No player may play for two or more teams on the same day in each age group. This may be waived at the discretion of the Executive Committee.
(d) Points for matches won and drawn shall be awarded as in the Senior League.
(e) Any Club playing an ineligible player shall, at the discretion of the Executive Committee, forfeit all games and points won by that player while he/she was ineligible.
(f) **Tracksuits may be used during warm-ups, but no tracksuits must be worn during any match.**
6. All matches to be played at a central venue to be determined by the Executive Committee on a date and at a time stated by that Committee. Any variation will be at the Executive Committee's discretion. **Teams must report ten minutes before start time.**
7. The annual subscription to the Junior League shall be determined by the Executive Committee. This shall be payable before 1st December in the season.
8. Transfers may only be allowed between Clubs with the written agreement of both Clubs. No Club shall have the right to object to the transfer except where the player is not clear on the books of the objecting Club in respect of monies outstanding.
9. No match may be postponed.
10. **Eligibility**
All Clubs applying to join the Junior League shall be junior sections of Senior League Clubs or have a base within 15 miles of Southport town centre
11. (a) All junior club members wishing to play in the Junior League and Individual Tournaments must be registered with Badminton England. Registration forms will be distributed by the Junior League Committee.
(b) Any variation will be at the Junior League Committee's discretion.

W. CROPPER & SON

Construction & Groundwork

TEL: 01704 232054

FAX: 01704 232132

MOB: 07973 847272

241b RUFFORD ROAD

CROSSENS, SOUTHPORT

MERSEYSIDE PR9 8JD

SITE CLEARANCE

GARDEN CLEARANCE & DRIVEWAY EXCAVATION

DRAINAGE WORKS

CONCRETE LAYING & FINISHING INCLUDING –
GARAGE BASES, FLOOR SLABS, EXTERNAL AREA
TARMAC PAVING AND ALL PREPARATION WORKS
CONSTRUCTION OF INDUSTRIAL BUILDINGS –

GARAGES – WORKSHOPS ETC.

FOUNDATION WORKS FOR EXTENSIONS – HOUSES ETC
INCLUDING – SETTING OUT WORKS, EXCAVATION,
CONCRETING & BRICKWORK

VARIOUS PLANT FOR HIRE WITH DRIVER INCLUDING –

MICRO – MINI – MIDI – EXCAVATORS

DUMPERS – MICRO – 3 TON SWIVEL

4x4 COMPACT FORKLIFT

HYDRAULIC BREAKERS Etc

CONTACT JOHN CROPPER

Established 1927

Construction – Groundwork – Mini Excavator Hire

V.A.T. Reg. No. 428986494

MKM Building Supplies Ltd

Crowland Street, Southport, PR9 7RL

Tel 01704 514700 Fax 01704 517349

UK's Fastest Growing & Largest Independent Builders' Merchant in the Country

Large Range of Building, Timber, Landscaping, Bathrooms, Plumbing & Heating materials

Professional Service & Competitive Pricing

Expert Advice from our Local Team

Open to Trade, Businesses and Public



"My Kind of Merchant"

For any further information please contact

Matt Gerrard on 07827 329428 or

email matt.gerrard@mkmb.co.uk



SOUTHPORT

12. Cup Competitions

- (a) Each match shall consist of one of each of the following, boys singles, girls singles, boys doubles, girls doubles and mixed doubles.
- (b) The boy and the girl who play singles events shall not be eligible to play the mixed doubles.

13. Complaints

- (a) The Junior League Committee shall deal with any written complaint arising out of League matches and deal with any matters not provided for in these regulations.
- (b) Any Club shall have the right to appeal to the League Executive Committee on any matter and any such appeal or application hereunder shall be dealt with in such a manner as the Executive Committee may determine, and its decision shall be final.

JUNIOR CLUBS

**Crosby
Southsands**

**Mawdesley
West End Park**

**Southport
Woodvale**

Contact Miss M. Taylor on 01704 545545 for further information.

JUNIOR SECTION

As the section has grown and eligible age groups have varied, the leagues and trophies have similarly varied in who may compete.

The League

Under 11

2000-01 Southport
2001-03 Woodvale
2003-04 Victoria
2004-05 Woodvale

Under 12

2005-11 Woodvale I

Under 13 Div I

2000-01 Woodvale
2001-02 Churchtown
2002-05 Woodvale

Under 13 Div II

2001-02 Churchtown II

Under 14 Div I

2005-06 Southport
2006-11 Woodvale I

Under 14 Div II

2008-09 Woodvale II

Under 16 Div I

2002-07 Woodvale
2007-09 Southport I
2009-11 Woodvale I

Under 16 Div II

2000-01 Woodvale II
2001-02 Southport II
2002-03 Churchtown II
2003-06 Southport II
2006-07 West End Park II
2007-09 Woodvale II

Under 16 Div III

2001-02 Southport III

Competitions

West End Cup

1995-96 Sacred Heart
1996-97 Southport
1997-99 Churchtown
1999-00 Southport
2000-03 Woodvale
2003-04 Victoria
2004-11 Woodvale

Wesley Cup

1992-99 Churchtown
1999-00 Crosby
2000-01 Woodvale I
2001-02 Southport
2002-05 Woodvale
2005-07 Southport
2007-11 Woodvale

T. R. Highton Cup

1992-93 Southbank Road
1993-98 Churchtown
1998-00 Southport
2000-02 Churchtown
2002-08 Woodvale
2008-09 Southport
2009-11 Woodvale

FINAL JUNIOR LEAGUE TABLES

2010/11 Season

U16	P	W	D	L	GF	GA	Pts
Woodvale 1	14	14	0	0	56	0	42
Woodvale 2	14	10	2	2	42	14	33
Woodvale 3	14	5	6	3	30	26	25
Southport 1	14	6	3	5	30	26	23
West End Park 1	14	5	4	5	29	27	21
Mawdesley 1	14	5	1	8	23	33	16
Crosby 1	14	1	2	11	10	46	6
Southsands 1	14	0	2	12	4	52	2

U14	P	W	D	L	GF	GA	Pts
Woodvale 1	12	12	0	0	45	3	36
Southport 1	12	7	0	5	24	24	21
Woodvale 2	12	5	1	6	22	26	17
Mawdesley 1	12	5	1	6	24	24	16
West End Park 1	12	0	0	12	5	43	0

U12	P	W	D	L	GF	GA	Pts
Woodvale 1	12	12	0	0	42	6	36
Southport 1	12	8	1	1	34	14	25
Woodvale 2	12	2	5	5	20	28	16
Southsands 1	12	2	2	5	13	35	8
West End Park 1	12	1	2	9	11	37	5

REGULATIONS FOR THE WATKINSON TROPHY COMPETITION

- The competition shall be played annually between all teams in the League on a knockout basis and the Executive shall be responsible for the organisation, including the handicapping and the draw for each round. Entry shall be free and optional.
- Matches shall be played by teams of four men and four women playing 4 mixed doubles, 2 men's doubles and 2 women's doubles with each event consisting of two games of 25 aces (no extended games) using rally points scoring. In all other respects matches will be played within the Rules applicable to league matches.
 - Teams will be handicapped on the standard of their current league team. If a player of a higher standard is included after the handicap has been set, then that team shall forfeit the match.
 - All teams shall receive a points handicap and scored points plus handicap points shall decide the winner. The home club for each match will be sent a sealed envelope containing the handicap for the match. The envelope **MUST** remain unopened but see (d) below.
 - Team captains shall complete their teams on **BOTH COPIES** of the score sheet prior to the start of the match. At the conclusion of the match, the home team captain in the presence of the visiting team captain, shall open the sealed envelope referred to in (c) above. The handicap must then be entered onto both copies of the score sheet and the winner decided as in (c).
 - BOTH SCORE SHEETS**, duly completed **must** be returned by the winners to the Cups and Shields Officer, within 48 hours of the completion of the match or the winners may be disqualified.
 - In the event of a tie on points, games won shall not count and the match shall be replayed on the court of the team playing away in the original match. In the event of a further tie, the captains shall spin a coin to decide the choice of court for the next replay.
- No player may play in more than one team in the Competition unless:
 - a player from a lower team who is of equal or lesser standard than those in the higher team in case of doubt about a player's eligibility then permission must be sought from the Chairman of the Cups and Shields Committee prior to the player playing in the Watkinson Trophy match.
 - Once a player has played for a team in the Competition, that player is tied to that team for the remainder of the season unless 3 (a) applies.
- An eligible substitute, if present at the match at the time of an injury may be used. Such substitution shall be direct, the substitute being assumed to be of an equivalent standard to the injured player. The substitute shall play in all relevant events after and including the event in which the injury occurred. Alternatively an eligible substitute may be summoned to the match without undue delay but may only take part in the injured players subsequent events and all points scored by a substitute shall count to the teams advantage.
 - Substitution as described in Rule 4(a) shall only be permitted provided the injury was caused entirely after play in the match had begun and was not due to tiredness or the worsening of an existing ailment.
 - Once replaced by a substitute, an injured player shall not take part again in the match.
 - A team may replace an injured player with an ineligible player subject to the approval of the opposing captain. Such substitution shall be direct as in regulation 4(a) above but all games involving the ineligible player shall be deemed to be lost with the ineligible player failing to score.
- Exceptionally an ineligible player may be played at 4th mixed doubles and 2nd men's/women's doubles but the opposing team captain must be told prior to the start of the match.
 - The scores in each game shall count as 25-0 to the opposing team.
 - If an ineligible player is played other than as stated in 4 or 5(a) then the match shall be forfeited to the opposing team.
- The Executive shall:-
 - arrange the venue for the final.
 - appoint a referee for the final who shall have full charge of the match, including the order of play.
 - deal with any matter not provided for in these regulations.
 - be the sole authority for the interpretation of these regulations.

5. (a) The order of play, unless mutually agreed otherwise, shall be 1st, 2nd & 3rd Mixed Doubles. The order of play in the Men's and Women's Doubles shall be in accordance with the requirements of the home team captain except in the final round.
- (b) A player asked to play consecutive games is entitled to a 10 minute break between games.
6. (a) If a player is injured during a match and unable to continue, the score in the game in which the injury occurred shall:
 - (i) if the game were completed, stand.
 - (ii) if the games were not completed, be recorded as a win for the opposing team with the injured player's team being credited with the score at the time of injury, subject to regulation 6(b) below.
- (b) An eligible substitute, if present at the match at the time of an injury may be used. Such substitution shall be direct, the substitute being assumed to be of an equivalent standard to the injured player. The substitute shall play in all relevant events after and including the event in which the injury occurred. Alternatively an eligible substitute may be summoned to the match without undue delay but may only take part in the injured players subsequent events and all points scored by a substitute shall count to the teams advantage.
- (c) Substitution as described in Rule 6(b) shall only be permitted provided the injury was caused entirely after play in the match had begun and was not due to tiredness or the worsening of an existing ailment.
- (d) Once replaced by a substitute, an injured player shall not take part again in the match.
- (e) A team may replace an injured player with an ineligible player subject to the approval of the opposing captain. Such substitution shall be direct but all games involving the ineligible player shall be deemed to be lost with the ineligible player failing to score.
7. Teams will be handicapped on the standard of their current League team. If a player of a higher standard is included after the handicap has been set, then that team shall forfeit the match.
8. The League Executive shall:
 - (a) arrange the venue for each final.
 - (b) appoint a referee to each final who shall have full charge of the match including the order of play.
 - (c) deal with any matter not provided for in these regulations.
 - (d) be the sole authority for the interpretation of these regulations.

LEAGUE A.G.M.

APRIL 18th 2012

**A.G.M. AGENDAS AVAILABLE FROM CLUB
SECRETARIES IN MID-MARCH**

Rimmer Scaffolding Ltd

11 Guildford Road Birkdale Southport PR8 4JU

T: +44(0)1704 550859 M: 07814 179087

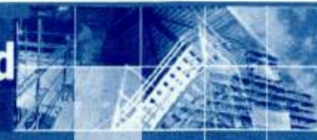

WITH OVER 20 YEARS EXPERIENCE

RUSSELL RIMMER OF RIMMER SCAFFOLD

HAS BEEN OFFERING A QUALITY SERVICE

TO BOTH COMMERCIAL AND DOMESTIC

CUSTOMERS

.....

CALL NOW FOR A FREE ESTIMATE

TELEPHONE: (01704) 550859

MOBILE: 07814 179087

All our work is fully insured because with

Rimmer Scaffold - Safety comes First

E-mail: rimmerscaff@hotmail.com

Website: www.rimmerscaffolding.co.uk

THE ANNUAL LEAGUE DANCE and PRESENTATION EVENING

will be held on

Saturday, 21st April, 2012

★ *Live entertainment* ★

★ **Buffet** ★ **Disco** ★

★ **Late Bar** ★ **Raffle** ★

**More information, including venue, will be
circulated to all Clubs in due course.**

THE SHIELDS COMPETITION REGULATIONS

1. The competition shall be played annually between League teams on a knockout basis and the League Executive shall be responsible for the organisation including the allocation of teams to competitions, handicapping and the draw for each round.
2.
 - (a) Matches shall be played by teams of 4 men and 4 women, playing three mixed doubles, three men's doubles and three women's doubles. The three mixed doubles events will consist of two games of 30 aces and the three men's and three women's level doubles events will consist of one game of 30 aces.
 - (b) Team captains shall complete their teams on both copies of the score sheet prior to the start of the match and BOTH SHEETS, duly completed, **must** be returned **by the winners** to the Cups & Shields Officer, within 48 hours of the completion of the match, or the winners may be disqualified.
 - (c) In each team three men and three women will form three mixed doubles pairs which shall play in order of strength. The remaining man/woman shall play in turn with the three men/women who played in the mixed events to play three men's/women's doubles which also shall be played in order of strength.
 - (d) Matches shall be decided on the number of games won. If a match is tied on games then the team with the most points will be the winner. Should a match be also tied on points then it shall be replayed at the away team's venue.
 - (e) Where an ineligible player is played, that player shall play third mixed and third men's/women's doubles.
 - (f) Games involving an ineligible player shall be deemed to have been lost and the ineligible player not to have scored. The score will appear on the score sheet to the handicap played. For example a team handicapped as +9, playing an ineligible player will have the score for each event they played in as 30:9 for level doubles and 30:9; 30:9 for mixed doubles.
 - (g) If a team plays an ineligible player other than as stated in regulations 2(d) or 6(c), then that team shall forfeit the match.
3.
 - (a) No player selected to play in a particular match shall be eligible to play in the match unless he or she is present and ready to play by 8.15 p.m. This may be extended to 8.30 p.m. by mutual agreement.
 - (b) All players in the competition shall be registered members of the League.
 - (c) No player may play in more than one team in the Competition unless:
 - (i) a player from a lower team who is of equal or lesser standard than those in the higher teamIn cases of doubt about a player's eligibility then permission must be sought from the Chairman of the Cups and Shields Committee prior to the player playing in the Shield match.
 - (d) Once a player has played for a team in the competition, that player is tied to that team for that Shield competition for the remainder of the season unless 3(c) applies.
4.
 - (a) It shall be the sole responsibility of the home team to decide on which night during the appointed week the match shall be played.
 - (b) The home team shall give at least 7 days notice to their opponents.
 - (c) All matches shall start at 7.00 p.m. unless mutually agreed otherwise.

Branded Clothing for Badminton Clubs

Give your teams that
professional look
...and let your opposition know
you mean business!

We print onto
Sports Shirts, Hoodies, Tracksuits,
Shorts, Skirts, Skorts & more

Call us on 01704 546748,
or come in and see us, we are based
in Arcade Sports, Hoghton Street,
Southport

info@zentex.co.uk
www.zentex.co.uk

zentex

Call 01704 546748



Bispham Road Pharmacy

Pharmacy Proprietor
Mr. TONY WOOLLEY,
BSc (Hons), M.R.PHARM.S.

Telephone 01704 506006

94 Bispham Road, Southport, Merseyside PR9 7DF

Email info@bisphamroadpharmacy.co.uk

Website www.bisphamroadpharmacy.co.uk

Facsimile 01704 507151

A local Pharmacy for your local Community

- Friendly • Family run
- Always happy to help

The Pharmacy is open

9:00a.m. - 6:30p.m.

Monday to Friday

and

9:00a.m - 1:00p.m. and 2:00p.m. - 5:00p.m. Saturday

DIVISIONAL CHAMPIONS

The following represent the League winners since the new structure was adopted in season 2001-2002. Should anyone wish to obtain earlier results, please contact the League Secretary.

CHAMPIONSHIP SHIELD

(Division 1)

2001-02 Victoria Hall
2002-04 Southport I
2004-08 Victoria Hall I
2008-09 West End Park I
2009-10 Victoria Hall I
2010-11 Churchtown I

BLAKEMAN TROPHY

(Division 2)

2002-03 Victoria Hall II
2003-04 Mawdesley I
2004-05 Victoria Hall II
2005-06 Woodvale II
2006-07 Churchtown II
2007-08 Woodvale II
2008-09 Southport II
2009-10 Burscough I
2010-11 West End Park II

WILF KIME SHIELD

(Division 3)

2004-05 Southport IV
2005-06 St. Cuthberts I
2006-07 Pioneers I
2007-08 St. Cuthberts I
2008-09 Mawdesley II
2009-10 Victoria Hall III
2010-11 Southsands II

ST. SIMON'S AND

ST. JUDE'S/WEST END

PARK SHIELD

(Division 4 from 2011/12 previously Division 8)

2003-04 West End Park V
2004-05 St. Cuthberts IV
2005-06 Southsands VIII
2006-07 Formby Meths III
2007-08 Churchtown V
2008-09 Southport VIII
2009-10 Hoole

RIGBY SHIELD

(Division 5)

2004-05 Churchtown III
2005-06 Burscough III
2006-07 Woodvale VI
2007-08 West End Park IV
2008-10 Formby II
2010-11 Pioneers II

ST. CUTHBERTS SHIELD

(Division 6)

2004-05 Ainsdale II
2005-06 Pioneers III
2006-07 Woodvale VI
2007-08 Mawdesley III
2008-09 Ormskirk II
2009-10 Southport VI
2010-11 Tarleton IV

CHURCHTOWN B.C.

SHIELD Division 7)

2004-05 Woodvale VII
2005-06 Ormskirk II
2006-07 West End Park V
2007-08 Mawdesley IV
2008-09 Woodvale VII
2009-10 Southport VII
2010-11 Hoole

BLOWICK SHIELD

(Previously Division 4 until 2010/11)

2004-05 Woodvale IV
2005-06 Churchtown III
2006-07 Woodvale IV
2007-08 Burscough III
2008-09 Southsands III
2009-10 Mawdesley III
2010-11 Ormskirk I

PANTHERS SHIELD

(Division 9)

2001-02 Woodvale VIII
2002-03 West End Park VI

- (b) The home team shall give at least 7 days notice to the visiting team and advise their opponents which will be the first two events played.
- (c) All matches shall start at 7.00 p.m. as per League Rule 5c (1.3).
6. (a) Exceptionally, an ineligible player must be played at 2nd men's/women's doubles and then either 3rd men's/women's doubles or 2nd mixed doubles.
(b) The scores of 2 games in each event shall be recorded as 21-0 to the opposing team.
(c) If an ineligible player is played other than as stated in 6 (a) then the match shall be forfeited to the opposing team.
7. The Executive shall:-
 - (a) arrange the venue for each final.
 - (b) appoint a referee in each final who shall have full charge of the match, including the order of play.
 - (c) deal with any matter not provided for in these regulations.
 - (d) be the sole authority for the interpretation of these regulations.



SOUTHPORT TYRES LTD

2 Southbank Road, Southport

Merseyside, PR8 6QJ

Telephone: 01704 530537

Telephone: 01704 501219

***ARE PLEASED TO SUPPORT THE
SOUTHPORT and DISTRICT
BADMINTON LEAGUE***

THE CUPS, COMPETITION REGULATIONS

1. The competitions shall be played annually between teams in the League on a knock-out basis and the League Executive shall be responsible for the organisation, including seeding and the draw for each round.
2. (a) Teams in the First division and any club that does not have a team in the First division but wishes to enter a representative team, shall be given free entry to the Hudson Cup competition.
(b) Teams in the second and lower divisions shall be given free entry to the appropriate cup competition for their divisions and the Executive, at their first meeting each season, shall decide which teams shall enter each competition.
3. (a) Matches shall consist of 3 men's doubles, 3 women's doubles and 2 mixed doubles. Each of the eight events will be the best of 3 games to 21 points (extended games if required) using the rally points scoring system. 1st and 2nd men's doubles and women's doubles **MUST** be played in order of strength as **MUST** both mixed doubles pairs. 3rd men's doubles has to be made up of one man from the 1st men's doubles and one man from the 2nd men's doubles. 3rd women's doubles has to be made up from one woman from the 1st women's doubles and one woman from the 2nd women's doubles. The 2 men and 2 women NOT playing in the 3rd men's/women's doubles make up the 2 pairs of mixed doubles. It is for each team captain to decide which of their players from the 1st and 2nd men's/women's doubles play in the 3rd men's/women's doubles. In all other respects matches will be played within the rules applicable to league matches.
(b) The order of play, unless mutually agreed otherwise, shall be all of the 3 men's and 3 women's doubles followed by the 2 mixed doubles.
(c) Team captains **MUST complete their teams on both copies of the score sheet PRIOR to the start of the match** and BOTH SHEETS, duly completed **must** be returned **by the winners** to the Cups and Shields Officer within 48 hours of the completion of the match, or the winners may be disqualified.
(d) Matches shall be decided on the number of the events won. If a match is tied on events then the tie is won by the team winning the most number of games. Should there still be a tie then the team with the most points will be the winner. If the match still remains tied on events, games and points, then the match shall be replayed on the court of the team playing away in the original match. Where a further tie is required, the captains shall spin a coin to decide the choice of court for the next replay.
4. (a) No player may play in more than one of the second and lower divisional Cups or in more than one team in each Cup Competition unless:
(i) a player from a lower team who is of equal or lesser standard than those in the higher team
In case of doubt about a player's eligibility then permission must be sought from the Chairman of the Cups and Shields Committee prior to the player playing in the Cup match.
(b) No player may play for more than one club in the Cup Competitions.
(c) Any player being nominated for a club team at the beginning of the season may not play in a lower team cup competition for that club.
(d) Once a player has played for a team in the second division or a lower divisional Cup competition that player is tied to that team for that Cup competition for the remainder of the season unless 4(a) applies.
5. (a) It shall be the sole responsibility of the home team to decide on which night during the appointed week the match shall be played.

FINAL LEAGUE TABLES

20010/11 Season

Division 1	P	W	WD	LD	Tie	L	EF	EA	GF	GA	Pts
Churchtown	18	15	2	1	0	0	114	27	241	82	50
Victoria Hall	18	14	1	1	0	2	110	34	235	90	45
West End Park	18	14	1	0	0	3	103	41	211	105	44
Woodvale	18	11	0	2	0	5	88	56	202	136	35
Southport	18	8	1	1	0	8	74	70	173	160	27
Southsands	18	7	1	2	0	8	70	74	164	165	25
Burscough	18	5	0	1	0	12	53	91	127	198	16
Victoria Hall 2	18	4	1	0	0	13	45	99	122	221	14
Southport 2	18	4	1	0	0	13	42	102	102	225	14
Churchtown 2	18	0	0	0	0	18	18	123	63	255	0

Division 2	P	W	WD	LD	Tie	L	EF	EA	GF	GA	Pts
West End Park 2	18	14	2	0	0	2	94	50	209	127	46
Mawdesley	18	14	1	1	0	2	97	47	222	122	45
Burscough 2	18	12	1	0	0	5	90	54	199	137	38
Southport 3	18	9	1	0	0	8	77	67	183	153	29
St Cuthberts	18	7	1	4	0	6	73	71	165	181	27
Woodvale 2	18	8	0	1	0	9	76	68	175	146	25
Tarleton	18	6	2	1	0	9	69	75	162	171	23
Mawdesley 2	18	5	0	4	0	9	66	78	160	187	19
Woodvale 3	18	3	1	0	0	14	37	107	106	235	11
Victoria Hall 3	18	1	2	0	0	15	41	103	115	222	7

Division 3	P	W	WD	LD	Tie	L	EF	EA	GF	GA	Pts
Southsands 2	18	16	1	0	0	1	110	34	228	90	50
Formby	18	12	4	1	0	1	97	47	201	114	45
Woodvale 4	18	10	1	2	0	5	78	66	198	151	34
Burscough 3	18	9	0	3	0	6	79	65	172	167	30
Pioneers	18	8	2	2	0	6	74	70	174	160	30
St Cuthberts2	18	5	3	3	0	7	68	76	170	199	24
Southport 4	18	6	2	1	0	9	71	73	168	176	23
Mawdesley 3	18	6	0	1	0	11	62	82	140	186	19
Churchtown 3	18	2	1	3	0	12	55	89	130	206	11
West End Park 3	18	0	2	0	0	16	26	118	97	248	4

Division 4	P	W	WD	LD	Tie	L	EF	EA	GF	GA	Pts
Ormskirk	18	18	0	0	0	0	109	35	231	100	54
Tarleton 2	18	12	3	0	0	3	94	50	207	130	42
Hesketh Bank	18	10	0	1	0	7	85	59	192	139	31
Woodvale 5	18	8	3	0	0	7	80	64	184	153	30
Southsands 3	18	8	0	3	0	7	79	65	185	159	27
Southport 5	18	5	2	2	0	9	59	85	150	182	21
Tarleton 3	18	5	2	1	0	10	61	83	149	188	20
Formby Meths	18	4	2	2	0	10	59	85	137	189	18
Formby 2	18	5	1	1	0	11	51	93	130	196	18
Southsands 4	18	2	0	3	0	13	43	101	112	224	9

Division 5	P	W	WD	LD	Tie	L	EF	EA	GF	GA	Pts
Pioneers 2	16	13	1	0	0	2	87	41	191	106	41
St Cuthberts 3	16	12	1	2	0	1	96	32	196	85	40
Southport 6	16	8	1	0	0	7	65	63	150	154	26
Woodvale 6	16	8	0	2	0	6	70	58	174	139	26
St Cuthberts 4	16	6	1	3	0	6	61	67	142	172	23
Ormskirk 2	16	4	3	0	0	9	55	73	135	163	18
West End Park 4	16	3	3	3	0	7	58	70	139	159	18
Southsands 6	16	3	1	0	0	12	47	81	125	212	11
Southsands 5	16	3	0	1	0	12	37	91	111	194	10

Division 6	P	W	WD	LD	Tie	L	EF	EA	GF	GA	Pts
Tarleton 4	18	16	2	0	0	0	106	38	224	99	52
Hesketh Bank 2	18	11	2	0	0	5	87	57	193	145	37
Woodvale 8	18	10	0	1	0	7	76	68	172	156	31
Formby 3	18	8	1	4	0	5	76	68	170	158	30
Mawdesley 4	18	9	1	0	0	8	74	70	167	161	29
Southport 7	18	7	2	2	0	7	74	70	177	174	27
Southsands 7	18	7	2	0	0	9	66	78	162	178	25
West End Park 5	18	5	1	1	0	11	56	88	146	199	18
Woodvale 7	18	3	0	2	0	13	49	95	126	216	11
Formby Meths 2	18	3	0	1	0	14	56	88	137	191	10

TEAM KNOCKOUT COMPETITIONS

HUDSON CUP

1986-96 Southport
1996-97 Freshfield
1997-99 Southport
1999-01 Victoria Hall
2001-05 Southport
2005-07 Victoria Hall
2007-08 West End Park I
2008-09 Victoria Hall
2009-10 Southport
2010-11 West End Park I

ST. PAUL'S CUP

2002-03 Phoenix I
2003-04 Tarleton I
2004-05 Southport IV
2005-06 Victoria Hall III
2006-07 Mawdesley II
2007-08 St. Cuthbert's I
2008-09 Pioneers
2009-10 Burscough II
2010-11 Formby I

INFLIGHT CUP

2004-05 St. Cuthbert's IV
2005-06 Southsands IX
2006-07 Mawdesley IV
2007-08 Churchtown V
2008-09 Southport VIII
2009-10 Hoole

NINTH DIVISION CUP

2001-02 Southsands VII
2002-03 West End Park VI

HACKNEY CUP

1996-00 Southport III
2000-01 West End Park I
2001-02 Burscough I
2002-03 Victoria Hall II
2003-04 Southport III
2004-05 Victoria Hall II
2005-08 Woodvale II
2008-09 Southport II
2009-10 Southport III
2010-11 Woodvale II

NAT. GIRO CUP

1990-91 Hoole II
1991-92 Hesketh Bank I
1992-93 St. Cuthbert's II
1993-94 Hoole III
1994-95 Burscough IV
1995-96 Feathers II
1996-97 Formby Ravens
1997-98 Southport VI

FRANK SIMPSON CUP

2000-01 Formby V
2001-02 Tarleton II
2002-03 Mawdesley III
2003-04 St. Cuthbert's III
2004-05 Ainsdale II
2005-06 Pioneers III
2006-07 Woodvale VI
2007-08 Mawdesley III
2008-09 Mawdesley IV
2009-10 Southport VI
2010-11 Tarleton IV

ST. SIMON & ST. JUDE CUP

1998-99 Woodvale III
1999-01 Formby
2001-03 Pioneers III
2003-05 Churchtown III
2005-06 Burscough III
2006-07 St. Cuthberts V
2007-08 West End Park IV
2008-09 Woodvale VI
2009-10 Tarleton III
2010-11 St. Cuthberts III

WEST END CUP

2002-03 Hoole I
2003-04 Ormskirk I
2004-05 Woodvale IV
2005-06 Churchtown III
2006-07 West End Park III
2007-08 Burscough III
2008-09 Southsands III
2009-10 Mawdesley III
2010-11 Ormskirk I

PIONEER CUP

2002-03 Southsands VI
2003-04 Tarleton III
2004-05 Woodvale VII
2005-06 Churchtown IV
2006-07 West End Park V
2007-08 Mawdesley IV
2008-09 Woodvale VII
2009-10 Formby Methodist II
2010-11 Hoole

OTHER AWARDS

THE RAYNOR TROPHY

1998-99 Victoria Hall III
1999-00 Pioneers III
2000-01 Southport
2001-02 Churchtown
2002-03 Churchtown
2003-04 Hesketh Bank I
2004-05 Southsands VIII
2005-06 Ainsdale II
2006-07 Southsands II and Southsands VI
2007-08 Southsands III and Formby Methodists II
2008-09 Hoole
2009-10 Churchtown I
2010-11 Mawdesley I

TEAM HANDICAP COMPETITIONS

THE FLEETWOOD HESKETH SHIELD

2000-01 Woodvale I
2001-02 Southsands I
2002-03 Victoria Hall I
2003-04 Southport I
2004-05 Mawdesley
2005-06 Victoria Hall I
2006-07 Southport I
2007-08 Woodvale I
2008-09 Churchtown II
2009-10 Victoria Hall II
2010-11 Burscough I

THE LEAGUE SHIELD IN MEMORY

of MALCOLM IDDON

2000-01 Churchtown II
2001-02 Phoenix I
2002-03 Victoria Hall IV
2003-04 Victoria Hall III
2004-05 Woodvale III
2005-06 Formby II
2006-07 Woodvale II
2007-08 Ormskirk I
2008-09 Pioneers I
2009-10 Southsands III
2010-11 Churchtown III

FRANK SIMPSON SHIELD

2001-02 Woodvale VII
2002-03 Mawdesley IV
2003-05 Woodvale VII
2005-06 Southport VII
2006-07 Tarleton IV
2007-08 Woodvale VII
2008-09 St. Cuthbert's V
2009-10 Formby III
2010-11 Southsands VIII

ST. JOHN'S SHIELD

2000-01 Victoria Hall VI
2001-02 Burscough II
2002-03 Ormskirk I
2003-04 Southsands III
2004-05 West End Park IV
2005-06 St. Cuthbert's V
2006-07 Formby III
2007-08 Pioneers II
2008-09 Tarleton III
2009-10 Woodvale VI
2010-11 Woodvale VI

BARCLAYS BANK SHIELD

1990-91 Woodvale IV
1991-92 Mawdesley III
1992-93 Southbank V
1993-94 Woodvale V
1994-95 Formby IV
1995-96 Churchtown IV
1996-97 Formby Ravens
1997-98 Ormskirk I

SOUTHPORT B.C. SHIELD

1997-98 West End Park V
1998-99 Woodvale VIII
1999-00 Phoenix IV
2000-01 Woodvale VIII
2001-02 Mawdesley IV
2002-03 West End Park VI
2003-04 Woodvale VIII
2004-05 St. Cuthbert's IV
2005-06 Formby Methodist III
2006-07 West End Park VII

THE WATKINSON TROPHY IN MEMORY

of DAVE BRADLEY

1998-99 Pioneers III
1999-00 Ainsdale
2000-01 Southsands II
2001-02 Woodvale VII
2002-03 Woodvale III
2003-05 Woodvale VII
2005-06 West End Park I
2006-07 Churchtown I
2007-08 West End Park
2008-09 Tarleton I
2009-10 Southsands X
2010-11 Formby Methodist I

Division 7	P	W	WD	LD	Tie	L	EF	EA	GF	GA	Pts
Hoole	18	17	0	0	0	1	110	34	237	155	51
Southsands 8	18	16	0	0	0	2	109	35	237	88	48
St Cuthberts 5	18	15	0	0	0	3	108	36	227	103	45
Southport 8	18	8	1	1	0	8	75	69	173	156	27
Southsands 9	18	7	2	0	0	9	73	71	171	168	25
Formby Meths 3	18	7	0	1	0	10	60	84	147	185	22
Hesketh Bank 3	18	6	1	0	0	11	62	82	139	177	20
West End Park 6	18	5	0	0	0	13	56	88	137	191	15
Woodvale 9	18	4	0	2	0	12	49	95	118	209	14
Southsands 10	18	1	0	0	0	17	18	126	50	245	3

Child Protection Policy

In May 2005, the Council of BADMINTON ENGLAND adopted a revised Child Protection Policy for Badminton endorsing a document entitled "Child Protection Policy and Implementation Procedures in Badminton".

The Southport and District Badminton League have formally adopted BADMINTON ENGLAND'S Child Protection Policy and Implementation Procedures. A copy of this document is held by our General Secretary, Mr. Paul Duncan, who is the responsible and designated person within our League.

Contacts:

Your Club's Child Protection Officer.

General Secretary of the Southport and District Badminton League - see Page 2 of this Handbook.

National Child Protection Officer.

Email — childprotection@badmintonengland.co.uk

Anyone requiring further information should access a full copy of the Child Protection Policy, available to download from:

www.badmintonengland.co.uk

or contact the development department on 01908 268400

MARIC TROPHIES



Quality Trophies & Engraving

Trophies made to your own specification

- Discount to clubs etc.
- Collection & Delivery Service

FREE
engraving on
all purchases



For a free brochure
call us any time on

(01704) 531798

E-mail: mariabulcock@yahoo.co.uk

Steve's
Shuttle
Service



Private Hire Transportation

- Airport transfers
- Journeys to anywhere in the UK (Distance no object)
- Personalised service

Over 20 years Professional Driving Experience

Fully Licensed - Competitive quotes available

For further details contact: **Steve Williams: 07884 050759**

Reputation menswear

- FOR THE ULTIMATE EXCLUSIVE MALE -



ARMANI COLLEZIONI
ARMANI JEANS
ROBERT GRAHAM
LACOSTE
LA MARTINA
TED BAKER
HACKETT
HILFGER
DUCHAMP
TRUE RELIGION
PAUL & SHARK
7 FOR ALL MANKIND
JEFFERY WEST
BARKERS
CANALI
LYLE AND SCOTT



ALSO 'ULTIMATE & MAGEE HIRE' FOR WEDDINGS AND FORMAL WEAR
AND LADIES AND MENS FASHION WATCHES

92-96 LORD STREET • SOUTHPORT • PR8 1JR • 01704 536959

5. **Higher Team Play Eligibility**
5.1 Where a club has more than one team, whether in the same division or different divisions, a player from a lower ranked team can play in a higher ranked team provided that player is of an equal or lower standard than those players in the higher team.
5.2 When a player from a lower ranked team plays in a higher ranked team as per rule 5.1, but the player is considered by the Executive not to be of an equal or lower standard than those players in the higher team, then that player will be regarded as ineligible. Where a team plays such an ineligible player then rule 2.10 will apply.
6. **Divisional Champions, Promotion and Relegation**
6.1 Promotion and relegation shall be decided by the Executive at its first meeting.
6.2 The team securing most points In each division shall be the champion team of that division and shall be entitled to the custody of the championship trophy of that division until the succeeding annual general meeting.
6.3 Points shall be awarded as follows:-
3 points for a win on events
2 points for a tie on events but a win on games
2 points for a tie on events and games but a win on aces
1 point for a tie on events but a loss on games
1 point for a tie on events and games but a loss on aces
1 point for a tie on events and games and on aces
6.4 Where two teams secure the same number of points, the number of events won shall be the deciding factor. Where the teams are still equal, then the greatest difference between games won and games lost shall be the deciding factor. Where there is still a tie, then the difference between aces won and aces lost shall be the deciding factor. Should the teams still remain equal then the deciding factor based on the above criteria will apply to the combined results of the 2 matches played by the 2 teams against each other during the season.
6.5 At least one team from the 2nd and lower divisions shall be promoted.

THE JACK BLOCKLEY TOURNAMENT

Under 21 Mixed Doubles

Sunday 4th December 2011

at Greenbank High School, Hastings Road, Hillside, Southport

Closing Date for Entries: Friday 11th November 2011

Entry Fee: £10 per pair

Handicapped tournament played in groups of at least 4 pairs
(guaranteeing 3 matches) followed by knockout rounds

Prizes will be awarded to winner and runners-up

*There is no restriction on the number of pairs a Club can enter -
see page 63 for entry form*

Entry by email is acceptable (daniel.wright@kpmg.co.uk)

Southport Sports

WE CARRY THE MOST COMPREHENSIVE RANGE
OF BADMINTON RACKETS IN TOWN

LARGE RANGE OF SPORTSWEAR AND FOOTWEAR

UNRIVALLED STRINGING SERVICE

GENEROUS CLUB DISCOUNTS

48 KING STREET, SOUTHPORT
Telephone: (01704) 530886

UMPIRES

The Badminton Umpires Association of England Authorised Umpires are:

M. Banham, A. Blakely, N. Bulcock, Mrs. E. Clough, P. Clough, S. Dart, R. Grindlay, K. Hughes, G. Perry and Y. Suleman.

Authorised Umpires may be used in all Cups, Shields and Trophy Finals, in the Jack Blockley, A, B, C and V Tournaments, and in any other event as the League may decide.

Umpires may appear at any match or event in an advisory capacity or as the League may decide.

Clubs may request the attendance of Umpires but this will only occasionally be possible and must not be assumed.

League members interested in Umpiring should contact Malcolm Banham (Tel: 01704 547917).

9. SERVICE

9.1 In a Correct service:

- 9.1.1 neither side shall cause undue delay to the delivery of the service once the server and the receiver are ready for the service. On completion of the backward movement of server's racket head, any delay in the start of the service (Law 9.2), shall be considered to be an undue delay;
 - 9.1.2 the server and the receiver shall stand within diagonally opposite service courts without touching the boundary lines of these service courts;
 - 9.1.3 some part of both feet of the server and the receiver shall remain in contact with the surface of the court in a stationary position from the start of the service (Law 9.2) until the service is delivered (Law 9.3);
 - 9.1.4 the server's racket shall initially hit the base of the shuttle;
 - 9.1.5 the whole shuttle shall be below the server's waist at the instant of being hit by the server's racket. The waist shall be considered to be an imaginary line round the body, level with the lowest part of the server's bottom rib;
 - 9.1.6 the shaft of the server's racket at the instant of hitting the shuttle shall be pointing in a downward direction;
 - 9.1.7 the movement of the server's racket shall continue forwards from the start of the service (Law 9.2) until the service is delivered (Law 9.3);
 - 9.1.8 the flight of the shuttle shall be upwards from the server's racket to pass over the net so that, if not intercepted, it shall land in the receiver's service court (i.e. on or within the boundary lines); and
 - 9.1.9 in attempting to serve, the server shall not miss the shuttle.
- 9.2 Once the players are ready for the service, the first forward movement of the server's racket head shall be the start of the service.
- 9.3 Once started (Law 9.2), the service is delivered when the shuttle is hit by the server's racket or, in attempting to serve, the server misses the shuttle.
- 9.4 The server shall not serve before the receiver is ready. However, the receiver shall be considered to have been ready if a return of the service is attempted.
- 9.5 In doubles, during the delivery of service (Law 9.2, 9.3), the partners may take up any positions within their respective courts, which do not unsight the opposing server or receiver.

- 3.2 The home team shall be responsible for ensuring that the completed score sheet is received by the League Match Officer within 5 days of the match being played. Failure to comply with this rule will result in a penalty not exceeding £20 being imposed by the Executive.
- 3.3 In the event of any occurrence arising under 2.4, the Executive may require both captains to appear before the League Match Committee for the purpose of explanation and may impose on the club found to be at fault such fine or penalty as they may in their absolute discretion deem adequate.
4. **Players' Eligibility**
- 4.1 All players participating in League competitions must be registered with the League and be members of League clubs. For registration, each club secretary shall send on the form provided together with required fees, a list of club players to Badminton England, before the first match of the season. Additional players may be registered on individual registration forms, together with required fees which must be sent to Badminton England before participating in any match or tournament of any kind. No player may be registered after 31st December in the current season except by permission of the Executive. Each year information about new fees will be sent to each club.
- 4.2 No player may participate in League competitions until the player's Badminton England and LCBA fees have been remitted to Badminton England.
- 4.3 Each club must provide the League Match Chairman with a list of their registered players, who must be assigned to one of their club's teams, before the first match of the season. The name(s) of any additional player(s) that a club wishes to register, as permitted in 4.1, must be sent and received by the League Match Chairman, together with the team to which they are assigned, before the player participates in any League competition.
- 4.4 Any player who participates in a League competition and whose registration with the League has not been effected before they play (4.1 and 4.3 refer), will be regarded as an ineligible player. If a team plays such an ineligible player then that team shall forfeit the match.
- 4.5 No player is eligible to play in a lower ranked team to the one they are assigned as required by 4.3. Any player who plays in a lower ranked team to the one to which they were assigned (4.3 refers) will be regarded as ineligible. Where a team plays such an ineligible player, then rule 2.10 will apply. A player will not be regarded as ineligible if a subsequent change has been made to the player's assigned team provided it has been notified to and approved by the League Match Chairman.
- 4.6 Any player having being registered for one club and wishing to play in league matches for another club during the same season may apply to the Executive for a transfer of their registration to the last mentioned club. A form of application to transfer, which must also state the team to which the player will be assigned, must be duly completed and deposited with the League Match Chairman not less than 7 days before the first match in which the player intends to play for his/her club. No player may be transferred in the current season except by permission of the League Match Committee. The player shall not play for the new club until he/she has received notification from the League Match Chairman that the transfer of their registration has been completed.
- 4.7 No club shall have the right to object to the registration of any player with another club except where the player is not clear on the books of the objecting club in respect of monies outstanding. Any club wishing to object under this rule must lodge such objection with the League Secretary, in writing, without undue delay, giving full particulars. The suspension by the Executive of any registration under this rule shall be operative only until the defaulting player shall have discharged his/her obligations to the objecting club.

2. **Match**
- 2.1 Each match shall consist of four mixed doubles, two men's doubles and two women's doubles; each event shall consist of the best of three games to 21 points (extended games if required) using rally points scoring. No player may play more than one like event nor in more than one match in any one night.
- 2.2 Captains must complete their teams on the match score sheet before the start of the match. Pairs must be played in order of strength otherwise, at the discretion of the Executive, events or the match may be forfeited.
- 2.3 Where a Club has two or more teams in the same division, it is expected that in matches between them the higher ranked team will prevail. However, the League Executive recognise that this will not always be the case and when such an eventuality occurs, will judge the circumstances accordingly.
- 2.4 The actual time of starting the match must be marked accurately on the score sheet. In the event of any delay arising in the commencement of any match, or any occurrence resulting in the match not being completed the reasons therefore shall be entered on the back of the score sheet and signed by both captains.
- 2.5 Feather shuttlecocks, of a standard to be determined by the Executive, shall be used in League matches and competitions.
- 2.6 In all events organised by the League, coloured clothing may be worn. In order to ensure attractive presentation of badminton, all clothing should be acceptable badminton sports clothing and, wherever possible, doubles partners are asked to try and wear the same colours. Track suits shall not be worn during match play except by agreement of both captains.
- 2.7 The order of play in all events shall be in accordance with the requirements of the home captain.
- 2.8 To be eligible to play in a particular match a player must be present and ready to play by 8.15pm. This may be extended to 8.30pm by mutual agreement on or before the date the match is played. Prior to 8.15pm (extended to 8.30pm by mutual agreement) a team can substitute a player already entered on the match score sheet and who has not yet played in that match provided the substitute is of equal or lesser standard than the player originally named.
- 2.9 Where a player is not present by 8.15pm (extended to 8.30pm by mutual agreement) and a substitute has not been used, as per rule 2.8, then the opposing team captain shall regard all the games in which the absent player would have played as being forfeited. The captain must inform the opposing captain immediately that he/she regards the games of the absent player as forfeited, and the games involved must be entered on the Match Score Sheet as 21.0 and identified by W/o (Walkover).
- 2.10 Where a team plays an ineligible player, that player must play at 4th mixed and 2nd Men's/Women's Doubles and the opposing captain notified. If a team plays an ineligible player other than as stated, then that team shall forfeit the match.
- 2.11 In the event of any player being incapacitated after play in a match has begun so that he or she cannot continue playing, a captain shall be entitled to include a substitute of an equal or lesser standard in any subsequent event in which the incapacitated player should have taken part provided that the injury or other incapacity was caused entirely after play in the match had begun and was not solely due to tiredness or the worsening of an existing ailment.
- 2.12 Any comments/complaints entered on the reverse of the Match Score Sheet must be acknowledged by way of signature by a representative from both teams, prior to the submission of the Match Score Sheet to the League Match Officer.
- 2.13 In the event of a match not being played it shall NOT be conceded without permission being sought and obtained from the League Match Officer.
3. **Post-match**
- 3.1 The home team is responsible for ensuring that the result of all league matches is sent to the Press Officer, Simon Dart either via email or text within 24 hours of the match being played.

DIAGRAM D

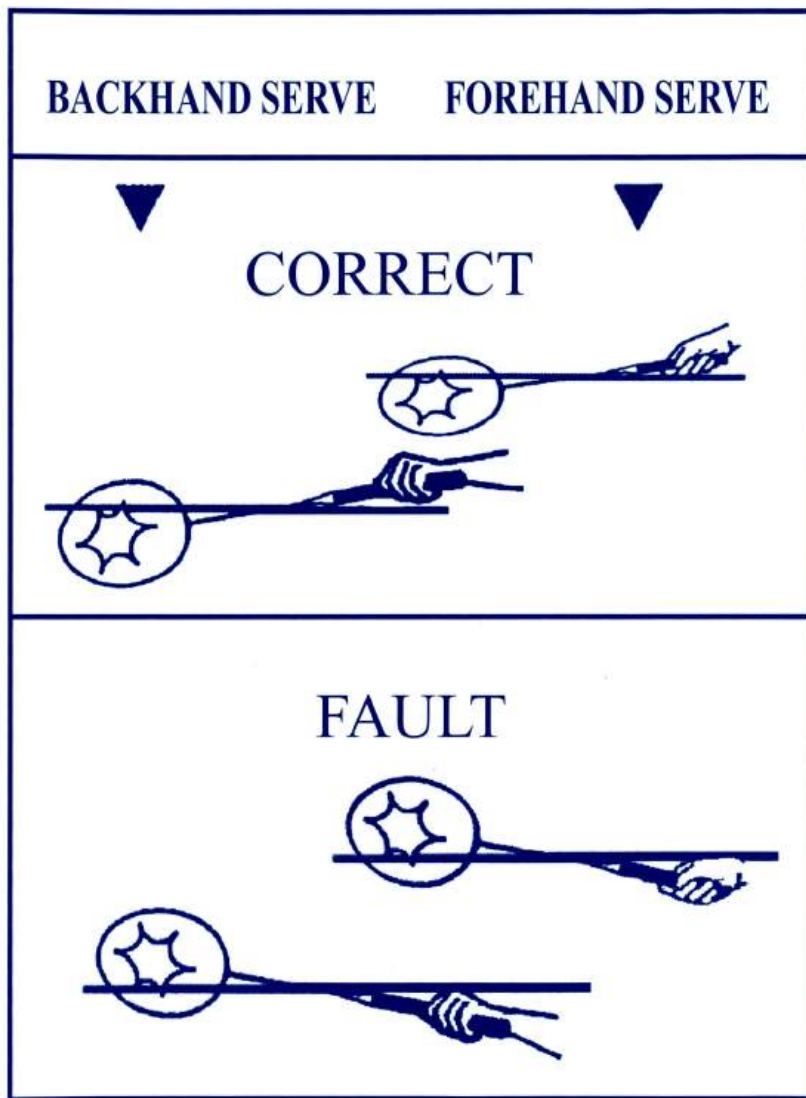

- 9.1.6 The shaft of the server's racket at the instant of hitting the shuttle shall be pointing in a downward direction



Campbell's of Southport

CITROËN SPECIALISTS



- Any Work Carried Out Does Not Affect Manufacturers Warranty
- All Work Carried Out By Ex-Citroen Consultant Technicians
- Genuine Citroen Parts & Total Lubricants Used
- Genuine Citroen Diagnostic Equipment
- Servicing & Repairs
- Servicing & Repair Of All Makes & Models Of Cars
- MOT Tests Arranged



Unit 1
Woodfield Garage
Gravel Lane
Banks Southport
PR9 8BY

Tel: 01704 226800
Mob: 07976 236675



- F. The League accounts shall be audited within two months of the end of the financial year and shall be available for inspection upon request by any registered League member.
- G. A copy of the final accounts for the financial year just ended shall be produced at the Annual General Meeting and shall be suitably clauseed if not audited.

8.-APPEALS

Any club or player shall have the right to appeal to the Executive on any matter and any such appeal or other application hereunder shall be dealt with in such manner as the Executive may determine and their decision shall be final.

9.-RULES

Any matter not provided for by these rules shall be dealt with by the Executive who shall also be the sole authority for the interpretation thereof, provided that any decision given by a General Meeting shall be binding. Any addition to, or interpretation of, these rules made by the Executive shall only be operative until the next Annual General Meeting of the League when they shall be reported to such meeting for confirmation or otherwise. No amendment or alteration to these rules shall be made except at a General Meeting.

APPENDIX

RULE 5c - COMPETITION

- Pre-match**
 - All matches shall be played under the Laws of Badminton with each court having a minimum playing standard as decided by the Executive. Unless prior permission to re-arrange a match has been obtained from the League Match Officer, see 1.4, matches shall be played in the particular week appointed by the Executive.
 - The home club shall have sole responsibility for deciding which night during the appointed week the match shall be played, what time play shall commence and which two events shall be played first, giving at least 14 days notice to the visiting club. It will be the duty of both clubs to ensure that its players are available for those events at the agreed time.
 - All matches shall commence not later than 7pm. In the event of a hall not being available for play at 7pm, prior approval for the use of the hall for matches must be obtained from the Executive.
 - Permission to re-arrange a match, which must be obtained by the Match Secretary from the League Match Officer, will only apply in the following circumstances:
 - The Home Club's hall is not available in the week the League fixture is due to be played
 - A Cup, Shield or Trophy match has to be played in the same week as the League Fixture by the home or away team and both matches cannot be played; or
 - A Club's lowest team is unable to field 8 players.

For re-arranged fixtures under (a), (b) or (c), permission must be **sought as soon as possible**. After 30 September in the current season not more than 2 postponements per team per season may be requested under (c) above. No postponement will be permitted within 48 hours of the start of the match where (c) applies. Failure to comply with this Rule will result in the Executive imposing a penalty not to exceed £30 and/or 3 points being deducted from either or both teams. For all re-arranged fixtures due to (c), where the away team seeks such a postponable, a payment of £20 to defray such expenses will be made by the away team to the home Club.
 - Matches can only be re-arranged (see 1.4) by Match Secretaries and must be completed within 56 days of the original match date. Failure to comply with this rule will result in a penalty not exceeding £20 being imposed by the Executive on either or both teams and the League Match Officer will direct when and where the match be played.

- (b) All items to be placed on the agenda of the Annual General Meeting, including nominations for office and for the Executive, shall be sent in writing to the General Secretary so as to reach him not later than 28th February in the same year.
- (c) Not less than 14 days notice of any general meeting shall be given. Written notification to each affiliated club secretary, which shall include the agenda for the meeting shall be deemed to be sufficient notice of the Annual General Meeting.
- (d) An Extraordinary General Meeting shall be convened upon a resolution of the League Executive or at the written request to the General Secretary of not less than 20 members being representative of at least 6 member clubs. Such requests shall state the purpose for which the meeting is required and no other business shall be transacted. The meeting shall be held within one month of such requisition being received by the General Secretary and the notice and agenda shall be circulated to all member club secretaries at least 14 days in advance.
- (e) Accidental omission to give the required notice to any Club Secretary shall not invalidate the proceedings at a general meeting.
- (f) All registered players of the League shall be entitled to attend and vote at any general meeting of the League.
- (g) Voting shall be by show of hands unless any 6 persons present (who are entitled to vote) demand a ballot.
- (h) No member may vote by proxy.
- (i) No individual may have more than one vote, except the Chairman of a meeting who shall have a casting vote.
- (j) At all General Meetings 20 members entitled to vote shall form a quorum.
- (k) If there is no quorum for:-
 - (i) an Extraordinary General Meeting, the motion(s) on the agenda shall be deemed to have been defeated and the meeting concluded.
 - (ii) an Annual General Meeting, it shall be adjourned and another notification shall be circulated without a time restriction. At the adjourned meeting the members present shall form a quorum.

7.-FINANCE

- A. The Financial year of the League shall end on 31st March.
- B. Annual subscriptions shall be paid by 1st October in each League year. The Club subscriptions are:-
 - (i) League entrance fee (New Clubs only).
 - (ii) Club annual subscription.
 - (iii) Team registration fee.
 - (iv) Junior team registration fee.
 and all rates will be advised by the league treasurer, to every Club Treasurer by the 31st of July of the current season.
- C. No player may participate in any Cup, League, Tournament or Shield event until the player's Badminton England and L.C.B.A. fees have been remitted to Badminton England. All rates will be advised to every Club Treasurer by the 31st July of the current season.
- D. All monies due to the League shall be deemed to be owing to the League Treasurer.
- E. Any Club whose annual subscriptions, as in 'B' above, remain unpaid after 1st October each year shall be liable to such a penalty as the Executive may decide.

SHUTTLE TESTING

One thing that most league members seem to agree on is the fact that the overall standard of feathered shuttlecocks is dropping.

Whereas there is little your League Executive can do to influence the quality and consistency of the shuttle manufacturers' product, we can at least try to ensure standardisation of speed.

It would appear that opinions of what speed a shuttle should be and more importantly how to test it vary greatly throughout all the divisions.

In order to clarify precisely what constitutes testing a shuttle we have printed below the relevant extracts from the LAWS OF BADMINTON and included a diagram of distances and tolerances to show where a tested shuttlecock should land from a full underhand stroke which makes contact with the shuttle over the back boundary line. The shuttle shall be hit at an upward angle and in a direction parallel to the sideline.

Optional Testing Marks for Doubles Court
(See Law 1.3)

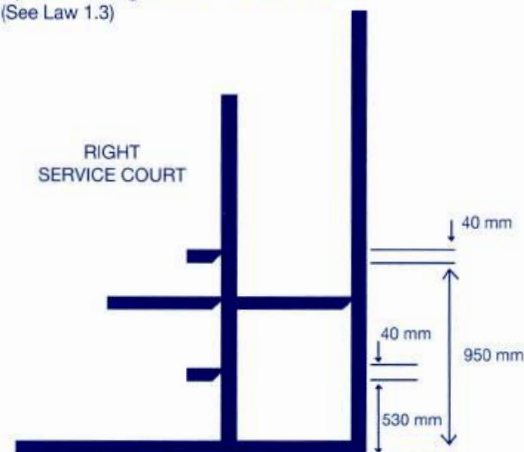

N.B. measurement of marks 40 mm by 40 mm

INTERNATIONAL APPEARANCES

Mrs. S. Sankey	GB	1
	England	81
Miss J. Wright / Mrs. Nicholas	GB	1
	England	36

SOUTHPORT LEAGUE PLAYERS

(representing Lancashire County 1st Team - not updated)

Mrs. S. Sankey	95	M. H. Hill	30	Miss C. Clucas	8
K. Houldcroft	57	Mrs. D. Vines	27	H. Wright	6
D. Allen	55	Miss S. Littlewood	15	R. Marshall	5
Mrs. J. Pearson	53	Miss D. Tollitt	12	Miss C. Walker	4
E. J. Usher	51	Mrs. A. Abdous	11	Mrs. D. Rigby	3
Miss J. Wright	51	M. Kellett	10	N. Green	2
Mrs. B. Kime	45	A. Hurd	9	R. C. Jones	2
Mrs. S. Lindsay	40	Miss H. Reed	7	Mrs. V. L. Maxwell	1
P. B. Kime	36	J. Harford	6	Miss C. Kelly	1
Miss K. Pearson	33				

APPEARANCES BY PLAYERS AWARDED

SOUTHPORT LEAGUE TOWN TEAM COLOURS

(7 or more appearances for Southport Town 1st Team in LCBA Inter-League League)

Mrs. D. Rigby	136	Mrs. S. Sankey	39	Miss J. Wright	12
R. Marshall	113	Mrs. S. Wilkie	38	Miss C. Atfield	11
S. Hurst	108	A. Pickles	36	M. Johnston	11
Mrs. D. Vines	93	N. Tolman	36	A. Pratt	11
J. Abdous	92	J. Machin	33	J. Steele	11
Mrs. A. Abdous	72	Miss J. Bridge	31	A. Davidson	10
Mrs. S. Hurst	72	Mrs. D. Balmforth	31	P. Athans	9
S. Almond	64	J. Harford	27	J. Bowker	7
K. Balmforth	40	Miss K. Pearson	18	J. Parsons	7

- 4C. (ii) All retiring officers shall be eligible for re-election.
- (i) The Executive shall have full power to transact the general business of the League.
- (ii) The Executive shall have the power to:-
- (a) fill any casual vacancy occurring, including a vacancy under Clause (iv) of this rule but anyone so appointed shall serve only until such time as the original member would have retired by rotation.
- (b) elect at any time any number of Vice-Presidents of the League, to hold office for such period as the Executive may determine.
- (c) take any steps which they consider necessary for the purpose of enforcing payment of any subscription or fines payable or imposed under any rules for the time being of the League.
- (d) admit individuals to League membership.
- (e) elect Honorary Life Members who may attend meetings of the Executive.
- (f) appoint and delegate powers to Committees and such Committees may co-opt members to the Committee from outside the Executive provided that the number of co-opted members is always less than the number of members of the Executive on the Committee.
- (iii) The Executive shall meet not less than three times annually. Meetings shall be called at the discretion of the Chairman or at the request in writing of at least six members of the Executive.
- (iv) if any member of the Executive be absent from three consecutive Meetings they may, at the discretion of the Executive be treated as having thereby tendered their resignation.

5.-THE LEAGUE

5A.

General

- (i) The League year for which all officers and Executive members, whether elected, co-opted or substituted, shall hold office, and during which the membership and registration of all clubs and players shall subsist shall be from the 1st day of May in one year to the 30th of April the following year.
- (ii) Application for membership to the League for any year must be delivered in writing to the General Secretary not later than the 30th day of April preceding the year concerned. First applications must be accompanied by the prescribed entrance fee and details of the Club's insurance cover which is compulsory.
- (iii) an annual subscription shall be paid by each member club.
- (iv) where a club has entered a number of teams in the League and then requests permission to withdraw any particular team after the Division has been formed by the Executive such requests may be submitted to the General Purposes Committee for arbitration. The decision of the Executive based on all relevant facts shall be final. The team registration fee and an administration fee, as determined by the Executive, shall be paid.

5B.

Structure

- (i) The League shall consist of one or more divisions as the Executive shall determine.
- (ii) The Executive shall form each division at its first meeting, when it may reconstitute the divisions.

5C.

Competition - (see Appendix page 40)

6.-GENERAL MEETINGS

(a)

The Annual General Meeting of the League shall be held in the month of April on a day and at a place and time appointed by the Executive for the adoption of the Executive report and final accounts, any alterations to rules, the election of officers and the Executive as required under Rule 4, the election of the Hon. Auditor, and such other business as may be transacted in general meeting.

SOUTHPORT AND DISTRICT BADMINTON LEAGUE RULES

1.-NAME

The League shall be called the Southport and District Badminton League.

2.-OBJECTS

The objects of the League shall be:-

- (a) to promote badminton generally in Southport and District.
- (b) to take any action to further the interests of badminton.
- (c) to ensure that affiliated members observe:-
 - (i) the Laws of Badminton
 - (ii) the regulations of the Badminton World Federation and of Badminton England
 - (iii) the regulations of the Lancashire County Badminton Association.

3.-CONSTITUTION

The League shall be affiliated to the Lancashire County B.A. Members eligible for affiliation to the League at the discretion of the Executive Committee shall be:-

- (a) clubs of which at least one of the objects is badminton and which have their headquarters and courts in Southport and district. The Executive shall determine the effective district boundary.
- (b) Schools and Youth Associations whose member clubs have an age limit of 21 years. Such member clubs need not affiliate themselves directly, but unless so affiliated shall not be entitled to the privileges of affiliation.
- (c) Schools and Youth Clubs whose members have an age limit of 21 years.
- (d) Individuals, known as private members, who shall:-
 - (i) pay an annual subscription
 - (ii) receive copies of all league circulars
 - (iii) be eligible to attend League Meetings
 - (iv) be eligible to vote and hold office
 - (v) be eligible to enter the Veterans Tournament only, subject to the rules of that tournament.

- (e) Honorary Life Members.

Individual members of individual clubs and associations are ipso facto indirect members of the League.

4.-ADMINISTRATION

- 4A. (i) The management of the League shall be vested in an Executive consisting of:-
 - (a) the officers of the League
 - (b) fifteen other members to be elected at the Annual General Meeting, five of whom retire each year in rotation.
- (ii) Six members shall form a quorum at any committee meeting.
- (iii) All retiring members of the Executive shall be eligible for re-election.
- (iv) The Officers of the League upon retirement from office shall be ex-officio Executive for one year unless the Executive shall otherwise decide.
- (v) The Chairman shall have a casting vote at all meetings of the Executive.
- 4B. (i) The officers of the League shall consist of:-

President	League Match Committee Chairman
Chairman	Cups & Shields Committee Chairman
Vice-Chairman	Tournaments Committee Chairman
General Secretary	League Match Officer
Treasurer	Press Officer
Junior League Officer	Sponsorship Officer



D REALITY ROADSHOW CO

Colin Peet
Professional DJ
Fully insured and CRB checked
E-mail: colin@realitydisco.co.uk

Reality Roadshow Disco
Music & Entertainment for your Special Occasion
Telephone: (01704) 225804
www.realitydisco.co.uk

✱ **Weddings**
✱ **Christenings**
✱ **Bar Mitzvah**
✱ **Dinner Dances**
✱ **New Year Celebrations**
✱ **Children's Parties**

Available for all Private Functions

Family History Research Service

Michael Dow Associates

E-mail: mrdown@btinternet.com or kathryn.dow@tesco.net

30 Barrett Road, Birkdale, Southport PR8 4PG
Telephone: (01704) 568415



*Research undertaken at
Lancashire, Liverpool & Cheshire Record Offices
BMDs, census, parish registers,
local graveyards & newspapers etc searched
to compile a family tree and family history.
Family trees printed and reports given.
Charges £10.00 an hour*

AWARD WINNING FISH & CHIP RESTAURANT & TAKE AWAY



29 EASTBANK STREET
SOUTHPORT
PR8 1DY

TELEPHONE
(01704) 537370

PROPRIETORS: C. AND D. BRINDLE

GUIDANCE ON RALLY POINTS SCORING

Scoring System

- A game consists of 21 points.
- In all League and Cup matches at 20 all, the side which gains a 2 point lead first, wins that game. (extended game).
- If the score reaches 29 all, then the side scoring the 30th point, wins that game.
- For Watkinson Trophy events a game consists of 25 points and there is no extended game i.e. a game can be won 25/24.
- For Shield matches a game consists of 30 points and there is no extended game i.e. a game can be won 30/29.
- In all matches, the side winning a rally adds a point to its score.
- The side winning a game serves first in the next game. This does not apply to Shield matches as each event consists of one game only.

Change of Ends

- When a third game is played in all League and Cup Matches, players change ends when a side has scored 11 points.

Serving, Receiving and Determination of Service Courts

- There is only one serve in doubles on each occasion a side has the right to serve.
- When a serving side loses the serve the next time the service comes back the player who did not serve on the last occasion becomes the new server.
- Service is from the right hand court at the beginning of the game and when the serving's side score is even, and from the left hand court when the serving's side score is odd.
- If the serving side wins a rally, the serving side scores a point and the same server serves again from the alternate service court. A player will continue to serve until his side loses a rally.
- If the receiving side wins a rally, the receiving side scores a point. The receiving side becomes the new serving side and the player in the appropriate court for the score (even-right; odd-left) of the new serving side will serve.
- The player of the new receiving side who served last stays in the same service court from where he served last. The reverse pattern applies to the receiver's partner.
- Players do not change their respective service courts until they win a point when their side is serving.
- If players commit an error in the service court, the error is corrected when the mistake is discovered but the score remains unaltered.

We serve...



...and our customers return

From business cards to full colour brochures, our service and quality remains paramount, which is why our company is growing, along with the recognition from our continually satisfied customers.

 **mitchell&wright printers Ltd**



The Print Works, Banastre Road, Southport PR8 5AL
Tel: 01704 535529 Fax: 01704 543216
Web: www.mitchell-wright.co.uk

BPIf
member

B.B JOINERY

All aspects of Joinery

- WINDOWS
- DOORS
- uPVC
- FLOORING
- KITCHENS
- SOFFITS
- FASCIAS

Tel: 07704 9111 08
E: bbjoinery@yahoo.co.uk

THE VERA MAXWELL AWARD

Nominations may be submitted any time but must be made by February 28th.

Personal nominations, in confidence, from any league member, to anyone on the Review Panel which is:

M. Banham (Executive Chairman), Mrs. F. Colville, P. Duncan, (General Secretary), N. Griffith and G. Perry (Vice-Chairman).

In considering the Award, the Review Panel prefers to recognise the services generously given by those unsung, hard working amateur enthusiasts who do not normally attract general acclaim.

The awards may be for a particular occurrence or for the culmination of many seasons' unrecognised service.

THE VERA MAXWELL AWARD

1978 J. Blockley	1995 Mrs. T. Pattison and A. Woolley
1979 D. Alderson and F. Simpson	1996 Mrs. H. Cannon and Mr. R. Cannon
1980 Mrs. K. Griffiths	1997 Mrs. L. Davies
1981 R. H. Simm	1998 M. R. E. Hyde
1982 Miss A. Howard	1999 Mrs. M. Warren and R. Shepherd
1983 <i>No Award Made</i>	2000 J. Sinclair
1984 G. H. Lloyd	2001 Mrs. J. Lewis and Mrs. H. Blomley
1985 F. Skelly	2002 Mrs. S. Clark
1986 <i>No Award Made</i>	2003 Mrs. B. Sephton
1987 J. Henderson	2004 Mrs. D. Rigby
1988 <i>No Award Made</i>	2005 J. Prescott
1989 D. Barton	2006 R. H. Simm
1990 P. Isherwood	2007 Mrs. J. Crowley
1991 Mrs. S. Rimmer	2008 Mrs. A. Almond
1992 D. James	2009 Miss C. Atfield and Miss E. Walmsley
1993 R. Warhurst and K. Breese	2010 Mrs. J. Edwards and J. Edwards
1994 <i>No Award Made</i>	2011 D. Miller

INDIVIDUAL OPEN CHAMPIONSHIPS

Mens Singles

1999 M. Kellett
2000 T. Cope
2001 M. McDonald
2002 M. McDonald
2003 J. Parsons
2004 J. Parsons
2005 J. Parsons
2006 N. Tolman
2007 N. Tolman
2008 S. Sankey
2009 J. Fairclough
2010 P. Maguire
2011 D. Finn

Womens Singles

1999 Miss J. Long
2000 Miss D. Tollitt
2001 Miss D. Tollitt
2002 No Event
2003 Miss J. Bridge
2004 No Event
2004 Miss H. Richards
2006 Miss N. Poole
2007 Miss S. James
2008 Miss E. Balmforth
2009 Miss A. Ashrafi
2010 No Event
2011 No Event

Mens Doubles

1999 S. Almond and J. Abdous
2000 S. Bentzen and M. Kellett
2001 S. Bentzen and M. Kellett
2002 S. Almond and M. Kellett
2003 J. Parsons and M. Kellett
2004 D. Allen and J. Priestley
2003 J. Parsons and J. Abdous
2006 P. Hope and S. Webber
2007 M. Tuttle and S. Bentzen
2008 S. Taylor and O. Morris
2009 A. Pratt and D. Finn
2010 A. Pratt and D. Finn
2011 A. Pratt and D. Finn

Womens Doubles

1999 Miss C. Clucas and Miss C. Walker
2000 Mrs. S. Sankey and Mrs. D. Rigby
2001 Miss C. Clucas and Miss C. Walker
2002 Miss C. Clucas and Miss C. Walker
2003 Miss J. Bridge and Miss W. Higgin
2004 Miss C. Clucas and Miss C. Walker
2005 Mrs. H. Harrison and Miss S. Taylor
2006 Mrs. H. Harrison and Miss S. Taylor
2007 Miss C. Clucas and Miss A. Wilson
2008 Miss C. Clucas and Miss C. Walker
2009 Miss C. Clucas and Miss C. Walker
2010 Miss C. Clucas and Miss C. Walker
2011 Miss C. Clucas and Miss C. Walker

Mixed Doubles

1999 S. Almond and Mrs. D. Rigby
2000 D. Allen and Mrs. D. Rigby
2001 M. Kellett and Miss D. Tollitt
2002 M. Kellett and Miss D. Tollitt
2003 M. Kellett and Miss D. Tollitt
2004 D. Allen and Miss D. Tollitt
2005 J. Parsons and Miss J. Long
2006 D. Hunter and Miss L. Hunter
2007 M. Tuttle and Miss A. Wilson
2008 S. Bentzen and Miss C. Clucas
2009 D. Finn and Mrs. H. Harrison
2010 P. Maguire and Miss E. Miller
2011 M. Johnston and Mrs. G. Sowden

HADLEY & Co.

Chartered Accountants

Business Advisors

Tax Planning Specialists

for a personal cost-effective service to
individuals and privately owned businesses
throughout the north west

Contact us for a free initial consultation

Tel. 01704 534539

Fax. 01704 500778

accts@hadleyand.co.uk

www.hadleyand.co.uk

Adelphi Chambers,
30 Houghton Street, Southport PR9 0NZ

Also at: 65 Penrhyn Avenue, Litherland L21 6ND
(Tel. 0151 949 0382 / 0398)

MASTER LOCK & SAFE

SOUTHPORT & DISTRICT BADMINTON LEAGUE

Formation of Divisions Season 2011/2012

Division One	Division Two	Division Three	Division Four
1 Burscough	1 Mawdesley 2	1 Burscough 3	1 Hesketh Bank
2 Woodvale	2 Southsands 2	2 Woodvale 3	2 Woodvale 5
3 West Park End	3 Southport 3	3 Tarleton 2	3 West End Park 3
4 Victoria Hall	4 St. Cuthberts	4 Victoria Hall 3	4 St. Cuthberts 3
5 Churchtown	5 Southport 2	5 Pioneers	5 Churchtown 3
6 Mawdesley	6 Burscough 2	6 Mawdesley 3	6 Southport 5
7 Southsands	7 Woodvale 2	7 Woodvale 4	7 Southsands 3
8 West End Park 2	8 Tarleton	8 Southport 4	8 Tarleton 3
9 Victoria Hall 2	9 Formby	9 St. Cuthberts 2	9 Formby Methodist
10 Southport	10 Churchtown 2	10 Ormskirk	10 Pioneers 2

Division Five	Division Six	Division Seven
1 Southport 6	1 Mawdesley 4	1 Formby Methodist 2
2 Southsands 4	2 Woodvale 7	2 Churchtown 4
3 Tarleton 4	3 West End Park 5	3 Southsands 9
4 Formby 2	4 Hoole	4 St. Cuthberts 5
5 Ormskirk 2	5 Southsands 6	5 Hesketh Bank 3
6 Hesketh Bank 2	6 Southport 7	6 Southport 8
7 Woodvale 6	7 Woodvale 8	7 Woodvale 9
8 West End Park 4	8 Southsands 8	8 Tarleton 5
9 St. Cuthberts 4	9 Formby 3	9 West End Park 6
10 Southsands 5	10 Southsands 7	10 Southsands 10
		11 Formby Methodist 3

SOUTHPORT AND DISTRICT BADMINTON LEAGUE - League Programme Season 2011/12

CUPS, SHIELDS and TOURNAMENTS		LEAGUE FIXTURES DIVISIONS 1 to 6 only						LEAGUE FIXTURES DIVISION 7					
2011		Week Beginning September						Week Nos.					
L1	CUPS - Round 1	12	—	—	—	—	—	L1	1 v 2	3 v 4	5 v 6	7 v 8	9 v 10
L2	CUPS - Round 2 by 21.10.11	19	1 v 2	7 v 6	5 v 3	8 v 10	9 v 4	L2	2 v 3	4 v 5	6 v 7	8 v 9	10 v 11
		26	3 v 1	6 v 8	2 v 7	4 v 5	10 v 9						
		October											
L3	A.C & Jack Blockley TOURNAMENTS Entries by 11.11.11	3	1 v 4	9 v 6	5 v 10	2 v 3	8 v 7	L3	3 v 1	5 v 8	7 v 10	9 v 4	11 v 6
L4	WATKINSON - Preliminary Round	10	5 v 1	6 v 10	3 v 8	4 v 2	7 v 9	L4	1 v 7	4 v 11	6 v 9	8 v 2	10 v 5
L5	CUPS - Semi Finals played by 18.11.11	17	1 v 6	3 v 4	2 v 5	9 v 8	10 v 7	L5	2 v 10	5 v 1	6 v 3	7 v 9	11 v 8
L6	SHIELDS- Preliminary Round to be played by 16.12.11	24	7 v 1	6 v 5	8 v 2	10 v 4	9 v 3	L6	1 v 11	6 v 2	8 v 3	9 v 5	10 v 4
	WATKINSON - Round 1 -	31	—	—	—	—	—						
		November											
L7		7	1 v 8	4 v 6	2 v 9	3 v 10	5 v 7	L7	2 v 5	3 v 7	4 v 1	8 v 10	11 v 9
L8		14	9 v 1	6 v 3	10 v 2	8 v 5	7 v 4	L8	1 v 10	4 v 6	5 v 11	7 v 2	9 v 3
	WATKINSON - Round 2	21	—	—	—	—	—						
	C Tournament (Finals Sunday 4 December)	28	—	—	—	—	—	L9	1 v 8	2 v 4	3 v 5	10 v 6	11 v 7
		December											
	A Tournament (Finals Sunday 4 December)	3 & 4	—	—	—	—	—						
	Jack Blockley Tournament (Sunday only including final)	4	—	—	—	—	—						
L9	CUPS - Finals	5	1 v 10	2 v 6	3 v 7	4 v 8	5 v 9	L10	2 v 11	7 v 4	8 v 6	9 v 1	10 v 3
L9	CUPS - Finals	12	—	—	—	—	—	L11	4 v 3	5 v 7	6 v 1	8 v 11	9 v 2
		19	—	—	—	—	—						
		26	—	—	—	—	—						
		January											
L10		2	2 v 1	6 v 7	3 v 5	10 v 8	4 v 9	L12	2 v 1	6 v 5	8 v 7	10 v 9	11 v 3
L11		9	1 v 3	8 v 6	7 v 2	5 v 4	9 v 10	L13	3 v 2	5 v 4	7 v 6	9 v 8	11 v 10
	WATKINSON - Round 3 & SHIELDS - Round 1	16	—	—	—	—	—						
L12		23	4 v 1	6 v 9	10 v 5	3 v 2	7 v 8	L14	1 v 3	4 v 9	6 v 11	8 v 5	10 v 7
L13	V & B TOURNAMENTS Entries by 09.03.12	30	1 v 5	10 v 6	8 v 3	2 v 4	9 v 7	L15	2 v 8	5 v 10	7 v 1	9 v 6	11 v 4
		February											
	WATKINSON - Round 4 & SHIELDS - Round 2	6	—	—	—	—	—	L16	1 v 5	3 v 6	8 v 4	9 v 7	10 v 2
L14	WATKINSON & SHIELDS - Semi-finals by 09.03.12	13	6 v 1	4 v 3	5 v 2	8 v 9	7 v 10	L17	2 v 6	3 v 8	4 v 10	5 v 9	11 v 1
L15		20	1 v 7	5 v 6	2 v 8	4 v 10	3 v 9	L18	1 v 4	5 v 2	7 v 3	9 v 11	10 v 8
L16		27	8 v 1	6 v 4	9 v 2	10 v 3	7 v 5	L19	2 v 7	3 v 9	6 v 4	10 v 1	11 v 5
		March											
L17		5	1 v 9	3 v 6	2 v 10	5 v 8	4 v 7	L20	4 v 2	5 v 3	6 v 10	7 v 11	8 v 1
L18		12	10 v 1	6 v 2	7 v 3	8 v 4	9 v 5	L21	1 v 9	3 v 10	4 v 7	6 v 8	11 v 2
	V TOURNAMENT (Finals Sunday 25 March)	19	—	—	—	—	—	L22	1 v 6	2 v 9	3 v 11	4 v 8	7 v 5
	B TOURNAMENT (Finals Sunday 25 March)	24 & 25	—	—	—	—	—						
	SHIELDS & WATKINSON FINALS	26	—	—	—	—	—						