

John Suncan

241 Lord Street, Southport PR8 1NQ
Telephone (01704) 537686
3 Cambridge Arcade, Southport PR8 1QS
Telephone (01704) 536051

Pipes, Lighters, Cigars, Tobacco, Gloves, Pens, Walking Sticks, Games, Umbrellas, Brief Cases, Handbags, Shaving Sets, Purses, Wallets, Compacts and other high class gifts.

Southport & District Badminton League 2002-2003

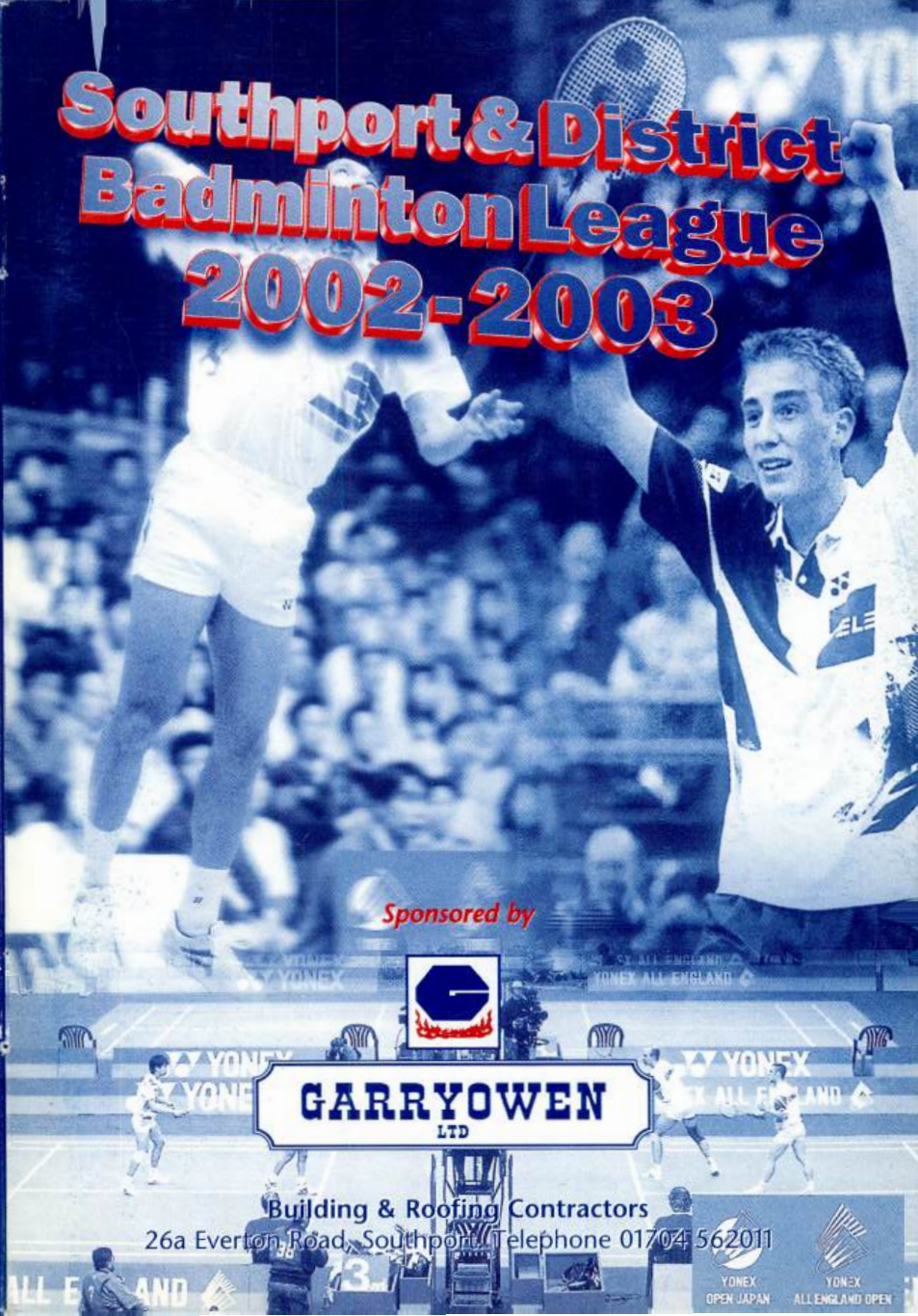

Sponsored by



GARRYOWEN
LTD

Building & Roofing Contractors

26a Everton Road, Southport Telephone 01704 562011



GARRYOWEN LTD

26a Everton Road, Southport PR8 4BT
Tel.: (01704) 562011 Fax.: (01704) 550003

Dear Members,

Fáilte moor (a big welcome) to the Southport and District Badminton League which Garryowen Limited are happy to be sponsoring.

I hope that the forthcoming events in the league's calendar will be successful. I wish the contestants good luck in the tournaments and the spectators a happy and enjoyable time. May the league go from success to success in the future and continue to be blessed with both the quality and quantity of competitors and spectators it deserves.

A big thank you to your committee for the invitation to your annual dinner which my manager and I thoroughly enjoyed. I enjoy our association with the league and look forward to seeing you at the prize-giving ceremonies.

Fáile go brá aguib
(Have great tournaments everyone).

Yours sincerely

F. J. Bartlett
Managing Director

Garryowen Limited

Est



1980

GARRYOWEN LTD

- * Building
 - * Plumbing
 - * Flooring
 - * Brickwork
 - * Painting
 - * Drainage
 - * Roofing
 - * Tiling
 - * Plastering
 - * Glazing
 - * Joinery
 - * Metalwork
- * Emergency Repairs
& Drain Clearing

All work carried out to the
Highest Standards
by Qualified Tradesmen

Tel: 01704 562011



26a Everton Road, Southport

THE JACK BLOCKLEY TOURNAMENT

Conditions of Entry

1. Entry Fee per pair is £6. Cheques payable to Southport Badminton League.
2. Competitors must be under 21 years of age at the closing date for entry.
3. The closing date for entry is 12/10/02.
4. The dates and times of your events will be sent to your Club Secretary and published in the Southport Visiter. No other notification will be given.
5. **Competitors must report to the desk immediately upon arrival.**

INDEX

	<i>Page/s</i>
Sponsor's letter and information	Inside front and back covers
ENTRY FORMS	
The GARRYOWEN LTD, V, A, B, C & J. BLOCKLEY Tournaments	53, 54, 55, 56, 57, 58, 59, 60
New Veterans Format	52
New International Setting Rule	30
THE LEAGUE	
Officials	2
Committees	3
Chairman's Message	4
Annual Presentation Dance	38
Directory of Clubs 2002/2003.....	5, 7, 9
The "Inflight" Junior League	10, 11
Divisional Champions	13
League Tables 1, 2, 3	15
League Tables 4, 5, 6	17
League Tables 7, 8, 9	19
Umpires	20
Fault Serving	20/21
Shuttle Testing, Rules and Court Markings.....	23
Divisions and League Programme 2002/2003 (Facing Centre Pages).....	30/31
Coaching, International, Lancashire, Town Team Appearances.....	25
LEAGUE RECORDS	
Individual Open	29
Team K.O. (Cups)	43
Team Handicap (Shields and Watkinson Trophy).....	41
Vera Maxwell Trophy	27
RULES AND REGULATIONS	
League Rules	32,33,34,35
League Rule 5c: Competition - Appendix & Registration Fees.....	35,36,37,38
Cup Regulations	44,45
Shield Regulations	46,47
Watkinson Trophy Regulations.....	49
Individual Tournament Regulations	50, 51
ADVERTS 6, 8, 12, 14, 16, 18, 22, 24, 26, 28, 39, 40, 42, 48, Back Cover	

SOUTHPORT AND DISTRICT BADMINTON LEAGUE

Life Member:

M. R. E. Hyde.

Vice-Presidents:

G. H. Bailey, K. Houldcroft, R. D. Kime, G. H. Lloyd and J. E. Moore.

THE LEAGUE EXECUTIVE

President:

J. Henderson, Flat 4, 16 Westcliffe Road, Southport, PR8 2BN. Tel. 565957

Executive Chairman:

M. Banham, 36 Larch Street, Southport, PR8 6DL. Tel. 547917

Vice-Chairman:

G. Perry, 216 Guildford Road, Southport, PR8 4NQ. Tel. 564551

General Secretary:

R. S. Grindlay, 92 Wicks Lane, Formby, Liverpool, L37 1PX. Tel. 874357

Assistant Secretary:

D. James, 3 Holmwood Gardens, Formby. Tel. 875203

Treasurer:

G. M. Pike, 25 Blundell Road, Hightown, Liverpool, L38 9EE. Tel. 0151 929 2996

League Match Chairman:

Mrs. M. Halliwell, 100 Lexton Drive, Southport, PR9 8QW. Tel. 225500

League Match Officer:

R. H. Simm, 87 Warren Road, Southport, PR9 7QU. Tel. 227939
Mobile 0780 3918656

Cups & Shields Chairman:

D. Bradley, 173 Wennington Road, Southport PR9 7AH. Tel. 214235

Tournaments Chairman:

M. Billington, 17 Barford Close, Southport, PR8 2RS. Tel: 576599

Sponsorship Officer:

N. R. Marshall, 9 Nolan Street, Southport, PR8 6QQ. Tel. 542088

Press Officer:

J. Sinclair, 12 Longacre, Southport, PR9 9TB. Tel. 212374

Ordinary Members:

Mrs. P. Boylett, Ms. J. Bridge, D. Clark, Mrs. S. Clark, Miss J. Cook, K. Courtley, R. Davies, P. Duncan, N. Haywood, J. Howell, M. R. E. Hyde, D. B. James, J. G. Prescott.

THE JACK BLOCKLEY TOURNAMENT

Entry Form

To: M. Billington, Esq.

17 Barford Close,
Southport PR8 2RS
Tel: 576599

From:.....(Club)

Please enter the following pair(s) in the above tournament

Pair (1)

Man

Lady

Full Name Full Name

.....

Tel. No..... Tel. No.....

Club Team..... Club Team.....

Division..... Division.....

Pair (2)

Man

Lady

Full Name Full Name

.....

Tel. No..... Tel. No.....

Club Team..... Club Team.....

Division..... Division.....

Signature(Club Secretary)

Entry Fee per pair is £6 (inclusive of all shuttles used)

Entry Fee enclosed £

Please refer to conditions of entry overleaf

THE GARRYOWEN LTD 'A', 'B', 'C' AND 'V' TOURNAMENTS

CONDITIONS OF ENTRY:

1. An entry form is required for each competitor.
2. Entry fee per person per event is £3.50. Cheques payable to Southport Badminton League.
3. Closing dates for entries are 'A', 'V1' and 'V2' 12-10-02, 'C' 11-1-03, 'B' 8-2-03.
4. All Tournaments will be played on a straight "Knockout" basis. The first shuttle used in each round will be provided.
5. A "Plate" Competition will be played in the B & C Tournaments Mixed Doubles Events.
6. The date and time of your first event will be sent to your club secretary and published in the Southport Visiter. No other notification will be given.
7. **Competitors must report to the desk immediately upon arrival and ensure that any additional shuttle costs have been settled prior to their departure.**
8. Tournament regulations on pages 50/51 should be noted carefully, in particular regulation 3(e) regarding 'V1' and 'V2' tournaments criteria.

Competitors may note below any further information relevant to their entry.

COMMITTEES:

The Chairman, Vice-Chairman and General Secretary are ex-officio members of all Committees except the Selection Sub Committee.

Tournaments Committee: M. Billington (Chairman)
Ms. J. Bridge, D. Clark, Miss J. Cook, K. Courtley, Mrs. M. Halliwell, J. Henderson, D. B. James, R. Simm and J. Sinclair.

Cups and Shields Committee: D. Bradley (Chairman)
Mrs. P. Boylett, Mrs. S. Clark, P. Duncan, N. Haywood, J. Prescott, R. Simm and J. Sinclair.

League Match Committee: Mrs. M. Halliwell (Chairman)
D. Bradley, D. Clark, K. Courtley, P. Duncan, N. Haywood, M. R. E. Hyde, D. B. James, R. Simm and J. Sinclair.

Administration Committees: G. Perry (Chairman)

Discipline & Courts:

M. Billington, Mrs. P. Boylett, D. Bradley, K. Courtley, Mrs. M. Halliwell, M. R. E. Hyde, N. Marshall, J. Prescott, R. Simm and J. Sinclair.

Juniors:

M. Banham, Ms. J. Bridge, D. Clark, Mrs. S. Clark, R. Davies, J. Howell, N. Marshall, R. Simm and Miss M. Taylor (Co-opted).

Selection:

R. Davies (537592), J. Howell, N. Marshall, plus 3 Club Co-optees.

General Purposes Committee:

Chairman, Vice-Chairman, Secretary, Treasurer and Four Committee Chairmen.

Auditor: Mr. L. Ball, 28 Dunkirk Road, Southport.

SOUTHPORT & DISTRICT BADMINTON LEAGUE
WEBSITE AT: <http://www.badminton.f2s.com>

LEAGUE A.G.M. APRIL 23rd 2003

**A.G.M. AGENDAS AVAILABLE FROM CLUB
SECRETARIES IN MID-MARCH**

CHAIRMAN'S MESSAGE

Yet another season has come around. It is amazing how quickly we have no sooner finished one season than another is with us.

Once again I extend a warm welcome to all members, whether existing or new, of advancing years or still in the flush of youth. Such a diversity of age ranges together with playing abilities is the cornerstone of our League and long may it continue.

As we take to the courts at the start of the season we will hopefully be full of enthusiasm and energy following what we hope will have been a successful Commonwealth Games for our England badminton team. Indeed with Sara Sankey, a player in our League for many seasons representing her country, there will have been a distinctly local interest in both the team and individual competitions.

I have been asked on several occasions during the past months about the changes that might be introduced by the International Badminton Federation (IBF) to the scoring system. In particular, many people are anxious as to what impact, if any, changes would have on the Southport and District League. Can I assure you that irrespective of what alterations are made by IBF, it will not affect our current scoring system - games to 15 points or 21 points for the Shield competitions.

Last season saw the introduction of, or indeed the re-introduction of, a straight through divisional structure. It is hoped that such a system will in time create more balanced divisions in terms of ability. This however will not happen overnight and is something that will hopefully evolve over a period. So please be patient.

In last season's message I mentioned major changes to the registration system. Whilst I did suggest that there could be teething problems I did not realise how prophetic these observations would be. The B.A. of E. acknowledges that there were problems. Simon Loake the Association's Administration Manager admitted as much at our A.G.M. in April. However as the new season dawns, I remain optimistic that the registration process this year will be better for the benefit of all.

The season ahead will I hope offer the usual challenges to you whether this be in a League match, competition or tournament. The various tournaments throughout the season are wholly dependent on your participation. If you have never entered before or it is some time since you last did, then why not make this season one in which you do take part.

I send my good wishes to all of you for the season ahead and hope you get many hours of enjoyment from the sport we all love.

With best wishes

Malcolm Banham

THE GARRYOWEN LTD 'A', 'B' and 'C' TOURNAMENTS

ENTRY FORM

To: M. Billington, Esq.

17 Barford Close,
Southport, PR8 2RS.
Tel: 576599

Please enter me in the following events:

Date Signature

Full Name (Mr./Mrs./Miss).....(Capitals)

Address Tel. No.

Club and Team in Southport League Division.....

Club and Team in other Leagues Division.....

EVENT:	A/B/C	PARTNER'S FULL NAME: (COMPETITORS REQUIRING A PARTNER SHOULD ENTER 'PARTNER REQUIRED')
Men's/Ladies Singles		
Men's/Ladies Doubles		
Mixed Doubles		

Entry Fee Per Person Per Event is £3.50 (see overleaf for provision of shuttles)

TOTAL ENTRY FEE ENCLOSED £.....

PLEASE REFER TO CONDITIONS OF ENTRY OVERLEAF

THE GARRYOWEN LTD

'A', 'B', 'C' AND 'V'

TOURNAMENTS

CONDITIONS OF ENTRY:

1. An entry form is required for each competitor.
2. Entry fee per person per event is £3.50. Cheques payable to Southport Badminton League.
3. Closing dates for entries are 'A', 'V1' and 'V2' 12-10-02, 'C' 11-1-03, 'B' 8-2-03.
4. All Tournaments will be played on a straight "Knockout" basis. The first shuttle used in each round will be provided.
5. A "Plate" Competition will be played in the B & C Tournaments Mixed Doubles Events.
6. The date and time of your first event will be sent to your club secretary and published in the Southport Visiter. No other notification will be given.
7. **Competitors must report to the desk immediately upon arrival and ensure that any additional shuttle costs have been settled prior to their departure.**
8. Tournament regulations on pages 50/51 should be noted carefully, in particular regulation 3(e) regarding 'V1' and 'V2' tournaments criteria.

Competitors may note below any further information relevant to their entry.

DIRECTORY OF CLUBS

AINSDALE7.00 p.m. Wednesday and Thursday
 Location of Hall : Ainsdale High School, Sandringham Road, Ainsdale, Southport.
 General Secretary : Mrs. B. Dawson, 32 Balmoral Drive, Southport. Tel. 231780
 Match Secretary : Mrs. M. Warren, Flat 2, 31 Park Road, Southport. Tel. 548448

BURSCOUGH7.00 p.m. Wednesday
 Location of Hall : Burscough S. C., Mart Lane, Burscough.
 General Secretary : Mrs. P. Boylett, Threlfells Farm, Ormskirik. Tel. 01695 572884
 Match Secretary : Mr. P. Trotter, 84 Thurston, Skelmersdale. Tel. 01695 723933

CHURCHTOWN7.00 p.m. Wednesday and Thursday
 Location of Hall : United Reformed Church Hall, Botanic Road, Southport.
 General Secretary : Mr. C. Equizi, 16 Rectory Road, Southport. Tel. 211971
 Match Secretary : Mr. K. Balmforth, 56 Montrose Drive, Southport. Tel. 233375

FORMBY7.00 p.m. Tuesday and Friday
 Location of Hall : Formby High School, Freshfield Road, Formby.
 General Secretary : Ms. S. Wilson, 1 Buttermere Close, Formby. Tel. 877520
 Match Secretary : Mrs. P. Wilde, 140a Sussex Road, Southport. Tel. 549361

FORMBY METHODIST7.00 p.m. Tuesday and Friday
 Location of Hall : Methodist Church Hall, Elbow Lane, Formby.
 General Secretary : Mrs. V. Bousfield, 12 Savon Hook, Formby. Tel. 876352
 Match Secretary : Mrs. A. Almond, 5 Romsey Avenue, Formby. Tel. 877857

HESKETH BANK7.00 p.m. Monday and Wednesday
 Location of Hall : All Saints Hall, Station Road, Hesketh Bank.
 General Secretary : Mrs. K. Baybutt, Aughton Farm, 465 Moss Lane, Hesketh Bank. Tel. 01772 811035
 Match Secretary : Mr. M. Elliot, The Cottage, Boundary Meanygate, Hesketh Bank. Tel. 01772 811770

HOOLE8.20 p.m. Friday
 Location of Hall : Burscough S. C., Mart Lane, Burscough.
 General Secretary : Mr. R. Jones, 8 Standhouse Lane, Aughton, Lancashire. Tel. 01695 423916
 Match Secretary : Mr. C. Hornby, 24 Springfield Close, Burscough Tel. 892276

MAWDESLEY7.00 p.m. Monday and Thursday
 Location of Hall : Burscough S. C., Mart Lane, Burscough.
 General Secretary : Mrs. K. Hughes, 147 Liverpool Road North, Maghull L31 2HQ. Tel. 0151 287 4941
 Match Secretary : Mrs. J. Lewis, Hayfields, Tanfield Nook, Parbold. Tel. 01257 462465

Southport Sports

WE CARRY THE MOST COMPREHENSIVE RANGE
OF BADMINTON RACKETS IN TOWN

LARGE RANGE OF SPORTSWEAR AND FOOTWEAR

UNRIVALLED STRINGING SERVICE

GENEROUS CLUB DISCOUNTS

48 KING STREET, SOUTHPORT
Telephone: (01704) 530886

THE GARRYOWEN LTD 'A', 'B' and 'C' TOURNAMENTS

ENTRY FORM

To: M. Billington, Esq.

17 Barford Close,
Southport, PR8 2RS.
Tel: 576599

Please enter me in the following events:

Date Signature

Full Name (Mr./Mrs./Miss).....(Capitals)

Address Tel. No.

Club and Team in Southport League Division.....

Club and Team in other Leagues Division.....

EVENT:	A/B/C	PARTNER'S FULL NAME:
Men's/Ladies Singles		(COMPETITORS REQUIRING A PARTNER SHOULD ENTER 'PARTNER REQUIRED')
Men's/Ladies Doubles		
Mixed Doubles		

Entry Fee Per Person Per Event is £3.50 (see overleaf for provision of shuttles)

TOTAL ENTRY FEE ENCLOSED £.....

PLEASE REFER TO CONDITIONS OF ENTRY OVERLEAF

THE GARRYOWEN LTD

'A', 'B', 'C' AND 'V'

TOURNAMENTS

CONDITIONS OF ENTRY:

1. An entry form is required for each competitor.
2. Entry fee per person per event is £3.50. Cheques payable to Southport Badminton League.
3. Closing dates for entries are 'A', 'V1' and 'V2' 12-10-02, 'C' 11-1-03, 'B' 8-2-03.
4. All Tournaments will be played on a straight "Knockout" basis. The first shuttle used in each round will be provided.
5. A "Plate" Competition will be played in the B & C Tournaments Mixed Doubles Events.
6. The date and time of your first event will be sent to your club secretary and published in the Southport Visiter. No other notification will be given.
7. **Competitors must report to the desk immediately upon arrival and ensure that any additional shuttle costs have been settled prior to their departure.**
8. Tournament regulations on pages 50/51 should be noted carefully, in particular regulation 3(e) regarding 'V1' and 'V2' tournaments criteria.

Competitors may note below any further information relevant to their entry.

ORMSKIRK7.00 p.m. Wednesday
 Location of Hall : Ormskirk Grammar School, Mill Lane, Ormskirk.
 General Secretary : Mr. A. D. Cunningham, 63 St. Helens Road, Ormskirk.
 Tel. 01695 574991
 Match Secretary : Mrs. A. Alcock, Slack House Farm, St. Helens Road, Ormskirk.
 Tel. 01695 573146

PHOENIX7.00 p.m. Monday
 Location of Hall : North Meols Community Leisure Centre (Greaves Hall), Banks.
 General Secretary : Mr. K. Courtley, 50 Mallee Crescent, Southport. Tel. 231606
 Match Secretary : Ms. N. Clarke, 1 Conyers Avenue, Southport. Tel. 551898

PIONEERS7.30 p.m. Monday and Friday
 Location of Hall : Burscough S. C., Mart Lane, Burscough.
 General Secretary : Mr. A. Dykes, 64 Brownmoor Lane, Crosby, Liverpool.
 Tel. 0151 286 0980
 Match Secretary : Mr. N. Haywood, 37 Highfield Road, Southport. Tel. 232910

ST. CUTHBERT'S7.00 p.m. Monday (PH) and 7.30 p.m. Friday (Hospital)
 Location of Halls : St. Cuthbert's Parochial Hall, Botanic Road, Southport.
 Southport Hospital, Town Lane, Southport (Spinal Unit Gym).
 General Secretary : Mr. S. Hodge, 22 Larkfield Lane, Southport. Tel. 07802 905916
 Match Secretary : Mrs. J. Bridge, 1a St. John's Road, Southport. Tel. 565596

SOUTHPORT7.00 p.m. Tuesday, Wednesday and 7.30 p.m. Thursday
 Location of Hall : The Drill Hall, Manchester Road, Southport.
 General Secretary : Ms. S. Core, 63 Carisbrooke Drive, Southport. Tel. 509471
 Match Secretary : Mr. A. Ascott, 1 The Willows, Bakers Lane, Southport. Tel. 233466

SOUTHSANDS7.00 p.m. Tuesday (Stanley H.S.)
 8.00 p.m. Wednesday and 7.00 p.m. Thursday (NMCLC)
 Location of Halls : Stanley High School, Fleetwood Road, Southport.
 North Meols Community Leisure Centre (Greaves Hall), Banks.
 General Secretary : Mr. D. Hooley, 55 Lethbridge Road, Southport. Tel. 545956
 Match Secretary : Mr. P. Marshall, 28 Ryder Crescent, Southport. Tel. 577378

TARLETON7.00 p.m. Tuesday
 Location of Halls : Burscough S. C., Mart Lane, Burscough.
 Methodist Hall, Church Road, Tarleton.
 General Secretary : Mrs. E. Hawksby, 69 Redcat Lane, Burscough. Tel. 893264
 Match Secretary : Mrs. D. Harrison, 58 Redcat Lane, Burscough. Tel. 892500

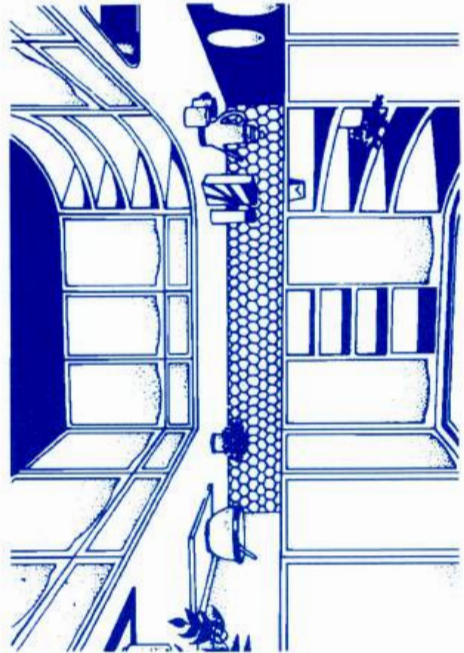

Malcolm Banham

- SHOPFITTERS •
 - KITCHEN SPECIALISTS •
 - CONSERVATORIES •
 - PLUMBING • JOINERY •
 - ELECTRICAL •
- FOR FREE ESTIMATES
PHONE (01704) 547917

THE GARRYOWEN LTD 'V' TOURNAMENT

ENTRY FORM

To: M. Billington, Esq.

17 Barford Close, Southport, PR8 2RS.
Tel: 576599

Date Signature

Full Name (Mr./Mrs./Miss).....(Capitals)

Address Tel. No.

Club and Team in Southport League Division.....

Club and Team in other Leagues Division.....

EVENT:	V1	V2	PARTNER'S FULL NAME: (COMPETITORS REQUIRING A PARTNER SHOULD ENTER 'PARTNER REQUIRED')
	(All Divisions)	(Divns. 4-9)	
Men's/Ladies Singles			
Men's/Ladies Doubles			V1
			V2
Mixed Doubles			V1
			V2

Entry Fee Per Person Per Event is £3.50 (see overleaf for provision of shuttles)

TOTAL ENTRY FEE ENCLOSED £.....

PLEASE REFER TO CONDITIONS OF ENTRY OVERLEAF



VETERANS TOURNAMENT

The 'V' tournament has been revised and this season will be run as follows:

- 1) Competitors must be aged 40 years or over at the closing date for entries. This applies to **both** the 'V1' and 'V2' sections of the tournament.
- 2) Tournament 'V1' is open to players in all divisions, but is intended primarily for those in divisions 1-3 and handicaps will be set accordingly.
- 3) Tournament 'V2' is open to players in divisions 4-9 only.
- 4) Competitors eligible to enter tournament 'V2' may also enter tournament 'V1'.

If there are any queries regarding the above, please give me a call.

Mike Billington, Tournaments Officer

VICTORIA HALL	7.00 p.m. Monday, Tuesday & Thursday
Location of Hall	: Victoria Hall, Timms Lane, Formby.
General Secretary	: Mr. E. Short, 18 Mariners Road, Blundellsands, Liverpool. Tel. 0151 474 6355
Match Secretary	: Mrs. C. Chua-Short, 18 Mariners Road, Blundellsands, Liverpool. Tel. 0151 474 6355
WEST END PARK	7.00 p.m. Monday and Wednesday (St. Johns PH) 7.15 p.m. Monday & Wednesday (KGV)
Location of Halls	: St. John's Parish Hall, St. John's Road, Southport. King George V College, Scarisbrick New Road, Southport.
General Secretary	: Miss C. Potter, 10 The Crescent, Southport. Tel. 229110
Match Secretary	: Mrs. S. Clark, 1 Charles Avenue, Southport. Tel. 579887
WOODVALE	7.30 p.m. Monday & 7.00 p.m. Thursday (URC Hall) 7.30 p.m. Monday & Wednesday (Hospital)
Location of Halls	: United Reformed Church Hall, Grosvenor Road, Southport. Southport Hospital, Town Lane, Southport (Spinal Unit Gym).
General Secretary	: Mrs. C. Grice, 20 Dunbar Crescent, Southport. Tel. 564696
Match Secretary	: Mrs. B. Miller, 9 Kirklees Road, Southport. Tel. 550129

JUNIOR CLUBS AND CONTACT NUMBERS

West End Park

Mr. & Mrs. D. Clark
1 Charles Avenue
Southport
PR8 3ET
Phone: 01704 579887

Crosby

Mr. J. Howell
3a Eshe Road North
Blundellsands
L23 3AR
Phone: 0151 924 2485

Southport

Miss J. Bridge
10 Woodview
Shevington
Wigan
Phone: 01257 251650

Southsands

Mrs. A. Pretty
12 Station Road
Banks
Southport
Phone: 01704 232758

Churchtown

Mrs. D. Rigby
49 Denmark Road
Southport
Phone: 01704 214756

Woodvale

Mr. D. Miller
9 Kirklees Road
Southport
PR8 4RB
Phone: 01704 550129

THE "INFLIGHT" JUNIOR LEAGUE – REGULATIONS

1. The Junior League shall be played in three age groups as follows:-
 - (a) - under 16 years at midnight December 31st.
 - (b) - under 13 years at midnight December 31st.
 - (c) - under 11 years at midnight December 31st.
2. A Club will be allowed a maximum of 3 teams per age group in Junior League events.
3. (a) Each team shall consist of at least two boys and two girls whose ages comply with 1 above.
(b) **A senior member of each Club or Organisation entering a team or teams in the Junior League shall be the non-playing captain of each team (1 adult to each team).**
(c) No player shall be eligible to play in the Junior League, who is not a bona fide member of the Club for which he/she plays.
4. The Executive Committee shall appoint one of its members to be in charge of all matches played on each particular occasion.
5. (a) Each match will consist of a boys doubles, a girls doubles and two mixed doubles or as decided by the Executive Committee.
(b) No player may play in more than one like event.
(c) No player may play for two or more teams on the same day in each age group. This may be waived at the discretion of the Executive Committee.
(d) Points for matches won and drawn shall be awarded as in the Senior League.
(e) Any Club playing an ineligible player shall, at the discretion of the Executive Committee, forfeit all games and points won by that player while he/she was ineligible.
(f) **Tracksuits may be used during warm-ups, but no tracksuits must be worn during any match.**
6. All matches to be played at a central venue to be determined by the Executive Committee on a date and at a time stated by that Committee. Any variation will be at the Executive Committee's discretion. **Teams must report ten minutes before start time.**
7. The annual subscription to the Junior League shall be determined by the Executive Committee. This shall be payable before 1st December in the season.
8. Transfers may only be allowed between Clubs with the written agreement of both Clubs. No Club shall have the right to object to the transfer except where the player is not clear on the books of the objecting Club in respect of monies outstanding.
9. No match may be postponed without 24 hrs notice being given to opposing team representative and the officer in charge on the evening concerned.
10. **Eligibility**
All Clubs applying to join the Junior League shall be junior sections of Senior League Clubs or have a base within 15 miles of Southport town centre

6. The Executive:-
 - (a) shall determine the entry fees per player per event;
 - (b) shall determine the date by which entries, accompanied by entry fees, shall be in the hands of the Tournaments & Competitions Officer;
 - (c) shall arrange the seeding, handicapping and draw;
 - (d) shall direct when and where matches shall be played and the disposal of results;
 - (e) shall arrange the finals;
 - (f) shall determine the prizes awarded;
 - (g) may delegate its authority to such Committee as it sees fit;
 - (h) shall have the power to refuse the entry of anyone who, in its opinion, is too good a player for the 'B', 'C' or 'V' Tournaments;
 - (i) shall have the power to cancel any event in the "B", "C" or "V" Tournaments if, in its opinion, the entry is not sufficient to warrant the event. Five events shall be played in the "A" Tournament;
 - (j) shall deal with any matter not provided for by these regulations and shall be the sole authority for the interpretation thereof.

Annual Presentation Dance

April 25th 2003

Clubs please do not forget
Prizes for the Tombola.

LEAGUE A.G.M.

APRIL 23rd 2003

**A.G.M. AGENDAS AVAILABLE FROM CLUB
SECRETARIES IN MID-MARCH**

**SOUTHPORT & DISTRICT BADMINTON LEAGUE
WEBSITE AT: <http://www.badminton.f2s.com>**

INDIVIDUAL TOURNAMENTS REGULATIONS

1. (a) At its first meeting each season, the Executive shall consider organising the following tournaments restricted to League members and veteran players who reside locally:-
 - Tournament A - Open.
 - Tournament B - Moderate Players Tournament. (Minimum standard).
 - Tournament C - Restricted Moderate Players Tournament.
(restricted to moderate players in the fourth and lower divisions).
 - Tournament V - Veterans Tournament.
 - Tournament JB - The Jack Blockley 'Under 21' Tournament.
- (b) Each tournament, unless decided otherwise by the Executive, shall consist of:-
Men's Singles, Ladies Singles.
Men's Doubles, Ladies Doubles, Mixed Doubles
2. All tournaments shall be run, as far as is practical, in accordance with the B.A. of E's regulations for tournaments and recommendations to tournament committees.
3. (a) All bona-fide players registered with League Clubs shall be eligible to enter the tournament.
- (b) Players shall be seeded in the Open Tournament.
- (c) Tournament B - Moderate Players Tournament
On the closing date for entries, a player who has been awarded Lancashire county colours or who, during the current season or past season, has played more than once for the Lancashire county first team, shall be debarred from competing in this tournament, except that a player who has been awarded Lancashire county colours may be eligible to compete at the discretion of the Executive provided that four clear seasons have elapsed since his or her last appearance for Lancashire county first team in the Inter County Championship. Players who have been awarded any other county's colours, or who have played for any other county first team, may be eligible to compete at the discretion of the Executive.
- (d) If a player, excluding a recognised floater, has played during the current season 4 or more times in a 3rd division or higher division team in League, Cup or Shield matches at the closing date for entries, he/she will not be eligible for the 'C' Tournament.
- (e) Veteran competitors must be aged 40 years or over at the closing date for entries.
Tournament VI: Open to players in all divisions.
Tournament V2: Restricted to players in the fourth and lower divisions.
Those eligible for Tournament 'V2' may also enter Tournament 'VI'.
- (f) The League Executive may refuse the entry for a player to any tournament if, in its opinion, that player has not competed in the Southport & District Badminton League on a sufficient number of occasions within the current or previous season.
4. Entry shall be on forms obtainable from the Tournaments Officer.
5. Unless decided otherwise by the Executive, matches shall consist of games of 15 aces (ladies singles-11 aces), the side first winning two games being the winner.

11. (a) All junior club members wishing to play in the Junior League and Individual Tournaments must be registered with the B.A. of E. Registration forms will be distributed by the Junior League Committee.
- (b) Any variation will be at the Junior League Committee's discretion.

12. Cup Competitions

- (a) Each match shall consist of one of each of the following, boys singles, girls singles, boys doubles, girls doubles and mixed doubles.
- (b) The boy and the girl who play singles events shall not be eligible to play the mixed doubles.

13. Complaints

- (a) The Junior League Committee shall deal with any written complaint arising out of League matches and deal with any matters not provided for in these regulations.
- (b) Any Club shall have the right to appeal to the League Executive Committee on any matter and any such appeal or application hereunder shall be dealt with in such a manner as the Executive Committee may determine, and its decision shall be final.

JUNIOR SECTION

As the section has grown and eligible age groups have varied, the leagues and trophies have similarly varied in who may compete.

The League

Under 11

1993-95 Victoria
1995-96 Sacred Heart
1996-97 Southport
1997-98 Churchtown
1998-99 Southport
1999-00 Churchtown
2000-01 Southport
2001-02 Woodvale

Under 13 Div I

1986-87 Southport
1987-88 Victoria II
1988-90 Southbank Road
1990-99 Churchtown
1999-00 Southport
2000-01 Woodvale
2001-02 Churchtown

Under 13 Div II

2001-02 Churchtown II

Under 16 Div I

1986-87 Red Rum II
1987-88 Penwortham
1988-90 Churchtown
1990-91 Victoria
1991-92 Hesketh Bank
1992-02 Churchtown

Under 16 Div II

2000-01 Woodvale II
2001-02 Southport II

Under 16 Div III

2001-02 Southport III

Competitions

West End Cup

1990-91 Victoria
1991-92 Churchtown
1992-95 Victoria I
1995-96 Sacred Heart
1996-97 Southport
1997-99 Churchtown
1999-00 Southport
2000-02 Woodvale I

Wesley Cup

1987-88 Victoria
1988-89 Southbank Road
1989-90 Victoria
1990-91 Churchtown
1991-92 Southport I
1992-99 Churchtown
1999-00 Crosby
2000-01 Woodvale I
2001-02 Southport

T. R. Highton Cup

1983-88 Southport
1988-90 Victoria
1990-92 Hesketh Bank
1992-93 Southbank Road
1993-98 Churchtown
1998-00 Southport
2000-01 Churchtown
2001-02 Crosby

Arcade Sports

For Sports & Games

Roller Blades, Classic Games, Crown Green Bowls

Large range of Badminton rackets and clothing
by leading manufacturers including:

**CARLTON, SLAZENGER, DONNAY,
BROWNING, TALBOT, WILSON,
PRO-KENNEX & YONEX (Specialist)**

Stringing Service

Extensive range of Badminton Shoes

Feathered shuttlecocks at discounted prices

*The sports shop that's run for Badminton players
by Badminton players!*

Cambridge Arcade, Lord Street, Southport
Telephone 01704 532522

REGULATIONS FOR THE WATKINSON TROPHY COMPETITION

1. The competition shall be played annually between all teams in the League on a knockout basis and the Executive shall be responsible for the organisation, including the handicapping and the draw for each round. Entry shall be free and optional.
2. (a) Matches shall be played by teams of four men and four ladies in a similar manner to League matches and within the rules applicable to League matches.
 - (b) Teams will be handicapped on the standard of their current league team. If a player of a higher standard is included after the handicap has been set, then that team shall forfeit the match.
 - (c) All teams shall receive a points handicap and scored points plus handicap points shall decide the winner. There shall be no setting.
 - (d) Team captains shall complete their teams on both copies of the score sheet prior to the start of the match and BOTH SHEETS, duly completed, **must** be returned **by the winners** to the Cups & Shields Officer, within 48 hours of the completion of the match, or the winners may be disqualified.
 - (e) In the event of a tie on points, games won shall not count and the match shall be replayed on the court of the team playing away in the original match. In the event of a further tie, the captains shall spin a coin to decide the choice of court for the next replay.
3. No player shall play for more than one team in the competition unless an authorised floater approved by the Executive.
4. (a) An eligible substitute, if present at the match at the time of an injury may be used. Such substitution shall be direct, the substitute being assumed to be of an equivalent standard to the injured player. The substitute shall play in all relevant events after and including the event in which the injury occurred. Alternatively an eligible substitute may be summoned to the match without undue delay but may only take part in the injured players subsequent events and all points scored by a substitute shall count to the teams advantage.
 - (b) Substitution as described in Rule 4(a) shall only be permitted provided the injury was caused entirely after play in the match had begun and was not due to tiredness or the worsening of an existing ailment.
 - (c) Once replaced by a substitute, an injured player shall not take part again in the match.
 - (d) A team may replace an injured player with an ineligible player subject to the approval of the opposing captain. Such substitution shall be direct as in regulation 4(a) above but all games involving the ineligible player shall be deemed to be lost with the ineligible player failing to score.
5. (a) Exceptionally an ineligible player may be played at 4th mixed doubles and 2nd men's/ladies doubles but the opposing team captain must be told prior to the start of the match.
 - (b) The scores in each game shall count as 15-0 to the opposing team.
 - (c) If an ineligible player is played other than as stated in 4 or 5(a) then the match shall be forfeited to the opposing team.
6. The Executive shall:-
 - (a) arrange the venue for the final.
 - (b) appoint a referee for the final who shall have full charge of the match, including the order of play.
 - (c) deal with any matter not provided for in these regulations.
 - (d) be the sole authority for the interpretation of these regulations.



Bispham Road Pharmacy

84 BISPHAM ROAD
SOUTHPORT
MERSEYSIDE • PR9 7DF

TELEPHONE: (01704) 506006 FAX: (01704) 507151

V.A.T. No. 636 4211 56

OUT OF WORK HOURS
TEL: (01704) 573938

Pharmacy Proprietor:
Mr. TONY WOOLLEY, BSc. (HONS.), M.R.PHARM.S.

DIVISIONAL CHAMPIONS

As the League is changing and its structure revised, the divisional shields have also been adapted accordingly.

CHAMPIONSHIP SHIELD (Division 1)

1970-76 Southport Hawks
1976-77 Wainwright
1977-78 The Park
1978-99 Southport
1999-01 Victoria Hall

BLAKEMAN TROPHY (Division 2)

1995-96 Woodvale
1996-97 Pioneers
1997-98 St. Peters
1998-00 Southport III
2000-01 Pioneers

WILF KIME SHIELD (Division 3A)

1996-97 Tarleton
1997-98 Formby
1998-99 Woodvale III
1999-00 Phoenix
2000-01 Formby

RIGBY SHIELD (Division 3B)

1996-97 Feathers
1997-98 Southport IV
1998-99 Ainsdale
1999-00 St. Cuthbert's
2000-01 West End Park II

BLOWICK SHIELD (Division 4A)

1996-97 Pioneers III
1997-98 Southport V
1998-99 Formby II
1999-00 Ainsdale II
2000-01 Phoenix II

ST. CUTHBERT'S SHIELD (Division 4B)

1996-97 Burscough IV
1997-98 Sandgrounders II
1998-99 Formby III
1999-00 Burscough II
2000-01 Churchtown III

PANTHERS SHIELD (Division 5A)

1996-97 St. Cuthbert's II
1997-98 Southport VI
1998-99 Formby Methodist
1999-00 Burscough III
2000-01 St. Cuthbert's III

RONNIE SIMM SHIELD (Division 5B)

1996-97 Formby Ravens
1997-98 Pioneers IV
1998-99 Ainsdale III
1999-00 Formby VI
2000-01 Hesketh Bank II

CHURCHTOWN B.C. SHIELD (Division 6)

1996-97 St. Cuthbert's III
1997-98 Churchtown IV
1998-99 Formby VI
1999-00 Ainsdale V
2000-01 St. Cuthbert's IV

KEW SHIELD (Division 7)

1993-94 Sacred Heart
1994-95 Woodvale VI
1995-96 -
1996-97 Formby VII
1997-98 Formby Methodist II

NEW STRUCTURE

CHAMPIONSHIP SHIELD (1st Division)

2001-02 Victoria Hall

BLAKEMAN TROPHY (2nd Division)

2001-02 Burscough

WILF KIME SHIELD (Division 3)

2001-02 Victoria III

BLOWICK SHIELD (Division 4)

2001-02 Southport IV

RIGBY SHIELD (Division 5)

2001-02 Southport V

ST. CUTHBERT'S SHIELD (Division 6)

2001-02 Tarleton II

CHURCHTOWN B.C. SHIELD (Division 7)

2001-02 West End Park IV

ST. SIMON'S & ST. JUDE'S/ WEST END PARK SHIELD (Division 8)

2001-02 West End Park V

PANTHERS SHIELD (Division 9)

2001-02 Woodvale VIII

Churchtown Decopators

CRAFTSMANSHIP IN PRIVATE & COMMERCIAL DECOR

WE WOULD BE PLEASED TO SUBMIT OUR FREE TENDER FOR ANY DECORATIONS YOU WISH TO BE CARRIED OUT



CONTACT:
D. WRIGHT



79a LINAKER STREET, SOUTHPORT, MERSEYSIDE.
Telephone: (01704) 537019

MENTHA & HALSALL LTD

D.I.Y. DEPARTMENT

FREE PARKING

FOR ALL YOUR D.I.Y. NEEDS COME TO OUR WORKS WHERE WE HAVE EVERYTHING YOU REQUIRE.

ALL SOFTWOODS, HARDWOODS, PLYWOODS ETC.
1,000's Sq. Ft. LAMINATE, ALUMINIUM,
POST-FORMED WORKTOPS.

CUT TO SIZE



CONTACT:
D. LITTLEWOOD



79 LINAKER STREET, SOUTHPORT, MERSEYSIDE
Telephone: (01704) 530800

6. (a) If a player is injured during a match and unable to continue, the score in the game in which the injury occurred shall:

(i) if the game were completed, stand.

(ii) if the games were not completed, be recorded as a win for the opposing team with the injured player's team being credited with the score at the time of injury, subject to regulation 6(b) below.

(b) An eligible substitute, if present at the match at the time of an injury may be used. Such substitution shall be direct, the substitute being assumed to be of an equivalent standard to the injured player. The substitute shall play in all relevant events after and including the event in which the injury occurred. Alternatively an eligible substitute may be summoned to the match without undue delay but may only take part in the injured players subsequent events and all points scored by a substitute shall count to the teams advantage.

(c) A team may replace an injured player with an ineligible player subject to the approval of the opposing captain. Such substitution shall be direct but all games involving the ineligible player shall be deemed to be lost with the ineligible player failing to score

(d) Substitution as described in Rule 6(b) shall only be permitted provided the injury was caused entirely after play in the match had begun and was not due to tiredness or the worsening of an existing ailment.

(e) Once replaced by a substitute, an injured player shall not take part again in the match.

7. Teams will be handicapped on the standard of their current League team. If a player of a higher standard is included after the handicap has been set, then that team shall forfeit the match.

8. The League Executive shall:

(a) arrange the venue for each final.

(b) appoint a referee to each final who shall have full charge of the match including the order of play.

(c) deal with any matter not provided for in these regulations.

(d) be the sole authority for the interpretation of these regulations.

LEAGUE A.G.M.

APRIL 23rd 2003

A.G.M. AGENDAS AVAILABLE FROM CLUB SECRETARIES IN MID-MARCH

**THE SHIELDS
COMPETITION REGULATIONS**

1. The competition shall be played annually between League teams on a knockout basis and the League Executive shall be responsible for the organisation including the allocation of teams to competitions, handicapping and the draw for each round.

2. (a) Matches shall be played by teams of 4 men and 4 ladies, playing three mixed doubles, three men's doubles and three ladies doubles, each event to consist of one game of 21 aces. There shall be no setting.

(b) Team captains shall complete their teams on both copies of the score sheet prior to the start of the match and BOTH SHEETS, duly completed, **must** be returned **by the winners** to the Cups & Shields Officer, within 48 hours of the completion of the match, or the winners may be disqualified.

(c) In each team three men and three ladies will form three mixed doubles pairs which shall play in order of strength. The remaining man/lady shall play in turn with the three men/ladies who played in the mixed events to play three men's/ladies doubles which also shall be played in order of strength.

(d) Where an ineligible player is played, that player shall play third mixed and third men's/ladies doubles.

(e) Games involving an ineligible player shall be deemed to have been lost and the ineligible player not to have scored. The score will appear on the score sheet to the handicap played e.g. 21:minus 5; 21:0; 21:5.

(f) If a team plays an ineligible player other than as stated in regulations 2(d) or 6(c), then that team shall forfeit the match.

3. (a) No player selected to play in a particular match shall be eligible to play in the match unless he or she is present and ready to play by 8.15 p.m. This may be extended to 8.30 p.m. by mutual agreement.

(b) All players in the competition shall be registered members of the League.

(c) No player may play in more than one team in the competition unless an authorised floater.

(d) Any player, unless an authorised floater or excepted player, having played during the current season two or more times for a team, may not play in any lower divisional competition.

(e) Excepted player. Subject to obtaining the prior approval of the competition secretary, any player promoted to a higher club team, having played in a lower competition team, may continue as a member of the lower competition team for the current season and shall be known as an Excepted Player.

4. (a) It shall be the sole responsibility of the home team to decide on which night during the appointed week the match shall be played.

(b) The home team shall give at least 7 days notice to their opponents.

(c) All matches shall start at 7.00 p.m. unless mutually agreed otherwise.

5. (a) The order of play, unless mutually agreed otherwise, shall be 1st, 2nd & 3rd Mixed Doubles. The order of play in the Men's and Ladies Doubles shall be in accordance with the requirements of the home team captain except in the final round.

(b) A player asked to play consecutive games is entitled to a 10 minute break between games.

FINAL LEAGUE TABLES 2001/2002

Division One	P	W	WD	LD	L	GF	GA	Pts
Victoria Hall I	18	17	1	0	0	253	35	53
Southport I	18	15	0	2	1	230	58	47
Churchtown I	18	12	0	1	5	159	129	37
Southport II	18	9	1	0	8	151	137	29
Woodvale I	18	9	0	0	9	139	149	27
West End Park I	18	8	0	0	10	137	151	24
Southsands I	18	6	1	1	10	128	160	21
Mawdesley I	18	6	0	0	12	115	173	18
Victoria Hall II	18	4	1	0	13	80	208	14
Pioneers I	18	0	0	0	18	48	240	0

Division Two	P	W	WD	LD	L	GF	GA	Pts
Burscough I	18	17	0	0	1	229	59	51
Formby I	18	14	1	0	3	188	100	44
Woodvale II	18	10	2	2	4	172	116	36
Southport III	18	10	1	1	6	168	120	33
Mawdesley II	18	8	2	0	8	122	166	28
Ainsdale I	18	8	0	2	8	144	144	26
Woodvale III	18	7	0	1	10	139	149	22
West End Park II	18	5	0	2	11	129	159	17
Southsands II	18	3	0	0	15	88	200	9
Tarleton I	18	1	0	0	17	61	227	3

Division Three	P	W	WD	LD	L	GF	GA	Pts
Victoria Hall III	18	15	3	0	0	202	86	51
St. Cuthbert's I	18	14	0	2	2	190	98	44
Pioneers II	18	12	0	0	6	171	117	36
Phoenix I	18	9	0	2	7	169	119	29
Churchtown II	18	7	3	2	6	145	143	29
Formby II	18	6	1	2	9	140	148	22
Victoria Hall IV	18	6	1	1	10	135	153	21
Hesketh Bank I	18	6	0	1	11	131	157	19
St. Cuthbert's II	18	5	0	0	13	103	185	15
Ainsdale II	18	1	0	0	17	54	234	3

Artemis Framing

Picture Framers and Art Gallery

51 Piercefield Road, Formby 01704 834559

Bespoke Picture Framing

Prints • Posters

Greetings Cards • Mirrors

Original Works by Local Artists

Sculptures • Caricatures

Tapestries stretched • Cross stitch framed

Photo Restoration

Commercial Themed murals • Exhibition & Stage Design

Commissions undertaken

We can frame anything:

Bring your treasured memories - Christening photographs • baby's first slippers • a favourite record • newspaper clipping • football shirt • jigsaws • sporting memorabilia • war medals • The more unusual it is, the more we enjoy it.

We can find anything:

Any print obtainable, computerised search facility

Competitive pricing with unbeatable workmanship

10% Discount for League Members

5. (a) It shall be the sole responsibility of the home team to decide on which night during the appointed week the match shall be played.
(b) The home team shall give at least 7 days notice to the visiting team and advise their opponents which will be the first two events played.
(c) All matches shall start at 7.00 p.m. as per League Rule 5c (1.3).
6. (a) Exceptionally, an ineligible player must be played at 2nd men's/ladies doubles and then either 3rd men's/ladies doubles or 2nd mixed doubles.
(b) The scores in each game shall be recorded as 15-0 to the opposing team.
(c) If an ineligible player is played other than as stated in 6 (a) then the match shall be forfeited to the opposing team.
7. The Executive shall:-
 - (a) arrange the venue for each final.
 - (b) appoint a referee in each final who shall have full charge of the match, including the order of play.
 - (c) deal with any matter not provided for in these regulations.
 - (d) be the sole authority for the interpretation of these regulations.

NOTES

.....

.....

.....

.....

.....

.....

.....

.....

.....

.....

.....

**THE CUPS,
COMPETITION REGULATIONS**

1. The competitions shall be played annually between teams in the League on a knock-out basis and the League Executive shall be responsible for the organisation, including seeding and the draw for each round.
2. (a) Teams in the First division and any club that does not have a team in the First division but wishes to enter a representative team, shall be given free entry to the Hudson Cup competition.
- (b) Teams in the second and lower divisions shall be given free entry to the appropriate cup competition for their divisions and the Executive, at their first meeting each season, shall decide which teams shall enter each competition.
3. (a) Matches shall consist of 3 men's doubles, 3 ladies doubles and 2 mixed doubles, all consisting of two games to fifteen points with **no setting**. 1st and 2nd men's doubles and ladies doubles **MUST** be played in order of strength as **MUST** both mixed doubles pairs. 3rd men's doubles has to be made up of one man from the 1st men's doubles and one man from the 2nd men's doubles. 3rd ladies doubles has to be made up from one lady from the 1st ladies doubles and one lady from the 2nd ladies doubles. The 2 men and 2 ladies NOT playing in the 3rd men's/ladies doubles make up the 2 pairs of mixed doubles. It is for each team captain to decide which of their players from the 1st and 2nd men's/ladies doubles play in the 3rd men's/ladies doubles. In all other respects matches will be played within the rules applicable to league matches.
- (b) The order of play, unless mutually agreed otherwise, shall be all of the 3 men's and 3 ladies doubles followed by the 2 mixed doubles.
- (c) Team captains **MUST complete their teams on both copies of the score sheet PRIOR to the start of the match** and BOTH SHEETS, duly completed **must** be returned **by the winners** to the Cups and Shields Officer within 48 hours of the completion of the match, or the winners may be disqualified.
- (d) Matches shall be decided on the number of the games won. In the event of a tie on games the match will then be decided on most points won. Should there be a tie on games and points the match shall be replayed on the court of the team playing away in the original match. In the event of a further tie, the captains shall spin a coin to decide the choice of court for the next replay.
4. (a) No player may play in more than one of the second or lower divisional Cups or in more than one team in each Cup Competition unless a registered floater approved by the Executive.
- (b) No player may play for more than one club in the Cup Competitions.
- (c) Any player being nominated for a club team at the beginning of the season may not play in a lower team cup competition for that club.
- (d) Any player, unless an authorised floater or excepted player, having played during the current season two or more times for a team, may not play in any lower divisional competition.
- (e) Excepted player. Subject to obtaining the prior approval of the competition secretary, any player promoted to a higher club team, having played in a lower competition team, may continue as a member of the lower competition team for the current season and shall be known as an Excepted Player.

Division Four

	P	W	WD	LD	L	GF	GA	Pts
Southport IV	18	14	1	0	3	200	88	44
Burscough II	18	14	0	2	2	183	105	44
Hoole	18	12	0	1	5	165	123	37
Ormskirk I	18	9	1	0	8	154	134	29
Phoenix II	18	6	1	4	7	136	152	24
Woodvale IV	18	6	1	2	9	130	158	22
Formby III	18	5	3	0	10	124	164	21
West End Park III	18	5	2	1	10	119	169	20
Churchtown III	18	5	1	1	11	123	165	18
Victoria Hall V	18	3	0	1	14	106	182	10

Division Five

Southport V	18	15	1	1	1	182	106	48
Southsands III	18	15	0	0	3	192	96	45
Pioneers III	18	14	1	0	3	197	91	44
Woodvale V	18	10	0	1	7	153	135	31
Formby Meths I	18	10	0	0	8	155	133	30
Burscough III	18	6	0	0	12	122	166	18
Formby IV	18	5	1	0	12	125	163	17
Southsands IV	18	5	0	1	12	121	167	16
Mawdesley III	18	4	0	0	14	98	190	12
Sacred Heart	18	3	0	0	15	95	193	9

Division Six

Tarleton II	16	15	0	0	1	194	62	45
St. Cuthbert's III	16	13	0	0	3	166	90	39
Victoria Hall VI	16	12	1	0	3	159	97	38
Ainsdale III	16	9	0	0	7	138	118	27
Formby V	16	7	0	0	9	122	134	21
Woodvale VI	16	6	0	1	9	116	140	19
Hesketh Bank II	16	3	0	1	12	93	163	10
Pioneers IV	16	2	1	1	12	94	162	9
Ainsdale IV	16	2	1	0	13	70	186	8

MARIC TROPHIES



*Quality Trophies
and Engraving*

**Trophies made to your
own specification**

- *Discount to clubs etc.*
- *Collection &
Delivery Service*

**FREE engraving
on all purchases**



**For a free brochure
call us any time on**

(01704) 531798

TEAM KNOCKOUT COMPETITIONS

HUDSON CUP

1976-77 Wainwright
1977-82 Southport
1982-83 Churchtown
1983-85 Southport
1985-86 Churchtown
1986-96 Southport
1996-97 Freshfield
1997-99 Southport
1999-01 Victoria Hall
2001-02 Southport

ST. PAUL'S CUP

1992-93 Southport V
1993-94 Formby I
1994-95 Formby II
1995-96 Churchtown III
1996-97 West End Park III
1997-98 Southport V
1998-99 Ainsdale II
1999-00 Sand/South IV
2000-01 Churchtown III
2001-02 Victoria Hall III

PIONEER CUP

2001-02 Tarleton III

INFLIGHT CUP

2001-02 West End Park V

NINTH DIVISION CUP

2001-02 Southsands VII

HACKNEY CUP

1985-87 Southbank II
1987-92 Southport II
1992-93 Mawdesley I
1993-94 Woodvale I
1994-95 Southport III
1995-96 Woodvale
1996-00 Southport III
2000-01 West End Park I
2001-02 Burscough I

NAT. GIRO CUP

1989-90 Duke Street II
1990-91 Hoole II
1991-92 Hesketh Bank I
1992-93 St. Cuthbert's II
1993-94 Hoole III
1994-95 Burscough IV
1995-96 Feathers II
1996-97 Formby Ravens
1997-98 Southport VI

FRANK SIMPSON CUP

1992-93 Southport X
1993-94 Sacred Heart II
1994-95 Tarleton V
1995-96 Pioneers V
1996-97 Formby VII
1997-98 Sandgrounders V
1998-99 Ainsdale III
1999-00 Woodvale VI
2000-01 Formby V
2001-02 Tarleton II

ST. SIMON & ST. JUDE CUP

1991-92 Southport III
1992-93 Hoole II
1993-94 Woodvale II
1994-95 Mawdesley II
1995-96 Phoenix
1996-98 Formby
1998-99 Woodvale III
1999-01 Formby
2001-02 Pioneers III

WEST END CUP

1992-93 Hoole IV
1993-94 Burscough IV
1994-95 Hesketh Bank II
1995-96 All Souis II
1996-97 St. Cuthbert's III
1997-98 Churchtown IV
1998-99 Woodvale VII
1999-00 Formby Methodists II
2000-01 Formby Methodists III
2001-02 Southport IV

OTHER AWARDS

THE RAYNOR TROPHY

1991-92 Formby Meth.
1992-93 Formby Ravens II
1993-94 Tarleton IV
1994-95 Phoenix III
1995-96 St. Peters IV
1996-97 Sacred Heart II
1997-98 Freshfield
1998-99 Victoria Hall III
1999-00 Pioneers III
2000-01 Southport
2001-02 Churchtown

OSIRIS ANTIQUES
DECORATIVE ARTS
&
FASHIONS
1880 ~ 1960

PERIOD CLOTHING
LINENS.
LACE TABLE-CLOTHS
EARLY TEXTILES
JEWELLERY.
GLASSWARE.
POTTERY
SILVER.
OLD TOYS
LIGHT FITTINGS
FURNITURE.

WE WISH TO BUY
ALL OF THE
ABOVE ITEMS.

104 SHAKESPEARE STREET
SOUTHPORT 500991
HOME 560418

Division Seven

	P	W	WD	LD	L	GF	GA	Pts
West End Park IV	16	15	0	0	1	197	59	45
Southport VI	16	13	0	0	3	174	82	39
Tarleton III	16	12	0	0	4	184	72	36
All Souls	16	11	1	0	4	155	101	35
Tarleton IV	16	4	1	0	11	103	153	14
Southport VII	16	4	0	2	10	101	155	14
Southsands V	16	4	0	1	11	91	165	13
Woodvale VII	16	3	2	0	11	74	182	13
Formby Meths II	16	2	0	1	13	73	183	7

Division Eight

West End Park V	16	15	0	1	0	194	62	46
Mawdesley IV	16	12	2	0	2	190	66	40
Southsands VI	16	9	1	0	6	138	118	29
Ormskirk II	16	8	0	2	6	136	120	26
St. Cuthbert's IV	16	8	1	0	7	131	125	26
Formby VI	16	7	0	1	8	116	140	22
Churchtown IV	16	2	2	1	11	77	179	11
Formby Meths III	16	3	0	1	12	81	175	10
Southport VIII	16	1	1	1	13	89	167	6

Division Nine

Woodvale VIII	12	10	1	0	1	136	56	32
Southsands VII	12	8	0	1	3	102	90	25
West End Park VI	12	6	1	0	5	103	89	20
Southport IX	12	3	0	1	8	84	108	10
West End Park VII	12	1	0	0	11	55	137	3

UMPIRES

The Badminton Umpires Association of England Accredited Umpires are:

M. Banham, D. Bradley, P. Clough, R. Grindlay, N. Haywood, K. Hughes, Mrs. B. Long, Mrs. S. Lynch, G. Perry, J. Sinclair.

Accredited Umpires may be used in all Cups, Shields and Trophy Finals, in the Jack Blockley A, B, C and V Tournaments, and in any other event as the League may decide.

Umpires may appear at any match or event in an advisory capacity or as the League may decide.

Clubs may request the attendance of Umpires but this will only occasionally be possible and must not be assumed.

League members interested in Umpiring should contact Malcolm Banham (Tel. 547917).

9. SERVICE

9.1 In a Correct service:

- 9.1.1 neither side shall cause undue delay to the delivery of the service once server and receiver have taken up their respective positions;
- 9.1.2 the server and receiver shall stand within diagonally opposite service courts without touching the boundary lines of these service courts;
- 9.1.3 some part of both feet of the server and receiver must remain in contact with the surface of the court in a stationary position from the start of the service (Law 9.4) until the service is delivered (Law 9.6);
- 9.1.4 the server's racket shall initially hit the base of the shuttle;
- 9.1.5 the whole shuttle shall be below the server's waist at the instant of being hit by the server's racket;
- 9.1.6 the shaft of the server's racket at the instant of hitting the shuttle shall be pointing in a downward direction to such an extent that the whole of the head of the racket is discernibly below the whole of the server's hand holding the racket as in Diagram D;
- 9.1.7 the movement of the server's racket must continue forwards after the start of the service (Law 9.4) until the service is delivered; and
- 9.1.8 the flight of the shuttle shall be upwards from the server's racket to pass over the net so that, if not intercepted, it lands in the receiver's service court (ie on or within the boundary lines).

9.2 If a service is not correct by virtue of any of Laws 9.1.1 to 9.1.8, it shall be a 'fault' (Law 13) by the offending side.

9.3 It is a 'fault' if the server, in attempting to serve, misses the shuttle.

9.4 Once the players have taken their positions, the first forward movement of the server's racket head is the start of the service.

9.5 The server shall not serve before the receiver is ready but the receiver shall be considered to have been ready if a return of service is attempted.

9.6 Once the service is started (Law 9.4), it is delivered when the shuttle is hit by the server's racket or, in attempting to serve, the server misses the shuttle.

9.7 In doubles, the partners may take up any positions which do not unsight the opposing server or receiver.

TEAM HANDICAP COMPETITIONS

THE FLEETWOOD HESKETH SHIELD

1991-92 West End
1992-94 Churchtown
1994-95 Southport IV
1995-96 Burscough
1996-97 Churchtown
1997-98 Southbank II
1998-99 Southport III
1999-00 Victoria Hall
2000-01 Woodvale I
2001-02 Southsands I

THE LEAGUE SHIELD IN MEMORY of MALCOLM IDDON

1992-93 Formby
1993-94 Our Ladys
1994-95 Burscough II
1995-96 St. Cuthbert's
1996-97 Formby II
1997-98 Woodvale III
1998-99 West End Park III
1999-00 Victoria Hall IV
2000-01 Churchtown II
2001-02 Phoenix I

FRANK SIMPSON SHIELD

1992-93 Range V
1993-94 Sandgrounders V
1994-95 Pioneers IV
1995-96 Formby Meths II
1996-97 West End Park V
1997-98 Formby Meths II
1998-99 Sacred Heart II
1999-00 Phoenix III
2000-01 Formby V
2001-02 Woodvale VII

ST. JOHN'S SHIELD

1992-93 Sandgrounders II
1993-94 Feathers
1994-95 Trafalgar
1995-96 Sandgrounders II
1996-97 Burscough III
1997-98 Woodvale V
1998-99 Tarleton IV
1999-00 Ainsdale III
2000-01 Victoria Hall VI
2001-02 Burscough II

BARCLAYS BANK SHIELD

1989-90 Formby IV
1990-91 Woodvale IV
1991-92 Mawdesley III
1992-93 Southbank V
1993-94 Woodvale V
1994-95 Formby IV
1995-96 Churchtown IV
1996-97 Formby Ravens
1997-98 Ormskirk II

SOUTHPORT B.C. SHIELD

1992-93 Range IV
1993-94 Pioneers IV
1994-95 Formby Ravens II
1995-96 Woodvale VIII
1996-97 Trafalgar II
1997-98 West End Park V
1998-99 Woodvale VIII
1999-00 Phoenix IV
2000-01 Woodvale VIII
2001-02 Mawdesley IV

THE WATKINSON TROPHY

1992-93 Burscough II
1993-94 Churchtown
1994-95 Woodvale VI
1995-96 Southport V
1996-97 Hesketh Bank
1997-98 Churchtown IV
1998-99 Pioneers III
1999-00 Ainsdale
2000-01 Southsands II
2001-02 Woodvale VII



Introducing the new Indoor shoe from *Inflight*

The New Indoor
D.A.S 8.0 shoe
from *Inflight*
incorporates
the latest
technology
to produce
the finest
badminton
footwear in the
world.



Leading international players are now moving to *Inflight* for their racquets, footwear and clothing etc. For a full brochure or your nearest stockist call 0800 043 0897.

Inflight UK, 634 Liverpool Road, Ainsdale, Southport, PR8 3BH

DIAGRAM D

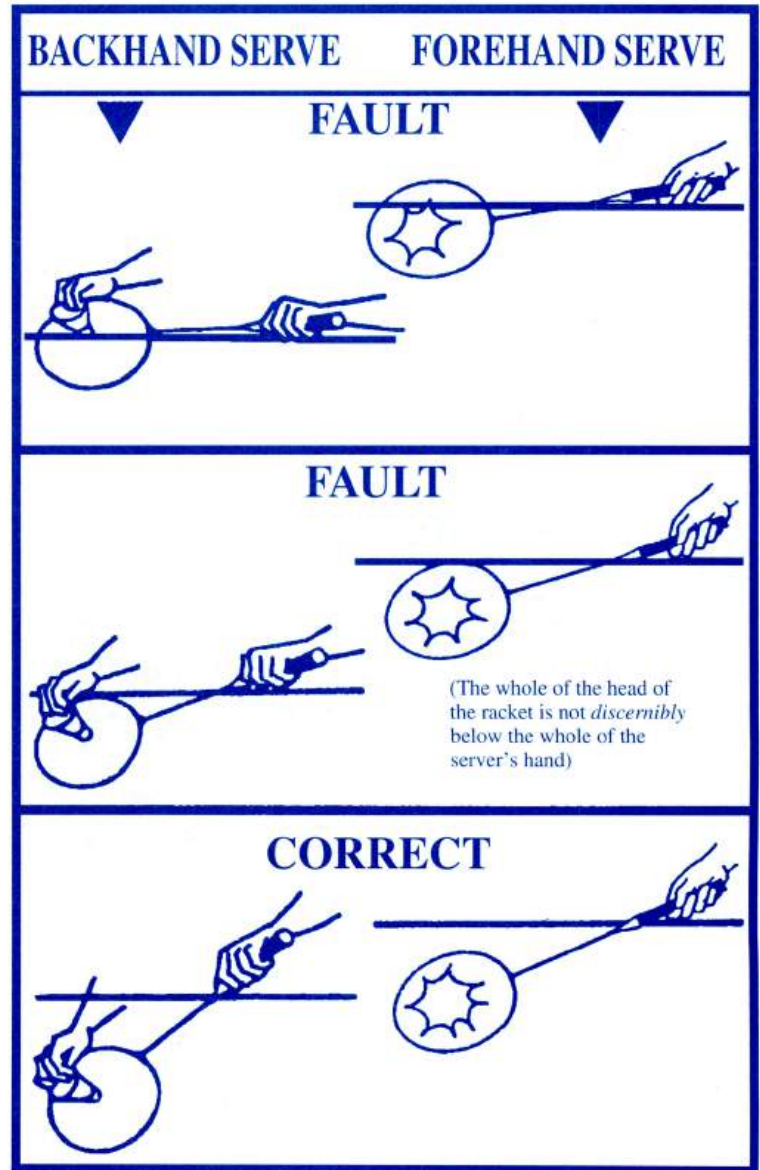

Karwowski Motors

VEHICLE
SERVICE AND
REPAIR
ENGINEERS

UNIPART



CAR CARE
CENTRE

*"For your peace
of mind"*

- Full service facilities available to EVERY MAKE OF CAR, courtesy car provided with every major service.
- 4x4 Landrover Discovery, Shogun, Toyotas, servicing a speciality.
- SAME DAY clutch/gearbox service.
- Brake overhauls.
- Lifetime guarantee batteries.
- Car alarms and radios supplied and fitted.
- Prop shafts repairs carried out ie Ford, Vauxhall, Volvo, Mercedes and BMW.
- Large selection of second hand parts available.
- MOT's with computerised reminders.

£10 OFF YOUR NEXT
FULL SERVICE

OR

£6 OFF YOUR NEXT
M.O.T.

PETROL AND DIESEL

On production of this advert

ACCIDENT DAMAGE REPAIRS CARRIED OUT WITH FULL BODY JIGGING
FACILITIES AND LOW BAKE PAINTING OVEN — INSURANCE APPROVED



Tram Shed Works, 99a Boundary Street,
Birkdale, Southport.
Telephone: 01704 543630

*After Service Hours Breakdown
Number 0860 272658*

AA

RAC

For the best
sports coverage,
53,000 adults in
the Southport
Visiter area turn
to

THE SOUTHPORT

VISITER

Your news, your views... we're No 1

The voice of Southport since 1844

Get your copy every Friday!

6. **Divisional Champions, Promotion and Relegation**
- 6.1 Promotion and relegation shall be decided by the Executive at its first meeting.
- 6.2 The team securing most points in each division shall be the champion team of that division and shall be entitled to the custody of the championship trophy of that division until the succeeding annual general meeting.
- 6.3 Points shall be awarded as follows:-
 3 points for a win on games irrespective of aces
 2 points for a tie on games and a win on aces
 1 point for a tie on games and a tie on aces
 1 point for a tie on games and a loss on aces
- 6.4 Where two teams secure the same number of points, the number of games won shall be the deciding factor. Where there is still a tie, then the difference between aces won and lost, shall be the deciding factor.
- 6.5 At least one team from the 2nd and lower divisions shall be promoted.

ANNUAL PRESENTATION DANCE

FRIDAY, 25th APRIL, 2003

8 p.m. till 1 a.m. in the

BALMORAL SUITE
THE ROYAL CLIFTON HOTEL

Tickets £4.00

from your own Secretary or Robbie Grindlay
Telephone: 874357

To avoid disappointment order your tickets now

Clubs are asked to provide a Raffle Prize which can
be given to any League Officer prior to the Dance

Bring a party and enjoy this final event of the season

SHUTTLE TESTING

One thing that most League members seem to agree on is the fact that the overall standard of feathered shuttlecocks is dropping.

Whereas there is little your League Executive can do to influence the quality and consistency of the shuttle manufacturers' product, we can at least try to ensure standardisation of speed.

It would appear that opinions of what speed a shuttle should be and more importantly how to test it vary greatly throughout all the divisions.

In order to clarify precisely what constitutes testing a shuttle we have printed below the relevant extracts from the LAWS OF BADMINTON and included a diagram of distances and tolerances to show where a tested shuttlecock should land from a full underhand stroke which makes contact with the shuttle over the back boundary line. The shuttle shall be hit at an upward angle and in a direction parallel to the sideline.

Optional Testing Marks for Doubles Court
(See Law 1.3)

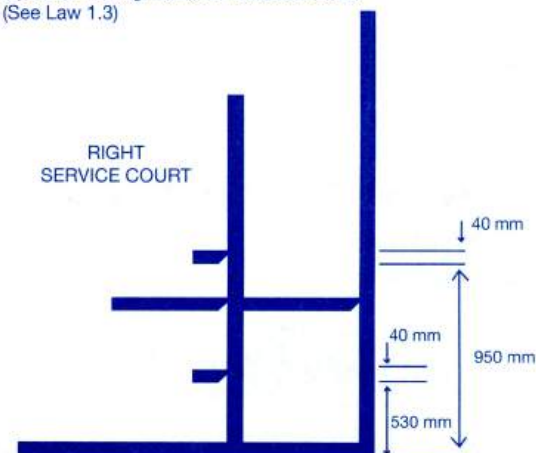

N.B. measurement of marks 40 mm by 40 mm

Leisure Services

Burscough Sports Centre

Mart Lane, Burscough, Tel. 01704 895266

Sports Halls, Fitness Suite, All Weather Courts, Squash Courts, Licensed Bar

Nye Bevan Pool

The Concourse, Skelmersdale, Tel. 01695 727111

Swimming Pools, Fitness Suite, Health Suite

North Meols Community Leisure Centre

Greaves Hall Avenue, Banks, Tel. 01704 212970

Sports Halls, Fitness Suite, All Weather Courts, Meetings Rooms, Licensed Bar

Park Pool

Park Road, Ormskirk, Tel. 01695 576325

Swimming Pools, Fitness Suite, Health Suite, Squash Courts

Skelmersdale Sports Centre

Digmoor Road, Skelmersdale, Tel. 01695 723777

Sports Halls, Fitness Suite, Squash Courts, Licensed Bar

Make the most of Your leisure time!

West Lancashire District Council, Commercial Services, Stanley Way,
Skelmersdale WN8 8EE

3.2 In the event of any occurrence arising under 2.3, the Executive may require both captains to appear before the League Match Committee for the purpose of explanation and may impose on the club found to be at fault such fine or penalty as they may in their absolute discretion deem adequate.

4. Players' Eligibility

4.1 All players participating in League competitions must be registered with the League and be members with League clubs. For registration, each club secretary shall send on the form provided together with required fees, a list of club players to the B.A. of E. before the first match of the season. Additional players may be registered on individual registration forms, together with required fees which must be sent to the B.A. of E. before participating in any match or tournament of any kind. No player may be registered after 31 January in the current season except by permission of the Executive. Each year information about new fees will be sent to each club.

4.2 Each club must provide the League Match Chairman with a list of their registered players, arranged in team order, before the first match of the season.

4.3 No player may participate in League competitions until the player's B.A. of E. and LCBA fees have been remitted to the B.A. of E.

4.4 Any player having been registered for one club and wishing to play in league matches for another club during the same season may apply to the Executive for a transfer to the last mentioned club. A form of application to transfer must be obtained from the League Match Chairman and must be duly completed and deposited with the League Match Chairman not less than 7 days before the first match in which the player intends to play for his/her new club. The player shall not play for the new club until he/she receives notification from the League Match Chairman that the transfer has been completed.

4.5 No club shall have the right to object to the registration of any player with another club except where the player is not clear on the books of the objecting club in respect of monies outstanding. Any club wishing to object under this rule must lodge such objection with the League Secretary, in writing, without undue delay, giving full particulars. The suspension by the Executive of any registration under this rule shall be operative only until the defaulting player shall have discharged his/her obligations to the objecting club.

5. Higher Team Play Eligibility and Floaters

5.1 Where a club has more than one team, whether in the same or different divisions, a player, having played in a club team on more than one occasion, or in two higher teams on one occasion each, is thereby debarred from playing in any lower ranked team.

5.2 However, the Executive may transfer down such a player from one team to another on application being made for that purpose but only one transfer shall be allowed in a season in respect of such a player. Such transfer shall be free. After such transfer has been made, a player may play for a higher ranked team on one further occasion. Upon playing on a second occasion rule 5.1 becomes operative.

5.3 A club shall have the right to nominate to the Executive not later than three weeks after the first Monday of the season the names of one lady and one gentleman from their lower team or from each of their lower teams, and upon being approved by the Executive, these players shall not during that season be subject to the provision of rule 5.1. Such players shall be known as "floaters" and may only float up.

5.4 No club shall be permitted to use floaters on a permanent basis except between their bottom two teams.

5.5 The decision of the Executive regarding any application under rule 5.2 or nomination under rule 5.3 above shall be final.

LANCASHIRE COUNTY BADMINTON ASSOCIATION COACHING

2. **Match**
- 2.1 Each match shall consist of four mixed doubles, two men's doubles and two ladies doubles; each event shall consist of two games of 15 aces. No payer, including floaters (see 5), may play more than one like event nor in more than one match in any one night.
- 2.2 Captains must complete their teams on the match score sheet before the start of the match. Pairs must be played in order of strength otherwise, at the discretion of the Executive, events or the match may be forfeited.
- 2.3 The actual time of starting the match must be marked accurately on the score sheet. In the event of any delay arising in the commencement of any match, or any occurrence resulting in the match not being completed the reasons therefore shall be entered on the back of the score sheet and signed by both captains.
- 2.4 Feather shuttles, of a standard to be determined by the Executive, shall be used in League matches and competitions.
- 2.5 In all events organised by the League, coloured clothing may be worn. In order to ensure attractive presentation of badminton, all clothing should be acceptable badminton sports clothing and, wherever possible, doubles partners are asked to try and wear the same colours. Track suits shall not be worn during match play except by agreement of both captains.
- 2.6 The order of play in all events shall be in accordance with the requirements of the home captain.
- 2.7 To be eligible to play in a particular match a player must be present and ready to play by 8.15pm. This may be extended to 8.30pm by mutual agreement on or before the date the match is played. Prior to 8.15pm (extended to 8.30pm by mutual agreement) a team can substitute a player already entered on the match score sheet and who has not yet played in that match provided the substitute is of equal or lesser standard than the player originally named.
- 2.8 Where a player is not present by 8.15pm (extended to 8.30pm by mutual agreement) and a substitute has not been used, as per rule 2.7, then the opposing team captain shall regard all the games in which the absent player would have played as being forfeited. The captain must inform the opposing captain immediately that he/she regards the games of the absent player as forfeited, and the games involved must be entered on the Match Score Sheet as 15.0 and identified by W/o (Walkover).
- 2.9 Where a team plays an ineligible player, that player must play at 4th mixed and 2nd Men's/Ladies Doubles and the opposing captain notified. If a team plays an ineligible player other than as stated, then that team shall forfeit the match.
- 2.10 In the event of any player being incapacitated after play in a match has begun so that he or she cannot continue playing, a captain shall be entitled to include a substitute of an equal or lesser standard in any subsequent event in which the incapacitated player should have taken part provided that the injury or other incapacity was caused entirely after play in the match had begun and was not solely due to tiredness or the worsening of an existing ailment.
- 2.11 Any comments/complaints entered on the reverse of the Match Score Sheet must be acknowledged by way of signature by a representative from both teams, prior to the submission of the Match Score Sheet to the League Match Officer.
- 2.12 In the event of a match not being played it shall NOT be conceded without permission being sought and obtained from the League Match Officer.
3. **Post-match**
- 3.1 The home team shall be responsible for ensuring that the completed score sheet is received by the League Match Officer within 5 days of the match being played. Failure to comply with this rule will result in a penalty not exceeding £20 being imposed by the Executive.

The Coach for Southport and District is: **Miss Jane Bridge**

The coaching scheme is available to all affiliated clubs and applications should be made to: **Miss Jane Bridge. Tel: 01257 - 251650.**

A qualified coach will come to your club to organise sessions to suit your own requirements. The number of sessions can be arranged with the coach.

Costs: The club requesting coaching is responsible for supplying the hall and shuttles and paying the coach's travelling expenses. As the coach probably lives locally these will be minimal.

Should individuals wish to become qualified coaches, please contact your League Chairman who will give you further advice on courses that can be arranged to suit your convenience.

INTERNATIONAL APPEARANCES

Name	No. of App.
Mrs. S. Sankey, G.B.	1
Mrs. S. Sankey, England	84
Miss J. Wright, England	5

SOUTHPORT LEAGUE PLAYERS

(representing Lancashire County 1st Team)

Name	No. of App.	Name	No. of App.	Name	No. of App.
Mrs. S. Sankey	80	P. B. Kime	36	R. Marshall	5
K. Houldcroft	57	Miss K. Pearson	33	M. Kellett	4
Mrs. J. Pearson	53	M. H. Hill	30	N. Green	2
E. J. Usher	51	Mrs. D. Vines	27	R. C. Jones	2
Miss J. Wright	48	Miss S. Littlewood	15	Miss C. Clucas	2
D. Allen	46	Mrs. A. Abdous	11	Miss C. Walker	2
Mrs. B. Kime	45	Miss H. Reed	7	Mrs. V. L. Maxwell	1
Mrs. S. Lindsay	40	J. Harford	6	Miss C. Kelly	1

APPEARANCES BY PLAYERS AWARDED SOUTHPORT LEAGUE TOWN TEAM COLOURS

(7 or more appearances for Southport Town 1st Team in LCBA Inter-League League)

Name	No. of App.	Name	No. of App.	Name	No. of App.
Mrs. D. Rigby	114	Mrs. S. Hurst	51	Mrs. S. Wilkie	27
R. Marshall	112	Mrs. S. Sankey	39	A. Pickles	21
S. Hurst	99	K. Balmforth	39	Mrs. D. Balmforth	20
Mrs. D. Vines	93	N. Tolman	36	Miss K. Pearson	18
J. Abdous	84	J. Machin	32	Miss J. Wright	12
Mrs. A. Abdous	70	Miss J. Bridge	28	A. Davidson	10
S. Almond	64	J. Harford	27		

Anyone having information which could make this a more complete record should forward it to the League General Secretary.

MERSEY OIL COMPANY LIMITED

"The Environmentally Friendly Oil Company"

CROWLAND STREET INDUSTRIAL ESTATE,
SOUTHPORT, MERSEYSIDE, PR9 7RJ.
TEL: (01704) 538787 FAX: (01704) 536783

Your Local Fuel Oil Distributor

Please ring for:

COMPETITIVE PRICES
FOR ALL GRADES OF PETROL,
HEATING OIL, ULTRA LOW SULPHUR DIESEL,
PARAFFIN, KEROSENE, TRACTOR FUELS,
LOW SULPHUR KEROSENE, LUBRICANTS

BULK SUPPLIES of L.P.G.,
PROPANE & BUTANE



PART OF THE SAMUEL COOKE GROUP

- F. The League accounts shall be audited within two months of the end of the financial year and shall be available for inspection upon request by any registered League member.
- G. A copy of the final accounts for the financial year just ended shall be produced at the Annual General Meeting and shall be suitably claused if not audited.

8.-APPEALS

Any club or player shall have the right to appeal to the Executive on any matter and any such appeal or other application hereunder shall be dealt with in such manner as the Executive may determine and their decision shall be final.

9.-RULES

Any matter not provided for by these rules shall be dealt with by the Executive who shall also be the sole authority for the interpretation thereof, provided that any decision given by a General Meeting shall be binding. Any addition to, or interpretation of, these rules made by the Executive shall only be operative until the next Annual General Meeting of the League when they shall be reported to such meeting for confirmation or otherwise. No amendment or alteration to these rules shall be made except at a General Meeting.

APPENDIX RULE 5c - COMPETITION

- 1. **Pre-match**
 - 1.1 All matches shall be played under the Laws of Badminton with each court having a minimum playing standard as decided by the Executive. Unless prior permission to re-arrange a match has been obtained from the League Match Officer, see 1.4, matches shall be played in the particular week appointed by the Executive.
 - 1.2 The home club shall have sole responsibility for deciding which night during the appointed week the match shall be played, what time play shall commence and which two events shall be played first, giving at least 14 days notice to the visiting club. It will be the duty of both clubs to ensure that its players are available for those events at the agreed time.
 - 1.3 All matches shall commence not later than 7pm. In the event of a hall not being available for play at 7pm, prior approval for the use of the hall for matches must be obtained from the Executive.
 - 1.4 Permission to re-arrange a match, which must be obtained by the Match Secretary from the League Match Officer, will only apply in the following circumstances:
 - (a) The Home Club's hall is not available in the week the League fixture is due to be played
 - (b) A Cup, Shield or Trophy match has to be played in the same week as the League Fixture by the home or away team and both matches cannot be played.
 - or
 - (c) A Club's lowest team is unable to field 8 players.For re-arranged fixtures under (a), (b) or (c), permission must be sought **as soon as possible**. No postponement will be permitted on the day of the match where (c) applies.
 - Failure to comply with this Rule will result in the Executive imposing a penalty not to exceed £20 and/or 3 points being deducted from either or both teams.
 - For all re-arranged fixtures due to (c), where the away team seeks such a postponement, a payment of £20 to defray expenses will be made by the away Club to the home Club.
- 1.5 Matches can only be re-arranged (see 1.4) by Match Secretaries and must be completed within 56 days of the original match date. Failure to comply with this rule will result in a penalty not exceeding £20 being imposed by the Executive on either or both teams and the League Match Officer will direct when and where the match be played.

- (b) All items to be placed on the agenda of the Annual General Meeting, including nominations for office and for the Executive, shall be sent in writing to the General Secretary so as to reach him not later than 28th February in the same year.
- (c) Not less than 14 days notice of any general meeting shall be given. Written notification to each affiliated club secretary, which shall include the agenda for the meeting shall be deemed to be sufficient notice of the Annual General Meeting.
- (d) An Extraordinary General Meeting shall be convened upon a resolution of the League Executive or at the written request to the General Secretary of not less than 20 members being representative of at least 6 member clubs. Such requests shall state the purpose for which the meeting is required and no other business shall be transacted. The meeting shall be held within one month of such requisition being received by the General Secretary and the notice and agenda shall be circulated to all member club secretaries at least 14 days in advance.
- (e) Accidental omission to give the required notice to any Club Secretary shall not invalidate the proceedings at a general meeting.
- (f) All registered players of the League shall be entitled to attend and vote at any general meeting of the League.
- (g) Voting shall be by show of hands unless any 6 persons present (who are entitled to vote) demand a ballot.
- (h) No member may vote by proxy.
- (i) No individual may have more than one vote, except the Chairman of a meeting who shall have a casting vote.
- (j) At all General Meetings 20 members entitled to vote shall form a quorum.
- (k) If there is no quorum for:-
 - (i) an Extraordinary General Meeting, the motion(s) on the agenda shall be deemed to have been defeated and the meeting concluded.
 - (ii) an Annual General Meeting, it shall be adjourned and another notification shall be circulated without a time restriction. At the adjourned meeting the members present shall form a quorum.

7.-FINANCE

- A. The Financial year of the League shall end on 31st March.
- B. Annual subscriptions shall be paid by 31st October in each League year. The Club subscriptions are:-
 - (i) League entrance fee (New Clubs only).
 - (ii) Club annual subscription.
 - (iii) Team registration fee.
 - (iv) Junior team registration fee.
 and all rates will be advised by the league treasurer, to every Club Treasurer by the 31st of July of the current season.
- C. No player may participate in any Cup, League, Tournament or Shield event until the player's B.A.E. and L.C.B.A. fees have been remitted to the B.A. of E. All rates will be advised to every Club Treasurer by the 31st July of the current season.
- D. All monies due to the League shall be deemed to be owing to the League Treasurer.
- E. Any Club whose annual subscriptions, as in 'B' above, remain unpaid after 31st October each year shall be liable to such a penalty as the Executive may decide.

THE VERA MAXWELL TROPHY

Nominations may be submitted any time but must be made by February 28th.

Personal nominations, in confidence, from any League member, to anyone on the Review Panel which is:

M. Banham (Executive Chairman), Mrs. F. Colville, J. Duncan, R. S. Grindlay (General Secretary) and G. Perry (Vice-Chairman).

In considering the award, the Review Panel prefers to recognise the services generously given by those unsung, hard working amateur enthusiasts who do not normally attract general acclaim.

The awards may be for a particular occurrence or for the culmination of many seasons' unrecognised service.

THE VERA MAXWELL TROPHY

1978 J. Blockley	1991 Mrs. S. Rimmer
1979 D. Alderson and F. Simpson	1992 D. James
1980 Mrs. K. Griffiths	1993 R. Warhurst and K. Breese
1981 R. H. Simm	1994 <i>No Award Made</i>
1982 Miss A. Howard	1995 Mrs. T. Pattison and A. Woolley
1983 <i>No Award Made</i>	1996 Mrs H. Cannon and Mr. R. Cannon
1984 G. H. Lloyd	1997 Mrs. L. Davies
1985 F. Skelly	1998 M. R. E. Hyde
1986 <i>No Award Made</i>	1999 Mrs. M. Warren and R. Shepherd
1987 J. Henderson	2000 J. Sinclair
1988 <i>No Award Made</i>	2001 Mrs. J. Lewis and Mrs. H. Blomley
1989 D. Barton	2002 Mrs. S. Clark
1990 P. Isherwood	

We serve...



...and our customers return.

From business cards to full colour brochures, our service and quality remains paramount, which is why our company is growing, along with the recognition from our continually satisfied customers.



The Print Works, Banastre Road, Southport PR8 5AL
Tel: 01704 535529 Fax: 01704 543216
Web: www.mitchell-wright.co.uk



- 4C.
- (iii) All retiring officers shall be eligible for re-election.
 - (i) The Executive shall have full power to transact the general business of the League.
 - (ii) The Executive shall have the power to:-
 - (a) fill any casual vacancy occurring, including a vacancy under Clause (iv) of this rule but anyone so appointed shall serve only until such time as the original member would have retired by rotation.
 - (b) elect at any time any number of Vice-Presidents of the League, to hold office for such period as the Executive may determine.
 - (c) take any steps which they consider necessary for the purpose of enforcing payment of any subscription or fines payable or imposed under any rules for the time being of the League.
 - (d) admit individuals to League membership.
 - (e) elect Honorary Life Members who may attend meetings of the Executive.
 - (f) appoint and delegate powers to Committees and such Committees may co-opt members to the Committee from outside the Executive provided that the number of co-opted members is always less than the number of members of the Executive on the Committee.
 - (iii) The Executive shall meet not less than three times annually. Meetings shall be called at the discretion of the Chairman or at the request in writing of at least six members of the Executive.
 - (iv) if any member of the Executive be absent from three consecutive Meetings he may, at the discretion of the Executive be treated as having thereby tendered his resignation.

5.-THE LEAGUE

5A.

General

- (i) The League year for which all officers and Executive members, whether elected, co-opted or substituted, shall hold office, and during which the membership and registration of all clubs and players shall subsist shall be from the 1st day of May in one year to the 30th of April the following year.
- (ii) Application for membership to the League for any year must be delivered in writing to the General Secretary not later than the 30th day of April preceding the year concerned. First applications must be accompanied by the prescribed entrance fee and details of the Club's insurance cover which is compulsory.
- (iii) an annual subscription shall be paid by each member club.
- (iv) where a club has entered a number of teams in the League and then requests permission to withdraw any particular team after the Division has been formed by the Executive such requests may be submitted to the General Purposes Committee for arbitration. The decision of the Executive based on all relevant facts shall be final. The team registration fee and an administration fee, as determined by the Executive, shall be paid.

5B.

Structure

- (i) The League shall consist of such one or more divisions as the Executive shall determine.
- (ii) The Executive shall form each division at its first meeting, when it may reconstitute the divisions.

5C.

Competition - (see Appendix page 35)

6.-GENERAL MEETINGS

(a)

The Annual General Meeting of the League shall be held in the month of April on a day and at a place and time appointed by the Executive for the adoption of the Executive report and final accounts, any alterations to rules, the election of officers and the Executives as required under Rule 4, the election of the Hon. Auditor, and such other business as may be transacted in general meeting.

SOUTHPORT AND DISTRICT BADMINTON LEAGUE RULES

1.-NAME

The League shall be called the Southport and District Badminton League.

2.-OBJECTS

The objects of the League shall be:-

- (a) to promote badminton generally in Southport and District.
- (b) to take any action to further the interests of badminton.
- (c) to ensure that affiliated members observe:-
 - (i) the laws of Badminton
 - (ii) the regulations of the International Badminton Federation and of the Badminton Association of England
 - (iii) the regulations of the Lancashire County Badminton Association.

3.-CONSTITUTION

The League shall be affiliated to the Lancashire County B.A. Members eligible for affiliation to the League at the discretion of the Executive Committee shall be:-

- (a) clubs of which at least one of the objects is badminton and which have their headquarters and courts in Southport and district. The Executive shall determine the effective district boundary.
- (b) Schools and Youth Associations whose member clubs have an age limit of 21 years. Such member clubs need not affiliate themselves directly, but unless so affiliated shall not be entitled to the privileges of affiliation.
- (c) Schools and Youth Clubs whose members have an age limit of 21 years.
- (d) Individuals, known as private members, who shall:-
 - (i) pay an annual subscription
 - (ii) receive copies of all league circulars
 - (iii) be eligible to attend League Meetings
 - (iv) be eligible to vote and hold office
 - (v) be eligible to enter the Veterans Tournament only, subject to the rules of that tournament.
- (e) Honorary Life Members.

Individual members of individual clubs and associations are ipso facto indirect members of the League.

4.-ADMINISTRATION

- 4A.
 - (i) The management of the League shall be vested in an Executive consisting of:-
 - (a) the officers of the League
 - (b) fifteen other members to be elected at the Annual General Meeting, five of whom retire each year in rotation.
 - (ii) Six members shall form a quorum at any committee meeting.
 - (iii) All retiring members of the Executive shall be eligible for re-election.
 - (iv) The Officers of the League upon retirement from office shall be ex-officio Executive for one year unless the Executive shall otherwise decide.
 - (v) The Chairman shall have a casting vote at all meetings of the Executive.
- 4B.
 - (i) The officers of the League shall consist of:-

President	League Match Committee Chairman
Chairman	Cups & Shields Committee Chairman
Vice-Chairman	Tournaments Committee Chairman
General Secretary	League Match Officer
Treasurer	Press Officer
	Sponsorship Officer

INDIVIDUAL OPEN CHAMPIONSHIPS

Men's Singles

1992 S. Almond
 1993 J. Harford
 1994 J. Machin
 1995 S. Almond
 1996 J. Harford
 1997 J. Harford
 1998 M. Kellett
 1999 M. Kellett
 2000 T. Cope
 2001 M. McDonald
 2002 M. McDonald

Ladies' Singles

1992 Miss S. Littlewood
 1993 Miss J. Wright
 1994 Miss J. Wright
 1995 Miss J. Wright
 1996 Miss D. Tollitt
 1997 Miss J. Wright
 1998 No Event
 1999 Miss J. Long
 2000 Miss D. Tollitt
 2001 Miss D. Tollitt
 2002 No Event

Men's Doubles

1992 S. Hurst and R. Marshall
 1993 S. Hurst and R. Marshall
 1994 J. Machin and K. Balmforth
 1995 S. Almond and J. Abdous
 1996 S. Hurst and R. Marshall
 1997 S. Hurst and R. Marshall
 1998 S. Almond and J. Abdous
 1999 S. Almond and J. Abdous
 2000 S. Bentzen and M. Kellett
 2001 S. Bentzen and M. Kellett
 2002 S. Almond and M. Kellett

Ladies' Doubles

1992 Mrs. A. Abdous and Mrs. D. Vines
 1993 Miss J. Bridge & Miss S. Littlewood
 1994 Mrs. S. Sankey and Miss J. Wright
 1995 Mrs. S. Sankey and Mrs. D. Rigby
 1996 Mrs. S. Sankey and Mrs. D. Rigby
 1997 Miss J. Wright and Miss D. Tollitt
 1998 Miss J. Wright and Mrs. D. Rigby
 1999 Miss C. Clucas and Miss C. Walker
 2000 Mrs. S. Sankey and Mrs. D. Rigby
 2001 Miss C. Clucas and Miss C. Walker
 2002 Miss C. Clucas and Miss C. Walker

Mixed Doubles

1992 R. Marshall and Mrs. D. Vines
 1993 R. Marshall and Mrs. D. Vines
 1994 S. Hurst and Mrs. A. Abdous
 1995 S. Almond and Mrs. D. Rigby
 1996 J. Harford and Miss J. Wright
 1997 J. Harford and Miss J. Wright
 1998 S. Almond and Mrs. D. Rigby
 1999 S. Almond and Mrs. D. Rigby
 2000 D. Allen and Mrs. D. Rigby
 2001 M. Kellett and Miss D. Tollitt
 2002 M. Kellett and Miss D. Tollitt

GARRYOWEN LTD
SOUTHPORT AND DISTRICT BADMINTON LEAGUE
COMPOSITION OF DIVISIONS FOR 2002/2003 SEASON

30

Division One	Division Two	Division Three	Division Four	Division Five	Division Six
1 Burscough	1 Mawdesley II	1 Phoenix	1 Ainsdale II	1 Burscough III	1 Mawdesley III
2 Southport II	2 Pioneers	2 Southport IV	2 St. Cuthbert's II	2 Pioneers III	2 Southport VI
3 Victoria Hall	3 Victoria Hall III	3 Southsands II	3 Ormskirk	3 Victoria Hall V	3 Southsands V
4 Formby	4 West End Park II	4 Tarleton	4 Formby III	4 St. Cuthbert's III	4 Formby V
5 Woodvale	5 Woodvale III	5 Churchtown II	5 Hoole	5 Woodvale V	5 Hesketh Bank II
6 Mawdesley	6 Ainsdale	6 Burscough II	6 Phoenix II	6 Formby Meths.	6 Ainsdale III
7 Southport	7 Southport III	7 Pioneers II	7 Southport V	7 Tarleton II	7 Pioneers IV
8 Southsands	8 Victoria Hall II	8 Victoria Hall IV	8 Southsands III	8 Southsands IV	8 Victoria Hall VI
9 West End Park	9 St. Cuthbert's	9 Formby II	9 West End Park III	9 Formby IV	9 West End Park IV
10 Churchtown	10 Woodvale II	10 Hesketh Bank	10 Woodvale IV	10 Churchtown III	10 Woodvale VI

Division Seven	Division Eight	Division Nine
1 Ainsdale IV	1 Formby Meths. II	1 Mawdesley V
2 Tarleton III	2 —	2 Southport VIII
3 Southsands VI	3 Southsands VIII	3 —
4 —	4 —	4 —
5 Woodvale VII	5 Churchtown IV	5 West End Park VI
6 —	6 Mawdesley IV	6 Formby Meths. III
7 Southport VII	7 St. Cuthbert's IV	7 Southport IX
8 Southsands VII	8 Ormskirk II	8 Southsands IX
9 Tarleton IV	9 —	9 —
10 West End Park V	10 Woodvale VIII	10 West End Park VII

INTERNATIONAL SETTING RULE

1. No setting at 13 all or 9 all (ladies singles)
2. Setting only at 14 all or 10 all (ladies singles)
3. Scoring does not return to "Love-All"
4. Scoring proceeds 15,16,17 and 11,12,13 (ladies singles)
5. 3 Points are played in all cases
6. Option of playing "Straight Through" is still available

CUPS, SHIELDS and TOURNAMENTS

LEAGUE FIXTURES - DIVISIONS 1 TO 9

	Week Beginning					
2002	September					
L1 CUPS - Round 1	9	-	-	-	-	-
L2	16	1 v 2	7 v 6	5 v 3	8 v 10	9 v 4
L3	23	3 v 1	6 v 8	2 v 7	4 v 5	10 v 9
	30	1 v 4	9 v 6	5 v 10	2 v 3	8 v 7
	October					
L4 CUPS - Round 2	7	-	-	-	-	-
A, V & JB TOURNAMENT Entries by 12.10.02	14	5 v 1	6 v 10	3 v 8	4 v 2	7 v 9
L5 WATKINSON - Preliminary Round	21	-	-	-	-	-
	28	1 v 6	3 v 4	2 v 5	9 v 8	10 v 7
	November					
L6 CUPS - Semi-Finals	4	7 v 1	6 v 5	8 v 2	10 v 4	9 v 3
A, V & JB TOURNAMENTS	11	-	-	-	-	-
L7 WATKINSON - Round 1	18	1 v 8	4 v 6	2 v 9	3 v 10	5 v 7
	25	-	-	-	-	-
	December					
L8 CUP Finals	2	9 v 1	6 v 3	10 v 2	8 v 5	7 v 4
L9 CUP Finals	9	1 v 10	2 v 6	3 v 7	4 v 8	5 v 9
WATKINSON - Round 2	16	-	-	-	-	-
SHIELDS - Preliminaries by 10.1.03	23	-	-	-	-	-
	30	-	-	-	-	-
	January					
L10 C TOURNAMENT Entries by 11.1.03	6	2 v 1	6 v 7	3 v 5	10 v 8	4 v 9
L11 WATKINSON - Round 3	13	1 v 3	8 v 6	7 v 2	5 v 4	9 v 10
	20	-	-	-	-	-
L12	27	4 v 1	6 v 9	10 v 5	3 v 2	7 v 8
	February					
L13 C TOURNAMENT	3	-	-	-	-	-
B TOURNAMENT Entries by 08.2.03	10	-	-	-	-	-
L14 SHIELDS - Round 1	17	1 v 5	10 v 6	8 v 3	2 v 4	9 v 7
	24	6 v 1	4 v 3	5 v 2	8 v 9	7 v 10
	March					
WATKINSON - Round 4	3	-	-	-	-	-
SHIELDS - Round 2	10	-	-	-	-	-
L15 B TOURNAMENT	17	1 v 7	5 v 6	2 v 8	4 v 10	3 v 9
L16	24	8 v 1	6 v 4	9 v 2	10 v 3	7 v 5
L17 SHIELDS & WATKINSON - Semi-Finals	31	1 v 9	3 v 6	2 v 10	5 v 8	4 v 7
	April					
L18 SHIELDS & WATKINSON - Finals	7	10 v 1	6 v 2	7 v 3	8 v 4	9 v 5
	14	-	-	-	-	-

31

N.B. - LEAGUE TOURNAMENTS MAY START THE WEEKEND PRIOR
 GOOD FRIDAY - 18th APRIL 2003
 LEAGUE A.G.M. - 23rd APRIL 2003

FORMBY RESTRICTED TOURNAMENT, EASTER
 EASTER MONDAY - 21st APRIL 2003
 LEAGUE DANCE - 25th APRIL 2003