

Est. Price:\$88,000  
Weight (fully loaded): 13,500 lbs

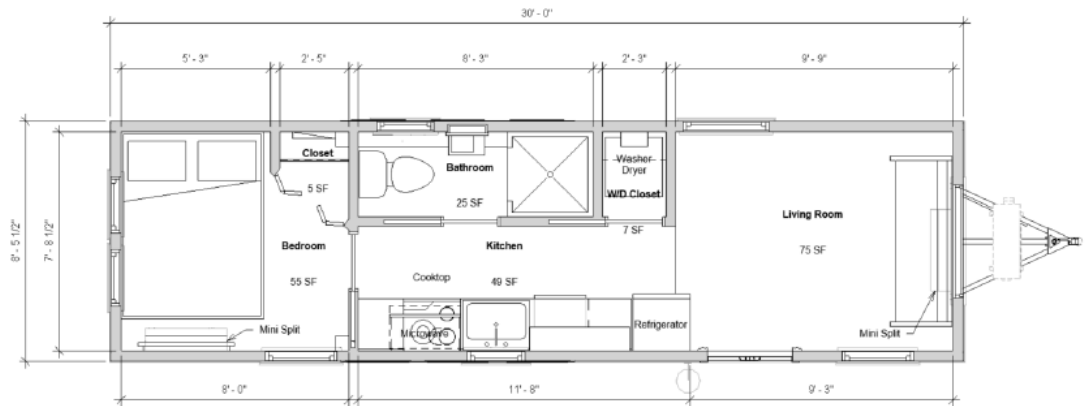

① Main Level Floor Plan  
3/8" = 1'-0"

## Specifications

- 8.5' x 30'. Total Livable Space= 216 sq. ft.
- Residential stick framing construction.
- High efficiency insulation envelope in floor, walls and ceiling.
- Built to meet or exceed IRC & NOAH ANSI+ standards.
- Design to travel without oversize load permits.
- Customizable floor plans. *Additional design service fee associated*

1 Coeur D'Alene Lake 8530

UNCHAINED CONSTRUCTION, LLC