

Packing contains :

1 Glider, 1 Dedicated Charger, 1 Wireless Push Button, 1 Hamster™ Transmitter and Hardware.

WARNINGS

By purchasing this product, you are agreeing to reading this manual before its use. Please Read safety and health information. In this manual / guide, we refer to this product as, device, Glider F™, Glider.

Applies to: all products.

Recmack products are developed to be safe and effective. You MUST read this guide before operation of the device for important safety and health information about your device, also, because of terms of the Limited Warranty that applies to your device. The guide is intended to help you to be familiar and comfortable with the Glider F™. **Failure to follow the instructions for proper set up, use, and care for your device can increase the risk of serious personal injury, death, or property damage.**

LED lights are very delicate, and if you rub them against rough surfaces permanent damage will occur such as deep scratches, fracture of LED's and entire strip.

Please consult with your local authorities before using this product to see if they have any limitations or objections to the use of this product.

Please do not use this product as a substitute, (for your vehicle or any other vehicle's), of manufacturer's installed signal system of the vehicle you intend to install and operate this product on. If there is a problem or malfunction with the manufacturer original provided signal system, please have a profesional take a look at it, since this product DOES NOT and will NEVER replace the manufacture's original intalled light signal system thereof. If this product is malfunctioning please discontinue the use immediately, death, serious bodily injury can occur if you keep using this product while malfunctioning. This product is intended to make the user of the Glider F™ visible to fellow riders, joggers, drivers or machines in good weather conditions; bad weather conditions like heavy fog will reduce the visivility of this device, therefore, exercise caution while riding, always assume other drivers, riders, joggers or machines are not able to see you. This product will not prevent you from getting into any kind of accidents, will NOT lessen the severity of a colition and will NOT prevent you from getting hurt or Die.

	<p>WARNING</p> <p>California Proposition 65</p> <p>WARNING: This product contains chemicals known to the State of California to cause cancer, and birth defects or other reproductive harm.</p> <p>ADVERTENCIA: Este producto contiene productos químicos reconocidos por el estado de California que provocan cancer, defectos de nacimiento u otros daños reproductivos.</p> <p><small>For more information: www.P65Warnings.ca.gov</small></p>	<p>This package contains lithium ion cells or batteries. This package must be handled with care. A flammable hazard may exist if the package is damaged. Special procedures must be followed if the package is damaged including inspection and repacking if necessary. Damaged cells or batteries should not be transported except under appropriate conditions.</p>
---	---	---

This package contains non-replaceable rechargeable 11.1V Dc / 800 mAh Lithium-Ion batteries located inside the Glider F™ receiving plastic box. Please dispose battery according to local regulations and not as a common household waste. Local authorities may encourage recycle your old lithium-ion batteries at a recycling center or a battery drop-off location near you.

Store your device where the temperature is between 32°F and 80° F (0°C to 30° C). Do not leave your device in your car because temperatures in parked cars can exceed this range. Do not use this device in temperatures below 0° C or (32° F) because the device may malfunction, and signal could be lost or interfere with each other.

This device is NO to be submerged in water. Submersion in water will cause electrical damage to this device and you will be electrocuted, and death will occur. This device is suitable for full-grown adults only and installation of Hamster™ must be done by a professional licensed auto electrician to avoid electrocution, serious harm and even death.

Do not use this device for anything other than its intended use.

Do not puncture, throw, bend, drop or modify this product. We reserve the right to modify and upgrade this device for future versions.

Do not put this product in water or into a fire. This product is rain proof only, therefore, avoid submersion in water.

Do not expose this product to any corrosive liquids such as salt water.

Do not operate this product if it has been submerged in water to prevent electric shock and bodily injury, even death may occur.

Do not leave your device in direct exposure to sunlight.

This device complies with part 15 of the FCC Rules. Operation is subject to the following two conditions: (1) this device may not cause harmful interference, and (2) this device must accept any interference received, including interference that may cause undesired operation.

Note: This equipment has been tested and found to comply with the limits for a Class B digital device, pursuant to part 15 of the FCC Rules. These limits are designed to provide reasonable protection against harmful interference in a residential installation. This equipment generates, uses, and can radiate radio frequency energy and, if not installed and used in accordance with the instructions, may cause harmful interference to radio communications. However, there is no guarantee that interference will not occur in a particular installation. If this equipment does cause harmful interference to radio or television reception, which can be determined by turning the equipment off and on, the user is encouraged to try to correct the interference by one or more of the following measures:

Reorient or relocate the receiving antenna.

Increase the separation between the equipment and receiver.

Connect the equipment to an outlet on a circuit different from that to which the receiver is connected.

Consult the dealer or an experienced radio/TV technician for help.

Changes or modifications to this product not authorized by Recmack LLC. negate your authority to operate the product and will absolutely lose the manufacturer 3 months warranty. Opening and/or repairing your device can present electric shock, device damage, fire, and personal injury risks, death and other hazards.

IF GLIDER F™ DOES NOT ILLUMINATE AND DOES NOT PAIR WITH HAMSTER™, MAY BE BECAUSE OF A LOW BATTERY STATUS. A LOW BATTERY CAUSES LACK OF BRIGHTNESS IN THE DEVICE AND NO CONNECTIVITY. FOR YOUR SAFETY AND FREQUENT IMPACT PROTECTION, THE BATTERY HAS BEEN ENCLOSED TIGHTLY.

ATTENTION <<After some time, the fittings will destroy and cause serious damage to your apparel or surface you will be attaching the device to. Please be aware of this issue, therefore, select proper clothing preferable thick clothing and something you will be willing to dispose after some time.>>

Specifications:

Version = 1.0

Effective Distance = 100 Feet or 30 Meters.

Fast Charging Time = 1 to 2 hours.

Frequency = 2.4GHz.

Voltage Input Of Glider F™= 11.1 VDC / 0.8 A

Charging Interface Of Glider F™ = Dedicated Male USB.

If the device contains SERIOUS manufacture defects, please send it back to us and we will fix or replace this product at no cost to you. But if the device has been attempted to be fixed by anyone else than us, opened, soft seals broken, suffered from trauma or other issues caused by the user, we will be charging you a fee for us having to fix this device and its corresponding shipping fee will be charged.

Trouble Shooting

Trouble	Cause	Resolution
<p>Glider F™ fails to turn on.</p> <p>White Diamond light located at center of Glider F™ fails to turn on.</p>	<p>Power Supply Failure</p> <p>On/Off round button was not pressed properly.</p> <p>Wireless push button has low battery status or dead batteries.</p>	<p>Connect the device to power outlet for some time to allow battery to charge, then turn on device. Press On/Off round button uniformly in center.</p> <p>Replace batteries inside the push button with two CR 2016 Duracell or better.</p>
<p>Glider F™ PAIRS WITH ANOTHER USER</p>	<p>USERS ATTEMPTED TO PAIR THEIR Glider F™ AT THE SAME TIME</p>	<p>TURN ALL THE DEVICES OFF AND START THE PROCESS OF PAIRING AGAIN. User 1 pair Glider F™ 1 with Hamster™ 1, then whenever user 1 is done pairing, only then, user 2 can go ahead and start paring Glider F™ 2 to Hamster™ 2 and whenever user 2 is done pairing only then user 3 can start paring Glider F™ 3 with Hamster™ 3 and so on.</p>

Glider F™ Connecting
Screws.

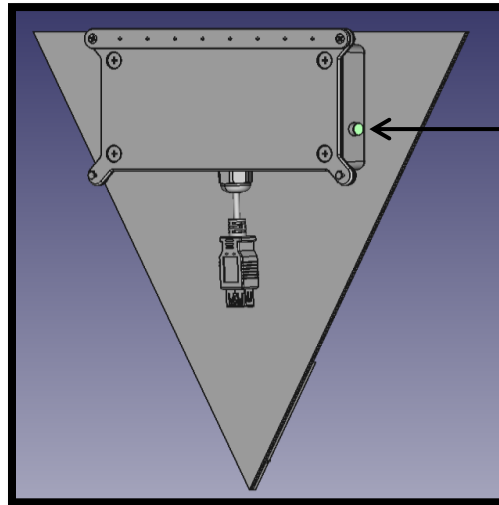
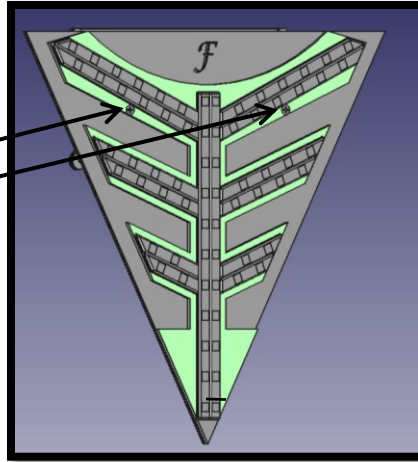

On/Off Pairing button. Whenever this button's blue light is blinking, it means the pairing mode is On, however, the Glider F™ is not paired with the Hamster™ yet. The button's solid blue light means that the device has been paired. **To pair device, first turn On Glider F™ then turn On vehicle and press the Break or turn on left or right signal.** The Glider F™ should pair with the Hamster™ already installed in your vehicle with no problem ****ATTENTION= Turn signals, left and right, and brake should be off before attempting to pair device, else device will fail to pair**** <<< If multiples vehicles are in use, please never pair all devices at the same time. Example: User 1 pair Glider F™ 1 with Hamster™ 1, then whenever user 1 is done pairing, only then, user 2 can go ahead and start paring Glider F™ 2 to Hamster™ 2 and whenever user 2 is done pairing only then user 3 can start paring Glider F™ 3 with Hamster™ 3 and so on.....>>>>>

If malfunction occurs just turn off the (Devices) Glider F™ and Hamster™ and start the paring procedure again, no big deal.

This a Tab expands the range of attachment area. This Tab has 1 mm holes distributed across the surface and (2 to 3) mm holes on each end. You can use the 1mm holes to attach the Glider F™ to your desired surface. If you have a better place of attachment on a particular surface, then install the Tab as shown in the picture. The tab comes with pins and micro screws that you can use to attach the Glider F™ to a Jacket, vest, backpack or preferred surface. You can also use your own fasteners if they can withstand the weight of the Glider.

You can use these openings to attach and secure the Glider F™ to a desired surface. << PLEASE MAKE SURE THAT THE OTHER SURFACE IS STRONG ENOUGH TO WITHSTAND THE WEIGHT OF THE GLIDER F™, ELSE THE OTHER SURFACE MAY COLLAPSE AND DAMAGE THE DEVICE. >>

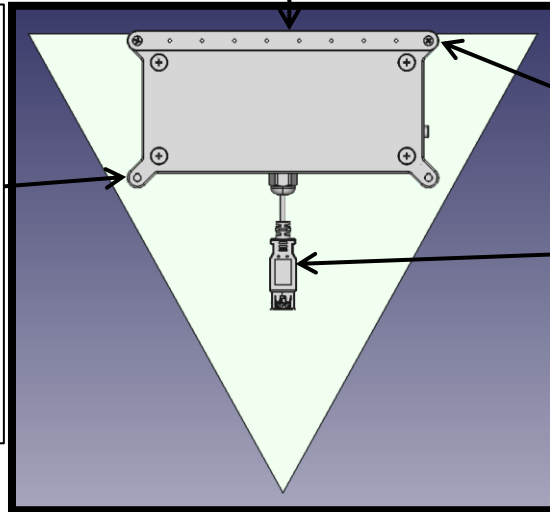

The Tab comes with M3 x 9mm fasteners. These are used to attach the Tab to the ears of the box, as shown in the picture.

Dedicated 12 Volts Manta Ray Charging Hub. Connect here the dedicated charger port for charging. << THIS DEVICE USES A 12 VOLT BATTERY TO OPERATE, THEREFORE, USE EXCLUSIVELY THE DEDICATED CHARGER SUPPLIED BY THE MANUFACTURER TO AVOID DAMAGE TO THE DEVICE AND PROTECT THE LIFE OF THE BATTERY. >>

The Rocker (square) switch turns On and Off the strobe light's function.

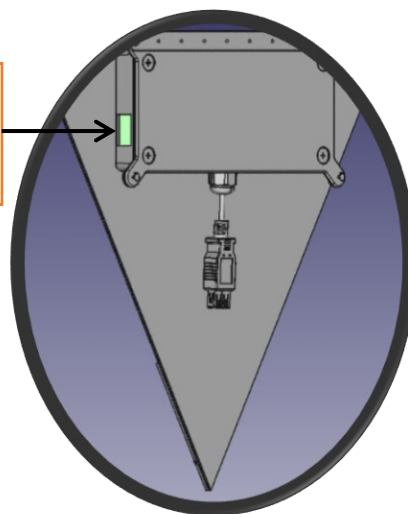

Vehicle Installation

These are holes designated to fasten the Hamster™ to the desired surface. You can use metal screw (not provided), or the zip ties provided by manufacturer.

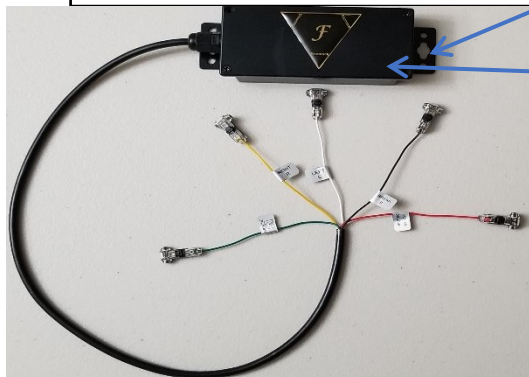

Red Pilot light. Whenever this light is blinking, it means the Hamster™ was turned on and it is not paired with Glider F™ yet; If light is **solid red**, it means Hamster™ has been paired or attempted to be paired with Glider F™. **ATTENTION << IF DEVICES DO NOT PAIR WITH EACH OTHER PLEASE CHECK BATTERIES. A LOW BATTERY CAUSES CONNECTION TO BE LOST.>>**

Connect the Hamster™ to the Electrical system of the vehicle you desire to use with the connectors supplied by manufacturer if they are compatible with the wire specifications described below. **<< ATTENTION = Please have a licensed and experienced Auto Electrician install the Hamster™ in your vehicle, Recmack LLC is not responsible for misuse or wrong installation of this product or side effect inflicted on your vehicle, never install this product on an overloaded circuit. Wrong installation of this product could cause Fire and Death. Please have a professional Auto Electrician install this product>> **ATTENTION=** If the electrical system consists of wire gauge of 22 AWG, 20 AWG or 18 AWG and bigger then serious damage to the wire strands will occur if you tap and then remove the connector provided to you. This connector works well with 24 AWG and 26AWG if your vehicle's electrical system consists of 24AWG or 26 AWG then you can safely tap into it with the connectors provided, but **MAKE SURE YOU DO NOT REMOVE THE CONNECTOR AFTER YOU TAP INTO THE VEHICLE'S ELECTRICAL SYSTEM, damage may occur to the wire strands.**** If you do not feel comfortable with our connectors, please feel free to use the ones recommended by your professional Auto Electrician technician.

Connect Hamster™ as shown in the following pictures =

Fast and Easy Connection, no soldering or splicing of wires. Just a few minutes or if you are fast in less than a few minutes installation.

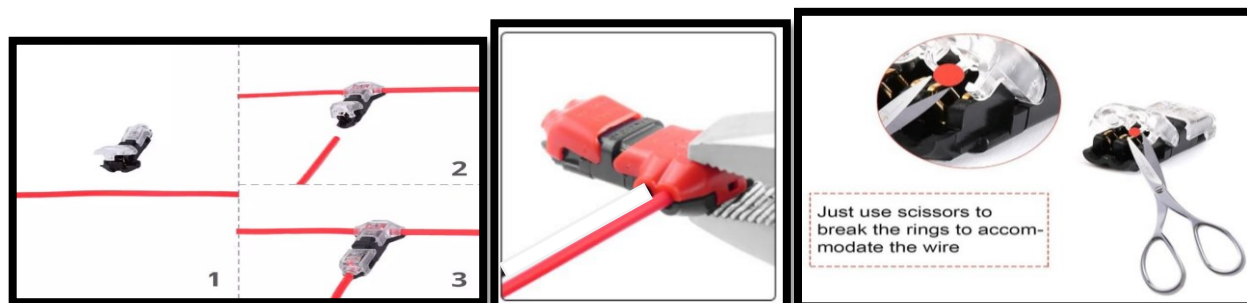

Apply connectors on wires as shown in the pictures on the left. To ensure a good connection, please press the tip of the connector firmly by using pliers as shown in picture in the center; If wire jacket is a little bigger cut the plastic ring with scissors as shown in the picture on the right.

12V Dc to 6 V Dc constant power, could possibly be the day light or rear light.
Do not connect straight to battery because it will drain the battery.



Vehicle's electrical system lines. << This is an assumption only; colors of the cables may vary depending on manufacturer and vehicle model>>

Red wire, tap to 12V DC to 6 V DC constant power, may be the day light or license plate light or constant rear light circuit **AS LONG AS THE CIRCUIT IS NOT OVERLOADED, ALWAYS CONSULT YOUR PROFESSIONAL LICENSED AUTO ELECTRICIAN.** << ATTENTION= Never connect directly to the battery, eventually it will discharge battery completely.>>

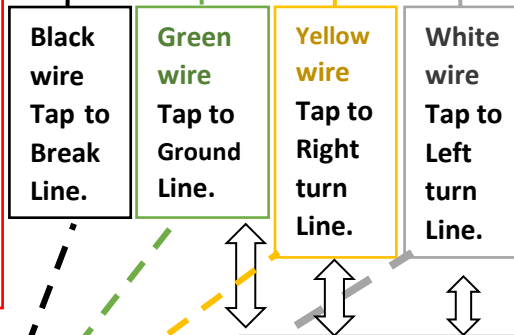

Hamster™ wire lines. **Red** (12VCD or 6VCD constant Dc Voltage), **Black** (Break), **Green** (Ground), **Yellow** (Right turn) and **White** (Left turn).

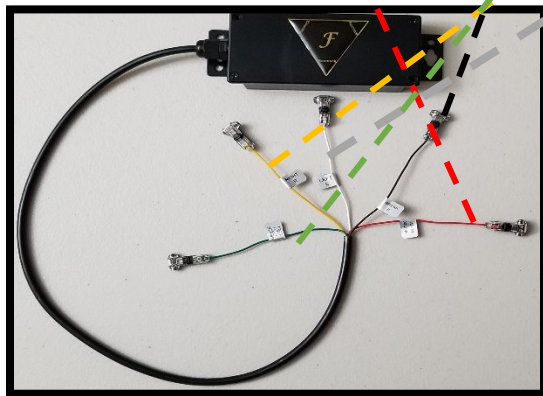

Push button. Press once and day light (white diamond light) in the center of device will turn on, press button again and day light will be off.

<<IF PUSH BOTTON IS NOT TURNING ON DAY LIGHTS ON YOUR GLIDER F™ PLEASE CHECK THAT THE PUSH BUTTON'S BATTERIES ARE NOT DEPLETED AND THE GLIDERS BATTERIES ARE CHARGED ELSE REPLACE THE BATTERIES INSIDE THE PUSH BUTTON (CR 2016 Duracell or better) OR JUST RECHARGE YOUR GLIDER F™.>>

Please view our tutorial installation videos for a comprehensive understanding of the product. This video highlight essential information, ensuring optimal performance and functionality of the device while guiding you on what to avoid. Thank you for your attention.

This device uses frequencies in the range of 2.4 GHz and 440 MHZ. Recmack LLC is not responsible for the side effects this device may cause to your health.



Assembled and designed in the US with most of the materials made in China.