



YAMAHA G-SERIES REAR FLIP SEAT INSTALLATION INSTRUCTIONS

MJRS3001I, MJRS3001

INCLUDED:

- SEAT FRAME
- SEAT BACK
- SEAT BOTTOM
- SEAT BACK SUPPORT BRACKET
- 2 MAIN BRACKETS
- 2 ARMRESTS
- 2 REAR STRUTS
- 2 J-HOOKS
- BAGWELL BRACKET
- 7 HARDWARE PACKS

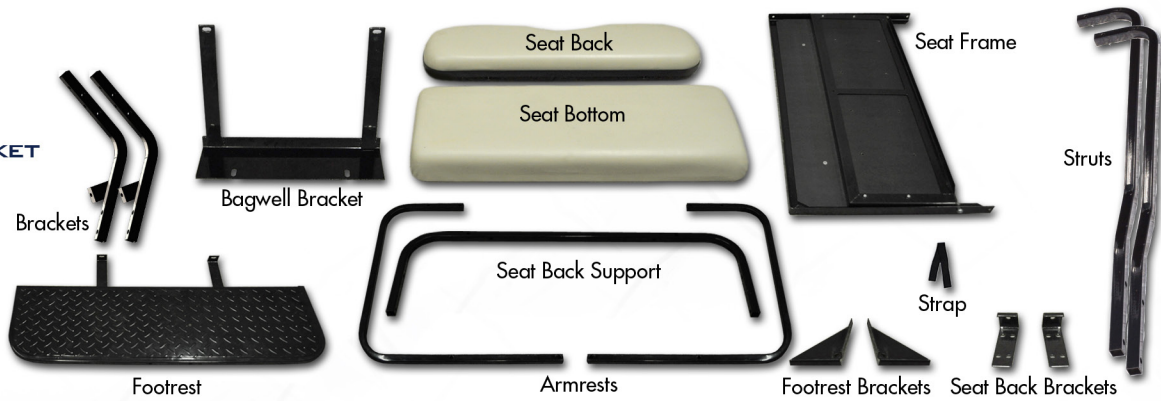

1
Take off canopy by removing upper strut hardware that secures canopy to front and rear struts. Retain hardware you will need it later.



2
Remove lower strut bolts and remove rear struts. If installing a seat on a Yamaha G-22, retain rear struts for later use.



3
Remove OEM front seat backs.
Retain hardware.

4
Remove motor cover.



5
Remove front seat.

6
Remove OEM front seat
supports. Retain hardware.





Insert main brackets into holes where OEM front seat supports were removed. Be sure the tabs are pointed to the cart's CENTER, as shown. Secure the main brackets with hardware retained in step 6.

Remove bagwell bolts. Then using a 5/16 drill bit, drill through the vehicle frame where the hardware was removed.



Attach bagwell bracket using hardware from pack 1.

10

Reinstall motor cover.





11 Place seat frame on cart. Attach seat frame to main brackets using hardware from pack 1.

12 Attach seat frame to bagwell bracket using hardware from pack 1. Ensure that the bottom of the seat frame lies in front of the bagwell bracket as shown.

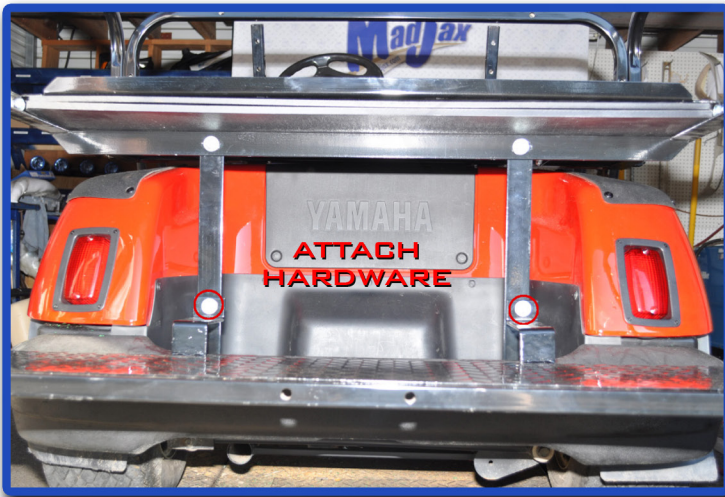
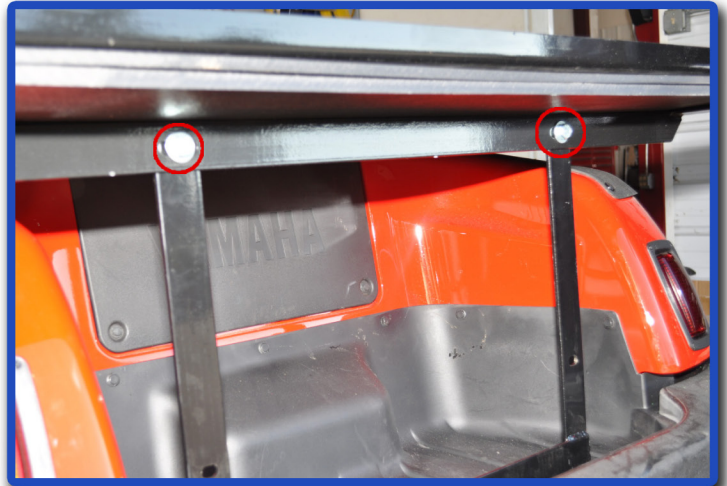

13 Attach footrest to bagwell bracket using remaining hardware from pack 1.
*Leave all hardware finger tight until later.

14 Attach seat back bracket and armrests to seat frame using hardware from pack 2.
*Leave all hardware finger tight until later.





Attach seat frame to rear portion of armrest using hardware from pack 2. Be sure to place hardware as shown.
*Leave all hardware finger tight until later.

Ensure that when attaching upper bolt through armrest and seat back bracket, you place a washer between the armrest and seat back bracket.
*Leave all hardware finger tight until later.

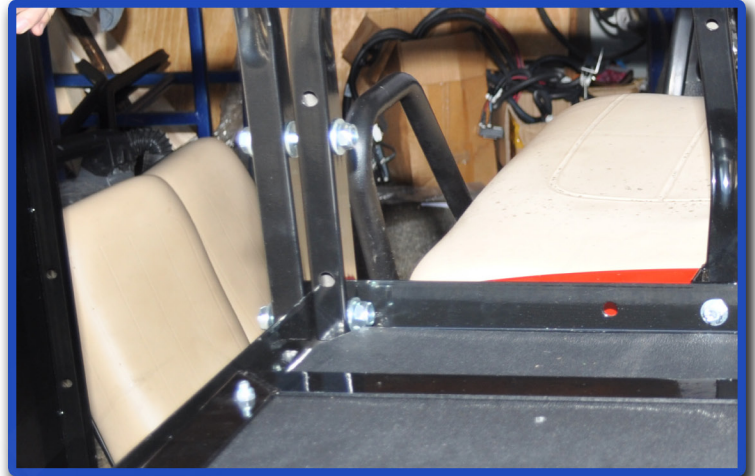

Reinstall front seat backs using hardware retained in step 3.

Attach lower location of armrests to footrests using remaining hardware from pack 2.
*You may now tighten all finger tight hardware on your rear flip seat.



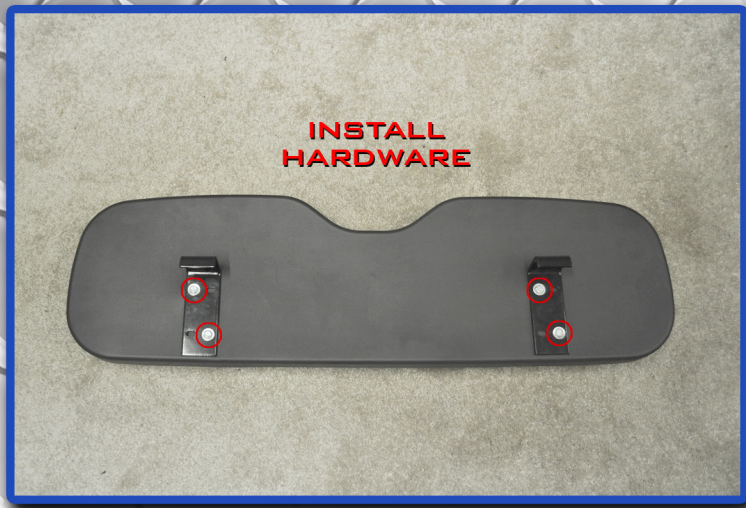

19

Attach seat back brackets to rear seat back using hardware from pack 3. Tighten hardware.

Install rear seat back and rear seat support bracket assembly by attaching end tabs of rear seat support bracket to armrests using remaining hardware from pack 3.



21

Attach seat bottom and strap to seat frame using hardware from pack 4.

Reattach struts and canopy using hardware retained in step 1. Tighten hardware.



YAMAHA G-SERIES REAR FLIP SEAT HARDWARE PACKS

HARDWARE PACK 1

- (6) 10MM X 25MM SHOULDER HEX BOLTS**
- (2) 8MM X 70MM SHOULDER HEX BOLTS**
- (12) 10MM X 20MM SHOULDER HEX BOLTS**
- (4) 8MM X 20MM X 2MM WASHERS**
- (6) 10MM ANTI-SLIP NUTS**
- (2) 8 MM ANTI-SLIP NUTS**

HARDWARE PACK 2

- (6) 10MM X 70MM SHOULDER HEX BOLTS**
- (2) 10MM X 45MM PHILLIPS HEAD BOLTS**
- (14) 10MM X 20MM X 2MM WASHERS**
- (8) 10MM ANTI-SLIP NUTS**
- (2) RUBBER SPACERS**

HARDWARE PACK 3

- (2) 10MM X 45MM SHOULDER HEX BOLTS**
- (4) 6MM X 30MM SHOULDER HEX BOLTS**
- (4) 10MM X 20MM X 2MM WASHERS**
- (4) 6MM X 18MM 1.5MM WASHERS**
- (2) 10MM ANTI-SLIP NUTS**
- (4) SPRING WASHERS**

HARDWARE PACK 4

- (9) CROSS RECESSED COUNTERSUNK HEAD SELF TAPPING SCREWS**
- (1) 6MM X 18MM X 1.5MM WASHER**

HARDWARE PACK 5

***FOR USE WITH OPTIONAL STRUTS**

- (4) 10MM X 70MM SHOULDER HEX BOLTS**
- (8) 10MM X 20MM X 2MM WASHERS**
- (4) 10MM ANTI-SLIP NUTS**
- (1) STRAP**

