

Conowingo Models

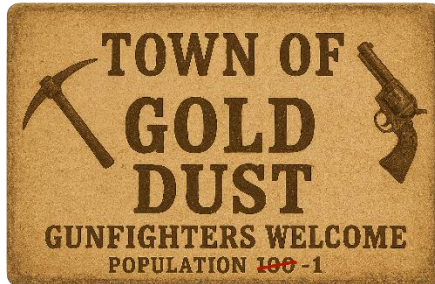

PACK 2

HO scale



www.conowingomodels.com
<https://www.facebook.com/ConowingoModels/>
conowingomodels@yahoo.com

November 2025



Thank you for purchasing this kit!

Enclosed are a pack of four background flats. They are somewhat based on real structures and movie sets of old west towns.

The first six pages of these instructions are the basic directions needed to complete the steps universal to all structures. Steps unique to each structure starts on page 7.

Please feel free to make variations and use the structures for other than what we intended them.

Some photos are of other structures in the Gold Dust series. They are provided to give you a general overview of what you are looking to accomplish.

One thing you could do is use these structures to model an abandoned "ghost town". Use scrap stripwood to board up windows, use a hobby knife to break the "glass"

or remove the shingles from the roof. The possibilities are only limited by your imagination.

If you do purchase multiple packs, make sure that you build only one pack at a time. This will help avoid confusion and help the building process.

As you will notice, there are lots of old western movie and television references in this series. Some are obvious, some require a little bit of research.

See conowingomodels.com for more info and tips on the instructions below.

INDEX

INDEX	1
PARTS DIAGRAM	2
GENERAL INSTRUCTIONS	2
1. EXTERIOR CORNER BRACING	2
2. INTERIOR BRACING	2
3. WINDOW CURTAINS	3
4. STRUCTURE STAINING/ PAINTING	3
5. ROOFING	3
6. DOOR AND WINDOW PREP	4
7. STRIPWOOD PREP	4
8. PORCH ROOF ASSEMBLY	4
9. BASE INSTALLATION	5
10. PORCH ROOF POSTS	5
11. DECKING	5
12. SIGNS	6
KIT NUANCES	7
HOUSE 2 – THE JOHN REID HOUSE	7
MADAM MARIE'S	8
SHOP 1- NORTHWESTERN MINING COMPANY	9
SHOP 3 – BORIS RIDGLEY UNDERTAKER	9

PARTS DIAGRAM

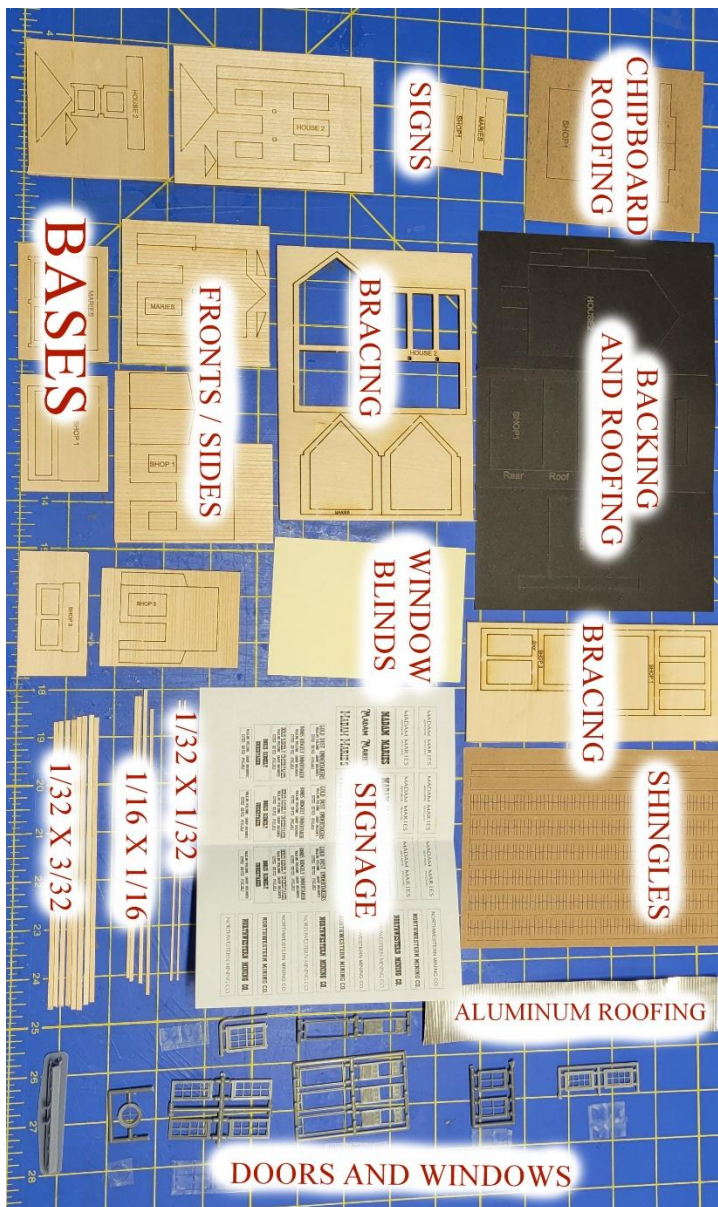

GENERAL INSTRUCTIONS

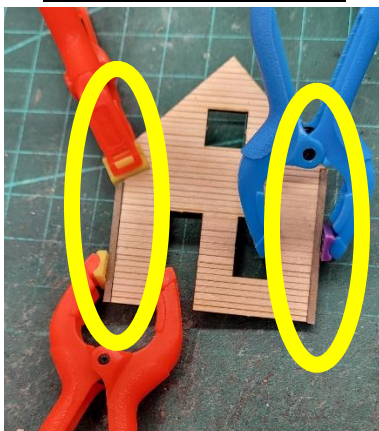

1. EXTERIOR CORNER BRACING

Not all structures in the series have 1/16 x 1/16 **exterior corner bracing**. In Pack 1, they all do.

Before you go any further, we recommend that you at least read through the Stripwood Prep section.

When adding the exterior corner bracing, we recommend adding them before the internal bracing.

Use rubber bands or clamps to glue the 1/16 x 1/16 bracing to the corners as tightly as possible.



2. INTERIOR BRACING

All structures use **two pieces of 1/8" laser-cut bracing**. One attaches to the **front wall** (1/16" basswood), the other to the **back wall** (black card stock).

When applying the card stock, **the name of the structure faces forward**. This prevents accidentally reversing the back wall (an easy mistake). Lay the card stock down first. Apply glue to the backside of the 1/8" bracing and gently place on the card stock.

This will result in the card stock protruding from the sides and bottom of the bracing. Make sure the sides are centered with the card stock visible on the bottom.

We recommend using clamps and/or rubber bands to help bond the card stock to the 1/8" bracing. The same is true for gluing the front and rear 1/8" bracing together.

While 3-2-1 blocks seem like a perfect solution to this issue, we've found that if the pressure isn't applied perfectly, the two pieces will slide before adhering.

If the two pieces end up not lining up they will need to be fixed. In some cases, this can be an easy fix, by cutting the protruding braces. However, it is not the prettiest.



3. WINDOW CURTAINS

Cut and install the **window curtains** on the inside of the front wall after staining. They do take paint well in the event that they are accidentally stained or you decide to change the color.



4. STRUCTURE STAINING/ PAINTING

All staining and painting should be done **after bracing is glued and dried** to help prevent warping. We suggest not using the same stain(s) on all structures. They would have all been built at different times, by different people and presumably using different materials. We used Hunterline Rust, Cedar and Raw Sienna for the different structures.

With the barn, we dry brushed on red paint after staining. Once the paint was dry, we added a few more layers of stain to suppress the red.

Be sure to stain the back side of the false-front. While most likely nobody will probably see the back sides, it will help prevent warping in the areas where there is no bracing.



Don't forget to stain the triangular sides of the porch roofing.

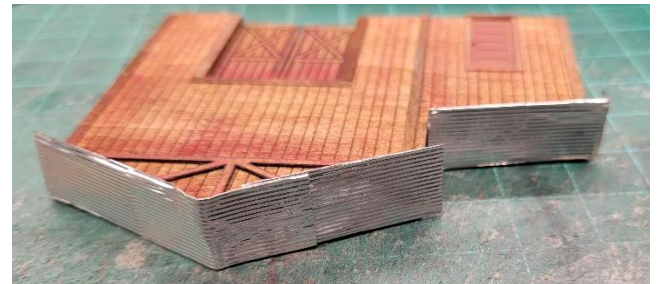

Corrugated Aluminum Roofing



Wood Shingle Roofing



Asphalt Roofing

5. ROOFING

We've included black cardstock roofing for all structures. This models asphalt roofing.

We suggest using varied roofing materials for the same reasons as stated in the Staining step. Take a good look at the structures and see what roofing surfaces are visible. Larger areas like porch roofs would be good candidates for the corrugated aluminum roofing or the wood shingles, for example.

Narrow roofing surfaces, such as pitched roofs may be better with the asphalt or aluminum.

We have included chipboard to serve as the roofing surface.

Remember, the aluminum roofing would be in three-foot-wide sections. We used a scale ruler to determine where to cut the sections.

To age the asphalt roofing, take the following steps;

After you glue the cardstock to the chip board (and they are dry), Jason Jensen recommends quickly spray painting a few shades of grey on the roof.

We didn't do that with the pilot models.

When the paint is dry, hold the roof firmly on a flat surface. (We use a hard piece of wood, so we're not tearing anything up.)

Sand the roofing material in the direction of rain flow.

Repeat until you're happy with the results.

6. DOOR AND WINDOW PREP

We used Apple Barrel Nutmeg Brown for all of the doors and windows. You may have a better brown color in mind. If you do, please share.

You may choose to test your color choices on some scrap wood to make sure the colors blend together.

You can also add stains over the top after the paint has dried. If you do this, you may want to spray it with a clear flat before applying any stain. This will help keep the brown paint on the window/door.

You could also paint the building as if it were new.

Once you're happy with the paint on each door/window, glue the glazing into place.

7. STRIPWOOD PREP

There are four sizes of stripwood that we included with these kits.

1. 1/32 x 1/32 – Could be used as a way to hold the roofing material down on the asphalt roof. It is more commonly used to frame out the signs.
2. 1/32 x 1/16 – Only used on the barn for corner bracing between the main building and the shed.

3. 1/16 x 1/16 – Corner bracing, corner posts, door framing and railing supports.
4. 1/32 x 3/32 – The workhorse. Used for roof trim, roof cornices, railings and deck boards.

We used several stains on all stripwood.

We tried a technique that we haven't used before. It's not new, just new to us. We dipped the stripwood directly in the bottle for a few seconds, which drastically reduced production time. Be sure to shake off the excess as you remove the stripwood from the bottle. They will stick together, which isn't a big deal, so don't worry about separating them.

We began by dividing the stripwood up by the number of base colors. In our example, we used two-Hunterline Blue Grey and Driftwood. This "ages" the wood.

Once dry, we re-divided them randomly between Hunterline Rust, Cedar and Raw Sienna. This "weathers" the wood and ultimately gives the wood variations.

Repeating either the aging or weathering process introduces further variations.

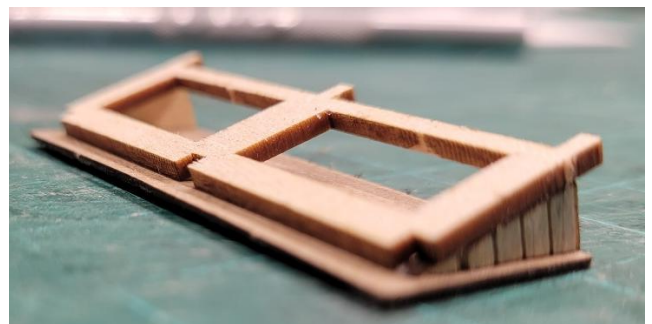

Porch roof assembly shown upside down.

8. PORCH ROOF ASSEMBLY

The porch roof frames mirror the deck frames in that when complete, they will be directly lined up.

You may want to sand the edges so that the notch disappears. If not, you can stain it away later.

The three notches (Two on some roofs) will attach the roof to the structure.

Glue the triangular sides to the porch roof frames so that the scribed pieces will be vertical when they are added to the structure. (Shown upside down above).

The short edge should cover the square notch in the corner.

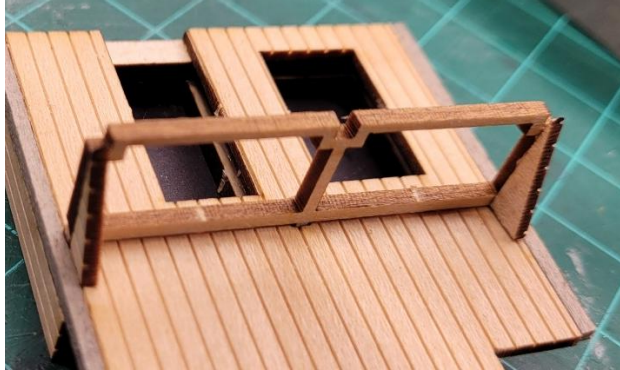

The above photo shows what the assembly will look like installed, minus the roof.

Install the porch roof.



9. BASE INSTALLATION

One of the biggest problems we ran into with the pilot models is that the bottoms don't always sit level.

To fix this, we recommend sanding the bottom flat.



Glue the base to the underside of the structure as shown above.

The base should be slightly narrower than the structure on the sides. It should fit even, front to back.

To ensure that the structure doesn't have a hunch back look, lay it on its rear wall and use a 3-2-1 block or something similar to hold the base at a 90° angle.

You may want to consider accomplishing the next step now in an effort to reduce time and ensure proper alignment.

Allow to dry.

10. PORCH ROOF POSTS

Use the 1/16 x 1/16 stripwood for this step.

You will notice that there are notches in both the porch roof and the deck. Some decks have two posts, while others have three.



Slide a piece of the stripwood into a top notch (Porch roof) and into the corresponding bottom notch (deck). Make sure that the piece fits firmly into place.

Mark and cut at the bottom of the deck.

Glue the stripwood into place and repeat for the remaining posts.

11. DECKING

Most of the decking is universal throughout the three packs. There are a few variations and they are noted in the individual kit notes.

You will notice that on many of these photos, the doors are already in place. We recommend doing the decking before adding the doors, so that the deck boards go under the door.

Start with the pre-stained 1/32 x 3/32 stripwood. Most decks take approximately two, six-inch pieces to complete.

You will notice in the photo below the variations in the deck wood. You want to vary the board colors in order for the structure to have character.

The common deck boards will need to be .65 inches wide.

Before you cut them all down, we highly recommend cutting one piece and seeing if it fits before you cut the rest down.

We used an Ultimotion Slicer for this task, but similar tools that allow you to set and repeat a length will also work.

If the deck you are working on has a center post, we recommend starting by adding one board behind that post first. You will need to cut it down to size. Use the post on either the right or left side to measure the length of that board.

We used Aileen's for gluing the deck boards down. In doing so, we found that you should cover about ¼ inch of the deck with glue at a time.

Glue all boards into place.

You will notice that the end boards overlap the edges by 50%. This is to make it more realistic.



On some of the pilot models, we cut the notch in the end boards for the corner posts. This extra bit next to the corner post **isn't realistic**. (left photo, above) You want to cut the end boards as you see on the right. We added this in case some of the photos show what you're seeing on the left.

Once the decking is dry, we recommend using a sanding sponge to make the deck boards even.

Follow that up with a universal stain (such as Rust) to cover up the cut ends.

12. SIGNS

You are highly encouraged to find your own signs. This will make the town yours.

Cut out the sign from the 1/32 basswood sheet.

Cut out the sign you would like to use.

Apply glue to the basswood and affix the paper sign to it.

Press to dry. In our experience, the glue dries pretty quickly. However, you may need to wait for it to dry before continuing.

You will need to trim the edges.

We used stains to tone down the signs. One color not mentioned previously is Hunterline Concrete. It does a great job in sun fading, while adding dirt at the same time.

Once this is dry, use some 1/32 x 1/32 stripwood to frame out the edges.

Glue the sign to the desired location.

KIT NUANCES



HOUSE 2 – THE JOHN REID HOUSE

John Reid is the real name of the [Lone Ranger](#).

Construction is fairly straightforward. For those that have built the Gold Dust Pack 1, this is a different version of Hotel 1.

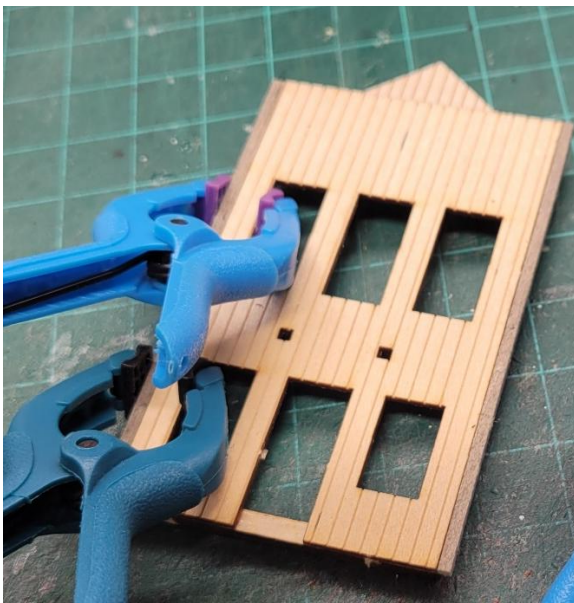

This structure does get 1/16 x 1/16 corner bracing on either side of the front wall as shown above.



Cut and glue the window blinds into place as desired.

Apply the roofing as desired to the chipboard pieces of the roof and the stoop.

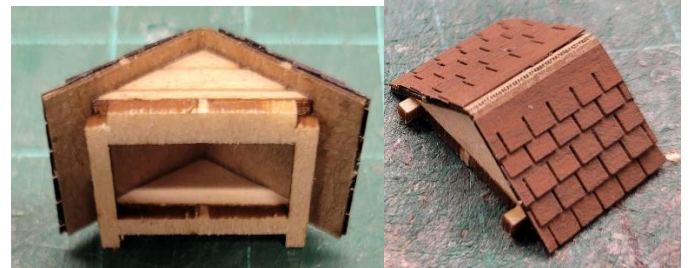

Assemble the front stoop as shown above. Notice how the notches protrude from the rear. They will connect to the structure. The triangular piece of 1/16 basswood will fit against the structure, so glue the chipboard piece into place with the excess hanging off the front.

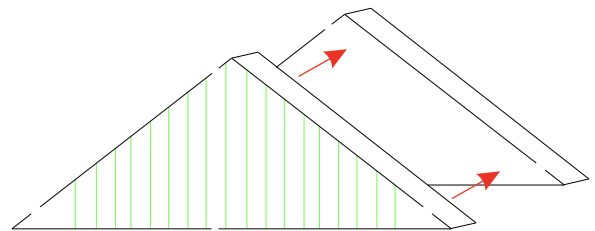

Glue the two larger triangular-shaped “attic” pieces together.

Glue the halves of the front and rear together, making sure they are even.

Glue the side walls into place.

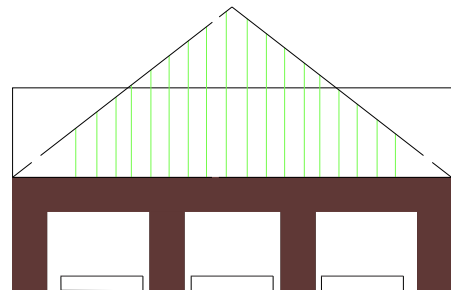

Glue the “attic pieces into place, with the scribed side facing forward. Ensure they sit on the shelf of the front piece of bracing and even with the rear piece of bracing. See also photo on adding window blinds.

For this next step, it works best if the structure is laid flat on its’ back.

Add the front stoop roof assembly, ensuring that the notches go in the slots on the front of the structure and that the triangular side is flat against the building.



You can apply the cornice as you desire. We used a piece of 1/32 x 3/32 stripwood across the top, with a slight overhang on each side. This was followed by another piece of 1/32 x 3/32 stripwood being glued to the front.

We also offer 3d printed cornices on the website or you can use the one from the shop.



Glue the roof into place. The top will overlap the cornices.

Glue the base into place. The sides and front will overlap the base slightly. Make sure the overlap is even. See photo below for what that will look like.



When dry, using a piece of 1/16 x 1/16 stripwood measure, cut and install the two support posts for the stoop. There are notches in both the stoop and base for the 1/16 x 1/16 to go.



Measure, cut and glue into place the deck boards using 1/32 x 3/32 stripwood.

Install the windows.

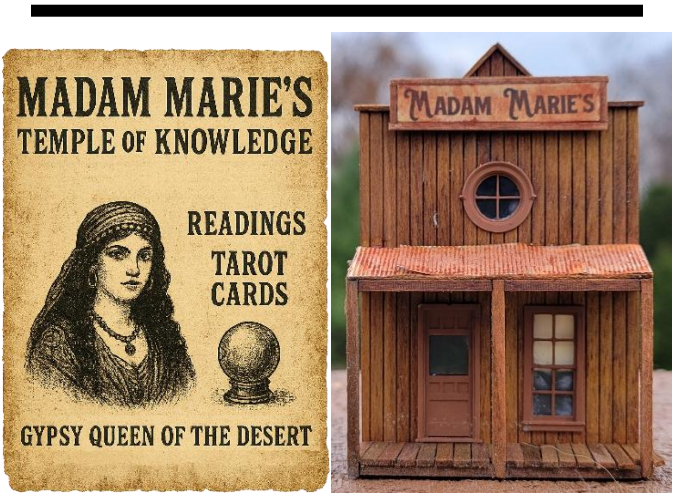

MADAM MARIE'S

A simple background flat with no direct prototype, just a blend of several businesses from the period. This is one of many Bruce Springsteen references in our kit line. [Madam Marie's](#) is a real place (that still exists on the boardwalk in Asbury Park, NJ) and [Madam Marie](#) was a real person. The structure itself has roots in the Cypress Lounge, which we felt it needed a different front. The great modeler Karl Osolinski built a similar structure with a round upper window. We figured a little mystery needed a mystic explanation or perhaps a lack thereof?

The background flat is based on the full-size structure that is available at conowingomodels.com



Construction of this structure is pretty straightforward.

This structure does NOT get 1/16 x 1/16 corner bracing on the front wall.

There are three 1/16 x 1/16 porch roof braces.

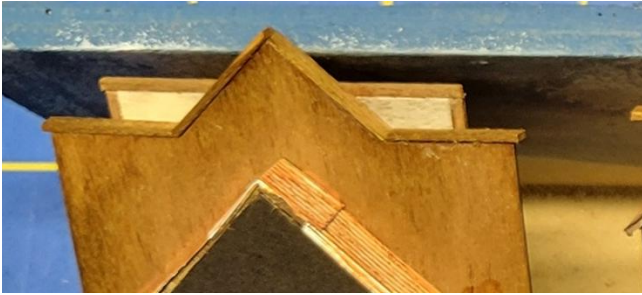

There are also 1/32 x 3/32 roof trim pieces as shown above.

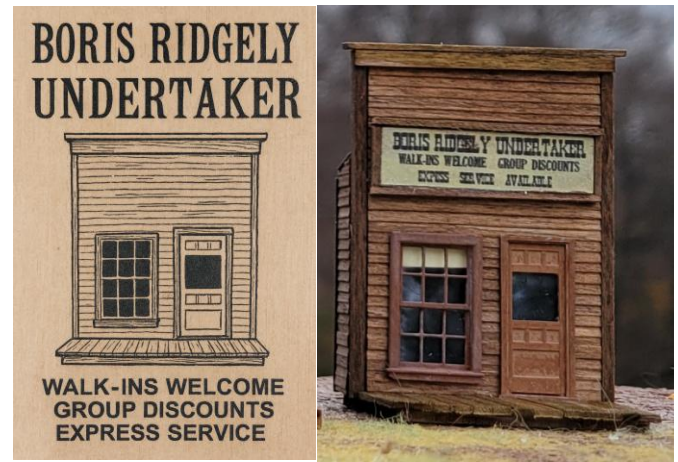

SHOP 3 – BORIS RIDGLEY UNDERTAKER

In [Blazing Saddles](#), there was no specific mention of an undertaker. However, the hangman was named Boris and was portrayed by Robert Ridgely.

Again, this structure is very straightforward.

This structure does get 1/16 x 1/16 front corner bracing.

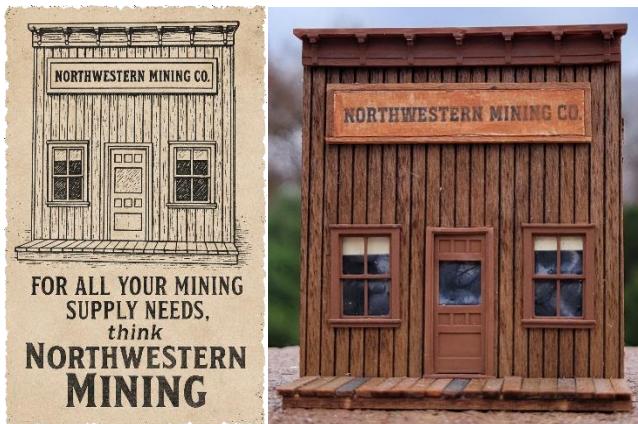

SHOP 1- NORTHWESTERN MINING COMPANY

[Northwestern Mining Company](#) – From the television show [“Northern Exposure”](#). The building exists in Roslyn, WA, but doesn’t look like this.

This structure does NOT get 1/16 x 1/16 corner bracing on the front wall.

Construction of this structure is pretty straightforward with no porch roofing.

We’ve included a 3d printed cornice. However, you can use 1/32 x 3/32 stripwood as shown with House #2 or we have other cornices available from conowingomodels.com

Please share your photos on our Facebook page!

<https://www.facebook.com/ConowingoModels>

Once again, thank you for your purchase!

If there are any parts missing, please e-mail us what you need to complete the kit and we'll send it your way. Suggestions for improvement are welcome. You will notice that there is a date on the first page of the instructions. As we improve our instructions, we update the date and add them to the website for download.

See the Conowingo Models website
www.conowingomodels.com
for more exciting, funky buildings for your model railroad!

Many thanks to my family, Jeff Grove, Steve Milley and Mark Schreier for their support!

COMING SOON!!!

PACKS 3, 4?



Pack 1

Hotel 1, Hotel Von Shtupp
House 1, John T. Chance House
Bank 1, Gold Dust Bank
Barn 1, Brimley's Farrier Service



Pilot models of Pack 3

Shop 4, Western Union Telegraph Office
Gold Dust Church
Shop 2, Gold Dust General Store
Saloon 1, Joe Bell's Saloon

We're working on designing Pack 4. The success of the first three packs will help determine if Pack 4 makes sense. We hope they're successful as what we have in mind for Pack 4 is more ornate and very cool.