



PRICE GUIDE



Metal Colors

STANDARD METAL

Same price for Standard Metal or Shingle Roof.

RUSTIC RED	CHARCOAL	BLACK
BURNISHED SLATE	HUNTER GREEN	SILVER

SPECIAL ORDER METAL

Adds one week to the lead-time and has a slight upcharge.



SEE YOUR
LOCAL
DEALER
FOR COLOR
OPTIONS

Shingles

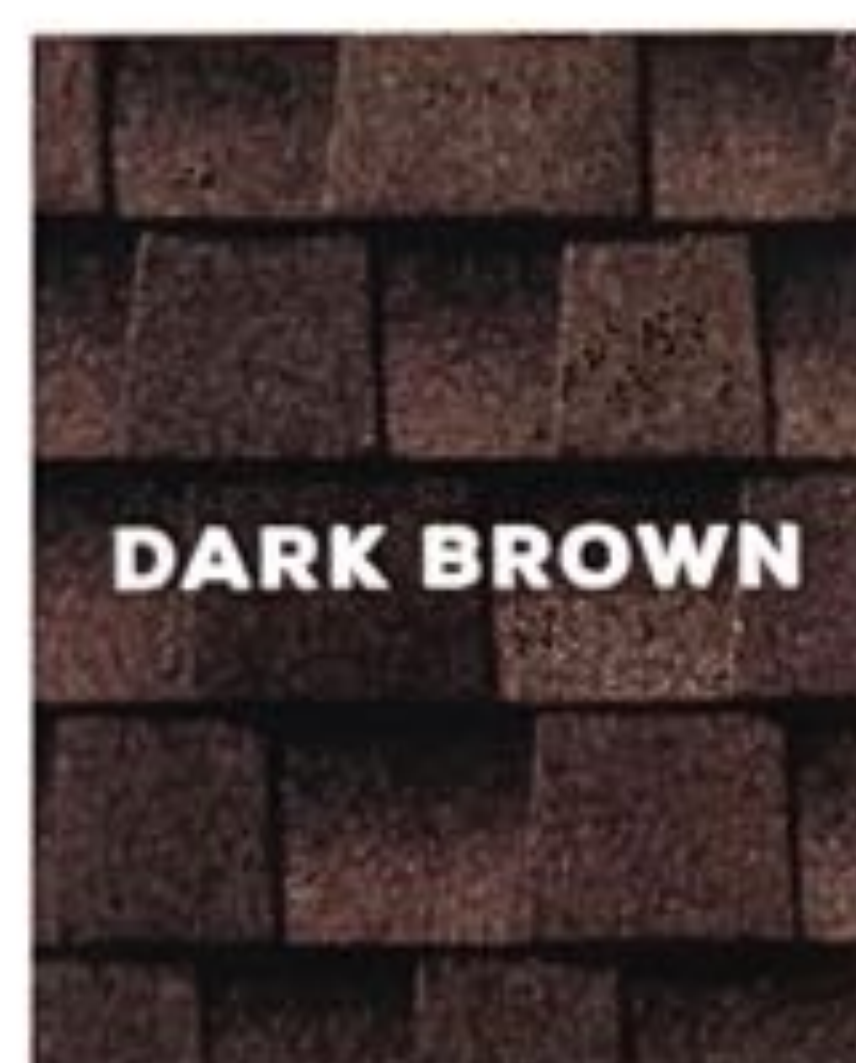

Paint & Urethane Colors

STANDARD PAINT

One Standard Paint Color included in price.

BARN WHITE	NAVAJO	BEIGE
CLAY	BUCKSKIN	BROWN
GRAY SHADOW	GAP GRAY	BLACK
EVERGREEN	PINNACLE RED	SCARLET RED

URETHANE STAIN COLORS

MAHOGANY	HONEY GOLD	CHESTNUT BROWN
DARK EBONY	DRIFTWOOD	

Metal color availability and color names vary by region. Please consult your dealer for options in your area. Actual colors may vary from those displayed in brochure. See dealer for actual color swatch. OHS is not responsible for colors not matching the brochure.

OLDHICKORYSHEDS.COM

FACEBOOK.COM/OLDHICKORYBUILDINGS
INSTAGRAM.COM/OLDHICKORYBUILDINGS



Scan the QR code or visit
oldhickorysheds.com/brochure
to view & download our full brochure.

NorCal Sheds & Carports

629 5th St
Marysville, CA 95901
Ph: 530-790-5268



LOFTED BARN

PRICE IS FOR 6' 3" WALLS (7' AVAIL)
TREATED OR PAINTED ONE COLOR

SIZE	CASH PRICE*	RENT TO OWN (36 MO)
8x10	\$5,045	\$233 ⁵⁶
8x12	\$5,275	\$244 ²¹
8x16	\$6,195	\$286 ⁸¹
10x10	\$5,975	\$276 ⁶²
10x12	\$6,475	\$299 ⁷⁷
10x14	\$7,225	\$334 ⁴⁹
10x16	\$7,245	\$335 ⁴²
10x20	\$9,125	\$422 ⁴⁵
12x16	\$9,545	\$441 ⁹⁰
12x20	\$10,525	\$487 ²⁷
12x24	\$12,425	\$575 ²³
12x28	\$14,125	\$653 ⁹⁴
12x30	\$15,125	\$700 ²³
12x32	\$15,245	\$705 ⁷⁹
12x36	\$16,775	\$776 ⁶²
12x40	\$18,575	\$859 ⁹⁵
14x24	\$15,495	NA
14x28	\$17,595	NA
14x32	\$19,845	NA
14x36	\$21,445	NA
14x40	\$22,825	NA
▶16x24	\$18,625	NA
▶16x28	\$21,075	NA
▶16x32	\$23,775	NA
▶16x36	\$25,725	NA
▶16x40	\$27,095	NA

Up to 8ft of loft included in price. Additional charges apply if over 8ft. No discount for subtracting loft.
▶16ft wide buildings only available as build on site.

STANDARD BUILDINGS

Choose a
Standard
Building
Style & Size

Then choose
an add-on
package below

Your package price is added
to the standard building price

ADD-ON PACKAGES



UTILITY SHEDS

PRICE IS FOR 6' 3" WALLS (7'/8' AVAIL)
TREATED OR PAINTED ONE COLOR

SIZE	CASH PRICE*	RENT TO OWN (36 MO)
8x8	\$4,045	\$187 ²⁷
8x10	\$4,175	\$193 ²⁹
8x12	\$4,495	\$208 ¹⁰
8x16	\$5,925	\$274 ³¹
10x10	\$5,275	\$244 ²¹
10x12	\$5,645	\$261 ³⁴
10x14	\$6,475	\$299 ⁷⁷
10x16	\$6,695	\$309 ⁹⁵
10x20	\$8,395	\$388 ⁶⁶
12x16	\$8,525	\$394 ⁶⁸
12x20	\$9,545	\$441 ⁹⁰
12x24	\$10,875	\$503 ⁴⁷
12x28	\$12,495	\$578 ⁴⁷
12x30	\$13,395	\$620 ¹⁴
12x32	\$14,075	\$651 ⁶²
12x36	\$15,175	\$702 ⁵⁵
12x40	\$16,895	\$782 ¹⁸
14x24	\$14,295	NA
14x28	\$15,995	NA
14x32	\$17,245	NA
14x36	\$20,395	NA
14x40	\$21,945	NA
▶16x24	\$17,025	NA
▶16x28	\$19,175	NA
▶16x32	\$20,675	NA
▶16x36	\$24,425	NA
▶16x40	\$26,275	NA

▶16ft wide buildings only available as build on site.



PLAYHOUSE

Includes HOUSE-STYLE DOOR WITH 9 LITE WINDOW, 4' PORCH*, two PORCH POSTS, and three 2' x 3' SINGLE PANE WINDOWS. The Utility Style Playhouse package will include 8' WALLS. Package price does not include wooden barn doors. *Total length of building includes 4' PORCH.

\$1,415

Adds \$65.51 to 36 month rent

Building must include a porch to get package price.



DELUXE PLAYHOUSE

Includes HOUSE-STYLE DOOR WITH 9 LITE WINDOW, PORCH, PORCH RAILING (Included porch railing is 3 sections that are approx. 4' each.), four PORCH POSTS, and five 2' x 3' SINGLE PANE WINDOWS. The Utility Style Deluxe Playhouse Package will also include 8' WALLS. Minimum size is 12' x 24'. Package price does not include wooden barn doors. *Total length of building includes 4' PORCH.

\$2,385

Adds \$110.42 to 36 month rent

Building must include a porch to get package price.



GARAGE

Includes GARAGE DOOR, HOUSE-STYLE DOOR WITH NO WINDOW, one 2' x 3' SINGLE PANE WINDOW and 12" ON CENTER FLOOR JOISTS. The Utility Style Garage Package will also include 8' WALLS. Package price does not include wooden barn doors. Occupancy class not intended for use as a 'Private Garage' as defined by IBC.

9' GARAGE DOOR

\$1,580

Adds \$73.15 to 36 month rent

8' GARAGE DOOR

\$1,565

Adds \$72.45 to 36 month rent

Building must include a garage door and house-style door with no window to qualify for package price.



SIDE PORCH

Includes HOUSE-STYLE DOOR WITH 9 LITE WINDOW, PORCH, PORCH RAILING (included porch railing is approx. 4'), one PORCH POST, two 2' x 3' SINGLE PANE WINDOWS and DOUBLE WOODEN BARN DOORS. The Utility Style Side Porch package will also include 8' WALLS. *Total building width and length includes porch dimensions.

\$1,585

Adds \$73.38 to 36 month rent

Building must include a porch to get package price.



SHED DORMER

Available only on Utility Sheds

Includes a 7/12 PITCH ROOF (normally 5/12), three 10" x 29" WINDOWS in dormer. Only available on 8', 10' & 12' wide buildings. Inside wall heights are 81" for T1-11 siding and 82.5" for painted LP Smart Panel. More than one dormer can be added to building if size permits. Add \$1,515 for each additional dormer.

\$1,515

Adds \$70.14 to 36 month rent



GABLE DORMER

Available only on Utility Sheds

Includes one 18" OCTAGONAL WINDOW. More than one dormer can be added to building if size permits. Add \$1,515 for each additional dormer.

\$1,515

Adds \$70.14 to 36 month rent



Engineer Certified buildings are certified for 105 mph winds and 30 psf Ground Snow Load (Barn & Utility Shed) or 60 psf Ground Snow Load (Lofted Barn) (wind rating requires customer supplied anchors). Higher Snow Load options available. See options table for pricing.



SPECIALTY BUILDINGS



BARNs

WALL HEIGHT IS 4'
TREATED OR PAINTED ONE COLOR

SIZE	CASH PRICE*	RENT TO OWN (36 MO)
8x8	\$3,625	\$167 ⁸²
8x10	\$4,045	\$187 ²⁷
8x12	\$4,175	\$193 ²⁹
8x16	\$5,275	\$244 ²¹
10x10	\$4,845	\$224 ³¹
10x12	\$5,095	\$235 ⁸⁸
10x14	\$5,775	\$267 ³⁶
10x16	\$5,975	\$276 ⁶²
10x20	\$7,275	\$336 ⁸¹
12x16	\$7,825	\$362 ²⁷

SINGLE SLOPE

FRONT HEIGHT INCREASES WITH WIDTH
TREATED OR PAINTED ONE COLOR

SIZE	CASH PRICE*	RENT TO OWN (36 MO)
8x12	\$4,670	\$216 ²⁰
8x16	\$6,100	\$282 ⁴¹
10x10	\$5,450	\$252 ³¹
10x12	\$5,820	\$269 ⁴⁴
10x14	\$6,650	\$307 ⁸⁷
10x16	\$6,870	\$318 ⁰⁶
10x20	\$8,570	\$396 ⁷⁶
12x16	\$8,700	\$402 ⁷⁸
12x20	\$9,720	\$450 ⁰⁰
12x24	\$11,050	\$511 ⁵⁷
12x28	\$12,670	\$586 ⁵⁷
12x30	\$13,570	\$628 ²⁴
12x32	\$14,250	\$659 ⁷²
12x36	\$15,350	\$710 ⁶⁵
12x40	\$17,070	\$790 ²⁸
14x24	\$14,470	NA
14x28	\$16,170	NA
14x32	\$17,420	NA
14x36	\$20,570	NA
14x40	\$22,120	NA

SIDING OPTIONS

T1-11
PRESSURE
TREATED

NO ADDITIONAL CHARGE

LP SMART
PANEL

NO ADDITIONAL CHARGE

FLOORING OPTIONS

YOU CHOOSE:

5/8" T&G UNTREATED PLYWOOD FLOORING
OR 5/8" T&G ENGINEERED PANELS FLOORING
(SAME PRICE)

5/8" TONGUE & GROOVE
UNTREATED PLYWOOD

5/8" TONGUE & GROOVE
ENGINEERED PANELS

UPGRADE: 3/4" FLOORING (SEE OPTIONS TABLE FOR PRICING)

ANIMAL SHELTERS

WALL HEIGHT IS 8'
TREATED OR PAINTED ONE COLOR

ANIMAL SHELTER FEATURES

- Comes standard with 8ft tall walls.
- Standard one stall per 20 feet of length or less (not counting tack room), unless specifically ordered differently.
- Additional stalls (includes opening and divider) can be added for \$485 per stall (optional).

TACK ROOM

- \$130/foot of length (minimum of 4ft). (Tack Room starts on an outside end wall. Add \$485 to start on an inside divider wall.)
- 3ft Wooden Barn door on all tack rooms. Upgrade to 4ft Wooden Barn door for \$30 (where applicable).

Buildings will be set directly on ground with no blocking. Ground must be suitable for application prior to delivery.

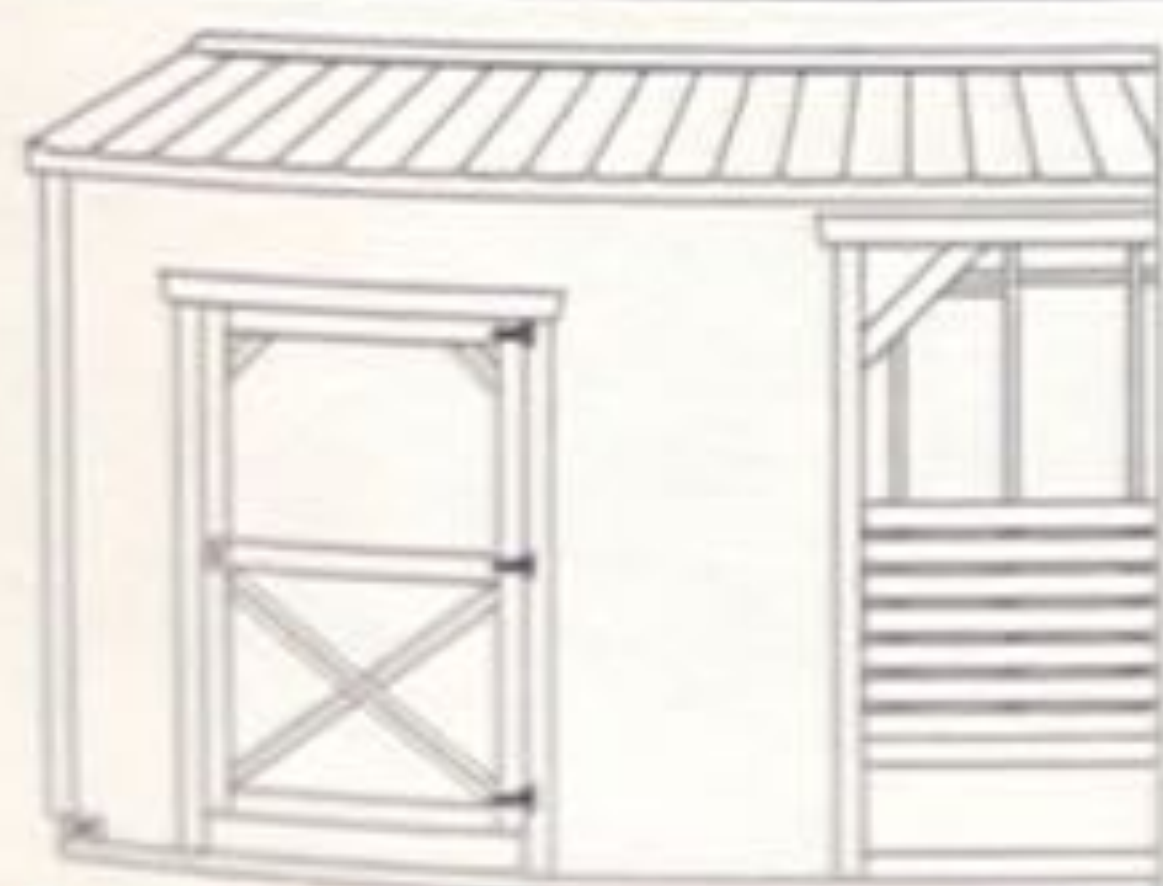

SIZE	CASH PRICE*	RENT TO OWN (36MO)
8x12	\$4,670	NA
8x16	\$6,100	NA
10x10	\$5,450	NA
10x12	\$5,820	NA
10x14	\$6,650	NA
10x16	\$6,870	NA
10x20	\$8,570	NA
12x16	\$8,700	NA
12x20	\$9,720	NA
12x24	\$11,050	NA
12x28	\$12,670	NA
12x30	\$13,570	NA
12x32	\$14,250	NA
12x36	\$15,350	NA
12x40	\$17,070	NA
14x24	\$14,470	NA
14x28	\$16,170	NA
14x32	\$17,420	NA
14x36	\$20,570	NA
14x40	\$22,120	NA
➤16x24	\$17,200	NA
➤16x28	\$19,350	NA
➤16x32	\$20,850	NA
➤16x36	\$24,600	NA
➤16x40	\$26,450	NA

➤16ft wide buildings only available as build on site.

BUILD ON SITE

Build on site requires additional fees paid to the builder.

See local dealer for details.

• 8' walls on a Lofted Barn Build On Site is a 10% upcharge.



OPTIONS & ADD-ONS

WINDOW OPTIONS

W1	24" x 27" LOFT WINDOW (IN LOFT ONLY; DOES NOT FIT ABOVE GARAGES)	\$165
W2S	2'x3' SINGLE PANE WINDOW	\$165
W2D	2'x3' DOUBLE PANE WINDOW	\$275
W3S	3'x3' SINGLE PANE WINDOW	\$195
W3D	3'x3' DOUBLE PANE WINDOW	\$350
W4	SHUTTER TRIM	\$60 PER WINDOW
W5	10" x 35" WINDOW (FITS 4' SINGLE BARN DOOR)	\$125
W6	10" x 29" WINDOW (FITS DOUBLE BARN DOOR)	\$105

DOOR OPTIONS

D1	SINGLE 3' WOODEN BARN DOOR	\$125
D2	SINGLE 3' WOODEN BARN DOOR WITH WINDOW	\$230
D3	SINGLE 4' WOODEN BARN DOOR	\$165
D4	SINGLE 4' WOODEN BARN DOOR WITH WINDOW	\$290
D5	DOUBLE WOODEN BARN DOORS	\$250
D6	DOUBLE WOODEN BARN DOORS WITH WINDOWS	\$455
D7	HOUSE - STYLE DOOR, NO WINDOW (OPENS IN & TO THE RIGHT ONLY)	\$545
D8	HOUSE - STYLE DOOR, 9 LITE WINDOW (OPENS IN & TO THE RIGHT ONLY)	\$685
D9	OPENING LOFT DOOR (LOFTED BARN ONLY)	\$105
D10	9'x7' GARAGE DOOR (WALL MUST BE AT LEAST 12' WIDE x 8' TALL) (12" ON CENTER FLOOR JOISTS INCLUDED)	\$1,210
D11	8'x7' GARAGE DOOR (WALL MUST BE AT LEAST 10' WIDE x 8' TALL) (12" ON CENTER FLOOR JOISTS INCLUDED)	\$1,195

FLOORING OPTIONS

ADDITIONAL SKIDS (EACH)	\$6/ft
3/4" FLOORING (PRICED PER SQUARE FOOT)	\$0.90/sq ft
2x6 FLOOR JOISTS (STANDARD ON 14' & 16' WIDE BUILDINGS)	\$0.60/sq ft
12" ON CENTER FLOOR JOISTS (STANDARD ON GARAGES)	\$0.60/sq ft

PAINT & URETHANE OPTIONS

PAINT (ONE STANDARD COLOR)	FREE
PAINTED BUILDING TRIM (SECOND COLOR / PAINT ONLY)	\$75
EACH ADDITIONAL COLOR (INCLUDES DOORS - PAINT OR URETHANE TRIM ON DOORS & SHUTTERS - PAINT ONLY)	\$75
UPGRADE TO URETHANE OR CUSTOM PAINT COLOR (8' & 10' WIDE BUILDINGS)	ADD \$140
UPGRADE TO URETHANE OR CUSTOM PAINT COLOR (12' & 14' WIDE BUILDINGS)	ADD \$275

OTHER OPTIONS

P1	HOUSE WRAP VAPOR BARRIER (ON WALLS ONLY)	\$1.75/sq ft
P2	TAR PAPER (UNDER ROOFING ONLY, RECOMMENDED FOR SHINGLE ROOFS)	\$1.75/sq ft
H1	7' TALL WALLS (81" INSIDE) (LOFTED & UTILITIES)	\$175
H2	8' TALL WALLS (92" INSIDE) (UTILITIES)	\$175
I1	WORKBENCH (PRICED PER FOOT OF WIDTH)	\$20/ft
I2	SHELVES (3 TIER) (PRICED PER FOOT OF WIDTH)	\$20/ft
I3	LOFT (PRICED PER FOOT OF DEPTH)	\$28/ft
E1	EXTRA PORCH POST	\$55/each
E2	PORCH RAILING	\$20/ft
E3	6" FRONT & BACK ROOF OVERHANG (GABLE END WALLS)	\$345
E4	7/12 PITCH (6' & 7' WALLS ONLY) (UTILITY ONLY) (8', 10' & 12' WIDE ONLY)	\$345
F1	16" ON CENTER TRUSSES (PAINTED ONLY)	\$0.50/sq ft
F2	16" ON CENTER STUDS & TRUSSES (TREATED ONLY)	\$1.10/sq ft
	SPECIAL ORDER METAL ROOF COLOR	\$90
	SNOW LOAD 60 PSF (STANDARD ON LOFTED BARN ONLY)	\$1.50/sq ft
	SNOW LOAD 140 PSF	\$3.50/sq ft

RENT TO OWN

Just a small security deposit equal to one month's rent plus your first month's rent and we'll set up a building at your location.

*Excludes Animal Shelters & Build on Site.

DELIVERY & SETUP

- Free delivery and easy setup within 30 miles.
- Please consult your local dealer for the most up-to-date delivery lead times.
- No site preparation necessary if site is no more than 3 feet out of level.
- Customer has the responsibility to decide if ground conditions are unsuitable for delivery. We are not responsible for yard damage.
- Site must be accessible by truck and trailer.

Free Delivery covers one trip up to 30 miles one way. Trips over 30 miles are subject to additional mileage fees. See dealer for details. Free setup includes leveling the building, starting with one corner at ground level and raising it up to a maximum of 3 feet. If leveling requires 1 foot or less, pressure treated wood may be used. Otherwise, customer may supply concrete blocks which are placed on top of the ground, or we can supply concrete blocks. Customers who require their building to be set on concrete blocks must have them ready PRIOR to delivery OR have a clear agreement with the driver to supply the blocks at a price to be negotiated with the driver.

In very rare cases, underground footers may be required by local building codes. Old Hickory Buildings does not offer digging or footer services and these are not included in free set up, however we can work with customer or contractor when required for an additional cost.

Please contact your local Building Inspector and/or Homeowner's Association for information on requirements and restrictions. The customer will be responsible for the mileage charge as well as the cost of any additional trips.



- *Prices shown include 3% discount offered for purchases made with cash or check. Credit card purchases are not eligible for the discounted price and will be priced 3% higher.
- One color paint/water sealer included in above price. Urethane and additional colors are extra (excluding Build On Site).
- 12ft wide and over buildings are measured across the eaves due to DOT regulations (all others are measured from outside corners).
- **Not available at all locations. See dealer for details.
- All 8ft wide buildings come with a single door (excluding packages).
- All 10ft, 12ft, 14ft & 16ft wide buildings come with double doors (excluding packages).
- Available RTO terms may change by location. See your local dealer for details. The Rent-to-Own transaction is a rental-purchase agreement. You will not own the merchandise until the total amount necessary to acquire ownership is paid in full or you exercise your early purchase option ("EPO").
- Rent to own not applicable on Animal Shelters, 14ft or 16ft wide buildings.
- Add package price to Lofted or Utility Style Buildings only. For package deals, some options may be removed but no credit given on price.

The Pacific Northwest region experiences extended periods of rain and extreme moisture. Customer maintenance on the shed may be required to remove moss, mildew, algae, fungi and the like. Sheds may require additional waterproofing or paint in extremely wet locations. While our water sealer works well in most cases, it cannot be guaranteed in locations with extreme moisture. Old Hickory's warranty therefore excludes water sealer.

Old Hickory Sheds, LLC and its associates are not responsible for permits, snow/wind load requirements, covenant searches, restrictions, setbacks, yard damage, or underground damage. In very rare cases, underground footers may be required by local building codes. Old Hickory Sheds does not offer digging or footer services and these are not included in free set up, however we can work with customer or contractor when required for an additional cost. Please contact your local Building Inspector and/or Homeowner's Association for information on requirements and restrictions. It is the customer's responsibility to decide if ground conditions are unsuitable for delivery. Old Hickory has the right to refuse any sale prior to the time when it is accepted and approved by Old Hickory's corporate office and the building is set up at customer's location.

ALL PRICES SUBJECT TO CHANGE.

3.14.23 (OHS_PG_CA-7245) Old Hickory Sheds, LLC ©Copyright 2023 | All rights reserved.

CA
v006