

## Eco-Duo - 45 Degree Elbow

		<u>SKU</u>	<u>RRP EX VAT</u>
45 Degree Elbow for 15mm	(10 Pack)	<b>W8329 CP</b>	<b>  £67.00</b>
45 Degree Elbow for 22mm	(10 Pack)	<b>W8330 CP</b>	<b>  £91.90</b>
45 Degree Elbow for 28mm	(10 Pack)	<b>W8331 CP</b>	<b>  £276.60</b>
45 Degree Elbow for 35mm	(10 Pack)	<b>W8332 CP</b>	<b>  £394.30</b>
45 Degree Elbow for 42mm	(10 Pack)	<b>W8333 CP</b>	<b>  £656.10</b>
45 Degree Elbow for 54mm	(Single)	<b>W1560 CP</b>	<b>  £93.30</b>
45 Degree Elbow for 66.7mm	(Single)	<b>W1561 CP</b>	<b>  £217.40</b>
45 Degree Elbow for 76.1mm	(Single)	<b>W1562 CP</b>	<b>  £269.36</b>
45 Degree Elbow for 108mm	(Single)	<b>W1654 CP</b>	<b>  £620.45</b>



## Weight KG / Fitting - Single

45 Degree Elbow for 15mm	- <b>0.27 KG</b>
45 Degree Elbow for 22mm	- <b>0.29 KG</b>
45 Degree Elbow for 28mm	- <b>0.32 KG</b>
45 Degree Elbow for 35mm	- <b>0.58 KG</b>
45 Degree Elbow for 42mm	- <b>0.66 KG</b>
45 Degree Elbow for 54mm	- <b>1.30 KG</b>
45 Degree Elbow for 66.7mm	- <b>1.47 KG</b>
45 Degree Elbow for 76.1mm	- <b>1.50 KG</b>
45 Degree Elbow for 108mm	- <b>2.75 KG</b>

## Details

### Finishing Options:

Copper CP

### Max Pressure:

16 Bar

### Designer:

Maxwell Bridges

### Material Type:

Main Body: Copper

Separators: 316 Stainless Steel

## Features and Benefits

- Patented Pipe-in-a-pipe technology
- Saves 50% energy costs (tested by BRE)
- Maintains temperatures across the whole building.
- Halves installation time and costs
- 50% reduction in pipe fixings and insulation
- No special installation required
- Pipework can be cut as normal
- Helps to reduce the risk of Legionella and other water borne pathogens
- Can be used on hot and cold potable water systems

## Notes:

- Only for use with potable water (not closed heating systems)
- Only for use with pumped recirculated water

SKU	Description	l1	d1	D1	es1	z1	l2	l3	d2	D2	es2	z2	DN1	DN2
W1525 CP	15mm	28	15	23	20	8	28	33	15	23	20	8	DN12	DN12
W1526 CP	22mm	31	22	31	19	12	31	36	22	31	19	12	DN20	DN20
W1527 CP	28mm	37	28	37	21	16	37	42	28	37	21	16	DN25	DN25
W1528 CP	35mm	44	35	44	26	18	44	49	35	44	26	18	DN32	DN32
W1529 CP	42mm	51	42	53	30	21	51	56	42	53	30	21	DN40	DN40
W1530 CP	54mm	62	54	65	35	27	62	67	54	65	35	27	DN50	DN50
W1531 CP	66.7mm	85	67	83	50	35	85	90	67	83	50	35	DN65	DN65
W1532 CP	76.1mm	91	76	94	46	45	91	96	76	94	46	45	DN65	DN65
W1654 CP	108mm	125	108	132	66	59	125	130	108	132	66	59	DN100	DN100

SKU'S shown above pertain to the respective fittings single units SKU

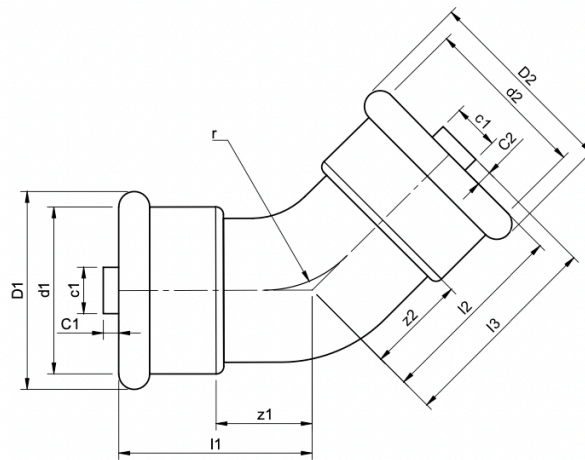

## Water Kinetics Eco-Duo Guarantee - Terms and Conditions

Products are subject to a guarantee that is between Water Kinetics, registered at Lomond House 7 Greenbank Road, Darvel, East Ayrshire, United Kingdom, KA17 0NN, Company No: SC632550, VAT: GB 350 116 837, and the final purchaser of the product.

When correctly assembled with the stated tubes and pipe the length of guarantee is as follows:

### **25 Years**

The Eco-Duo Copper and Stainless ranges are guaranteed for a period of 25 years commencing on the date of purchase when installed in conjunction with Eco-Duo fittings and components.

The guarantee is subject to proof of purchase being supplied.

This guarantee does not affect any statutory rights the purchaser may have in law.

The guarantee covers manufacturing or material defects when installed in accordance with our instructions on specified tube materials and applications and does not cover instances of normal wear and tear).

This product range has been designed for the use of domestic and commercial applications and therefore the guarantee is subject to the product being properly selected for their intended service conditions.

The guarantee is not applicable where the product is fitted contrary to the conditions contained within the fitting instructions.

Provided Eco-Duo is installed correctly and receives adequate preventative maintenance it should give years of trouble-free service.

Abusive behaviour, and accidental damage to the product are not covered by this guarantee.

The extent of any liability from this guarantee is limited to the cost of the replacement of the defective item and not to installation or consequential damages.

### **Eco-Duo is a trademark of Water Kinetics Ltd**

Water Kinetics Ltd makes every effort to ensure that the information provided on its website is accurate. However, we cannot guarantee this, and accept no liability for any information or advice given via its website.

