



Contact us: 0141 280 9585
Website: www.water-kinetics.co.uk
Email: info@water-kinetics.co.uk



Contents

03

Who Are We?

06

Why Should You Specify
Eco-Duo?

10

Features & Benefits

13

BRE Study

05

The Story Behind Eco-Duo

08

Sustainability

11

University Study

14

Technical Information

Who Are We?

Who?

Water Kinetics is a new and exciting innovative company that has been built on the many years of experience of one of its Founding Directors Maxwell Bridges and its Managing Director Jonathan Waggott. **Water Kinetics is a UK company** with the manufacturing and offices being based in Scotland. Water Kinetics specialises in bringing **innovative change** to the plumbing world by applying the research and benefits of science to the all important element of water.

What?

Water Kinetics aims to be the **world leader** in providing hygienic, safe, low energy hot and cold water within buildings of all types so that users are kept safe whilst delivering cost savings and substantial **risk reduction** from water-borne pathogens such as Legionella for building owners/operators.

How?

Water Kinetics' patented first product, **Eco-Duo is the world's first** single pipe recirculation system that can provide potable water in a safe way whilst delivering up to a 50% **cost reduction** in energy charges.

Water Kinetics works with leading industry experts, professionals and suppliers. Its products are available nationwide through leading builders merchants, so on-going supply is never an issue.



The Story Behind Eco-Duo

Water Kinetics are very proud to be part of the amazing story of how the new Eco-Duo system was invented. Maxwell Bridges, one of its founding Directors has always been someone to think about how things can be improved, and how solutions to problems can be found. Maxwell is also a great lover of nature documentaries, and it was whilst watching such a documentary on how penguins in the Antarctic keep warm and prevent their feet from sticking to the ice that a moment of inventive inspiration came upon him.

Penguins have an ingenious system working within their feet which creates a counter current heat exchange from the blood traveling to their feet which then warms their blood up as it travels back to their heart.

Maxwell thought that if it can work for blood vessels, then it could work for pipework systems. After much trial and error and testing and thought, the world's first single pipe recirculation system was born.

Nature has so much to teach us, and Water Kinetics is sure that there will be many more inventions and innovative products still to be created from its inspiration.

This is why the Company brand and logo features the beautiful outline of a penguin.

Why Should You Specify Eco-Duo?

Water Kinetics' Eco-Duo system is truly a game changer in the world of potable water plumbing technology. Not only does the system save **50% of energy costs**, but it also **halves all the pipework fittings, insulation and the time and costs of installation.**

As it is a one pipe system, it is simpler and easier to install and any requirement to cut the piping once it is installed is done using the traditional methods employed by plumbers.

Unlike most systems, Eco-Duo brings the circulating water right up to the point of use, **completely eliminating the possibility of dead legs in the system**, resolving one of the main causes of water-borne pathogens within potable water systems today. This benefit, added to the stability of temperature goes a long way in the fight against water-borne pathogens including Legionella.



Sustainability

As a company, Water Kinetics recognises its responsibility to take care of the environment. To demonstrate, Water Kinetics only sources their copper from companies who utilise a high degree of **recyclable material** within the metals they supply.

One of the greatest features of the Eco-Duo system is the energy saving achieved through its usage. It also requires half the **pipework fittings**, half the **insulation**, and half the **delivery costs** and therefore **reduces the impact on the environment** significantly in comparison to traditional copper pipe systems.

The copper, brass and stainless steel Water Kinetics use can be **100% recycled**, and all packaging that is used within the Water Kinetics factory for Eco-Duo is made from **recycled materials** and where possible all energy used within the premises comes from carbon neutral suppliers.

“Water Kinetics saves a high degree of energy whilst keeping temperatures constant to keep water safe”

Dr. Paul McDermott - World Infection Control Practitioner and Microbiologist



Features & Benefits

Water Kinetics has discovered, from looking at conventional water recirculation systems, that they simply aren't able to control their temperature well. This leads to poor temperature control and areas of static water. However, the unique Water Kinetics Eco-Duo system is able to help water maintain its temperature across the entire length of the pipeline, saving half the energy required for a typical recirculation system.

With Eco-Duo's unique pipe-within-a-pipe system, installation times will also be halved, component costs and pipe work fixings will be halved AND duct space is halved!

Eco-Duo is the only system to provide high efficiency throughout, keeping cold water cold and hot water hot, circulating right up to the outlet to eliminate the threat of dead legs. Even if the system is interrupted by a closed isolation valve, water never stops flowing.

Yet another added benefit of Eco-Duo is that since the water is virtually the same temperature at the outlet as it is at the heating source, it can also help prevent the need for time consuming, costly and energy wasting practices like thermal flushing.

In addition to all this, Eco-Duo has been proven to reduce the risk of waterborne pathogens like Legionella and Pseudomonas aeruginosa, keeping not only hot water hot, but cold water cold and also keeping the people who visit and use the building safe.

Another unique aspect of the system is the Continuous Isolation Valve. This allows water to keep circulating around the system even when the water supply needs to be isolated.

Water Kinetics' unique Confluence T fitting allows Eco-Duo to be fitted to all types of heating or cooling devices and does not require any specialised taps or showers, but fits to current configurations.



University Study

UK Leading University Prototype

As part of the development process, a four storey installation of Water Kinetics' Eco-Duo was installed in 2017 into a large UK University to monitor the **energy saving potential** of the pipework system. It was this test that began to really identify the extent to which Eco-Duo saves energy. The energy consumption reduced by 50% and because there was virtually no reduction in temperature

from the heater to the outlet, a previously persistent problem with Legionella within the pipework system was completely eradicated, and has never returned since.

This prototype is still installed within the University and is **continuing to bring the university significant cost savings and safety benefits.**





BRE Study

Details of the Testing

Water Kinetics have undertaken a comprehensive study with BRE in Watford during 2019. The study focused on a comparison of a traditional potable water re-circulation system versus the Water Kinetics Eco-Duo system.

The type of pipework, fittings, pump, insulation and heater used was identical for the two tests. The results proved to be very conclusive and mirrored the on-going testing at Bristol University. It showed that Eco-Duo does in fact **save up to 50% of ongoing energy costs**. It also demonstrated how effective the system is in keeping hot water hot with an **outgoing water temperature of 61 degrees and a return temperature of 60 degrees**.

If you would like more information on this study and the energy savings then please **contact us** and we can arrange for one of our representatives to contact you and present the results in more detail.

bre

Technical Information

Water Kinetics want to make specifying Eco-Duo as simple as possible, and so have uploaded a wealth of information to their website, such as:

Installation Instructions

In order to ensure installation is as easy as possible, Water Kinetics have full installation instructions available, allowing viewers to understand how the pipework fittings connect with one another, along with QR codes on all packaging that will take plumbers to how-to videos.

BIM Files

In a world that is growing ever more technologically advanced, Water Kinetics makes sure to keep with the times, and so, Building Information Modelling (BIM) files are available upon request.

National Building Specifications (NBS) Clauses

NBS clauses are available on the Water Kinetics website for all Eco-Duo products, allowing specifiers to copy and paste the information into specifications, streamlining the process.

Data Sheets

Data Sheets are also viewable, giving a full overview of Eco-Duo products, elaborating on the dimensions available for each pipe fitting, along with features and benefits.

Flow and Pressure Charts

Flow and Pressure Charts that enable prospective specifiers the chance to measure up Eco-Duo and compare and contrast with traditional plumbing systems.

Continuing Professional Development (CPD) Courses

Water Kinetics also offers a CPD course, which covers the challenges that are faced in order to keep plumbing systems safe. The course is titled “Controlling Water-Borne Pathogens in Hot and Cold Water Systems.”

Now, more than ever it is imperative for architects, engineers, and more to understand the importance of being able to keep plumbing systems pathogen-free.

The course will help give insight in:

- The challenge of keeping systems safe
- Common problems and issues that systems face
- Current guidance and how it aids in managing systems correctly
- System design and how to improve upon it moving forward

WRAS and Kiwa Certification

Eco-Duo is also WRAS and Kiwa certified - ensuring that Eco-Duo conforms to the Water Supply regulations and is fit for use with UK plumbing systems. Full details of both certifications are available on the Water Kinetics site.



Associations

Made in Britain

Water Kinetics is also a proud member of Made In Britain, given that Eco-Duo is 100% manufactured in Great Britain, in order to deliver a reliable, dependable and local product.



Royal Society for Public Health (RSPH)

Water Kinetics is also a member of the Royal Society for Public Health (RSPH). The aims of the RSPH also align with those of Water Kinetics. The company wishes to create healthier environments, improve and also protect the public's health, which is made possible with Eco-Duo's ability to drastically reduce levels of water-born pathogens including Legionella.



Eco-Duo - 45 Degree Elbow

45 Degree Elbow

Eco-Duo 45 degree elbow for 15mm	W1525 CP
Eco-Duo 45 degree elbow for 22mm	W1526 CP
Eco-Duo 45 degree elbow for 28mm	W1527 CP
Eco-Duo 45 degree elbow for 35mm	W1528 CP
Eco-Duo 45 degree elbow for 42mm	W1529 CP
Eco-Duo 45 degree elbow for 54mm	W1530 CP
Eco-Duo 45 degree elbow for 66.7mm	W1531 CP
Eco-Duo 45 degree elbow for 76.1mm	W1532 CP
Eco-Duo 45 degree elbow for 108mm	W1654 CP



Finishing Options:

Copper CP

Material Type

Main Body: COPPER
Separators: 316 STAINLESS STEEL

Weight

Eco-Duo 45 degree elbow for 15mm	- 0.27 KG
Eco-Duo 45 degree elbow for 22mm	- 0.29 KG
Eco-Duo 45 degree elbow for 28mm	- 0.32 KG
Eco-Duo 45 degree elbow for 35mm	- 0.58 KG
Eco-Duo 45 degree elbow for 42mm	- 0.66 KG
Eco-Duo 45 degree elbow for 54mm	- 1.30 KG
Eco-Duo 45 degree elbow for 66.7mm	- 1.47 KG
Eco-Duo 45 degree elbow for 76.1mm	- 1.50 KG
Eco-Duo 45 degree elbow for 108mm	- 2.75 KG

Max Pressure Details

16 Bar

Designer : Maxwell Bridges

Features and Benefits

- Patented Pipe-in-a-pipe technology
- Saves 50% energy costs (tested by BRE)
- Maintains temperatures across the whole building.
- Halves installation time and costs
- 50% reduction in pipe fixings and insulation
- No special installation required
- Pipework can be cut as normal
- Helps to reduce the risk of Legionella and other water borne pathogens
- Can be used on hot and cold potable water systems

Notes:

- Only for use with potable water (not closed heating systems)
- Only for use with pumped recirculated water

Dimensions

SKU	Description	I1	d1	D1	rs1	r1	I2	I3	d2	D2	rs2	r2	DN1	DN2
W1525 CP	15mm	28	13	23	20	8	28	33	15	23	20	8	DN12	DN12
W1526 CP	22mm	31	22	31	19	12	31	36	22	31	19	12	DN20	DN20
W1527 CP	28mm	37	28	37	21	16	37	42	28	37	21	16	DN25	DN25
W1528 CP	35mm	44	35	44	26	18	44	49	35	44	26	18	DN32	DN32
W1529 CP	42mm	51	42	53	30	21	51	56	42	53	30	21	DN40	DN40
W1530 CP	54mm	62	54	65	35	27	62	67	54	65	35	27	DN50	DN50
W1531 CP	66.7mm	85	67	83	50	35	85	90	67	83	50	35	DN65	DN65
W1532 CP	76.1mm	91	76	94	46	45	91	96	76	94	46	45	DN85	DN85
W1654 CP	108mm	125	108	132	66	59	125	130	108	132	66	59	DN100	DN100

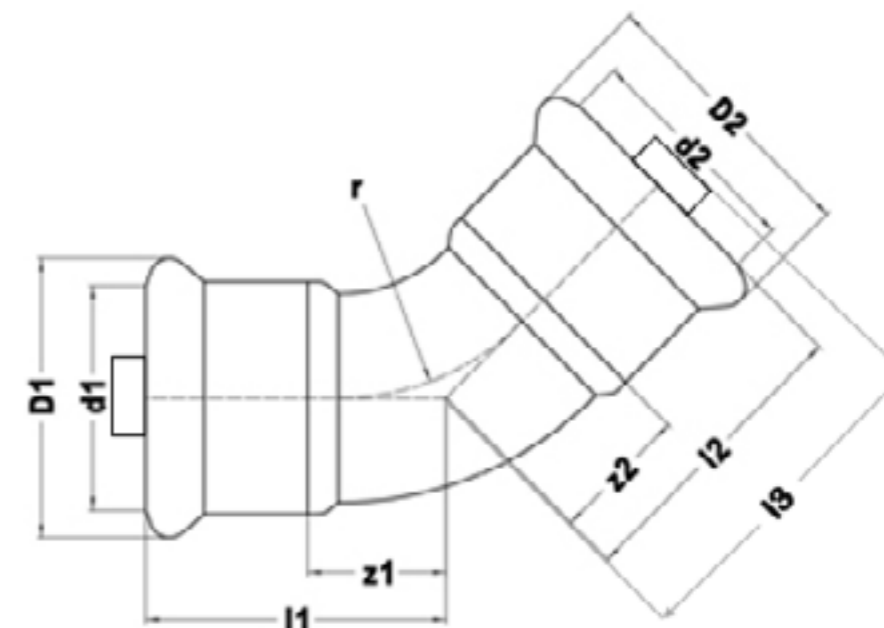

Eco-Duo - 45 Degree Street Elbow

45 Degree Street Elbow

Eco-Duo 45 degree street elbow for 15mm	W1533 CP
Eco-Duo 45 degree street elbow for 22mm	W1534 CP
Eco-Duo 45 degree street elbow for 28mm	W1535 CP
Eco-Duo 45 degree street elbow for 35mm	W1536 CP
Eco-Duo 45 degree street elbow for 42mm	W1537 CP
Eco-Duo 45 degree street elbow for 54mm	W1538 CP
Eco-Duo 45 degree street elbow for 66.7mm	W1539 CP
Eco-Duo 45 degree street elbow for 76.1mm	W1540 CP
Eco-Duo 45 degree street elbow for 108mm	W1655 CP



Finishing Options:

Copper CP

Material Type

Main Body: COPPER
Separators: 316 STAINLESS STEEL

Weight

Eco-Duo 45 degree street elbow for 15mm	- 0.34 KG
Eco-Duo 45 degree street elbow for 22mm	- 0.37 KG
Eco-Duo 45 degree street elbow for 28mm	- 0.40 KG
Eco-Duo 45 degree street elbow for 35mm	- 0.59 KG
Eco-Duo 45 degree street elbow for 42mm	- 0.66 KG
Eco-Duo 45 degree street elbow for 54mm	- 0.96 KG
Eco-Duo 45 degree street elbow for 66.7mm	- 1.39 KG
Eco-Duo 45 degree street elbow for 76.1mm	- 1.65 KG
Eco-Duo 45 degree street elbow for 108mm	- 2.37 KG

Max Pressure Details

16 Bar

Designer : Maxwell Bridges

Features and Benefits

- Patented Pipe-in-a-pipe technology
- Saves 50% energy costs (tested by BRE)
- Maintains temperatures across the whole building.
- Halves installation time and costs
- 50% reduction in pipe fixings and insulation
- No special installation required
- Pipework can be cut as normal
- Helps to reduce the risk of Legionella and other water borne pathogens
- Can be used on hot and cold potable water systems

Notes:

- Only for use with potable water (not closed heating systems)
- Only for use with pumped recirculated water

Dimensions

SKU	Description	l1	d1	D1	es1	z1	l2	D	d2	es2	z2	DN1	DN2
W1533 CP	15mm	28	15	23	20	8	37	43	15	20	17	DN12	DN12
W1534 CP	22mm	32	22	31	21	11	44	49	22	21	23	DN20	DN20
W1535 CP	28mm	37	28	37	23	14	47	52	28	23	24	DN25	DN25
W1536 CP	35mm	43	35	44	26	17	58	63	35	26	32	DN32	DN32
W1537 CP	42mm	51	42	53	30	21	71	76	42	30	41	DN40	DN40
W1538 CP	54mm	62	54	65	35	27	82	87	54	35	47	DN50	DN50
W1539 CP	66.7mm	85	67	83	50	35	98	93	67	50	58	DN65	DN65
W1540 CP	76.1mm	90	76	84	52	40	97	102	76	43	54	DN65	DN65
W1655 CP	108mm	115	108	133	67	48	138	141	108	67	69	-	-

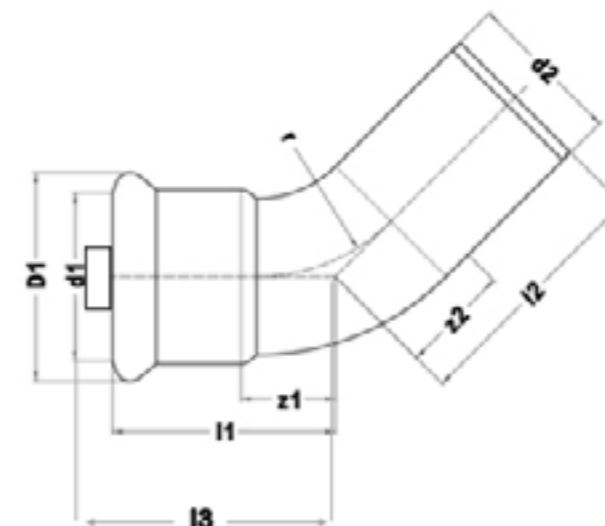

Eco-Duo - 90 Degree Elbow

90 Degree Elbow

Eco-Duo 90 degree elbow for 15mm	W1509 CP
Eco-Duo 90 degree elbow for 22mm	W1510 CP
Eco-Duo 90 degree elbow for 28mm	W1511 CP
Eco-Duo 90 degree elbow for 35mm	W1512 CP
Eco-Duo 90 degree elbow for 42mm	W1513 CP
Eco-Duo 90 degree elbow for 54mm	W1514 CP
Eco-Duo 90 degree elbow for 66.7mm	W1515 CP
Eco-Duo 90 degree elbow for 76.1mm	W1516 CP
Eco-Duo 90 degree elbow for 108mm	W1650 CP



Dimensions

SKU	Description	z1	d1	D1	ee1	z1	z2	z3	d2	D2	ee2	z2	DN1	DN2
W1509 CP	15mm	38	15	23	21	17	38	43	15	23	21	17	DN15	DN15
W1510 CP	22mm	47	22	31	21	28	47	52	22	31	21	28	DN22	DN22
W1511 CP	28mm	58	28	37	22	34	58	61	28	37	22	34	DN28	DN28
W1512 CP	35mm	68	35	44	26	42	68	73	35	44	26	42	DN35	DN35
W1513 CP	42mm	80	42	53	30	50	80	85	42	53	30	50	DN42	DN42
W1514 CP	54mm	100	54	65	35	60	100	105	54	65	35	60	DN54	DN54
W1515 CP	66.7mm	132	67	83	45	87	132	137	67	83	45	87	DN66.7	DN66.7
W1516 CP	76.1mm	142	76	94	50	92	142	147	76	94	50	92	DN76.1	DN76.1
W1650 CP	108mm	201	108	132	60	135	201	206	108	132	60	135	DN108	DN108

Finishing Options:

Copper CP

Material Type

Main Body: COPPER
Separators: STAINLESS STEEL

Weight

Eco-Duo 90 degree elbow for 15mm	- 0.27 KG
Eco-Duo 90 degree elbow for 22mm	- 0.35 KG
Eco-Duo 90 degree elbow for 28mm	- 0.38 KG
Eco-Duo 90 degree elbow for 35mm	- 0.62 KG
Eco-Duo 90 degree elbow for 42mm	- 0.70 KG
Eco-Duo 90 degree elbow for 54mm	- 1.03 KG
Eco-Duo 90 degree elbow for 66.7mm	- 1.48 KG
Eco-Duo 90 degree elbow for 76.1mm	- 1.76 KG
Eco-Duo 90 degree elbow for 108mm	- 3.11 KG

Features and Benefits

- Patented Pipe-in-a-pipe technology
- Saves 50% energy costs (tested by BRE)
- Maintains temperatures across the whole building.
- Halves installation time and costs
- 50% reduction in pipe fixings and insulation
- No special installation required
- Pipework can be cut as normal
- Helps to reduce the risk of Legionella and other water borne pathogens
- Can be used on hot and cold potable water systems

Notes:

- Only for use with potable water (not closed heating systems)
- Only for use with pumped recirculated water

Max Pressure Details

16 Bar

Designer : Maxwell Bridges

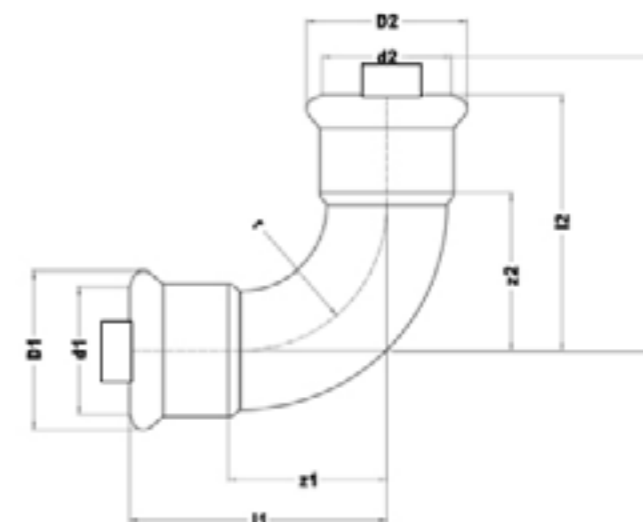

Eco-Duo - 90 Degree Street Elbow

90 Degree Street Elbow

- Eco-Duo 90 degree street elbow for 15mm W1517 CP
- Eco-Duo 90 degree street elbow for 22mm W1518 CP
- Eco-Duo 90 degree street elbow for 28mm W1519 CP
- Eco-Duo 90 degree street elbow for 35mm W1520 CP
- Eco-Duo 90 degree street elbow for 42mm W1521 CP
- Eco-Duo 90 degree street elbow for 54mm W1522 CP
- Eco-Duo 90 degree street elbow for 66.7mm W1523 CP
- Eco-Duo 90 degree street elbow for 76.1mm W1524 CP
- Eco-Duo 90 degree street elbow for 108mm W1653 CP

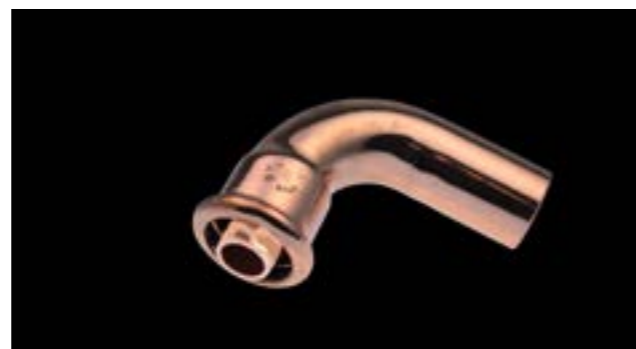

Finishing Options:

Copper CP

Material Type

Main Body: COPPER
Separators: 316 STAINLESS STEEL

Weight

- Eco-Duo 90 degree street elbow for 15mm - 0.28 KG
- Eco-Duo 90 degree street elbow for 22mm - 0.31 KG
- Eco-Duo 90 degree street elbow for 28mm - 0.35 KG
- Eco-Duo 90 degree street elbow for 35mm - 0.64 KG
- Eco-Duo 90 degree street elbow for 42mm - 0.72 KG
- Eco-Duo 90 degree street elbow for 54mm - 1.05 KG
- Eco-Duo 90 degree street elbow for 66.7mm - 1.45 KG
- Eco-Duo 90 degree street elbow for 76.1mm - 1.77 KG
- Eco-Duo 90 degree street elbow for 108mm - 2.92 KG

Max Pressure Details

16 Bar

Designer : Maxwell Bridges

Features and Benefits

- Patented Pipe-in-a-pipe technology
- Saves 50% energy costs (tested by BRE)
- Maintains temperatures across the whole building.
- Halves installation time and costs
- 50% reduction in pipe fixings and insulation
- No special installation required
- Pipework can be cut as normal
- Helps to reduce the risk of Legionella and other water borne pathogens
- Can be used on hot and cold potable water systems

Notes:

- Only for use with potable water (not closed heating systems)
- Only for use with pumped recirculated water

Dimensions

SKU	Description	H	d1	D1	es1	z1	I2	I3	d2	D2	es2	z2	DN1	DN2
W1517 CP	15mm	38	15	23	20	16	50	55	15	50	-	30	DN15	DN15
W1518 CP	22mm	47	22	31	27	21	58	63	22	58	-	37	DN20	DN20
W1519 CP	28mm	58	28	37	34	26	64	69	28	-	64	41	DN25	DN25
W1520 CP	35mm	69	35	44	41	31	72	77	35	72	-	58	DN30	DN30
W1521 CP	42mm	81	42	51	48	37	80	85	42	-	80	71	DN35	DN35
W1522 CP	54mm	100	54	63	60	46	100	105	54	100	-	85	DN40	DN40
W1523 CP	66.7mm	130	67	76	73	61	130	135	67	-	100	120	-	-
W1524 CP	76.1mm	143	76	84	81	67	150	155	76	150	-	101	DN45	DN45
W1653 CP	108mm	197	108	117	114	93	208	213	108	-	144	144	-	-

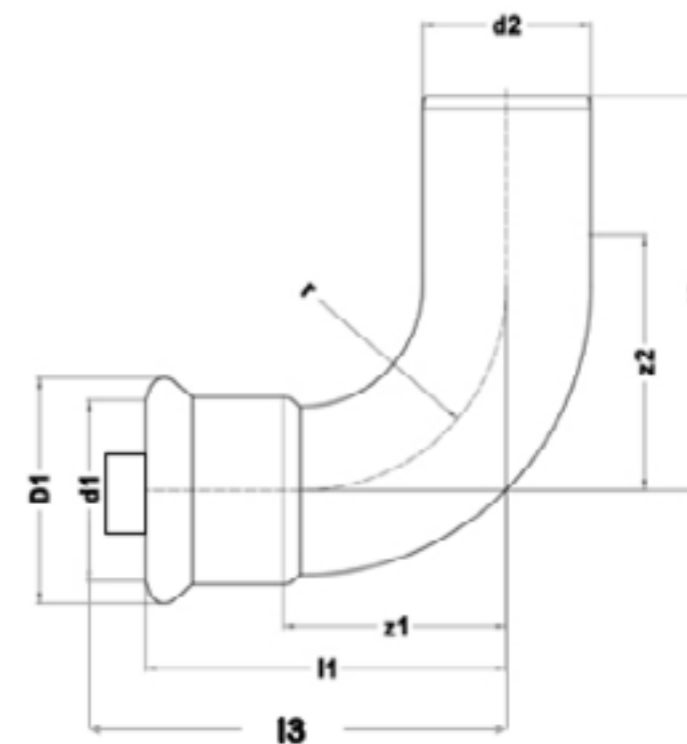

Eco-Duo - Copper Press Slip Coupler

Copper Press Slip Coupler

Eco-Duo Copper Press Slip Coupler 15mm	W1584 CP
Eco-Duo Copper Press Slip Coupler 22mm	W1585 CP
Eco-Duo Copper Press Slip Coupler 28mm	W1586 CP
Eco-Duo Copper Press Slip Coupler 35mm	W1587 CP
Eco-Duo Copper Press Slip Coupler 42mm	W1588 CP
Eco-Duo Copper Press Slip Coupler 54mm	W1589 CP
Eco-Duo Copper Press Slip Coupler 66.7mm	W1590 CP
Eco-Duo Copper Press Slip Coupler 76.1mm	W1591 CP
Eco-Duo Copper Press Slip Coupler 108mm	W1659 CP



Finishing Options:

Copper CP

Material Type

Main Body: COPPER
Separators: 316 STAINLESS STEEL

Weight

Eco-Duo Copper Press Slip Coupler 15mm	- 0.05 KG
Eco-Duo Copper Press Slip Coupler 22mm	- 0.08 KG
Eco-Duo Copper Press Slip Coupler 28mm	- 0.11 KG
Eco-Duo Copper Press Slip Coupler 35mm	- 0.15 KG
Eco-Duo Copper Press Slip Coupler 42mm	- 0.22 KG
Eco-Duo Copper Press Slip Coupler 54mm	- 0.32 KG
Eco-Duo Copper Press Slip Coupler 66.7mm	- 0.44 KG
Eco-Duo Copper Press Slip Coupler 76.1mm	- 0.59 KG
Eco-Duo Copper Press Slip Coupler 108mm	- 1.12 KG

Max Pressure Details

16 Bar

Designer : Maxwell Bridges

Features and Benefits

- Patented Pipe-in-a-pipe technology
- Saves 50% energy costs (tested by BRE)
- Maintains temperatures across the whole building.
- Halves installation time and costs
- 50% reduction in pipe fixings and insulation
- No special installation required
- Pipework can be cut as normal
- Helps to reduce the risk of Legionella and other water borne pathogens
- Can be used on hot and cold potable water systems

Notes:

- Only for use with potable water (not closed heating systems)
- Only for use with pumped recirculated water

Dimensions

SKU	Description	l1	d1	D1	es1	z1	l2	d2	D2	es2	z2	DN1	DN2
W1584 CP	15mm	40	15	23	20	20	40	15	23	20	20	DN12	DN12
W1585 CP	22mm	42	22	31	21	21	42	22	31	21	21	DN20	DN20
W1586 CP	28mm	46	28	37	23	23	46	28	37	23	23	DN25	DN25
W1587 CP	35mm	50	35	44	25	25	50	35	44	25	25	DN32	DN32
W1588 CP	42mm	60	42	53	30	30	60	42	53	30	30	DN40	DN40
W1589 CP	54mm	71	54	65	36	35	71	54	65	36	35	DN50	DN50
W1590 CP	66.7mm	85	67	83	50	5	85	67	83	50	5	DN65	DN65
W1591 CP	76.1mm	95	67	83	50	5	95	67	83	50	5	DN65	DN65
W1659 CP	108mm	72	108	132	68	5	72	108	132	68	5	DN100	DN100



Eco-Duo - Coupler Street Reducer Data Sheet 1

Coupler Street Reducer

Eco-Duo Coupler Street Reducer 28mm x 15mm	W1551 CP
Eco-Duo Coupler Street Reducer 35mm x 22mm	W1552 CP
Eco-Duo Coupler Street Reducer 35mm x 28mm	W1553 CP
Eco-Duo Coupler Street Reducer 42mm x 22mm	W1554 CP
Eco-Duo Coupler Street Reducer 42mm x 28mm	W1555 CP
Eco-Duo Coupler Street Reducer 42mm x 35mm	W1556 CP
Eco-Duo Coupler Street Reducer 54mm x 35mm	W1557 CP
Eco-Duo Coupler Street Reducer 54mm x 42mm	W1558 CP

(See Data Sheet 2 and 3 for larger sizes)



Finishing Options:
Copper CP

Material Type

Main Body: COPPER
Separators: 316 STAINLESS STEEL

Weight

Eco-Duo Coupler Street Reducer 28mm x 15mm	- 0.05 KG
Eco-Duo Coupler Street Reducer 35mm x 22mm	- 0.07 KG
Eco-Duo Coupler Street Reducer 35mm x 28mm	- 0.09 KG
Eco-Duo Coupler Street Reducer 42mm x 22mm	- 0.11 KG
Eco-Duo Coupler Street Reducer 42mm x 28mm	- 0.12 KG
Eco-Duo Coupler Street Reducer 42mm x 35mm	- 0.12 KG
Eco-Duo Coupler Street Reducer 54mm x 35mm	- 0.16 KG
Eco-Duo Coupler Street Reducer 54mm x 42mm	- 0.19 KG

Max Pressure Details

16 Bar

Designer : Maxwell Bridges

Features and Benefits

- Patented Pipe-in-a-pipe technology
- Saves 50% energy costs (tested by BRE)
- Maintains temperatures across the whole building.
- Halves installation time and costs
- 50% reduction in pipe fixings and insulation
- No special installation required
- Pipework can be cut as normal
- Helps to reduce the risk of Legionella and other water borne pathogens
- Can be used on hot and cold potable water systems

Notes:

- Only for use with potable water (not closed heating systems)
- Only for use with pumped recirculated water

Dimensions

SKU	Description	I1	d1	D1	z1	I2	d2	D2	z2	DN1	DN2
W1551 CP	28 x 15mm	25	15	23	20	4	37	28	-	23	14
W1552 CP	35 x 22mm	29	22	31	21	5	39	35	-	26	13
W1553 CP	35 x 28mm	28	28	37	23	5	35	35	-	26	8
W1554 CP	42 x 22mm	25	22	31	21	4	49	42	-	30	19
W1555 CP	42 x 28mm	27	28	37	23	4	44	42	-	30	14
W1556 CP	42 x 35mm	35	35	44	26	8	38	42	-	30	8
W1557 CP	54 x 35mm	35	35	44	26	9	53	54	-	35	18
W1558 CP	54 x 42mm	40	42	53	30	9	47	54	-	35	12

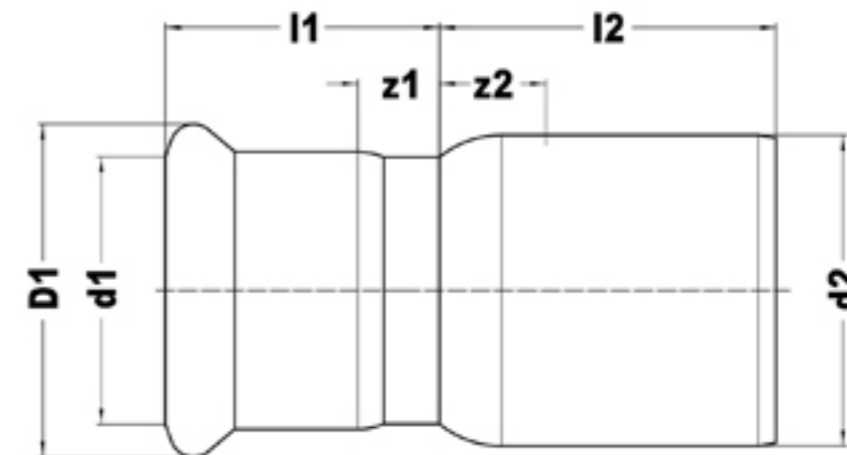



Eco-Duo - Coupler Street Reducer Data Sheet 2

Coupler Street Reducer

- Eco-Duo Coupler Street Reducer 66.7mm x 28mm W1559 CP
 - Eco-Duo Coupler Street Reducer 66.7mm x 35mm W1560 CP
 - Eco-Duo Coupler Street Reducer 66.7mm x 42mm W1561CP
 - Eco-Duo Coupler Street Reducer 66.7mm x 54mm W1562 CP
 - Eco-Duo Coupler Street Reducer 76.1mm x 35mm W1563 CP
 - Eco-Duo Coupler Street Reducer 76.1mm x 42mm W1564 CP
 - Eco-Duo Coupler Street Reducer 76.1mm x 54mm W1565 CP
 - Eco-Duo Coupler Street Reducer 76.1mm x 66.7mm W1566 CP
- (See Data Sheet 1 for smaller sizes or Data sheet 3 for larger sizes)



Dimensions

SKU	Description	l1	d1	D1	ee1	z1	l2	d2	D2	ee2	z2	DN1	DN2
W1559 CP	66.7 x 28mm	37	28	37	23	14	72	67	-	50	22	DN25	DN65
W1560 CP	66.7 x 35mm	40	35	44	26	14	69	67	-	50	19	DN32	DN65
W1561 CP	66.7 x 42mm	37	42	53	30	7	75	67	-	50	25	DN40	DN65
W1562 CP	66.7 x 54mm	39	54	65	35	4	64	67	-	55	13	DN50	DN65
W1563 CP	76.1 x 35mm	39	35	44	26	13	74	76	-	50	24	DN32	DN65
W1564 CP	76.1 x 42mm	43	42	53	30	13	70	76	-	50	20	DN40	DN65
W1565 CP	76.1 x 54mm	42	54	65	35	7	75	76	-	50	15	DN50	DN65
W1566 CP	76.1 x 66.7mm	57	67	63	50	7	65	76	-	50	15	DN65	DN65

Finishing Options:

Copper CP

Material Type

Main Body : COPPER
Separators: 316 STAINLESS STEEL

Weight

- Eco-Duo Coupler Street Reducer 66.7mm x 28mm - 0.97 KG
- Eco-Duo Coupler Street Reducer 66.7mm x 35mm - 0.97 KG
- Eco-Duo Coupler Street Reducer 66.7mm x 42mm - 0.97 KG
- Eco-Duo Coupler Street Reducer 66.7mm x 54mm- 0.99 KG
- Eco-Duo Coupler Street Reducer 76.1mm x 35mm - 1.07 KG
- Eco-Duo Coupler Street Reducer 76.1mm x 42mm -1.07 KG
- Eco-Duo Coupler Street Reducer 76.1mm x 54mm- 1.08 KG
- Eco-Duo Coupler Street Reducer 76.1mm x 66.7mm - 1.16KG

Features and Benefits

- Patented Pipe-in-a-pipe technology
- Saves 50% energy costs (tested by BRE)
- Maintains temperatures across the whole building.
- Halves installation time and costs
- 50% reduction in pipe fixings and insulation
- No special installation required
- Pipework can be cut as normal
- Helps to reduce the risk of Legionella and other water borne pathogens
- Can be used on hot and cold potable water systems

Notes:

- Only for use with potable water (not closed heating systems)
- Only for use with pumped recirculated water

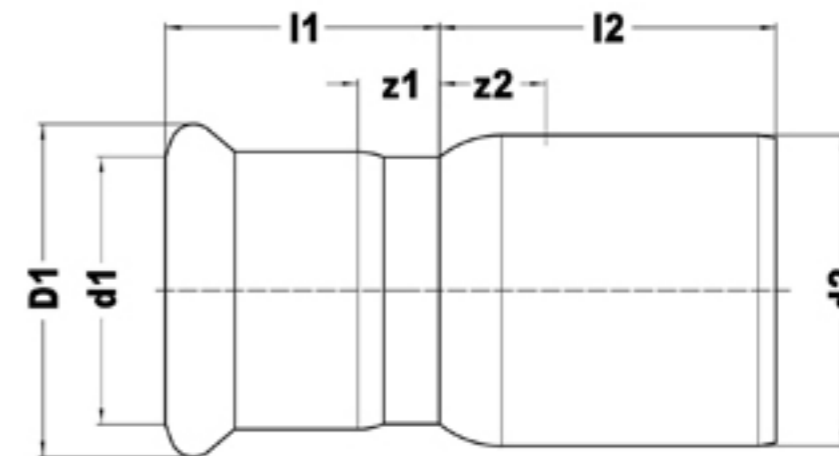

Max Pressure Details

16 Bar

Designer : Maxwell Bridges





Eco-Duo - Coupler Street Reducer Data Sheet 3

Coupler Street Reducer

Eco-Duo Coupler Street Reducer 108mm x 42mm	W8386 CP
Eco-Duo Coupler Street Reducer 108mm x 54mm	W8387 CP
Eco-Duo Coupler Street Reducer 108mm x 66.7mm	W8389 CP
Eco-Duo Coupler Street Reducer 108mm x 76.1mm	W8390 CP



(See Data Sheet 1 and 2 for smaller sizes)

Finishing Options:

Copper CP

Material Type

Main Body : COPPER
Separators: 316 STAINLESS STEEL

Weight

Eco-Duo Coupler Street Reducer 108mm x 42mm	0.93 KG
Eco-Duo Coupler Street Reducer 108mm x 54mm	0.94 KG
Eco-Duo Coupler Street Reducer 108mm x 66.7mm	1.05 KG
Eco-Duo Coupler Street Reducer 108mm x 76.1mm	1.10 KG

Max Pressure Details

16 Bar

Designer : Maxwell Bridges

Features and Benefits

- Patented Pipe-in-a-pipe technology
- Saves 50% energy costs (tested by BRE)
- Maintains temperatures across the whole building.
- Halves installation time and costs
- 50% reduction in pipe fixings and insulation
- No special installation required
- Pipework can be cut as normal
- Helps to reduce the risk of Legionella and other water borne pathogens
- Can be used on hot and cold potable water systems

Notes:

- Only for use with potable water (not closed heating systems)
- Only for use with pumped recirculated water

Dimensions

SKU	Description	l1	d1	D1	ea1	z1	l2	d2	D2	ea2	z2	DN1	DN2
W8386 CP	108mm x 42mm	47	42	53	30	17	106	108	-	67	39	DN40	DN100
W8387 CP	108mm x 54mm	54	54	65	34	20	102	108	-	67	29	DN50	DN100
W8389 CP	108mm x 66.7mm	70	67	83	50	20	96	108	-	67	25	DN65	DN100
W8390 CP	108mm x 76.1mm	70	76	94	50	20	92	108	-	67	25	DN65	DN100

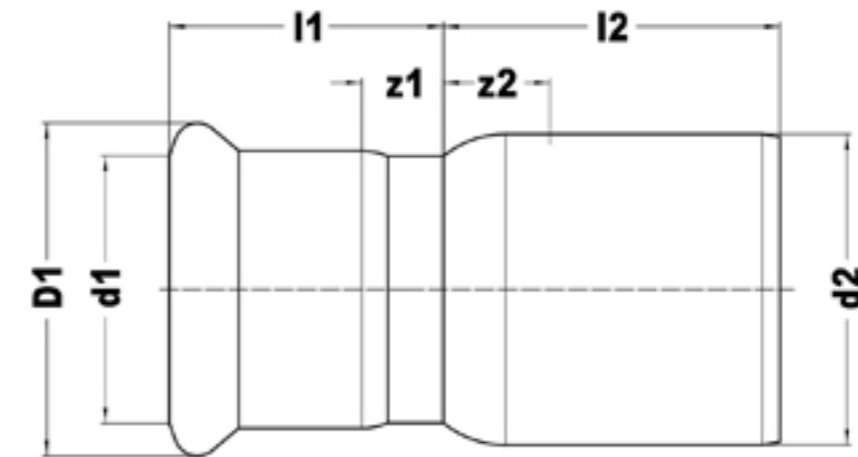

Eco-Duo - Coupling Reducer

Coupling Reducer

Eco-Duo Coupling Reducer 22mm x 15mm	W1549 CP
Eco-Duo Coupling Reducer 28mm x 22mm	W1550 CP
Eco-Duo Coupling Reducer 28mm x 15mm	W1649 CP
Eco-Duo Coupling Reducer 35mm x 28mm	W1650 CP
Eco-Duo Coupling Reducer 42mm x 35mm	W1651 CP
Eco-Duo Coupling Reducer 54mm x 42mm	W1652 CP



Finishing Options:

Copper CP

Material Type

Main Body: COPPER
Separators: 316 STAINLESS STEEL

Weight

Eco-Duo Coupling Reducer 22mm x 15mm- 0.05 KG
Eco-Duo Coupling Reducer 28mm x 22mm- 0.07 KG
Eco-Duo Coupling Reducer 28mm x 15mm - 0.07 KG
Eco-Duo Coupling Reducer 35mm x 28mm - 0.09 KG
Eco-Duo Coupling Reducer 42mm x 35mm - 0.14 KG
Eco-Duo Coupling Reducer 54mm x 42mm - 0.21 KG

Max Pressure Details

16 Bar

Designer : Maxwell Bridges

Features and Benefits

- Patented Pipe-in-a-pipe technology
- Saves 50% energy costs (tested by BRE)
- Maintains temperatures across the whole building.
- Halves installation time and costs
- 50% reduction in pipe fixings and insulation
- No special installation required
- Pipework can be cut as normal
- Helps to reduce the risk of Legionella and other water borne pathogens
- Can be used on hot and cold potable water systems

Notes:

- Only for use with potable water (not closed heating systems)
- Only for use with pumped recirculated water

Dimensions

SKU	Description	l1	d1	D1	es1	z1	l2	d2	D2	es2	z2	DN1	DN2
W1549 CP	22 x 15mm	28	22	31	21	7	25	15	23	20	5	DN20	DN12
W1649 CP	28 x 15mm	35	28	37	23	12	23	15	23	20	3	DN25	DN12
W1650 CP	28 x 22mm	29	28	37	23	6	26	22	31	21	6	DN25	DN20
W1650 CP	35 x 28mm	33	35	44	26	7	28	28	37	23	5	DN32	DN25
W1651 CP	42 x 35mm	37	42	53	30	7	31	35	44	26	5	DN40	DN32
W1652 CP	54 x 42mm	46	54	65	35	11	34	42	53	30	4	DN50	DN40

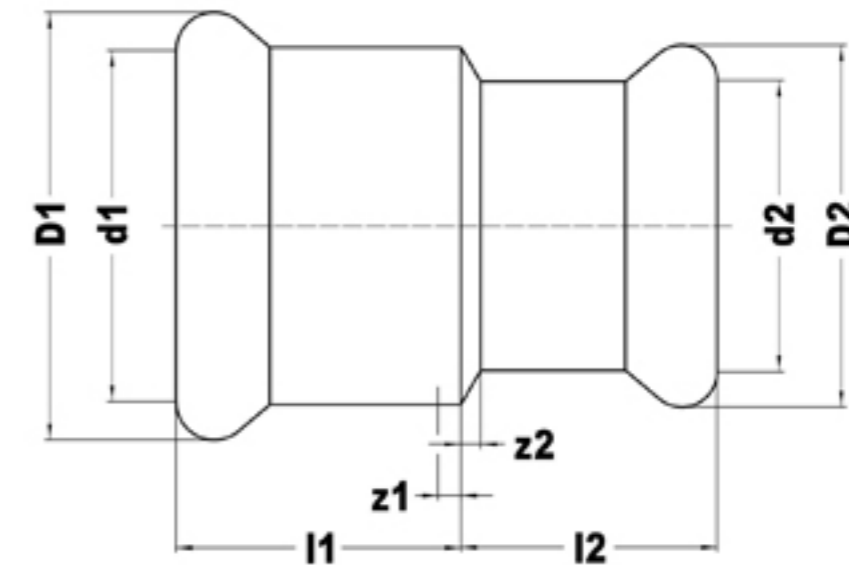



Eco-Duo - Equal Tee

Tee-Piece

Eco-Duo Tee for 15mm	W1541 CP
Eco-Duo Tee for 22mm	W1542 CP
Eco-Duo Tee for 28mm	W1543 CP
Eco-Duo Tee for 35mm	W1544 CP
Eco-Duo Tee for 42mm	W1545 CP
Eco-Duo Tee for 54mm	W1546 CP
Eco-Duo Tee for 66.7mm	W1547 CP
Eco-Duo Tee for 76.1mm	W1548 CP
Eco-Duo Tee for 108mm	W1656 CP



Dimensions

SKU	Description	D1	d1	D2	w1	x1	z1	D3	d3	w2	x2	z2	z3	z4	D4	D5	D6	D7
W1541 CP	15mm	32	15	22	20	15	32	15	22	20	12	32	15	32	15	22	20	22
W1542 CP	22mm	37	22	27	21	16	37	22	27	21	14	37	22	37	22	27	21	27
W1543 CP	28mm	42	28	32	23	18	42	28	32	23	16	42	28	42	28	32	23	32
W1544 CP	35mm	50	35	44	28	24	50	35	44	28	18	50	35	50	35	44	28	44
W1545 CP	42mm	58	42	51	31	28	58	42	51	31	20	58	42	58	42	51	31	51
W1546 CP	54mm	68	54	63	35	34	68	54	63	35	24	68	54	68	54	63	35	63
W1547 CP	66.7mm	80	66.7	75	40	40	80	66.7	75	40	28	80	66.7	80	66.7	75	40	75
W1548 CP	76.1mm	91	76	84	45	45	91	76	84	45	32	91	76	91	76	84	45	84
W1656 CP	108mm	136	108	123	67	69	136	108	123	67	40	136	108	136	108	123	67	123

Finishing Options:

Copper CP

Material Type

Main Body: COPPER
Separators: 316 STAINLESS STEEL

Weight

Eco-Duo Tee Piece for 15mm - 0.30 KG
Eco-Duo Tee Piece for 22mm - 0.37 KG
Eco-Duo Tee Piece for 28mm - 0.42 KG
Eco-Duo Tee Piece for 35mm - 0.72 KG
Eco-Duo Tee Piece for 42mm - 0.87 KG
Eco-Duo Tee Piece for 54mm - 1.26 KG
Eco-Duo Tee Piece for 66.7mm - 1.78 KG
Eco-Duo Tee Piece for 76.1mm - 2.15 KG
Eco-Duo Tee Piece for 108mm - 3.85 KG

Features and Benefits

- Patented Pipe-in-a-pipe technology
- Saves 50% energy costs (tested by BRE)
- Maintains temperatures across the whole building.
- Halves installation time and costs
- 50% reduction in pipe fixings and insulation
- No special installation required
- Pipework can be cut as normal
- Helps to reduce the risk of Legionella and other water borne pathogens
- Can be used on hot and cold potable water systems

Notes:

- Only for use with potable water (not closed heating systems)
- Only for use with pumped recirculated water

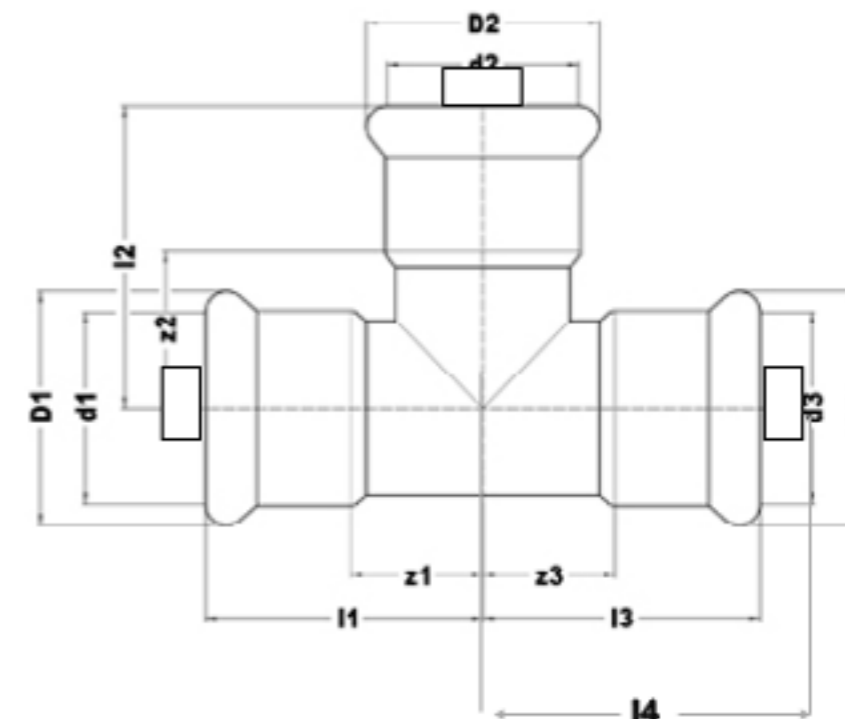

Max Pressure Details

16 Bar

Designer : Maxwell Bridges





Eco-Duo - Pipe Spiral

Pipe Spiral

Eco-Duo Pipe Spiral 15mm	W1609 SS
Eco-Duo Pipe Spiral 22mm	W1610 SS
Eco-Duo Pipe Spiral 28mm	W1611 SS
Eco-Duo Pipe Spiral 35mm	W1612 SS
Eco-Duo Pipe Spiral 42mm	W1613 SS
Eco-Duo Pipe Spiral 54mm	W1614 SS
Eco-Duo Pipe Spiral 66.7mm	W1615 SS
Eco-Duo Pipe Spiral 76.1mm	W1616 SS
Eco-Duo Pipe Spiral 108mm	W1617 SS



Finishing Options:

Stainless Steel SS

Material Type

316 Stainless Steel

Weight

Eco-Duo Pipe Spiral 15mm	- 0.2 KG
Eco-Duo Pipe Spiral 22mm	- 0.4 KG
Eco-Duo Pipe Spiral 28mm	- 0.6 KG
Eco-Duo Pipe Spiral 35mm	- 0.10 KG
Eco-Duo Pipe Spiral 42mm	- 0.12 KG
Eco-Duo Pipe Spiral 54mm	- 0.14 KG
Eco-Duo Pipe Spiral 66.7mm	- 0.16 KG
Eco-Duo Pipe Spiral 76.1mm	- 0.18 KG
Eco-Duo Pipe Spiral 108mm	- 0.20 KG

Max Pressure Details

16 Bar

Designer : Maxwell Bridges

Features and Benefits

- Patented Pipe-in-a-pipe technology
- Saves 50% energy costs (tested by BRE)
- Maintains temperatures across the whole building.
- Halves installation time and costs
- 50% reduction in pipe fixings and insulation
- No special installation required
- Pipework can be cut as normal
- Helps to reduce the risk of Legionella and other water borne pathogens
- Can be used on hot and cold potable water systems

Notes:

- Only for use with potable water (not closed heating systems)
- Only for use with pumped recirculated water

Eco-Duo - Straight Coupling

Straight Coupling

Eco-Duo Straight Coupling 15mm	W1567 CP
Eco-Duo Straight Coupling 22mm	W1568 CP
Eco-Duo Straight Coupling 28mm	W1569 CP
Eco-Duo Straight Coupling 35mm	W1570 CP
Eco-Duo Straight Coupling 42mm	W1571 CP
Eco-Duo Straight Coupling 54mm	W1572 CP
Eco-Duo Straight Coupling 66.7mm	W1573 CP
Eco-Duo Straight Coupling 76.1mm	W1574 CP
Eco-Duo Straight Coupling 108mm	W1657 CP

Finishing Options:

Copper CP

Material Type

Main Body: COPPER
Separators: 316 STAINLESS STEEL

Weight

Eco-Duo Straight Coupling 15mm	- 0.03 KG
Eco-Duo Straight Coupling 22mm	- 0.05 KG
Eco-Duo Straight Coupling 28mm	- 0.06 KG
Eco-Duo Straight Coupling 35mm	- 0.09 KG
Eco-Duo Straight Coupling 42mm	- 0.13 KG
Eco-Duo Straight Coupling 54mm	- 0.19 KG
Eco-Duo Straight Coupling 66.7mm	- 0.44 KG
Eco-Duo Straight Coupling 76.1mm	- 0.58 KG
Eco-Duo Straight Coupling 108mm	- 1.26 KG

Max Pressure Details

16 Bar

Designer : Maxwell Bridges



Features and Benefits

- Patented Pipe-in-a-pipe technology
- Saves 50% energy costs (tested by BRE)
- Maintains temperatures across the whole building.
- Halves installation time and costs
- 50% reduction in pipe fixings and insulation
- No special installation required
- Pipework can be cut as normal
- Helps to reduce the risk of Legionella and other water borne pathogens
- Can be used on hot and cold potable water systems

Notes:

- Only for use with potable water (not closed heating systems)
- Only for use with pumped recirculated water



Dimensions

SKU	Description	l1	d1	D1	ss1	z1	l2	d2	D2	ss2	z2	DN1	DN2
W1567 CP	15mm	22	15	23	20	2	22	15	23	20	2	DN12	DN12
W1568 CP	22mm	23	22	31	25	2	23	22	31	25	2	DN20	DN20
W1569 CP	28mm	25	28	37	27	2	25	28	37	27	2	DN25	DN25
W1570 CP	35mm	29	35	44	28	2	29	35	44	28	2	DN32	DN32
W1571 CP	42mm	36	42	53	32	4	36	42	53	32	4	DN40	DN40
W1572 CP	54mm	42	54	65	37	5	42	54	65	37	5	DN50	DN50
W1573 CP	66.7mm	55	67	83	50	5	55	67	83	50	5	DN65	DN65
W1574 CP	76.1mm	55	76	94	50	5	55	76	94	50	5	DN65	DN65
W1657 CP	108mm	72	108	132	68	5	72	108	132	68	5	DN100	DN100

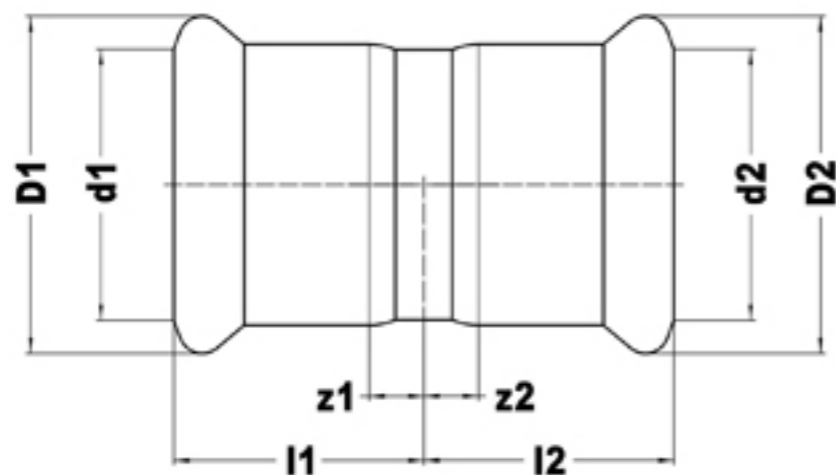

Eco-Duo - Tee Reduced Branch Data Sheet 1

Eco-Duo Tee Reduced Branch

Eco-Duo Tee Reduced Branch 22x22x15mm
 Eco-Duo Tee Reduced Branch 28x28x15mm
 Eco-Duo Tee Reduced Branch 28x28x22mm
 Eco-Duo Tee Reduced Branch 35x35x15mm
 Eco-Duo Tee Reduced Branch 35x35x22mm
 Eco-Duo Tee Reduced Branch 35x35x28mm
 Eco-Duo Tee Reduced Branch 42x42x15mm
 Eco-Duo Tee Reduced Branch 42x42x22mm
 Eco-Duo Tee Reduced Branch 42x42x28mm
 Eco-Duo Tee Reduced Branch 54x54x22mm
 Eco-Duo Tee Reduced Branch 54x54x28mm
 Eco-Duo Tee Reduced Branch 54x54x35mm
 Eco-Duo Tee Reduced Branch 54x54x42mm
 (See Data Sheet 2 for larger sizes)

- W1635 CP
- W1636 CP
- W1637 CP
- W1638 CP
- W1639 CP
- W1640 CP
- W1641 CP
- W1642 CP
- W1643 CP
- W1645 CP
- W1646 CP
- W1647 CP
- W1648 CP



Finishing Options:
 Copper CP

Material Type
 Main Body : COPPER
 Separators : 316 STAINLESS STEEL

Weight

Eco-Duo Tee Reduced Branch 22x22x15mm	- 0.36KG
Eco-Duo Tee Reduced Branch 28x28x15mm	- 0.41KG
Eco-Duo Tee Reduced Branch 28x28x22mm	- 0.42KG
Eco-Duo Tee Reduced Branch 35x35x15mm	- 0.67KG
Eco-Duo Tee Reduced Branch 35x35x22mm	- 0.67KG
Eco-Duo Tee Reduced Branch 35x35x28mm	- 0.70KG
Eco-Duo Tee Reduced Branch 42x42x15mm	- 0.73KG
Eco-Duo Tee Reduced Branch 42x42x22mm	- 0.65KG
Eco-Duo Tee Reduced Branch 42x42x28mm	- 0.84KG
Eco-Duo Tee Reduced Branch 54x54x22mm	- 1.10KG
Eco-Duo Tee Reduced Branch 54x54x28mm	- 1.08KG
Eco-Duo Tee Reduced Branch 54x54x35mm	- 1.11KG
Eco-Duo Tee Reduced Branch 54x54x42mm	- 1.22KG

Max Pressure Details

16 Bar

Designer : Maxwell Bridges

Features and Benefits

- Patented Pipe-in-a-pipe technology
- Saves 50% energy costs (tested by BRE)
- Maintains temperatures across the whole building.
- Halves installation time and costs
- 50% reduction in pipe fixings and insulation
- No special installation required
- Pipework can be cut as normal
- Helps to reduce the risk of Legionella and other water borne pathogens
- Can be used on hot and cold potable water systems

Notes:

- Only for use with potable water (not closed heating systems)
- Only for use with pumped recirculated water

Dimensions

SKU	Description	W	H1	H2	H3	H4	H5	H6	H7	H8	H9	H10	H11	H12	H13	H14	W1	W2	D1
W1594 CP	108x108x54mm	108	108	54	108	108	54	108	108	54	108	108	54	108	108	54	108	108	54
W1595 CP	108x108x66.7mm	108	108	66.7	108	108	66.7	108	108	66.7	108	108	66.7	108	108	66.7	108	108	66.7
W1596 CP	108x108x76.1mm	108	108	76.1	108	108	76.1	108	108	76.1	108	108	76.1	108	108	76.1	108	108	76.1

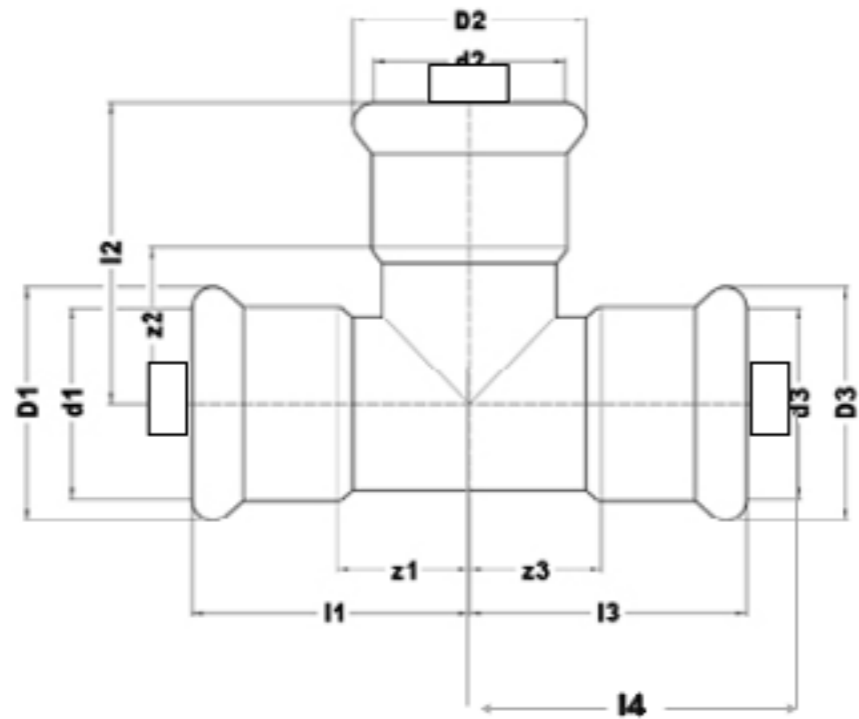

Eco-Duo - Tee Reduced Branch 2

Tee Reduced Branch

Eco-Duo Tee Reduced Branch 108x108x54mm W1594 CP
 Eco-Duo Tee Reduced Branch 108x108x66.7mm W1595 CP
 Eco-Duo Tee Reduced Branch 108x108x76.1mm W1596 CP
 (See Data Sheet 1 for smaller sizes)

Finishing Options:

Copper CP

Material Type

Main Body: COPPER
 Separators: 316 STAINLESS STEEL

Weight

Eco-Duo Tee Reduced Branch 108x108x54mm - 3.05 KG
 Eco-Duo Tee Reduced Branch 108x108x66.7mm - 3.23 KG
 Eco-Duo Tee Reduced Branch 108x108x76.1mm - 3.23KG

Max Pressure Details

16 Bar

Designer : Maxwell Bridges



Features and Benefits

- Patented Pipe-in-a-pipe technology
- Saves 50% energy costs (tested by BRE)
- Maintains temperatures across the whole building.
- Halves installation time and costs
- 50% reduction in pipe fixings and insulation
- No special installation required
- Pipework can be cut as normal
- Helps to reduce the risk of Legionella and other water borne pathogens
- Can be used on hot and cold potable water systems

Notes:

- Only for use with potable water (not closed heating systems)
- Only for use with pumped recirculated water

Dimensions

SKU	Description	D1	d1	D2	d2	D3	d3	I1	I2	I3	I4	Z1	Z2	Z3	Wt	Qty	Unit
W1501-CP	Eco-Duo Copper Pipe 15mm	15.8	15.0	15.8	15.0	15.8	15.0	30	30	30	30	1.5	1.5	1.5	0.510	3000	M
W1502-CP	Eco-Duo Copper Pipe 22mm	22.8	22.0	22.8	22.0	22.8	22.0	30	30	30	30	1.5	1.5	1.5	0.761	3000	M
W1503-CP	Eco-Duo Copper Pipe 28mm	28.8	28.0	28.8	28.0	28.8	28.0	30	30	30	30	1.5	1.5	1.5	0.912	3000	M
W1504-CP	Eco-Duo Copper Pipe 35mm	35.8	35.0	35.8	35.0	35.8	35.0	30	30	30	30	1.5	1.5	1.5	1.584	3000	M
W1505-CP	Eco-Duo Copper Pipe 42mm	42.8	42.0	42.8	42.0	42.8	42.0	30	30	30	30	1.5	1.5	1.5	1.819	3000	M
W1506-CP	Eco-Duo Copper Pipe 54mm	54.8	54.0	54.8	54.0	54.8	54.0	30	30	30	30	1.5	1.5	1.5	2.422	3000	M
W1507-CP	Eco-Duo Copper Pipe 66.7mm	66.8	66.0	66.8	66.0	66.8	66.0	30	30	30	30	1.5	1.5	1.5	2.848	3000	M
W1508-CP	Eco-Duo Copper Pipe 76.1mm	76.8	76.0	76.8	76.0	76.8	76.0	30	30	30	30	1.5	1.5	1.5	3.779	3000	M
W1649CP	Eco-Duo Copper Pipe 108mm	108.8	108.0	108.8	108.0	108.8	108.0	30	30	30	30	1.5	1.5	1.5	5.601	3000	M

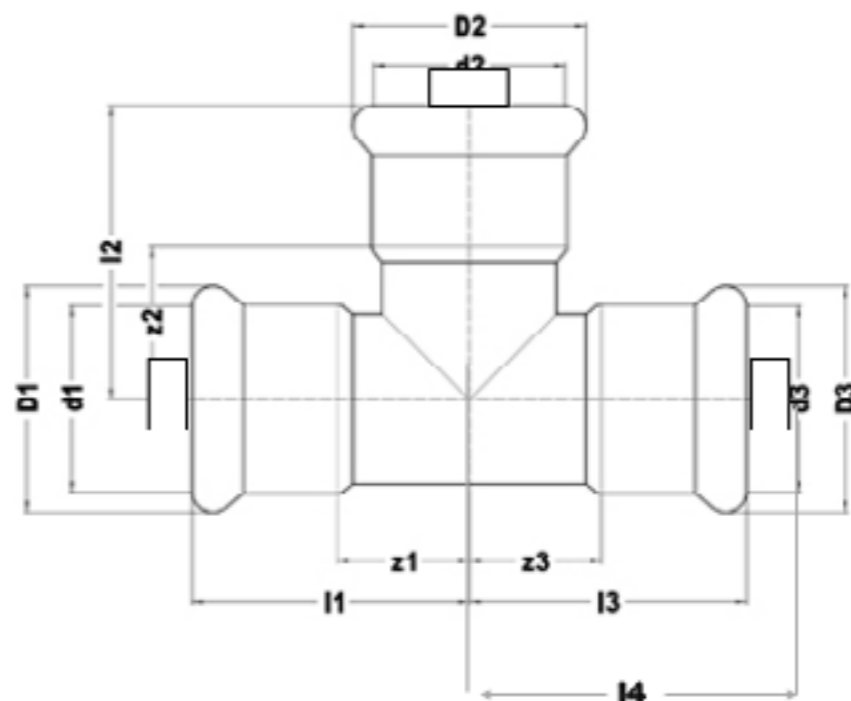

Eco-Duo - PipeWork

Pipework

Eco-Duo Copper Pipe 15mm - 3m length	W1501 CP
Eco-Duo Copper Pipe 22mm - 3m length	W1502 CP
Eco-Duo Copper Pipe 28mm - 3m length	W1503 CP
Eco-Duo Copper Pipe 35mm - 3m length	W1504 CP
Eco-Duo Copper Pipe 42mm - 3m length	W1505 CP
Eco-Duo Copper Pipe 54mm- 3m length	W1506 CP
Eco-Duo Copper Pipe 66.7mm - 3m length	W1507 CP
Eco-Duo Copper Pipe 76.1mm - 3m length	W1508 CP
Eco-Duo Copper Pipe 108mm - 3m length	W1649CP

Finishing Options:

Copper CP

Material Type

COPPER TUBE TO BS EN 1057 – R250/R290
 15mm - 54mm - Half Hard
 66.7mm-108mm - Hard
 Separators: 316 STAINLESS STEEL

Weight KG/M

Eco-Duo Copper Pipe 15mm - 0.510 KG
 Eco-Duo Copper Pipe 22mm - 0.761 KG
 Eco-Duo Copper Pipe 28mm - 0.912 KG
 Eco-Duo Copper Pipe 35mm - 1.584 KG
 Eco-Duo Copper Pipe 42mm - 1.819 KG
 Eco-Duo Copper Pipe 54mm - 2.422 KG
 Eco-Duo Copper Pipe 66.7mm - 2.848 KG
 Eco-Duo Copper Pipe 76.1mm - 3.779 KG
 Eco-Duo Copper Pipe 108mm - 5.601KG

Max Pressure Details

16 Bar

Designer : Maxwell Bridges



Features and Benefits

- Patented Pipe-in-a-pipe technology
- Saves 50% energy costs (tested by BRE)
- Maintains temperatures across the whole building.
- Halves installation time and costs
- 50% reduction in pipe fixings and insulation
- No special installation required
- Pipework can be cut as normal
- Helps to reduce the risk of Legionella and other water borne pathogens
- Can be used on hot and cold potable water systems

Notes:

- Only for use with potable water (not closed heating systems)
- Only for use with pumped recirculated water

Eco-Duo - Drain Cock

Drain Cock

Eco-Duo Drain Cock 15mm W1582 CP



Dimensions

SKU	Description	a	b	c	s
W1582 BR	15mm	74	35	56	8

Finishing Options:

Brass/Copper CP

Material Type

Brass

Weight

Eco-Duo Drain Cock 15mm - 0.11 KG

Features and Benefits

- For use with Eco Duo Patented Pipe-in-a-Pipe technology
- Use in conjunction with Eco-Duo Confluence Tee to temporarily interrupt the dual pipe system - converting to single pipe where this drain cock is to be fitted
- Can be used on hot and cold potable water systems

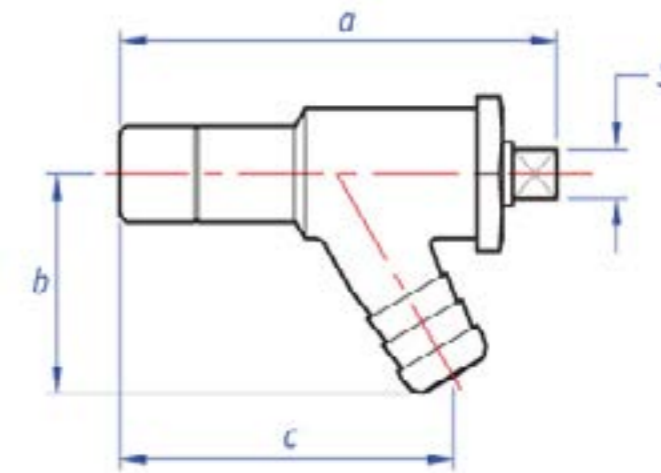

Max Pressure Details

16 Bar

Notes:

- Only for use with potable water (not closed heating systems)
- Only for use with pumped recirculated water

Designer : Maxwell Bridges

Eco-Duo - Continuous Isolation Valve Blue Handle

Continuous Isolation Valve

Eco-Duo Continuous Isolation Valve for 15mm W1599 BL
 Eco-Duo Continuous Isolation Valve for 22mm W1600 BL
 Eco-Duo Continuous Isolation Valve for 28mm W1601 BL
 Eco-Duo Continuous Isolation Valve for 35mm W1602 BL
 Eco-Duo Continuous Isolation Valve for 42mm W1603 BL
 Eco-Duo Continuous Isolation Valve for 54mm W1604 BL



Finishing Options:

Brass BR

Material Type

Main Body: BRASS
 Pipes: COPPER
 Separators: 316 STAINLESS STEEL

Weight

Eco-Duo Continuous Isolation Valve for 15mm - 0.27KG
 Eco-Duo Continuous Isolation Valve for 22mm - 0.45KG
 Eco-Duo Continuous Isolation Valve for 28mm - 0.69KG
 Eco-Duo Continuous Isolation Valve for 35mm - 0.89KG
 Eco-Duo Continuous Isolation Valve for 42mm - 1.62KG
 Eco-Duo Continuous Isolation Valve for 54mm - 2.62KG

Max Pressure Details

16 Bar up to 30°C

Designer : Maxwell Bridges

Features and Benefits

- Continues to Circulate water even when Valve is closed
- Patented Pipe-in-a-pipe technology
- Saves 50% energy costs (tested by BRE)
- Maintains temperatures across the whole building.
- Halves installation time and costs
- 50% reduction in pipe fixings and insulation
- No special installation required
- Pipework can be cut as normal
- Helps to reduce the risk of Legionella and other water borne pathogens
- Can be used on hot and cold potable water systems

Notes:

- Only for use with potable water (not closed heating systems)
- Only for use with pumped recirculated water

SKU	Description	A	B
W1599BL	15mm	78	46
W1600BL	22mm	85	54
W1601BL	28mm	100	57
W1602BL	35mm	120	62
W1603BL	42mm	135	77
W1604BL	54mm	160	84

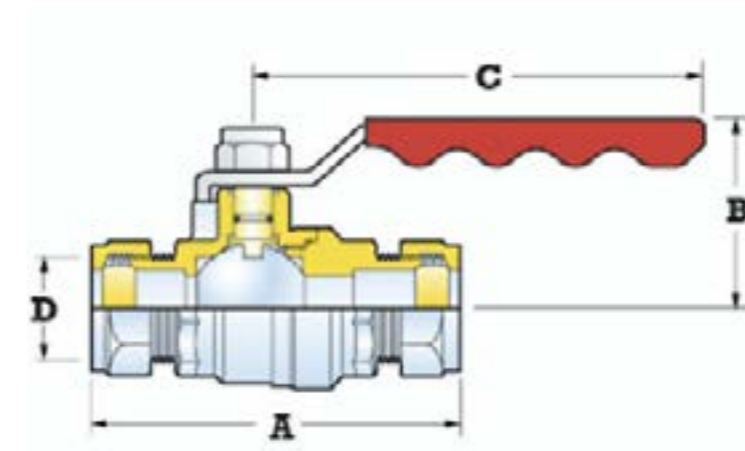

Eco-Duo - Continuous Isolation Valve Red Handle

Continuous Isolation Valve

Eco-Duo Continuous Isolation Valve for 15mm	W1599 RD
Eco-Duo Continuous Isolation Valve for 22mm	W1600 RD
Eco-Duo Continuous Isolation Valve for 28mm	W1601 RD
Eco-Duo Continuous Isolation Valve for 35mm	W1602 RD
Eco-Duo Continuous Isolation Valve for 42mm	W1603 RD
Eco-Duo Continuous Isolation Valve for 54mm	W1604 RD



Finishing Options:

Brass BR

Material Type

Main Body: BRASS
Pipes: COPPER
Separators: 316 STAINLESS STEEL

Weight

Eco-Duo Continuous Isolation Valve for 15mm	- 0.27KG
Eco-Duo Continuous Isolation Valve for 22mm	- 0.45KG
Eco-Duo Continuous Isolation Valve for 28mm	- 0.69KG
Eco-Duo Continuous Isolation Valve for 35mm	- 0.89KG
Eco-Duo Continuous Isolation Valve for 42mm	- 1.62KG
Eco-Duo Continuous Isolation Valve for 54mm	- 2.62KG

Max Pressure Details

5 Bar unto 120°C

Designer : Maxwell Bridges

Features and Benefits

- Continues to Circulate water even when Valve is closed
- Patented Pipe-in-a-pipe technology
- Saves 50% energy costs (tested by BRE)
- Maintains temperatures across the whole building.
- Halves installation time and costs
- 50% reduction in pipe fixings and insulation
- No special installation required
- Pipework can be cut as normal
- Helps to reduce the risk of Legionella and other water borne pathogens
- Can be used on hot and cold potable water systems

Notes:

- Only for use with potable water (not closed heating systems)
- Only for use with pumped recirculated water

SKU	Description	A	B
W1599 RD	15mm	78	46
W1600 RD	22mm	85	54
W1601 RD	28mm	100	57
W1602 RD	35mm	120	62
W1603 RD	42mm	135	77
W1604 RD	54mm	160	84

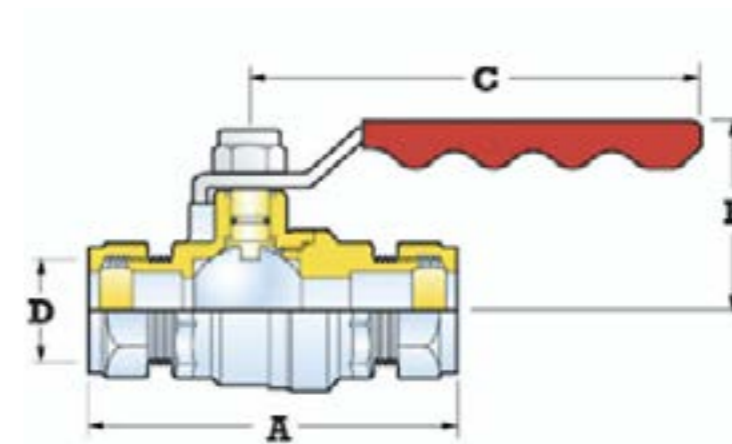

Eco-Duo - Commissioning Fitting

Commissioning Fitting

Eco-Duo Commissioning Fitting 22mm W1605 BR
 Eco-Duo Commissioning Fitting 28mm W1606 BR
 Eco-Duo Commissioning Fitting 35mm W1607 BR
 Eco-Duo Commissioning Fitting 42mm W1608 BR



Finishing Options:

Brass BR

Material Type

Main Body : BRASS
 Pipes: COPPER
 Separators: 316 STAINLESS STEEL

Weight

Eco-Duo Commissioning Fitting 22mm - 0.45KG
 Eco-Duo Commissioning Fitting 28mm - 0.69KG
 Eco-Duo Commissioning Fitting 35mm - 0.89KG
 Eco-Duo Commissioning Fitting 42mm - 1.62KG

Max Pressure Details

16 Bar

Designer : Maxwell Bridges

SKU	Description	A	B
W1605BR	22mm	85	54
W1606BR	28mm	100	57
W1607BR	35mm	120	62
W1608BR	42mm	135	77

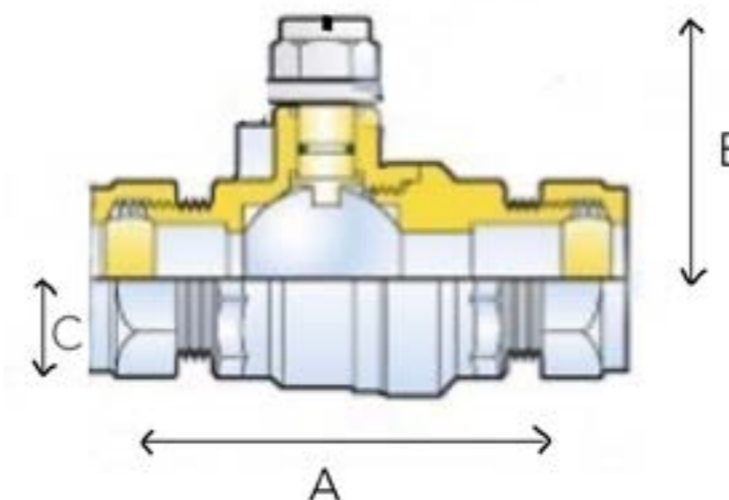

Features and Benefits

- Patented Pipe-in-a-pipe technology
- Saves 50% energy costs (tested by BRE)
- Maintains temperatures across the whole building.
- Halves installation time and costs
- 50% reduction in pipe fixings and insulation
- No special installation required
- Pipework can be cut as normal
- Helps to reduce the risk of Legionella and other water borne pathogens
- Can be used on hot and cold potable water systems

Notes:

- Only for use with potable water (not closed heating systems)
- Only for use with pumped recirculated water



Contact us: 0141 280 9585
Website: www.water-kinetics.co.uk
Email: info@water-kinetics.co.uk

