



lujan

LJN5418L

Headlamp beam setter

CE



lujan

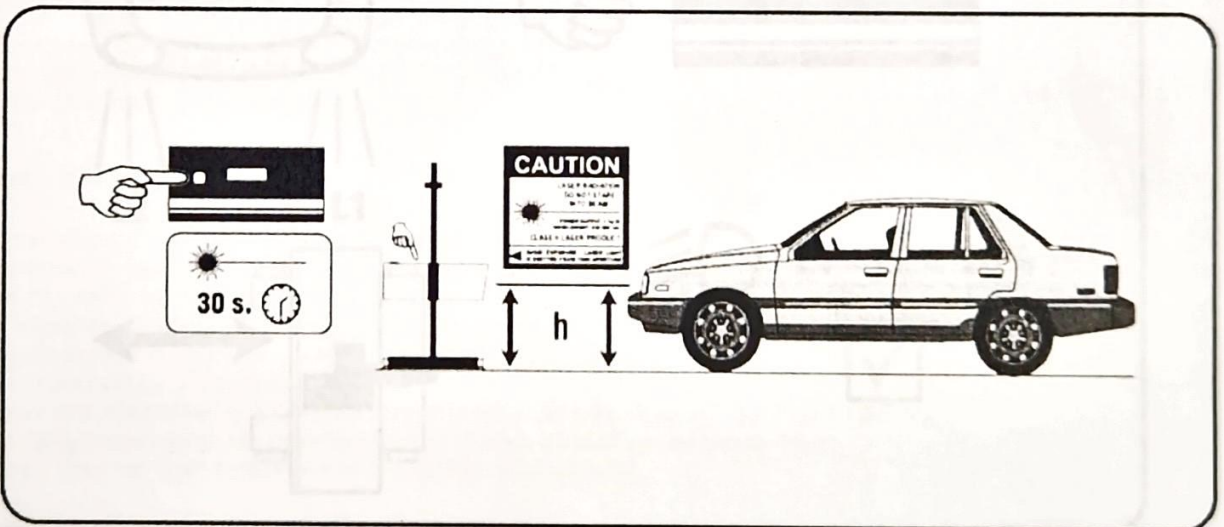
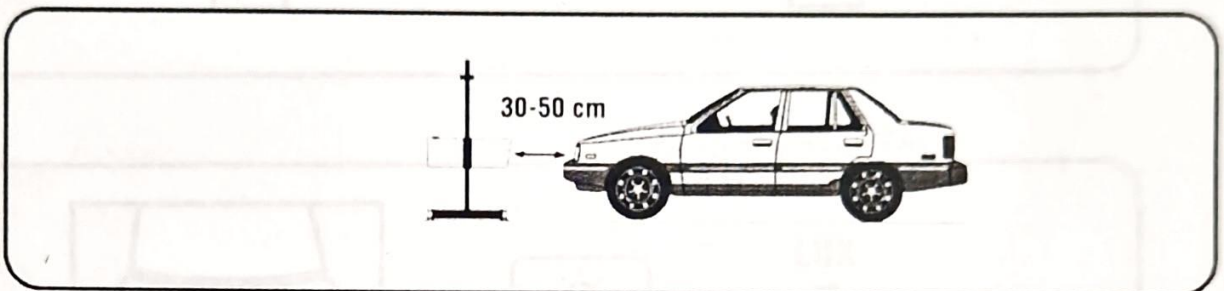
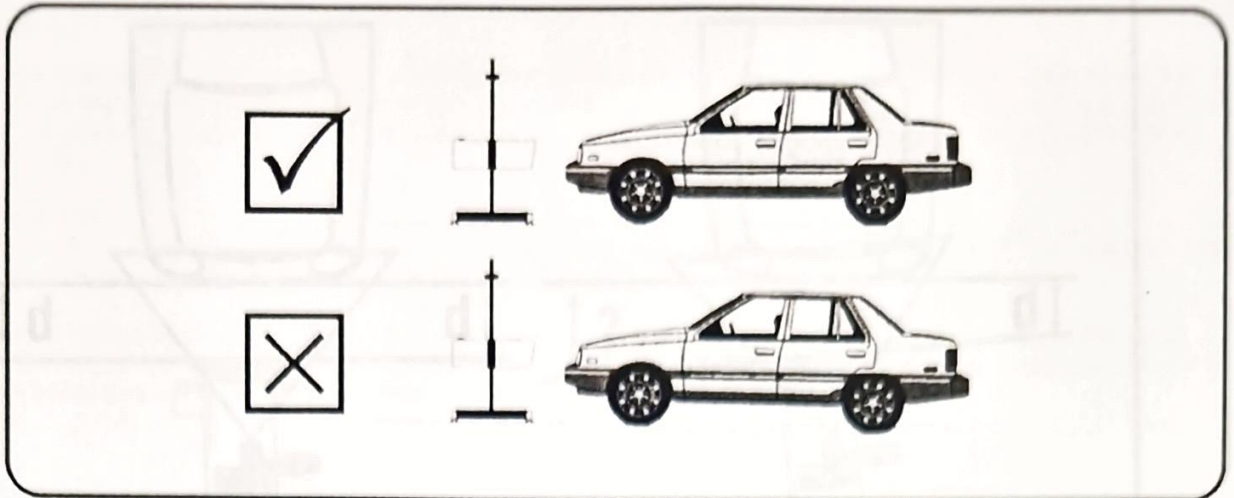



lujan

LOW BEAMS (AND FCG LAMPS)

BEAM DISTANCE

Before you start, make sure the car is on a level surface. The distance between the two beams should be 200 mm. If the distance is not 200 mm, the beams are parallel and the car is on a level surface.

IMPORTANT

The distance between the two beams should be 200 mm. If the distance is not 200 mm, the beams are parallel and the car is on a level surface.

HOW TO ADJUST

Adjust the distance between the two beams to 200 mm. If the distance is not 200 mm, the beams are parallel and the car is on a level surface.



HIGH BEAMS

DIRECTION AND HEIGHT

The high beam should be centered over the low beam. The distance between the two beams should be 200 mm.

MAINTENANCE

This beam should be checked at a minimum of once a year. The distance between the two beams should be 200 mm.

Grease and oil can lead to a decrease in the beam's performance. It is highly recommended to clean the beam's surface at least once per year.

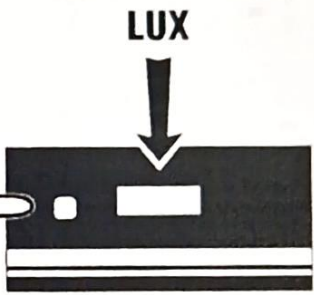

$$L1 = L2 \pm 20\%$$





lujan

LOW BEAMS (AND FOG LAMPS)

BEAM DIRECTION AND HEIGHT

Before to proceed to the beamsetting, it is important to know its height. It is measured from the center of the light to the floor. If the beam's height is less than 850 mm, it must be adjusted between 0,5% and 2% slope. If it is more than 850 mm, between 1,25% and 2,75%. This data are generic and can vary depending on the traffic laws for different countries.

IMPORTANT !!

You need to follow the headlamp aim test procedure detailed in the latest version of the relevant MOT Inspection Manual when carrying out a statutory MOT test.

Light up the low beams (or fog lamps). The light projected on the screen must stay inside the corresponding limits. For assymmetric low beams, the assymmetric part must also stay inside the corresponding limits, and the angle's vertex must be located on the center of the screen, otherwise the beam is bad directed.

LOW BEAM OR FOG LAMP

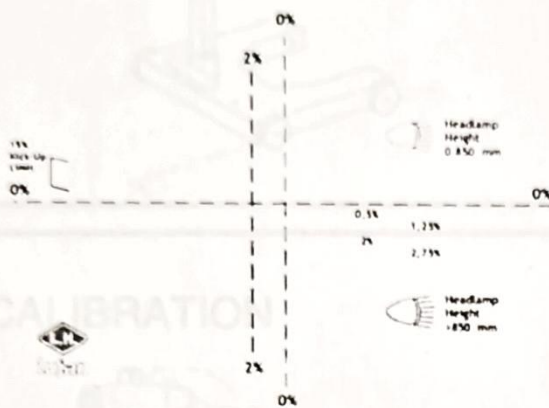

LOW BEAM (ASSIMETRIC)

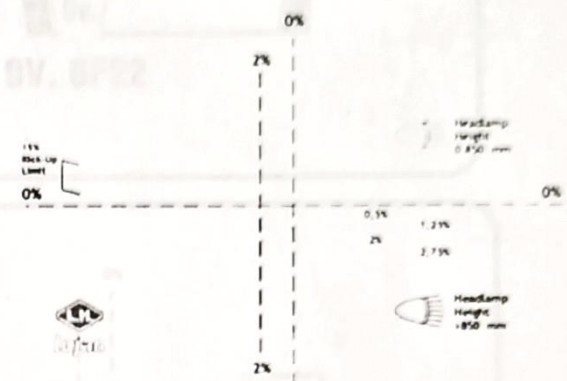

HIGH BEAMS

DIRECTION AND HEIGHT

The projection of the high beam must be centered over the intersection of the dashed lines on the screen. Otherwise, the beam is bad directed.

MAINTENANCE

This beamsetter has been designed for a minimum of maintenance needs. Thus, it is not necessary any type of power supply. In addition, because of the high quality of the essential components, their conservation is assured for a long time. Cleaning is very important for a long operating life.

Grease and oil can lead to a faulty locking of the beamsetter, so keep the bar clean and dry.

It is highly recommendable to avoid deposits of abrasive dust on the lens surface.

At least once per year, please check the calibration of the unit.

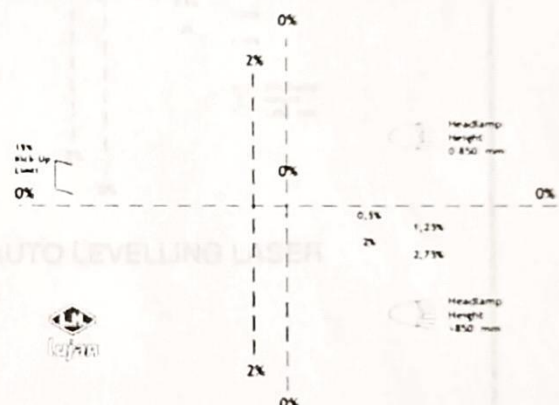



Lujan

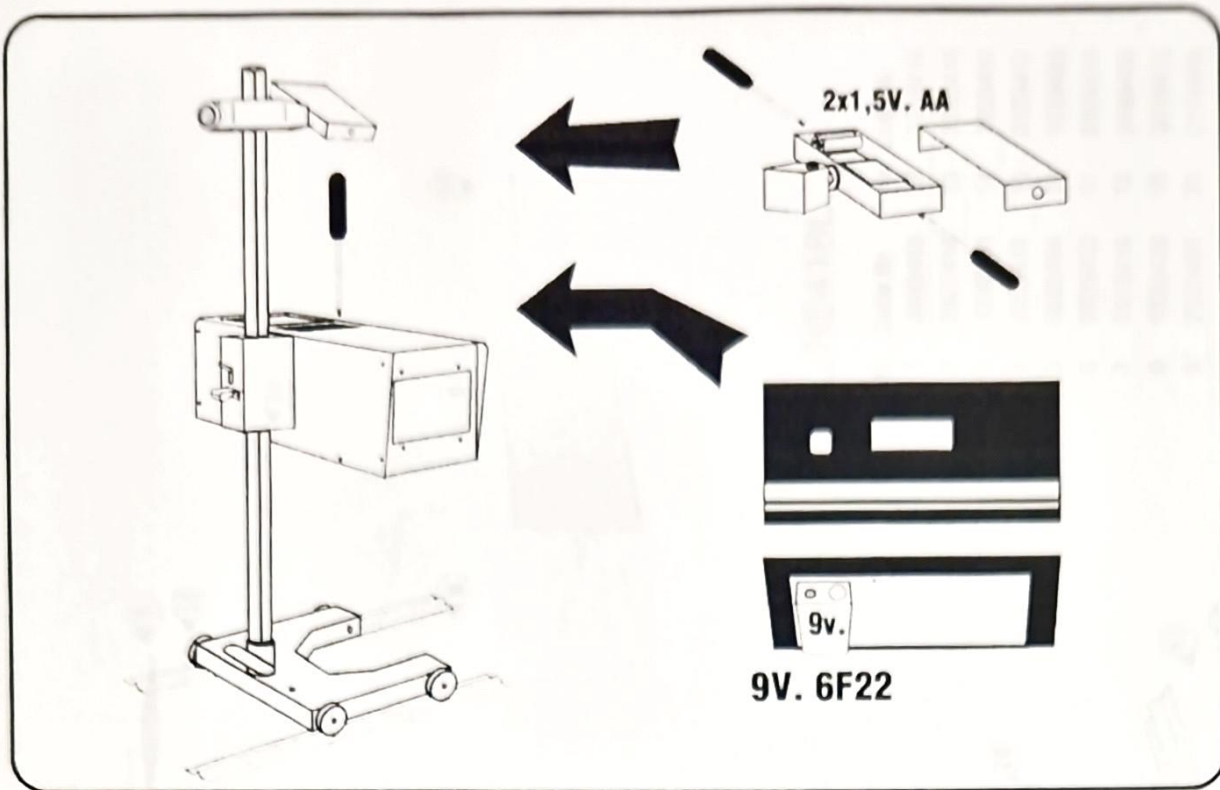

CALIBRATION

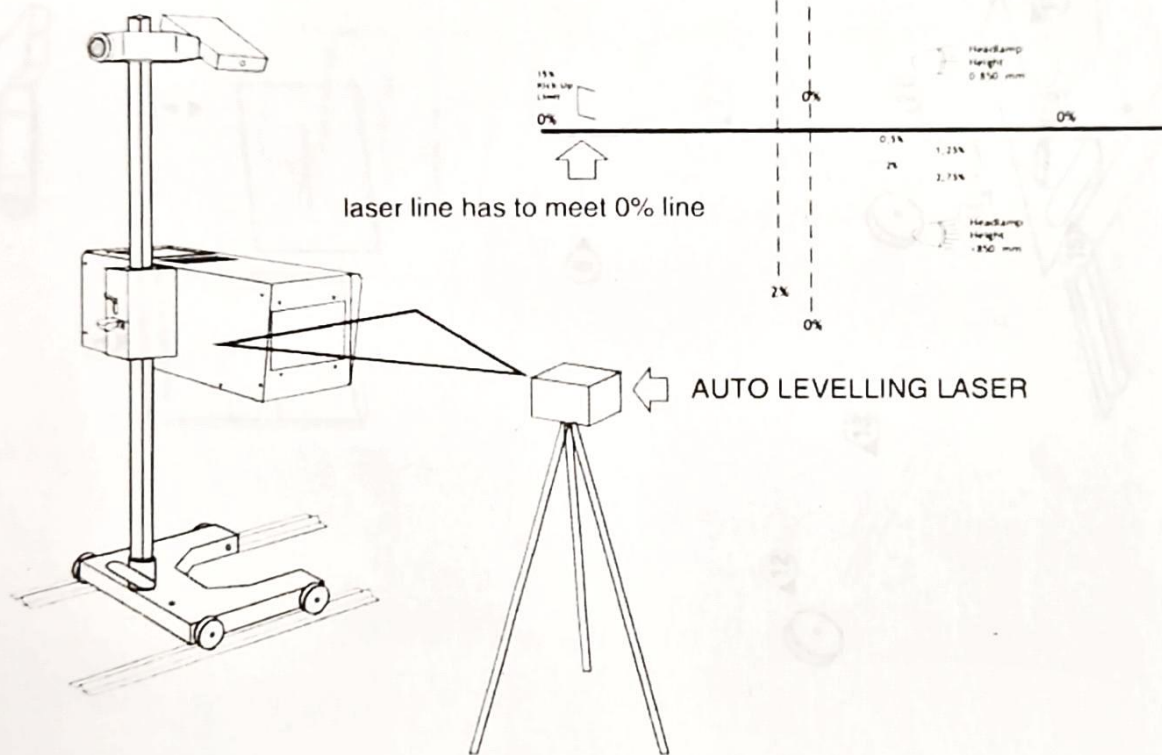

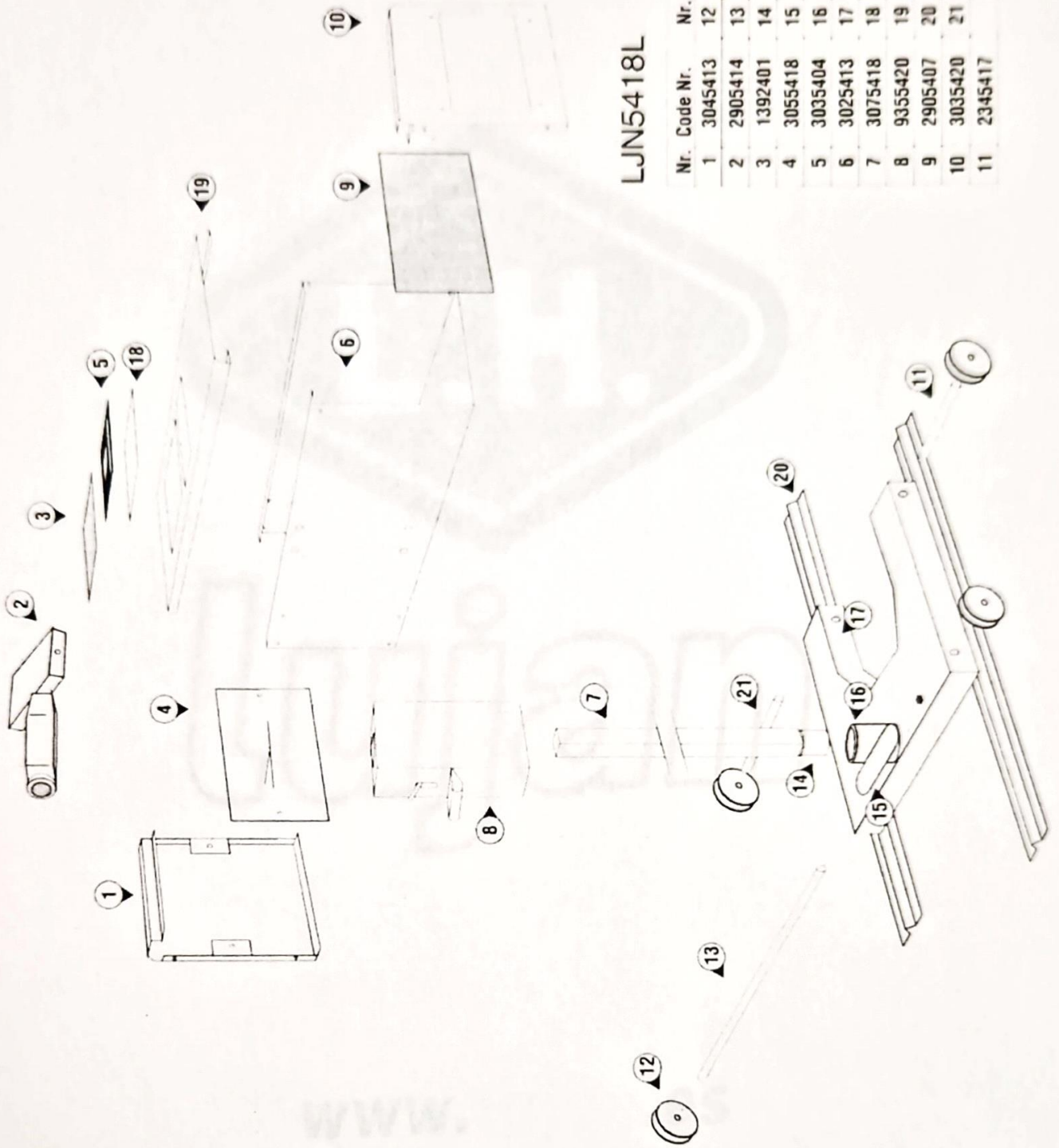

LJN5418L

Nr.	Code Nr.	Nr.	Code Nr.
1	3045413	12	2750018
2	2905414	13	2345418
3	1392401	14	1055430
4	3055418	15	3125412
5	3035404	16	1055489
6	3025413	17	3065418
7	3075418	18	2495400
8	9355420	19	3015413
9	2905407	20	3115418
10	3035420	21	2345419
11	2345417		