

Copyright Notice:
The original architect or designer maintains full title and ownership of these unique creations. Any unauthorized use, reproduction, or distribution of these plans, whether in whole or in part, is expressly prohibited without prior written consent.

Designer Information:
By: **Julian Wells**
27 Stoneledge Drive,
Suite 209
Weymouth MA
Phone: 540-370-9910
Email: Wellshomebuilders@gmail.com
Web: www.wellshomebuilders.com

Wells Home Builders
Ana Marie Plan



Client Information:
Sample

REVISION TABLE		
DESCRIPTION	DATE	BY

DATE:

Plan No.

C1

Ceiling Height
1st Floor: 9'
2nd Floor:
Basement: 9'

Square Footage
1st Floor Living Area: 1978
2nd Floor Living Area: 0
Basement: 1439
Unfinished Basement: 526
Garage: 612
Front Porch: 168
Rear Porch: 158
Screened In Porch: 208

Wall Section
Exterior Wall 2x6
Interior Wall 2x4
Foundation Plate ?
Roof Pitch 8/12

Step location to be determined by site location.

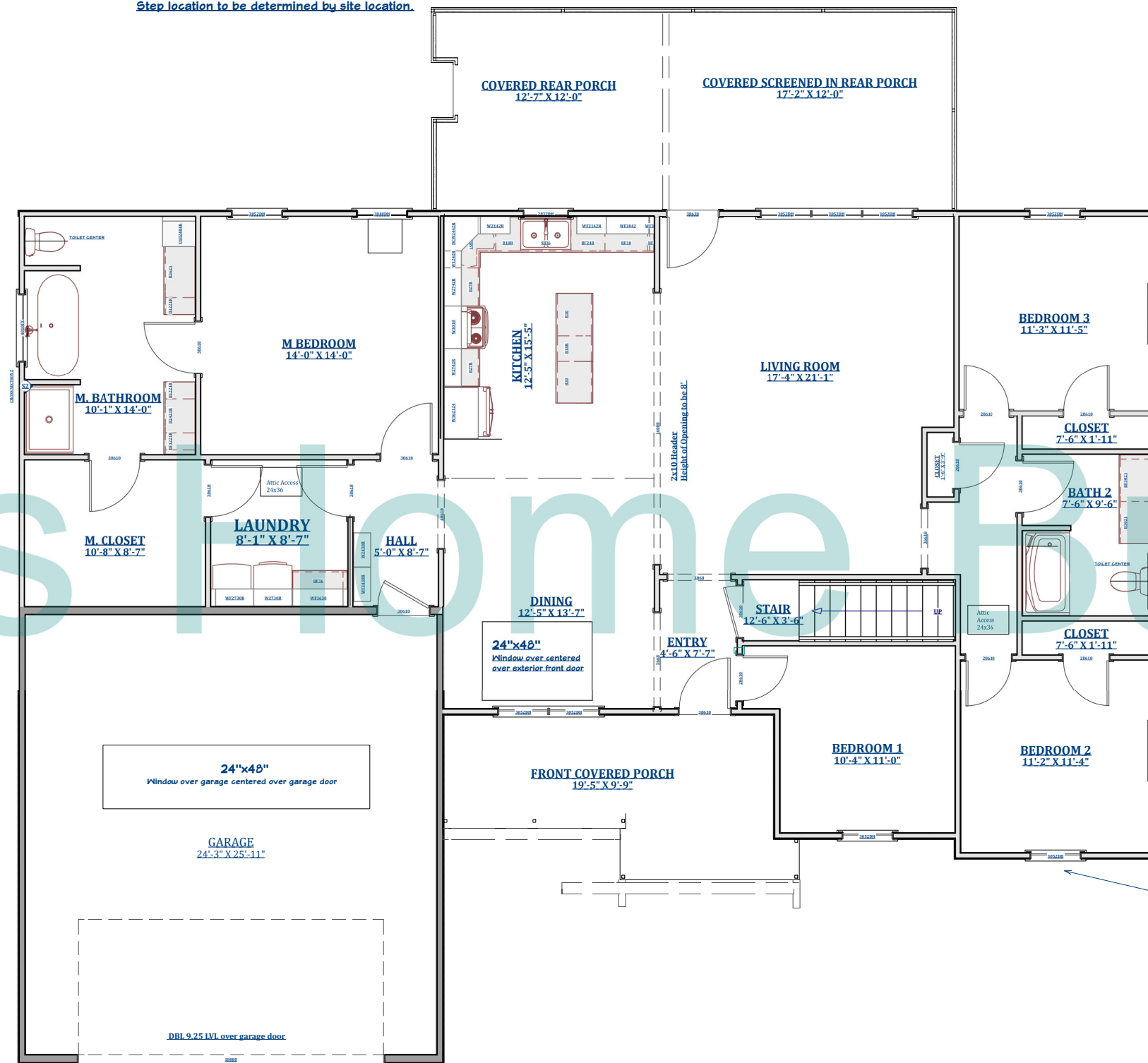

1ST FLOOR

Wells Home Builders