

**Property Owner**

**Name:** GEORGE, DON JR

**Property Information**

**Physical Address:** 1711 CENTRAL AVE

**Mailing Address:** 1711 CENTRAL AVE  
 HOT SPRINGS, AR 71901

**Subdivision:** MORRISON & BELDING

**Block / Lot:** 004 / 004

**Type:** (RI) Res. Improv.

**S-T-R:** 05-03S-19W

**Tax Dist:** (061) HOT SPRINGS INSIDE

**Size (Acres):**

**Millage Rate:** 45.70

**Extended Legal:** BLK 4 LOT 4, 5 & 6

**Market and Assessed Values**

**Taxes**

	Estimated Market Value	Full Assessed (20% Mkt Value)	Taxable Value
<b>Land:</b>	\$14,050	\$2,810	\$2,810
<b>Building:</b>	106250	21250	21250
<b>Total:</b>	\$120,300	\$24,060	\$24,060

<b>Estimated Taxes:</b>	\$725	
<b>Homestead Credit:</b>	\$375	<small>Note: Tax amounts are estimates only. Contact the county/parish tax collector for exact amounts.</small>

**Land**

Land Use	Size	Units
150.000X150	2.000	Site
<b>Total</b>	<b>2.000</b>	

**Deed Transfers**

Deed Date	Book	Page	Deed Type	Stamps	Est. Sale	Grantee	Code	Type
1/1/1901	1326	0708	N/A			GEORGE, DON, JR	Unval.	N/A

**Reappraisal Value History**

Tax Year	Total Value	Total Assessed
2015	\$126,400.00	\$23,001.00
2016	\$126,400.00	\$24,106.00
2017	\$120,300.00	\$24,060.00
2018	\$120,300.00	\$24,060.00
2019	\$120,300.00	\$24,060.00

**Details for Residential Card 1**

Occupancy	Story	Construction	Total Liv	Grade	Year Built	Age	Condition	Beds
Single Family	ONE	Frame Siding Std.	1,110	5	1930		Average	
<b>Exterior Wall:</b> FRAME			<b>Plumbing:</b> Half: 1					
<b>Foundation:</b> Slab			<b>Fireplace:</b> Type: 1s Sgl. Qty: 1					
<b>Floor Struct:</b> ElevSlab			<b>Heat / Cool:</b> F/W/Furn					

Parcel: 400-46300-037-000  
 Prev. Parcel: 00346300004004000  
 As of: 2/5/2020

# Garland County Report

ID: 38873

**Floor Cover:** Carpet & Tile  
**Insulation:** Ceilings  
**Roof Cover:** Fiberglass Shingle  
**Roof Type:** Gable

**Basement:** N/A  
**Basement Area:**  
**Year Remodeled:**  
**Style:**



DataScout, LLC

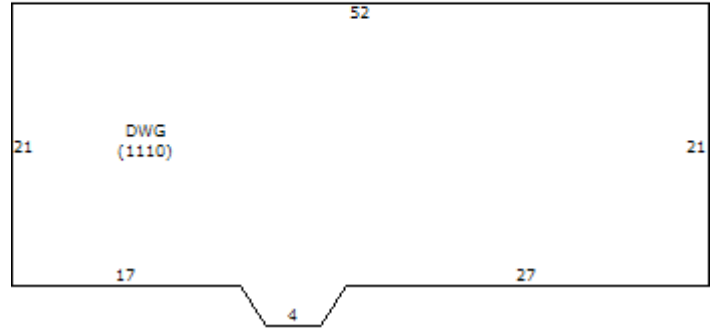

## Base Structure

Item	Label	Description	Area
A	DWG	Dwelling	1110

## Outbuildings and Yard Improvements

Item	Type	Size/Dim	Unit Multi.	Quality	Age
Patio cover, aluminum over sla		22x22			

## Details for Residential Card 2

Occupancy	Story	Construction	Total Liv	Grade	Year Built	Age	Condition	Beds
Single Family	ONE	Frame Siding Std.	2,328	4	1930		Average	

**Exterior Wall:** ALUMINUM

**Foundation:** Closed Piers

**Floor Struct:** Wood with subfloor

**Floor Cover:** Carpet & Tile

**Insulation:** Ceilings Walls

**Roof Cover:** Asphalt Shingle

**Roof Type:** Gable

**Plumbing:** Full: 1 Half: 1

**Fireplace:** Type: 1s Sgl. Qty: 1

**Heat / Cool:** Central

**Basement:** Unfin

**Basement Area:** 396

**Year Remodeled:** 2004

**Style:**



DataScout, LLC

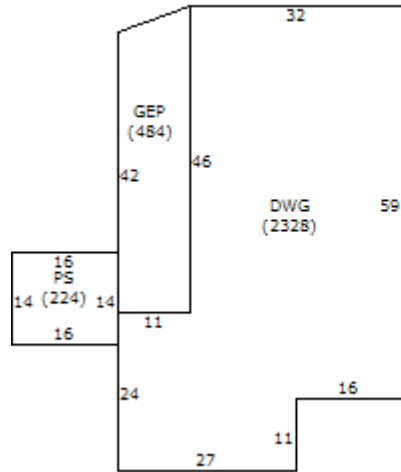

**Base Structure**

Item	Label	Description	Area
A	DWG	Dwelling	2328
B	GEP	Porch, glass enclosed	484
C	PS	Patio slab	224

**Outbuildings and Yard Improvements**

Item	Type	Size/Dim	Unit Multi.	Quality	Age
Driveway, concrete		60x30		L	
Fence, chain link 5'		64		A	
Concrete slab, unreinforced		169		L	
Wall, masonry (brick or stone)		250x4		A	

**Other Adjustments**

Code	Type	Quantity
WC		295

## Map

---

