



PIPER PA-32 FLY-IN SAFETY BRIEFING

Event Date: May 20-22, 2022

Olive Branch Airport (KOLV)



PIPER
OWNER SOCIETY
piperowner.org

AVIDYNE®



SPONSORS





Troy Kornacki



James Sandlin



Butch Mauldin



Todd Woods



Cannon Loughry

ORGANIZERS



Cannon Loughry – based in Murfreesboro, Tennessee (KMBT)
1979 PA-32-300 N121HE

PRESENTER

State	PA32s
TN	10
FL	7
PA	6
VA	5
AL	5
MS	4
GA	4
WI	3
OH	3
KY	3
SC	2
NC	2
MO	2
MI	2
IL	2
AZ	2
AR	2
VA	1
TX	1
OK	1
NY	1
NJ	1
MD	1
MA	1
KS	1
IN	1
CT	1
CA	1
Total	75

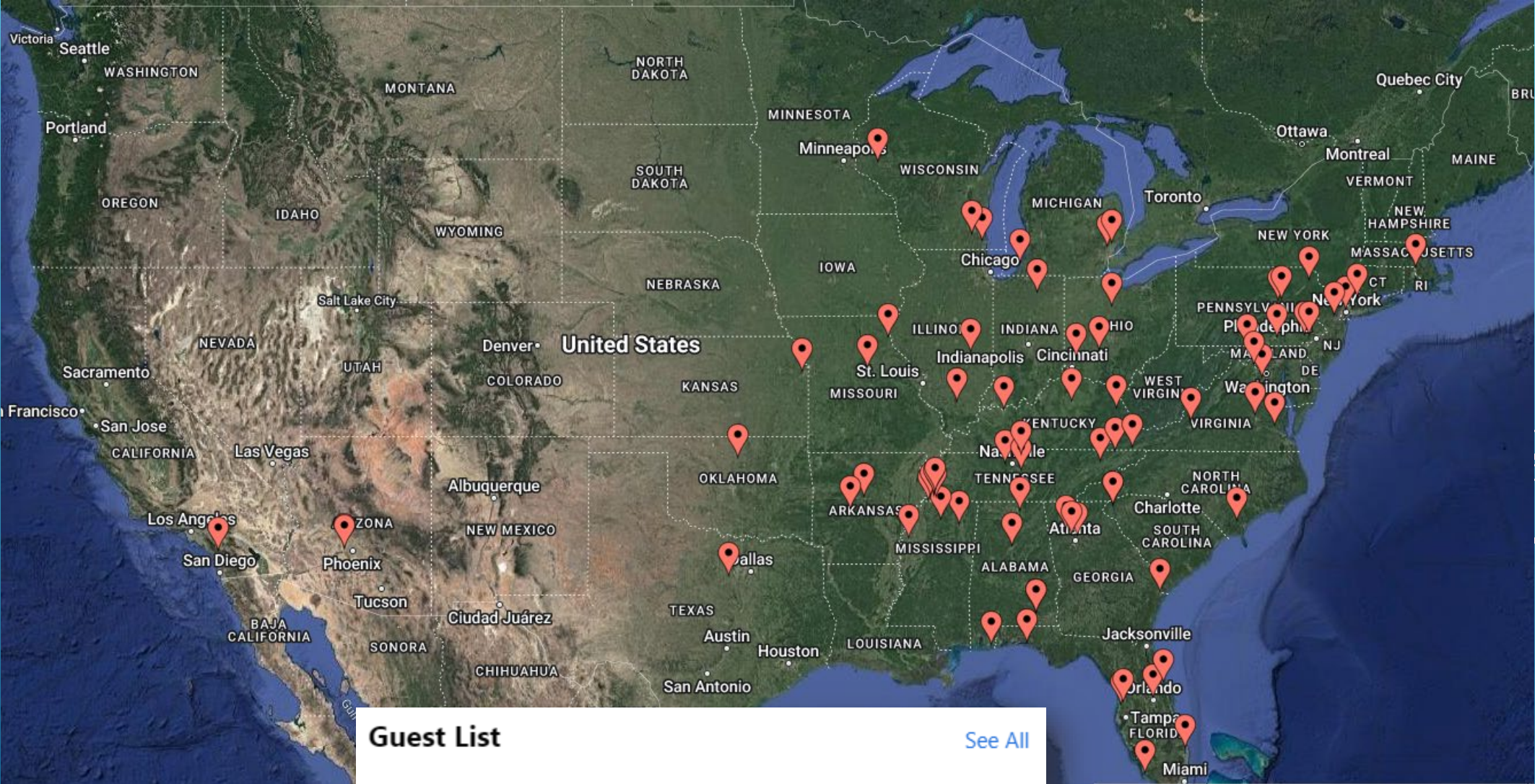

Guest List

93

GOING

46

MAYBE

6

INVITED

[See All](#)

STATISTICS

▶ Friday, May 20th

- ▶ 10am to 4pm CDT: ARRIVAL Olive Branch Airport (KOLV) – Expect taxiway Echo to enter ramp
- ▶ 4:00pm CDT: Hotel Check-in – Peabody Hotel - 149 Union Ave, Memphis, TN – 901-529-4000
- ▶ 5:30pm to 6:30pm CDT: Cocktail Hour – Peabody Hotel Lobby Bar
- ▶ 6:45pm to 8pm CDT: PA-32 Group Dinner (1st Seating)– Texas de Brazil – 150 Peabody Place Street, Suite 103
- ▶ 8pm to 9:15pm CDT: PA-32 Group Dinner (2nd Seating)– Texas de Brazil – 150 Peabody Place Street, Suite 103

▶ Saturday, May 21st

- ▶ 9am to 12pm CDT: ARRIVAL Olive Branch Airport (KOLV) – Expect taxiway Echo to enter ramp
- ▶ NOTE: If flying in ONLY for the day please plan to ARRIVE before 12:00pm and DEPART no earlier than 4:00pm
- ▶ 9am to 4pm CDT: Vendor Displays – Main Event Hangar
- ▶ 9am to 10am CDT: Aviation Weather – Cannon Loughry & Tyler Kirby – Main Event Hangar
- ▶ 10am to 11am CDT: ForeFlight IFR Real World Pro Tips* - Gary Reeves – Small Hangar West of Main Event Hangar

PA-32 FLY-IN SCHEDULE

▶ Saturday, May 21st (continued)

- ▶ 10:30am to 11:15am CDT: Angel Flight Soars - Bernadette Kitts Darnell – Main Event Hangar
- ▶ 11:30am to 1pm CDT: BBQ Lunch Sponsored by Piper Aircraft – Main Event Hangar
- ▶ 11:30am to 12pm CDT: Raffle and Fly-In Committee Introductions – Main Event Hangar
- ▶ 12pm to 12:45pm CDT: Using an Engine Fire to Keep the Ice Off - Gary Reeves – Main Event Hangar
- ▶ 1:45pm to 2:30pm CDT: Women in Aviation - Natalie "flyGirl" Kelley – Main Event Hangar
- ▶ 2pm to 3pm CDT: Mastering GPS Procedures* - Gary Reeves – Small Hangar West of Main Event Hangar
- ▶ 2:45pm to 3:30pm CDT: Ask a DPE - Pete Reddan – Main Event Hangar
- ▶ 7pm to 8:30pm CDT: Dinner at The Rendezvous - 52 S 2nd St, Memphis, TN 38103

▶ Sunday, May 22nd

- ▶ 12pm to 4pm CDT: DEPART Olive Branch Airport (KOLV) – Please use taxiway Foxtrot to exit ramp

PA-32 FLY-IN SCHEDULE



OLIVE BRANCH AIRPORT (KOLV)

8000 Terminal Drive, Olive Branch, MS 662-895-2978

22083

AIRPORT DIAGRAM

AL-5883 (FAA)

OLIVE BRANCH (OL V)
OLIVE BRANCH, MISSISSIPPIFIELD
ELEV
402

ATIS
 119.925
 OLIVE BRANCH TOWER *
 125.275
 GND CON
 121.2
 CLNC DEL
 121.2
 121.3 (When tower closed)

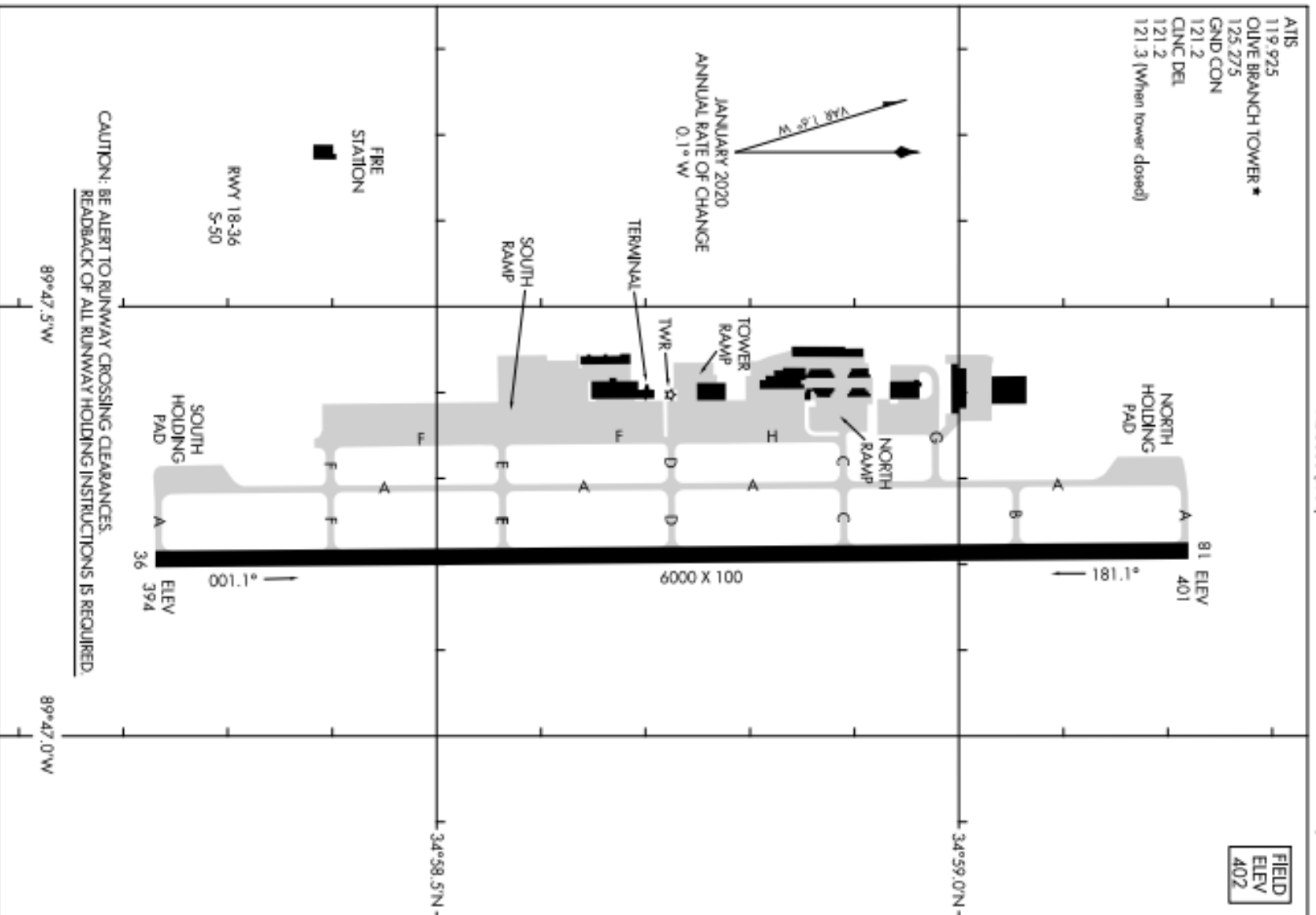

JANUARY 2020
 ANNUAL RATE OF CHANGE
 0.1° W

VAR 1.5° W
 0.1° W

SC-4, 24 MAR 2022 to 21 APR 2022

SC-4, 24 MAR 2022 to 21 APR 2022

AIRPORT DIAGRAM

22083

OLIVE BRANCH, MISSISSIPPI
OLIVE BRANCH (OL V)

OLIVE BRANCH (OLV)(KOLV) 3 NE UTC-6(-5DT) N34°58.73' W89°47.21'

402 B TPA-1602(1200) NOTAM FILE OLV

RWY 18-36: H6000X100 (ASPH-GRVD) S-50 HIRL

RWY 18: MALSR. VASI(V4L)—GA 3.0° TCH 51'.

RWY 36: VASI(V4L)—GA 3.0° TCH 31'. Trees.

SERVICE: S4 FUEL 100LL, JET A QX3 LGT Actvt MALSR rwy
18—CTAF.

AIRPORT REMARKS: Attended 1200-0300Z†; Mon-Fri, 1400-2300Z†;
Sat-Sun. Closed Thanksgiving, Christmas and Easter. Fuel avbl H24
with credit card. Bottle oxygen avbl on request call 662-895-2978.
Read back rprd of all hold back instructions. Twy H clsd except to single
and light twin acft only. Fixed dist mkr. Courtesy van avbl.

AIRPORT MANAGER: 662-895-2978

WEATHER DATA SOURCES: AWOS-3 119.925 (662) 893-5906. LAWRS.

COMMUNICATIONS: CTAF 125.275 ATIS 119.925 UNICOM 122.95

Ⓡ MEMPHIS APP CON 125.8 120.075

Ⓡ MEMPHIS DEP CON 124.15

TOWER 125.275 (1300-0300Z†) **GND CON** 121.2 **CLNC DEL** 121.2

CLNC DEL 121.3 (When twr clsd)

AIRSPACE: CLASS D svc 1300-0300Z†; other times CLASS G.

RADIO AIDS TO NAVIGATION: NOTAM FILE MEM.

MEMPHIS (H) (H) VORTACW 117.5 MEM Chan 122 N35°00.91'

W89°58.99' 102° 9.9 NM to fld. 363/1E.

ILS/DME 109.3 I-OLV Chan 30 Rwy 18. Class IA. Unmonitored when ATCT is clsd.

LOC/DME 111.55 I-EVO Chan 52(Y) Rwy 36.

MEMPHIS

H-61, L-18G

IAP, AD

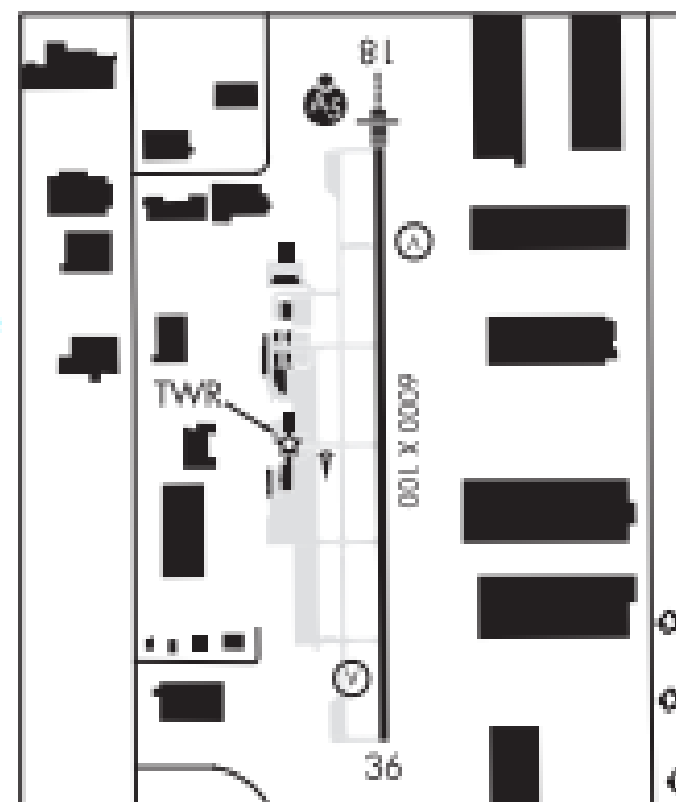

▶ ATIS	119.925	662-893-5906
▶ Olive Branch Clearance Delivery	121.2	121.3 when tower closed
▶ Olive Branch Ground	121.2	0700-2100
▶ Olive Branch Tower	125.275	0700-2100 (CTAF afterhours)
▶ UNICOM	122.95	Olive Branch Aviation – FBO
▶ Contact Butch at Taxiway Echo	123.45	
▶ Flight Service	122.3	Greenwood 24H 800-992-7433
▶ Memphis Approach (East)	125.8	Please contact at 30nm from KOLV
▶ Memphis Approach (West)	119.1	Please contact at 30nm from KOLV
▶ Memphis Departure	125.8	

FREQUENCIES

- ▶ OLV Navigation ILS Runway 18 Distance Measuring Equipment Out of Service.
Expiration estimated
Effective Apr 19 2022, 4:38 AM CDT
Expires May 3 2022, 3:00 PM CDT
- ▶ OLV Taxiway B, C, D, G AND Taxiway A NORTH OF Taxiway D EDGE Light Out of Service
Effective Jan 17 2022, 8:44 PM CST
Expires Dec 30 2022, 8:59 PM CST
- ▶ OLV Instrument Approach Procedure OLIVE BRANCH, OLIVE BRANCH, MS. LOC Runway 36, Amendment 1A... Distance Measuring Equipment REQUIRED EXCEPT FOR AIRCRAFT EQUIPPED WITH SUITABLE RNAV SYSTEM WITH GPS, HLI VORTAC OUT OF SERVICE. Expiration estimated
Effective Feb 4 2022, 9:38 AM CST
Expires Sep 16 2022, 10:38 AM CDT
- ▶ OLV Instrument Approach Procedure OLIVE BRANCH, OLIVE BRANCH, MS. ILS OR LOC Runway 18, Amendment 3A... Distance Measuring Equipment REQUIRED EXCEPT FOR Aircraft EQUIPPED WITH SUITABLE RNAV SYSTEM WITH GPS. RADAR REQUIRED FOR PROCEDURE ENTRY EXCEPT FOR Aircraft EQUIPPED WITH SUITABLE RNAV SYSTEM WITH GPS, HLI VORTAC OUT OF SERVICE. Expiration estimated
Effective Feb 4 2022, 9:38 AM CST
Expires Sep 16 2022, 10:38 AM CDT

KOLV NOTAMS

*showing airport NOTAMS only
current as of April 20, 2022*



1. The control tower requests that everyone check in with Memphis Approach on **125.8** (East) **119.1** (West) at 30nm out. That way, everyone will be checked into the ATC system prior to contacting the tower.
2. Expect taxiway Echo to enter fly-in parking. This is shown in red. Butch Mauldin will be standing at Echo with a handheld and a sign telling them to tune into my frequency. We will be using **123.45** for fly-in coordination. Butch will then ask them if they need a tie down or if they are ok with chocks.
3. Anyone who is ok with chocks will be sent to the yellow area (left turn off Echo).

PA-32 FLY-IN NOTAM



4. Anyone who needs to be tied down will be led to the **green** area (right turn off Echo). **Please bring your own tie down ropes!**
5. If we run out of tie downs in the **green** area, we will lead them to the **blue** area (on Friday). Then, on Saturday, we will have anyone tied down in the **blue** area, move their planes to the **yellow** area (if they want to) in order to have all the airplanes parked together for walk around during the day
6. When departing leave ramp on taxiway Foxtrot.

PA-32 FLY-IN NOTAM

▶ Fly-in Store:

- ▶ <https://pa-32-owners-pilots.myshopify.com/collections/all>

▶ Fly-in Registration

- ▶ \$100 per aircraft (not per person) to help us cover the cost of portable bathrooms, transportation, and other fly-in support expenses

▶ Dinners

- ▶ \$75/person (tip included) Friday night at Texas de Brazil. *There will be two dinner time options 6:45pm and 8pm CDT*
- ▶ \$65/person (tip/beer included) Saturday night at The Rendezvous. *There will only be one dinner time option at 7pm CDT*

▶ T-Shirts

- ▶ Ordering has closed

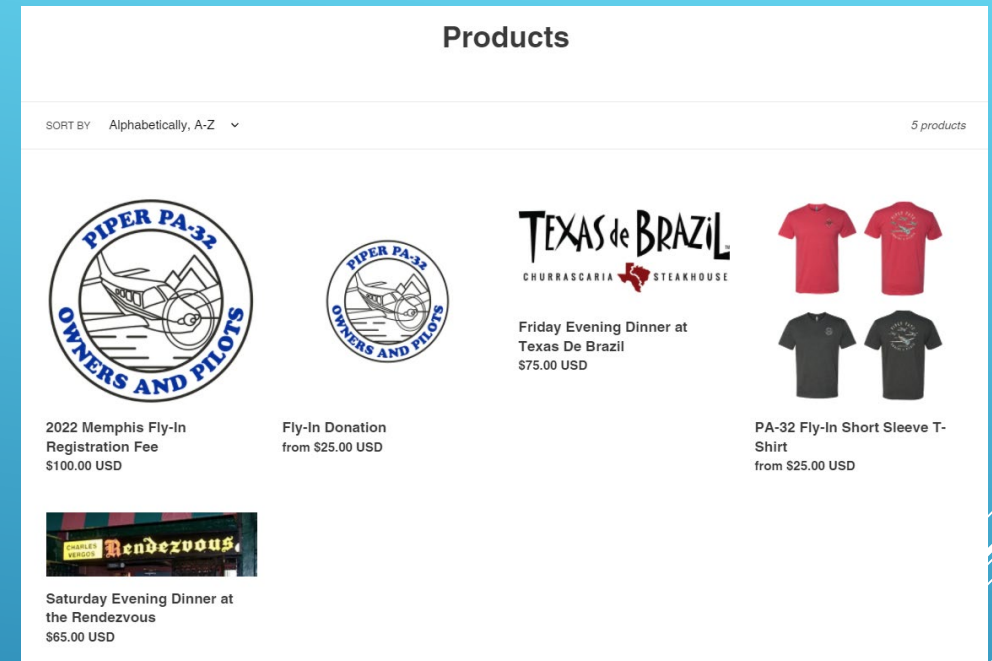

MERCH & ENTERTAINMENT

Raffle will be held on Saturday, May 21st from 11:30am to 12pm CDT

Main raffle items shown below will require tickets (1 ticket for \$25 or 5 tickets for \$100)
any fly-in proceeds after expenses will be donated to *Angel Flights* and *Pilots to the Rescue*

The secondary raffle will have over 35 items

There are no tickets required for the secondary raffle. Your \$100 Fly-in registration fee enters you into the secondary raffle. Be sure to fill out the registration form when you arrive.

You must be present to win raffle items



LightSpeed Zulu 3



Garmin D2 Air Watch



Aerox ProO2 Plus System



ForeFlight Sentry



Sporty PJ2 Radio

PA32 FLY-IN RAFFLE

- ▶ The Peabody is located 25 miles NW of KOLV and is 38 minute drive
- ▶ Two 25 passenger buses will be available for transportation from KOLV to the Peabody running every hour
- ▶ Transportation Hours
 - ▶ Friday: 2pm to 8pm
 - ▶ Saturday: 7:30am to 7pm
 - ▶ Sunday: 7:30am to 12pm



TRANSPORTATION

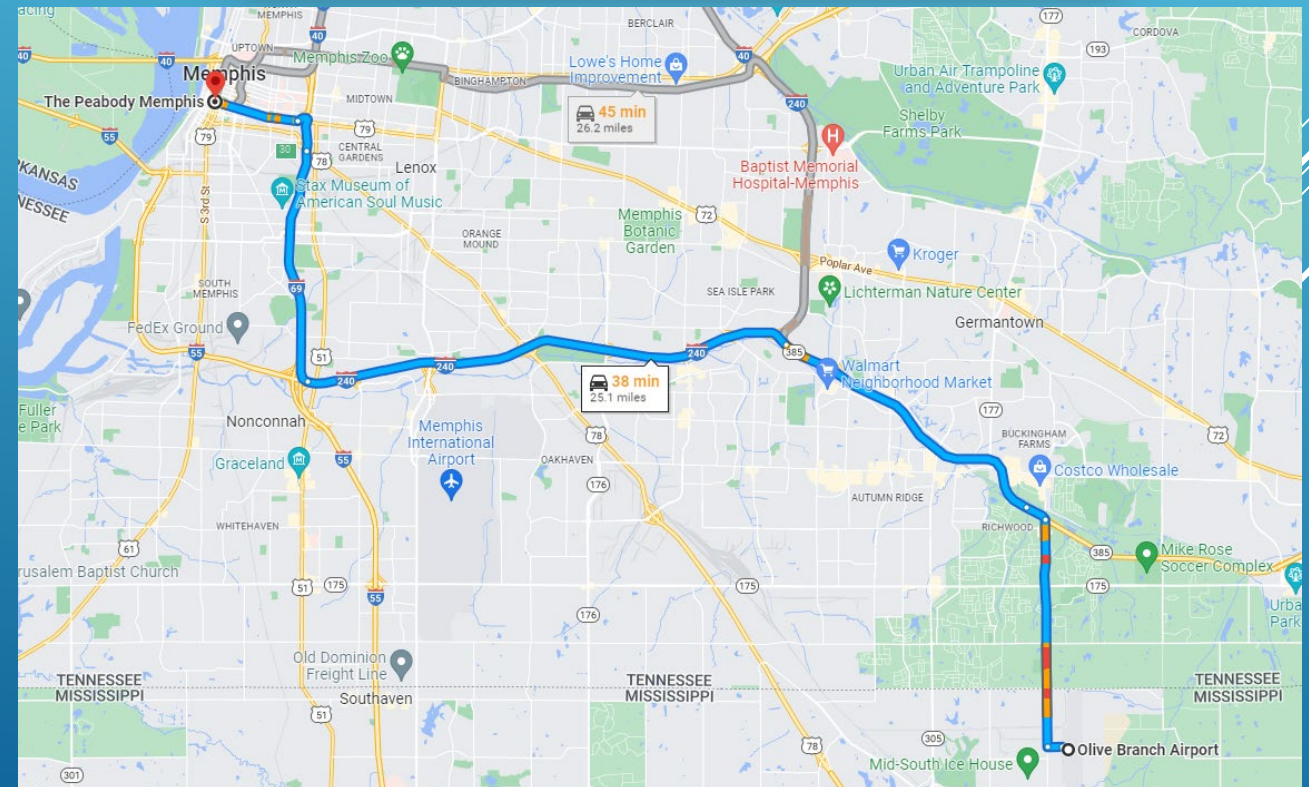

- ▶ Fly-In Website: www.pa-32.com
- ▶ To receive Fly-In updates text **PA32** to **901.472.7940**
- ▶ To help KOLV and Fly-in staff plan for your arrival please complete our [Fly-in Arrival Form](#)
- ▶ [Fly-In Downloads](#)
- ▶ [FlightAwareTV](#) showing all PA32s

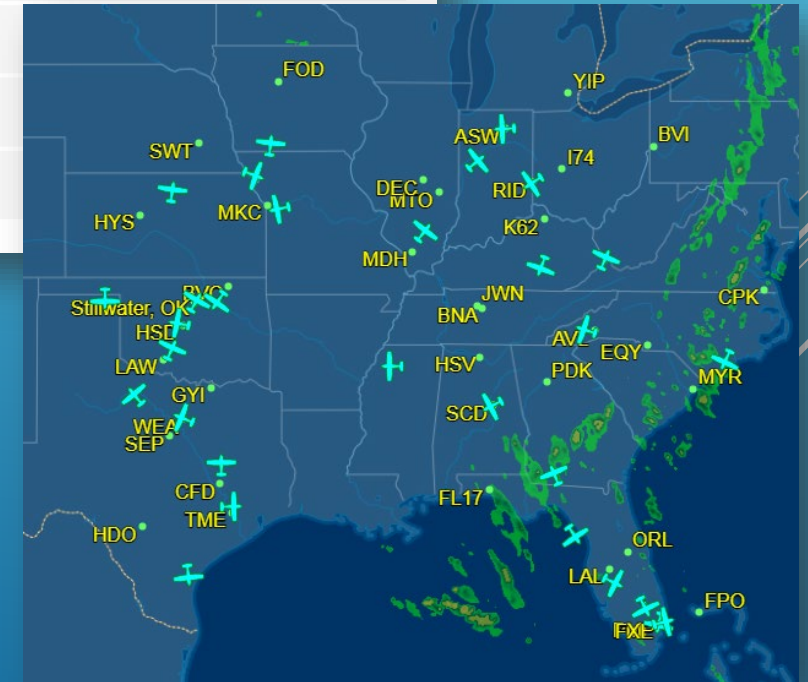
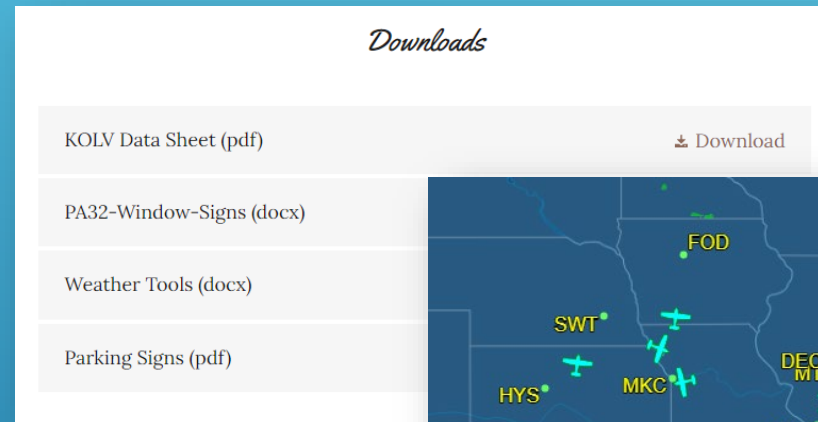

ADDITIONAL INFORMATION

Please remember to bring tie downs for attachment to line on the pavement / concrete buckets or chocks. Grass tie downs would be helpful as a backup.

We would also appreciate donations of bottled water and hand sanitizer for the event

REMINDER

N121HE

1979 Piper Cherokee Six 300

Based in Murfreesboro, TN (KMBT)



Owner

Cannon Loughry

615.347.3464

WINDOW SIGNS

PARKING LOCATION SIGNS

Please print and bring with you



YELLOW

Use this sign if you are OK parking with chocks only

GREEN

Use this sign if you are would like to park at a tie-down.
BE SURE TO BRING YOUR OWN ROPES