

🕒 Completion - DEC 2026

# Mercedes-Benz Places by Binghatti

Binghatti

BINGHATTI  
بن عاتقي

Binghatti

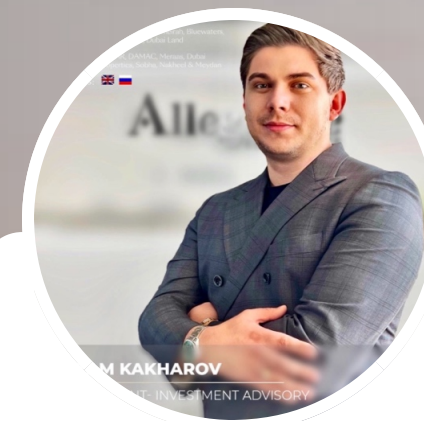

**Rustam Kakharov**

Dubai, United Arab Emirates

🛡️ **Verified Agent**

Phone 971585869577

Email rustam@allegiance.ae

Website

Instagram: rus\_kakharov

WhatsApp

Email



# Mercedes-Benz Places by Binghatti

 Furnishing - Furnished  
& Unfurnished

 Parking -

 Floors - 3B + G + 5P +  
65floors

 Service charge - 20-30  
AED/sqft

## Project general facts

Introducing Mercedes-Benz Places | Binghatti: A gateway to experience new grounds for extraordinary moments. A combination of intelligence and emotion, glamour and simplicity, and historic legacies eager towards a future of infinite possibilities. Mercedes-Benz Places | Binghatti explores the creation of concepts that are from tomorrow. In line with the philosophy of Sensual Purity, there is created spectacular propor...



# Project Facts

Developer name

Binghatti Developers

Project name

Mercedes-Benz Places | Binghatti

Property type

Residential Hyper-Tower

---

Suite Types (Level 12 to 52)

**The Mercedes-Benz Pagoda Suite**

2 Bedroom | Level 12-31 (140 - 170 sq.m)

**The Grand Mercedes Suite**

3 Bedroom | Level 34-52 (200 - 215 sq.m)

---

Penthouses (level 55-66)

**The Mercedes-Benz  
Vision One Eleven Penthouse**

4 Bedroom Penthouse | Level 55-58 (245 - 280 sq.m)

**The Mercedes-Benz Gullwing Penthouse**

5 Bedroom Penthouse | Level 59-61 (623-667 sq.m)

**The Mercedes-Benz  
Vision EQ Silver Arrow Penthouse**

Duplex Penthouse | Level 62-63 (1160 sq.m)

**The Mercedes-Benz  
Uhlenhaut Coupé Penthouse**

Triplex Penthouse | Level 64-66 (1620 sq.m)

Ownership

Freehold

Location

Downtown Dubai

Total number of floors

(3B + G + 5P + 65 Floors)

Number of mechanical floors

6

Total Number of residential floors

51

Total number of amenities floors

3 + HC

Ceiling height

4.2 m (Slab to slab)

Total number of units

150

Building height

341 M

Unit type

Furnished / Unfurnished



# Exclusive features and services



SOLAR PHOTOVOLTAIC  
TECHNOLOGY



LEED  
CERTIFICATION\*



PENTHOUSES  
PRIVATE PARKING



ACOUSTIC  
SYSTEM



SMART  
SYSTEM



SPA  
SERVICE



SKY INFINITY  
POOL



PRIVATE  
POOL



PODIUM  
POOL

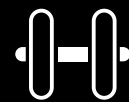

GYM



CONCIERGE  
SERVICE



PARKING  
ACCESS CARD



FOOD &  
BEVERAGE



VALET  
SERVICE



HOUSE  
KEEPING

\*The Mercedes-Benz Places | Bingham is aiming to hold a LEED Qualification.

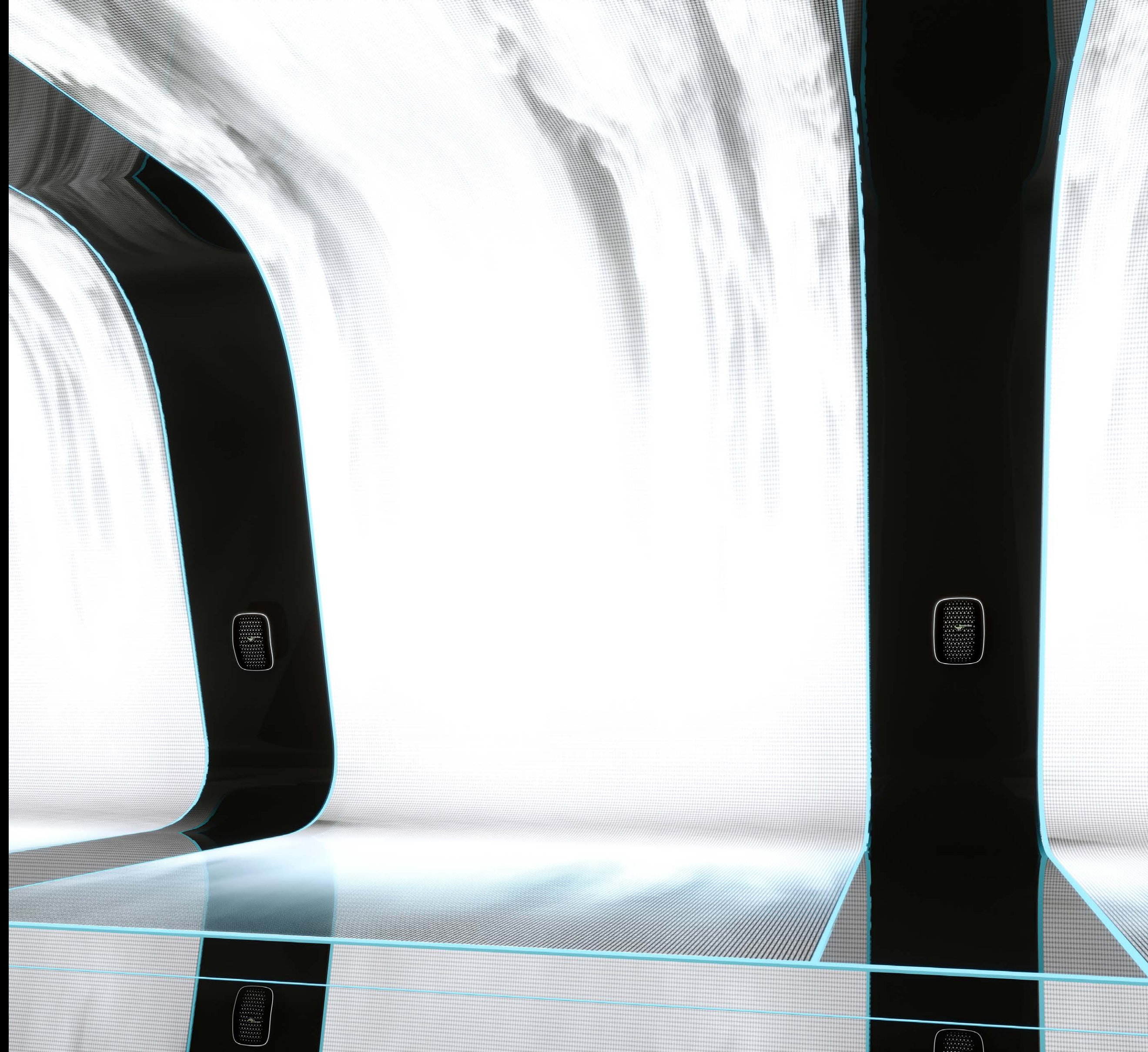

# The Map

JUMEIRAH PUBLIC BEACH  
7.7 KM | 15 MINUTES

BURJ KHALIFA  
3 KM | 10 MINUTES

DOWNTOWN DUBAI  
1.1 KM | 4 MINUTES

DUBAI MALL  
3 KM | 7 MINUTES

DUBAI INTERNATIONAL  
FINANCIAL CENTRE  
3 KM | 7 MINUTES

EMIRATES TOWERS  
4.9 KM | 11 MINUTES



# Located in the heart of Downtown Dubai

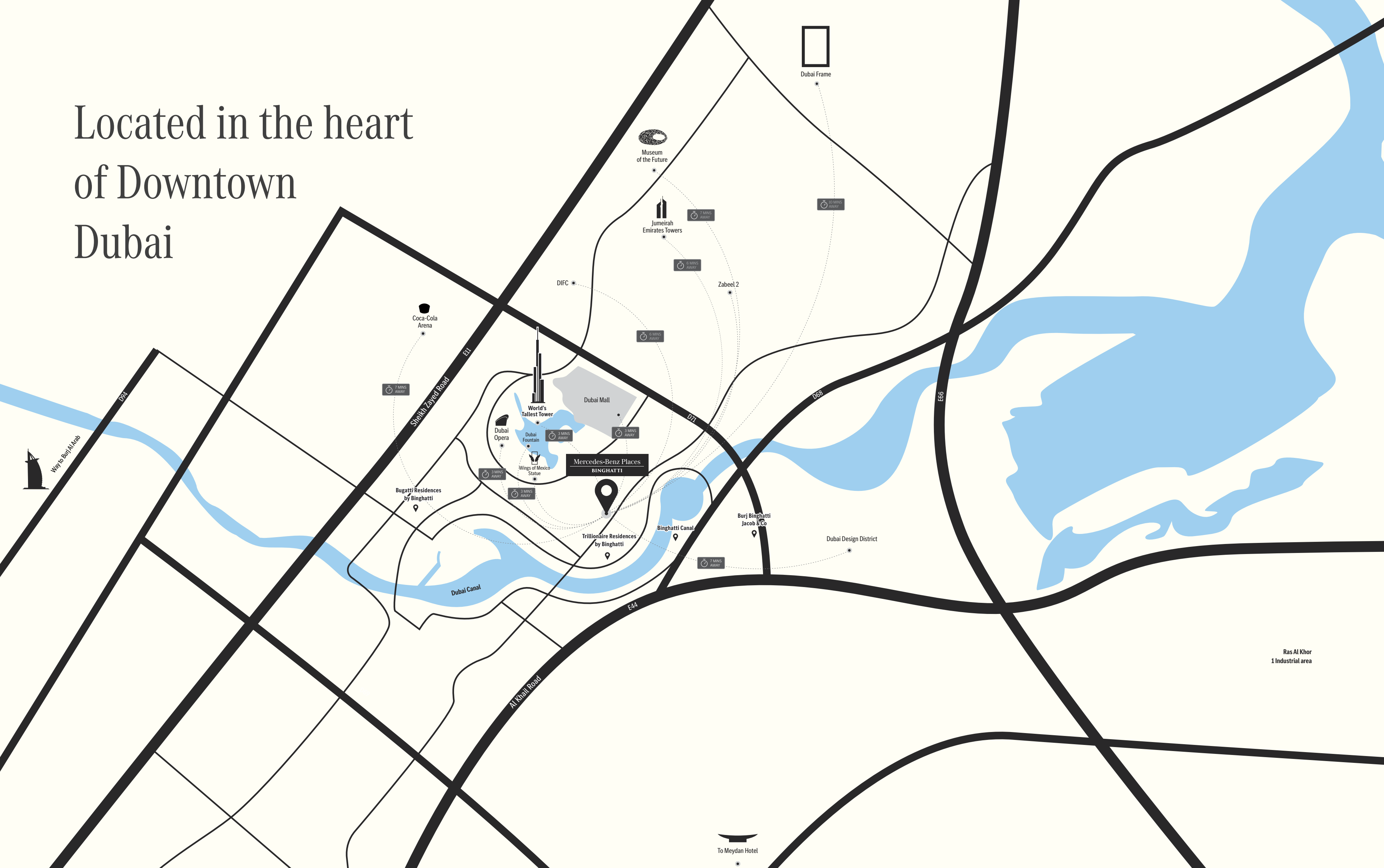



Mercedes-Benz Places  
BINGHATTI





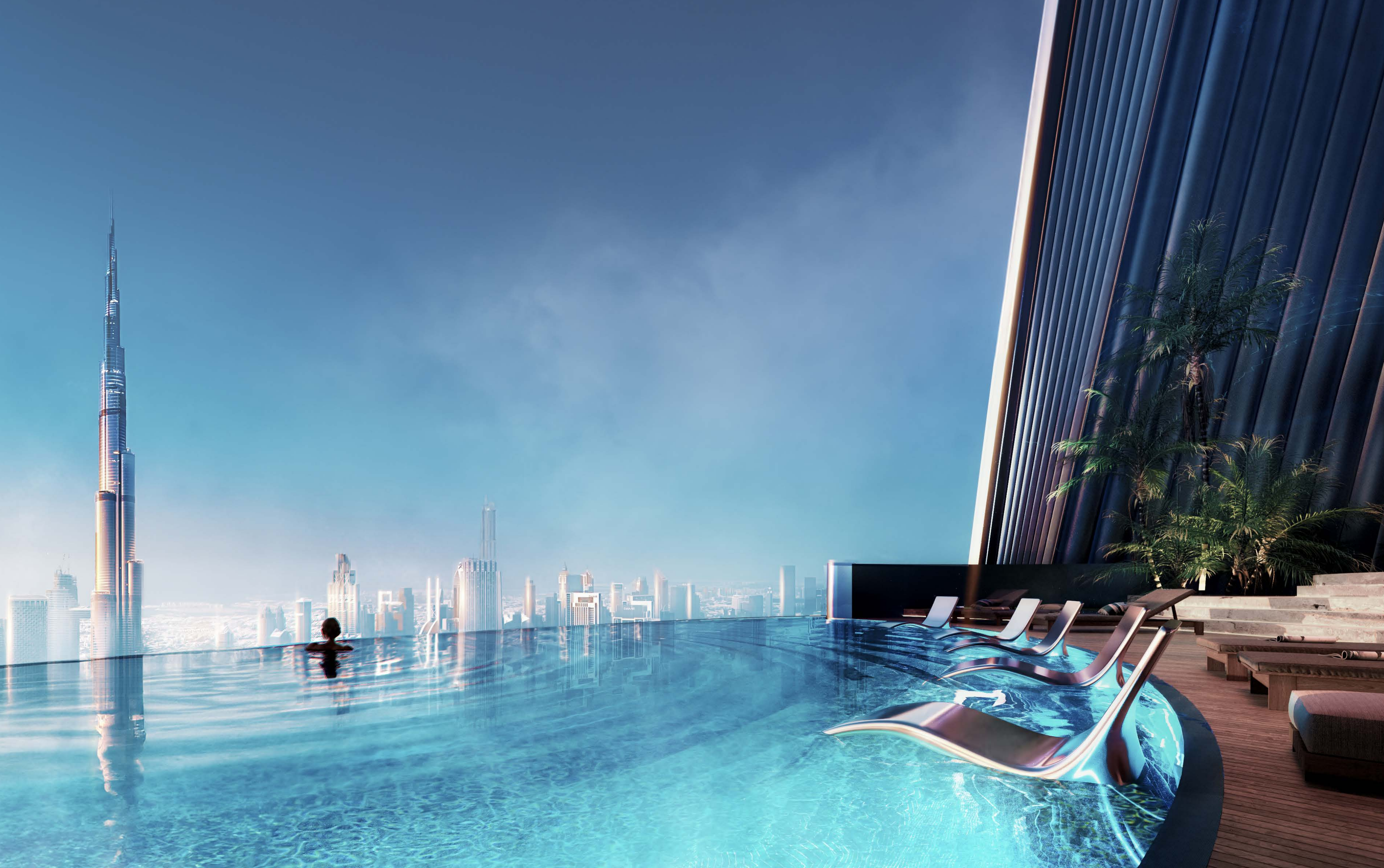







Mercedes-Benz Places  
BINGHAGGI

A paradigmatic  
demonstration of a form  
beyond comparison

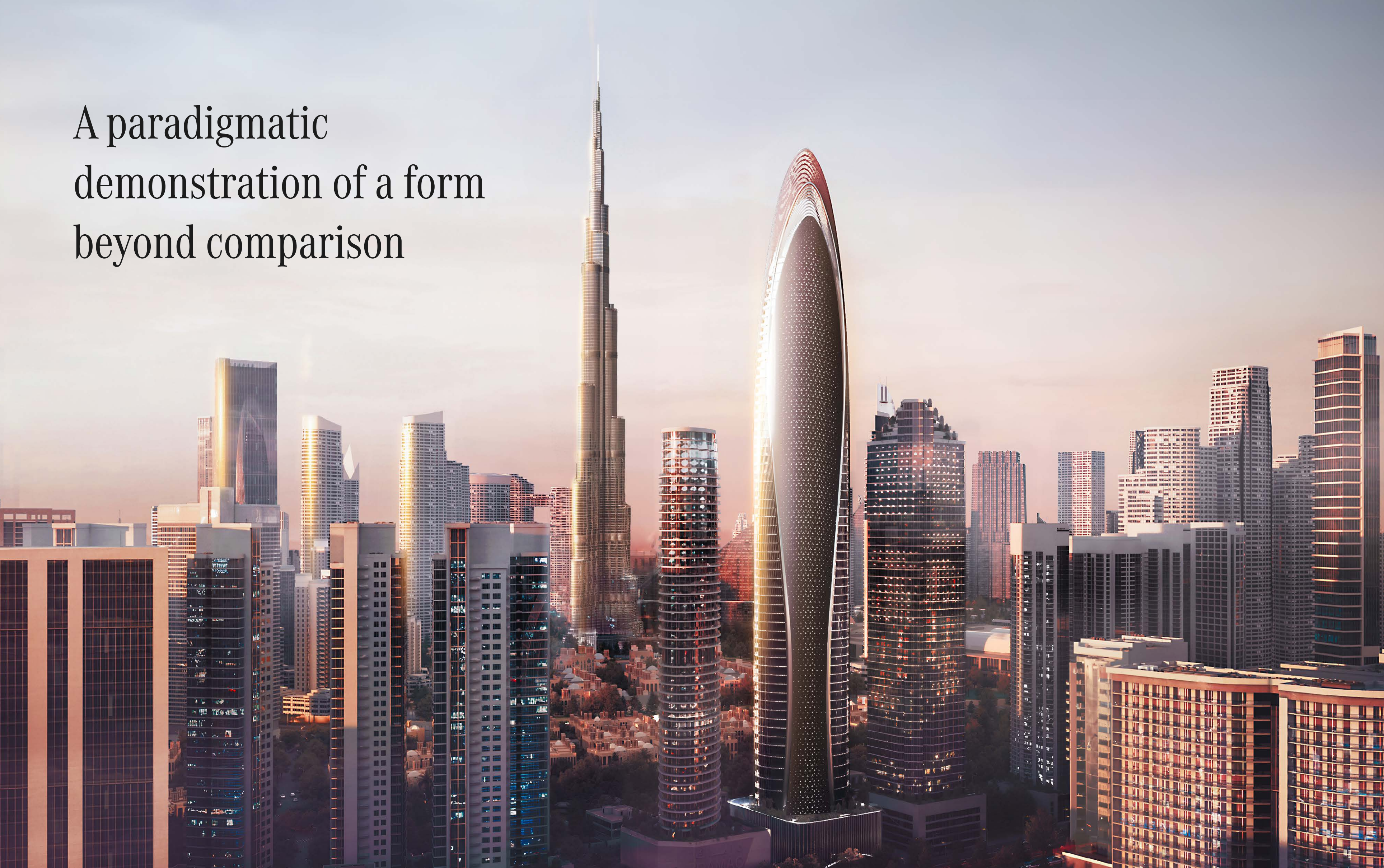

# Interior



# Conspicuous dexterity

A selection of the finest materials, seamlessly integrated



Travertine



Fluted Travertine



Walnut Wood



Fluted Walnut Wood



Stucco Paint



Satin Chrome



Leather



Black Gloss Glass



Mirror

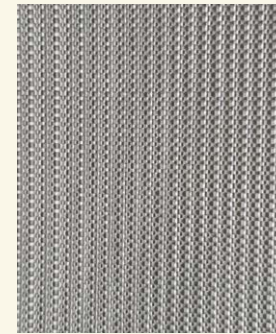

Sandwich Glass

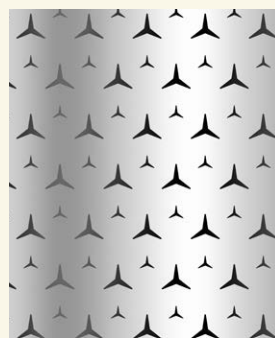

Chrome Mesh



Parquet



Gaya Marble

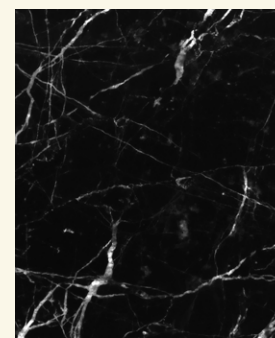

Black Granite



Screen

\*All finishes are subject to change without notice at our sole discretion for any reason including for aesthetic purposes.



# Location



Open location in Google Maps





# Facilities



**Sky Infinity Pool**

Visualisation from developer

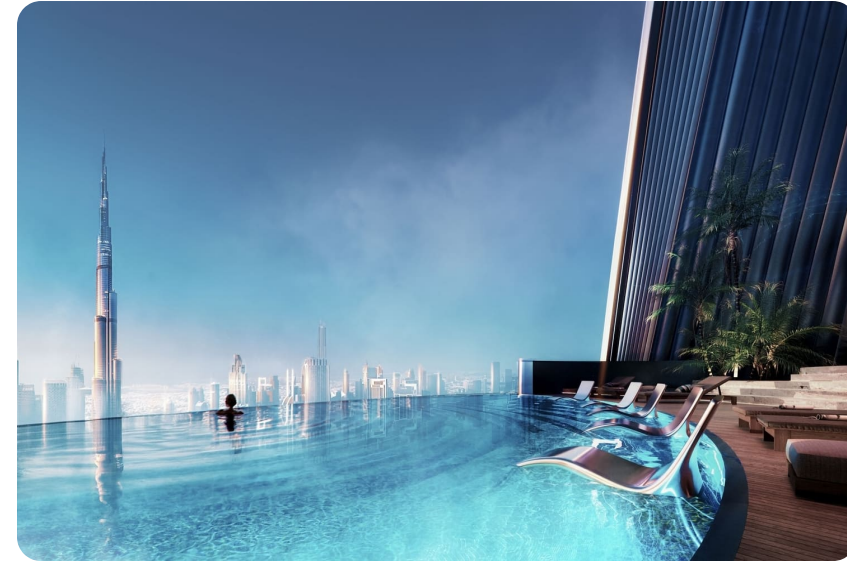

**Private Pool**

Visualisation from developer



**SPA**

Image for general understanding



**Podium Pool**

Visualisation from developer



**Gym**

Image for general understanding



**Concierge Service**

Image for general understanding



**Food & Beverage**

Image for general understanding

# Payment plan



## Payment Plan

20% payment	On booking
5% payment	3 months after booking
3% payment	5 months after booking
3% payment	7 months after booking
3% payment	8 months after booking
3% payment	10 months after booking
3% payment	12 months after booking
3% payment	14 months after booking
3% payment	16 months after booking
3% payment	18 months after booking
3% payment	20 months after booking
3% payment	22 months after booking

3% payment	24 months after booking
3% payment	26 months after booking
3% payment	28 months after booking
3% payment	30 months after booking
3% payment	32 months after booking
30% payment	Upon Handover

---

**Condition for the unit resale**

**Not specified**

# Typical units and prices



**Apartments**      **2 bedroom**

FROM **AED 10,499,999**      TO **AED 14,499,999**

1836 sqft / 171 m<sup>2</sup>      2586 sqft / 240 m<sup>2</sup>



**Apartments**      **3 bedroom**

FROM **AED 20,299,999**      TO **AED 25,099,999**

2762 sqft / 257 m<sup>2</sup>      3264 sqft / 303 m<sup>2</sup>



**Penthouse**      **4 bedroom**

FROM **AED 36,299,999**      TO **AED 36,799,999**

4010 sqft / 373 m<sup>2</sup>

# Typical units and prices



**Penthouse**

**5 bedroom**

FROM

**AED 89,000,000**

6591 sqft / 612 m<sup>2</sup>

TO

**AED 99,000,000**

6969 sqft / 647 m<sup>2</sup>



**Penthouse**

**6 bedroom**

FROM

**AED  
149,000,000**

11196 sqft / 1040 m<sup>2</sup>

TO

**No info**



**Penthouse**

**7 bedroom**

FROM

**AED  
199,000,000**

14136 sqft / 1313 m<sup>2</sup>

TO

**No info**

**Do you have any questions? Contact me.**



**Rustam Kakharov**

Phone 971585869577  
Email rustam@allegiance.ae  
Instagram rus\_kakharov

