

TruStile offers architectural-grade, square corner, ball bearing hinges custom built to its specifications.

Doors that are ordered pre-hung receive 4" hinges on 1-3/4" and 2-1/4" doors, while 1-3/8" doors receive 3-1/2" hinges.

4-1/2" hinges are available for 1-3/4" and 2-1/4" doors. Hinges can also be ordered for TruStile doors not pre-hung at the factory.

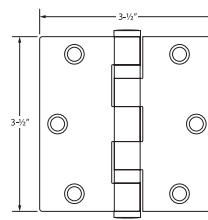

3-1/2" Hinge

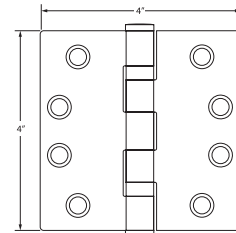

4" Hinge

Available Finishes



US3 Bright Brass

US4 Satin Brass

US5 Antique Brass

US10A Antique Bronze

US10B Oil Rubbed Bronze



US15 Satin Nickel

US15A Antique Nickel

US17A Dull Black

US26 Polished Chrome

US26D Satin Chrome