

**SECTION 5**

**ARM ELECTRICAL**

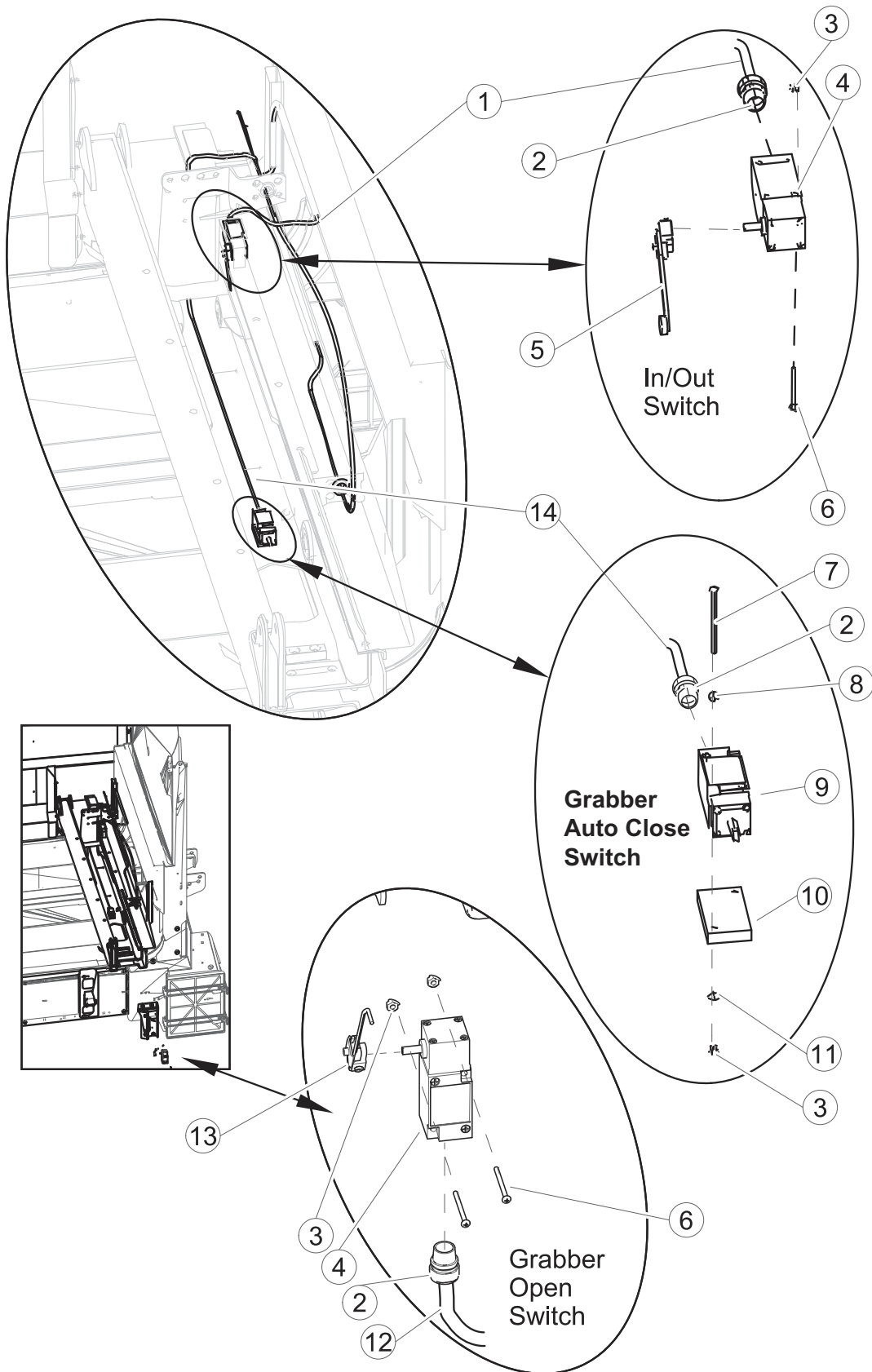

**ARM ELECTRICAL**

REF. NO.	PART NO.	DESCRIPTION	QTY.
1	27584	HARNESS	1
2	ELC00140	CONNECTOR	3
3	QUE01070	NUT	6
4	ELI00550	SWITCH	2
5	ELI00852	ACTUATOR	1
6	QUV01925	CAPSCREW	4
7	QUV01965	CAPSCREW	2
8	QUB47500	SPACER	2
9	ELI00530	SWITCH	1
10	64677	SPACER	1
11	QUR01600	WASHER	2
12	66752	HARNESS	1
13	81718	ACTUATOR	1
14	27744	HARNESS, Standard Arm	1
	94338	HARNESS, Long Reach Arm	1