

CROSS SECTION

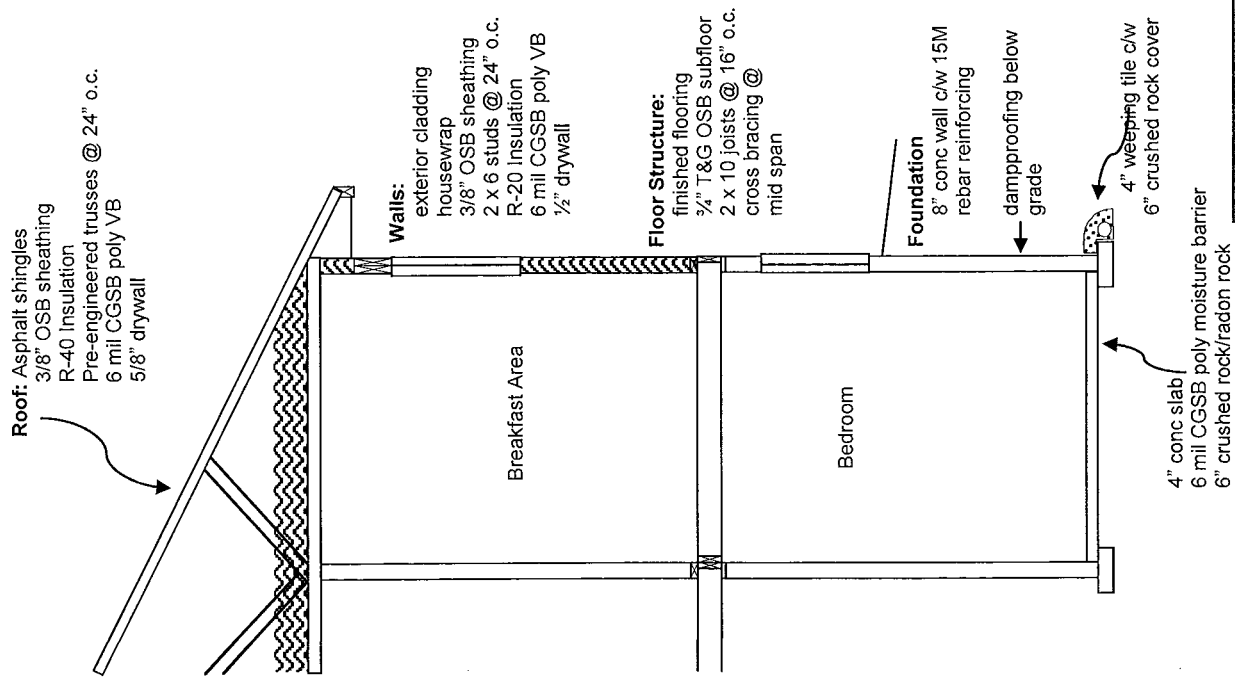

FOUNDATION

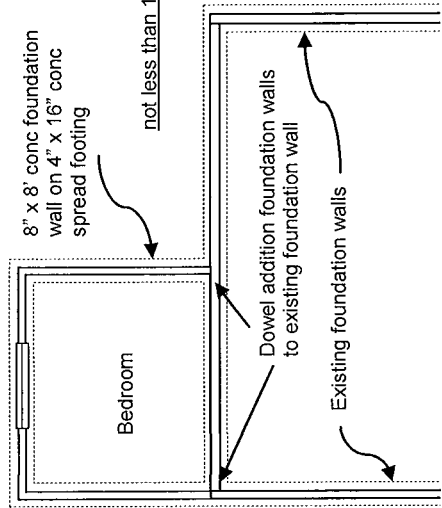

SITE PLAN

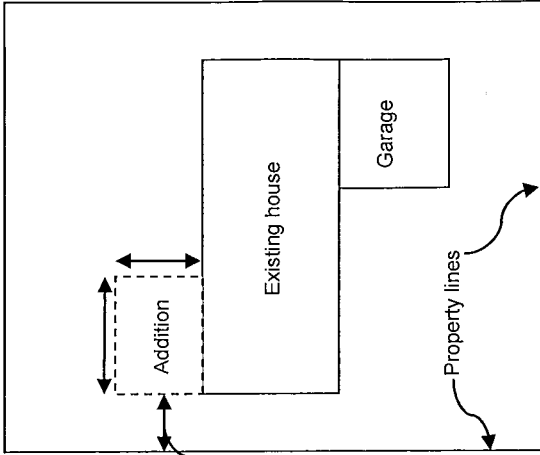

The following information must be submitted with the building permit application:

- Foundation details:** type of foundation (concrete or PWF), dampproofing material, drainage around the foundation, lintel (header) details of any openings within the foundation wall.
- Floor structure:** the type of floor constructed (joist size and spacing), how anchored to the existing building, if and how the floor will be supported (i.e. floor beams, columns, column pads), the subfloor thickness and material (plywood or OSB).
- Wall structure:** the wall stud size and spacing, the wall sheathing, all window opening sizes and headers, insulation type (batt or spray foam), vapour barrier, interior finishes. Exterior air barrier and finishes must be provided.
- Roof structure:** provide details of the roof construction. If pre-engineered trusses are installed, provided a truss layout. Indicate the location and size of the attic access, roof sheathing and thickness, insulation, roofing material installed and the number, location and size of roof vents.
- Floor plan:** a drawing indicating the use of all rooms, including the basement (if undeveloped indicate on the drawing) and how access will be provided to the rooms.
- Elevations:** provide detailed drawings of all walls indicating the location of windows, doors and exterior finishes
- Interior changes:** are any new openings being constructed? What size are the header being installed? Is ventilation of these rooms required? **Provide details of all changes.**

DWELLING ADDITION SAMPLE DRAWING