

# Let's talk about the Room!

You're going to arrive to the dorm room and it's going to be laid out very **awkwardly**, they always are.....bed on one side, dresser/desks on the other, or in many cases the dressers are in the closets. If you've ordered a micro/frig it will be in the most conveniently located spot for the delivery staff who put it there. Take a **deep breadth** and know you are going to **change** this layout/floor plan immediately! If you are mom or dad, being the voice of **reason & calm** goes a long way in this exact moment! Also, you can discuss the floor plan before you arrive, which will also help quell any anxiety upon entry! I'm including some **improved floorplans** as starting points on the next pages. But know that once in the room there might be some **curveballs**.

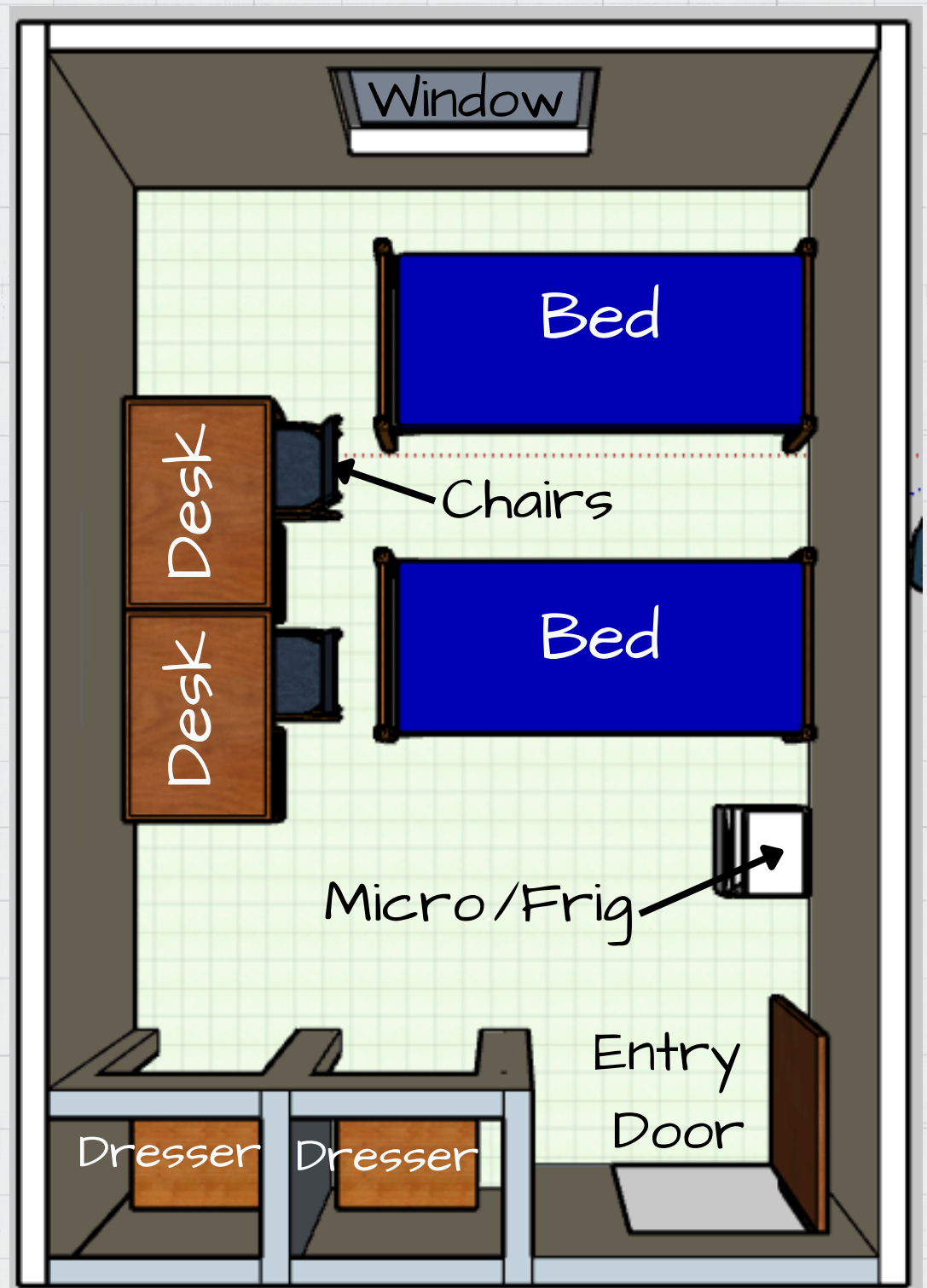

The floor plan above represents a very **typical freshman** double occupancy dorm room that is 12' wide with one central window and 15' long to the closets, the closets add another 2'-6" to the room for a total length of 17'-6". Some closets will have doors others will not.

# Typical Dorm Floorplan #1

This floorplan is really going to start to **change the dynamic** of the space, giving each person their **own area**, in as much as can be achieved in this small environment! This likely represents most of what you have seen in some media already. **This is a good layout.** Only negative is that in some situations based on the furniture the college/university offers the dressers might encroach on the window. Still it's a trade off for **personal space!** It also doesn't create any hierarchy in the space deeming one bed more preferential than the other. If you can accomplish this layout I would certainly recommend it. In this layout beds can be additionally lofted or just elevated a bit more to provide for added storage underneath.

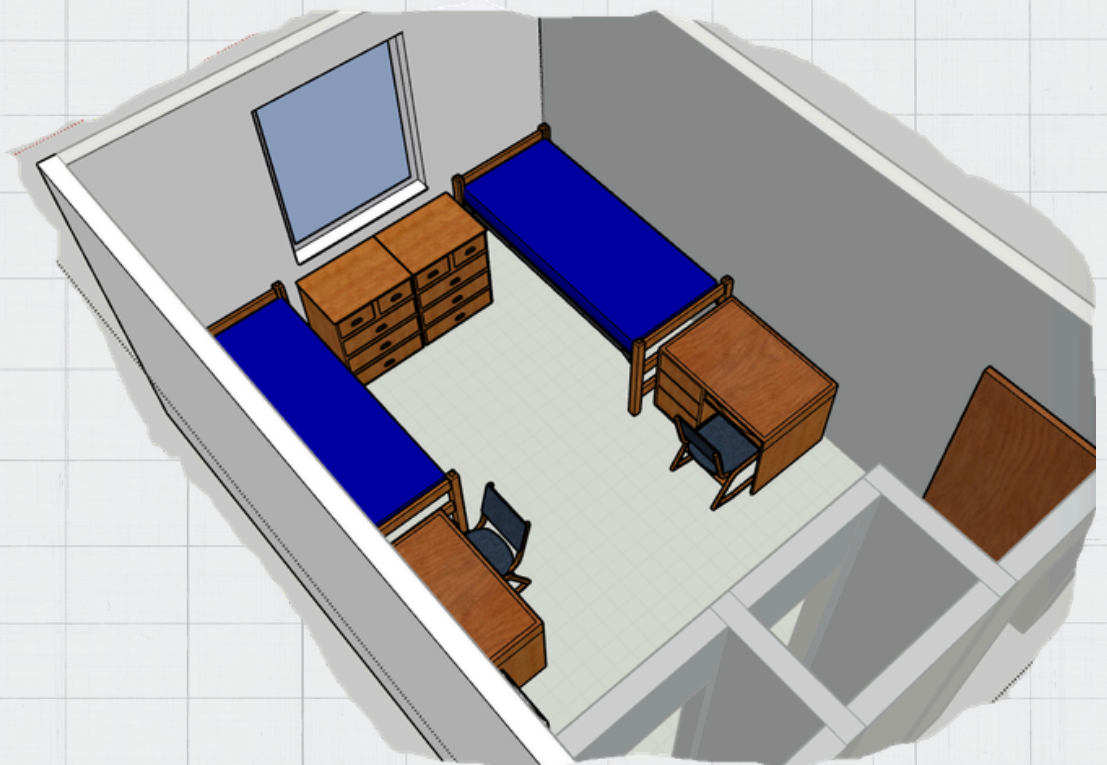
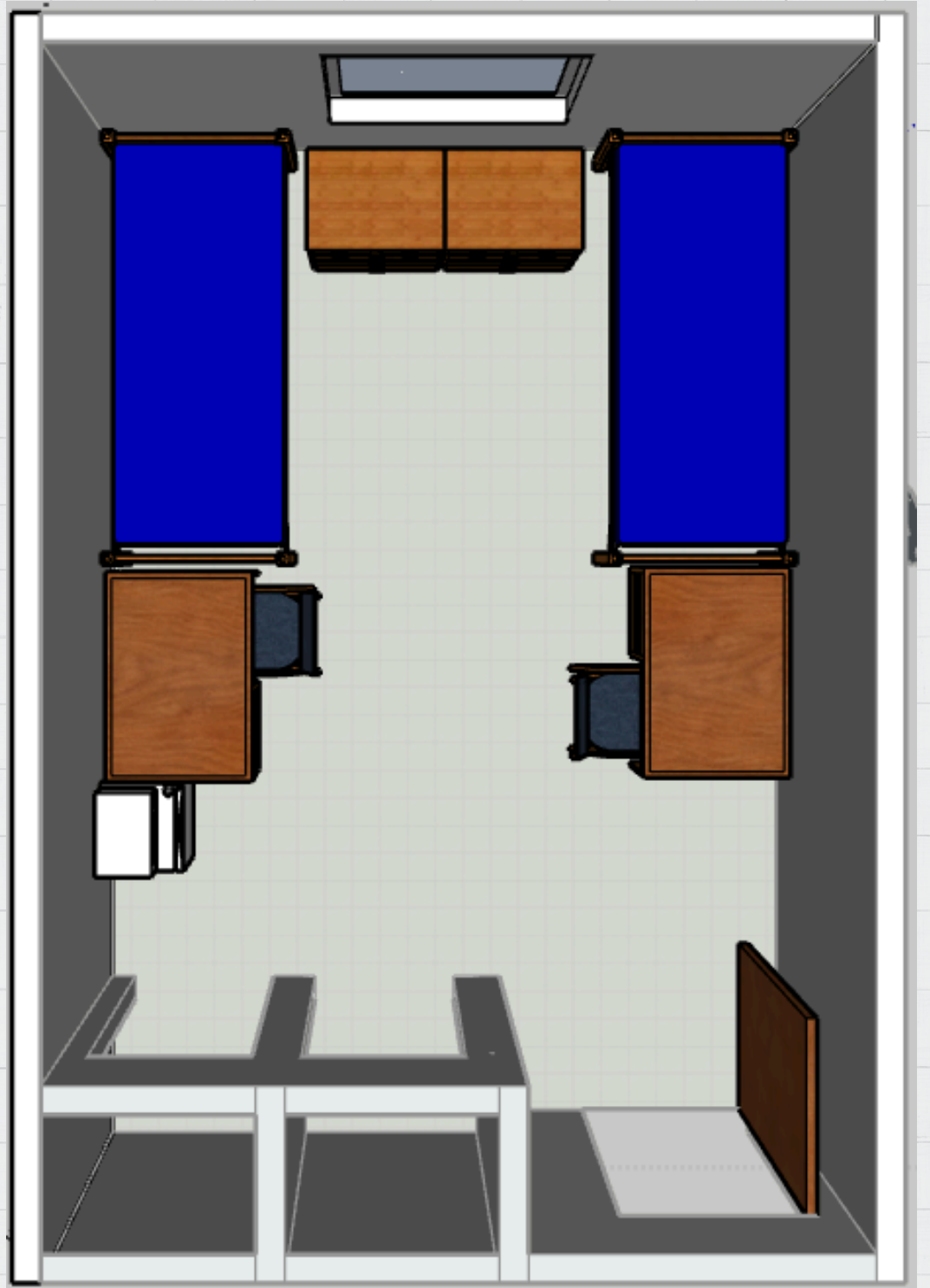

# Typical Dorm Floorplan #2

Just a slight variation on Floorplan #1, moving one of the dressers into the closet (if a roommate is willing to do so, allows for the area by the windows to open up, for either one larger shared dresser, we like this one because it still feels divided with drawers on each side for each person. Alternately individual night stands could be purchased and used in this configuration by the window. Storage that would incorporate the micro/frig could be accommodated by the window and if there are no doors on the closets then the dresser could move out of the closet and mirror the right side of the plan. Again the beds could be **lofted** (puts mattress at approximately **60"-66"** off the floor) or **lifted** (which is more like **32" to 37"** off the floor)

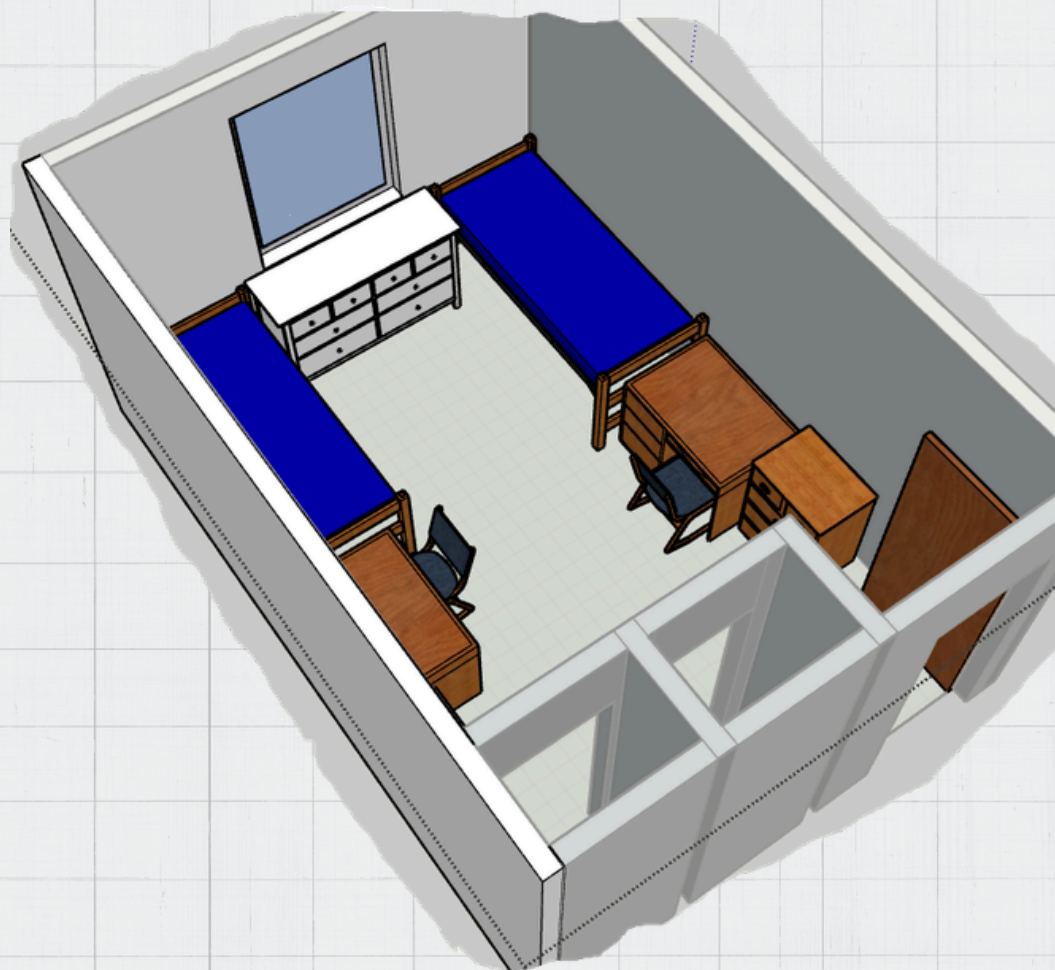
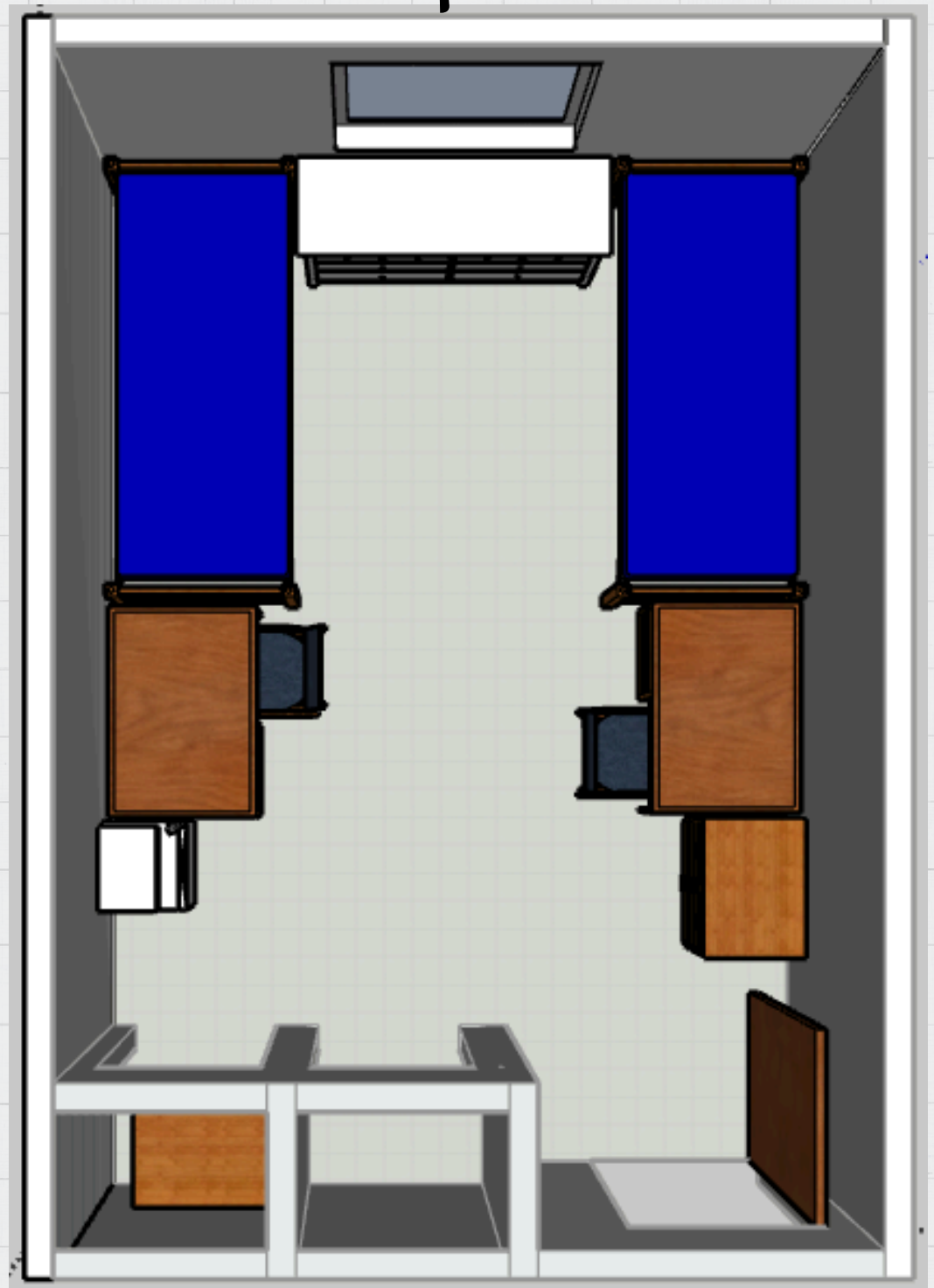

# Typical Dorm Floorplan #3

This plan represents a **fully lofted bed** (mattress 60"-66" off the floor). Allows for the dressers to go under the bed; the desks could go under as well **freeing up even more floor area**. It is important to continue to maintain divided personal space. It might be tempting to put the micro/frig under one roommate's lofted bed, but I would caution that unless they know each other well and won't feel that there is any issue of **infringement on personal space**. Other tricks for this layout are, you have to consider some type of **elevated surface** for all the things needed like a lamp, phone, charging, books, ect....a tall bookcase can work well here but other options include using a storage headboard either a twin at the head or a king along the side, **I'll be diving into this more in later plan reviews.**

