



## NON-MARRING FORK CAP WRENCH

Thank you for purchasing our NON-MARRING FORK CAP WRENCH set. This guide will help you assemble the wrench with the insert for proper use. This wrench set is compatible with many different forks currently out on the market, with updates on newer forks coming soon. If you find you need a new insert, please contact Factory Wrench® for your needs.

This wrench will work with all Factory Wrench® Tools inserts. No need to buy new wrenches for new forks, just update the insert.



There is a lifetime warranty on this product. If any defects in workmanship or manufacturing occur, please contact Factory Wrench® Tools LLC for replacement.

To use the non-marring fork cap wrench correctly, follow the guidelines listed:

- First, grab the main wrench handle (62-8000, Part 2)
- Next, select your correct insert for your work piece (Part 1)

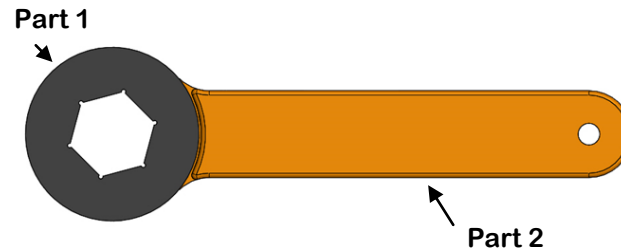

- Loosen the small set screw located on the top of the wrench. (Pic 1) A small screwdriver is included with the kit. This screw puts tension on the retaining pin to help hold the insert in place during use. You may have to loosen it to install the insert, then re-tighten it once the insert is installed.

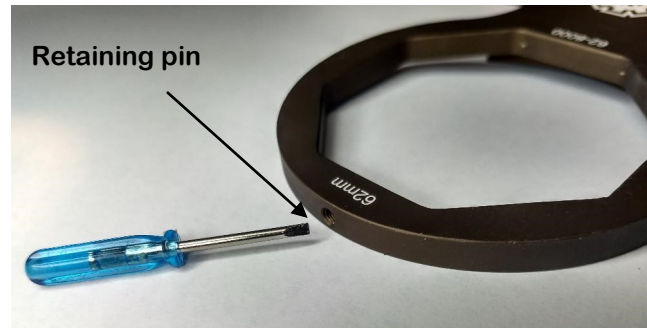

Pic 1

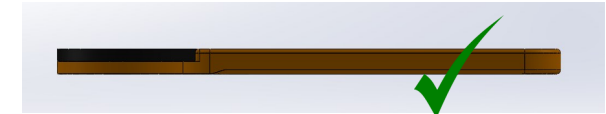

Fig 4

As you can see from the image above, once the insert is inserted it should be flush with the wrench.

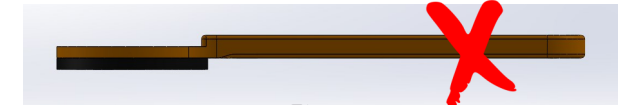

Fig 5

This is an insert incorrectly installed (Fig 5)

After selecting the proper insert needed for your work piece, place them on the top of the fork and loosen. Use the lower tool to hold the main fork cap in place while using the upper tool to loosen the inside fork cap.



Proper wrench set up

