



**BioTwin**

# **Bio-materials for Low-Carbon Construction**

April 2026



# DISCLAIMER

*This presentation has been prepared for general informational purposes only and does not constitute, and should not be relied upon as, legal, financial, regulatory or other professional advice.*

*The content reflects the presenter's views as at the date of the presentation and may be subject to change without notice.*

*Any financial projections, estimates or forward-looking statements included in this presentation are indicative only, are based on assumptions that may not materialise and are not guarantees of future performance. No representation or warranty, express or implied, is made as to the accuracy, completeness or reliability of such projections, and no responsibility or liability is accepted for any loss arising from reliance on them.*

# EXECUTIVE SUMMARY



**BioTwin**

# THE PROBLEM

- **Building codes and market preference increasingly require use of lower carbon materials in tenders for construction projects**
- **Steel is one of the principal components used in building construction and has high carbon content**
- **Steel is not easy to replace as part of the structure or frame of a building, but it is also a key component in interiors, most importantly in the use of steel studs as frames for internal walls**
- **If steel could be replaced with lower carbon materials in building interiors, it would go a long way to meeting net zero targets and other regulations requiring reduction of carbon content in construction**

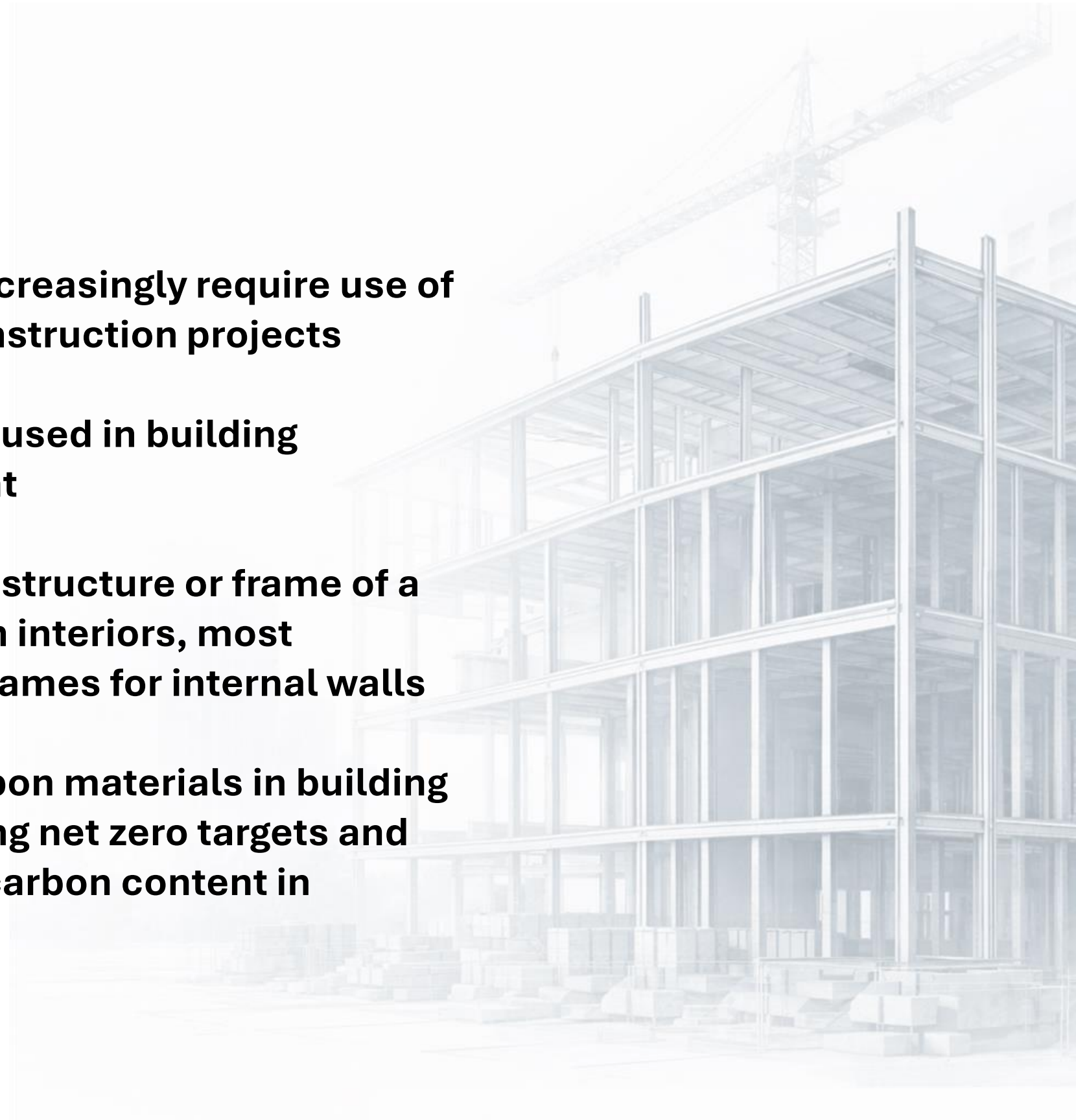

# THE SOLUTION

- **BioTwin has developed a lower-carbon direct replacement for steel studs**
- **BioTwin has developed a patent-pending hemp-based wall stud for internal partitions with a 70% lower carbon content than steel**
- **BioTwin studs can be installed using existing systems and workflows**
- **At a relatively modest scale, BioTwin hemp-based studs are cheaper than competitive steel products**



# READY FOR MARKET

- **BioTwin's products have been used successfully in four initial projects, three in the UK and one in New York**
- **BioTwin products have been evaluated by market-leading testing firms and have passed fire, structural lateral load, acoustic and thermal tests**
- **Independent Life Cycle Assessment studies by Imperial Consultants and BRE demonstrate that at current levels of production, the BioTwin stud is 71.5% lower in carbon than steel studs**
- **BioTwin has applied for patents on its materials and manufacturing process in the UK, with a PCT application (international application) also filed**



# COST COMPETITIVE

- **BioTwin's steel studs will reach cost parity at only 30,000 units of production (for context, 20,000 steel studs are required for one 18-story building)**
- **At production of 10 million units, cost per stud is projected to be less than half the cost of steel studs; at production of 20 million units, cost is projected to be less than one-third of the cost of steel studs**



# **INVESTMENT TO REACH THE NEXT PHASE OF DEVELOPMENT**

**BioTwin is seeking €2.5 to €3.5 million (£2.2 to £3.0 million) of new investment to implement the next phase of its development**

**Use of investment proceeds will be as follows:**

- **Building initial production line and fabrication of required machinery**
- **Critical hires – COO, Production Manager, Sales Manager**
- **Certifications and patents – certifications for new markets and application for patents in the US and potentially other locations**
- **Premises and overheads – establishment of production facility and creation of full operational readiness and production support**

# THE MARKET



**BioTwin**

## THE MARKET

- **One 18-story commercial building requires ~ 20,000 steel studs**
- **Commercial and office buildings are replaced or retrofitted approximately every ten years, making interior fit-outs a repeat-buy market**
- **Demand for building materials will continue to grow with ongoing new construction and exiting building retrofits**

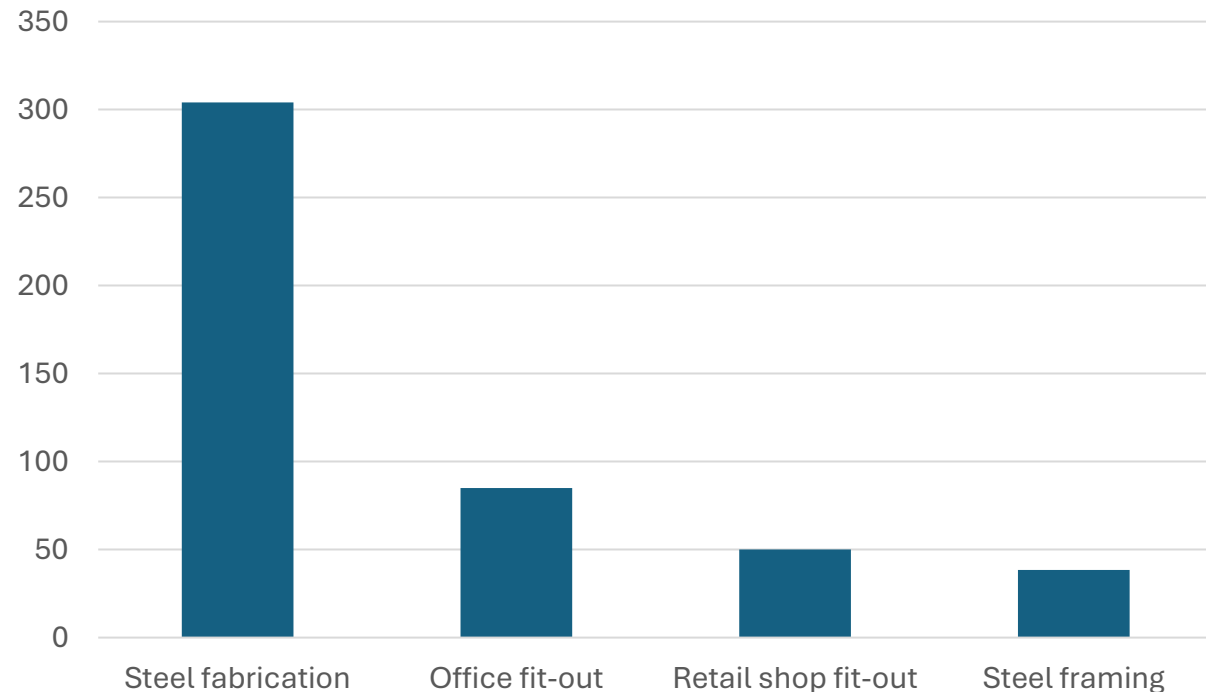

# NEED FOR DE-CARBONISATION OF BUILDING MATERIALS



**BioTwin**

## NEED FOR DE-CARBONISATION OF BUILDING MATERIALS

- **Builders are under increasing pressure to meet net-zero targets**
- **Net-zero demand is outpacing supply, and tenants increasingly expect carbon reduction to be part of building strategy**
- **Low-carbon premiums are narrowing — but high-carbon assets are increasingly penalised**
- **Investors and insurers increasingly penalise carbon risk**

### Low-carbon buildings outperform

Green premiums vs. share of green office stock



Green-certified buildings achieve pricing premiums.

Source: JLL Research – CBD Class A > 100,000 s.f. only.

[Link to research](#)

Source: JLL Research – CBD Class A > 100,000 s.f. only.  
[Link to research](#)

## NEED FOR DE-CARBONISATION OF BUILDING MATERIALS

- **BioTwin studs are 71.5% lower in Co2 now than the comparable figure for the most commonly used steel stud**
- **With scale, BioTwin will continue to reduce carbon content, ultimately to 95% lower (and 88% lower than for studs made with recycled steel)**

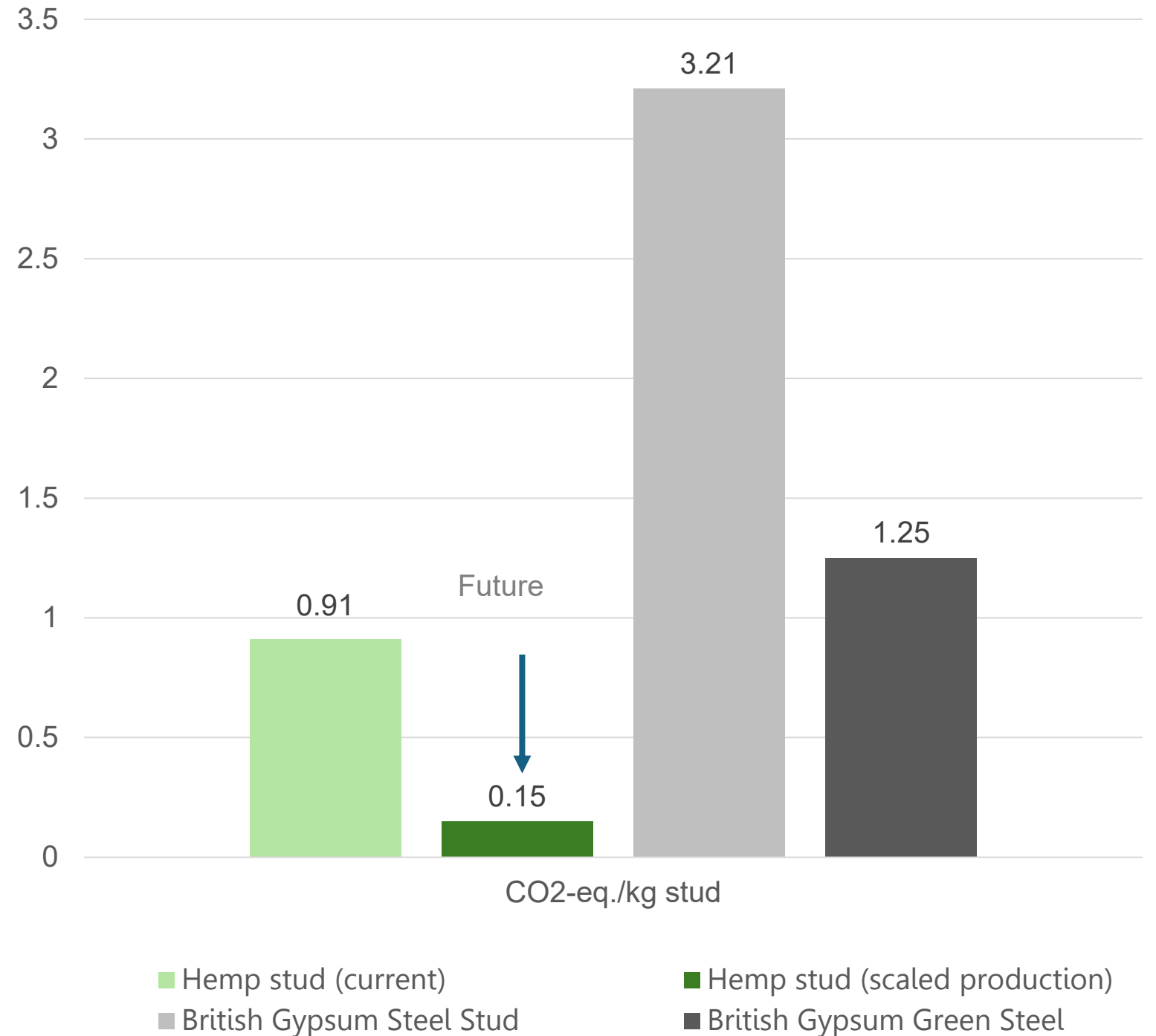

*Figures from Lifecycle Analysis Reports  
conducted by Imperial Consultants and BRE*

# THE PRODUCT



**BioTwin**

# THE PRODUCT

## Product Data

**BioStud 70: hemp-based wall stud**

---

## Material

**Hemp Fiber and Shiv 30%  
Binder and FR powder**

---

## Key Benefits

- ✓ 71.5% lower in carbon than conventional steel studs
- ✓ Acoustic and thermal enhancement
- ✓ Excellent tensile strength

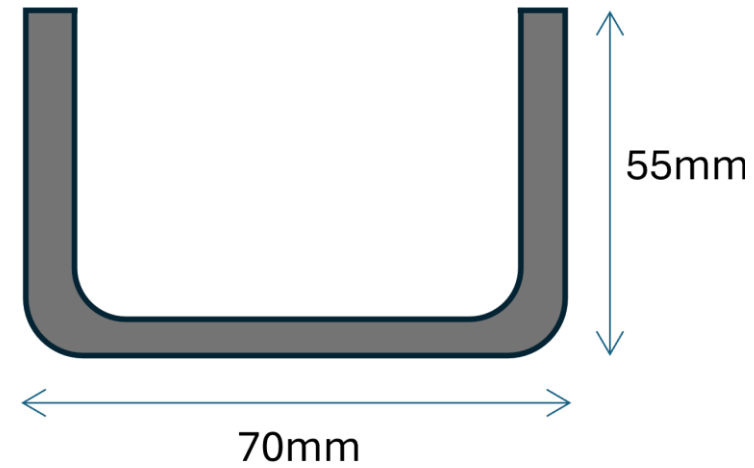

<b>Length: 2500mm (4mtr lengths in development)</b>	<b>Weight: 0.62kg/lm</b>
<b>Width: 70mm</b>	<b>Colour: Light brown finish</b>
<b>Thickness: 4-5mm</b>	<b>Storage: Indoors and kept in dry conditions</b>

## **BioTwin's hemp and resin-based studs are a direct replacement for steel studs**

- Hemp-based wall stud for internal partitions
- ~70% lower CO<sub>2</sub> than steel at current production levels (will reduce as production increases)
- Installs using existing systems and workflows



## THE PRODUCT

**Biostuds** are a direct replacement for steel studs and do not require material changes in workflows or specifications

- Same dimensions
- Same workflow
- No redesign required



70mm C stud British Gypsum



## STEEL



## BIOSTUaD

- ✓ High Carbon
- ✓ Standard Install

- ✓ ~70% lower CO<sub>2</sub>
- ✓ Same install

### Commercial Walls are systems

- Performance comes from the full assembly
- Enables direct substitution
- Direct replacement requires no redesign or changes in specifications

## BUILDINGS ARE SYSTEMS OF REPEATABLE PARTS

Standardised components.  
Installed at massive volume.  
Replace one, impact scales instantly.



### FLOORS

Structural slabs spanning the building.



### WALLS

Define spaces and separate environments.



### STUDS

The repeating element. Thousands per building.  
Maximum impact.

 **ONE CHANGE, MASSIVE IMPACT.**  
Replace the stud, transform the outcome.

■ OTHER COMPONENTS  
■ OUR FOCUS: THE STUD

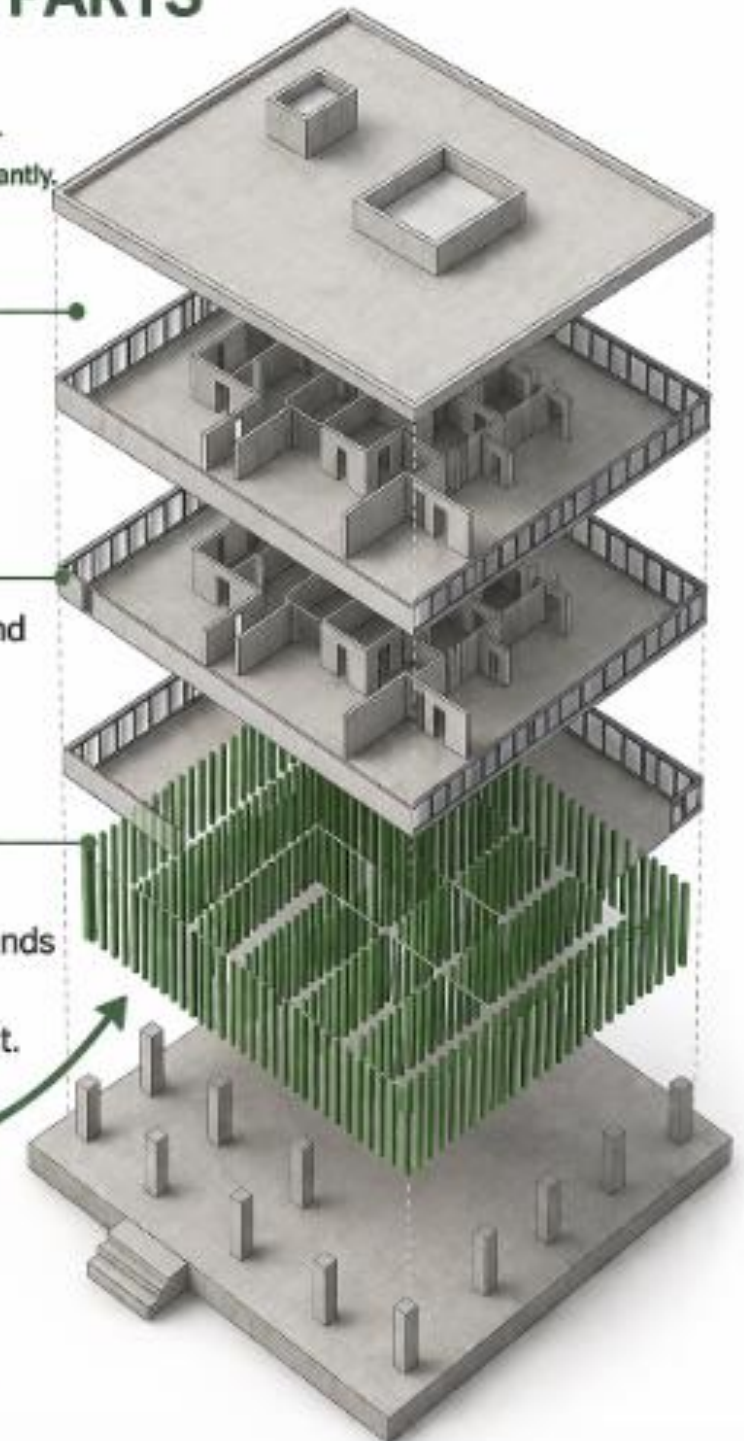

## THE PRODUCT

# The BioTwin process and manufacturing capability can be applied to the manufacture of other building products

- Acoustic isolator bars
- Horizontal channels
- And many more



# COMPETITIVE ADVANTAGE



**BioTwin**

## Can replace steel at scale

- Offers customers immediate carbon reduction
- Cheaper than steel at modest scale
- Can be applied to markets throughout the world



COMPETITIVE ADVANTAGE

Stud type	Low carbon	Acoustic Performance	Light Weight	Fire Resistance 60 & 120 mins (with plasterboard)	Cost	Screw grip & flex
	✓	✓ 37db	✓ 1.5kg	✓	Cost parity (30,000 units)	Good screw grip due to fibres. Little flex.
Steel C Stud British Gypsum, Siniat, and Knauf	✗	✗ 35db	✓ 1.46kg	✓	£3 – 4 (wholesale)	Thin steel, less grip. Can bend and buckle.
Timber CLS 47mm x 74mm Soft fast grown pine	✓	✗ 33db	✗ 3.47kg	✓	£3 – 4 (wholesale)	Good screw grip. Can warp/bow.

## COMPETITIVE ADVANTAGE

- **71.5% lower in carbon**, 95% as production scales
- Up to **5 decibels** sound improvement
- Patent-pending in the UK, with a PCT application (international application) filed
- 3 years of systems testing and validation
- Custom machine designed and operational
- Supply chain in place
- Cheaper when production scales



## Difficult to replicate process and IP

- Patent-pending in the UK, with a PCT application (international application) filed
  - We plan to enter the national patent application phase in the US, Europe, US and potentially other countries, covering material **and** manufacturing method
- BRE fire, acoustic and structural tests lock in spec advantage
- Independent Life Cycle Assessment A1-A3
- Custom machinery line, smart integration to existing machinery, layered material composition and supply chain know-how create real barriers





## **Cost & Scale**

Price gap reflects low production  
not inefficiency.  
Costs fall significantly with scale.



## **Carbon Creates Value**

Supports ESG, compliance and  
tender competitiveness.  
Increasing importance in  
decision-making.

# PROGRESS TO DATE



**BioTwin**

## Company operational at pilot stage

- Custom machine built and operational
- Completed three initial projects in London and one in New York
- Product tested successfully for fire, structural lateral load, acoustic and thermal
- Patent-pending in the UK, with a PCT application (international application) filed
- Product readiness level TRL 7–8

### Customers

FRASERS  
GROUP



IMPERIAL

NYC / EDC



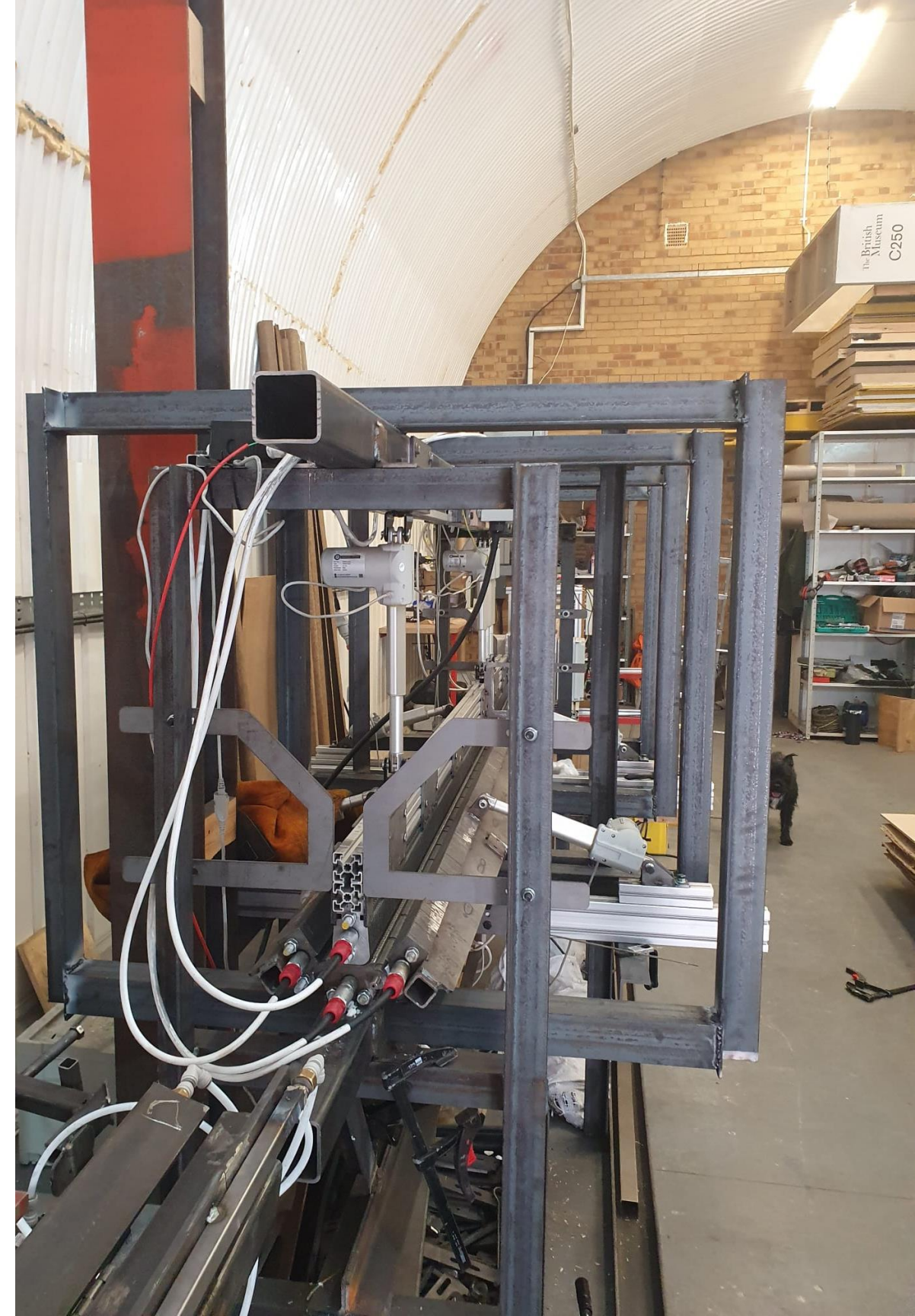

## Proprietary manufacturing process operating successfully

- Custom machine developed to produce BioStud at scale
- Tested and aligned with production workflows
- Used successfully in four initial projects
- Foundation for high-volume, cost-efficient manufacturing

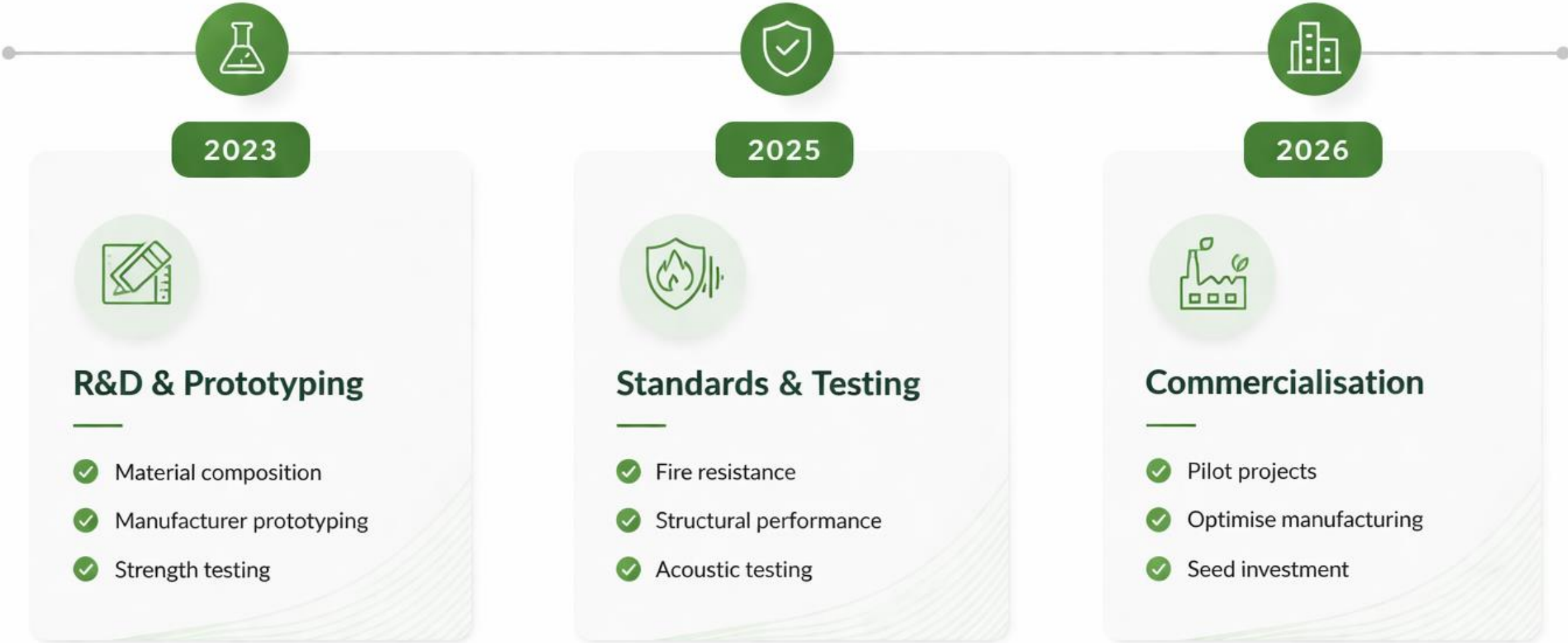

# Building, validating, and preparing to scale



 Raising **£2.6 million** | To accelerate pilot projects, scale manufacturing, and drive market entry.

CLEAR PATH TO CREATING SCALE



**BioTwin**

# CLEAR PATH TO CREATING SCALE

- **Clear route to market and path to scale**
  - Pilots → specification
  - Contractors → supply
  - Global rollout

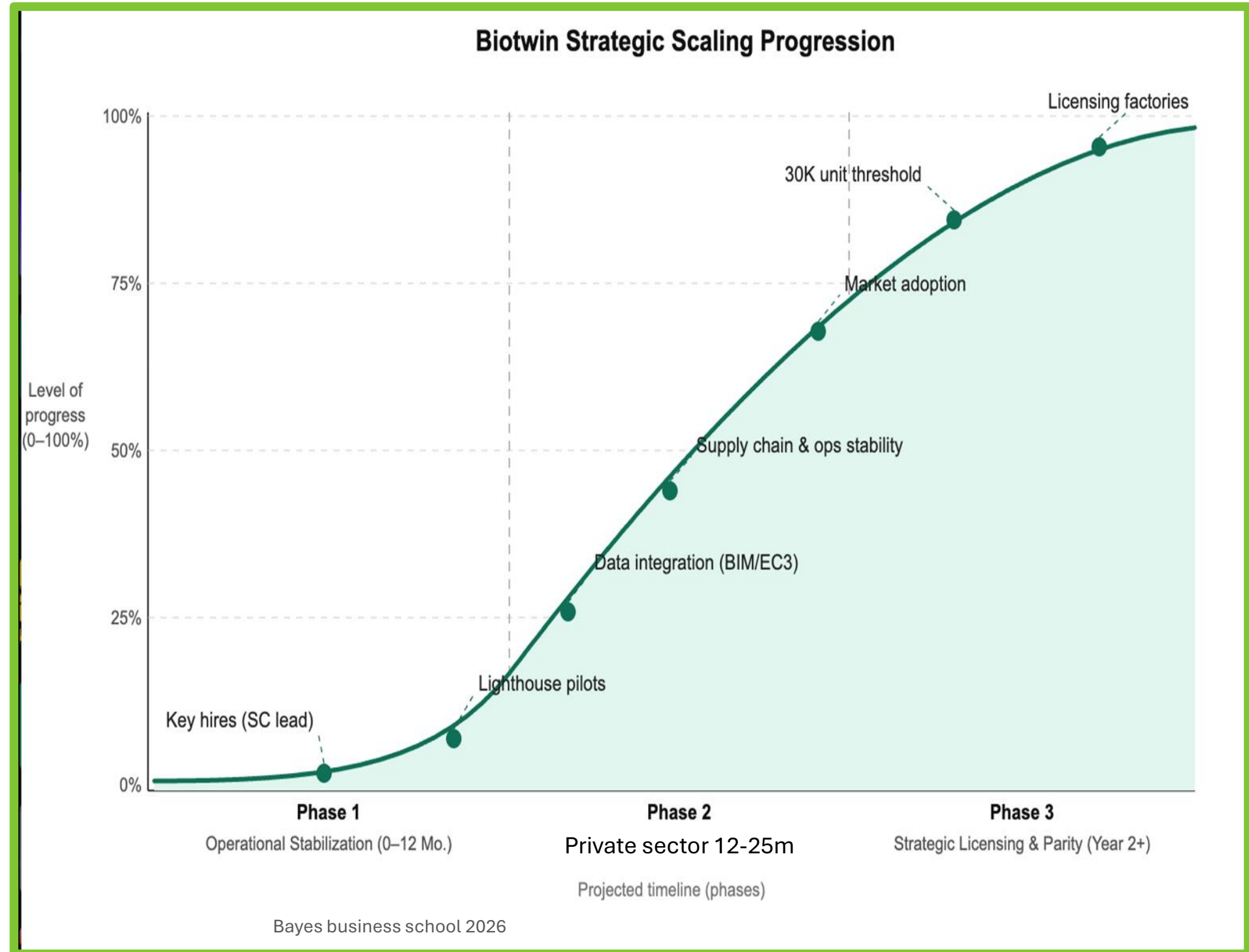

## Completed production road map 2025-2026

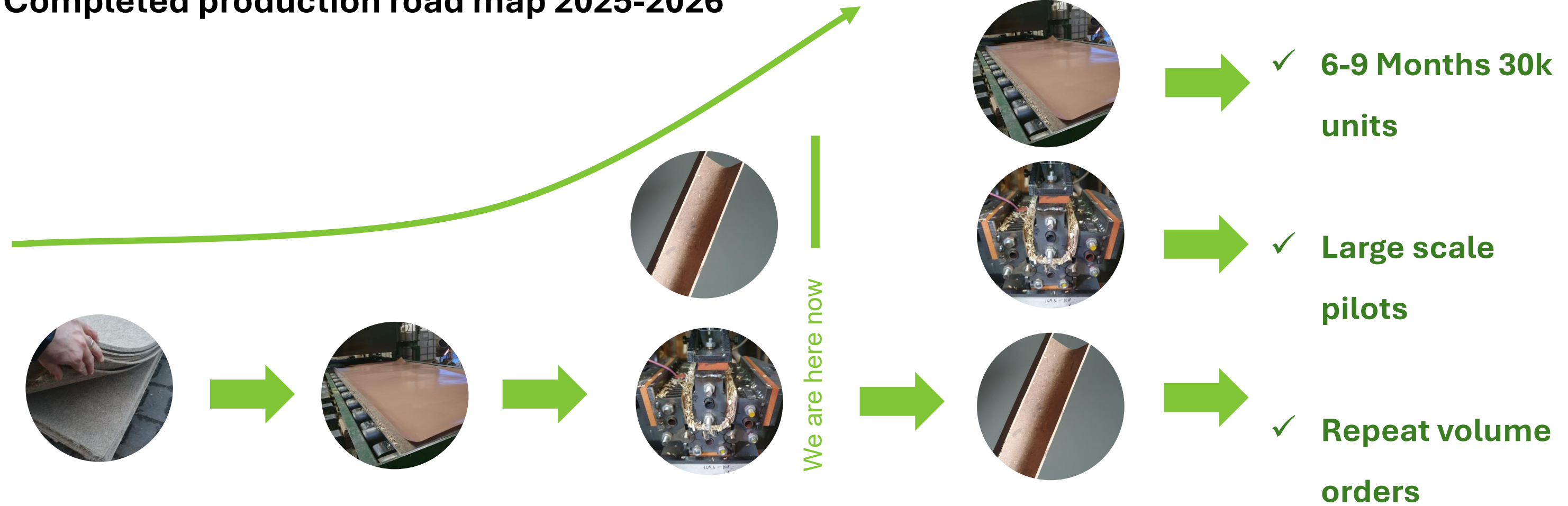

### RAW MATERIALS

- ✓ Hemp + Resin
- ✓ Established partners to produce both parts of the material

### MANUFACTURE PARTNER

- ✓ Established EU partner
- ✓ To press sheets at scale
- ✓ Only at 2.6mtr
- ✓ Grow partners for 4mtr

### PRODUCTION

- ✓ BioTwin presently takes raw material
- ✓ forms Stud
- ✓ Volume sub 1K
- ✓ Pilots low volume

### SCALE PRODUCTION 9-12 Months

- ✓ **Low-capex** forming line make 4m BioStud high density ready for larger commercial pilots.
- ✓ Secure volume orders
- ✓ Build Pilot plant

## BioStud cost today <£10 → ~ £3.26 at modest scale

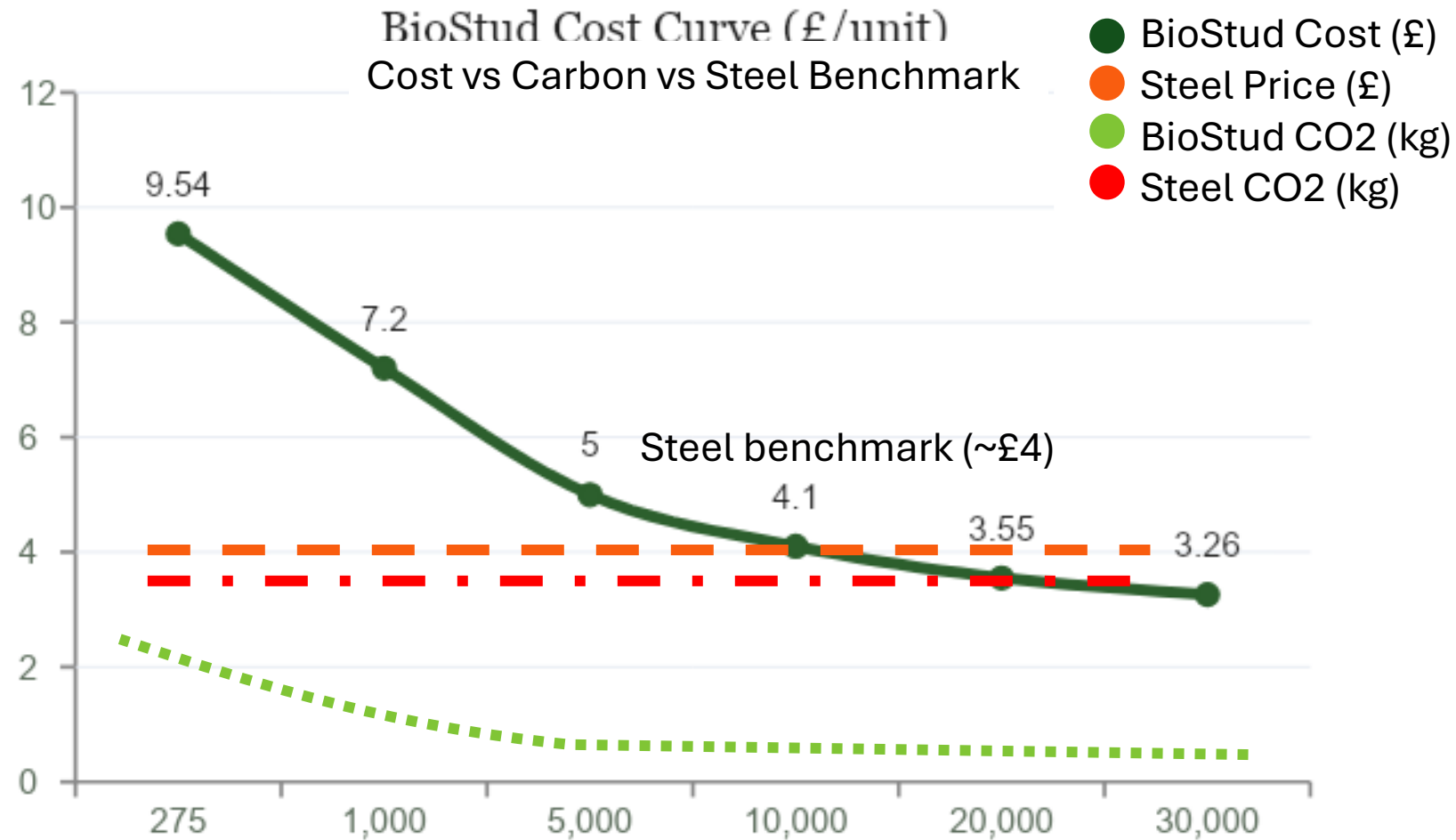

Steel benchmark: £3–4/unit set at 10 million units +

Cost per unit today is:

**£9.54**

Pilot production (~275 units)

Cost per unit at 30k units is:

**£3.26**

Matches steel stud production cost

Cost per unit at 10m units is:

**£1.50**

Less than half the production cost of steel studs

Cost per unit at 22m units is:

**£1.00**

Less than one-third the production cost of steel studs

TEAM



**BioTwin**

# TEAM



## Matthew Elton - CEO

### Co-founder, manufacturing & product leader

---

- ✓ 20+ years in design,
- ✓ manufacturing, construction
- ✓ Built and exited multiple businesses
- ✓ Specialist in materials and production at scale



## Jane Goddard - CTO

### Testing, certification & product strategy

---

- ✓ Deputy CEO, Building Research Establishment (BRE)
- ✓ Leads certification, compliance, and system performance
- ✓ Deep expertise in construction standards



## Henry Schmeltzer - NED<sup>1</sup>

### Finance, structuring & global expansion

---

- ✓ 40+ years in finance, banking, and trade
- ✓ Expert in international structuring (Malta, US, EU)
- ✓ Supports scale, capital strategy, and governance



## Burcu Karaca - Advisor

---

- ✓ CEO, BPREG Composites
- ✓ Hemp and materials specialist



## Matteo Turi - Advisor

---

- ✓ Experienced CFO
- ✓ Capital strategy specialist

<sup>1)</sup> To be appointed

# USE OF FUNDS AND SUMMARY FINANCIAL PROJECTIONS



**BioTwin**

# Use of proceeds

Funding	Allocation	Activities
Manufacturing	40%	<ul style="list-style-type: none"> <li>• Setup new pilot production line by Oct 2026</li> <li>• Custom machine line and off the shelf machinery 60/40 split</li> <li>• Gets us to cost parity with steel studs</li> <li>• Produce up to 40,000 stud units per month</li> <li>• Custom machinery: 43% Off-the-shelf equipment: 25% Install &amp; contingency: 32%</li> </ul>
Team	25%	<ul style="list-style-type: none"> <li>• Critical hires to unlock sales growth and optimising production</li> <li>• Go from 5 employees to 10</li> <li>• COO (operations &amp; scale) Production Manager (output &amp; quality) Sales (commercial traction) Technical support (product delivery)</li> </ul>
R&D/certifications	15%	<ul style="list-style-type: none"> <li>• Variants of studs and new acoustic profiles</li> <li>• UK regional certifications and EPD</li> <li>• De-risking product for full commercial deployment</li> <li>• Certification (fire, acoustic, structural)</li> <li>• Product refinement for scale</li> <li>• Enabling specification across key markets</li> </ul>
Overheads	20%	<ul style="list-style-type: none"> <li>• Facility costs are relatively modest (~£50–100K/year), with the majority of overhead allocated to operational readiness and production support.</li> </ul>

USE OF FUNDS AND SUMMARY FINANCIAL PROJECTIONS

# Five-year projections for revenues, profits and project volumes

Year	Revenue	Profit	No of Projects
2026	£420,000	-£284,572	42
2027	£5,130,000	£669,490	171
2028	£19,125,000	£5,899,282	382
2029	£47,250,000	£20,980,248	945
2030	£110,250,000	£61,740,828	2205

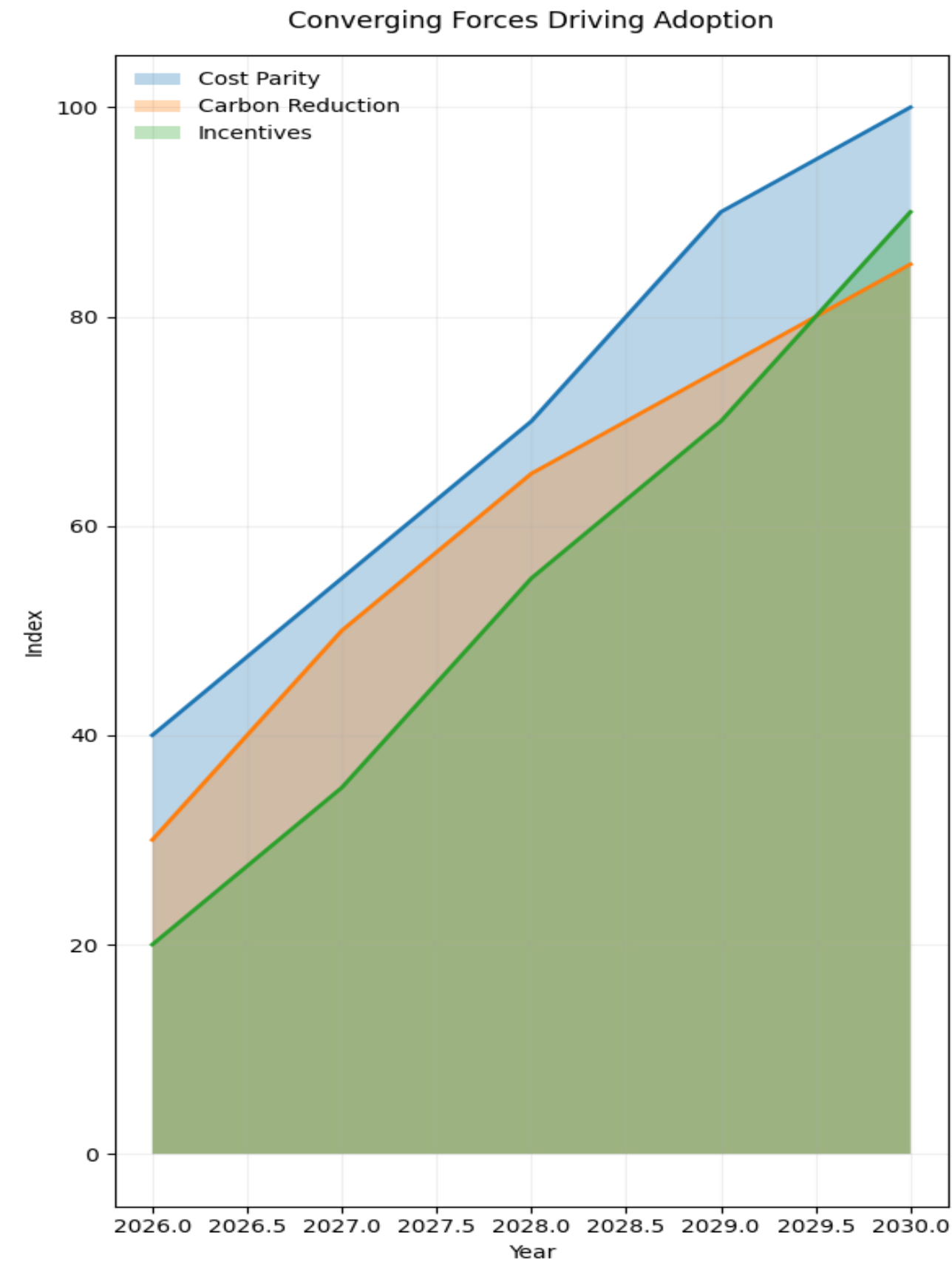

# APPENDICES



**BioTwin**

APPENDIX 1  
COMPLETED  
CERTIFICATIONS



**BioTwin**

## **BioTwin products have received the following certifications from highly qualified testing firms**

- Fire Testing
- Lateral Load Testing
- Sound Insulation Testing
- Thermal Conductivity testing
- Life Cycle Assessment - A1-A3



## Testing with one and two layers of fire-rated plasterboard shows BioStud can meet fire standards in both standard and higher-performance wall systems

- 60min Furnace test - EN13501-1:2023
- 3m x 3m Single layer 15mm FR plasterboard
- 120min Furnace test - EN13501-2:2023
- 3m x 3m Double layer 15mm FR plasterboard

### Tests conducted by BRE

[Fire report 120min](#)

[Fire report 60min](#)



## We test structural load to make sure BioStud can safely replace steel in real building conditions

- 3.6m tall walls 4-point bend test
- 4.6m tall walls 4-point bend test
- Double layer 12,5mm Plasterboard

## Tests conducted by BRE

[Lateral Load report 3.6m](#)

[Lateral Load report 4.6m](#)



## We tested to prove BioStud improves wall performance while keeping costs the same

- Sound Insulation Testing for Drywall Partitions
- ISO-10140-1:2021 BS EN ISO10140-2:2021

### Tests conducted by BRE

[Sound report](#)

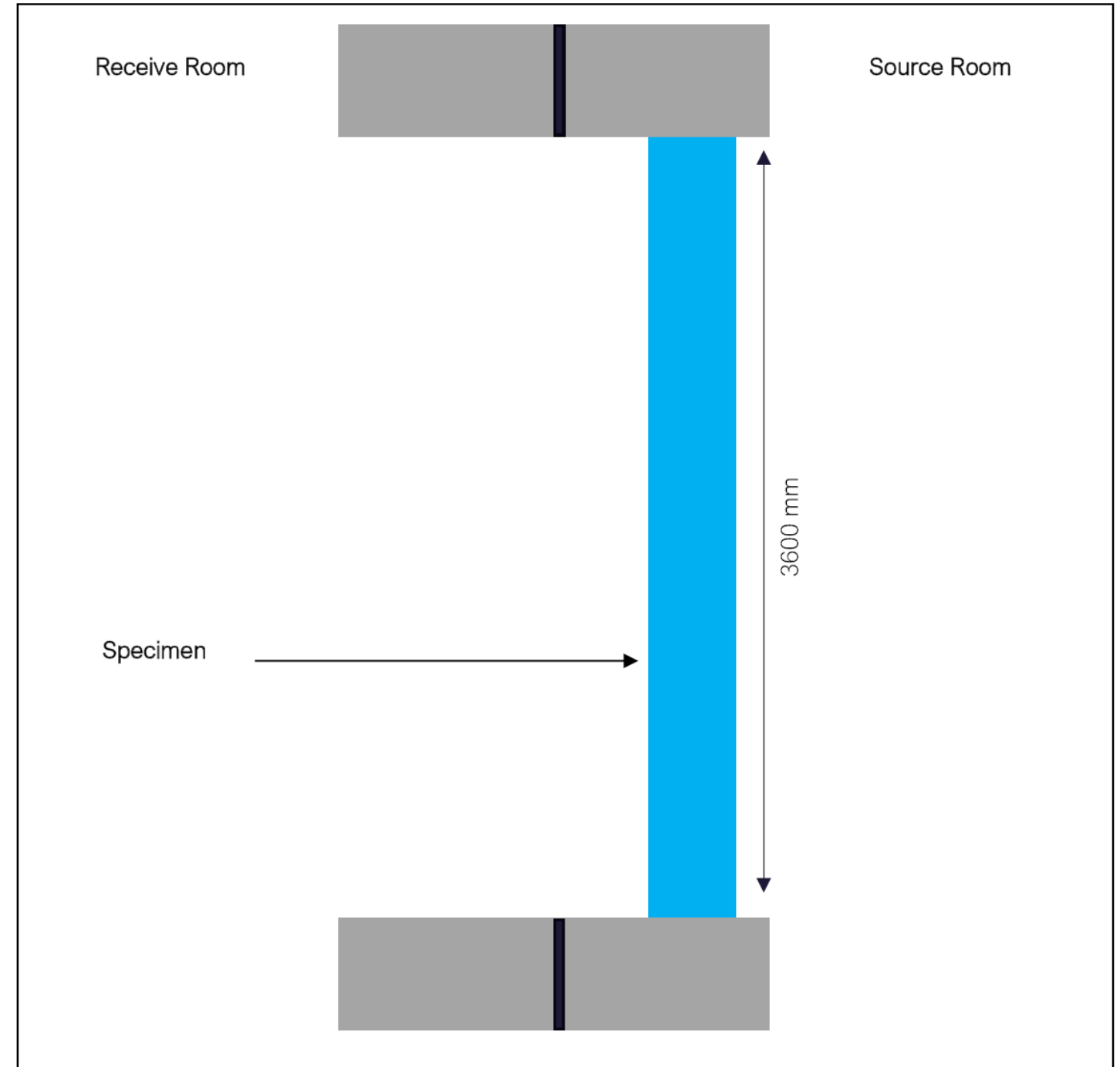

Figure 2: Plan through elevation showing the approximate position of the test samples in the transmission suite aperture.

**W/m·K = is a measure of how easily heat moves through a material**

- **Higher number** = heat passes through easily (like steel)
- **Lower number** = heat is blocked / slowed (like BioStud)

## Thermal Testing

- Thermal Conductivity Test
- ASTM C518-21

## Tests conducted by BRE

Thermal Report

SAMPLE	THICKNESS/M M	MASS/g	TEMP/C	BioStud K/W/mk	Steel K/W/mk
BioTwin-1	4.9	7.957	31.89	0.135	50
BioTwin-1	4.9	7.957	51.74	0.131	50
BioTwin-2	4.9	8.212	32.23	0.139	50
BioTwin-2	4.9	8.212	51.92	0.135	50
BioTwin-3	5	8.298	32.17	0.135	50
BioTwin-3	5	8.928	51.9	0.135	50

## **LCA measures the total environmental impact of a material from production to disposal**

- Independent LCA A1-A3 studies conducted by Imperial Consultants and BRE both prove at present volumes the Bio Stud is 71.5% Lower carbon than steel studs.

[BRE LCA Report](#)

[Imperial LCA Report](#)

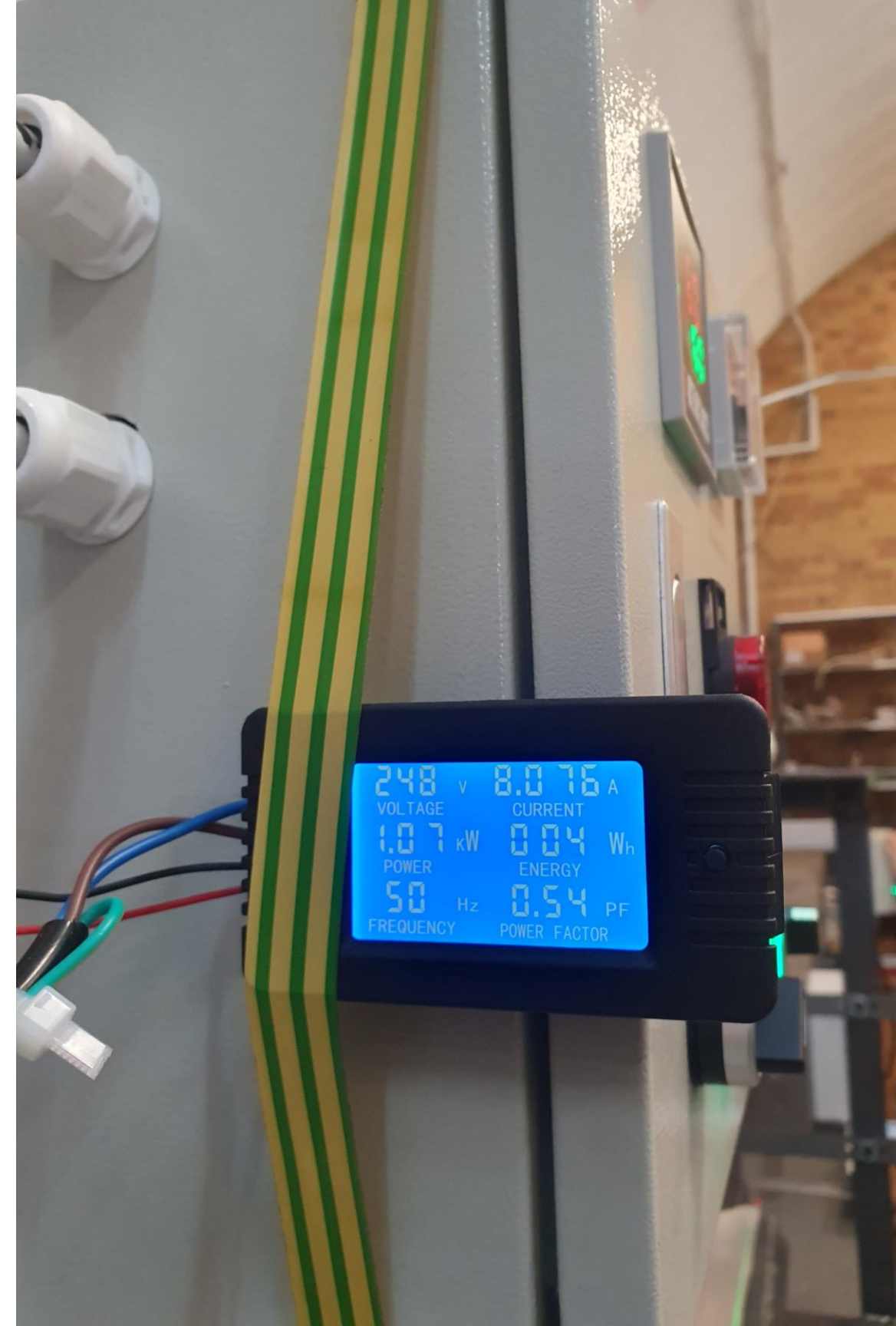





# APPENDIX 2

## COMPLETED PROJECTS



**BioTwin**

# Working with major developers like British Land shows how seriously the industry is taking BioStud

Completed pilots and customers	Location	Real estate	Future projects
	London	Owns £269m of property directly	Current tender for 12-storey block <a href="#">Media coverage</a>
	London	Portfolio spans 22mil sq ft space	Central London retrofit + more projects
	London	3,900 offices and branches globally	Discussion on other office retrofits
	New York	NY's largest landlord, 60m sq ft space	1st international pilot, Brooklyn Discussions on BATWorks retrofit <a href="#">Video</a> <a href="#">Press release</a>

## British Land, completed 2026

- Portfolio spans 22mil sq ft space
- 2nd UK installation
- Current tender 20 Triton Street
- Chosen to reduce carbon and acoustics
- Central London retrofit + more projects

[Video](#)



## Imperial/Sciopolis, completed 2026

- Owns £269m of property directly
- 1st UK installation, London
- Current tender for 12-storey block
- Chosen to reduce carbon and acoustics
- Current tender for 12-storey block

[Video](#)

[Media coverage](#)



## HSBC, completed 2026

- 3,900 offices and branches globally
- Discussion on other office retrofits
- Chosen for its acoustic benefits
- Discussion on other office retrofits

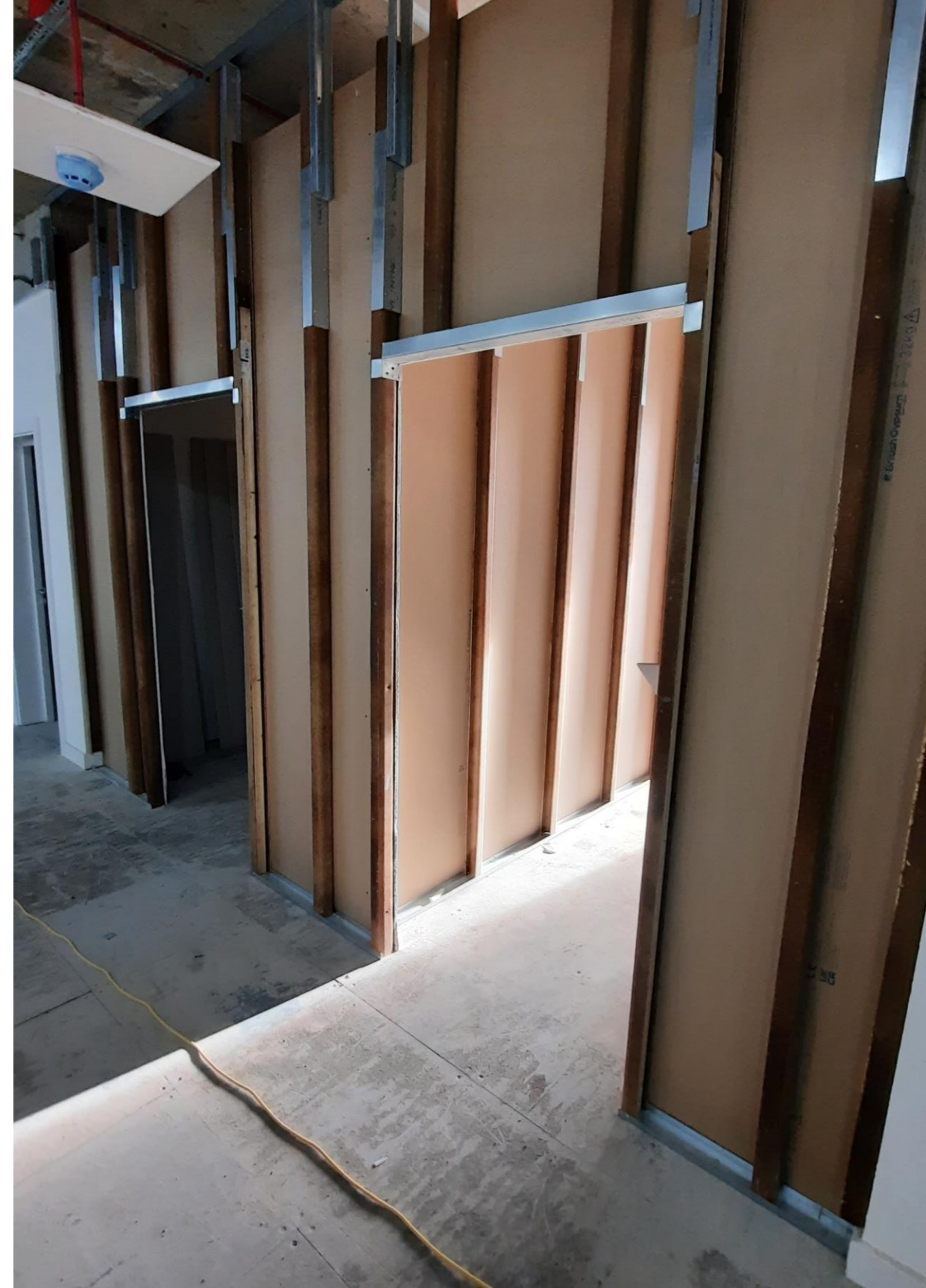

## **NYEDC, completed 2025**

- 60m sq ft space
- 1st international pilot
- Discussions on BATWorks retrofit

[Video](#)

[Press release](#)



# Replacing steel with biomaterials that install the same way

Target market commercial fit-out and retrofits

[matt@biotwin.co.uk](mailto:matt@biotwin.co.uk)  
[www.biotwin.co.uk](http://www.biotwin.co.uk)



**BioTwin**

THANK YOU

