

GREEN  
PARK  
**TULIP**



EXCLUSIVELY FOR **BOHRA COMMUNITY**

LIMITED EDITION  
SUPERLATIVE SIGNATURE RESIDENCES  
KONDHWA, PUNE

MAHARERA NO. P52100000501



## Tulip @ Capricorn Green Park.

All the amenities are exclusive and has one flat per floor, high wall to Window Ratio for better Natural Lighting & Cross Ventilation

# INSPIRED HOMES

A curated collection of the most premium apartments in Pune, Green Park Tulip, bespoke homes for quintessential living. A paradigm of contemporary luxury, designed to foster modern lifestyles, Green Park Tulip has a mélange of modern architecture in a burgeoning neighbourhood.

Located at a prime location in Kondhawa, Green Park Tulip is your home base for daily excursions to everything of your need.

An elegant space in itself the Park Tulip makes a bold statement, highlighting your taste and style. Every home is designed to be chic and appealing, these residences and privy to an exquisite view of the city.



LIVING AREA



MASTER BEDROOM



DINING AREA

# INSPIRED LIFESTYLE

TOUCH FREE  
EXPERIENCES AT ONE PARK TULIP

TULIP  
GREEN  
PARK

## THOUGHTFULLY DESIGNED AMENITIES

### SWIMMING POOL WITH KIDS' POOL

Plunge in, relax and revel in the luxurious amenities offered at One Green Park. Colossal swimming pool along with a kid's pool for residents to enjoy and relax the evening with their peers.

### WELL APPOINTED CLUBHOUSE

A right mix of activities planned at the club will ensure the residents are a part of a lively community lifestyle.

### YOGA & MEDITATION LAWNS

Away from the metropolitan lifestyle, dwell into the charisma of nature. With the Yoga & Meditation lawns in the vicinity, it is easier for one to focus more on their health and schedule their routines with minor changes.

### KIDS' PLAY AREA WITH SKATING RINK

For the growing kids and their daily activities, Green Park Tulip has an expansive area where the children can play, enjoy, and caper their activities. Besides the play area, there is a humongous skating rink for the kids who enjoy skating, take classes, thereby promoting more physical

### JOGGING TRACK

The jogging track at One Green Park will help you keep yourself fit and competent for your routine or walk the talk.

### AMPHITHEATRE

It is a perfect place to enjoy a quality time with your friends and other peers and mass at large while watching theatre, act, or performance. Host your functions and performances at the alluring arena that is located right at the heart of the development.

### VEHICLE - FREE AMENITIES SPACE

The amenities at Green Park Tulip are as relaxing as they are supposed to be. Including yourself in things you do is as good as meditating. We add on to it by providing you with a vehicle-free amenities space.

Unique Pandemic Safety Features - touch-free experience

Touch-Free Elevator Call Panels on every floor

Motion Sensor based Light Fitting in Bathrooms

Sensor-Based Guest bathroom washbasin Tap for a touch-free experience

Three Tier Security for the Gated Community

Vehicle-Free Central Greens and Recreational Areas

More than 60% of Open Areas

Green Amenities like STP, OWC & Solar Lighting

Grand Entrance Lobbies with Access Control

High Window to Wall ratio for better Natural Lighting & Cross Ventilation

Video Door Phone with every apartment

Intercom To Entrance Lobbies & Between all apartments

CCTV Camera in Entrance Lobbies, Children's Play area and,

at the Club House Lounge

Fire Fighting Systems and Fire Hydrants

Smoke Detectors

Full Automation (AC, Curtains, Lights & Fans)

Split AC in each Apartment



# TULIP GREEN PARK

## TYPICAL FLOOR PLAN (4 BEDROOM APARTMENTS)

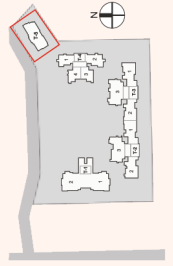

TOWER-5	TYPICAL FLOOR FLAT	REAR AREA (SQM)*	BALCONY (SQM)	UTILITY / DRY BALC (SQM)	TOTAL AREA (SQM)*
Series 1 Flats	101, 201, 301, 401, 501, 601, 701	156.45	8.96	4.47	169.88



**BlackRock Housing**

Real Estate since 2003

# PRREM KATARIA



**88289 59595**

Email : [blackrockhousing@gmail.com](mailto:blackrockhousing@gmail.com)

SITE ADDRESS; SURVEY NO. 25/2/2A, KONDHAWA (BK), PUNE -411 048, MAHARASHTRA, INDIA

The project has been registered via MahaRERA registration number; P52100000501 and is available on the website <https://maharera.mahaonline.gov.in> under registered projects

**MAHARERA NO. P52100000501**

