

**Boundary Survey**

TRACT "B"  
DRAINAGE/RETENTION



First American  
Title Insurance Company

- ① R = 275.00'(P)
- L = 47.39'(P)
- Δ=9°52'24"(P)
- CH = 47.33'(P) 47.32'(M)
- CB = N36°03'37"W(P)
- N 36°03'10" W(M)

FND 1/2" IRON ROD & CAP LB #4937

- S 81°50'21" E(P)
- 55.90'(P)
- S 81°44'57" E(M)
- 55.96'(M)

LOT 15

LOT 16

FND 1/2" IRON ROD & CAP LB #4937

- N 49°00'11" E(P)
- N 49°00'11" E(M)

- 135.00'(P)
- 134.99'(M)

- S 00°36'01" E(P)
- S 00°36'01" E(M)

LOT 17

- 135.00'(P)
- 134.93'(M)

FND 1/2" IRON ROD & CAP LB #4937 WALK IS 0.1' OFF

- N 41°02'46" W(M)
- N 11°64'(M)
- N 40°59'49" W(P)
- 11.57'(P)

PT FND 1/2" IRON ROD & CAP LB #4937 WALK IS 0.1' OFF

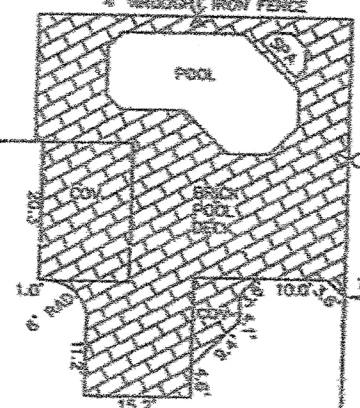

TWO STORY RESIDENCE #1560

FND 1/2" IRON ROD & CAP LB #4937 WALK IS 0.3' OFF

FND 1/2" IRON ROD & CAP LB #4937 WALK IS 0.2' OFF

FND 1/2" IRON ROD & CAP LB #4937 WALK IS 0.5' OFF

- S 89°25'00" W(M)
- 63.66'(M)
- S 89°23'59" W(P)
- 63.59'(P)

FND 1/2" IRON ROD & CAP LB #4937 WALK IS 0.3' OFF

TRACT "A"  
BELFIORE WAY  
50' PRIVATE ROADWAY  
ASPHALT ROADWAY

- ② R = 25.00'(P)
- L = 30.73'(P)
- Δ=70°25'29"(P)
- CH = 28.83'(P) 28.83'(M)
- CB = S66°20'09"E(P)
- S 66°23'58" E(M)

- ③ R = 175.00'(P)
- L = 33.44'(P)
- Δ=10°56'53"(P)
- CH = 33.39'(P) 33.29'(M)
- CB = S83°55'32"W(P)
- S 83°54'10" W(M)



1" = 30'  
GRAPHIC SCALE

ADDRESS  
1560 BELFIORE WAY  
WINDERMERE, FLORIDA 34786

LEGAL DESCRIPTION: (AS FURNISHED)

LOT 16, TUSCANY RIDGE, ACCORDING TO THE PLAT THEREOF.

AS RECORDED IN PLAT BOOK 32, PAGES 141 THROUGH 144, OF THE PUBLIC RECORDS OF ORANGE COUNTY, FLORIDA.

BASIS OF BEARINGS: BEARINGS SHOWN HEREON ARE BASED ON THE EASTERLY LINE OF LOT 16, BEING N 00°36'01" W, PER PLAT

LIST OF POSSIBLE ENCROACHMENTS:

RLS #:	07-11-0253
CLIENT #:	1098-1776293
FIELD DATE:	11/08/07
DRAFTER:	BEK
APPROVED:	AER
SCALE:	1" = 30'