

GREEN ISLAND COVE

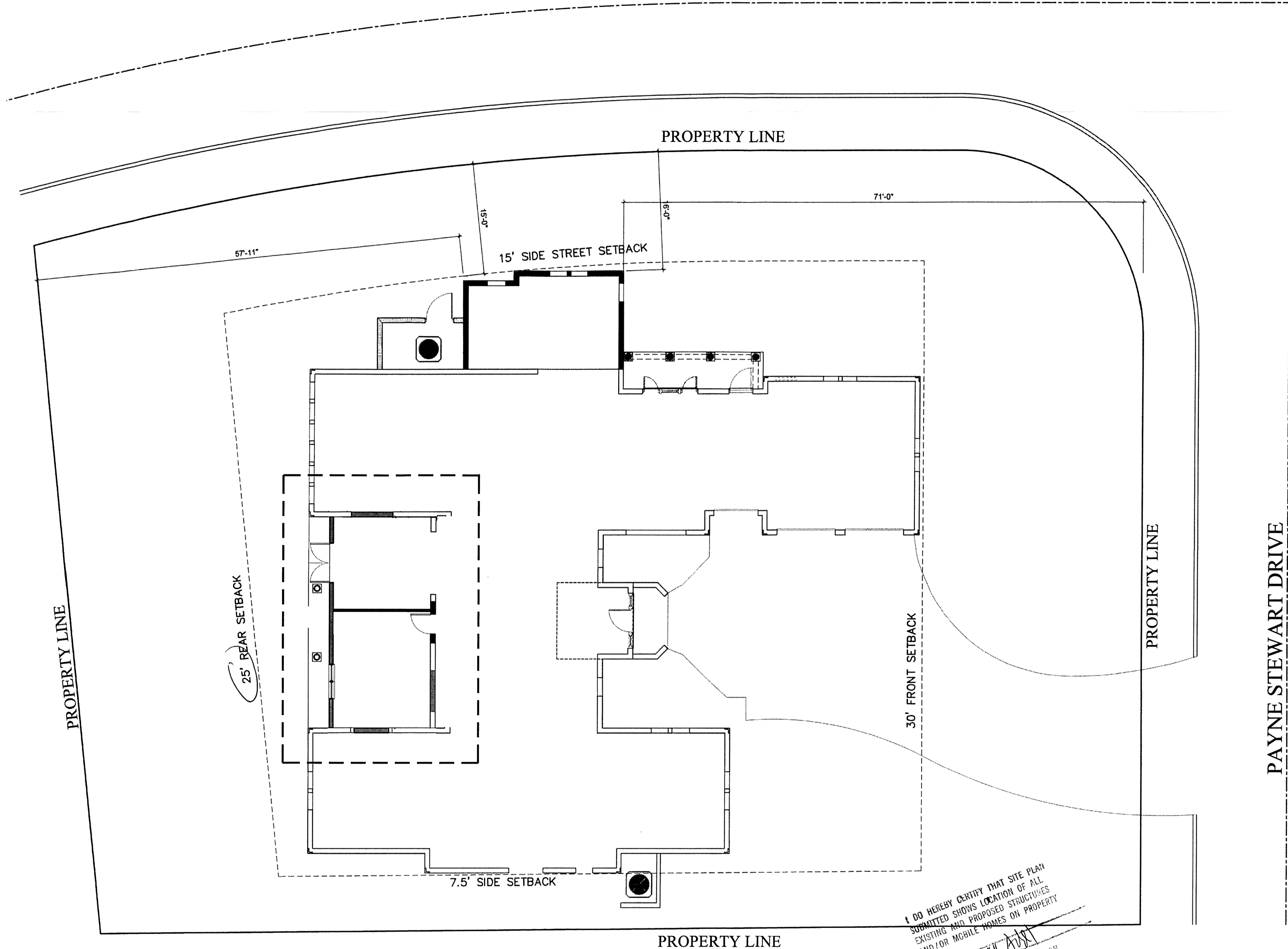

PERVIOUS VS. IMPERVIOUS

TOTAL LOT AREA:
15,025 S.F. = .345 ACRE
AMOUNT IMPERVIOUS =
5,867 SF = 39% IMPERVIOUS

SETBACKS:

BUILDING:
FRONT 30'
SECOND FRONT 15'
REAR 25'
SIDE YARD 7.5'

LEGAL DESCRIPTION

LOT 344, ISLEWORTH, ACCORDING TO THE PLAT THEREOF, AS RECORDED IN PLAT BOOK 16, PAGE(S) 118-130, OF THE PUBLIC RECORDS OF ORANGE COUNTY, FLORIDA.

I DO HEREBY CERTIFY THAT SITE PLAN
SUBMITTED SHOWS LOCATION OF ALL
EXISTING AND PROPOSED STRUCTURES
AND/OR MOBILE HOMES ON PROPERTY
APPLICANT: *[Signature]*
DATE: *11/15/2011*
ORANGE COUNTY ZONING DIVISION

APPROVED BY: *[Signature]*
In addition to public regulations which Orange
County enforces, be advised that there may be other
private restrictions or approval requirements that will
affect your ability to build this structure. Please review
your deed restrictions and/or consult with your
Homeowners Association or Architectural Review
Board.

