

# *Audi R8 MK2*

## *Cluster + gauge pod*



### *Installation guide*

**AUDI R8**

**2015-PRESENT: TYPE 4S**



Welcome to you new Podwurx Audi R8 cluster + 60mm gauge pod!

Make sure that you have what is shown here before you start

1 pod, 2 square "O"ring



Start by making sure you have all your wiring ran to the drivers footwell.

Coverage of installing all the supporting wiring, hoses or cables will not be covered beyond the scope of the gauge pod itself.



Tools that will be needed are as follows

1. 8mm socket
2. 1 long extension
3. 1 short extension
4. 1 ¼ ratchet
5. 1 pick tool
6. 1 trim tool



Start with removing the trim cover panel directly forward of the cluster assembly



Using the small trim tool gently pry the edge of the trim panel up and pull with fingers.





This panel will need to be slid forward  
Then out.





Remove only the 2 screws show circled  
In green.

Next lower the starting column as far down and out as possible.



This will allow access to the trim panel below the cluster.



Using a trim tool remove the panel by gently prying out and snap back and let rest aside





Using the long extension remove the 2, 8mm screws from under the cluster. They are deep Use a magnet to catch the screw if nessasary.



Then carefully lift the cluster up and set it on its side using protection on the leather dash components.



Use a soft towel or microfiber to protect the dash and the carbon.



3 plugs and one clip will need to be removed.



Use a pick to depress the lock and pull the lever back.





Use the pic tool to press in the clips on the 2 small plugs, space is tight and fingers will not fit in the small space provided.



Be careful with the can cable and press on the clip lever shown then pull gently.



Then remove the entire cluster from the vehicle carefully over the steering wheel.

---

## ***Pod installation to the cluster***

Now lay your cluster on a flat soft surface to prepare for disassembly



Lay the cluster on its top and remove all the fasteners shown circled in green.

8mm socket



Then flip and remove the leather visor from the cluster



Next remove the lower 8mm head bolt from the bottom of the carbon shroud cover. Set this bolt aside as it will be reinstalled in a different location.



Also remove the 8mm head bolt from the front of the cluster forward housing.

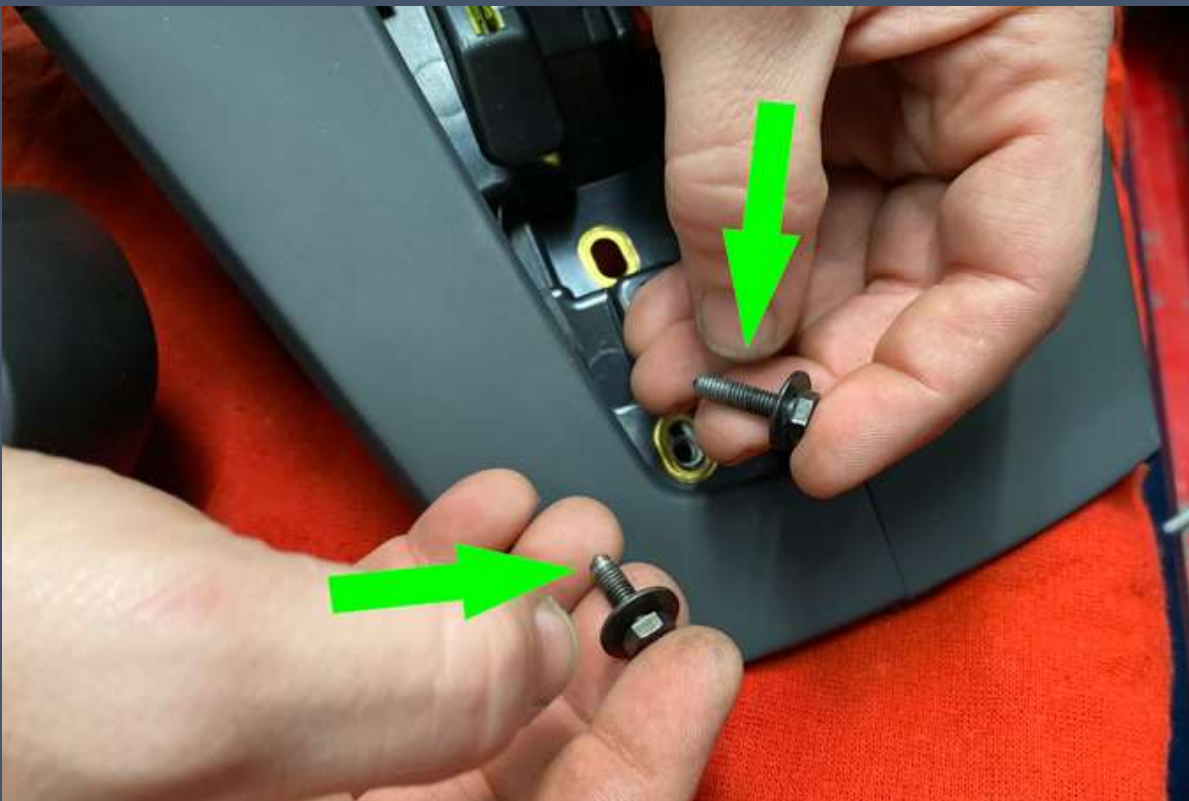

You can see there is a length difference. Replace the longer bolt for the forward housing with the shorter one from the carbon shroud. This is important as you will need the longer bolt to hold the gauge pod to the carbon shroud later.



***Now pre install the gauge of your choice.***

For this example we will be using a readily available boost controller.



Start by installing the mounting band over the gauge housing on a gauge of this size 2 bands may be needed for a secure hold in the pod.





Pass the gauges wiring though the pods passage way.



Next slide the gauge in to the pod making sure the rings slide in to the pod smoothly



Then press the gauge until it seats in the pod.

Note: that if you have a 52mm gauge and are using the optional 52mm adapter ring, install the ring first and follow the same procedure shown.



Run the wiring or lines in the designed channel like shown.



Now install the pod on to the carbon shroud.



Hook the top of the pod into the opening it may not stay unless held but it will get you lined up for the lower mounting bolt in a moment.



Make sure that the wires are in the channel

then install the longer screw from earlier as shown.





Now holding the upper part of the pod in the channel opening, reinstall the latter sun shroud.



Snug all the sun shroud bolts to the point that the top of the pod is sandwiched in the channel securely.



With the pod installed on to the cluster assembly, reinstall the cluster assembly in the reverse order being sure to connect and rough the wiring for the gauge.



Use this joint to run the wires.



***This concludes your installation.***

## *In the case of using a 52mm adapter*

---

Use the 52mm adapter by inserting in to the Audi gauge pod, in most cases it is not necessary to use a mounting band to install as it is a light press fit but for a tighter fit 1 single band can be used.



Some manufactures may not always make a perfect 52mm gauge body, An example is the Snow performance Meth controller that comes in around 51 mm, you can use a method of crossing the mounting as shown







***You have now completed your gauge install.  
Enjoy!***

---



# ***PodWurX***

**602-935-8955**   [\*info@podwurx.com\*](mailto:info@podwurx.com)

[\*www.podwurx.com\*](http://www.podwurx.com)



